

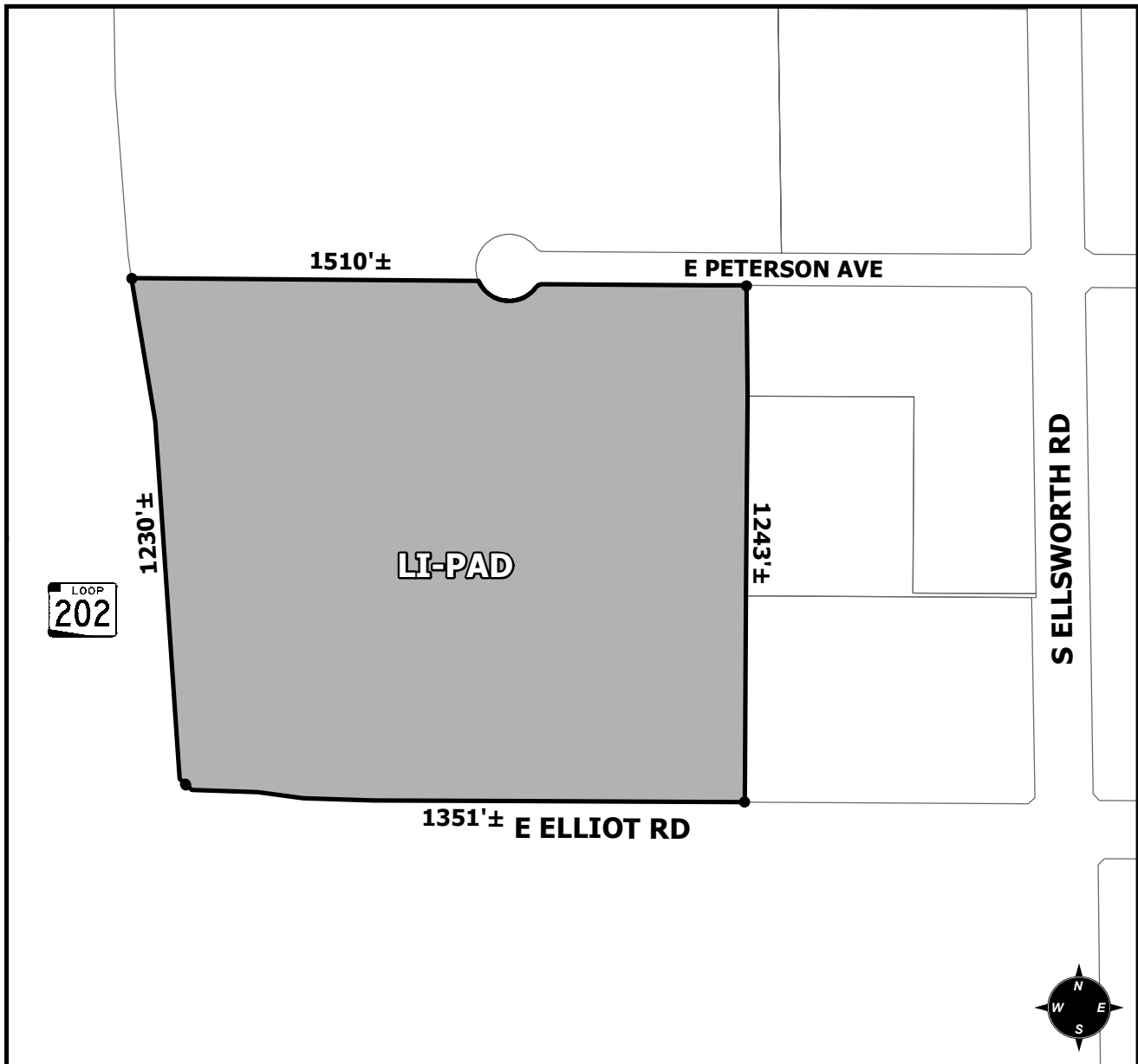

OFFICIAL SUPPLEMENTARY ZONING MAP AMENDING THE CITY OF MESA ZONING MAP



CASE: ZON21-00224

ACREAGE: 41±

REQUEST: REZONE FROM LIMITED COMMERCIAL (LC) WITH A PLANNED AREA DEVELOPMENT OVERLAY (PAD) AND PLANNED EMPLOYMENT PARK (PEP)-PAD TO LIGHT INDUSTRIAL (LI)-PAD: AND SITE PLAN REVIEW.

ORDINANCE: _____

Please be advised that the attached zoning changes were approved by the Mesa City Council on _____, 2021 by Ordinance # _____. If you have any questions concerning these changes, contact the City of Mesa Planning Division at 480-644-2385.

MAYOR

ATTEST: _____
CITY CLERK

DATE: _____