

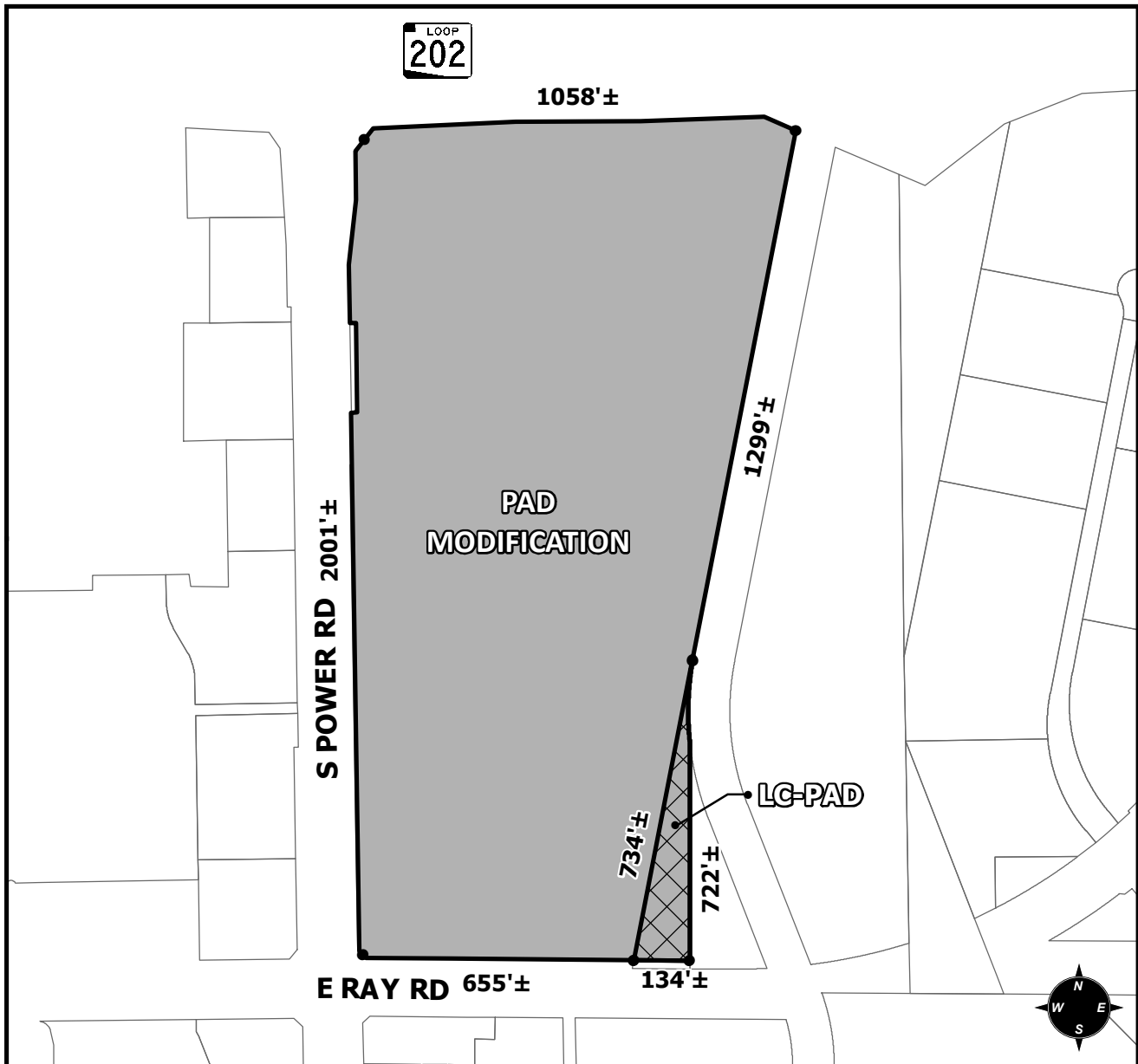

OFFICIAL SUPPLEMENTARY ZONING MAP AMENDING THE CITY OF MESA ZONING MAP



CASE: ZON21-00069

ACREAGE: PAD MODIFICATION - 41±; REZONE AG TO LC - 1±

REQUEST: REZONE 1± ACRE OF THE 41± ACRE PROPERTY FROM AG TO LC-PAD.
SITE PLAN MODIFICATION OF AN EXISTING PAD ON THE ENTIRE 41± ACRES

ORDINANCE: _____

Please be advised that the attached zoning changes were approved by the Mesa City Council on _____, 2021 by Ordinance # _____. If you have any questions concerning these changes, contact the City of Mesa Planning Division at 480-644-2385.

MAYOR

ATTEST: _____ **DATE:** _____

CITY CLERK