

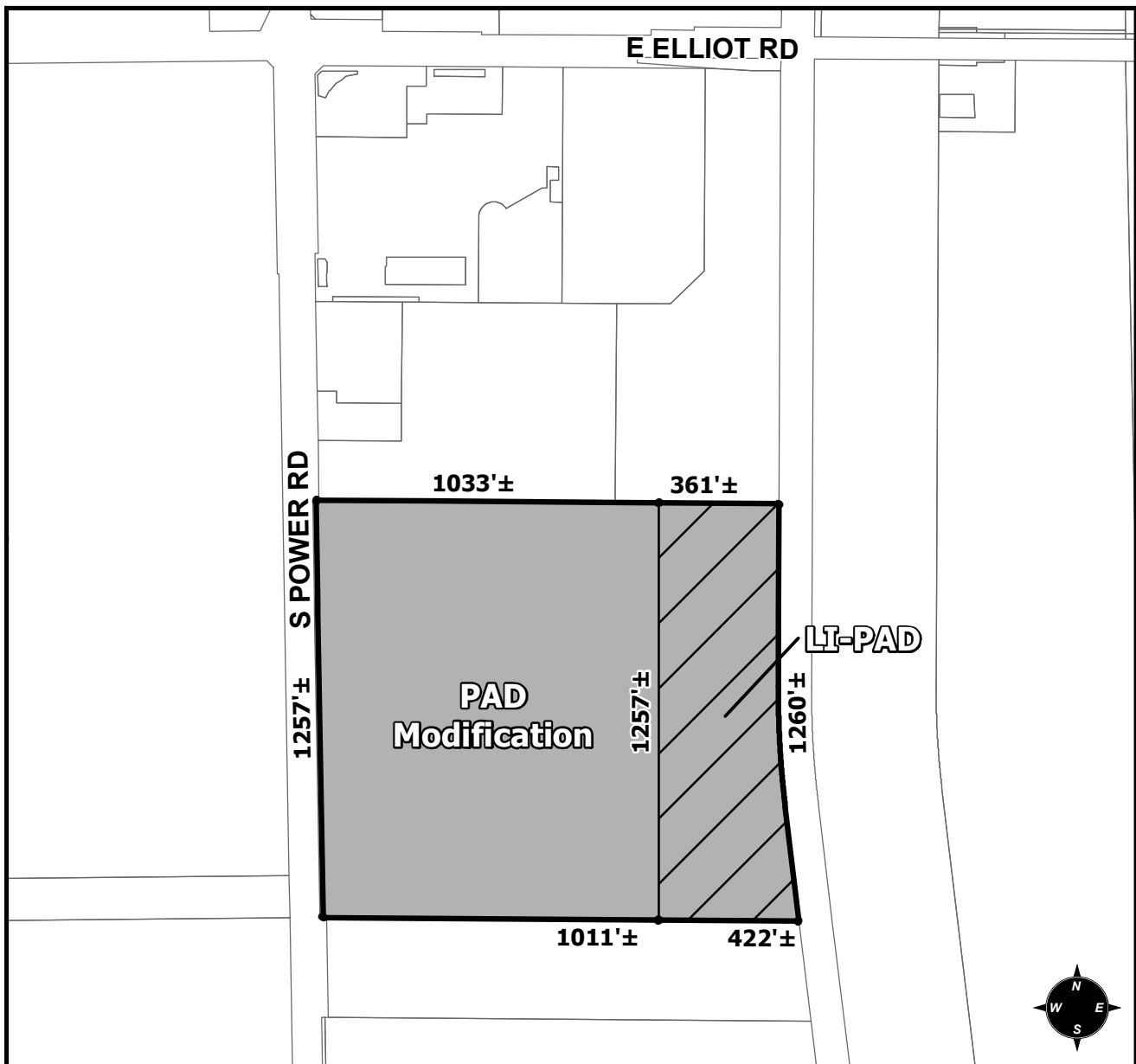

# OFFICIAL SUPPLEMENTARY ZONING MAP AMENDING THE CITY OF MESA ZONING MAP



CASE: ZON20-00872

ACREAGE: 41.85±

REQUEST: MODIFICATION TO AN APPROVED PLANNED AREA DEVELOPMENT OVERLAY (PAD) ON A 41.85± ACRE PROPERTY; REZONE 10.8± ACRES OF THE 41.85± ACRE PROPERTY FROM GENERAL INDUSTRIAL (GI) PAD TO LIGHT INDUSTRIAL (LI) PAD

ORDINANCE: \_\_\_\_\_

Please be advised that the attached zoning changes were approved by the Mesa City Council on \_\_\_\_\_, 2021 by Ordinance # \_\_\_\_\_. If you have any questions concerning these changes, contact the City of Mesa Planning Division at 480-644-2385.

\_\_\_\_\_  
MAYOR

ATTEST: \_\_\_\_\_  
CITY CLERK

DATE: \_\_\_\_\_