

Planning and Zoning Vicinity Map: ZON20-00872

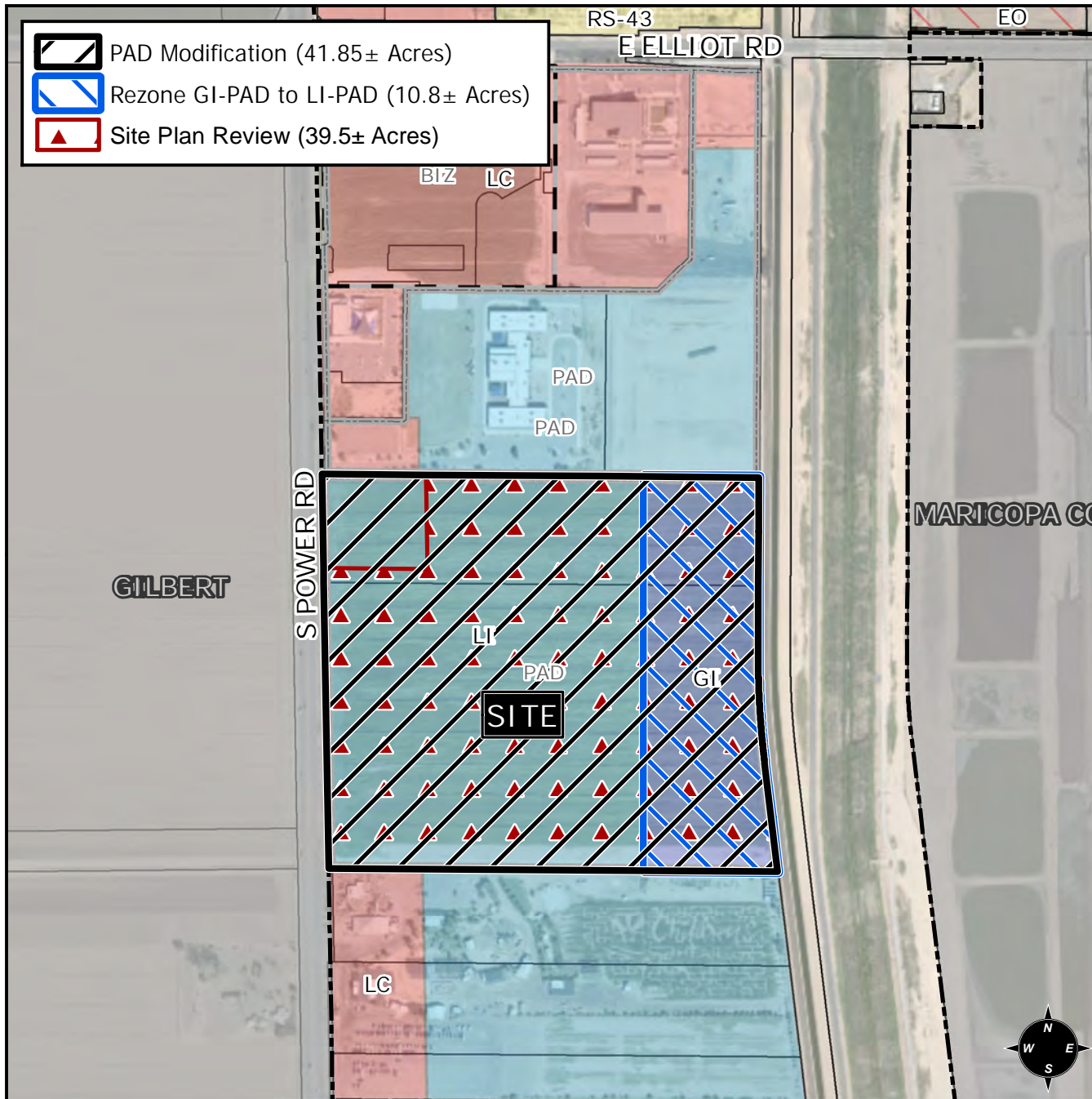

Case Details

CASE:

ZON20-00872

PRE-PLAT : ☒

SITE / ADDRESS:

District 6. Within the 3800 to 4000 blocks of South Power Road (east side). Located south of Elliot Road on the east side of Power Road. (overall 41.85± acres)

REQUEST:

Modification to an approved Planned Area Development Overlay (PAD) on a 41.85± acre property; rezone 10.8± acres of the 41.85± acre property from General Industrial (GI) PAD to Light Industrial (LI) PAD; and Site Plan Review on 39.5± acres of the 41.85± acre property. This request will allow the development of an industrial park.

