

ORDINANCE NO. _____

AN ORDINANCE EXTENDING AND INCREASING THE CORPORATE LIMITS OF THE CITY OF MESA, MARICOPA COUNTY, ARIZONA, PURSUANT TO ARIZONA REVISED STATUTES TITLE 9, CHAPTER 4, ARTICLE 7, SUBSECTION (N), BY ANNEXING CERTAIN COUNTY RIGHT-OF-WAY ADJACENT TO THE EXISTING CORPORATE LIMITS OF THE CITY OF MESA SUBJECT TO APPROVAL BY THE MARICOPA COUNTY BOARD OF SUPERVISORS.

WHEREAS, the City of Mesa ("City") desires to annex into the City that certain Maricopa County ("County") right-of-way located within the 6000 to 6400 blocks of South Meridian Road as more particularly described in Section 1 below and shown on the map attached to this Ordinance as Exhibit A ("Property"); and

WHEREAS, the Property consists solely of County right-of-way or roadway with no taxable real property; and

WHEREAS, the entire length of the Property is adjacent to the corporate boundaries of the City; and

WHEREAS, A.R.S. § 9-471(N), permits the transfer of county right-of-way or roadway from an unincorporated area within the county to the corporate limits of a city by mutual consent of the governing bodies of the city and the county; and

WHEREAS, the annexation of the Property to the City of Mesa is subject to approval by the Maricopa County Board of Supervisors at a future public meeting.

NOW THEREFORE, BE IT ORDAINED BY THE CITY COUNCIL OF THE CITY OF MESA, MARICOPA COUNTY, ARIZONA, AS FOLLOWS;

SECTION 1: That the Property described below and shown on the map attached as Exhibit A, incorporated herein by this reference, is hereby annexed to the City of Mesa and the present corporation limits are hereby extended and increased to include the Property upon approval of the annexation by the Maricopa County Board of Supervisors at an upcoming public meeting.

BEGINNING AT A 3" MARICOPA COUNTY BRASS CAP FOUND AT THE NORTHEAST CORNER OF SAID SECTION 36, PER THE RECORD OF SURVEY ON FILE WITH THE MARICOPA COUNTY RECORDER IN BOOK 609, PAGE 29, FROM WHICH A BRASS CAP, FOUND AT THE EAST QUARTER CORNER OF SAID SECTION 36, PER SAID RECORD OF SURVEY, BEARS SOUTH 0° 37' 53" EAST, 2,644.04 FEET (BASIS OF BEARING);

THENCE, ALONG THE EAST LINE OF THE NORTHEAST QUARTER OF SAID SECTION 36, SOUTH 0° 37' 53" EAST, 2,010.16 FEET TO A POINT ON THE NORTH RIGHT-OF-WAY LINE OF THE GATEWAY FREEWAY (SR24) ACCORDING TO PLANS ON FILE WITH THE ARIZONA DEPARTMENT OF TRANSPORTATION FOR PROJECT NO. 024 MA 001 H8915, PREPARED BY MICHAEL BAKER INTERNATIONAL, DATED JULY 22, 2020;

THENCE, ALONG SAID NORTH RIGHT-OF-WAY LINE, SOUTH 89° 22' 07" WEST, 55.00 FEET TO A POINT ON A LINE WHICH IS 55.00 FEET WEST OF AND PARALLEL WITH THE EAST LINE OF SAID SECTION 36, SAID POINT ALSO BEING ON THE EAST LINE OF THAT PROPERTY AS ANNEXED IN CITY OF MESA ORDINANCE NO. 2514;

THENCE, ALONG SAID PARALLEL LINE AND THE EAST LINE OF ANNEXATION ORDINANCE NO. 2514, NORTH 0° 37' 53" WEST, 2,011.17 FEET TO A POINT ON THE NORTH LINE OF SAID SECTION 36;

THENCE, ALONG SAID NORTH SECTION LINE, SOUTH 89° 34' 39" EAST, 55.01 FEET TO THE POINT OF BEGINNING.

SAID PARCEL CONTAINING 110,587 SQUARE FEET OR 2.539 ACRES, MORE OR LESS.

SECTION 2: The City Clerk is hereby authorized and directed to forward a copy of this Ordinance and the map attached as Exhibit A to the Maricopa Board of Supervisors.

SECTION 3: RECITALS. The recitals above are fully incorporated in this Ordinance by reference.

SECTION 4: EFFECTIVE DATE. This Ordinance shall take effect upon the occurrence of all of the following:

- a. Adoption of an ordinance by the County Board of Supervisors transferring the Property to the City; and
- b. A copy of this Ordinance and the ordinance approved by the County, together with Exhibit A, being filed and recorded in the Office of the County Recorder of Maricopa County, Arizona; and
- c. Thirty (30) days following the adoption of this Ordinance by the City Council.

PASSED AND ADOPTED by the Council of the City of Mesa, this 19th day of April, 2021.

APPROVED:

Mayor

ATTEST:

City Clerk

EFFECTIVE DATE: May 20, 2021

ANX20-00464

2.5± Acres

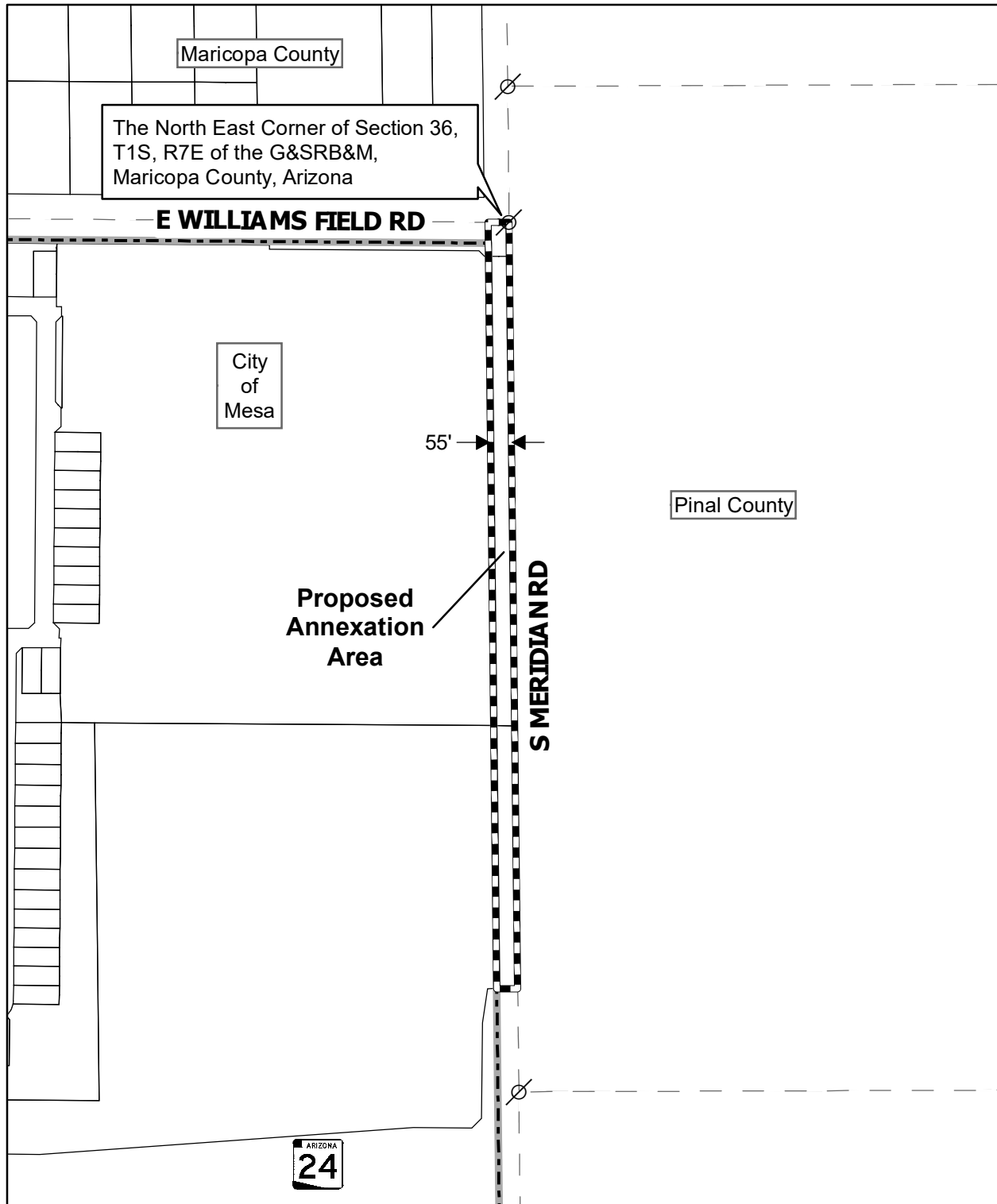

- Legal Control Point
- City of Mesa Boundary
- Proposed Annexation Boundary
- Quarter Section

EXHIBIT 'A'