

PRELIMINARY GRADING & DRAINAGE PLAN

FOR CMC STEEL ARIZONA - AZ2 MICRO-MILL SITE

11444 E. GERMANN ROAD., MESA, AZ 85242
PART OF THE SOUTH HALF OF SECTION 36, T1S, R7E OF THE GILA AND SALT
RIVER BASE AND MERIDIAN, MARICOPA COUNTY, ARIZONA

CITY OF MESA - GENERAL NOTES (MAY 2012)

- ALL WORK AND MATERIALS SHALL CONFORM TO THE CURRENT UNIFORM STANDARD SPECIFICATIONS AND DETAILS FOR PUBLIC WORKS CONSTRUCTION AS FURNISHED BY THE MARICOPA ASSOCIATION OF GOVERNMENTS AND AS AMENDED BY THE CITY OF MESA. ALL WORK AND MATERIALS NOT IN CONFORMANCE WITH THESE AMENDED SPECIFICATIONS AND DETAILS ARE SUBJECT TO REMOVAL AND REPLACEMENT AT THE CONTRACTOR'S EXPENSE.
- SEPARATE RIGHT-OF-WAY PERMITS ARE REQUIRED FOR ALL PUBLIC UTILITIES, PUBLIC STREET IMPROVEMENTS, AND RIGHT-OF-WAY LANDSCAPING. FOR INFORMATION REGARDING AVAILABILITY AND COST OF RIGHT-OF-WAY PERMITS, CONTACT THE DEVELOPMENT SERVICES DEPARTMENT AT (480) 644-4273 OR AT <http://www.mesaaz.gov/devustain/constructionpermits.aspx>. THE CONTRACTOR SHALL OBTAIN ALL PERMITS REQUIRED UNLESS OTHERWISE NOTED. CONTRACTORS MUST HOLD THE APPROPRIATE CLASS OF LICENSE AND SHALL HAVE ON FILE WITH THE PERMIT SERVICES SECTION PROOF OF INSURANCE COVERAGE. PERMITS BECOME INVALID AND MUST BE UPDATED IF WORK HAS NOT BEGUN WITHIN NINETY (90) DAYS. PERMITS ALSO BECOME INVALID IF THE CONTRACTOR'S INSURANCE LAPSES OR IS VOIDED.
- TWENTY FOUR (24) HOURS PRIOR TO THE COMMENCEMENT OF ANY WORK, CONSTRUCTION OR INSTALLATIONS ASSOCIATED WITH THIS PERMIT, THE PERMITTEE SHALL NOTIFY CITY OF MESA ENGINEERING DEPARTMENT AT (480) 644-2251 OF INTENT TO BEGIN AND REQUEST/SCHEDULE PRELIMINARY FIELD REVIEW AT THE PROJECT SITE WITH THE CITY OF MESA ENGINEERING DEPARTMENT CONSTRUCTION INSPECTOR (CITY INSPECTOR). FAILURE TO PROVIDE PROPER INSPECTION NOTIFICATION AS PRESCRIBED ABOVE SHALL RESULT IN THIS PERMIT BECOMING INVALID AND WORK BEING STOPPED.
- CONTRACTOR'S SHALL COMPLY WITH THE REQUIREMENTS TO OBTAIN THE NECESSARY RIGHT-OF-WAY PERMITS AND SHALL COMPLY WITH THE RIGHT-OF-WAY PERMIT CONDITIONS AS FOUND ON THE BACK OF THE PERMIT FORM.
- THE CITY OF MESA PARKS & RECREATION DIVISION IS NOT REPRESENTED BY BLUE STAKE. WHEN THE CONTRACTOR EXCAVATES NEAR OR ADJACENT TO A CITY PARK, THE CONTRACTOR SHALL CONTACT THE PARKS & RECREATION ADMINISTRATION SECTION AT (480) 644-2354 TO REQUEST ASSISTANCE IN LOCATING ALL THEIR UNDERGROUND FACILITIES.
- THE CONTRACTOR SHALL OBTAIN AN EARTH-MOVING PERMIT FROM THE MARICOPA COUNTY ENVIRONMENTAL SERVICES DEPARTMENT AND SHALL COMPLY WITH ITS REQUIREMENTS FOR DUST CONTROL.
- THE ENGINEER HEREBY CERTIFIES AS EVIDENCED BY A PROFESSIONAL SEAL & SIGNATURE, THAT ALL AFFECTED UTILITY COMPANIES BOTH PUBLIC AND PRIVATE HAVE BEEN CONTACTED AND ALL EXISTING AND/OR PROPOSED UTILITY LINES AND OTHER RELATED INFORMATION HAVE BEEN TRANSFERRED ONTO THESE PLANS. THE ENGINEER OR ARCHITECT ALSO HEREBY CERTIFIES THAT ALL EXISTING AND/OR PROPOSED PUBLIC RIGHT-OF-WAY AND EASEMENTS HAVE BEEN CORRECTLY PLOTTED/SHOWN.
- THE ENGINEER, OR LAND SURVEYOR OF RECORD SHALL CERTIFY UPON COMPLETION OF CONSTRUCTION THAT ALL PUBLIC IMPROVEMENTS (WATER AND SEWER UTILITIES, STORM SEWER, CONCRETE, PAVING, STREET LIGHTS, ETC.) HAVE BEEN INSTALLED AT THE LOCATIONS AND ELEVATIONS SHOWN ON THE APPROVED PLANS. ANY CHANGES SHALL BE REFLECTED ON "AS-BUILT" DRAWINGS PROVIDED BY THE ENGINEER TO THE CITY'S ENGINEERING DEPARTMENT.
- THE REGISTERED ENGINEER OR LAND SURVEYOR SHALL CERTIFY THAT THE MINIMUM HORIZONTAL AND VERTICAL SEPARATIONS BETWEEN UTILITIES WITHIN PUBLIC RIGHT-OF-WAY AND EASEMENTS HAVE BEEN MAINTAINED AS REQUIRED BY LAW OR POLICY.
- THE DEVELOPER SHALL PROVIDE ALL CONSTRUCTION STAKING FOR THE PROJECT.

CITY OF MESA - GENERAL NOTES (cont.)

- THE DEVELOPER OR THE ENGINEER IS RESPONSIBLE FOR ARRANGING FOR THE RELOCATION OR REMOVAL OF ALL UTILITIES OR FACILITIES THAT ARE IN CONFLICT WITH THE PROPOSED PUBLIC IMPROVEMENTS. THE CONTRACTOR IS RESPONSIBLE FOR COORDINATING THE RELOCATION OF ALL UTILITIES, POWER POLES, IRRIGATION DRY-UPS, RESETS REMOVALS BY OTHERS, ETC.
- THE CONTRACTORS SHALL LOCATE ALL UTILITIES PRIOR TO EXCAVATION AND AVOID DAMAGE TO SAME. CALL (602) 263-1100 FOR BLUE STAKE TWO WORKING DAYS PRIOR TO DIGGING. CALL SALT RIVER PROJECT FOR POLE BRACING, ELECTRIC SERVICE OR CONSTRUCTION SCHEDULING AT (602) 273-8888.
- WHEN GAS MAINS AND/OR SERVICES ARE EXPOSED, CONTACT THE CITY OF MESA AT (480) 644-2261 FOR INSPECTION OF THE EXPOSED PIPE AND COATING PRIOR TO BACKFILLING OF THE TRENCH.
- CONTRACTORS SHALL COMPLY WITH THE PROVISIONS FOR TRAFFIC CONTROL AND BARRICADING PER THE CURRENT CITY OF MESA TRAFFIC BARRICADE MANUAL.
- IF A FIRE HYDRANT IS NEEDED TO OBTAIN CONSTRUCTION WATER, THE CONTRACTOR SHALL OBTAIN A FIRE HYDRANT METER FROM PERMIT SERVICES AND PAY ALL APPLICABLE FEES AND CHARGES.
- IF DURING THE CONSTRUCTION OF A PUBLIC FACILITY, THE CONTRACTOR FAILS TO OR IS UNABLE TO COMPLY WITH A REQUEST OF THE CITY INSPECTOR, AND IT IS NECESSARY FOR CITY FORCES TO DO WORK THAT IS NORMALLY THE CONTRACTOR'S RESPONSIBILITY, THE CITY SHALL BE JUSTIFIED IN BILLING THE CONTRACTOR. EACH INCIDENT REQUIRING WORK BY CITY FORCES SHALL BE COVERED BY A SEPARATE BILLING AT THE CURRENT APPLICABLE RATES.
- THE CONTRACTOR IS ADVISED THAT DAMAGE TO PUBLIC SERVICES OR SYSTEMS AS A RESULT OF THIS PROJECT SHALL BE REPAIRED BY THE CONTRACTOR AND INSPECTED BY THE CITY INSPECTOR. UNLESS OTHERWISE APPROVED BY THE CITY, ALL REPAIRS SHALL BE DONE WITHIN 24 HOURS. THE CONTRACTOR IS ADVISED THAT ANY COSTS RELATED TO REPAIR OR REPLACEMENT OF DAMAGED PUBLIC SERVICES AND SYSTEMS AS A RESULT OF CONTRACTOR'S ACTIVITIES SHALL BE BORNE BY THE CONTRACTOR.

STORMWATER DRAINAGE & RETENTION NOTES

- THE ENGINEER, OR LAND SURVEYOR SHALL CERTIFY THAT THE REQUIRED STORM WATER RETENTION HAS BEEN PROVIDED. THE CERTIFICATION SHALL ALSO INDICATE THE ACTUAL VOLUME PROVIDED. SUCH CERTIFICATION SHALL BE PROVIDED TO BUILDING SAFETY DIVISION - BUILDING INSPECTIONS WHEN THE RETENTION AREA IS TO REMAIN PRIVATE PROPERTY AND TO ENGINEERING CONSTRUCTION SERVICES WHEN THE RETENTION AREA IS TO BECOME CITY OF MESA PROPERTY.
- ALL DRYWELLS SHOWN ON THIS PROJECT SHALL BE MAINTAINED BY THE OWNERS AND ARE TO BE REPLACED BY THE OWNERS WHEN THEY CEASE TO DRAIN WATER IN A 36-HOUR PERIOD. REGULAR MAINTENANCE OF THE DRYWELL-SILTING CHAMBER IS REQUIRED TO ACHIEVE THE BEST OPERATION OF THE DRYWELL. IN ACCORDANCE WITH ARIZONA REVISED STATUTES, DRYWELLS ARE REQUIRED TO BE REGISTERED WITH THE ARIZONA DEPARTMENT OF ENVIRONMENTAL QUALITY (A.D.E.Q.) IT IS THE OWNERS RESPONSIBILITY TO REGISTER ALL DRYWELLS. AN AQUIFER PROTECTION PERMIT MAY BE REQUIRED BY A.D.E.Q. FOR DRYWELLS DEEMED TO BE HAZARDOUS TO GROUNDWATER.

SHEET INDEX

	CIVIL SHEET	SHEET
COVER SHEET	C-1	1
DRAINAGE DATA SHEET	C-2	2
PRELIMINARY GRADING & DRAINAGE PLAN	C-3	3
PRELIMINARY GRADING & DRAINAGE PLAN	C-4	4

VICINITY MAP

N.T.S.

OWNER/DEVELOPER

CMC STEEL FABRICATORS INC.
11444 E. GERMANN ROAD
MESA, ARIZONA 85242
PHONE: (830) 305-2246
CONTACT: ANDREW SARAT

CIVIL ENGINEER

LANDCOR CONSULTING, PC
6859 E. REMBRANDT AVE. #124
MESA, ARIZONA 85212
PHONE: (480) 223-8573
CONTACT: WADE COOKE

PROJECT BENCHMARK

SURVEY MONUMENT
BRASS CAP IN MANHOLE AT GERMANN AND MERIDIAN ROADS
CORNER SEC. 1
NORTHING 9937.10
EASTING 116221.44
ELEVATION: 1446.06

CITY OF MESA BENCHMARK

N-S X STREET SOSSAMAN
E-W X STREET GERMANN
ELEVATION: 1356.69
CORNER SEC. 1

SITE INFORMATION

APN: 304-63-004-E
QUARTER SECTION NO.: Q5349D

CASE NO.:

ZONING NO. Z08-39, Z07-67
DESIGN REVIEW NO. DR07-81

LEGEND

RIGHT-OF-WAY/PROPERTY LINE	---
EASEMENT LINE	---
WATER	W
SANITARY SEWER	S
UNDERGROUND ELECTRICAL	E
OVERHEAD ELECTRICAL	OHE
EDGE OF PAVEMENT	---
NEW PAVEMENT	[Pattern]
NEW CONCRETE	[Pattern]
EXISTING GRADE ELEVATION	x 99.99
PROPOSED GRADE ELEVATION	99.99
CATCH ARROW	~
EXISTING GRADE CONTOUR	99
PROPOSED GRADE CONTOUR	99
GRADE BREAK	◆
STORM DRAIN	---
CATCH BASIN	□
VALVE	⊗
FIRE HYDRANT	⊙
SANITARY SEWER MANHOLE	⊙
WATER METER	⊗
TOP OF CURB	TC
GUTTER	G
PAVEMENT	P
SIDEWALK	S/W
EXISTING/NATURAL GRADE	NG
FINISHED GRADE	FG
FINISHED FLOOR	FF
INVERT	INV
GRATE	GR
HIGH POINT	HP
GRADE BREAK	GB
ELEVATION CONTROL POINT	CP

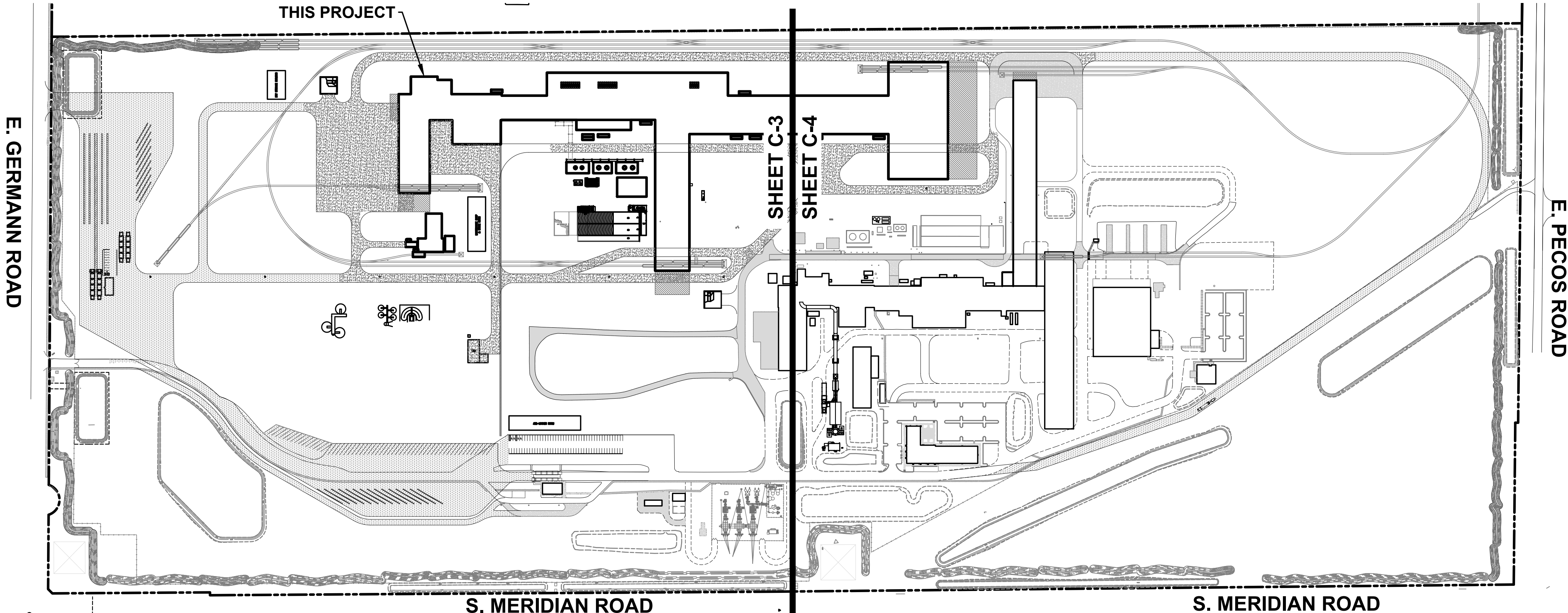

KEY MAP

SCALE: 1"=250'



6859 E. Rembrandt Ave. #124
Mesa, Arizona 85212
Ph: (480) 223-8573

THIS DRAWING AND THE INFORMATION IT CONTAINS IS THE PROPERTY OF COMMERCIAL METALS COMPANY AND ITS SUBSIDIARIES. IT IS SUBMITTED ONLY IN CONNECTION WITH THE TRANSACTION TO WHICH IT PERTAINS AND MUST NOT BE USED IN ANY MANNER DETRIMENTAL TO THE INTEREST OF COMMERCIAL METALS COMPANY AND ITS SUBSIDIARIES. THIS DRAWING IS NOT TO BE COPIED OR REPRODUCED AND MUST BE RETURNED UPON REQUEST.

NO.	REVISION	BY	DATE
1			
2			
3			
4			
5			
6			
7			
8			
9			
10			
11			
12			
13			
14			
15			
16			
17			
18			
19			
20			
21			



COMMERCIAL METALS COMPANY
CMC STEEL ARIZONA

11444 E. GERMANN ROAD
MESA, ARIZONA 85212-9700

DRAWN BY:	DATE:
WEC	12/7/20
CHK'D BY:	DATE:
JDM	12/7/20

DEPARTMENT:	ENGINEERING
PROJECT:	AZ2

TITLE:	PRELIMINARY GRADING & DRAINAGE PLAN COVER SHEET
--------	--

DRAWING NUMBER:

C-1

SHEET:

1 OF 4

REV:

-

DRAINAGE DATA SHEET

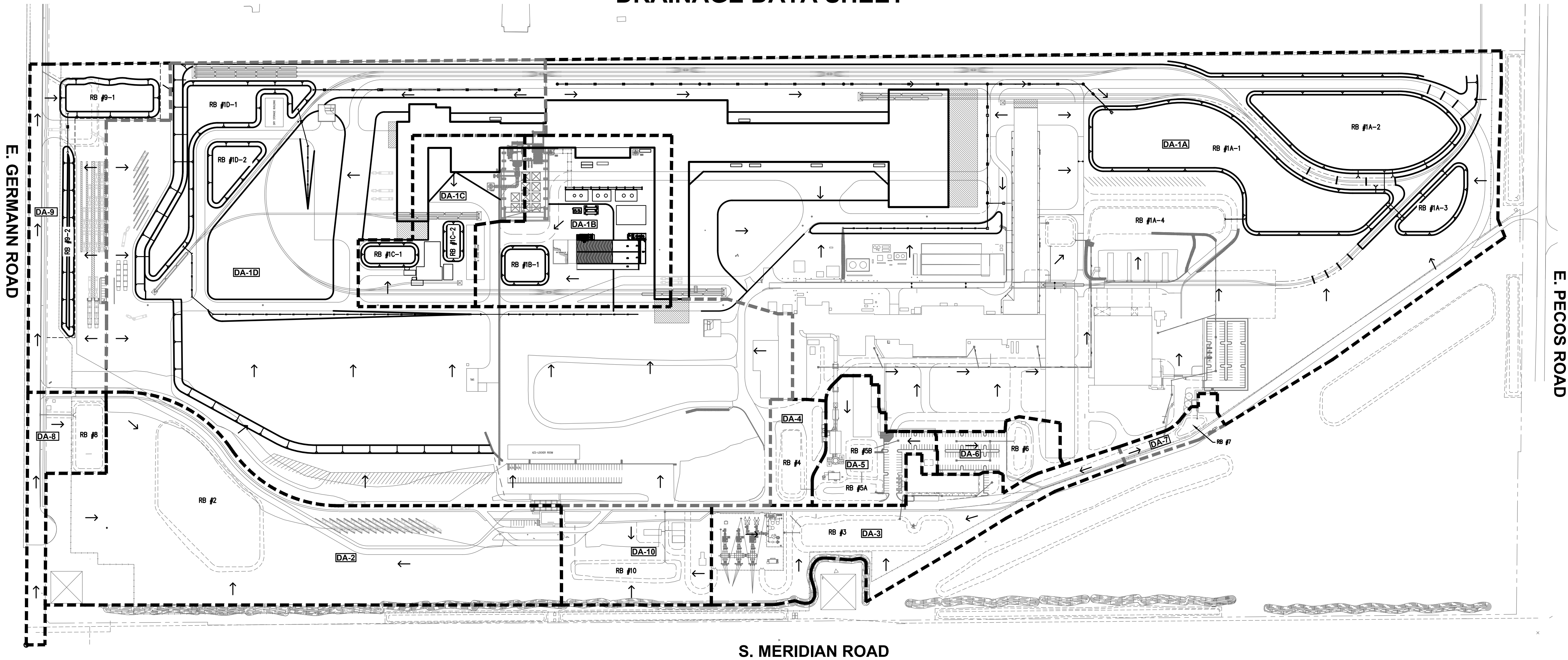

RETENTION CALCULATIONS
CMC STEEL - AZ2

RETENTION VOLUME REQUIRED / PROVIDED:

	A (S.F.)	A (AC.)	Cw	P	Vr (C.F.)	Vp (C.F.)
DA-1A	3,382,700	77.66	0.68	2.20	421,478	603,977
DA-1B	353,435	8.11	0.76	2.20	49,497	55,677
DA-1C	225,466	5.18	0.75	2.20	30,889	61,308
DA-1D	2,391,609	54.90	0.61	2.20	269,643	314,658
DA-2	814,244	18.69	0.49	2.20	73,430	108,900
DA-3	323,544	7.43	0.55	2.20	32,744	42,559
DA-5	125,217	2.87	0.61	2.20	13,978	14,147
DA-6	73,515	1.69	0.75	2.20	10,137	5,227
DA-7	31,719	0.73	0.62	2.20	3,615	3,688
DA-8	115,756	2.66	0.74	2.20	15,740	21,601
DA-9	351,004	8.06	0.68	2.20	43,880	59,125
DA-10	180,421	4.14	0.55	2.20	18,149	18,753
Total	8,368,630	192.12			983,178	1,309,618

Weighted Runoff Coefficients: (from Table 8.1)

	Impermeable Surface (concrete & roof tops)		Asphalt Pavement		Desert Landscaping / Unimproved Areas		Grass Lawn		
	Area (S.F.)	"C"	Area (S.F.)	"C"	Area (S.F.)	"C"	Area (S.F.)	"C"	Cw
DA-1A	935,106	0.95	533,775	0.85	1,913,819	0.50	0	0.15	0.68
DA-1B	207,263	0.95	0	0.85	146,172	0.50	0	0.15	0.76
DA-1C	123,893	0.95	0	0.85	101,573	0.50	0	0.15	0.75
DA-1D	297,386	0.95	425,483	0.85	1,646,541	0.50	22,199	0.15	0.61
DA-2	25,238	0.95	42,335	0.85	653,047	0.50	93,624	0.15	0.49
DA-3	28,446	0.95	37,480	0.85	231,649	0.50	25,969	0.15	0.55
DA-5	37,375	0.95	27,790	0.85	23,163	0.50	36,889	0.15	0.61
DA-6	6,315	0.95	50,835	0.85	10,369	0.50	5,996	0.15	0.75
DA-7	7,986	0.95	11,052	0.85	2,384	0.50	10,297	0.15	0.62
DA-8	62,166	0.95	0	0.85	53,590	0.50	0	0.15	0.74
DA-9	68,459	0.95	94,386	0.85	188,158	0.50	0	0.15	0.68
DA-10	7,543	0.95	47,325	0.85	93,628	0.50	31,925	0.15	0.55

RETENTION VOLUME PROVIDED:

	Top Area (S.F.)	Bottom Area (S.F.)	Depth (FT)	Vp (C.F.)
Retention Basin #1A-1	213,002	197,557	1.5	307,919
Retention Basin #1A-2	151,455	141,512	1.5	219,725
Retention Basin #1A-3	30,602	26,234	1.5	42,627
Retention Basin #1A-4	52,272	44,031	0.7	33,706
Retention Basin #1B-1	21,623	15,495	3.0	55,677
Retention Basin #1C-1	15,883	10,194	3.0	39,116
Retention Basin #1C-2	9,480	5,315	3.0	22,193
Retention Basin #1D-1	98,253	60,576	3.0	238,244
Retention Basin #1D-2	30,827	20,116	3.0	76,415
Retention Basin #2 *				108,900
Retention Basin #3	45,024	40,093	1.0	42,559
Retention Basin #5A	7,010	5,311	1.0	6,161
Retention Basin #5B	8,697	7,275	1.0	7,986
Retention Basin #6 *				5,227
Retention Basin #7	4,208	3,167	1.0	3,688
Retention Basin #8	22,826	20,375	1.0	21,601
Retention Basin #9-1	33,481	28,681	1.5	46,622
Retention Basin #9-2	12,139	4,532	1.5	12,503
Retention Basin #10	20,325	17,181	1.0	18,753
Total				739,347 C.F.

* Note: The Volumes provided (Vp) for Retention Basins #2 and #6 are based off the Final Drainage Report for CMC Steel Micromill-Arizona by Hatch Mott MacDonald dated April 2008 (see Figure 2.1.2).

DRAIN TIME CALCULATIONS:

Drain Time is calculated as follows:

$T = Vr / (P \times Ap) \times 2$

Where,

T = Total Drain Time (hrs)
P = Percolation Rate (See Appendix B)
Vr = Volume drained by percolation in 36-hours (cubic feet)
Ap = Effective Percolation Area = basin area at 0.5 feet deep (square feet)
2 = De-rating factor

Therefore,

	Vr (C.F.)	Ap (S.F.)**	P ** (C.F./hr/S.F.)	T (hrs)	Drywell Required (Y/N)
DA-1A	421,478	409,333	0.27	7.7	N
DA-1B	49,497	15,495	0.27	24.0	N
DA-1C	30,889	15,509	0.27	14.9	N
DA-1D	269,643	80,692	0.27	25.1	N
DA-2	73,430	115,544	0.27	4.8	N
DA-3	32,744	40,093	0.27	6.1	N
DA-5	13,978	12,586	0.27	8.3	N
DA-6	10,137	5,555	0.27	13.7	N
DA-7	3,615	3,167	0.27	8.6	N
DA-8	15,740	20,375	0.27	5.8	N
DA-9	43,880	33,213	0.27	9.9	N
DA-10	18,149	17,181	0.27	7.9	N
Total Volume	81,383	73,936			

Notes:

* Existing retention basins to remain undisturbed are not included as part of this study.

** Percolation rates from Geotechnical Evaluation for CMC Steel Plant Expansion by Ninyo & Moore dated November 2020 (Project #606575001)

DRAINAGE STATEMENT

SITE IMPROVEMENTS HAVE BEEN DESIGNED TO MAINTAIN EXISTING DRAINAGE PATTERNS. EXISTING RETENTION VOLUMES ARE SUFFICIENT TO ACCOUNT FOR THE INCREASE IN ACCUMULATED RUNOFF DUE TO THE ADDITION OF IMPERVIOUS SURFACES. THE NEW IMPROVEMENTS WILL NOT CAUSE AN ADVERSE IMPACT TO ADJACENT PROPERTIES. RETENTION CALCULATIONS ARE SHOWN HEREON.

LEGEND

- GRADE BREAK
- DRAINAGE FLOW DIRECTION
- PROPOSED GRADE CONTOUR
- CONTRIBUTING DRAINAGE AREA
- DA-6 DRAINAGE AREA
- RB # RETENTION BASIN NUMBER

NOTE:

SEE PRELIMINARY GRADING & DRAINAGE PLAN FOR ALL GRADE ELEVATIONS, CONTOURS, FINISHED FLOOR ELEVATIONS, DRAINAGE STRUCTURES AND EROSION PROTECTION.

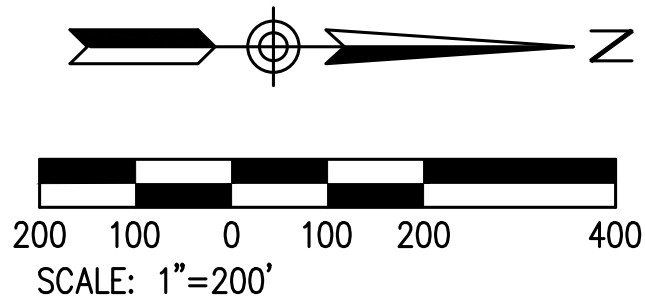

6859 E. Rembrandt Ave. #124
Mesa, Arizona 85212
Ph: (480) 223-8573

THIS DRAWING AND THE INFORMATION IT CONTAINS IS THE PROPERTY OF COMMERCIAL METALS COMPANY AND ITS SUBSIDIARIES. IT IS SUBMITTED ONLY IN CONNECTION WITH THE TRANSACTION TO WHICH IT PERTAINS AND MUST NOT BE USED IN ANY MANNER DETRIMENTAL TO THE INTEREST OF COMMERCIAL METALS COMPANY AND ITS SUBSIDIARIES. THIS DRAWING IS NOT TO BE COPIED OR REPRODUCED AND MUST BE RETURNED UPON REQUEST.

NO.	REVISION	BY	DATE



COMMERCIAL METALS COMPANY
CMC STEEL ARIZONA

11444 E. GERMANN ROAD
MESA, ARIZONA 85212-9700

DRAWN BY: WEC
CHK'D BY: JDM
DATE: 12/7/20

DEPARTMENT: ENGINEERING
PROJECT: AZ2

TITLE: PRELIMINARY GRADING & DRAINAGE PLAN
DRAINAGE DATA SHEET

DRAWING NUMBER:

C-2

SHEET: 2 OF 4
REV: -

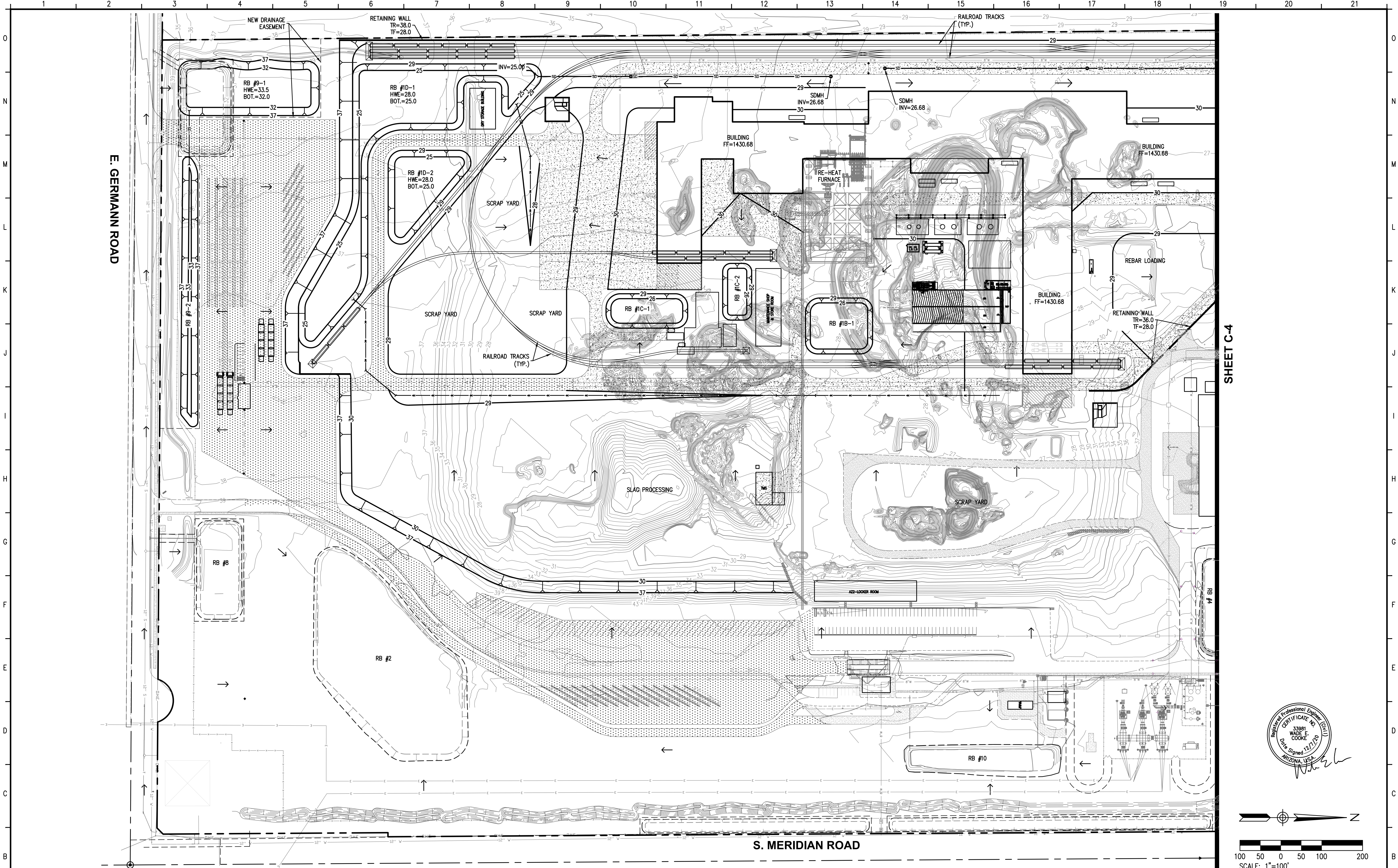

SHEET C-4

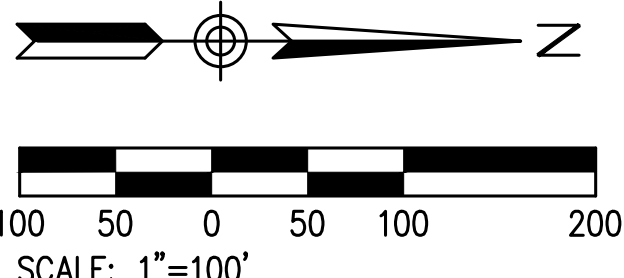

LANDCOR
CONSULTING

6859 E. Rembrandt Ave. #124
Mesa, Arizona 85212
Ph: (480) 223-8573

THIS DRAWING AND THE INFORMATION IT CONTAINS IS THE PROPERTY OF COMMERCIAL METALS COMPANY AND ITS SUBSIDIARIES. IT IS SUBMITTED ONLY IN CONNECTION WITH THE TRANSACTION TO WHICH IT PERTAINS AND MUST NOT BE USED IN ANY MANNER DETRIMENTAL TO THE INTEREST OF COMMERCIAL METALS COMPANY AND ITS SUBSIDIARIES. THIS DRAWING IS NOT TO BE COPIED OR REPRODUCED AND MUST BE RETURNED UPON REQUEST.

-	-	-	-
-	-	-	-
-	-	-	-
-	-	-	-
-	-	-	-
-	-	-	-
NO.	REVISION	BY	DATE

CMC

Commercial Metals

COMMERCIAL METALS COMPANY
CMC STEEL ARIZONA

11444 E. GERMANN ROAD
MESA, ARIZONA 85212-9700

DRAWN BY:
WEC

DATE:
12/7/20

CHK'D BY:
JDM

DATE:
12/7/20

DEPARTMENT:
ENGINEERING

PROJECT:
AZZ

TITLE:
PRELIMINARY GRADING & DRAINAGE PLAN
GRADING SHEET

DRAWING NUMBER:
C-3

SHEET:
3 OF 4

REV:
-

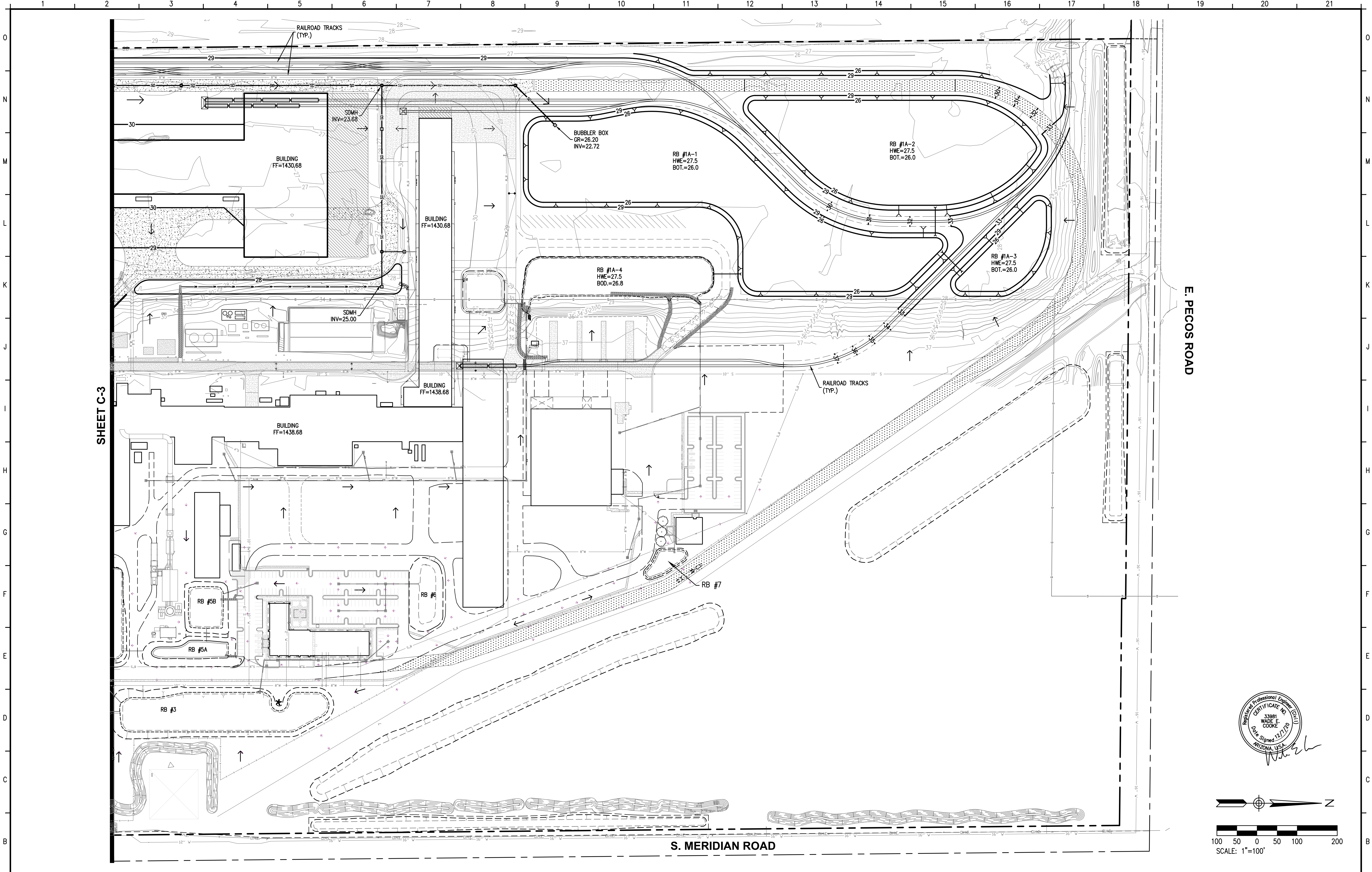

SHEET C-3

E. PECOS ROAD

S. MERIDIAN ROAD

LANDCOR
CONSULTING

6859 E. Rembrandt Ave. #124
Mesa, Arizona 85212
Ph: (480) 223-8573

THIS DRAWING AND THE INFORMATION IT CONTAINS IS THE PROPERTY OF COMMERCIAL METALS COMPANY AND ITS SUBSIDIARIES. IT IS SUBMITTED ONLY IN CONNECTION WITH THE TRANSACTION TO WHICH IT PERTAINS AND MUST NOT BE USED IN ANY MANNER DETRIMENTAL TO THE INTEREST OF COMMERCIAL METALS COMPANY AND ITS SUBSIDIARIES. THIS DRAWING IS NOT TO BE COPIED OR REPRODUCED AND MUST BE RETURNED UPON REQUEST.

NO.	REVISION		BY	DATE
1				
2				
3				
4				
5				
6				
7				
8				

CMC
Commercial Metals

COMMERCIAL METALS COMPANY
CMC STEEL ARIZONA

11444 E. GERMANN ROAD
MESA, ARIZONA 85212-9700

DRAWN BY:	WEC	DATE:	12/7/20
CHK'D BY:	JDM	DATE:	12/7/20

DEPARTMENT:	ENGINEERING
PROJECT:	AZ2

TITLE:	PRELIMINARY GRADING & DRAINAGE PLAN GRADING SHEET
--------	--

DRAWING NUMBER:	C-4
-----------------	-----

SHEET:	4 OF 4
REV:	-

<