

RESOLUTION NO. _____

**A RESOLUTION OF THE CITY COUNCIL OF THE CITY OF
MESA, MARICOPA COUNTY, ARIZONA, EXTINGUISHING A
PORTION OF A 20-FOOT WATERLINE EASEMENT,
LOCATED AT 8046 EAST RAY ROAD**

WHEREAS, pursuant to Arizona Revised Statutes Title 28 §§ 7201-7215 and/or Mesa City Code Title 9, Chapter 10, the City Council has the authority to abandon, vacate or extinguish (collectively, hereafter, “abandon”) unnecessary roadway, right-of-way, or easements to which the City holds right or title to.

WHEREAS, the City of Mesa has determined that a portion of a 20-foot waterline easement on Lot 1, dedicated on The Final Plat of Landing 202, as recorded in Book 1487 of Maps, Page 40, records of Maricopa County, Arizona, located at 8046 East Ray Road, as hereinafter described (“Waterline Easement”), is no longer needed.

WHEREAS Mesa City Code 9-10-2 permits the City Council to extinguish easements no longer needed by the City upon application and payment of the application fee.

NOW THEREFORE, BE IT RESOLVED BY THE CITY COUNCIL OF THE CITY OF MESA, MARICOPA COUNTY, ARIZONA, AS FOLLOWS:

Section 1: That all rights of the City of Mesa in and to a portion of the Waterline Easement are abandoned and deemed extinguished:

PLEASE REFER TO THE LEGAL DESCRIPTION AND DEPICTION
ON **EXHIBIT A** ATTACHED HERETO AND MADE A PART HEREOF
FOR THE EXTINGUISHED EASEMENT AREA.

PASSED AND ADOPTED by the City Council of the City of Mesa, Maricopa County,
Arizona, this 1st day of March, 2021.

APPROVED:

Mayor

City Clerk

EXHIBIT A

WATERLINE EASEMENT ABANDONMENT LEGAL DESCRIPTION

AN EASEMENT LYING WITHIN A PORTION OF LOT 1 OF "LANDING 202" AS RECORDED IN BOOK 1487, PAGE 40, OFFICIAL RECORDS OF MARICOPA COUNTY RECORDER, ARIZONA, BEING A PORTION OF THE SOUTHEAST QUARTER OF SECTION 20, TOWNSHIP 1 SOUTH, RANGE 7 EAST OF THE GILA AND SALT RIVER BASE AND MERIDIAN, MARICOPA COUNTY, ARIZONA, MORE PARTICULARLY DESCRIBED AS FOLLOWS:

COMMENCING AT THE SOUTHEAST CORNER OF THE NORTHWEST QUARTER OF THE SOUTHEAST QUARTER OF SAID SECTION 20;

THENCE NORTH 89°32'36" WEST, ALONG THE SOUTH LINE OF THE THE NORTHWEST QUARTER OF THE SOUTHEAST QUARTER OF SAID SECTION 20, A DISTANCE OF 70.30 FEET;

THENCE NORTH 15°14'44" WEST, A DISTANCE OF 30.62 FEET;

THENCE NORTH 90°00'00" WEST, ALSO LABELED L21 ON THE FINAL PLAT, A DISTANCE OF 59.73 FEET, SAID POINT BEING THE POINT OF BEGINNING;

THENCE CONTINUING NORTH 90°00'00" WEST, A DISTANCE OF 20.00 FEET;

THENCE NORTH 00°00'00" EAST, A DISTANCE OF 58.62 FEET;

THENCE SOUTH 89°59'51" WEST, A DISTANCE OF 30.00 FEET;

THENCE NORTH 00°00'09" WEST, A DISTANCE OF 20.00 FEET;

THENCE NORTH 89°59'51" EAST, A DISTANCE OF 30.00 FEET;

THENCE NORTH 00°00'00" EAST, ALSO LABELED L101 ON THE FINAL PLAT, A DISTANCE OF 18.11 FEET;

THENCE NORTH 90°00'00" WEST, ALSO LABELED L100 ON THE FINAL PLAT, A DISTANCE OF 32.50 FEET;

THENCE NORTH 00°00'00" EAST, ALSO LABELED L99 ON THE FINAL PLAT, A DISTANCE OF 20.00 FEET;

THENCE NORTH 90°00'00" EAST, A DISTANCE OF 52.50 FEET;

THENCE SOUTH 00°00'00" EAST, A DISTANCE OF 96.73 FEET TO THE POINT OF BEGINNING.

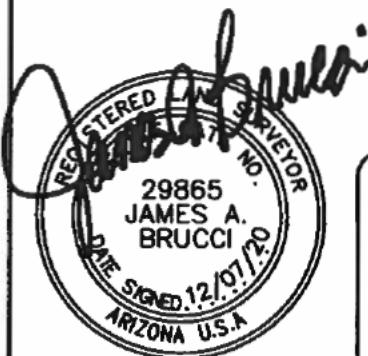

PAGE 1 OF 2

TITLE: XB04
SCALE:
DATE: 12/07/20
DESC: EASEMENT
ABANDONMENT

HUNTER
ENGINEERING

10450 N. 74TH ST., SUITE 200
SCOTTSDALE, AZ 85258
T 480 991 3985
F 480 991 3986

EXHIBIT A
CIVIL AND SURVEY

PROJ: MARW005
MARW005-XB04.DWG



LINE TABLE		
LINE	BEARING	DISTANCE
L1	N15°14'44"W	30.62'
L2	N90°00'00"W	59.73'
L3	N90°00'00"W	20.00'
L4	N00°00'00"E	58.62'

LINE TABLE		
LINE	BEARING	DISTANCE
L5	S89°59'51"W	30.00'
L6	N00°00'09"W	20.00'
L7	N89°59'51"E	30.00'
L8	N00°00'00"E	18.11'

LINE TABLE		
LINE	BEARING	DISTANCE
L9	N90°00'00"W	32.50'
L10	N00°00'00"E	20.00'
L11	N90°00'00"E	52.50'
L12	S00°00'00"E	96.73'

LOT 1

20.00' WATER
EASEMENT
BK. 1487, PG. 40
M.C.R.

EASEMENT TO
BE ABANDON

POINT OF BEGINNING

N0°47'41"W 1316.38'

APN 304-30-025K
SUNBELT LAND HOLDING LP
18-0468744 MCR

EXHIBIT A

LOT 2

SE CORNER NORTHWEST QUARTER OF THE
SOUTHEAST QUARTER OF SECTION 20
FND. 1/2" REBAR WITH CAP 21081

N89°32'36"W 1135.77'

70.30'

PAGE 2 OF 2



TITLE: XB04
SCALE: 1"=60'
DATE: 12/07/20
DESC: EASEMENT
ABANDONMENT

HUNTER
ENGINEERING
10450 N. 74TH ST., SUITE 200
SCOTTSDALE, AZ 85258
T 480 991 3865
F 480 991 3986
CIVIL AND SURVEY
PROJ: MARW005
MARW005-XB04.DWG