

No.	Revisions/Submittals	Date
	CIVIL PLANS SUBMITTAL	01/05/21
	ENTITLEMENT SUBMITTAL	12/1/20

VALVINE INSTANT OIL CHANGE
10739 E GUADALUPE ROAD
MESA, ARIZONA

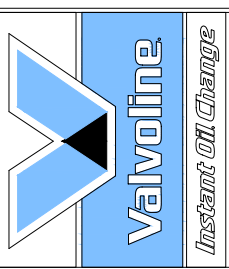

Professional Seal

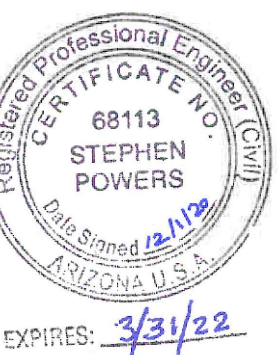

Project No. 20191177.0

Scale 1:20

Drawn NICOLE NOVACK

Checked STEPHEN POWERS

Date

Drawing Title

LANDSCAPE PLAN

Drawing No.

L-1.0

EXISTING LEGEND:

● MONUMENT FOUND	POWERPOLE	SS-- SAN. SEWER LINE
○ MONUMENT SET	GUY WIRE	○ SEWER MANHOLE
■ P.K. NAIL FOUND	LIGHT POLE	○ GREASE TRAP
□ P.K. NAIL SET	GROUND LIGHT	--- FORCE MAIN
■ MAG NAIL FOUND	STREET LIGHT POLE	--- CLEAN OUT
■ MAG NAIL SET	ELEC. TRANSFORMER	--- STORM DRAIN LINE
✕ FOUND X MARK	AIR CONDITIONER	○ STORM DRAIN MANHOLE
✕ SET X MARK	BURIED ELECTRIC	○ STORM INLET
▲ R.R. SPIKE FOUND	OVERHEAD ELECTRIC	○ CATCH BASIN
▲ R.R. SPIKE SET	ELECTRIC MANHOLE	○ CURB INLET
△ BENCHMARK	ELECTRIC METER	○ PAY PHONE
△ CONC. R/W MARKER	ELECTRIC BOX	○ TELEPHONE BOX
○ RECORD DATA	ELECTRICAL VAULT	○ TELEPHONE PEDESTAL
○ MEASURED DATA	ELECTRICAL VAULT	○ TELEPHONE MANHOLE
○ CALCULATED DATA	WATER LINE	○ TELEPHONE POLE
○ RIGHT OF WAY	WATER MANHOLE	○ TELEPHONE LINE
○ BACK SET LINE	WATER VALVE	○ OVERHEAD TELEPHONE
○ REINFORCED CONC PIPE	WATER METER	○ UNDERGROUND
○ CORRUGATED METAL PIPE	HYDRANT	○ TELEPHONE MARKER
○ PLASTIC PIPE	BACK FLOW	○ CABLE TELEVISION
○ METAL	PREVENTOR	○ FIBER OPTIC CABLE
○ ABOVE GROUND LEVEL	FIRE DEPARTMENT	○ OVERHEAD CABLE
○ FOOTPRINT	CONNECTION	○ CABLE BOX
○ DECIDUOUS TREE	PIPE PROTECTION	○ CABLE PEDESTAL
○ LANDSCAPING	HOSE BIBB	○ UNDERGROUND
○ CONIFER TREE	CONTROL VALVE	○ CABLE MARKER
○ SQUARE METAL LID	IRRIGATION CONTROL	○ TELECOMMUNICATIONS
○ FUEL TANK LID	VALVE	○ MANHOLE
○ FLAG POLE	RECLAIMED WATER	○ TELECOMMUNICATIONS
○ UNKNOWN MANHOLE	WATER VAULT	○ PEDESTAL
○ FROZEN MANHOLE	GAS VALVE	○ TRAFFIC POLE
○ UNKNOWN VAULT	GAS METER	○ TRAFFIC SIGNAL
○ UNKNOWN VAULT METAL	GAS MARKER	○ TRAFFIC MANHOLE
○ MAIL BOX	GAS PEDESTAL	○ TRAFFIC SIGNAL BOX
○ BOLLARD	GAS MANHOLE	○ TRAFFIC VAULT
○ BORE HOLE	GAS LINE	○ STOP SIGN
○ MONITORING WELL	PROPANE TANK	○ SIGN
	UNDERGROUND	○ GUARD RAIL
	OIL MARKER	○ FENCE

PLANT SCHEDULE

TREES

BOTANICAL / COMMON NAME	CONT	QTY
ACACIA STENOPHYLLA / SHOESTRING ACACIA	24" BOX	4
CERCIDUM X 'DESERT MUSEUM' / THORNLESS PALO VERDE	36" BOX	5
CHILOPSIS LINEARIS 'PARADISE' / PARADISE DESERT WILLOW MATCHING	24" BOX	2
PROSOPIS VELUTINA / VELVET MESQUITE STRAIGHT TRUNK, MATCHING	24" BOX	1
SOPHORA SECUNDIFLORA 'SILVER SIERRA' TM / SILVER TEXAS MOUNTAIN LAUREL	24" BOX	4

SHRUBS

BOTANICAL / COMMON NAME	SIZE	QTY
DODONAEA VISCOSA 'GREEN' / GREEN HOPSEED BUSH	5 GAL	4
EPHEDRA NEVADENSIS / MORMON TEA WELL ROOTED, FULL TO GROUND	5 GAL	34
EREMOPHILA MACULATA 'VALENTINE' / VALENTINE BUSH	5 GAL	18
HESPERALOE PARVIFLORA / RED YUCCA	5 GAL	46
MUHLENBERGIA RIGENS / DEER GRASS	5 GAL	80
MYRTUS COMMUNIS 'COMPACTA' / DWARF MYRTLE	5 GAL	9
TECOMA X 'ORANGE JUBILEE' / ORANGE JUBILEE YELLOW BELLS	5 GAL	3

GROUND COVERS

BOTANICAL / COMMON NAME	QTY
DECOMPOSED GRANITE GRANULAR STONE SURFACING MATERIAL CONSISTING OF PARTICLE SIZES RANGING FROM 3/8" DOWN TO ROCK DUST. 2" MIN. D.G. TO COVER ALL LANDSCAPE AREAS. COLOR TO MATCH EXISTING ON SITE.	7,467 SF



Know what's below.
Call before you dig.

GRAPHIC SCALE

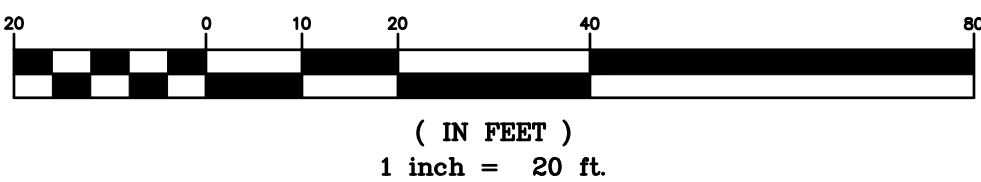

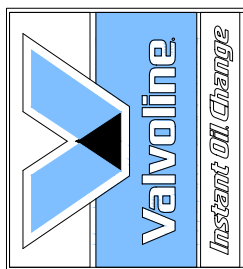
[illegible]

VALVOLINE INSTANT OIL CHANGE
10739 E GUADALUPE ROAD
MESA, ARIZONA

Professional Seal



EXPIRES: 3/31/22

Project No. 20191177.0

Scale 1:20

Drawn NICOLE NOVACK

Checked **STEPHEN POWERS**

Date _____

Drawing Title

LINE OF SIGHT PLAN

Drawing No.

L-0.1

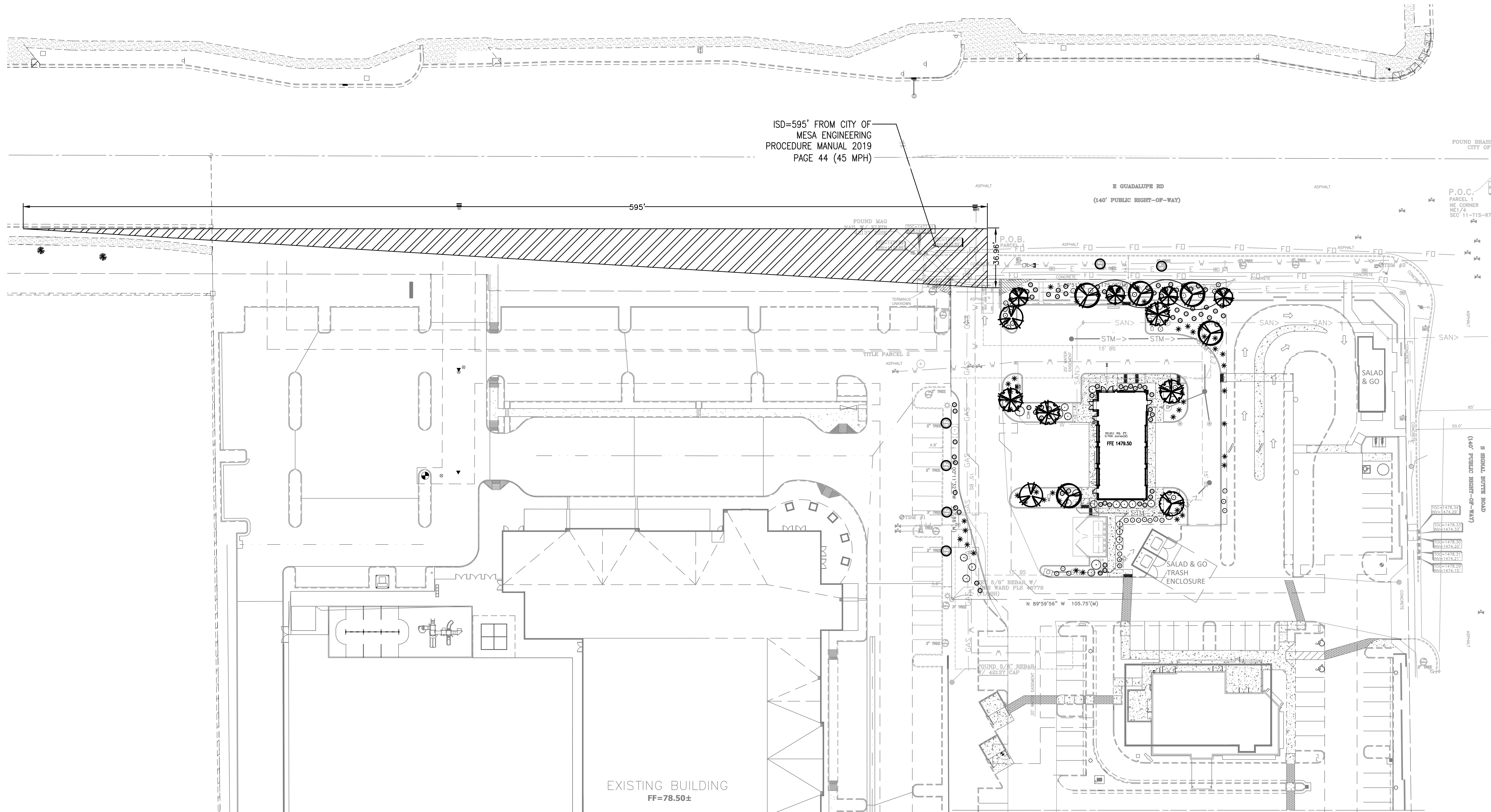

Know what's **below**.
Call before you dig.

GRAPHIC SCALE



(IN FEET)
1 inch = 30 ft



1. LANDSCAPE PLANS ARE FOR THE LOCATION AND IDENTIFICATION OF PLANT MATERIAL ONLY. NO OTHER WORK IS TO BE PERFORMED BASED ON THESE PLANS.
2. QUANTITIES ON THE PLANT SCHEDULE ARE PROVIDED FOR CONVENIENCE. THE CONTRACTOR SHALL BE RESPONSIBLE FOR HIS/HER OWN QUANTITY CALCULATIONS. IN THE EVENT OF A DISCREPANCY BETWEEN THE LANDSCAPE PLANS AND THE PLANT SCHEDULE, THE LANDSCAPE PLAN WILL TAKE PRECEDENCE. THE CONTRACTOR SHALL INFORM THE OWNER'S REPRESENTATIVE IMMEDIATELY UPON DISCOVERING ANY QUANTITY DISCREPANCIES.
3. THE CONTRACTOR SHALL NOT CHANGE OR SUBSTITUTE PLANT VARIETIES OR SPECIES WITHOUT PRIOR WRITTEN APPROVAL FROM THE OWNER'S REPRESENTATIVE
4. CONTRACTOR SHALL TAKE 3 REPRESENTATIVE SOIL SAMPLES OF EACH PROPOSED PLANT BED AND SUBMIT COPIES OF THE RESULTS TO THE OWNER'S REPRESENTATIVE PRIOR TO BEGINNING WORK.
5. CONTRACTOR SHALL ENSURE POSITIVE DRAINAGE OF ALL PLANTING HOLES AND PLANT BEDS PRIOR TO INSTALLATION.
6. QUALITY OF PLANT MATERIAL: ALL PLANTS SHALL CONFORM TO THE CURRENT VERSION OF THE AMERICAN STANDARD FOR NURSERY STOCK (ANSI Z60.1) AND MEET OR EXCEED THE ARIZONA NURSERY ASSOCIATION (ANA SPECIFICATIONS).
7. PLANT MATERIAL SHALL BE FREE OF DISEASE AND/OR INSECTS, AND SHALL HAVE A HEALTHY ROOT SYSTEM WITH NO CIRCLING OR KINKED ROOTS. CONTAINER PLANTS SHALL NOT BE ROOT BOUND. PLANT MATERIAL SHALL CONFORM TO THE CURRENT STANDARDS OF THE AMERICAN STANDARD FOR NURSERY STOCK (ANSI Z60.1-2004).

8. TREES SHALL HAVE STRAIGHT TRUNKS, DENSE CANOPIES AND STRONG BRANCHING WITH GOOD CROTCH ANGLES. CONTRACTOR SHALL SUBMIT GRADE PHOTOS OF EACH TREE TO OWNER'S REPRESENTATIVE PRIOR TO DELIVERY.
9. ALL PLANT MATERIAL SHALL BE SUFFICIENTLY WATERED TO WET THE ENTIRE ROOT BALL WITHIN TWO HOURS OF PLANTING.

WATER NECESSARY FOR PLANTING AND MAINTENANCE SHALL BE OF SATISFACTORY QUALITY TO SUSTAIN ADEQUATE PLANT GROWTH AND SHALL NOT CONTAIN HARMFUL, NATURAL OR MAN-MADE ELEMENTS DETRIMENTAL TO PLANTS. WATER MEETING THE ABOVE STANDARD SHALL BE OBTAINED ON THE SITE FROM THE OWNER, IF AVAILABLE, AND THE CONTRACTOR SHALL BE RESPONSIBLE TO MAKE ARRANGEMENTS FOR ITS USE BY HIS TANKS, HOSES, SPRINKLERS, ETC.... IF SUCH WATER IS NOT AVAILABLE AT THE SITE, THE CONTRACTOR SHALL PROVIDE SATISFACTORY WATER FROM SOURCES OFF THE SITE AT NO ADDITIONAL COST TO THE OWNER.

* WATERING/IRRIGATION RESTRICTIONS MAY APPLY REFER TO PROPERTY'S JURISDICTIONAL AUTHORITY.

10. INSPECTION AND APPROVAL OF PLANT MATERIAL: ALL PLANT MATERIAL SHALL BE INSPECTED AND APPROVED BY THE OWNER'S REPRESENTATIVE UPON DELIVERY TO THE SITE, PRIOR TO INSTALLATION. CONTRACTOR SHALL GIVE THE OWNER'S REPRESENTATIVE AT LEAST ONE WEEK NOTICE PRIOR TO PLANT DELIVERY.

11. NEW SHRUB AND GROUND COVER PLANTING SHALL BE A MINIMUM OF 36" AWAY FROM EXISTING TREES.

12. CONTRACTOR SHALL REMOVE ALL PLANT TAGS AFTER APPROVAL OF PLANT INSTALLATION BY OWNER'S REPRESENTATIVE.

13. ALL PLANT BEDS TO BE FINISHED WITH DECOMPOSED GRANITE GROUND COVER AT A DEPTH OF TWO (2) INCHES. FINISHED DECOMPOSED GRANITE GROUND COVER SHALL MATCH THE EXISTING GROUND COVER ADJACENT TO THE PROPERTY. DO NOT PILE FINISHED DECOMPOSED GRANITE GROUND COVER AROUND THE BASE OF PLANTS OR TREE TRUNKS. ALL DECOMPOSED GRANITE GROUND COVER EDGES SHALL BE NEAT.

14. MAINTENANCE: CONTRACTOR SHALL MAINTAIN ALL PLANT MATERIAL FROM THE TIME IT IS INSTALLED UNTIL FINAL ACCEPTANCE OR WHEN THE OWNER TAKES OVER MAINTENANCE, WHICHEVER OCCURS FIRST. MAINTENANCE SHALL INCLUDE BUT NOT BE LIMITED TO MOWING, EDGING, WEEDING, WATERING, PRUNING, FERTILIZING, ETC.

15. WARRANTY: CONTRACTOR SHALL PROVIDE A ONE-YEAR WARRANTY ON ALL PLANT MATERIAL AND LABOR. WARRANTY PERIOD SHALL BEGIN UPON FINAL COMPLETION OR WHEN THE OWNER TAKES OVER MAINTENANCE, WHICHEVER OCCURS FIRST.

16. THE CONTRACTOR SHALL MAKE PERIODIC INSPECTIONS OF THE PROJECT DURING THE WARRANTY PERIOD TO ENSURE THAT THE ESTABLISHMENT RATE OF GROWTH IS ADEQUATE. ANY METHODS OR PRODUCTS DEEMED NOT NORMAL OR DETRIMENTAL TO GOOD PLANT GROWTH SHALL BE REPORTED TO THE OWNER'S REPRESENTATIVE IN WRITING. FAILURE TO INSPECT AND REPORT WILL BE INTERPRETED AS APPROVAL, AND THE CONTRACTOR SHALL BE RESPONSIBLE FOR ANY AND ALL REPLACEMENTS.

17. LANDSCAPE AREAS ARE DEFINED AS ALL NON PAVED AREAS DISTURBED BY CONSTRUCTION. SLIGHT VARIATIONS MAY EXIST BETWEEN ACTUAL SITE CONDITIONS AND DRAWINGS. CONTRACTOR SHALL ADJUST PLANTING LAYOUT AS REQUIRED TO MAINTAIN PLANT QUANTITIES AND DESIGN INTENT.

18. THE CONTRACTOR SHALL NOT SUBSTITUTE ANY PLANT (IN SPECIES, VARIETY, OR PATENT) FOR ANY PLANT THAT IS SPECIFIED IN THE LEGEND. IF AVAILABILITY IS A PROBLEM, THE CONTRACTOR SHALL CONTACT THE OWNER AND THE OWNER'S REPRESENTATIVE TO DISCUSS ACCEPTABLE OPTIONS.

19. COORDINATE ALL NECESSARY EXCAVATION AREAS WITH OWNER'S REPRESENTATIVE.

20. LANDSCAPE CONTRACTOR IS RESPONSIBLE FOR ALL LANDSCAPE SLEEVING. COORDINATE INSTALLATION WITH GENERAL CONTRACTOR. VERIFY ANY EXISTING SLEEVES INSTALLED BY OTHER CONTRACTORS.

21. IRRIGATION AND ELECTRICAL SLEEVES TO BE SCHEDULE 40 PVC. ALL SLEEVES TO EXTEND 6" BEYOND CONCRETE STRUCTURES. ALLOW AT LEAST 4" - 6" FROM END OF SLEEVES TO FIRST FITTING ON IRRIGATION LINES. ALL SLEEVES TO BE 24" BELOW GRADE AND/OR AS PER PROJECT DETAILS.

22. COMMON SLEEVES MAY BE USED FOR LATERAL LINES AND MAINLINES. CONTRACTOR IS RESPONSIBLE FOR ADEQUATE SIZE SLEEVE SO ALL PIPES MOVE FREELY WITHIN THE SLEEVE. CONTRACTOR TO 'AS BUILT' ALL SLEEVE SIZES AND LOCATIONS.

23. MARK BACK OF EXISTING AND NEW CURBS AT SLEEVE LOCATIONS BY NOTCHING NEW CONCRETE WITH 1/2" "V" NOTCH OR PLACING RE-BAR VERTICAL SO TOP OF BAR IS 6" BELOW FINISH GRADE.

24. FINISHED GRADE(S) NOTED ON THE LANDSCAPE DETAILS TO BE FIELD VERIFIED/APPROVED AND MODIFIED AS PER ARCHITECTURAL AND CIVIL DRAWINGS.

25. GRANULAR TOP DRESSING SHALL EXTEND UNDER SHRUBS AND BE RAKED UNIFORMLY ALONG CURBS, SIDEWALKS AND WALLS AT A CONSISTENT DEPTH AS SPECIFIED BY DETAILS.

26. THE LANDSCAPE CONTRACTOR SHALL BE RESPONSIBLE FOR THE PROPER CARE AND HANDLING OF TREES AND PLANTS FOR DELIVERY AND PLACEMENT IN PLANTING PIT. TREES THAT ARE DROPPED FROM TRUCKS OR DROPPED INTO PITS SHALL BE REJECTED FOR REPLACEMENT BY THE LANDSCAPE CONTRACTOR. IF ROOTBALLS FALL APART DURING THE PLANTING OPERATION THE PLANT SHALL NOT BE PLANTED. NEW PLANT MATERIALS SHALL BE PROVIDED TO REPLACE THOSE THAT ROOTBALLS FALL APART.

27. PLANT CONTAINERS SHALL BE CUT TO REMOVE ROOTBALLS THAT ARE TIGHT IN THE CONTAINER. THE CONTRACTOR SHALL NOT REMOVE THE PLANT FROM THE CONTAINER BY THE TRUNK.

28. LANDSCAPE CONTRACTOR SHALL BE AWARE OF ALL EXISTING SITE CONDITIONS AND PREPARE BID ACCORDINGLY.

29. EXISTING PLANT MATERIALS SHALL BE PROTECTED IN PLACE AND REPLACED IN LIKE SIZE, QUANTITY AND TYPE IF DAMAGED DURING CONSTRUCTION.

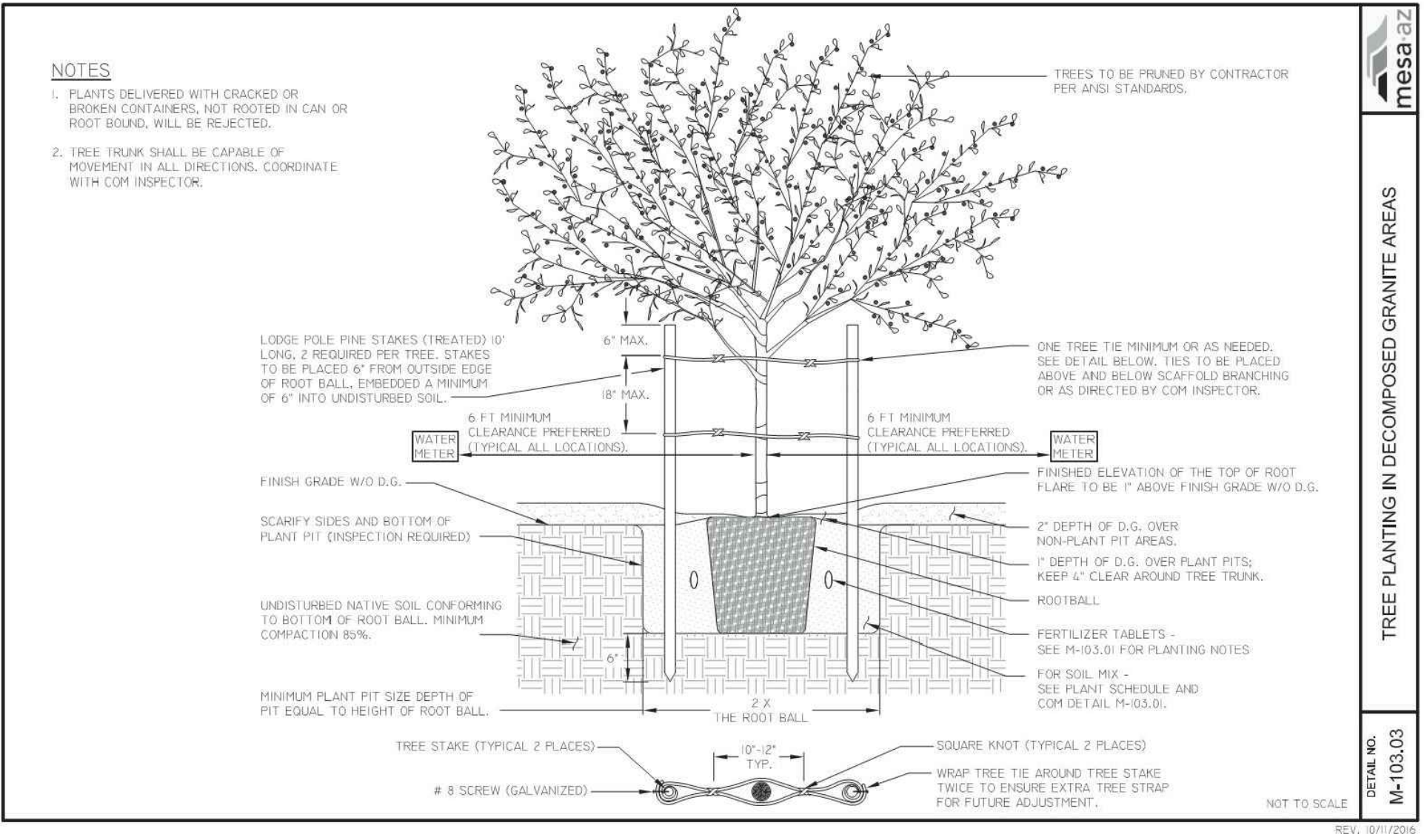
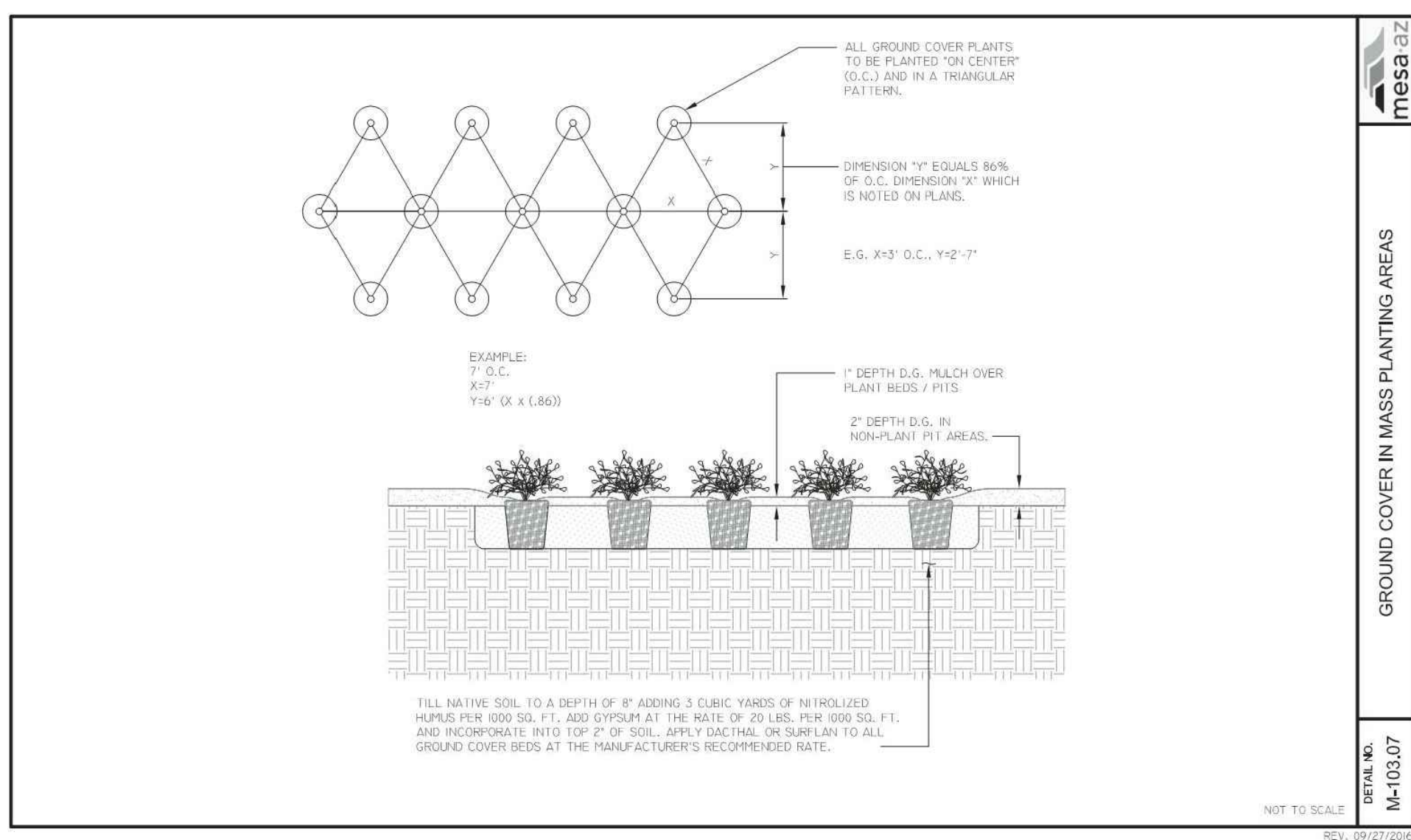
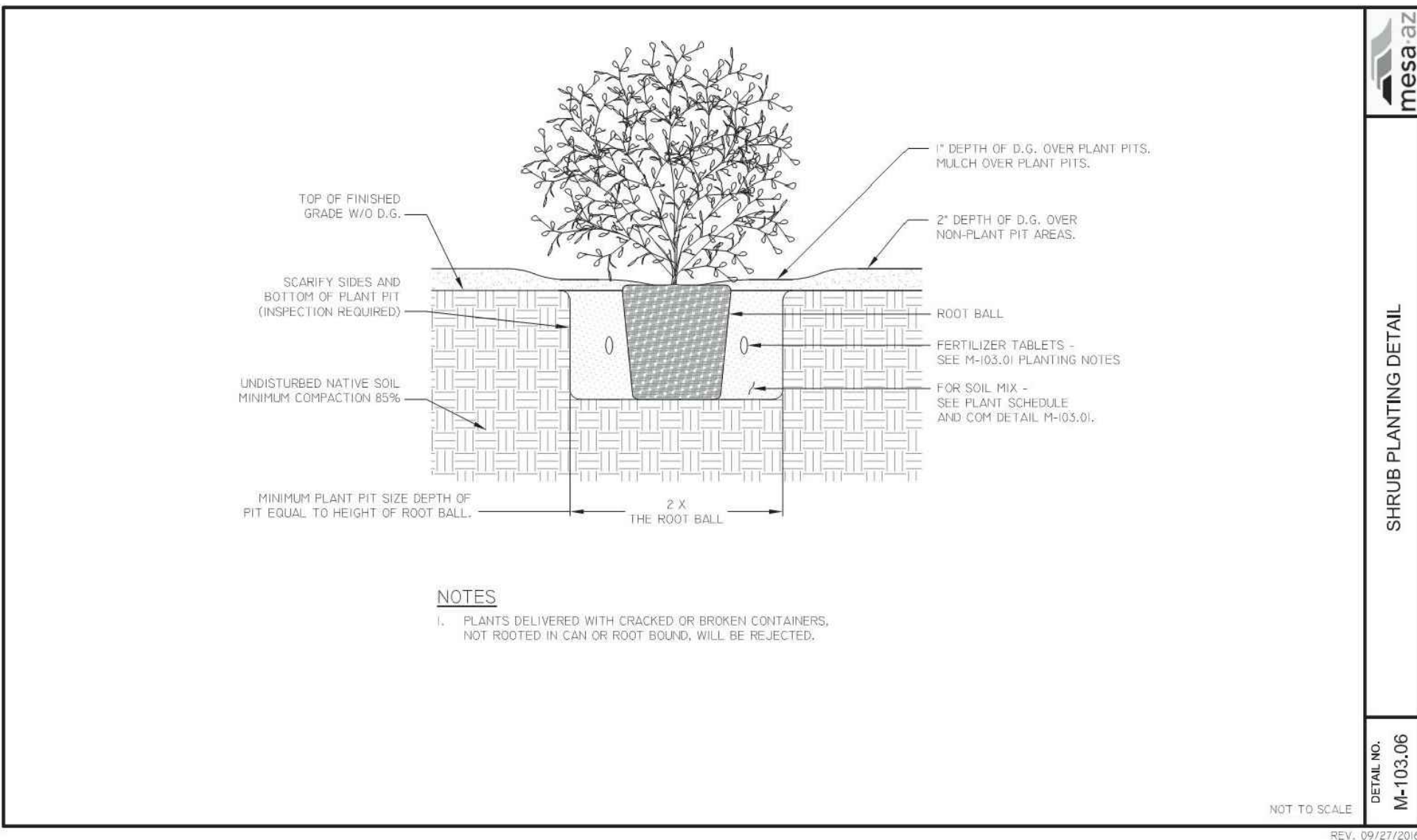

NATIVE PLANTING BACKFILL MIX:	MIX SHALL CONSIST OF: "NATIVE" SITE SOIL (NO CALICHE IN BACKFILL). REMOVE ALL INORGANIC MATERIAL GREATER THAN 1" IN SIZE. SOIL MIX SHALL BE WATER SETTLED WITHOUT POOLING. NO ADDITIONAL FERTILIZATION REQUIRED IN NATIVE PLANTING BACKFILL MIX.
AMENDED PLANTING BACKFILL MIX:	MIX SHALL CONSIST OF: 1/2 PART "NATIVE" SITE SOIL (NO CALICHE IN BACKFILL) & 1/2 PART MULCH ("MULCH" = "NATURAL FERTILE, FRAGILE SOIL, THOROUGHLY MIXED PRIOR TO BACKFILLING"). REMOVE ALL INORGANIC MATERIAL GREATER THAN 1" IN SIZE. SOIL BACKFILLING SHALL BE ACCOMPLISHED IN 6" LIFTS. EACH LIFT SHALL BE WATER SETTLED WITHOUT POOLING.
FERTILIZER TABLETS:	FERTILIZER TABLETS SHALL BE AGRIFORM OR EQUAL. (2) GRAM 20-20-3) SLOW RELEASE. TABLETS SHALL BE PLACED AT 1/2 THE DEPTH OF THE ROOTBALL AT THE FOLLOWING RATES: 1. TABLET PER 1 GALLON CONTAINER 2. TABLETS PER 5 GALLON CONTAINER 3. TABLETS PER 10 GALLON CONTAINER 4. TABLETS PER 24" BOX AND AT A RATE OF 1 TABLET PER EACH ADDITIONAL 6" BOX SIZE. WHEN MULTIPLE QUANTITIES OF TABLETS ARE REQUIRED, THEY SHALL BE EQUALLY SPACED AT THE SPECIFIED DEPTH.

[illegible]

Drawing Name: C:\Users\jnovack\Documents\Projects\Irrigation\Irrigation_20191177_Landscaping.dwg User: jnovack Date: 07/20/2021 11:15am Printed on: 07/20/2021 11:15am

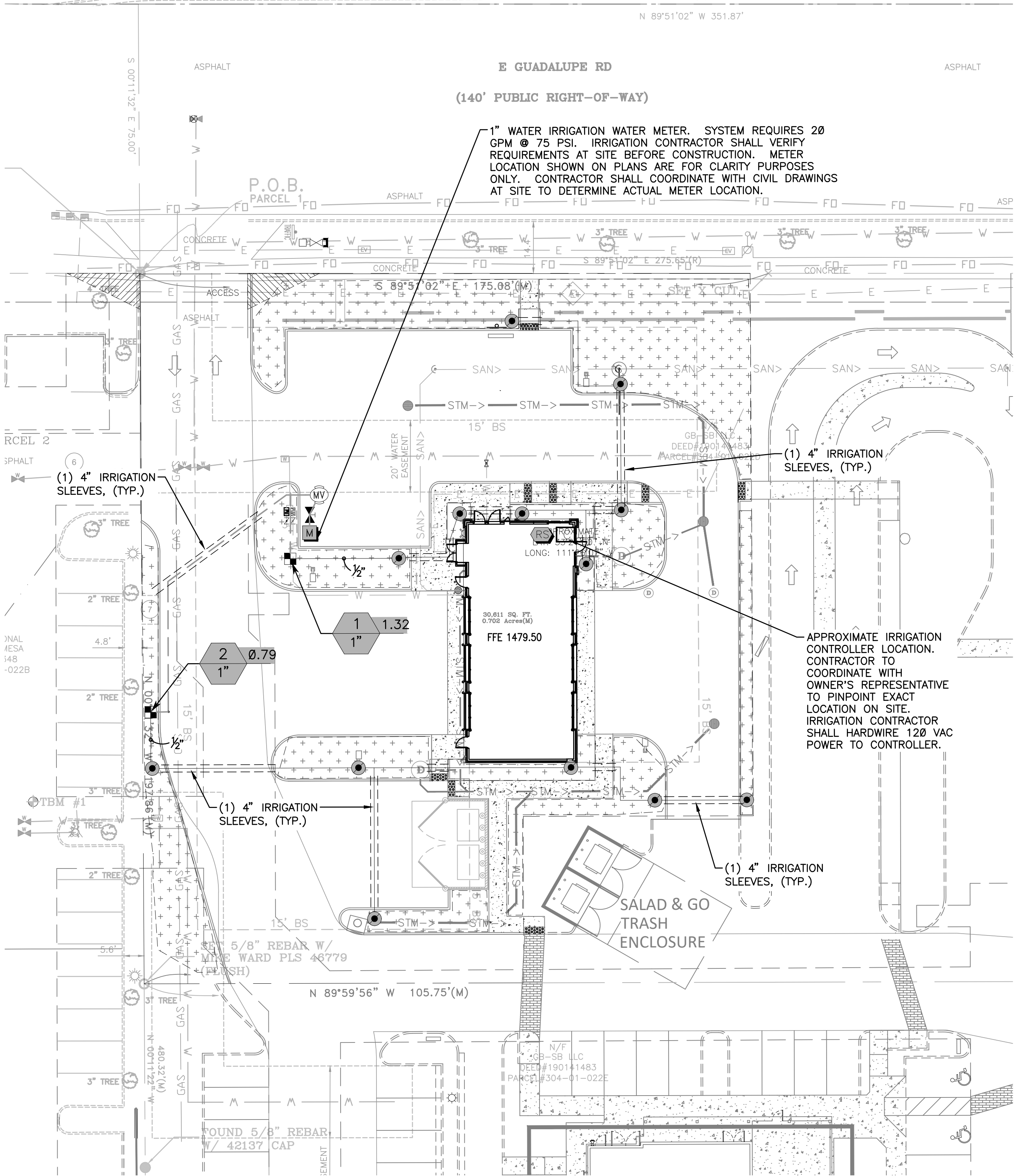

IRRIGATION SCHEDULE

SYMBOL	MANUFACTURER/MODEL/DESCRIPTION	QTY
	RAIN BIRD XZC-100-PRB-LC WIDE FLOW DRIP CONTROL KIT, FOR LIGHT COMMERCIAL USES. 1" PEB VALVE, WITH 1" PRESSURE REGULATING 40PSI BASKET FILTER. 0.3GPM TO 2.0GPM.	2
	PIPE TRANSITION POINT IN DRIP BOX PIPE TRANSITION POINT FROM PVC LATERAL TO DRIP TUBING WITH RISER IN 6" (150MM) DRIP BOX.	13
	AREA TO RECEIVE DRIP EMITTERS RAIN BIRD XB-PC SINGLE OUTLET, PRESSURE COMPENSATING DRIP EMITTERS. FLOW RATES OF 0.5GPH=BLUE, 1.0GPH=BLACK, AND 2.0GPH=RED. COMES WITH A SELF-PIERCING BARB INLET X BARB OUTLET. Emitter Notes: 0.5 GPH emitters (1 assigned to each 1 gal plant) 0.5 GPH emitters (1 assigned to each 5 gal plant) 0.5 GPH emitters (2 assigned to each 24" box plant) 0.5 GPH emitters (3 assigned to each 36" box plant)	6,845 S.F.
	NIBCO T-580-S6-R-66-LL STAINLESS STEEL BALL SHUT OFF VALVE	1
	RAIN BIRD PEB-PRS-D 1-1/2" 1", 1-1/2", 2" PLASTIC INDUSTRIAL VALVES. LOW FLOW OPERATING CAPABILITY, GLOBE CONFIGURATION, WITH PRESSURE REGULATOR MODULE.	1
	RAIN BIRD ESP8XME 8 STATION CAPABLE COMMERCIAL CONTROLLER. MOUNTED ON A PLASTIC WALL MOUNT. WITHOUT FLOW SENSOR.	1
	HUNTER MINI-CLICK RAIN SENSOR, MOUNT AS NOTED.	1
	WATER METER 1"	1
	IRRIGATION LATERAL LINE: PVC CLASS 200 SDR 21	433.0 L.F.
	IRRIGATION MAINLINE: PVC CLASS 200 SDR 21	118.4 L.F.
	PIPE SLEEVE: PVC SCHEDULE 40	216.8 L.F.
	Valve Callout Valve Number Valve Flow Valve Size	

IRRIGATION ROUTING SHOWN ON THIS PLAN IS FOR DEMONSTRATION PURPOSES ONLY.
IRRIGATION CONTRACTOR SHOULD FIELD RUN THE IRRIGATION SYSTEM IN THE MANNER OF
AVOIDING ANY CONFLICT WITH PROPOSED/EXISTING DRAINAGE STRUCTURES AND
UNDERGROUND UTILITIES.

GENERAL IRRIGATION NOTES

- THE CONTRACTOR SHALL PROVIDE A FULLY FUNCTIONAL IRRIGATION SYSTEM AS SHOWN ON THE PLANS. IRRIGATION EMITTERS SHALL PROVIDE 100% COVERAGE OF THE AREA TO BE IRRIGATED.
- ALL QUESTIONS CONCERNING THE PLANS, DETAILS OR SPECIFICATIONS SHALL BE DIRECTED TO THE OWNER'S REPRESENTATIVE.
- THE CONTRACTOR SHALL FIELD VERIFY THE CAPABILITY OF THE WATER SOURCE TO DELIVER A MINIMUM PRESSURE (75 PSI) AND VOLUME (30 GPM) TO OPERATE THE IRRIGATION SYSTEMS AS DESIGNED. IN THE EVENT OF DISCREPANCIES CONTACT THE OWNER'S REPRESENTATIVE PRIOR TO INSTALLATION.
- ALL NECESSARY PERMITS (INCLUDING RIGHT OF WAY USE PERMIT) ARE TO BE PROVIDED BY THE INSTALLING CONTRACTOR FOR WORK SHOWN ON THE PLANS.
- ALL COMPONENTS OF THE PROPOSED IRRIGATION SYSTEM SHALL MEET THE FEDERAL, STATE AND LOCAL CODES, REGULATIONS AND ORDINANCES CONCERNING IRRIGATION CONSTRUCTION.
- IN AN EFFORT TO CREATE GRAPHIC CLARITY, IRRIGATION MAINLINE, LATERAL LINE, VALVES AND OTHER COMPONENTS OF THE IRRIGATION SYSTEM MAY BE SHOWN IN PAVED AREAS OR INSIDE BUILDINGS ON THE PLANS. THESE COMPONENTS ARE TO BE INSTALLED IN APPROPRIATE LANDSCAPE AREAS TO CARRY OUT THE INTENT OF THE PLANS.
- THE CONTRACTOR SHALL BE RESPONSIBLE FOR VERIFICATION AND PROTECTION OF ALL UNDERGROUND AND OVERHEAD UTILITIES.
- THE CONTRACTOR SHALL REVIEW THE LANDSCAPE PLANS PRIOR TO INSTALLING THE IRRIGATION SYSTEM. COORDINATE INSTALLATION LOCATIONS OF PIPES, VALVES AND OTHER EQUIPMENT WITH THE INSTALLATION LOCATIONS OF TREES AND SHRUBS.
- AS-BUILT DRAWINGS ARE TO BE PROVIDED BY THE CONTRACTOR. DRAWINGS SHALL BE ON OWNER FURNISHED BASE PLANS IN HARD COPY OR ELECTRONIC VERSIONS. CONTRACTOR SHALL NOTE ALL DEVIATIONS FROM THE IRRIGATION PLANS.
- MAINLINE IS TO BE INSTALLED WITH A MINIMUM OF 18" DEPTH OF COVER, AND LATERAL LINES ARE TO BE INSTALLED WITH A MINIMUM OF 12" DEPTH OF COVER.
- SLEEVINGS IS TO BE PROVIDED BY THE CONTRACTOR (UNLESS OTHERWISE SPECIFICALLY STATED IN THE SPECIFICATIONS OR BID DOCUMENTS).
- THE CONTRACTOR SHALL PROVIDE OPERATING MAINTENANCE INSTRUCTIONS AND OPERATION MANUALS TO THE OWNER PRIOR TO ACCEPTANCE OF THE PROJECT.
- OWNER SHALL PROVIDE 110 VOLT POWER TO THE CONTROLLER LOCATION. ELECTRICAL CONNECTION FROM POWER SOURCE TO CONTROL CLOCK IS TO BE PROVIDED BY THE CONTRACTOR (UNLESS OTHERWISE SPECIFICALLY STATED IN THE SPECIFICATIONS OR BID DOCUMENTS). CONTRACTOR SHALL COORDINATE INSTALLATION LOCATION OF CONTROL CLOCK WITH OWNER'S REPRESENTATIVE.
- CONTRACTOR SHALL INSTALL AN INLINE 120VAC-15A LIGHTNING SURGE PROTECTOR BETWEEN THE POWER SOURCE AND THE CONTROLLER. GROUND EACH CONTROLLER TO A 5/8" X 8" COPPER CLAD GROUND ROD WITH AWG #6 BARE SOLID COPPER WIRE. A PROPER GROUND SHALL HAVE 10 OHMS OR LESS RESISTANCE TO EARTH. USE OF MULTIPLE GROUND RODS MAY BE NECESSARY TO ACHIEVE THE DESIRED RESISTANCE READING.
- CONTRACTOR SHALL LABEL LOCATION AND HEAD TYPE FOR EACH ZONE IN THE IRRIGATION SYSTEM ON THE INSIDE OF THE CONTROLLER DOOR. SUGGESTED ZONE RUN TIME SHALL BE INDICATED. ALL ZONE VALVES SHALL HAVE PERMANENT (PLASTIC OR METAL) TAGS ATTACHED TO THE VALVE CORRESPONDING TO THE NUMBER OF THE ZONE ON THE CONTROLLER.
- THE RAIN SHUT-OFF DEVICE SHALL BE INSTALLED TO MEET LOCAL CODES. CONTRACTOR SHALL LOCATE DEVICE SO THAT OBSTRUCTIONS DO NOT ALTER THE ACCURATE MONITORING OF RAINFALL AT THE PROJECT SITE. ALL WIRING TO THE DEVICE SHALL BE ENCLOSED IN 1/2" PVC ELECTRICAL CONDUIT.
- THE CONTRACTOR SHALL ADJUST ALL EMITTERS TO PROVIDE OPTIMUM COVERAGE AND MINIMIZE OVERTHROW ONTO PAVED SURFACES. ADJUST PRESSURE REGULATING VALVES TO PREVENT MISTING FROM HEADS.
- VALVE BOXES SHALL BE SIZED TO ACCOMMODATE INSTALLATION AND MAINTENANCE OF ZONE VALVE(S). THE VALVE BOX SHALL HAVE A 3" DEEP LAYER OF 1/2" DIAMETER GRAVEL AS A SUMP INSTALLED 2" BELOW THE BOTTOM OF THE VALVE. VALVE BOXES SHALL BE INSTALLED SO THAT THE TOP OF THE BOX IS NO MORE THAN 1.5 INCH ABOVE FINISH GRADE AND SET PARALLEL TO THE SURROUNDING GRADE.
- ALL 24 VOLT CONTROL WIRING SHALL BE UL LISTED, SINGLE STRAND, TYPE UF 600 VOLT CONTROL CABLE. COMMON WIRES TO BE WHITE, AWG #12 OR LARGER WIRE. HOT WIRES TO BE RED, AWG #14 OR LARGER WIRE. SPARE WIRES TO BE ANY COLOR WIRE EXCEPT GREEN, RED OR WHITE, AWG #14 OR LARGER WIRE.
- ALL SPLICES TO THE 24 VOLT CONTROL WIRING SHALL BE MADE WITH KING TECHNOLOGY (KING 6) SILICONE FILLED SAFETY CONNECTORS.
- MAINLINE PIPING SHALL HAVE THRUST BLOCKS SIZED AND PLACED IN ACCORDANCE WITH THE PIPE MANUFACTURER'S RECOMMENDATIONS. THRUST BLOCKS SHALL BE INSTALLED AT ALL CHANGES IN DIRECTION, REDUCTION IN PIPE SIZE, AND END CAPS ON THE MAINLINE.
- IRRIGATION AND ELECTRIC SLEEVES TO BE SCHEDULE 40 PVC. ALL SLEEVES TO EXTEND 6" BEYOND CONCRETE STRUCTURES. ALLOW AT LEAST 4-6" FROM END OF SLEEVES INSTALLED BY OTHER CONTRACTORS.
- MARK BACK OF EXISTING AND NEW CURBS AT SLEEVE LOCATIONS BY NOTCHING NEW CONCRETE WITH 3/4" V NOTCH OR PLACE REBAR VERTICAL SO TOP OF BAR IS NOW 6" BELOW FINISH GRADE.
- COMMON SLEEVES MAY BE USED FOR LATERAL LINES AND MAINLINES. CONTRACTOR IS RESPONSIBLE FOR ADEQUATE SIZE SLEEVE SO ALL PIPES MOVE FREELY WITHIN THE SLEEVE. CONTRACTOR TO 'AS-BUILT' ALL SLEEVES SIZES AND LOCATIONS.



Know what's below.
Call before you dig.

GRAPHIC SCALE

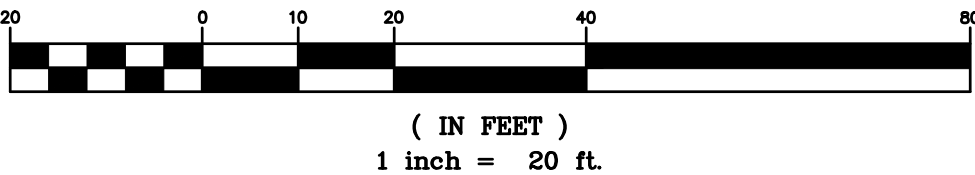

Revisions/Submissions	Date
01/05/21	12/1/20
CIVIL PLANS SUBMITTAL	
ENTITLEMENT SUBMITTAL	
No.	

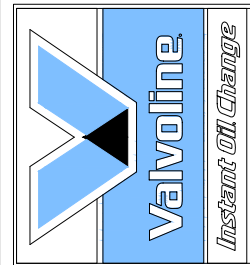

VALVOLINE INSTANT OIL CHANGE
10739 E GUADALUPE ROAD
MESA, ARIZONA

Professional Seal



Project No. 20191177.0

Scale 1:20

Drawn NICOLE NOVACK

Checked STEPHEN POWERS

Date

Drawing Title

IRRIGATION
PLAN

Drawing No.

IR-1.0

Drawing Name: C:\Users\jnovack\appdata\local\temp\AutoCAD_24544\20191177_Landscaping.dwg User: jnovack Date: 07/20/2021 11:25am Printed on: 07/20/2021 11:25am by: jnovack

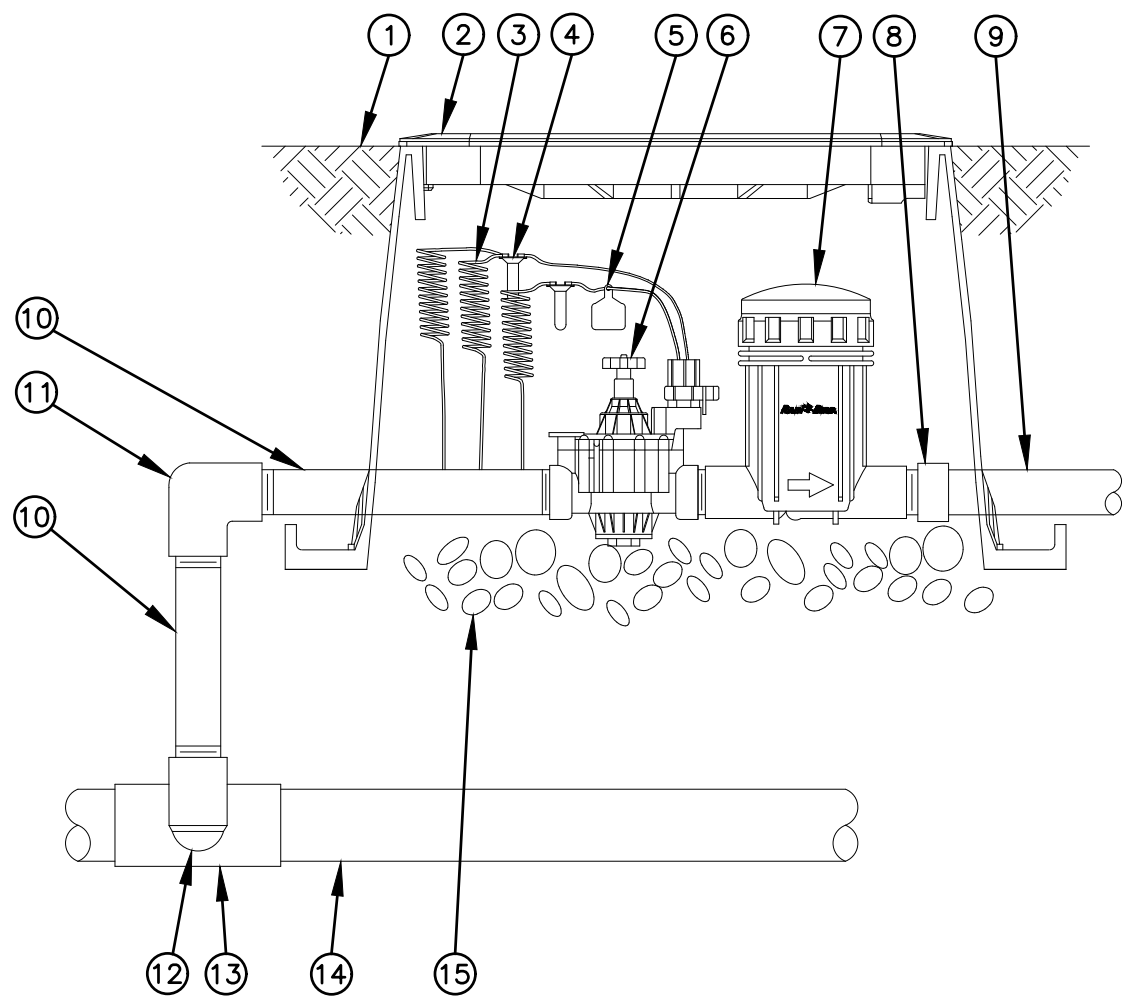

- 1 FINISH GRADE/TOP OF MULCH
- 2 VALVE BOX WITH COVER:
RAIN BIRD VB-STD
- 3 30-INCH LINEAR LENGTH OF WIRE,
COILED
- 4 WATERPROOF CONNECTION:
RAIN BIRD DB SERIES
- 5 ID TAG
- 6 REMOTE CONTROL VALVE:
RAIN BIRD 100-PGA
(INCLUDED IN CZK-100-PRB-LC KIT)
- 7 PRESSURE REGULATING BASKET FILTER:
RAIN BIRD PRB-100
(INCLUDED IN CZK-100-PRB-LC KIT)
- 8 PVC SCH 40 FEMALE ADAPTOR
- 9 LATERAL PIPE
- 10 PVC SCH 80 NIPPLE (LENGTH AS
REQUIRED)
- 11 PVC SCH 40 ELL
- 12 PVC SCH 80 NIPPLE (2-INCH LENGTH,
HIDDEN) AND PVC SCH 40 ELL
- 13 PVC SCH 40 TEE OR ELL
- 14 MAINLINE PIPE
- 15 3-INCH MINIMUM DEPTH OF 3/4-INCH
WASHED GRAVEL

1 XCZ-100-PRB-LC CONTROL ZONE KIT

SCALE: NTS

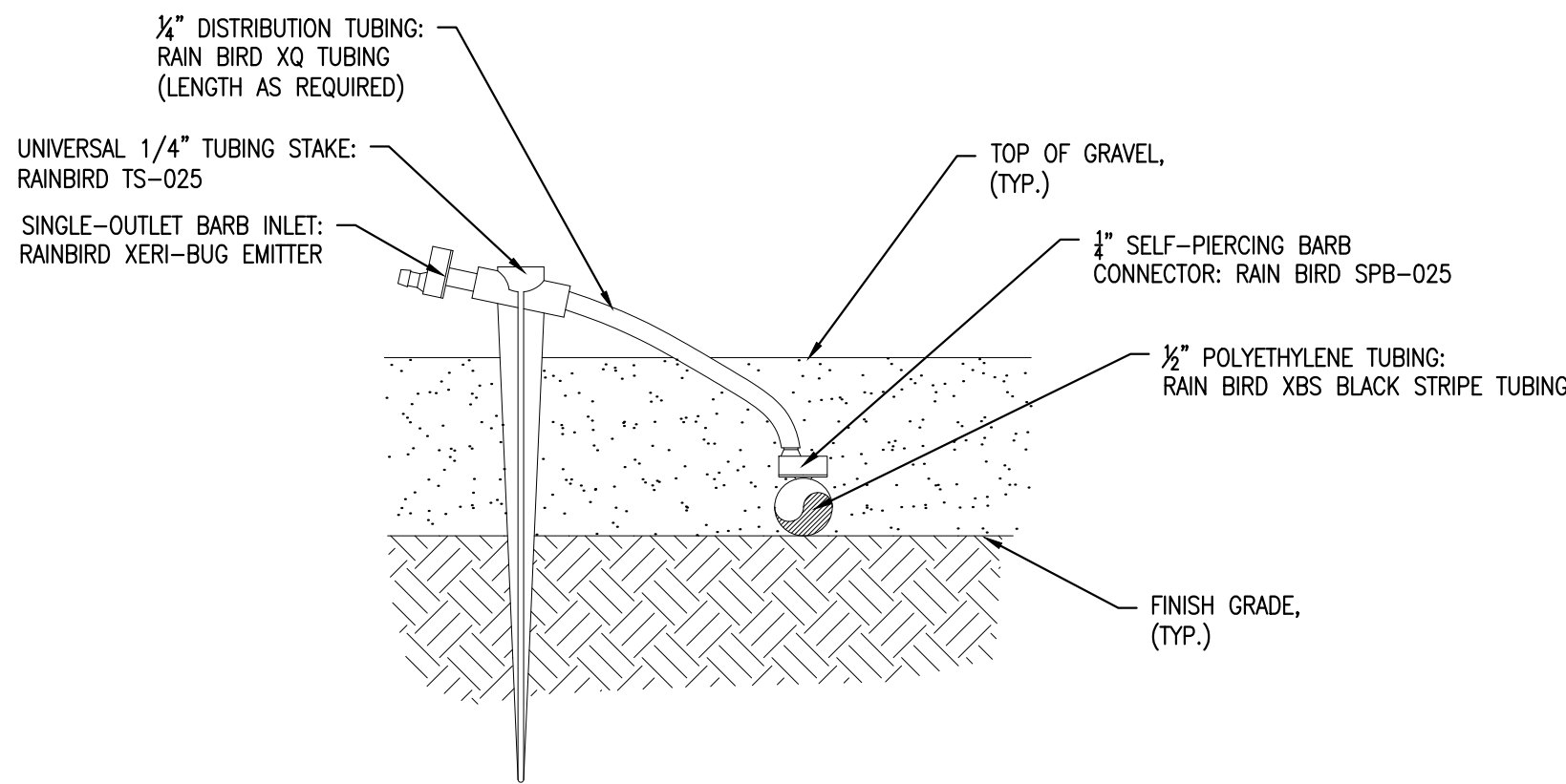

- NOTES:
1. USE RAIN BIRD XERIMAN TOOL XM-TOOL TO INSERT BARB CONNECTOR DIRECTLY INTO 1/2" POLYETHYLENE TUBING.
 2. SHOULD THE EMITTER BECOME DISLODGED UNREGULATED FLOW WILL OCCUR.
 3. RAIN BIRD XERI-BUG BARB X BARB EMITTERS ARE AVAILABLE IN THE FOLLOWING MODELS: XB-05PC 0.5 GPH XB-10PC 1.0 GPH XB-20PC 2.0 GPH

3 XERI-BUG DRIP EMITTER WITH BARBED CONNECTOR

SCALE: NTS

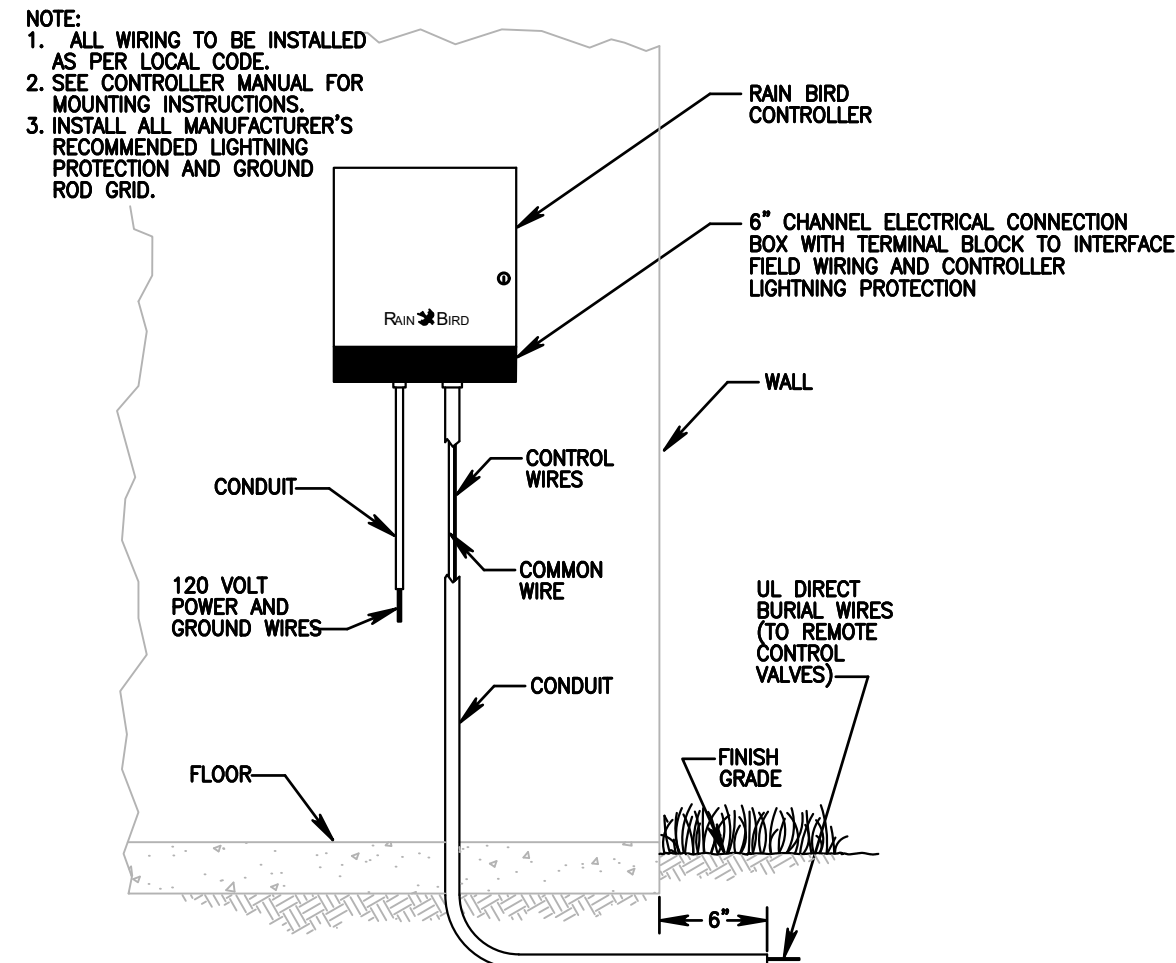

6 CONTROLLER

SCALE: NTS

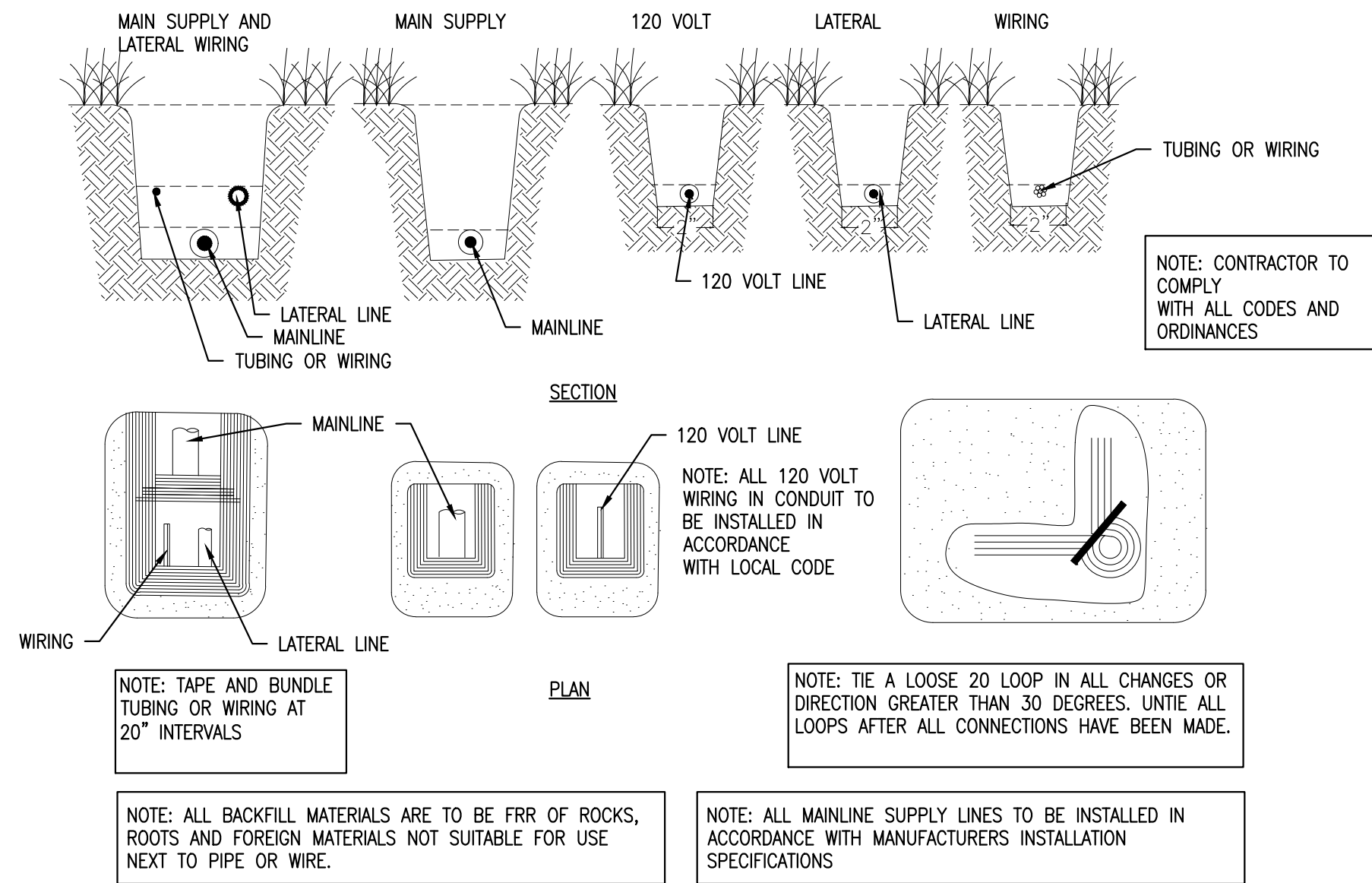

4 TRENCHING DETAIL

SCALE: NTS

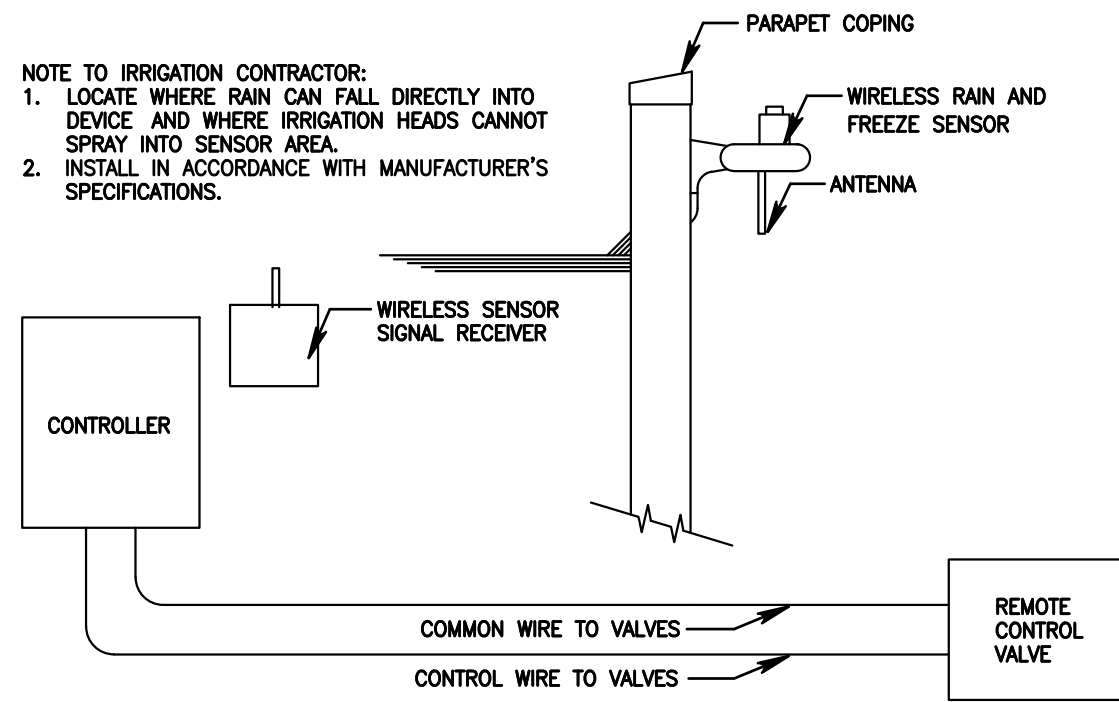

7 RAIN SENSOR

SCALE: NTS

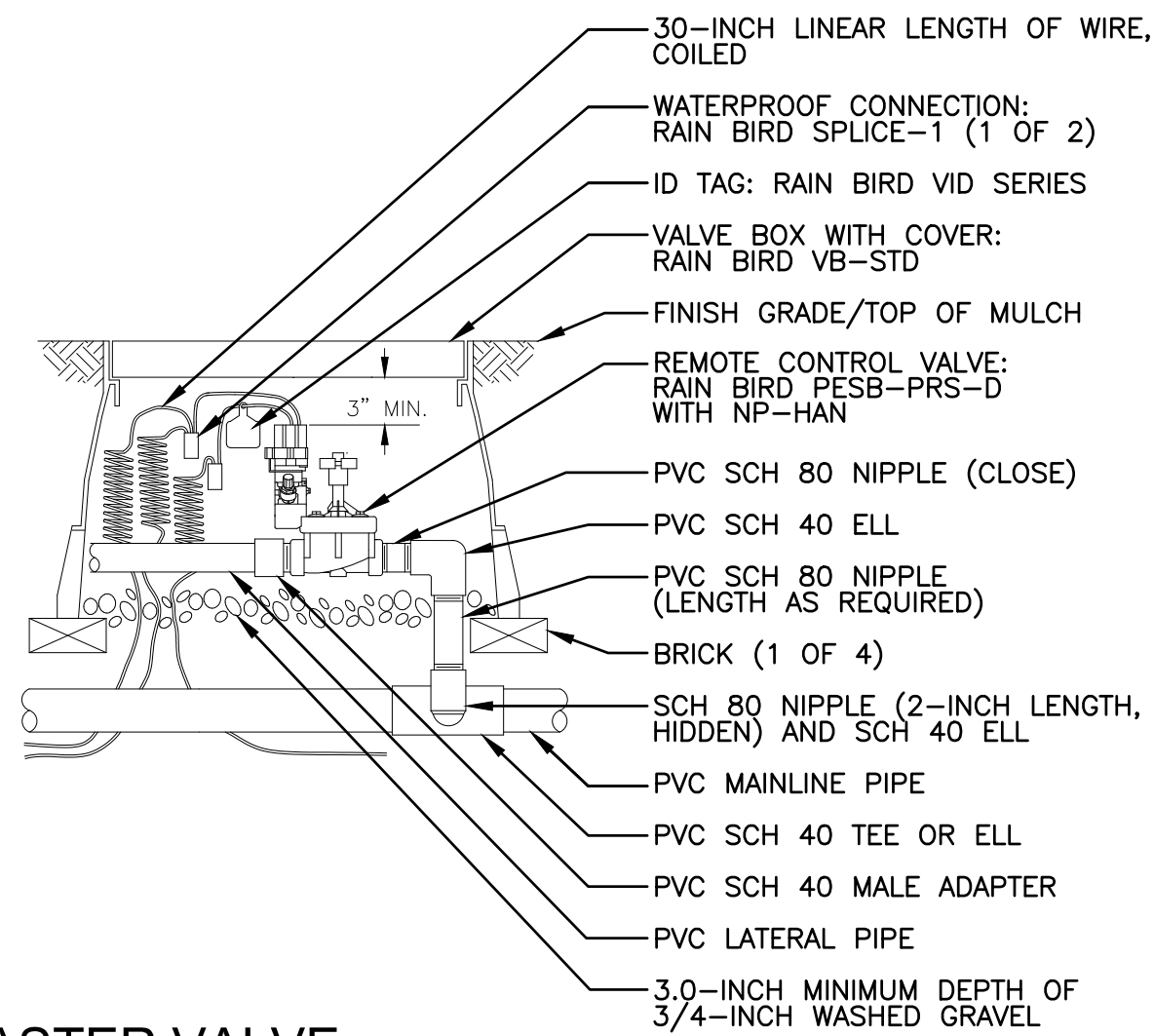

2 SLEEVING DETAIL

SCALE: 1"=1'-0"

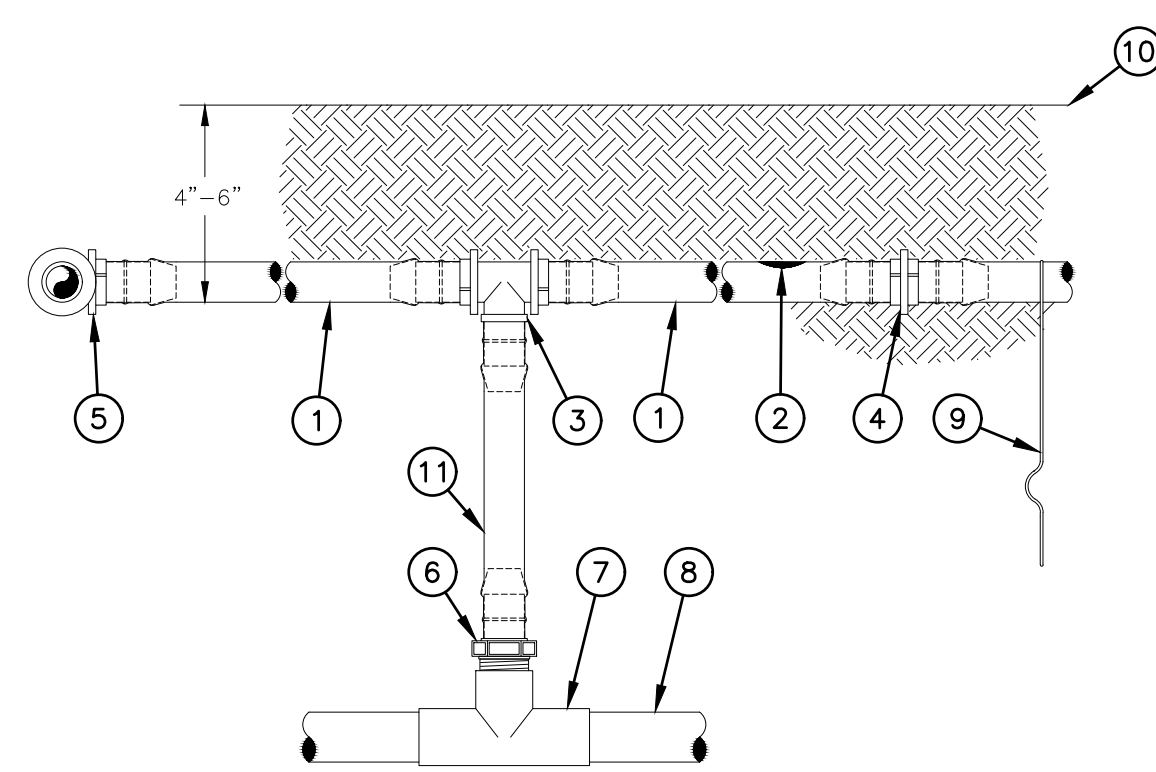

- NOTES:
1. PLACE TIE DOWN STAKES EVERY THREE FEET IN SAND, FOUR FEET IN LOAM, AND FIVE FEET IN CLAY.
 2. AT FITTINGS WHERE THERE IS A CHANGE OF DIRECTION SUCH AS TEES OR ELBOWS, USE TIE-DOWN STAKES ON EACH LEG OF THE CHANGE OF DIRECTION.
 3. SAVE YOUR HANDS. USE THE RAIN BIRD FITTINGS-TOOL XF INSERTION TOOL FOR FITTING ASSEMBLY.

5 XFS SUB-SURFACE DRIPLINE

SCALE: NTS

- 1 ON-SURFACE DRIPLINE:
RAIN BIRD XF SERIES DRIPLINE
POTABLE: XFS DRIPLINE
NON-POTABLE: XFSP DRIPLINE
- 2 INLINE DRIP EMITTER OUTLET, SEE PLANS
FOR DRIPLINE OUTLET SPACING.
- 3 BARB TEE 17x17x17mm
RAIN BIRD XFF-TEE
- 4 BARB COUPLING 17x17mm
RAIN BIRD XFF-COUP
- 5 BARB ELBOW 17x17mm
RAIN BIRD XFF-ELBOW
- 6 BARB MALE ADAPTER
17mm X 1/2" MPT
RAIN BIRD XFF-MA-050
17mm X 3/4" MPT
RAIN BIRD XFF-MA-075
- 7 PVC TEE SxSxT
- 8 PVC LATERAL SUPPLY HEADER
- 9 TIE DOWN STAKE:
RAIN BIRD TDS-050 WITH BEND (TYPICAL)
- 10 FINISH GRADE
- 11 RAIN BIRD XF SERIES BLANK TUBING
LENGTH AS REQUIRED

Revisions/Submissions	Date
01/05/21	12/1/20
ENTITLEMENT SUBMITTAL	
CIVIL PLANS SUBMITTAL	
No.	