

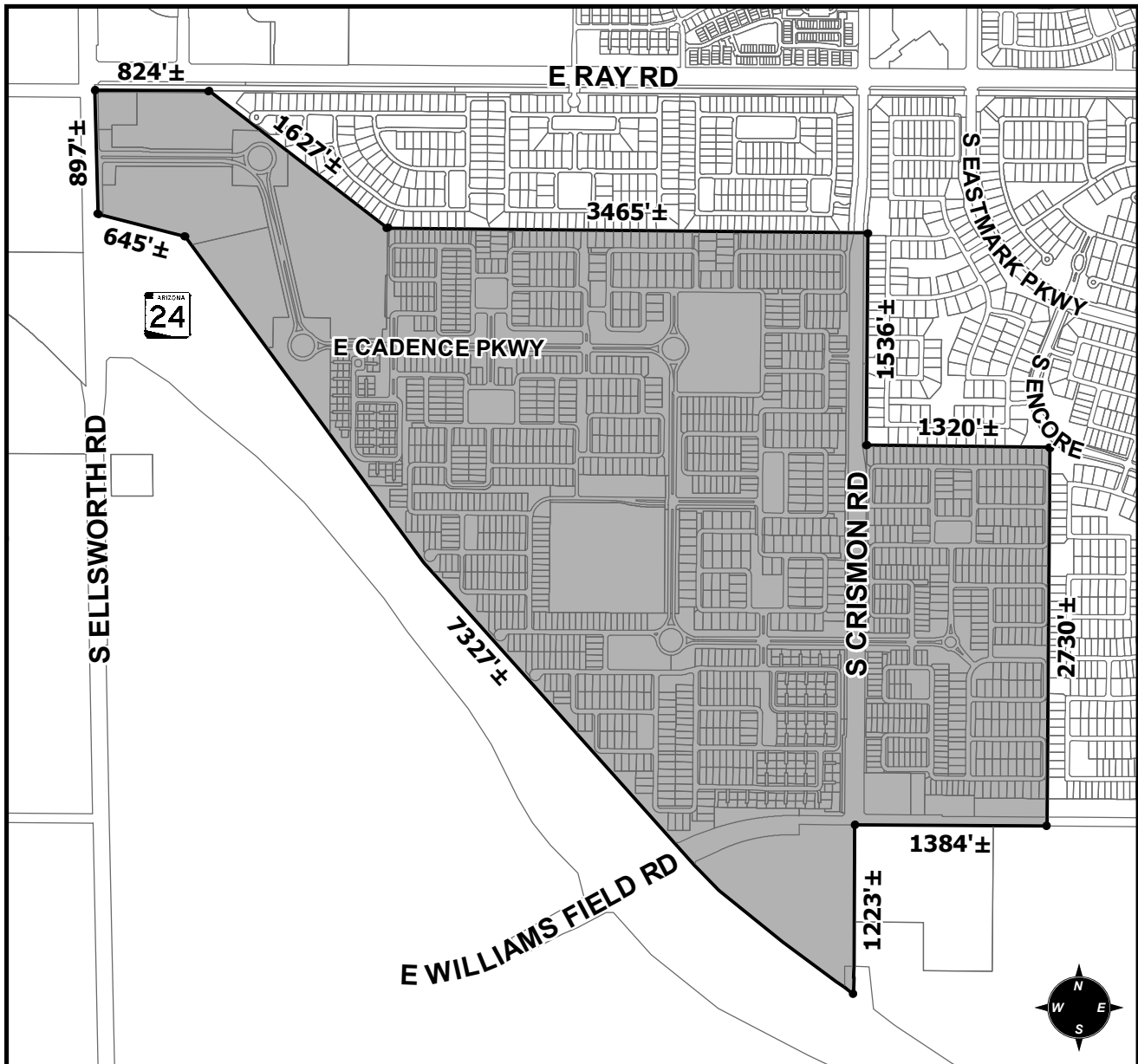

# OFFICIAL SUPPLEMENTARY ZONING MAP AMENDING THE CITY OF MESA ZONING MAP



**CASE:** ZON20-00491

**ACREAGE:** 465±

**REQUEST:** MAJOR AMENDMENT TO THE PACIFIC PROVING GROUNDS NORTH COMMUNITY PLAN, ALSO KNOWN AS THE CADENCE COMMUNITY PLAN.

**ORDINANCE:** \_\_\_\_\_

Please be advised that the attached zoning changes were approved by the Mesa City Council on \_\_\_\_\_, 2021 by Ordinance # \_\_\_\_\_. If you have any questions concerning these changes, contact the City of Mesa Planning Division at 480-644-2385.

\_\_\_\_\_  
**MAYOR**

**ATTEST:** \_\_\_\_\_

**CITY CLERK**

**DATE:** \_\_\_\_\_