

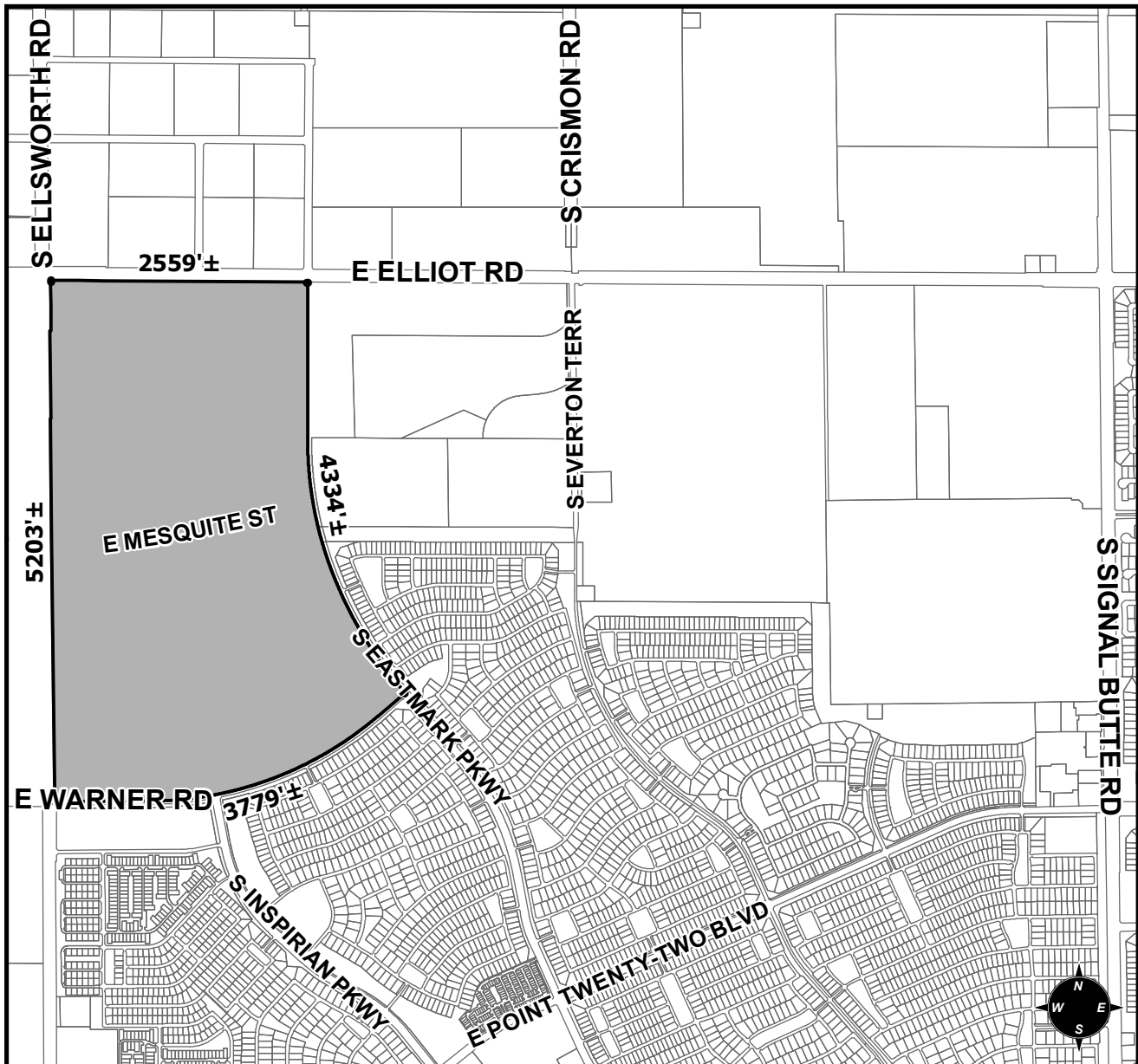

# OFFICIAL SUPPLEMENTARY ZONING MAP AMENDING THE CITY OF MESA ZONING MAP



**CASE: ZON20-00861**

**ACREAGE: 325±**

**REQUEST: MAJOR AMENDMENT TO THE EASTMARK COMMUNITY PLAN.**

**ORDINANCE:** \_\_\_\_\_

Please be advised that the attached zoning changes were approved by the Mesa City Council on \_\_\_\_\_, 2021 by Ordinance # \_\_\_\_\_. If you have any questions concerning these changes, contact the City of Mesa Planning Division at 480-644-2385.

**ATTEST:** \_\_\_\_\_ **DATE:** \_\_\_\_\_

**MAYOR**

**CITY CLERK**