



DESIGN REVIEW BOARD

October 13, 2020



DRB20-00495



Request

- Design Review

Purpose

- Proposed dental office

Location

- West of Dobson on the south side of Broadway.

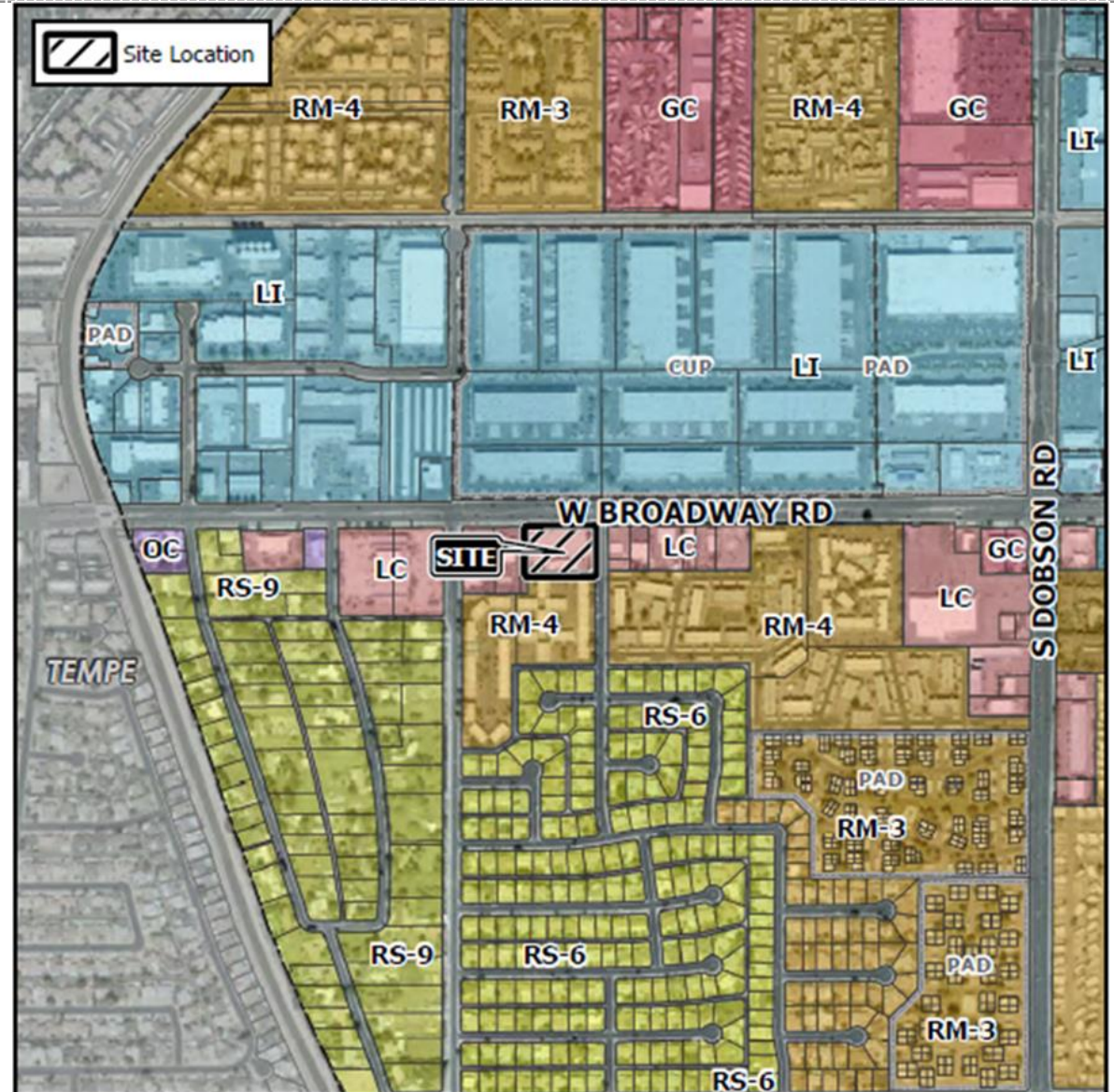

Site Photos



Looking southwest towards the site



Looking south towards the site

Site Plan



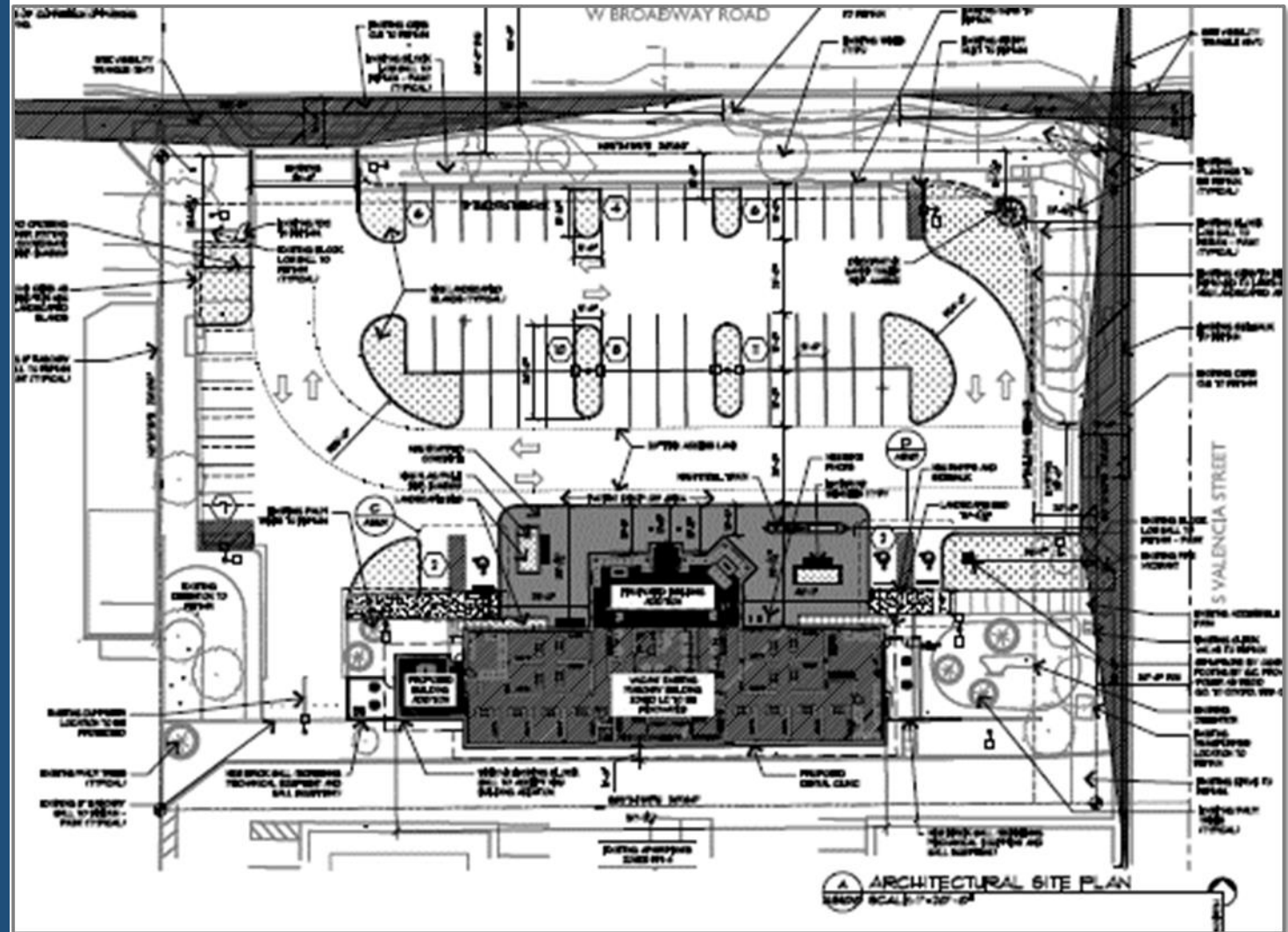











- Access from Broadway and Valencia
- 2 new additions to the existing building
- New foundation base area
- Updated landscaping/reduced landscape setback



Landscape Plan

THE SOIL ACCORDINGLY.

PLANT MATERIAL SCHEDULE

AUP LANDSCAPING	BOTANICAL NAME	COMMON NAME	SIZE	QTY.	FOLIAGE	50 FT. COV.
	TREES					
 QTY: 2 25 sq ft.	FIGUS MICROCARPA	INDIAN LAUREL	24" BOX/36" BOX 5/5	NON-DECIDUOUS SHEDS TWIG		25 sq ft.
 QTY: 1 30 sq ft.	MISTACIA CHINENSIS	CHINESE MISTACHE	24" BOX/36" BOX 5/5	NON-DECIDUOUS SHADE TREE		50 sq ft.
 QTY: 1 30 sq ft.	CHLOPSIS LINEARIS	DESERT WILLOW	24" BOX 3	DECIDUOUS DENSE FOLIAGE		25 sq ft.
 QTY: 1 30 sq ft.	CERCIDUM DESERT MUSEUM	DESERT MUSEUM	24" BOX/36" BOX 6/1	DECIDUOUS DENSE FOLIAGE		50 sq ft.
 QTY: 1 30 sq ft.	QUERCUS VIRGINIANA	SOUTHERN LIVE OAK	36" BOX 4	DECIDUOUS SHADE TREE		50 sq ft.
	ACCENTS & VINES					
 QTY: 5 3 sq ft.	ALOE VERA	MEDICINAL ALCE	5-GAL	4	SMALL SHRUB	10 sq ft.
 QTY: 5 3 sq ft.	HESPERALOE PARVIFLORA	RED YUCCA	5-GAL	16	MEDIUM SHRUB	25 sq ft.
 QTY: 5 3 sq ft.	MULLENBERGIA NASHVILLE	NASHVILLE GRASS	5-GAL	9	ORN. GRASS	5 sq ft.
	SHRUBS					
 QTY: 5 25 sq ft.	LEUCOPHYLLUM 'RIO BRAVO'	'RIO BRAVO SAGE'	5-GAL	30	MEDIUM SHRUB	25 sq ft.
 QTY: 5 25 sq ft.	NEROLI 'PETITE PINK'	'PETITE PINK' OLEANDER	5-GAL	30	MEDIUM SHRUB	25 sq ft.
 QTY: 5 25 sq ft.	TECOMA X 'BELLS OF FIRE'	BELLS OF FIRE	5-GAL	5	MEDIUM SHRUB	25 sq ft.
 QTY: 5 25 sq ft.	TECOMA STANS	YELLOW BELLS	5-GAL	31	MEDIUM SHRUB	25 sq ft.
	GROUND COVERS					
 QTY: 18 25 sq ft.	EREMOPHYLLA MACULATA	YELLOW OUTBACK SUNRISE	1-GAL	60	EVERGREEN G.C.	25 sq ft.
 QTY: 5 3 sq ft.	EREMOPHYLLA HYDROPHANA	BLUE BELLS	1-GAL	70	PERENNIAL G.C.	5 sq ft.
	MISCELLANEOUS					
<div>DG</div> DECOMPOSED GRANITE IN ALL PLANTING AREAS 2" DEPTH MINIMUM (TYP) SIZE AND COLOR TO MATCH THE EXISTING AREAS WITH DECOMPOSED GRANITE						

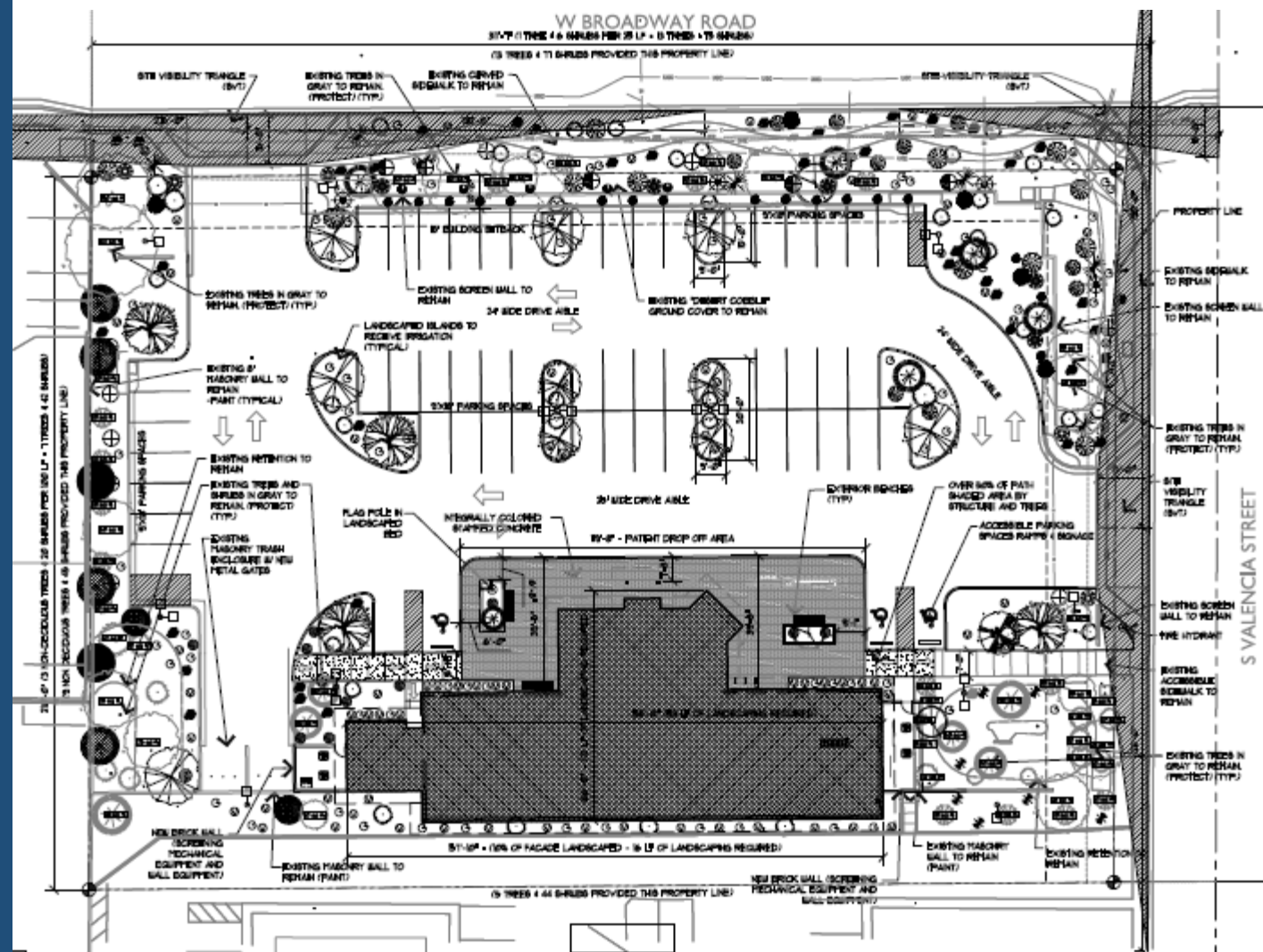

Elevations



D EXTERIOR ELEVATION
SCALE: 1/8" = 1'-0"



C EXTERIOR ELEVATION
SCALE: 1/8" = 1'-0"



B EXTERIOR ELEVATION
SCALE: 1/8" = 1'-0"

EXTERIOR PAINT LEGEND:
ALL COLORS NOTED ARE SHOWN IN LUPIS PAINT
COLORS
BL2000 "NOTOCROFT BRASS"
BL2000 "NOTOCROFT COPPER RED"
BL2000 "NOTOCROFT PEARL WHITE"
BL2000 "TOSC PEAR"

GENERAL NOTES:
1. PAINT ALL JOINTS BL2000 "TOSC PEAR"
2. DO TO CAULK AND PAINT ALL JOINTS
3. DO TO VERIFY ARCHITECT FIRM APPROVAL
OF CAULKING MATERIAL BEFORE PAINTING
4. DO SHALL PAINT ALL ROOF TOP VENTS
TO MATCH ROOF

ALL SHOWN BY SEPARATE PERMIT AND WILL NOT BE REVIEWED
THROUGH THE DESIGN REVIEW OR SITE PLAN REVIEW PROCESS
BUT MUST FOLLOW SIGN CODE (PER ARTICLE 5)



A EXTERIOR ELEVATION
SCALE: 1/8" = 1'-0"

Colors & Materials



Proposed Lighting



WST LED
Architectural Wall Sconce



Specifications Luminaire

Height: 8-1/2"
(21.59 cm)

Width: 17"
(43.18 cm)

Depth: 10-3/16"
(25.9 cm)

Weight: 20 lbs
(9.1 kg)

Optional Back Box (BBW)

Height: 4"
(10.2 cm)

Width: 5-1/2"
(14.0 cm)

Depth: 1-1/2"
(3.8 cm)

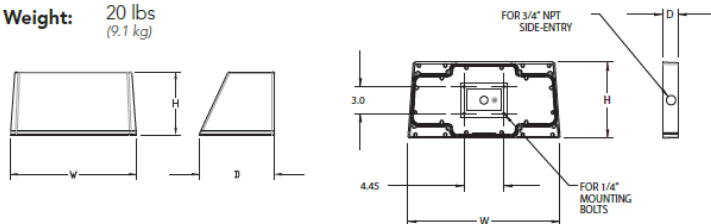

D-Series Size 1
LED Area Luminaire



d^{series}

Specifications

EPA: 1.01 ft²
(0.09 m²)

Length: 33"
(83.8 cm)

Width: 13"
(33.0 cm)

Height H1: 7-1/2"
(19.0 cm)

Height H2: 3-1/2"

Weight (max): 27 lbs
(12.2 kg)

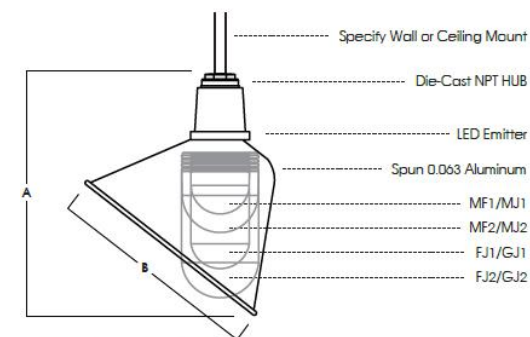
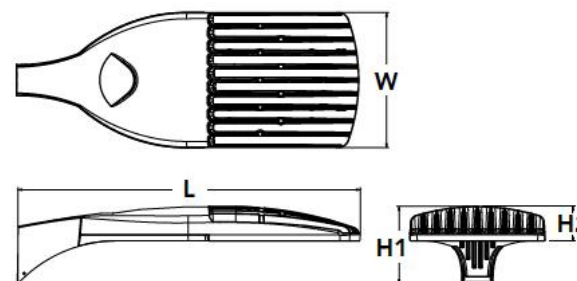

Dimensioned with AR1214LW

SERIES	A	B
AR1012LW	10.4	10.3
AR1214LW	12.9	12.3

Criteria

Section 11-6-3.B

✓	Mix of materials
✓	Base and Top Treatments
✓	No more than fifty percent (50%) of the total facade covered with one (1) single material
✓	All visible facades shall incorporate detailing

Summary

Findings

- Staff has no major concerns
- Project meets MZO requirements

Staff welcomes any feedback



DESIGN REVIEW BOARD

October 13, 2020