

ENLARGED SITE PLAN

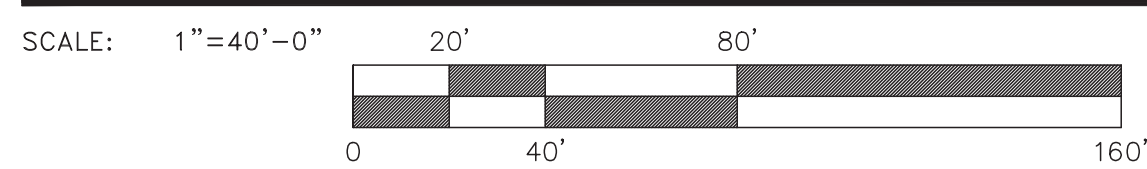

SITE GENERAL NOTES:

- A. ALL WORK DONE IN THE PUBLIC RIGHT-OF-WAY REQUIRES A SEPARATE PERMIT.
- B. CONTRACTOR SHALL VERIFY LOCATION OF ALL EXISTING UTILITIES PRIOR TO COMMENCING WITH CONSTRUCTION, TYPICAL.
- C. CONTRACTOR SHALL MAINTAIN A SAFE AND SECURE SITE AT ALL TIMES DURING THE COURSE OF CONSTRUCTION, TYPICAL.
- D. ALL MATERIALS TO BE REMOVED FROM SITE, SHALL BE DISPOSED OF IN THE PROPER MANNER AND IN THE APPROPRIATE LANDFILL.
- E. THE CONTRACTOR SHALL MAINTAIN FIRE LANE ACCESS DURING THE COURSE OF CONSTRUCTION. FIRE LANE ACCESS SHALL MEET REQUIREMENTS SET FORTH BY THE CITY OF MESA.
- F. THE USE OF PROFANITY, TOBACCO, ALCOHOL OR OTHER DRUGS WILL NOT BE ALLOWED ON THIS SITE. FAILURE TO ADHERE TO THESE RULES SHALL RESULT IN REMOVAL FROM PROJECT SITE.
- G. CONTRACTOR SHALL VERIFY ALL SITE CONDITIONS AND DIMENSIONS PRIOR TO BEGINNING OF CONSTRUCTION. NOTIFY ARCHITECT OF ANY AND ALL DISCREPANCIES IMMEDIATELY.
- H. DEVELOPMENT AND USE OF PROJECT SITE SHALL CONFORM WITH ALL APPLICABLE CODES, ORDINANCES AND GUIDELINES.
- I. ALL NEW AND RELOCATED UTILITIES SHALL BE PLACED UNDERGROUND.
- J. COORDINATE NEW LIGHT POLE LOCATIONS WITH ELECTRICAL AND ARCHITECTURAL DRAWINGS.
- K. PROVIDE HORIZONTAL AND VERTICAL CONTROL JOINTS AT ALL FLATWORK TRANSITIONS AS SHOWN ON PLANS, TYPICAL.
- L. EXPANSION JOINTS IN FLATWORK SHALL BE 20'-0" SPACING, TYPICAL.
- M. SEE CIVIL DRAWINGS FOR ADDITIONAL INFORMATION ON GRADING AND DRAINAGE DESIGN.

CONSTRUCTION NOTES:

- A. "COMPLY WITH ALL PROVISIONS AND REQUIREMENTS OF MESA BUILDING CODE (MBC) CHAPTER 33 - SAFEGUARDS DURING CONSTRUCTION, MESA FIRE CODE (MFC) CHAPTER 33 - FIRE SAFETY DURING CONSTRUCTION AND DEMOLITION, AND NFPA 241 FOR ITEMS NOT SPECIFICALLY ADDRESSED BY MFC CHAPTER 33.
- B. "REQUIRED FIRE APPARATUS ACCESS ROAD DURING CONSTRUCTION OR DEMOLITION SHALL COMPLY WITH MESA FIRE AND MEDICAL DEPARTMENT STANDARD DETAIL FPD 3310.1. THE ACCESS ROAD SHALL BE A MINIMUM OF 20 FEET WIDE OF ALL-WEATHER DRIVING SURFACE, GRADED TO DRAIN STANDING WATER AND ENGINEERED TO BEAR THE IMPOSED LOADS OF FIRE APPARATUS (78,000 LBS. / 24,000 LBS. FRONT AXLE, 54,000 LBS. REAR AXLE) WHEN ROADS ARE WET.
- C. "WATER SUPPLY FOR FIRE PROTECTION. AN APPROVED WATER SUPPLY FOR CONSTRUCTION SITE SHALL MEET THE REQUIREMENTS OF MFC APPENDIX CHAPTERS B AND C. THE MINIMUM FIRE FLOW REQUIREMENT WHEN CONTRACTOR OR DEVELOPER BRINGS COMBUSTIBLE MATERIALS ON SITE IS 1,500 GPM AT 20 PSI. AT LEAST ONE FIRE HYDRANT SHALL BE WITHIN 500 FEET OF ANY COMBUSTIBLE MATERIAL AND CAPABLE OF DELIVERING THE MINIMUM FIRE FLOW REQUIREMENT. THIS HYDRANT OR HYDRANTS MAY BE EITHER TEMPORARY OR PERMANENT AS THE PROJECT SCHEDULE PERMITS.
- D. "IN ADDITION, THERE ARE TIMES WHEN HYDRANTS AND VALVES MUST BE CLOSED TEMPORARILY FOR REPAIR WORK OR CONSTRUCTION OF THE WATER SYSTEM. THE DEVELOPER/CONTRACTOR IS RESPONSIBLE FOR ENSURING THAT THE WATER SUPPLY IS ALWAYS AVAILABLE. WHEN THE WORK IS COMPLETE, DEVELOPER/CONTRACTOR SHALL MAKE SURE THAT THE FIRE HYDRANTS ARE ACTIVE, AND THE VALVES ARE OPEN."

LEGEND:

- DENOTES A.D.A. ACCESSIBLE ROUTE FROM PUBLIC RIGHT-OF-WAY AND A.D.A. ACCESSIBLE PARKING STALLS

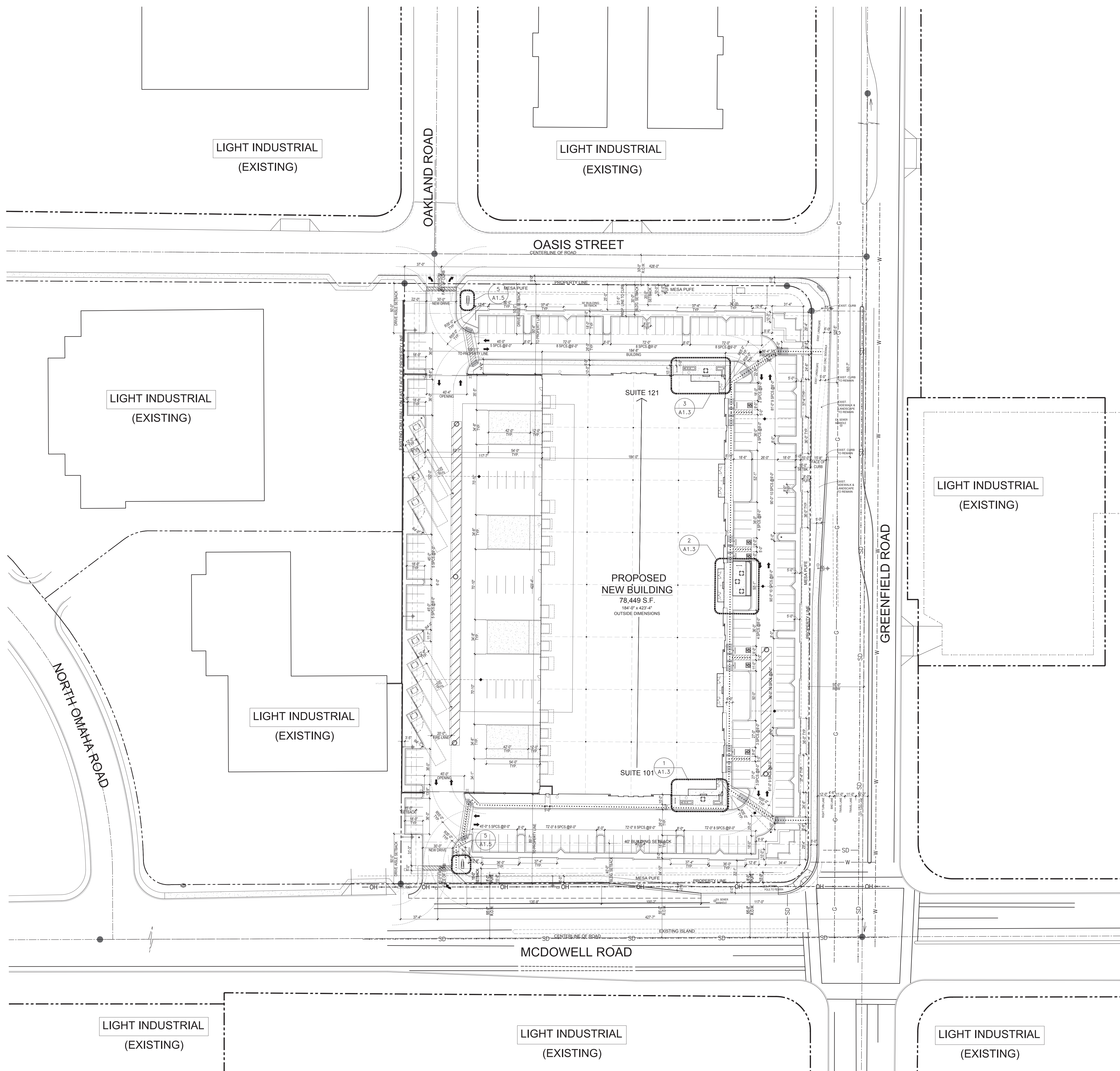

ENLARGED DIMENSIONED SITE PLAN

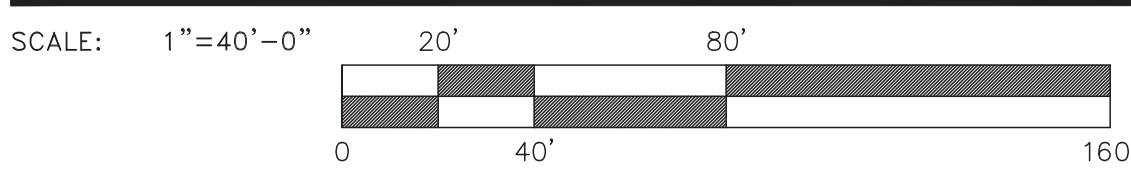

architecture.
design.
management.

adm

2100 WEST 15TH STREET | TEMPE, AZ 85281 | 480.285.3800

JEFFREY FLEMING
05.09.23
ARIZONA U.S.A.
EXPIRES 06/30/2024
DIGITALLY SIGNED PER 42878

GREENFIELD ROAD
AND
MCDOWELL ROAD
INDUSTRIAL PROJECT

2835 N. GREENFIELD RD.
MESA, ARIZONA 85215

WESTERN
SEMI SOLUTIONS

REVISION DATE DESCRIPTION

Project Number
7133-100

Date
09.15.2022

Drawn By
GK

Checked By
JS

DIMENSIONED SITE PLAN

A1.2