



D-Series Size 0 LED Area Luminaire



Catalog
Number

Notes

Type

Hit the Tab key or mouse over the page to see all interactive elements.

Introduction

The modern styling of the D-Series is striking yet unobtrusive - making a bold, progressive statement even as it blends seamlessly with its environment. The D-Series distills the benefits of the latest in LED technology into a high performance, high efficacy, long-life luminaire.

The outstanding photometric performance results in sites with excellent uniformity, greater pole spacing and lower power density. It is ideal for replacing up to 400W metal halide with typical energy savings of 70% and expected service life of over 100,000 hours.

Specifications

EPA: 0.95 ft²
(.09 m²)

Length: 26"
(66.0 cm)

Width: 13"
(33.0 cm)

Height₁: 3"
(7.62 cm)

Height₂: 7"
(17.8 cm)

Weight (max): 16 lbs
(7.25 kg)

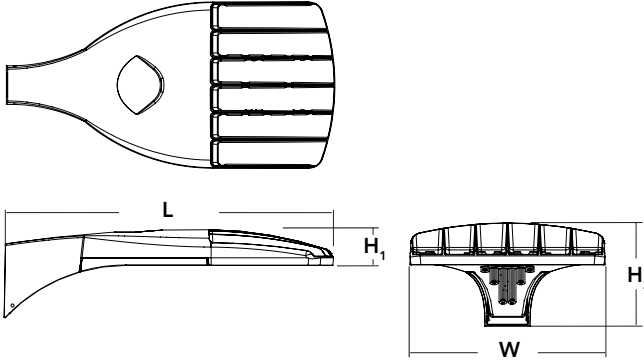

Ordering Information

EXAMPLE: DSX0 LED P6 40K T3M MVOLT SPA NLTAIR2 PIRHN DDBXD

DSX0 LED					
Series	LEDs	Color temperature	Distribution	Voltage	Mounting
DSX0 LED	Forward optics P1 P5 P2 P6 P3 P7 ¹ P4 ¹ Rotated optics P10 ² P12 ² P11 ² P13 ^{1,2}	30K 3000 K 40K 4000 K 50K 5000 K	T1S Type I short (Automotive) T2S Type II short T2M Type II medium T3S Type III short T3M Type III medium T4M Type IV medium TFTM Forward throw medium T5VS Type V very short ³	T5S Type V short ³ T5M Type V medium ³ T5W Type V wide ³ BLC Backlight control ⁴ LCCO Left corner cutoff ⁴ RCCO Right corner cutoff ⁴	Shipped included SPA Square pole mounting RPA Round pole mounting ¹⁰ WBA Wall bracket ³ SPUMBA Square pole universal mounting adaptor ¹¹ RPUMBA Round pole universal mounting adaptor ¹¹ Shipped separately KMA8 DDBXD U Mast arm mounting bracket adaptor (specify finish) ¹²
				MVOLT (120V-277V) ^{5,6} XVOLT (277V-480V) ^{7,8,9} 120 ⁶ 208 ⁶ 240 ⁶ 277 ⁶ 347 ⁶ 480 ⁶	

Control options	Other options	Finish (required)
Shipped installed NLTAIR2 nLight AIR generation 2 enabled ^{13,14} PIRHN Network, high/low motion/ambient sensor ¹⁵ PER NEMA twist-lock receptacle only (control ordered separate) ¹⁶ PER5 Five-pin receptacle only (control ordered separate) ^{16,17} PER7 Seven-pin receptacle only (leads exit fixture) (control ordered separate) ^{16,17} DMG 0-10V dimming extend out back of housing for external control (control ordered separate) ¹⁸	Shipped installed HS House-side shield ²² SF Single fuse (120, 277, 347V) ⁶ DF Double fuse (208, 240, 480V) ⁶ L90 Left rotated optics ² R90 Right rotated optics ² DDL Diffused drop lens ²² HA 50°C ambient operations ¹ BAA Buy America(n) Act Compliant Shipped separately BS Bird spikes ²³ EGS External glare shield	DDBXD Dark bronze DBLXD Black DNAXD Natural aluminum DWHXD White DDBTXD Textured dark bronze DBLBXD Textured black DNATXD Textured natural aluminum DWHGXD Textured white
PIR High/low, motion/ambient sensor, 8-15' mounting height, ambient sensor enabled at 5fc ^{19,20} PIRH High/low, motion/ambient sensor, 15-30' mounting height, ambient sensor enabled at 5fc ^{19,20} PIR1FC3V High/low, motion/ambient sensor, 8-15' mounting height, ambient sensor enabled at 1fc ^{19,20} PIRH1FC3V High/low, motion/ambient sensor, 15-30' mounting height, ambient sensor enabled at 1fc ^{19,20} FAO Field adjustable output ²¹		



COMMERCIAL OUTDOOR

One Lithonia Way • Conyers, Georgia 30012 • Phone: 1-800-705-SERV (7378) • www.lithonia.com
© 2011-2021 Acuity Brands Lighting, Inc. All rights reserved.

DSX0-LED
Rev. 07/19/21
Page 1 of 8

Ordering Information

Accessories

Ordered and shipped separately.

DLL127F 1.5 JU	Photocell - SSL twist-lock (120-277V) ²⁴
DLL347F 1.5 CUL JU	Photocell - SSL twist-lock (347V) ²⁴
DLL480F 1.5 CUL JU	Photocell - SSL twist-lock (480V) ²⁴
DSHORT SBK U	Shorting cap ²⁴
DSX0HS 20C U	House-side shield for P1,P2,P3 and P4 ²²
DSX0HS 30C U	House-side shield for P10,P11,P12 and P13 ²²
DSX0HS 40C U	House-side shield for P5,P6 and P7 ²²
DSX0DDL U	Diffused drop lens (polycarbonate) ²²
PUMBA DDBXD U*	Square and round pole universal mounting bracket adaptor (specify finish) ²⁵
KMA8 DDBXD U	Master arm mounting bracket adaptor (specify finish) ¹²
DSX0EGS (FINISH) U	External glare shield

For more control options, visit [DTL](#) and [ROAM](#) online.
Link to [nLight Air 2](#)

NOTES

- HA not available with P4, P7, and P13.
- P10, P11, P12 and P13 and rotated options (L90 or R90) only available together.
- Any Type 5 distribution with photocell, is not available with WBA.
- Not available with HS or DDL.
- MVOLT driver operates on any line voltage from 120-277V (50/60 Hz).
- Single fuse (SF) requires 120V, 277V or 347V. Double fuse (DF) requires 208V, 240V or 480V. XVOLT not available with fusing (SF or DF).
- XVOLT only suitable for use with P4, P7 and P13.
- XVOLT operates with any voltage between 277V and 480V.
- XVOLT not available with fusing (SF or DF) and not available with PIR, PIRH, PIR1FC3V, PIRH1FC3V.
- Suitable for mounting to round poles between 3.5" and 12" diameter.
- Universal mounting brackets intended for retrofit on existing pre-drilled poles only. 1.5 G vibration load rating per ANCI C136.31. Only usable when pole's drill pattern is NOT Lithonia template #8.
- Must order fixture with SPA mounting. Must be ordered as a separate accessory; see Accessories information. For use with 2-3/8" diameter mast arm (not included).
- Must be ordered with PIRHN.
- Sensor cover available only in dark bronze, black, white and natural aluminum colors.
- Must be ordered with NLTAIR2. For more information on nLight Air 2 visit [this link](#).
- Photocell ordered and shipped as a separate line item from Acuity Brands Controls. See accessories. Shorting Cap included.
- If ROAM® node required, it must be ordered and shipped as a separate line item from Acuity Brands Controls. Shorting Cap included.
- DMG not available with PIRHN, PER5, PER7, PIR, PIRH, PIR1FC3V or PIRH1FC3V, FAO.
- Reference Controls Options table on page 4.
- Reference Motion Sensor Default Table on page 4 to see functionality.
- Not available with other dimming controls options.
- Not available with BLC, LCCO and RCCO distribution.
- Must be ordered with fixture for factory pre-drilling.
- Requires luminaire to be specified with PER, PER5 or PER7 option. See Controls Table on page 4.
- For retrofit use only. Only usable when pole's drill pattern is NOT Lithonia template #8

EGS – External Glare Shield

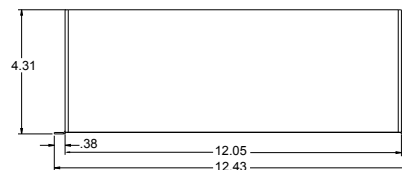
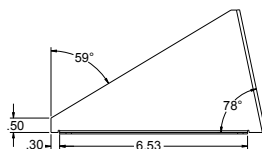
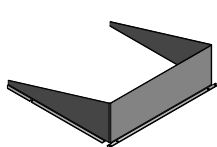

Drilling

HANDHOLE ORIENTATION (from top of pole)

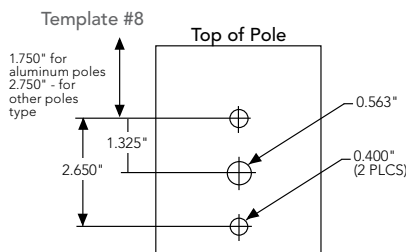
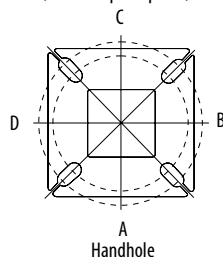

Tenon Mounting Slipfitter

Tenon O.D.	Mounting	Single Unit	2 @ 180	2 @ 90	3 @ 90	3 @ 120	4 @ 90
2-3/8"	RPA	AS3-5 190	AS3-5 280	AS3-5 290	AS3-5 390	AS3-5 320	AS3-5 490
2-7/8"	RPA	AST25-190	AST25-280	AST25-290	AST25-390	AST25-320	AST25-490
4"	RPA	AST35-190	AST35-280	AST35-290	AST35-390	AST35-320	AST35-490

Mounting Option	Drilling Template	Single	2 @ 180	2 @ 90	3 @ 90	3 @ 120	4 @ 90
Head Location		Side B	Side B & D	Side B & C	Side B, C & D	Round Pole Only	Side A, B, C & D
Drill Nomenclature	#8	DM19AS	DM28AS	DM29AS	DM39AS	DM32AS	DM49AS
Minimum Acceptable Outside Pole Dimension							
SPA	#8	2-7/8"	2-7/8"	3.5"	3.5"		3.5"
RPA	#8	2-7/8"	2-7/8"	3.5"	3.5"	3"	3.5"
SPUMBA	#5	2-7/8"	3"	4"	4"		4"
RPUMBA	#5	2-7/8"	3.5"	5"	5"	3.5"	5"

DSX0 Area Luminaire - EPA

*Includes luminaire and integral mounting arm. Other tenons, arms, brackets or other accessories are not included in this EPA data.

Fixture Quantity & Mounting Configuration	Single DM19	2 @ 180 DM28	2 @ 90 DM29	3 @ 90 DM39	3 @ 120 DM32	4 @ 90 DM49
Mounting Type						
DSX0 LED	0.950	1.900	1.830	2.850	2.850	3.544

Performance Data

Lumen Ambient Temperature (LAT) Multipliers

Use these factors to determine relative lumen output for average ambient temperatures from 0-40°C (32-104°F).

Ambient		Lumen Multiplier
0°C	32°F	1.04
5°C	41°F	1.04
10°C	50°F	1.03
15°C	59°F	1.02
20°C	68°F	1.01
25°C	77°F	1.00
30°C	86°F	0.99
35°C	95°F	0.98
40°C	104°F	0.97

Projected LED Lumen Maintenance

Data references the extrapolated performance projections for the platforms noted in a **25°C ambient**, based on 10,000 hours of LED testing (tested per IESNA LM-80-08 and projected per IESNA TM-21-11).

To calculate LLF, use the lumen maintenance factor that corresponds to the desired number of operating hours below. For other lumen maintenance values, contact factory.

Operating Hours	Lumen Maintenance Factor
25,000	0.96
50,000	0.92
100,000	0.85

Motion Sensor Default Settings						
Option	Dimmed State	High Level (when triggered)	Photocell Operation	Dwell Time	Ramp-up Time	Ramp-down Time
PIR or PIRH	3V (37%) Output	10V (100%) Output	Enabled @ 5FC	5 min	3 sec	5 min
*PIR1FC3V or PIRH1FC3V	3V (37%) Output	10V (100%) Output	Enabled @ 1FC	5 min	3 sec	5 min

*for use when motion sensor is used as dusk to dawn control.

Electrical Load

					Current (A)					
	Performance Package	LED Count	Drive Current	Wattage	120	208	240	277	347	480
Forward Optics (Non-Rotated)	P1	20	530	38	0.32	0.18	0.15	0.15	0.10	0.08
	P2	20	700	49	0.41	0.23	0.20	0.19	0.14	0.11
	P3	20	1050	71	0.60	0.37	0.32	0.27	0.21	0.15
	P4	20	1400	92	0.77	0.45	0.39	0.35	0.28	0.20
	P5	40	700	89	0.74	0.43	0.38	0.34	0.26	0.20
	P6	40	1050	134	1.13	0.65	0.55	0.48	0.39	0.29
	P7	40	1300	166	1.38	0.80	0.69	0.60	0.50	0.37
Rotated Optics (Requires L90 or R90)	P10	30	530	53	0.45	0.26	0.23	0.21	0.16	0.12
	P11	30	700	72	0.60	0.35	0.30	0.27	0.20	0.16
	P12	30	1050	104	0.88	0.50	0.44	0.39	0.31	0.23
	P13	30	1300	128	1.08	0.62	0.54	0.48	0.37	0.27

Controls Options

Nomenclature	Description	Functionality	Primary control device	Notes
FAO	Field adjustable output device installed inside the luminaire; wired to the driver dimming leads.	Allows the luminaire to be manually dimmed, effectively trimming the light output.	FAO device	Cannot be used with other controls options that need the 0-10V leads
DS	Drivers wired independently for 50/50 luminaire operation	The luminaire is wired to two separate circuits, allowing for 50/50 operation.	Independently wired drivers	Requires two separately switched circuits. Consider nLight AIR as a more cost effective alternative.
PERS or PER7	Twist-lock photocell receptacle	Compatible with standard twist-lock photocells for dusk to dawn operation, or advanced control nodes that provide 0-10V dimming signals.	Twist-lock photocells such as DLL Elite or advanced control nodes such as ROAM.	Pins 4 & 5 to dimming leads on driver, Pins 6 & 7 are capped inside luminaire
PIR or PIRH	Motion sensors with integral photocell. PIR for 8-15' mounting; PIRH for 15-30' mounting	Luminaires dim when no occupancy is detected.	Acuity Controls SBGR	Also available with PIRH1FC3V when the sensor photocell is used for dusk-to-dawn operation.
NLTAIR2 PIRHN	nLight AIR enabled luminaire for motion sensing, photocell and wireless communication.	Motion and ambient light sensing with group response. Scheduled dimming with motion sensor over-ride when wirelessly connected to the nLight Eclipse.	nLight Air rSDGR	nLight AIR sensors can be programmed and commissioned from the ground using the CIAIRity Pro app.



THINTEK™ WAFER S

Direct Mount Recessed

DESCRIPTION

The ThinTek™ Wafer series from TGS allows for easy installation from below the ceiling without the need for an existing can and is ideal for shallow ceiling plenum applications. The CCT switch allows for selection between 2700K, 3000K, 3500K, 4000K, and 5000K. With Title 24 certification, 90 CRI, and a variety of sizes and lumen packages, ThinTek™ Wafers provide versatility, reliable performance, and a fast, simple installation process.

APPLICATIONS

Residential, Institution, Hospitality, Retail, Offices, Schools, Basement remodels, Kitchens and Hallways.

FEATURES

Construction

Die-cast aluminum housing and PC lens.
Air-tight IC Rated.

Optical System

Glare controlling lens for comfortable light distribution.
Provides a 110° beam angle.

Warranty

5 year warranty.
See warranty documentation for more information.

Electrical

Input voltage: 120~347VAC, 60Hz
16W or 25W High Voltage Emergency Battery Backup option available.
12" Power Cable (Standard): Extension Cable option available in 3' or 10'.

Installation/ Mounting

Recessed Mounting with adjustable spring loaded retention tabs for secure fixture.

Controls/Dimming

0-10V Dimming (Dims to 10%)
Tunable White between 2700K, 3000K, 3500K 4000K, 5000K.



120~347VAC/0-10V Dimming

ThinTek™ Wafer S

3", 8W (500 lm)
4", 10W (650 lm)
4", 12W (850 lm)
6", 12W (900 lm)
6", 15W (1100 lm)
8", 18W (1500 lm)

Projected L70: 50,000+ hours
Warranty: 5 Years
0-10V Dimming (10%)

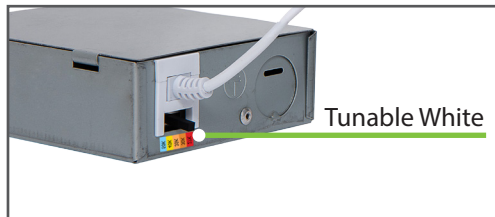
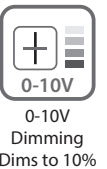

Ordering Information

EXAMPLE: TWSF-0308-C-U

Series	Size/Wattage	CCT Switchable	Input Voltage/Control
TWSF - ThinTek Wafer Square Flat	0308 - 3"/8W 0410 - 4"/10W 0412 - 4"/12W 0612 - 6"/12W 0615 - 6"/15W 0818 - 8"/18W	C - 2700K/3000K/3500K/4000K/5000K	U - 120~347VAC/ 0-10VDimming
Accessories			

TW-EC03 (3' Extension Cable)
TW-EC10 (10' Extension Cable)
90016-H (16W High Voltage Emergency Battery Backup)
90025-H (25W High Voltage Emergency Battery Backup)

Specifications and Dimensions subject to change without notice.

*MOQ and longer lead times may apply, please contact customer service for more information.

Accessories options are purchased separately.

Performance Information

Input Voltage	120~347VAC
Input Frequency	60Hz
Wattage	See Performance Table
Delivered Lumens	See Performance Table
Efficacy	See Performance Table
CRI	>90
Available CCT	2700K, 3000K, 3500K, 4000K, 5000K
Projected L70	50,000+ hours
Power Factor	>0.9
THD	<20%
Dimming	0-10V Dimming (Dims To 10%)
Operating Temp.	32°~104°F

Photometric Data

6" 15W

* IESNA LM-63 IES Available

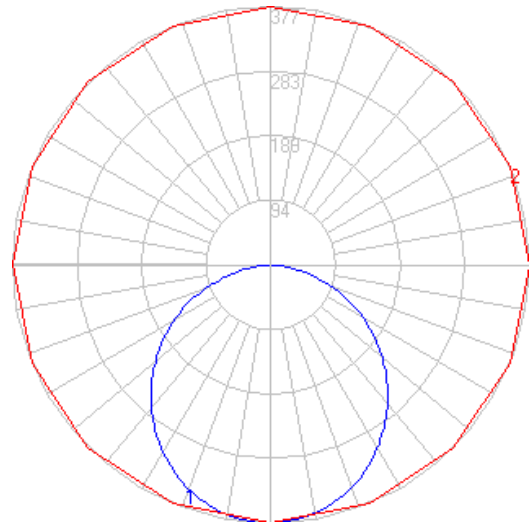

Performance Table

SKU	Size (in)	Wattage (W)	5000K	
			Delivered Lumens (lm)	Efficacy (lm/W)
TWSF-0308-C-U	3	8	500	63
TWSF-0410-C-U	4	10	650	65
TWSF-0412-C-U	4	12	850	71
TWSF-0612-C-U	6	12	900	75
TWSF-0615-C-U	6	15	1100	73
TWSF-0818-C-U	8	18	1500	83

Product Dimensions

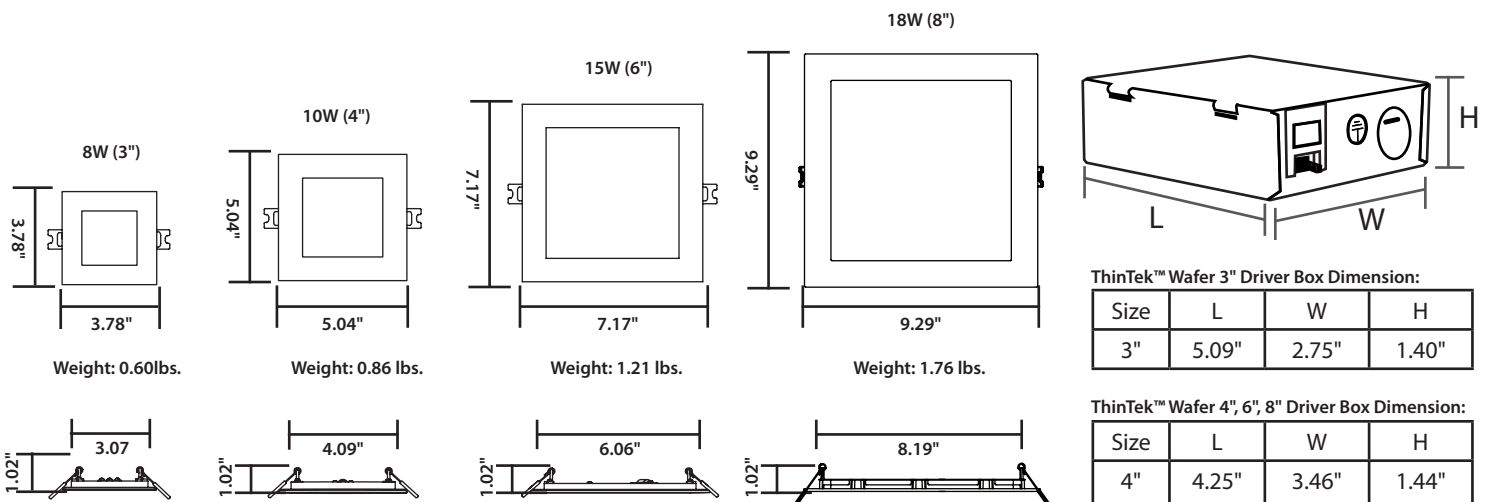

Schedule										
Symbol	Label	Quantity	Manufacturer	Catalog Number	Description	Lamp	Filename	Lumens Per Lamp	Light Loss Factor	Wattage
	SA	1	Lithonia Lighting	DSX0 LED P4 30K 80CRI T4M MVOLT SPA (FINISH) / SSS 12.5' W/2.5' BASE	D-Series Size 0 Area Luminaire P4 Performance Package 3000K CCT 80 CRI Type 4 Medium	LED - 3000K	DSX0_LED_P4_30K_80CRI_T4M.ies	9840	0.91	93.04
	SB	2	Lithonia Lighting	DSX0 LED P4 30K 80CRI T2M MVOLT SPA (FINISH) / SSS 12.5' W/2.5' BASE	D-Series Size 0 Area Luminaire P4 Performance Package 3000K CCT 80 CRI Type 2 Medium	LED - 3000K	DSX0_LED_P4_30K_80CRI_T2M.ies	9584	0.91	93.04
	SD	24	TGS	TWSF 0818 C(3000K) S 90025-H	THINTEK WAFER S	LED - 3000K	TWSF-0818-C-U (2700K)_IESNA 2002.IES	1427	0.91	17.5
	SDE	1	TGS	TWSF 0818 C(3000K) S 90025-H	THINTEK WAFER S W/EM BATTERY PACK	LED - 3000K	TWSF-0818-C-U (2700K)_IESNA 2002.IES	1427	0.91	17.5

Statistics						
Description	Symbol	Avg	Max	Min	Max/Min	Avg/Min
SITE - FC @ GRADE	+	2.9 fc	9.7 fc	0.2 fc	48.5:1	14.5:1
PROPERTY LINE - FC @ 3' AFG	✱	0.0 fc	0.1 fc	0.0 fc	N/A	N/A



2233 W. WASHINGTON ST.
AVONDALE, AZ 85323
TEL. (602) 326-5104
FAX (602) 606-7922
fsterm08@gmail.com

THIS DRAWING IS AN INSTRUMENT OF SERVICE
AND AS SUCH SHALL REMAIN THE PROPERTY
OF FRED STERN ARCHITECT. UNAUTHORIZED
USE OR REPRODUCTION WITHOUT PERMISSION OF
THE ARCHITECT IS PROHIBITED. THIS DRAWING
IS ONLY FOR USE IN CONNECTION WITH THIS PROJECT
AND SHALL NOT BE USED FOR OTHER LOCATIONS.

BUILDING ADDITION

2121 S. POWER ROAD
MESA, AZ 85209

◆ REVISIONS ◆

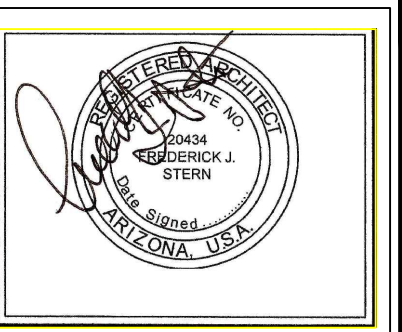

◆ FEB 2023 ◆
JOB NO.: 2206
A400

SITE PHOTOMETRICS

1"=20'-0"