

Plant list is an aid to bidders only. Contractor shall verify all quantities on plan. All heights and spreads are minimums. Trees shall have a strong central leader and be of matching specimens. All plant material shall meet or exceed remarks as indicated.



SECTION 32 9900 - LANDSCAPE
PART 1 - GENERAL

1.1 QUALIFICATIONS OF THE LANDSCAPE CONTRACTOR

- A. ALL LANDSCAPE WORK SHOWN ON THESE PLANS SHALL BE PERFORMED BY A SINGLE FIRM SPECIALIZING IN LANDSCAPE PLANTING

1.2 REFERENCE DOCUMENTS

- A. REFER TO LANDSCAPE PLANS, NOTES, SCHEDULES AND DETAILS FOR ADDITIONAL REQUIREMENTS

1.3 SCOPE OF WORK / DESCRIPTION OF WORK

- A. WORK COVERED BY THESE SECTIONS INCLUDES: FURNISH ALL SUPERVISIONS, LABOR, MATERIALS, SERVICES, EQUIPMENT AND APPLIANCES REQUIRED TO COMPLETE THE WORK COVERED IN CONJUNCTION WITH THE LANDSCAPING COVERED IN LANDSCAPE PLANS AND SPECIFICATIONS INCLUDING:

1. PLANTING (TREES, SHRUBS, GRASSES)
2. BED PREP AND FERTILIZATION
3. NOTIFICATION OF SOURCES
4. WATER AND MAINTENANCE UNTIL ACCEPTANCE
5. GUARANTEE

- B. ALL WORK SHALL BE PERFORMED IN ACCORDANCE WITH ALL APPLICABLE LAWS, CODES AND REGULATIONS REQUIRED BY AUTHORITIES HAVING JURISDICTION OVER SUCH WORK, INCLUDING ALL INSPECTIONS AND PERMITS REQUIRED BY FEDERAL, STATE AND LOCAL AUTHORITIES IN SUPPLY, TRANSPORTATION AND INSTALLATION OF MATERIALS.

- C. THE LANDSCAPE CONTRACTOR SHALL VERIFY THE LOCATION OF ALL UNDERGROUND UTILITY LINES (WATER, SEWER, ELECTRICAL, TELEPHONE, GAS, CABLE, TELEVISION, ETC.) PRIOR TO THE START OF ANY WORK

1.4 REFERENCES

- A. AMERICAN STANDARD FOR NURSERY STOCK PUBLISHED BY AMERICAN ASSOCIATION OF NURSERYMEN, 27 OCTOBER 1980, EDITION, BY AMERICAN NATIONAL STANDARDS INSTITUTE (290.1), PLANT MATERIAL
B. AMERICAN JOINT COMMITTEE ON HORTICULTURE NOMENCLATURE, 1942 EDITION OF STANDARDIZED PLANT NAMES
C. TEXAS ASSOCIATION OF NURSERYMEN, GRADES AND STANDARDS

1.5 SUBMITTALS

- A. PROVIDE REPRESENTATIVE QUANTITIES OF EACH SOIL, MULCH, BED MIX, GRAVEL AND STONE BEFORE INSTALLATION. SAMPLES TO BE APPROVED BY OWNER'S REPRESENTATIVE BEFORE USE
B. SOIL AMENDMENTS AND FERTILIZERS SHOULD BE RESEARCHED AND BASED ON THE SOILS IN THE AREA
C. BEFORE INSTALLATION, SUBMIT DOCUMENTATION THAT PLANT MATERIALS ARE AVAILABLE AND HAVE BEEN RESERVED FOR ANY PLANT MATERIAL NOT AVAILABLE, SUBMIT REQUEST FOR SUBSTITUTION

1.6 JOB CONDITIONS, DELIVERY, STORAGE AND HANDLING

- A. GENERAL CONTRACTOR TO COMPLETE WORK BEFORE LANDSCAPE CONTRACTOR TO COMMENCE
B. ALL PLANTING BED AREAS SHALL BE LEFT THREE INCHES BELOW FINAL GRADE OF SIDEWALKS, DRIVES AND CURBS. ALL AREAS TO RECEIVE SOLID SOD SHALL BE LEFT ONE INCH BELOW THE FINAL GRADE OF WALKS, DRIVES AND CURBS. CONSTRUCTION DEBRIS SHALL BE REMOVED PRIOR TO LANDSCAPE CONTRACTOR BEGINNING WORK
C. STORAGE OF MATERIALS AND EQUIPMENT AT THE JOB SITE WILL BE AT THE RISK OF THE LANDSCAPE CONTRACTOR. THE OWNER CANNOT BE HELD RESPONSIBLE FOR THEFT OR DAMAGE

1.7 SEQUENCING

- A. INSTALL TREES, SHRUBS, AND LINER STOCK PLANT MATERIALS PRIOR TO INSTALLATION OF LAWN/SOLID SOD
B. WHERE EXISTING TURF AREAS ARE BEING CONVERTED TO PLANTING BEDS, THE TURF SHALL BE CHEMICALLY ERADICATED TO MINIMIZE RE-GROWTH IN THE FUTURE. AREAS SHALL BE PROPERLY PREPARED WITH AMENDED ORGANIC MATTER

1.8 MAINTENANCE AND GUARANTEE

MAINTENANCE:

- A. THE LANDSCAPE CONTRACTOR SHALL BE HELD RESPONSIBLE FOR THE MAINTENANCE OF ALL WORK FROM THE TIME OF PLANTING UNTIL FINAL ACCEPTANCE BY OWNER
B. NO TREES, GRASS, GROUND COVER OR GRASS WILL BE ACCEPTED UNLESS THEY SHOW HEALTHY GROWTH AND SATISFACTORY FOLIAGE CONDITIONS
C. MAINTENANCE SHALL INCLUDE WATERING OF TREES AND PLANTS, CULTIVATION, WEED SPRAYING, EDGING, PRUNING OF TREES, MOWING OF GRASS, CLEANING UP AND ALL OTHER WORK NECESSARY FOR MAINTENANCE
D. A WRITTEN NOTICE REQUESTING FINAL INSPECTION AND ACCEPTANCE

SHOULD BE SUBMITTED TO THE OWNER AT LEAST 7 DAYS PRIOR TO COMPLETION, AN ON SITE INSPECTION BY THE OWNER'S AUTHORIZED REPRESENTATIVE WILL BE COMPLETED PRIOR TO WRITTEN ACCEPTANCE

- E. NOTIFY OWNER OR OWNER'S REPRESENTATIVE SEVEN DAYS PRIOR TO THE EXPIRATION OF THE WARRANTY PERIOD
F. REMOVE DEAD, UNHEALTHY AND UNSIGHTLY PLANTS DURING WARRANTY PERIOD
G. REMOVE GUYING AND STAKING MATERIALS AFTER ONE YEAR
H. ALL LANDSCAPE MUST BE MAINTAINED AND GRASS MOWED/EDGED ON A WEEKLY SCHEDULE UNTIL ACCEPTANCE BY OWNER. REMOVE CLIPPINGS AND DEBRIS FROM SITE PROMPTLY
I. REMOVE TRASH, DEBRIS, AND LITTER, WATER, PRUNE, RESTAKE TREES, FERTILIZE, WEED AND APPLY HERBICIDES AND FUNGICIDES AS REQUIRED
J. COORDINATE THE OPERATION OF IRRIGATION SYSTEM TO ENSURE THAT PLANTS ARE ADEQUATELY WATERED. HAND WATER AREAS NOT RECEIVING ADEQUATE WATER FROM AN IRRIGATION SYSTEM
K. THE LANDSCAPE CONTRACTOR SHALL MAINTAIN THE IRRIGATION SYSTEM IN TOP SOIL OR SITE USE IMPORTED TOPSOIL AS NEEDED FREE FROM LARGE CLUMPS, ROCKS, DEBRIS, CALCICHE, SUBSOILS, ETC., PLACED IN NINE (9") INCH LAYERS AND WATERED IN THOROUGHLY
L. REAPPLY MULCH TO BARE BEDS AND THIN AREAS
M. SHOULD SEEDING AND/OR SODDED AREAS NOT BE COVERED BY AN AUTOMATIC IRRIGATION SYSTEM, THE LANDSCAPE CONTRACTOR SHALL BE RESPONSIBLE FOR WATERING THESE AREAS AND OBTAINING A FULL, HEALTHY STAND OF GRASS AT NO ADDITIONAL COST TO THE OWNER
N. TO ACHIEVE FINAL ACCEPTANCE AT THE END OF THE MAINTENANCE PERIOD, ALL OF THE FOLLOWING CONDITIONS MUST OCCUR:
1. THE LANDSCAPE SHALL SHOW ACTIVE, HEALTHY GROWTH (WITH EXCEPTIONS MADE FOR SEASONAL DORMANCY). ALL PLANTS NOT MEETING THIS CONDITION SHALL BE REJECTED AND REPLACED BY HEALTHY PLANT MATERIALS
2. ALL HARDSCAPE SHALL BE CLEANED PRIOR TO FINAL ACCEPTANCE
3. SODDED AREAS MUST BE ACTIVELY GROWING AND MUST REACH A MINIMUM HEIGHT OF 1 1/2 INCHES BEFORE FIRST MOWING. HYDROMULCHED AREAS SHALL SHOW ACTIVE, HEALTHY GROWTH. BARE AREAS LARGER THAN TWELVE SQUARE INCHES MUST BE RESODDED OR RESEED (AS APPROPRIATE) PRIOR TO FINAL ACCEPTANCE. ALL SODDED TURF SHALL BE NEATLY MOWED

- A. TREES, SHRUBS, GROUND COVER SHALL BE GUARANTEED (IN WRITING) FOR A 12 MONTH PERIOD (90 DAYS) FROM ANNUAL PLANTING AT THE END OF THE SEASONAL COLOR GROWING SEASON, WHICHEVER COMES SOONER) AFTER FINAL ACCEPTANCE. THE CONTRACTOR SHALL REPLACE ALL DEAD MATERIALS AS SOON AS WEATHER PERMITS AND UPON NOTIFICATION OF THE OWNER
B. PLANTS INCLUDING TREES, WHICH HAVE PARTIALLY DIED SO THAT SHAPE, SIZE OR SYMMETRY HAVE BEEN DAMAGED SHALL BE CONSIDERED SUBJECT TO REPLACEMENT. IN SUCH CASES, THE OPINION OF THE OWNER SHALL BE FINAL
C. PLANTS USED FOR REPLACEMENT SHALL BE OF THE SAME SIZE AND KIND AS THOSE ORIGINALLY PLANTED OR SPECIFIED. ALL WORK INCLUDING MATERIALS, LABOR AND EQUIPMENT USED IN REPLACEMENTS SHALL CARRY A 12 MONTH GUARANTEE. ANY DAMAGE INCLUDING RUTS IN LAWN OR BED AREAS INCURRED AS A RESULT OF MAKING REPLACEMENTS SHALL BE IMMEDIATELY REPAIRED
D. WHEN PLANT REPLACEMENTS ARE MADE, PLANTS, SOIL MIX, FERTILIZER AND MULCH ARE TO BE UTILIZED AS ORIGINALLY SPECIFIED AND REINSPECTED FOR FULL COMPLIANCE WITH THE CONTRACT REQUIREMENTS. ALL REPLACEMENTS ARE INCLUDED UNDER "WORK OF THIS SECTION"
E. THE OWNER AGREES THAT FOR THE ONE YEAR WARRANTY PERIOD TO BE EFFECTIVE, HE WILL WATER PLANTS AT LEAST TWICE A WEEK DURING DRY PERIODS
F. THE ABOVE GUARANTEE SHALL NOT APPLY WHERE PLANTS DIE AFTER ACCEPTANCE BECAUSE OF DAMAGE DUE TO ACTS OF GOD, VANDALISM, INSECTS, DISEASE, INJURY BY HUMANS, MACHINES, THEFT OR NEGLIGENCE BY OWNER
G. ACCEPTANCE FOR ALL LANDSCAPE WORK SHALL BE GIVEN AFTER FINAL INSPECTION BY THE OWNER PROVIDED THE JOB IS IN A COMPLETE, UNDAMAGED CONDITION AND THERE IS A STAND OF GRASS IN ALL LAWN AREAS. AT THAT TIME, THE OWNER WILL ASSUME MAINTENANCE ON THE ACCEPTED WORK

GUARANTEE:

- A. TREES, SHRUBS, GROUND COVER SHALL BE GUARANTEED (IN WRITING) FOR A 12 MONTH PERIOD (90 DAYS) FROM ANNUAL PLANTING AT THE END OF THE SEASONAL COLOR GROWING SEASON, WHICHEVER COMES SOONER) AFTER FINAL ACCEPTANCE. THE CONTRACTOR SHALL REPLACE ALL DEAD MATERIALS AS SOON AS WEATHER PERMITS AND UPON NOTIFICATION OF THE OWNER
B. PLANTS INCLUDING TREES, WHICH HAVE PARTIALLY DIED SO THAT SHAPE, SIZE OR SYMMETRY HAVE BEEN DAMAGED SHALL BE CONSIDERED SUBJECT TO REPLACEMENT. IN SUCH CASES, THE OPINION OF THE OWNER SHALL BE FINAL
C. PLANTS USED FOR REPLACEMENT SHALL BE OF THE SAME SIZE AND KIND AS THOSE ORIGINALLY PLANTED OR SPECIFIED. ALL WORK INCLUDING MATERIALS, LABOR AND EQUIPMENT USED IN REPLACEMENTS SHALL CARRY A 12 MONTH GUARANTEE. ANY DAMAGE INCLUDING RUTS IN LAWN OR BED AREAS INCURRED AS A RESULT OF MAKING REPLACEMENTS SHALL BE IMMEDIATELY REPAIRED
D. WHEN PLANT REPLACEMENTS ARE MADE, PLANTS, SOIL MIX, FERTILIZER AND MULCH ARE TO BE UTILIZED AS ORIGINALLY SPECIFIED AND REINSPECTED FOR FULL COMPLIANCE WITH THE CONTRACT REQUIREMENTS. ALL REPLACEMENTS ARE INCLUDED UNDER "WORK OF THIS SECTION"
E. THE OWNER AGREES THAT FOR THE ONE YEAR WARRANTY PERIOD TO BE EFFECTIVE, HE WILL WATER PLANTS AT LEAST TWICE A WEEK DURING DRY PERIODS
F. THE ABOVE GUARANTEE SHALL NOT APPLY WHERE PLANTS DIE AFTER ACCEPTANCE BECAUSE OF DAMAGE DUE TO ACTS OF GOD, VANDALISM, INSECTS, DISEASE, INJURY BY HUMANS, MACHINES, THEFT OR NEGLIGENCE BY OWNER
G. ACCEPTANCE FOR ALL LANDSCAPE WORK SHALL BE GIVEN AFTER FINAL INSPECTION BY THE OWNER PROVIDED THE JOB IS IN A COMPLETE, UNDAMAGED CONDITION AND THERE IS A STAND OF GRASS IN ALL LAWN AREAS. AT THAT TIME, THE OWNER WILL ASSUME MAINTENANCE ON THE ACCEPTED WORK

1.9 QUALITY ASSURANCE

- A. COMPLY WITH ALL FEDERAL, STATE, COUNTY AND LOCAL REGULATIONS GOVERNING LANDSCAPE MATERIALS AND WORK
B. EMPLOY PERSONNEL EXPERIENCED AND FAMILAR WITH THE REQUIRED WORK AND SUPERVISION BY A FOREMAN
C. MAKE CONTACT WITH SUPPLIERS IMMEDIATELY UPON OBTAINING NOTICE OF CONTRACT ACCEPTANCE TO SELECT AND BOOK MATERIALS

- D. DEVELOP A PROGRAM OF MAINTENANCE (PRUNING AND FERTILIZATION) WHICH WILL ENSURE THE PURCHASED MATERIALS WILL MEET AND/OR EXCEED PROJECT SPECIFICATIONS
E. DO NOT MAKE PLANT MATERIAL SUBSTITUTIONS. IF THE LANDSCAPE MATERIAL SPECIFIED IS NOT READILY AVAILABLE, SUBMIT PROOF TO LANDSCAPE ARCHITECT ALONG WITH THE PROPOSED MATERIAL TO BE USED IN LIEU OF THE SPECIFIED PLANT
F. AT THE TIME BIDS ARE SUBMITTED, THE CONTRACTOR IS ASSUMED TO HAVE LOCATED THE MATERIALS NECESSARY TO COMPLETE THE JOB AS SPECIFIED
G. OWNERS REPRESENTATIVE SHALL INSPECT ALL PLANT MATERIAL AND RETAINS THE RIGHT TO INSPECT MATERIALS UPON ARRIVAL TO THE SITE AND DURING INSTALLATION. THE OWNERS REPRESENTATIVE MAY ALSO REJECT ANY MATERIALS HE/SHE FEELS TO BE UNSATISFACTORY OR DEFECTIVE DURING THE WORK PROCESS. ALL PLANTS DAMAGED IN TRANSIT OR AT THE JOB SITE SHALL BE REJECTED
H. THE LANDSCAPE CONTRACTOR SHALL MAINTAIN THE IRRIGATION SYSTEM IN TOP SOIL OR SITE USE IMPORTED TOPSOIL AS NEEDED FREE FROM LARGE CLUMPS, ROCKS, DEBRIS, CALCICHE, SUBSOILS, ETC., PLACED IN NINE (9") INCH LAYERS AND WATERED IN THOROUGHLY

1.10 PRODUCT DELIVERY, STORAGE AND HANDLING

- A. PREPARATION
1. BALLED AND BURLAPPED BAB PLANTS: DIG AND PREPARE SHIPMENT IN A MANNER THAT WILL NOT DAMAGE ROOTS, BRANCHES, SHAPE AND FUTURE DEVELOPMENT
2. CONTAINER GROWN PLANTS: DELIVER PLANTS IN RIGID CONTAINER TO HOLD BALL SHAPE AND PROTECT ROOT MASS
B. DELIVERY
1. DELIVER PACKAGED MATERIALS IN SEALED CONTAINERS SHOWING WEIGHT, ANALYSIS AND NAME OF MANUFACTURER. PROTECT MATERIALS FROM DETERIORATION DURING DELIVERY AND WHILE STORED ON SITE
2. DELIVER ONLY PLANT MATERIALS THAT CAN BE PLANTED IN ONE DAY UNLESS ADEQUATE STORAGE AND WATERING FACILITIES ARE AVAILABLE ON SITE
3. PROTECT ROOT BALLS BY HEELING IN WITH SAWDUST OR OTHER APPROVED MOISTURE RETAINING MATERIAL IF NOT PLANTED WITHIN 24 HOURS OF DELIVERY
4. PROTECT PLANTS DURING DELIVERY TO PREVENT DAMAGE TO ROOT BALL OR DESICCATION OF LEAVES
5. KEEP PLANTS MOIST AT ALL TIMES. COVER ALL MATERIALS DURING TRANSPORT
6. NOTIFY OWNERS REPRESENTATIVE OF DELIVERY 72 HOURS PRIOR TO DELIVERY OF PLANT MATERIAL AT JOB SITE
7. REMOVE REJECTED PLANT MATERIAL IMMEDIATELY FROM JOB SITE
8. TO AVOID DAMAGE OR STRESS, DO NOT LIFT, MOVE, ADJUST TO PLUMB, OR OTHERWISE MANIPULATE PLANTS BY TRUNK OR STEMS

2.1 PLANT MATERIALS

- A. GENERAL: WELL FORMED NO. 1 GRADE OR BETTER NURSERY GROWN STOCK. LISTED PLANT HEIGHTS ARE FROM TOPS OF ROOT BALLS TO NOMINAL TOPS OF PLANTS. PLANT SPREAD REFERS TO NOMINAL OUTSIDE OF THE PLANT NOT THE OUTER LEAF TIPS. PLANTS SHALL BE INDIVIDUALLY APPROVED BY THE OWNERS REPRESENTATIVE AND THEIR DECISION AS TO THEIR ACCEPTABILITY SHALL BE FINAL
B. QUANTITIES: THE DRAWINGS AND SPECIFICATIONS ARE COMPLEMENTARY. ANYTHING CALLED FOR ON ONE AND NOT THE OTHER IS AS BINDING AS IF SHOWN AND CALLED FOR ON BOTH. THE PLANT SCHEDULE IS AN AID TO BIDDERS ONLY. CONFIRM ALL QUANTITIES ON PLAN
C. QUANTITIES AND SIZE: PLANT MATERIALS SHALL CONFORM TO THE SIZE GIVEN ON THE PLAN AND SHALL BE HEALTHY, WELL SHAPED, FULL BRANCHED AND WELL ROOTED. SYMMETRY IS ALSO IMPERATIVE. PLANTS SHALL BE FREE FROM INSECTS, INJURY, DISHIE, BROKEN BRANCHES, DISFIGUREMENTS, INSECT EGGS AND ARE TO BE OF SPECIFIC QUALITY
D. APPROVAL: ALL PLANTS WHICH ARE FOUND UNSUITABLE IN GROWTH OR ARE UNHEALTHY, BADLY SHAPED OR UNDERIZED WILL BE REJECTED BY THE OWNERS REPRESENTATIVE EITHER BEFORE OR AFTER PLANTING AND SHALL BE REMOVED AT THE EXPENSE OF THE LANDSCAPE CONTRACTOR AND REPLACED WITH ACCEPTABLE SPECIMENS
E. TREES SHALL BE HEALTHY, FULL BRANCHED, WELL SHAPED AND SHALL MEET THE MINIMUM REQUIREMENTS AS SPECIFIED ON THE PLANT SCHEDULE. ALL TREES SHALL BE OBTAINED FROM SOURCES WITHIN 200 MILES OF THE PROJECT SITE IF POSSIBLE, AND WITH SIMILAR CLIMATIC CONDITIONS
F. PRUNING: ALL PRUNING OF TREES AND SHRUBS SHALL BE EXECUTED BY THE LANDSCAPE CONTRACTOR AT NO ADDITIONAL COST TO THE OWNER, PRIOR TO FINAL ACCEPTANCE
G. PLANTS SHALL CONFORM TO THE MEASUREMENTS SPECIFIED, EXCEPT THE PLANTS LARGER THAN THOSE SPECIFIED MAY BE USED, USE OF LARGER PLANTS SHALL NOT INCREASE THE CONTRACT PRICE
H. WHERE MATERIALS ARE PLANTED IN MASSES, PROVIDE PLANTS OF UNIFORM SIZE
I. ROOT SYSTEMS SHALL BE HEALTHY, DENSELY BRANCHED, FIBROUS ROOT SYSTEMS, NON-POT-BOUND, FREE FROM ENCIRCLING AND/OR GIRDLING

2.2 PLANT MATERIALS

- A. GENERAL: WELL FORMED NO. 1 GRADE OR BETTER NURSERY GROWN STOCK. LISTED PLANT HEIGHTS ARE FROM TOPS OF ROOT BALLS TO NOMINAL TOPS OF PLANTS. PLANT SPREAD REFERS TO NOMINAL OUTSIDE OF THE PLANT NOT THE OUTER LEAF TIPS. PLANTS SHALL BE INDIVIDUALLY APPROVED BY THE OWNERS REPRESENTATIVE AND THEIR DECISION AS TO THEIR ACCEPTABILITY SHALL BE FINAL
B. QUANTITIES: THE DRAWINGS AND SPECIFICATIONS ARE COMPLEMENTARY. ANYTHING CALLED FOR ON ONE AND NOT THE OTHER IS AS BINDING AS IF SHOWN AND CALLED FOR ON BOTH. THE PLANT SCHEDULE IS AN AID TO BIDDERS ONLY. CONFIRM ALL QUANTITIES ON PLAN
C. QUANTITIES AND SIZE: PLANT MATERIALS SHALL CONFORM TO THE SIZE GIVEN ON THE PLAN AND SHALL BE HEALTHY, WELL SHAPED, FULL BRANCHED AND WELL ROOTED. SYMMETRY IS ALSO IMPERATIVE. PLANTS SHALL BE FREE FROM INSECTS, INJURY, DISHIE, BROKEN BRANCHES, DISFIGUREMENTS, INSECT EGGS AND ARE TO BE OF SPECIFIC QUALITY
D. APPROVAL: ALL PLANTS WHICH ARE FOUND UNSUITABLE IN GROWTH OR ARE UNHEALTHY, BADLY SHAPED OR UNDERIZED WILL BE REJECTED BY THE OWNERS REPRESENTATIVE EITHER BEFORE OR AFTER PLANTING AND SHALL BE REMOVED AT THE EXPENSE OF THE LANDSCAPE CONTRACTOR AND REPLACED WITH ACCEPTABLE SPECIMENS
E. TREES SHALL BE HEALTHY, FULL BRANCHED, WELL SHAPED AND SHALL MEET THE MINIMUM REQUIREMENTS AS SPECIFIED ON THE PLANT SCHEDULE. ALL TREES SHALL BE OBTAINED FROM SOURCES WITHIN 200 MILES OF THE PROJECT SITE IF POSSIBLE, AND WITH SIMILAR CLIMATIC CONDITIONS
F. PRUNING: ALL PRUNING OF TREES AND SHRUBS SHALL BE EXECUTED BY THE LANDSCAPE CONTRACTOR AT NO ADDITIONAL COST TO THE OWNER, PRIOR TO FINAL ACCEPTANCE
G. PLANTS SHALL CONFORM TO THE MEASUREMENTS SPECIFIED, EXCEPT THE PLANTS LARGER THAN THOSE SPECIFIED MAY BE USED, USE OF LARGER PLANTS SHALL NOT INCREASE THE CONTRACT PRICE
H. WHERE MATERIALS ARE PLANTED IN MASSES, PROVIDE PLANTS OF UNIFORM SIZE
I. ROOT SYSTEMS SHALL BE HEALTHY, DENSELY BRANCHED, FIBROUS ROOT SYSTEMS, NON-POT-BOUND, FREE FROM ENCIRCLING AND/OR GIRDLING

2.3 MISCELLANEOUS MATERIALS

- A. STEEL EDGING - SHALL BE 3/16" X 4" X 16" DARK GREEN LANDSCAPE EDGING, DURAEDGE STEEL OR APPROVED EQUAL
B. TREE STAKING - TREE STAKING SOLUTIONS OR APPROVED SUBSTITUTE; REFER TO DETAILS
C. FILTER FABRIC - MIRAFI 1405 BY MIRAFI INC. OR APPROVED SUBSTITUTE, AVAILABLE AT LONE STAR PRODUCTS, INC. (409-828-0414)
D. SAND - UNIFORMLY GRADED, WASHED, CLEAN, BANK RUN SAND
E. GRAVEL - WASHED NATIVE PEA GRAVEL, GRADED 1" TO 1.5"
F. DECOMPOSED GRANITE - BASE MATERIAL OF NATURAL MATERIAL MIX OF GRANITE AGGREGATE NOT TO EXCEED 1/8" IN DIAMETER COMPOSED OF VARIOUS STAGES OF DECOMPOSED EARTH BASE
G. RIVER ROCK - LOCALLY AVAILABLE NATIVE RIVER ROCK BETWEEN 2"-4" IN DIAMETER
H. PRE-EMERGENT HERBICIDES: ANY GRANULAR, NON-STAINING

ROOTS, AND FREE FROM ANY OTHER ROOT DEFECTS (SUCH AS J-SHAPED ROOTS)
J. ALL TREES SHALL BE STANDARD IN FORM, UNLESS OTHERWISE SPECIFIED. TREES WITH CENTRAL LEADERS WILL NOT BE ACCEPTED IF LEADER IS DAMAGED OR REMOVED. PRUNE ALL DAMAGED TWIGS AFTER PLANTING
K. TREE TRUNKS TO BE STURDY, EXHIBIT HARDENED SYSTEMS AND VIGOROUS AND FIBROUS ROOT SYSTEMS, NOT ROOT OR POT BOUND
L. TREES WITH DAMAGED OR CROOKED LEADERS, BARK ABRASIONS, SUNSCALD, DISFIGURING KNOTS, OR INSECT DAMAGE WILL BE REJECTED
M. CALIPER MEASUREMENTS FOR STANDARD SINGLE TRUNK TREES SHALL BE AS FOLLOWS: SIX INCHES ABOVE THE ROOT FLARE FOR TREES UP TO AND INCLUDING FOUR INCHES IN CALIPER, AND TWELVE INCHES ABOVE THE ROOT FLARE FOR TREES EXCEEDING FOUR INCHES IN CALIPER
N. MULTITRUNK TREES SHALL BE MEASURED BY THEIR OVERALL HEIGHT, MEASURED FROM THE TOP OF THE ROOT BALL
O. ANY TREE OR SHRUB SHOWN TO HAVE EXCESS SOIL PLACED ON TOP OF THE ROOT BALL, SO THAT THE ROOT FLARE HAS BEEN COMPLETELY COVERED, SHALL BE REJECTED
P. SOD: PROVIDE WELL-ROOTED SOD OF THE VARIETY NOTED ON THE PLANS. SOD SHALL BE CUT FROM HEALTHY, MATURE TURF WITH SOIL THICKNESS OF 3/4" TO 1". EACH PALLET OF SOD SHALL BE ACCOMPANIED BY A CERTIFICATE FROM SUPPLIER STATING THE COMPOSITION OF THE SOD

1. FRABLE, FERTILE, DARK, LOAMY SOIL, FREE OF CLAY LUMPS, SUBSOIL, STONES AND OTHER EXTRANEOUS MATERIAL AND REASONABLY FREE OF WEEDS AND FOREIGN GRASSES. LOAM CONTAINING DALLASGRASS OR NUTGRASS SHALL BE REJECTED
2. PHYSICAL PROPERTIES AS FOLLOWS:
a. CLAY - BETWEEN 7-27%
b. SILT - BETWEEN 15-25%
c. SAND - LESS THAN 52%
3. ORGANIC MATTER SHALL BE 3%-10% OF TOTAL DRY WEIGHT
4. IF REQUESTED, LANDSCAPE CONTRACTOR SHALL PROVIDE A CERTIFIED SOIL ANALYSIS CONDUCTED BY AN APPROVED SOIL TESTING LABORATORY VERIFYING THAT SANDY LOAM MEETS THE ABOVE REQUIREMENTS
B. ORGANIC MATERIAL: COMPOST WITH A MIXTURE OF 80% VEGETATIVE MATTER AND 20% ANIMAL WASTE. INGREDIENTS SHOULD BE A MIX OF COURSE AND FINE TEXTURED MATERIAL
C. PREMIXED BEDDING SOIL AS SUPPLIED BY VITAL EARTH RESOURCES, GLADEWATER, TEXAS. PROFESSIONAL BEDDING SOIL AS SUPPLIED BY LIVING EARTH TECHNOLOGY, DALLAS, TEXAS OR ACID GRO MUNICIPAL MIX AS SUPPLIED BY SOIL BUILDING SYSTEMS, DALLAS, TEXAS OR APPROVED EQUAL
D. SHARP SAND: SHARP SAND MUST BE FREE OF SEEDS, SOIL PARTICLES AND WEEDS
E. MULCH: DOUBLE SHREDDED HARDWOOD MULCH, PARTIALLY DECOMPOSED, DARK BROWN
F. ORGANIC FERTILIZER: FERTILAD, SUBTANE, OR GREEN SENSE OR EQUAL AS RECOMMENDED FOR REQUIRED APPLICATIONS. FERTILIZER SHALL BE DELIVERED TO THE SITE IN ORIGINAL UNOPENED CONTAINERS, EACH BEARING THE MANUFACTURER'S GUARANTEED STATEMENT OF ANALYSIS
G. COMMERCIAL FERTILIZER: 10-20-10 OR SIMILAR ANALYSIS. NITROGEN SOURCE TO BE A MINIMUM 50% SLOW RELEASE ORGANIC NITROGEN (SOL OR UFI) WITH A MINIMUM 8% SULFUR AND 4% IRON, PLUS MICROINUTRIENTS
H. PEAT: COMMERCIAL SPHAGNUM PEAT MOSS OR PARTIALLY DECOMPOSED SHREDDED PINE BARK OR OTHER APPROVED ORGANIC MATERIAL

2.4 PREPARATION MATERIALS

- A. SANDY LOAM:
1. FRABLE, FERTILE, DARK, LOAMY SOIL, FREE OF CLAY LUMPS, SUBSOIL, STONES AND OTHER EXTRANEOUS MATERIAL AND REASONABLY FREE OF WEEDS AND FOREIGN GRASSES. LOAM CONTAINING DALLASGRASS OR NUTGRASS SHALL BE REJECTED
2. PHYSICAL PROPERTIES AS FOLLOWS:
a. CLAY - BETWEEN 7-27%
b. SILT - BETWEEN 15-25%
c. SAND - LESS THAN 52%
3. ORGANIC MATTER SHALL BE 3%-10% OF TOTAL DRY WEIGHT
4. IF REQUESTED, LANDSCAPE CONTRACTOR SHALL PROVIDE A CERTIFIED SOIL ANALYSIS CONDUCTED BY AN APPROVED SOIL TESTING LABORATORY VERIFYING THAT SANDY LOAM MEETS THE ABOVE REQUIREMENTS
B. ORGANIC MATERIAL: COMPOST WITH A MIXTURE OF 80% VEGETATIVE MATTER AND 20% ANIMAL WASTE. INGREDIENTS SHOULD BE A MIX OF COURSE AND FINE TEXTURED MATERIAL
C. PREMIXED BEDDING SOIL AS SUPPLIED BY VITAL EARTH RESOURCES, GLADEWATER, TEXAS. PROFESSIONAL BEDDING SOIL AS SUPPLIED BY LIVING EARTH TECHNOLOGY, DALLAS, TEXAS OR ACID GRO MUNICIPAL MIX AS SUPPLIED BY SOIL BUILDING SYSTEMS, DALLAS, TEXAS OR APPROVED EQUAL
D. SHARP SAND: SHARP SAND MUST BE FREE OF SEEDS, SOIL PARTICLES AND WEEDS
E. MULCH: DOUBLE SHREDDED HARDWOOD MULCH, PARTIALLY DECOMPOSED, DARK BROWN
F. ORGANIC FERTILIZER: FERTILAD, SUBTANE, OR GREEN SENSE OR EQUAL AS RECOMMENDED FOR REQUIRED APPLICATIONS. FERTILIZER SHALL BE DELIVERED TO THE SITE IN ORIGINAL UNOPENED CONTAINERS, EACH BEARING THE MANUFACTURER'S GUARANTEED STATEMENT OF ANALYSIS
G. COMMERCIAL FERTILIZER: 10-20-10 OR SIMILAR ANALYSIS. NITROGEN SOURCE TO BE A MINIMUM 50% SLOW RELEASE ORGANIC NITROGEN (SOL OR UFI) WITH A MINIMUM 8% SULFUR AND 4% IRON, PLUS MICROINUTRIENTS
H. PEAT: COMMERCIAL SPHAGNUM PEAT MOSS OR PARTIALLY DECOMPOSED SHREDDED PINE BARK OR OTHER APPROVED ORGANIC MATERIAL

2.5 MISCELLANEOUS MATERIALS

- A. STEEL EDGING - SHALL BE 3/16" X 4" X 16" DARK GREEN LANDSCAPE EDGING, DURAEDGE STEEL OR APPROVED EQUAL
B. TREE STAKING - TREE STAKING SOLUTIONS OR APPROVED SUBSTITUTE; REFER TO DETAILS
C. FILTER FABRIC - MIRAFI 1405 BY MIRAFI INC. OR APPROVED SUBSTITUTE, AVAILABLE AT LONE STAR PRODUCTS, INC. (409-828-0414)
D. SAND - UNIFORMLY GRADED, WASHED, CLEAN, BANK RUN SAND
E. GRAVEL - WASHED NATIVE PEA GRAVEL, GRADED 1" TO 1.5"
F. DECOMPOSED GRANITE - BASE MATERIAL OF NATURAL MATERIAL MIX OF GRANITE AGGREGATE NOT TO EXCEED 1/8" IN DIAMETER COMPOSED OF VARIOUS STAGES OF DECOMPOSED EARTH BASE
G. RIVER ROCK - LOCALLY AVAILABLE NATIVE RIVER ROCK BETWEEN 2"-4" IN DIAMETER
H. PRE-EMERGENT HERBICIDES: ANY GRANULAR, NON-STAINING

- A. STEEL EDGING - SHALL BE 3/16" X 4" X 16" DARK GREEN LANDSCAPE EDGING, DURAEDGE STEEL OR APPROVED EQUAL
B. TREE STAKING - TREE STAKING SOLUTIONS OR APPROVED SUBSTITUTE; REFER TO DETAILS
C. FILTER FABRIC - MIRAFI 1405 BY MIRAFI INC. OR APPROVED SUBSTITUTE, AVAILABLE AT LONE STAR PRODUCTS, INC. (409-828-0414)
D. SAND - UNIFORMLY GRADED, WASHED, CLEAN, BANK RUN SAND
E. GRAVEL - WASHED NATIVE PEA GRAVEL, GRADED 1" TO 1.5"
F. DECOMPOSED GRANITE - BASE MATERIAL OF NATURAL MATERIAL MIX OF GRANITE AGGREGATE NOT TO EXCEED 1/8" IN DIAMETER COMPOSED OF VARIOUS STAGES OF DECOMPOSED EARTH BASE
G. RIVER ROCK - LOCALLY AVAILABLE NATIVE RIVER ROCK BETWEEN 2"-4" IN DIAMETER
H. PRE-EMERGENT HERBICIDES: ANY GRANULAR, NON-STAINING

PRE-EMERGENT HERBICIDE THAT IS LABELED FOR THE SPECIFIC ORNAMENTALS OR TURF ON WHICH IT WILL BE UTILIZED. PRE-EMERGENT HERBICIDES SHALL BE APPLIED PER THE MANUFACTURERS LABELED RATES

PART 3 - EXECUTION

3.1 PREPARATION

- A. LANDSCAPE CONTRACTOR TO INSPECT ALL EXISTING CONDITIONS AND REPORT ANY DEFICIENCIES TO THE OWNER
B. ALL PLANTING AREAS SHALL BE CONDITIONED AS FOLLOWS:
1. PREPARE NEW PLANTING BEDS BY SCRAPING AWAY EXISTING GRASS AND WEEDS AS NECESSARY. TILL EXISTING SOIL TO A DEPTH OF SIX (6") INCHES PRIOR TO PLACING COMPOST AND FERTILIZER. APPLY FERTILIZER AS PER MANUFACTURER'S RECOMMENDATIONS. ADD SIX (6") INCHES OF COMPOST AND TILL INTO A DEPTH OF SIX (6") INCHES OF SPECIFIED MULCH (SETTLED THICKNESS)
2. BACKFILL FOR TREE PITS SHALL BE AS FOLLOWS: USE EXISTING TOP SOIL ON SITE USE IMPORTED TOPSOIL AS NEEDED FREE FROM LARGE CLUMPS, ROCKS, DEBRIS, CALCICHE, SUBSOILS, ETC., PLACED IN NINE (9") INCH LAYERS AND WATERED IN THOROUGHLY
C. GRASS AREAS
1. BLOCKS OF SOD SHOULD BE LAID JOINT TO JOINT (STAGGERED JOINTS) AFTER FERTILIZING THE GROUND FIRST. ROLL GRASS AREAS TO ACHIEVE A SMOOTH, EVEN SURFACE. THE JOINTS BETWEEN THE BLOCKS OF SOD SHOULD BE FILLED WITH TOPSOIL WHERE THEY ARE GAPPED OPEN, THEN WATERED THOROUGHLY

3.2 INSTALLATION

- A. MAINTENANCE OF PLANT MATERIALS SHALL BEGIN IMMEDIATELY AFTER EACH PLANT IS DELIVERED TO THE SITE AND SHALL CONTINUE UNTIL CONSTRUCTION HAS BEEN SATISFACTORILY ACCOMPLISHED
B. PLANT MATERIALS SHALL BE DELIVERED TO THE SITE ONLY AFTER THE BEDS ARE PREPARED AND AREAS ARE READY FOR PLANTING. ALL SHIPMENTS OF NURSERY MATERIALS SHALL BE THOROUGHLY PROTECTED FROM THE WINDS DURING TRANSPORT. ALL PLANTS WHICH CANNOT BE PLANTED AT ONCE, AFTER DELIVERY TO THE SITE, SHALL BE WELL PROTECTED AGAINST THE POSSIBILITY OF DRYING BY WIND AND BALLS OF EARTH OF B & B PLANTS SHALL BE KEPT COVERED WITH SOIL OR OTHER ACCEPTABLE MATERIAL. ALL PLANTS REMAIN THE PROPERTY OF THE CONTRACTOR UNTIL FINAL ACCEPTANCE
C. POSITION THE TREES AND SHRUBS IN THEIR INTENDED LOCATION AS PER PLAN
D. NOTIFY THE OWNER'S AUTHORIZED REPRESENTATIVE FOR INSPECTION AND APPROVAL OF ALL POSITIONING OF PLANT MATERIALS
E. EXCAVATE PITS WITH VERTICAL SIDES AND HORIZONTAL BOTTOM. TREE PITS SHALL BE LARGE ENOUGH TO PERMIT HANDLING AND PLANTING WITHOUT INJURY TO BALLS OF EARTH OR ROOTS AND SHALL BE OF SUCH DEPTH THAT WHEN PLANTED AND SETTLED, THE CROWN OF THE PLANT SHALL BEAR THE SAME RELATIONSHIP TO THE FINISH GRADE AS IT DID TO SOIL SURFACE IN ORIGINAL PLACE OF GROWTH. THE SIDES OF THE HOLE SHOULD BE ROUGH AND JAGGED, NEVER SMOOTH OR GLAZED
F. SHRUB AND TREE PITS SHALL BE NO LESS THAN TWENTY-FOUR (24") INCHES WIDER THAN THE MEASURAL DIMENSION OF THE EARTH BALL AND SIX (6") INCHES DEEPER THAN ITS VERTICAL DIMENSION. REMOVE AND HAIL FROM SITE ALL ROCKS AND STONES OVER THREE-QUARTER (3/4") INCH IN DIAMETER. PLANTS SHOULD BE THOROUGHLY MOIST BEFORE REMOVING CONTAINERS
G. PERCOLATION TEST: FILL THE HOLE WITH WATER. IF THE WATER LEVEL DOES NOT PERCOLATE WITHIN 24 HOURS, THE TREE NEEDS TO MOVE TO ANOTHER LOCATION OR HAVE DRAINAGE ADDED. INSTALL A PVC STAND PIPE PER TREE IF THE PERCOLATION TEST FAILS
H. BACKFILL ONLY WITH 5 PARTS EXISTING SOIL OR SANDY LOAM AND 1 PART BED PREPARATION. WHEN THE HOLE IS DUG IN SOLID ROCK, TOPSOIL FROM THE SAME AREA SHOULD NOT BE USED. CAREFULLY SETTLE BY WATERING TO PREVENT AIR POCKETS. REMOVE THE BURLAP FROM THE TOP 1/2 OF THE BALL, AS WELL AS ALL NYLON, PLASTIC STRING AND WIRE. CONTAINER TREES WILL USUALLY BE ROOT BOUND. IF SO FOLLOW STANDARD NURSERY PRACTICE OF "ROOT SCORING"
I. DO NOT WRAP TREES
J. DO NOT OVER PRUNE
K. REMOVE NURSERY TAGS AND STAKES FROM ALL PLANTS
L. REMOVE BOTTOM OF PLANT BOXES PRIOR TO PLACING PLANTS. REMOVE SIDES AFTER PLACEMENT AND PARTIAL BACKFILLING
M. REMOVE UPPER THIRD OF BURLAP FROM BALLED AND BURLAPPED TREES AFTER PLACEMENT
N. PLACE PLANT UPRIGHT AND PLUMB IN CENTER OF HOLE. ORIENT PLANTS FOR BEST APPEARANCE
O. MULCH THE TOP OF THE BALL. DO NOT PLANT GRASS ALL THE WAY TO THE TRUNK OF THE TREE. LEAVE THE AREA ABOVE THE TOP OF

THE BALL AND MULCH WITH AT LEAST TWO (2") INCHES OF SPECIFIED MULCH

- P. ALL PLANT BEDS AND TREES TO BE MULCHED WITH A MINIMUM SETTLED THICKNESS OF TWO (2") INCHES OVER THE ENTIRE BED OR PIT
Q. OBSTRUCTION BELOW GROUND: IN THE EVENT THAT ROCK, OR OBSTRUCTION BELOW GROUND CONSTRUCTION WORK OR OBSTRUCTIONS ARE ENCOUNTERED IN ANY PLANT PIT EXCAVATION WORK TO BE DONE UNDER THIS SECTION, ALTERNATE LOCATIONS MAY BE SELECTED BY THE OWNER. WHERE LOCATIONS CANNOT BE CHANGED, THE OBSTRUCTIONS SHALL BE REMOVED TO A DEPTH OF NOT LESS THAN THREE (3") FEET BELOW GRADE AND NO LESS THAN SIX (6") INCHES BELOW THE BOTTOM OF BALL WHEN PLANT IS PROPERLY SET AT THE REQUIRED GRADE. THE WORK OF THIS SECTION SHALL INCLUDE THE REMOVAL OF FRUIT, BRANCHES, OR OTHER OBSTRUCTIONS ENCOUNTERED AT THE COST OF THE LANDSCAPE CONTRACTOR
R. TREES AND LARGE SHRUBS SHALL BE STAKED AS SITE CONDITIONS REQUIRE. POSITION STAKES TO SECURE TREES AGAINST SEASONAL PREVAILING WINDS
S. PRUNING AND MULCHING: PRUNING SHALL BE DIRECTED BY THE LANDSCAPE ARCHITECT AND SHALL BE PRUNED IN ACCORDANCE WITH STANDARD HORTICULTURAL PRACTICE FOLLOWING FINE PRUNING, CLASS I PRUNING STANDARDS PROVIDED BY THE NATIONAL ARBORESTRIC ASSOCIATION
1. DEAD WOOD, SUCKERS, BROKEN AND BADLY BRUISED BRANCHES SHALL BE REMOVED. GENERAL TYPING OF THE BRANCHES IS NOT PERMITTED. DO NOT CUT TERMINAL BRANCHES
2. PRUNING SHALL BE DONE WITH CLEAN, SHARP TOOLS
3. IMMEDIATELY AFTER PLANTING OPERATIONS ARE COMPLETED, ALL TREE PITS SHALL BE COVERED WITH A LAYER OF ORGANIC MATERIAL TWO (2") INCHES IN DEPTH. THIS LIMIT OF THE ORGANIC MATERIAL FOR TREES SHALL BE THE DIAMETER OF THE PLANT PIT

- STEEL EDGE INSTALLATION: EDGE SHALL BE ALIGNED AS INDICATED ON PLANS. STAKE OUT LIMITS OF STEEL CURBING AND OBTAIN OWNERS APPROVAL PRIOR TO INSTALLATION
1. ALL STEEL CURBING SHALL BE FREE OF KINKS AND ABRUPT BENDS
2. TOP OF EDGING SHALL BE 2" MAXIMUM HEIGHT ABOVE FINAL FINISHED GRADE
3. STAKES ARE TO BE INSTALLED ON THE PLANTING BED SIDE OF THE CURBING, AS OPPOSED TO THE GRASS SIDE
4. DO NOT INSTALL STEEL EDGING ALONG SIDEWALKS OR CURBS
5. CUT STEEL EDGING AT 45 DEGREE ANGLE WHERE EDGING MEETS SIDEWALKS OR CURBS

- STEEL EDGE INSTALLATION: EDGE SHALL BE ALIGNED AS INDICATED ON PLANS. STAKE OUT LIMITS OF STEEL CURBING AND OBTAIN OWNERS APPROVAL PRIOR TO INSTALLATION
1. ALL STEEL CURBING SHALL BE FREE OF KINKS AND ABRUPT BENDS
2. TOP OF EDGING SHALL BE 2" MAXIMUM HEIGHT ABOVE FINAL FINISHED GRADE
3. STAKES ARE TO BE INSTALLED ON THE PLANTING BED SIDE OF THE CURBING, AS OPPOSED TO THE GRASS SIDE
4. DO NOT INSTALL STEEL EDGING ALONG SIDEWALKS OR CURBS
5. CUT STEEL EDGING AT 45 DEGREE ANGLE WHERE EDGING MEETS SIDEWALKS OR CURBS

- STEEL EDGE INSTALLATION: EDGE SHALL BE ALIGNED AS INDICATED ON PLANS. STAKE OUT LIMITS OF STEEL CURBING AND OBTAIN OWNERS APPROVAL PRIOR TO INSTALLATION
1. ALL STEEL CURBING SHALL BE FREE OF KINKS AND ABRUPT BENDS
2. TOP OF EDGING SHALL BE 2" MAXIMUM HEIGHT ABOVE FINAL FINISHED GRADE
3. STAKES ARE TO BE INSTALLED ON THE PLANTING BED SIDE OF THE CURBING, AS OPPOSED TO THE GRASS SIDE
4. DO NOT INSTALL STEEL EDGING ALONG SIDEWALKS OR CURBS
5. CUT STEEL EDGING AT 45 DEGREE ANGLE WHERE EDGING MEETS SIDEWALKS OR CURBS

- STEEL EDGE INSTALLATION: EDGE SHALL BE ALIGNED AS INDICATED ON PLANS. STAKE OUT LIMITS OF STEEL CURBING AND OBTAIN OWNERS APPROVAL PRIOR TO INSTALLATION
1. ALL STEEL CURBING SHALL BE FREE OF KINKS AND ABRUPT BENDS
2. TOP OF EDGING SHALL BE 2" MAXIMUM HEIGHT ABOVE FINAL FINISHED GRADE
3. STAKES ARE TO BE INSTALLED ON THE PLANTING BED SIDE OF THE CURBING, AS OPPOSED TO THE GRASS SIDE
4. DO NOT INSTALL STEEL EDGING ALONG SIDEWALKS OR CURBS
5. CUT STEEL EDGING AT 45 DEGREE ANGLE WHERE EDGING MEETS SIDEWALKS OR CURBS

- STEEL EDGE INSTALLATION: EDGE SHALL BE ALIGNED AS INDICATED ON PLANS. STAKE OUT LIMITS OF STEEL CURBING AND OBTAIN OWNERS APPROVAL PRIOR TO INSTALLATION
1. ALL STEEL CURBING SHALL BE FREE OF KINKS AND ABRUPT BENDS
2. TOP OF EDGING SHALL BE 2" MAXIMUM HEIGHT ABOVE FINAL FINISHED GRADE
3. STAKES ARE TO BE INSTALLED ON THE PLANTING BED SIDE OF THE CURBING, AS OPPOSED TO THE GRASS SIDE
4. DO NOT INSTALL STEEL EDGING ALONG SIDEWALKS OR CURBS
5. CUT STEEL EDGING AT 45 DEGREE ANGLE WHERE EDGING MEETS SIDEWALKS OR CURBS

- STEEL EDGE INSTALLATION: EDGE SHALL BE ALIGNED AS INDICATED ON PLANS. STAKE OUT LIMITS OF STEEL CURBING AND OBTAIN OWNERS APPROVAL PRIOR TO INSTALLATION
1. ALL STEEL CURBING SHALL BE FREE OF KINKS AND ABRUPT BENDS
2. TOP OF EDGING SHALL BE 2" MAXIMUM HEIGHT ABOVE FINAL FINISHED GRADE
3. STAKES ARE TO BE INSTALLED ON THE PLANTING BED SIDE OF THE CURBING, AS OPPOSED TO THE GRASS SIDE
4. DO NOT INSTALL STEEL EDGING ALONG SIDEWALKS OR CURBS
5. CUT STEEL EDGING AT 45 DEGREE ANGLE WHERE EDGING MEETS SIDEWALKS OR CURBS

- STEEL EDGE INSTALLATION: EDGE SHALL BE ALIGNED AS INDICATED ON PLANS. STAKE OUT LIMITS OF STEEL CURBING AND OBTAIN OWNERS APPROVAL PRIOR TO INSTALLATION
1. ALL STEEL CURBING SHALL BE FREE OF KINKS AND ABRUPT BENDS
2. TOP OF EDGING SHALL BE 2" MAXIMUM HEIGHT ABOVE FINAL FINISHED GRADE
3. STAKES ARE TO BE INSTALLED ON THE PLANTING BED SIDE OF THE CURBING, AS OPPOSED TO THE GRASS SIDE
4. DO NOT INSTALL STEEL EDGING ALONG SIDEWALKS OR CURBS
5. CUT STEEL EDGING AT 45 DEGREE ANGLE WHERE EDGING MEETS SIDEWALKS OR CURBS

- STEEL EDGE INSTALLATION: EDGE SHALL BE ALIGNED AS INDICATED ON PLANS. STAKE OUT LIMITS OF STEEL CURBING AND OBTAIN OWNERS APPROVAL PRIOR TO INSTALLATION
1. ALL STEEL CURBING SHALL BE FREE OF KINKS AND ABRUPT BENDS
2. TOP OF EDGING SHALL BE 2" MAXIMUM HEIGHT ABOVE FINAL FINISHED GRADE
3. STAKES ARE TO BE INSTALLED ON THE PLANTING BED SIDE OF THE CURBING, AS OPPOSED TO THE GRASS SIDE
4. DO NOT INSTALL STEEL EDGING ALONG SIDEWALKS OR CURBS
5. CUT STEEL EDGING AT 45 DEGREE ANGLE WHERE EDGING MEETS SIDEWALKS OR CURBS

- STEEL EDGE INSTALLATION: EDGE SHALL BE ALIGNED AS INDICATED ON PLANS. STAKE OUT LIMITS OF STEEL CURBING AND OBTAIN OWNERS APPROVAL PRIOR TO INSTALLATION
1. ALL STEEL CURBING SHALL BE FREE OF KINKS AND ABRUPT BENDS
2. TOP OF EDGING SHALL BE 2" MAXIMUM HEIGHT ABOVE FINAL FINISHED GRADE
3. STAKES ARE TO BE INSTALLED ON THE PLANTING BED SIDE OF THE CURBING, AS OPPOSED TO THE GRASS SIDE
4. DO NOT INSTALL STEEL EDGING ALONG SIDEWALKS OR CURBS
5. CUT STEEL EDGING AT 45 DEGREE ANGLE WHERE EDGING MEETS SIDEWALKS OR CURBS

- STEEL EDGE INSTALLATION: EDGE SHALL BE ALIGNED AS INDICATED ON PLANS. STAKE OUT LIMITS OF STEEL CURBING AND OBTAIN OWNERS APPROVAL PRIOR TO INSTALLATION
1. ALL STEEL CURBING SHALL BE FREE OF KINKS AND ABRUPT BENDS
2. TOP OF EDGING SHALL BE

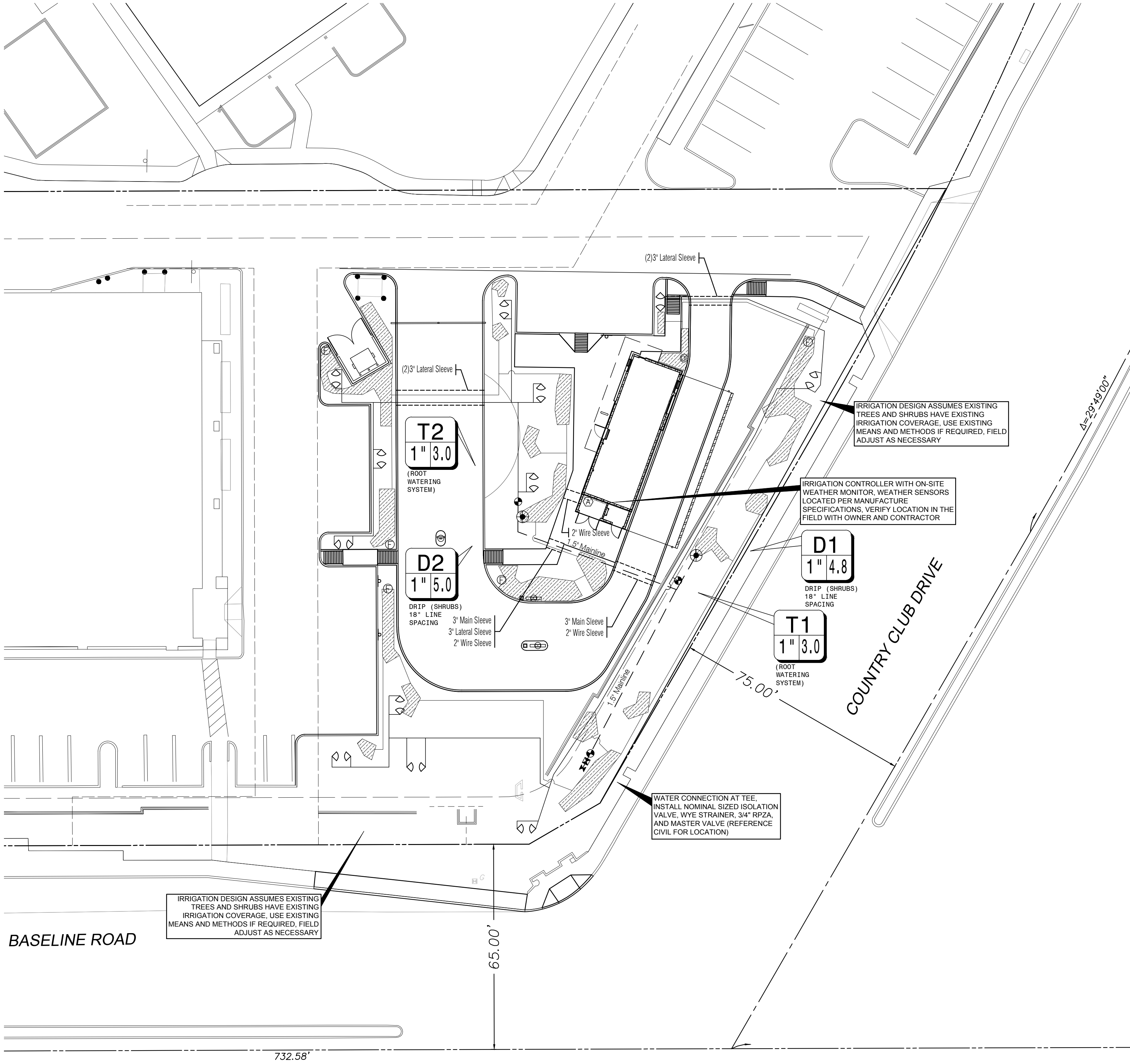

SLEEVING NOTES

1. PIPING AND CONTROL WIRES SHALL BE INSTALLED IN SEPARATE SLEEVES UNDER PAVING. REFERENCE DRAWINGS FOR SLEEVE SIZE AND LOCATION.
2. SLEEVES SHALL BE FURNISHED AND INSTALLED BY GENERAL CONTRACTOR.
3. INSTALLATION OF SLEEVES SHALL BE TWENTY (24) BELOW TOP OF PAVEMENT OR FINISHED GRADE.
4. SLEEVES SHALL EXTEND ONE (1) FOOT BEYOND EDGE OF ALL PAVEMENT AND STAKED FOR LOCATION.
5. ALL SLEEVES SHALL BE SCHEDULE 40 PVC PIPE, CAPPED ON BOTH ENDS AND SIZED AT LEAST TWO TIMES LARGER THAN THE DIAMETER OF THE PIPE INSIDE THE SLEEVE.
6. SLEEVE LOCATIONS SHALL BE MARKED ONTO THE CURB WITH A SAWCUT OF TWO PARALLEL LINES THAT ARE TWO (2) INCHES LONG AND ONE (1) APART.
7. CONTRACTOR IS RESPONSIBLE FOR THE INSTALLATION OF SLEEVES AND SHALL ALSO BE RESPONSIBLE FOR LOCATING ANY SLEEVE THAT CANNOT BE FOUND DURING THE INSTALLATION OF THE SYSTEM.
8. CONTRACTOR SHALL FURNISH OWNER AND IRRIGATION CONTRACTOR WITH AN AS-BUILT DRAWING SHOWING ALL SLEEVE LOCATIONS.

IRRIGATION GENERAL NOTES

1. THE IRRIGATION CONTRACTOR SHALL COORDINATE INSTALLATION OF THE IRRIGATION SYSTEM WITH THE LANDSCAPE CONTRACTOR SO THAT ALL PLANT MATERIAL WILL BE WATERED IN ACCORDANCE WITH THE INTENT OF THE PLANS AND SPECIFICATIONS.
2. THE CONTRACTOR SHALL BE RESPONSIBLE TO NOTIFY THE IRRIGATION DESIGNER OF SITE CONDITIONS OR ASSUME FULL RESPONSIBILITY FOR ANY AND ALL ON SITE REVISIONS NECESSARY.
3. CONTRACTOR TO VERIFY DESIGN AND ITS INTENT TO PROVIDE FULL COVERAGE TO ALL NEW PLANTING MATERIAL.
4. NOTIFY IRRIGATION DESIGNER OF ANY LAYOUT DISCREPANCIES PRIOR TO BIDDING.
5. LOCATE ALL UTILITIES AND SITE LIGHTING CONDUITS BEFORE IRRIGATION INSTALLATION BEGINS.
6. IRRIGATION CONTRACTOR TO PROCURE ALL PERMITS, LICENSES AND GIVE ALL NECESSARY NOTICES THROUGHOUT THE DURATION OF THE PROJECT.
7. THE CONTRACTOR SHALL BE IN GOOD STANDING WITH STATE BOARDS AND REGULATORS.
8. THE CONTRACTOR SHALL BE RESPONSIBLE FOR ANY AND ALL PLANT MATERIAL UPON ACCEPTANCE AND THROUGH THE WARRANTY PERIOD FOR DAMAGE DUE TO IRRIGATION SYSTEM FAILURE.
9. ALL ASPECTS OF THE IRRIGATION INSTALLATION SHALL CONFORM WITH THE PROPER GOVERNING AUTHORITIES, CODES AND ORDINANCES.
10. SLEEVES SHALL BE FURNISHED AND INSTALLED BY GENERAL CONTRACTOR. SLEEVE MATERIAL SHALL BE SCHEDULE 40, SIZE AS INDICATED ON PLAN. REFER TO SLEEVING NOTES.
11. ALL MAIN LINE AND LATERAL LINE PIPING IN PLANTING AND LAWN AREAS SHALL HAVE A MINIMUM OF 12 INCHES OF COVER. ALL PIPING UNDER PAVING SHALL HAVE A MINIMUM OF 18 INCHES OF COVER. CONTRACTOR TO VERIFY LOCAL FREEZE DEPTHS AND ADJUST DEPTH OF COVER ACCORDINGLY.
12. ZONE VALVES SHALL NOT BE LOCATED WITHIN THREE (3) FEET OF ANY DRIVEWAY, TRAFFIC AISLE, ISLAND ETC. WHERE THEY WILL BE DAMAGED BY VEHICLES DRIVING OVER CURBS.
13. ALL NOZZLES IN PARKING LOT ISLANDS AND PLANTING BEDS SHALL BE LOW ANGLE NOZZLES TO MINIMIZE OVER SPRAY ON PAVEMENT SURFACES.
14. AUTOMATIC CONTROLLER SHALL BE INSTALLED AT LOCATION SHOWN. POWER (120V) SHALL BE LOCATED IN A JUNCTION BOX WITHIN FIVE (5) FEET OF CONTROLLER. LOCATION BY OTHER TRADES. RAIN AND FREEZE SENSORS SHALL BE INSTALLED WITH EACH CONTROLLER.
15. ELECTRICAL SPICES SHOULD BE LOCATED AT EACH VALVE AND CONTROLLER ONLY.
16. PROVIDE A 3/4" BLOW DOWN DRAIN TEE TO ALLOW WATER TO BE BLOWN FROM THE IRRIGATION LINES/SYSTEM.
17. DISTURBED AREAS IN NEED OF TURF ESTABLISHMENT MAY EXIST BEYOND COVERAGE LIMITS OF THE PERMANENT IRRIGATION SYSTEM. IN THESE AREAS, CONTRACTOR TO DETERMINE A TEMPORARY MEANS TO ESTABLISH NECESSARY TURF. CONTRACTOR IS ENCOURAGED TO BEGIN TURF ESTABLISHMENT IMMEDIATELY UPON FINAL GRADE IN ACCORDANCE WITH AND TO SATISFY SWPPP.
18. PROVIDE WITH OWNER A COPY OF ALL INSTALLED EQUIPMENT AND LINES (AS BUILT PLANS.)
19. PLACE COPY OF ZONE MAP WITH ALL ZONE VALVE LOCATIONS SHOWN AND APPROVED IRRIGATION PLAN IN PROTECTIVE JACKET IN MAIN CONTROL PANEL.

IRRIGATION PROJECT NOTES

1. THE LOCATION OF MAINLINE AND VALVES ON THIS PLAN MAY BE SHOWN IN PAVED AREAS FOR DESIGN CLARITY ONLY. IRRIGATION ELEMENTS HAVE BEEN SHOWN ON THIS PLAN AS ACCURATELY AS POSSIBLE WITHOUT THE FORFEIT OF DESIGN CLARITY AND INTENT. ALL PIPES AND VALVES SHALL BE INSTALLED WITHIN PREVIOUS AREAS. ALL PIPE AND WIRES THAT CROSS UNDER PAVING SHALL BE INSTALLED IN SEPARATE SLEEVES AS SPECIFIED.
2. ALL SPRINKLER EQUIPMENT NUMBERS REFERENCE THE HUNTER EQUIPMENT CATALOG UNLESS OTHERWISE INDICATED.
3. TEN DAYS PRIOR TO START OF CONSTRUCTION, IRRIGATION CONTRACTOR SHALL VERIFY STATIC WATER PRESSURE. THE IRRIGATION SYSTEM FOR THIS SITE IS DESIGNED TO OPERATE WITH A PRESSURE OF SIXTY (60 PSI) POUNDS PER SQUARE INCH. SHOULD THE DESIGN PRESSURE FOR THE SYSTEM BE HIGHER THAN THE EXISTING PRESSURE, THE IRRIGATION CONTRACTOR SHALL NOTIFY THE IRRIGATION DESIGNER IMMEDIATELY.
4. IRRIGATION CONTRACTOR SHALL COORDINATE THE LOCATION OF THE CONTROLLER AND SENSORS WITH THE GENERAL CONTRACTOR AND OWNER. A 110 VOLT ELECTRICAL SERVICE TO POWER THE IRRIGATION CONTROLLER SHALL BE PROVIDED BY THE GENERAL CONTRACTOR AT THE LOCATION SHOWN ON THIS PLAN.
5. WATER SERVICE TAP, METER AND LEAD FOR THE IRRIGATION SYSTEM SHALL BE PROVIDED AND INSTALLED BY THE GENERAL CONTRACTOR. SERVICE LINE AND METER SHALL BE SIZED AS NOTED ON THIS PLAN.
6. TYPE AND INSTALLATION OF THE WATER METER AND BACK FLOW PREVENTION DEVICE SHALL BE DETERMINED BY THE GOVERNING AUTHORITY. AN ISOLATION VALVE SHALL BE PROVIDED BETWEEN THE WATER METER AND BACK FLOW DEVICE.
7. ALL CALCULATIONS FOR THIS IRRIGATION SYSTEM ARE BASED ON PRODUCTS AND EQUIPMENT INFORMATION PROVIDED BY HUNTER. INSTALLATION OF THESE PRODUCTS SHALL NOT EXCEED MANUFACTURERS RECOMMENDATIONS.
8. REFERENCE HUNTER GUIDELINES AND SPECIFICATIONS PRIOR TO INSTALLATION. CONFIRM REQUIREMENTS FOR CONTROLLER, WATERPROOF CONNECTIONS, GROUNDING, SURGE PROTECTORS, DECODERS, VALUES, AND WIRING PRIOR TO INSTALLATION. HUNTER TECHNICAL SERVICES (760) 591-7383. WWW.HUNTERINDUSTRIES.COM
9. IRRIGATION REMOTE CONTROL VALVES SHALL BE 1" AND/OR 1.5" HUNTER ICV AS INDICATED. PRIOR TO ALL REMOTE CONTROL VALVES, INSTALL A NOMINALLY SIZED BALL VALVE WITHIN THE SAME BOX.
10. SIZE OF VALVES ARE AS SHOWN ON PLAN. VALVES SHALL BE INSTALLED IN APPROVED BOXES WITH COVERS LARGE ENOUGH TO PERMIT MANUAL OPERATION, REMOVAL OF SOLENOID AND / OR VALVE COVER WITHOUT ANY EARTH EXCAVATION. OWNERS MAY ELECT LOCKING BOXES ON A PROJECT BY PROJECT BASIS.
11. QUICK COUPLING VALVES SHALL BE HUNTER INSTALLED PER DETAIL SHOWN. SWING JOINTS SHALL BE CONSTRUCTED USING 3/4" SCHEDULE 80 ELBOWS. CONTRACTOR SHALL SUPPLY OWNER WITH THREE (3) CH75 COUPLERS AND THREE (3) #10HSL SWIVEL HOSE ELLS AS PART OF THIS CONTRACT.
12. IRRIGATION SYSTEM AUTOMATIC CONTROLLER SHALL BE HUNTER PRO-C 6 STATION - PC-1200 WITH RAIN AND FREEZE SENSORS. INSTALL PER MANUFACTURERS RECOMMENDATIONS. CONFIRM WIRING, GROUNDING AND SURGE PROTECTION REQUIREMENTS BEFORE INSTALLING.
13. DRIP IRRIGATION REMOTE CONTROL VALVES SHALL BE HUNTER ICZ-101-LF-40 AS INDICATED. DRIP TUBING SHALL BE HUNTER HDL-06-12-CV.
14. INSTALL DRIP TUBING/LINES PER MANUFACTURERS RECOMMENDATIONS. USE PLD-LOC FITTINGS PLD-LOC 075, PLD-LOC 050, PLD-LOC ELB, PLD-LOC CPL, PLD-LOC CAP, PLD-LOC TEE, PLD-LOC OR USE FHS BARB FITTINGS PLD-075, PLD-050, PLD-ELB, PLD-CPL, PLD-CAP, PLD-TEE, PLD-075-TBTEE, PLD-SV, USE ECO-INDICATOR ECO-ID, USE LINE FLUSHING VALVE HUNTER AFV-B.
15. DRIP TUBING SHALL BE SPACED 18" APART IN SHRUB AREAS. REFER TO MANUFACTURERS RECOMMENDATIONS.
16. ROOT BUBBLERS SHALL BE HUNTER PLD-CIRCLE BUBBLERS WITH PROS-06-PRS30 WITH PCN MODEL 25 NOZZLES.
17. ALL VALVE CONTROL WIRE SHALL BE SIZED PER MANUFACTURER GUIDELINES BY THE CONTRACTOR ACCORDING TO THE ACTUAL FIELD DISTANCE. ALL CONNECTIONS SHALL BE WATER-PROOF, KEPT TO A MINIMUM, AND LOCATED IN AN APPROVED BOX.

IRRIGATION LEGEND			
SYMBOL	DESCRIPTION	MANUFACTURER	MODEL NO.
	FULL-CIRCLE BUBBLERS	HUNTER	PROS-06-PRS30 WITH PCN25 NOZZLES
	REMOTE CONTROL VALVE	HUNTER	ICV
	3/4" REDUCED PRESSURE ZONE	FEBCO	880 SERIES
	HDL DRIPLINE	HUNTER	HDL-06-12-CV
	LINE FLUSHING VALVE	HUNTER	AFV-B
	PRESSURE OPERATOR INDICATOR	HUNTER	ECO-ID
	DRIP CONTROL VALVE	HUNTER	ICZ-101-LF-40

IRRIGATION LEGEND		
SYMBOL	DESCRIPTION	
	DESIGN ASSUMES WATER CONNECTION AT TEE FROM DOMESTIC METER	
	HUNTER - PRO-C-6 STATION - WITH RAIN AND FREEZE SENSORS	
	ISOLATION VALVE	
	LATERAL PIPING	REFER TO PLAN CLASS 200 PVC
	MAINLINE PIPING	REFER TO PLAN SCH. 40 PVC, SIZED AS SHOWN (INSTALL THRUST BLOCKS AND AIR/VACUUM RELIEF VALVES AS NECESSARY TO PROTECT MAINLINE SYSTEM)
	IRRIGATION SLEEVE, SCH. 40 PVC, MIN. TWICE SIZE OF PIPE TO BE INSERTED, ONE SLEEVE PER PIPE CONTROL WIRING SLEEVE, 2" SCH. 40 PVC	
	VALVE STATION # (WHERE D = DRIP TUBING, S = SPRAY, R = ROTOR, T = TREE DRIP)	
	VALVE SIZE GPM	

SUGGESTED LATERAL PIPE SIZE, CLASS 200 PVC	
FLOW RANGE GPM	PIPE SIZE
0 - 8 GPM	3/4"
8 - 12 GPM	1"
12 - 22 GPM	1-1/4"
22 - 28 GPM	1-1/2"
28 + GPM	2"

- NOTE:**
1. ENTIRE SYSTEM SHALL BE INSTALLED PER STATE STANDARDS, MANUFACTURERS SPECIFICATIONS AND ALL CITY CODES.
 2. THIS DESIGN IS DIAGRAMMATIC. ALL PIPING, VALVES, AND OTHER EQUIPMENT SHOWN WITHIN PAVED AREAS OR OUT OF PROPERTY BOUNDARIES ARE FOR DESIGN CLARIFICATION ONLY, AND SHALL BE INSTALLED IN PLANTING AREAS WITHIN THE PROPERTY LINES OR LIMITS INDICATED ON PLAN. THE IRRIGATION CONTRACTOR SHALL VERIFY THE LOCATIONS OF ALL ABOVE GROUND IRRIGATION EQUIPMENT WITH THE OWNERS AUTHORIZED REPRESENTATIVE PRIOR TO INSTALLATION, OR IRRIGATION CONTRACTOR MAY BE REQUIRED TO MOVE SUCH ITEMS AT HIS OWN COST.
 3. VARIOUS AREAS ON PLAN ARE SHOWING SINGLE HEAD COVERAGE. IF OWNER SHOULD ELECT FOR FULL COVERAGE, CONTRACTOR TO PROCURE THE PROPER PERMITS AND BID ALTERNATE FOR THESE ADDITIONAL SPRAY HEADS, ZONES, AND CONTROLLER EXPANSION FOR THE SYSTEM.
 4. IRRIGATION CONTRACTOR IS TO COORDINATE LOCATION AND PLACEMENT OF ALL IRRIGATION ITEMS WITH THE GENERAL CONTRACTOR. CONTRACTOR IS TO USE EXTREME CAUTION IN TRENCHING TO AVOID EXISTING AND PROPOSED UTILITIES. CONTRACTOR TO LOCATE ALL UTILITIES PRIOR TO IRRIGATION INSTALLATION.
 5. IRRIGATION SPRAY NOZZLES TO BE ADJUSTED TO AVOID PAVEMENT, BUILDING, WALLS, FENCES, UTILITIES, EQUIPMENT, SIGNAGE, AND CALL BOX
 6. REFERENCE LANDSCAPE PLAN FOR LOCATION OF GRAVEL, STEEL EDGING AND ALL PROPOSED PLANT MATERIAL.
 7. IN TURF AREAS (BOTH SOG AND HYDROMULCH AREAS) OUTSIDE OF IRRIGATION PERMANENT COVERAGE, CONTRACTOR TO PROVIDE TEMPORARY IRRIGATION UNTIL ESTABLISHED, TYP
 8. CONTRACTOR TO TAKE ALL NECESSARY MEASURES TO PREVENT WATER HAMMER AND SYSTEM COLLAPSE BY DISCHARGING AIR DURING STARTUP AND ALLOWING AIR TO ENTER DURING SHUTDOWN. INSTALL THRUST BLOCKS AND AIR/VACUUM RELIEF VALVES AS NECESSARY TO PROTECT MAINLINE SYSTEM. FOR 3 INCH AND LARGER MAINLINE, INSTALL JOINT RESTRAINTS AT TURNS. INSTALL PER MANUFACTURERS RECOMMENDATIONS.
 9. ALL MAINLINE PIPING 3 INCHES AND LARGER SHALL BE BELL AND GASKETED CLASS 200 PVC PIPE, SIZE 21. INSTALL PER MANUFACTURERS RECOMMENDATIONS. CONTACT MANUFACTURE OR DISTRIBUTOR FOR PRODUCT DEMONSTRATION.
 10. GROUP VALVES IN FIELD AS NECESSARY FOR MAINLINE SIZING. CENTER FEED LATERALS WHEN POSSIBLE.



AWR Designs, LLC
P.O. Box 1746
Alledo, Texas 76008
amanda@awr-designs.com
c. 512.517.5589



GRAPHIC SCALE

0 20 40 FEET

Scale 1"=20' - 0"



Know what's below.
Call before you dig.



Know what's below.
Call before you dig.

THE LOCATION OF EXISTING UNDERGROUND UTILITIES ARE SHOWN IN AN APPROXIMATE WAY ONLY AND HAVE NOT BEEN INDEPENDENTLY VERIFIED BY THE OWNER OR ITS REPRESENTATIVE. THE CONTRACTOR SHALL DETERMINE THE EXACT LOCATION OF ALL EXISTING UTILITIES BEFORE COMMENCING WORK, AND AGREES TO BE FULLY RESPONSIBLE FOR ANY AND ALL DAMAGE WHICH MIGHT BE OCCURRED BY THE CONTRACTOR'S FAILURE TO EXACTLY LOCATE AND PRESERVE ANY AND ALL UNDERGROUND UTILITIES.

NOTICE
CONSTRUCTION SITE SAFETY IS THE SOLE RESPONSIBILITY OF THE CONTRACTOR. NEITHER THE OWNER NOR THE ENGINEER SHALL BE EXPECTED TO ASSUME ANY RESPONSIBILITY FOR SAFETY OF THE WORK OF PERSONS ENGAGED IN THE WORK OF ANY NEARBY STRUCTURES, OR OF ANY OTHER PERSONS.

COPYRIGHT © 2023 ATWELL LLC NO REPRODUCTION SHALL BE MADE WITHOUT THE PRIOR WRITTEN CONSENT OF ATWELL LLC

24 HOUR
EMERGENCY CONTACT

ATWELL
866.850.4200 www.atwell-group.com
9001 AIRPORT FREEWAY, SUITE 660
NORTH RICHMOND, TEXAS 75480
AZ COA 16251



COUNTRY CLUB RD & BASELINE RD

MESA

MARICOPA COUNTY, ARIZONA

SALAD & GO # 1176
AND GO CONCEPTS, LLC
DEVELOPMENT PLANS:
IRRIGATION PLAN

DATE 2023-3-13

REVISIONS

DRAWN BY: C. ATCHLEY
CHECKED BY: M. HOLMES
PROJECT MANAGER: T. BOUSQUET
JOB #: 22003717
FILE CODE: ##
SHEET NO. L201

SECTION 32 8423 - UNDERGROUND IRRIGATION SLEEVES AND UTILITY CONDUITS

PART 1 - GENERAL

1.1 DESCRIPTION

- A. PROVIDE UNDERGROUND IRRIGATION SLEEVES AS INDICATED ON THE DRAWINGS.

1.2 RELATED WORK

- A. SECTION 32 8424 - IRRIGATION SYSTEM.

1.3 REFERENCE STANDARDS

- A. AMERICAN STANDARD FOR TESTING AND MATERIALS (ASTM) - LATEST EDITION.

PART 2 - MATERIALS

2.1 GENERAL

- A. POLYVINYL CHLORIDE PIPE (PVC) - SCHEDULE 40 SHALL BE USED FOR ALL SLEEVING PURPOSES.
- B. PVC PIPES SHALL BE MARKED WITH SDR NUMBER, ASTM STANDARD NUMBER, AND THE NSF SEAL.
- C. SOLVENT SHALL BE USED AS RECOMMENDED BY MANUFACTURER TO MAKE SOLVENT WELDED JOINTS. PIPE AND FITTINGS SHOULD BE CLEANED BEFORE APPLYING SOLVENT.

PART 3 - EXECUTION

3.1 INSTALLATION

- A. A MINIMUM OF TWENTY FOUR (24) INCHES COVER SHALL BE PROVIDED OVER THE TOP OF SLEEVE FROM FINISH GRADE.
- B. SLEEVES SHALL BE EXTENDED ONE (1) FOOT PAST THE EDGE OF PAVEMENT OF WALLS. INSTALL A NINETY DEGREE ELBOW ON EACH SLEEVE AND ADD ADDITIONAL LENGTH TO EXTEND ABOVE FINISH GRADE BY TWELVE (12) INCHES. CAP PIPE ENDS.

3.2 BACKFILL

- A. BACKFILL SHALL BE PLACED OVER SLEEVES IN SIX (6) INCH LIFTS. SOIL SHALL BE TAMPED INTO PLACE, TAKING CARE TO NOT DAMAGE SLEEVE.
- B. REPAIR ANY DAMAGE FROM IMPROPER COMPACTION.

END OF SECTION

SECTION 32 8424 - IRRIGATION SYSTEM

PART 1 - GENERAL

1.1 DESCRIPTION

- A. PROVIDE A COMPLETE IRRIGATION SYSTEM INSTALLATION AS DETAILED AND SPECIFIED. THIS SHALL INCLUDE FURNISHING ALL LABOR, MATERIAL, EQUIPMENT AND SERVICES NECESSARY TO PROVIDE COMPLETE INSTALLATION. WORK INCLUDES:

- a. TRENCHING
- b. BACKFILL
- c. AUTOMATIC CONTROLLED SYSTEM
- d. AS BUILT DRAWINGS

- B. SLEEVING AS SHOWN SHALL BE FURNISHED BY THE GENERAL CONTRACTOR.
- C. METER AND POWER SHALL BE PROVIDED BY THE GENERAL CONTRACTOR.

1.2 RELATED WORK

- C. REFERENCE IRRIGATION PLANS FOR CONTROLLER, HEAD AND ALL VALVE LOCATIONS.
- D. REFERENCE LANDSCAPE PLANS, NOTES, DETAILS FOR ADDITIONAL REQUIREMENTS.

E. SECTION 32 9300 - LANDSCAPE

F. SECTION 32 8423 - UNDERGROUND IRRIGATION SLEEVE AND UTILITY CONDUITS

1.3 REFERENCE STANDARDS

- A. AMERICAN STANDARD FOR TESTING AND MATERIALS (ASTM) - LATEST EDITION.

1.4 QUALITY ASSURANCE AND REQUIREMENTS

- A. PERMITS AND FEES: THE CONTRACTOR SHALL OBTAIN AND PAY FOR ANY PERMITS NECESSARY AND ALL OBSERVATIONS AS REQUIRED.
- B. MANUFACTURER'S DIRECTIONS: MANUFACTURER'S DIRECTIONS AND DETAILED DRAWINGS SHALL BE FOLLOWED IN ALL CASES WHERE THE MANUFACTURERS OF ARTICLES USED IN THIS CONTRACT FURNISH DIRECTIONS COVERING POINTS NOT SHOWN IN THE DRAWINGS AND SPECIFICATIONS.

- C. ORDINANCES, CODES, AND REGULATIONS: ALL LOCAL, MUNICIPAL AND STATE LAWS, AND RULES AND REGULATIONS GOVERNING OR RELATING TO ANY PORTION OF THIS WORK ARE HEREBY INCORPORATED INTO AND MADE A PART OF THESE SPECIFICATIONS, AND THEIR PROVISIONS SHALL BE CARRIED OUT BY THE CONTRACTOR. ANYTHING CONTAINED IN THESE SPECIFICATIONS SHALL NOT BE CONSTRUED TO CONFLICT WITH ANY OF THE ABOVE RULES AND REGULATIONS AND REQUIREMENTS OF THE SAME.
- D. HOWEVER, WHEN THESE SPECIFICATIONS AND DRAWINGS CALL FOR OR DESCRIBE MATERIALS, WORKMANSHIP, OR CONSTRUCTION OF A BETTER QUALITY, HIGHER STANDARD OR LARGER SIZE THAN IS REQUIRED BY THE ABOVE RULES AND REGULATIONS, THESE SPECIFICATIONS AND DRAWINGS SHALL TAKE PRECEDENCE.

1.5 SCHEDULE OF MATERIALS

A. MATERIALS LIST:

- a. ALL EQUIPMENT MANUFACTURERS AND MODEL NUMBERS SHALL BE AS NOTED ON THE PLANS.

- b. THE CONTRACTOR SHALL FURNISH THE ARTICLES, EQUIPMENT, MATERIALS, OR PROCESSES SPECIFIED BY NAME IN THE DRAWINGS AND SPECIFICATIONS. NO SUBSTITUTION WILL BE ALLOWED WITHOUT PRIOR WRITTEN APPROVAL OF THE LANDSCAPE ARCHITECT.

- c. A COMPLETE MATERIAL LIST OF EQUIPMENT SHALL BE SUBMITTED BEFORE PERFORMING ANY WORK. SUBMITTAL SHOULD INCLUDE ALL MANUFACTURERS' SPECIFICATIONS AND LITERATURE FOR APPROVAL BY THE LANDSCAPE ARCHITECT PRIOR TO INSTALLATION.

- d. EQUIPMENT OR MATERIALS INSTALLED OR FURNISHED WITHOUT PRIOR APPROVAL OF THE LANDSCAPE ARCHITECT MAY BE REJECTED.

- e. APPROVAL OF ANY ITEM, ALTERNATE OR SUBSTITUTE INDICATES ONLY THAT THE PRODUCT OR PRODUCTS APPARENTLY MEET THE REQUIREMENTS OF THE DRAWINGS AND SPECIFICATIONS ON THE BASIS OF THE INFORMATION OR SAMPLES SUBMITTED.

- f. MANUFACTURER'S WARRANTIES SHALL NOT RELIEVE THE CONTRACTOR OF HIS LIABILITY UNDER THE GUARANTEE. SUCH WARRANTIES SHALL ONLY SUPPLEMENT THE GUARANTEE.

1.6 RECORD AND AS BUILT DRAWINGS/SUBMITTALS

- A. CONTRACTOR SHALL PROVIDE AND KEEP UP TO DATE AND COMPLETE "AS-BUILT" RECORD SET OF PRINTS.
- B. CONTRACTOR SHOULD USE ALL SYMBOLS AND NOTATIONS CONSISTENT WITH THE ORIGINAL DRAWINGS.
- C. IN "AS-BUILT" DRAWINGS, CONTRACTOR SHALL LOCATE:
- a. CONNECTION TO EXISTING WATER LINES
- b. CONNECTION TO ELECTRICAL POWER
- c. GATE VALVES
- d. ROUTING OF SPRINKLER PRESSURE LINES

e. SPRINKLER CONTROL VALVES

f. QUICK COUPLING VALVES

g. OTHER RELATED EQUIPMENT

- D. SUBMIT COMPLETED TRACINGS PRIOR TO FINAL ACCEPTANCE. DATE AND SIGN ALL DRAWINGS.

E. EQUIPMENT TO BE FURNISHED:

- a. SUPPLY AS PART OF THIS CONTRACT THE FOLLOWING TOOLS:
- i. QUICK COUPLING KEYS, THREE (3) WITH BOLTER DRAINS ATTACHED USING BRASS REDUCER.

- ii. THREE (3) KEYS FOR EACH AUTOMATIC CONTROLLER

- b. THE ABOVE MENTIONED EQUIPMENT SHALL BE TURNED OVER TO THE OWNER AT THE CONCLUSION OF THE PROJECT.

- F. THE IRRIGATION CONTRACTOR SHOULD DEMONSTRATE THAT THE FINAL INSTALLED SYSTEM WILL OPERATE ACCORDING TO THE INTENT OF THE DESIGNED AND SPECIFIED SYSTEM. IRRIGATION CONTRACTOR SHALL GUARANTEE 100% COVERAGE TO ALL AREAS TO BE IRRIGATION.

1.7 MAINTENANCE AND GUARANTEE

- A. MAINTENANCE AND WORKMANSHIP SHALL BE GUARANTEED FULLY FOR ONE (1) YEAR AFTER FINAL ACCEPTANCE.
- B. PROVIDE MAINTENANCE OF SYSTEM, CLEANING AND ADJUSTMENT OF THE HEADS, FOR ONE (1) YEAR AFTER COMPLETION OF INSTALLATION.

- C. GUARANTEE IS LIMITED TO REPAIR AND REPLACEMENT OF DEFECTIVE MATERIALS AND WORKMANSHIP, INCLUDING THE REPAIR OF BACKFILL SETTLEMENT.

1.8 TESTING

A. PERFORM TESTING REQUIRED WITH OTHER TRADES INCLUDING EARTHWORK, PAVING, PLUMBING, ETC. TO AVOID CUTTING, PATCHING OR BORING.

- B. WATER PRESSURE SHOULD BE FOUND PRIOR TO STARTING CONSTRUCTION. DETERMINE/CONFIRM THAT STATIC WATER PRESSURE IS MORE THAN THE WATER PRESSURE NEEDED FOR THE SYSTEM TO FUNCTION PROPERLY. IF STATIC PRESSURE IS LESS THAN THE DESIGN PRESSURE NEEDED, DO NOT START WORK UNTIL THE LANDSCAPE ARCHITECT IS NOTIFIED.

1.9 COORDINATION

- A. COORDINATE INSTALLATION OF ALL PRODUCTS, INCLUDING EARTHWORK, PAVING AND PLUMBING.

- B. COORDINATE TO ENSURE THAT ELECTRICAL POWER SOURCE IS IN PLACE.

- C. COORDINATE INSTALLATION WITH WORK SPECIFIED IN OTHER SECTIONS.

- D. COORDINATE WITH THE LANDSCAPE CONTRACTOR TO ENSURE PLANT MATERIAL IS UNIFORMLY WATERED IN ACCORDANCE WITH INTENT SHOWN ON DRAWINGS.

PART 2 - PRODUCTS

2.1 MATERIALS

- B. REFER TO CONSTRUCTION DRAWINGS AND NOTES.
- C. SPRINKLER HEADS IN LAWN AREAS AS SPECIFIED ON PLAN

- D. PVC PIPE: CLASS 200 SPR 21

- E. COPPER TUBING (FOR CITY CONNECTIONS): TYPE "M"

- F. 24V WIRE - SIZE 14, TYPE UF

- G. ELECTRIC VALVES TO BE ALL PLASTIC CONSTRUCTION AS INDICATED ON PLANS.

- H. REFER TO DRAWING FOR BACKFLOW PREVENTION LOCATION - COORDINATE EXACT LOCATION WITH THE GENERAL CONTRACTOR.

PART 3 - EXECUTION

3.1 INSPECTION:

A. SITE CONDITIONS:

- a. ALL SCALED DIMENSIONS ARE APPROXIMATE. THE CONTRACTOR SHALL CHECK AND VERIFY ALL SIZE DIMENSIONS.

- b. EXERCISE EXTREME CARE IN EXCAVATING AND WORKING NEAR UTILITIES. CONTRACTOR SHALL BE RESPONSIBLE FOR DAMAGES TO UTILITIES WHICH ARE CAUSED BY ANY OF HIS OPERATIONS OR NEGLIGENCE.

- c. COORDINATE INSTALLATION OF IRRIGATION MATERIALS, INCLUDING PIPE, SO THERE SHALL BE NO INTERFERENCE WITH UTILITIES OR OTHER CONSTRUCTION DIFFICULTY IN PLANTING TREES, SHRUBS, AND GROUNDCOVERS. COORDINATE WORK WITH OTHER SITE CONTRACTORS.

3.2 PREPARATION

A. PHYSICAL LAYOUT:

- a. PIPING AND HEAD LAYOUT AS SHOWN ON PLANS IS SCHEMATIC ONLY. ALL PIPES TO BE INSTALLED DIRECTLY BEHIND CURBS, WALKS AND WALLS WHEREVER POSSIBLE.

- b. PRIOR TO INSTALLATION CONTRACTOR SHALL STAKE OUT ALL PRESSURE SUPPLY LINES, ROUTING AND LOCATION OF SPRINKLER HEADS.

- c. ALL LAYOUTS SHALL BE APPROVED BY THE LANDSCAPE ARCHITECT OR OWNER'S REPRESENTATIVE PRIOR TO INSTALLATION.

B. WATER SUPPLY:

- a. IRRIGATION SYSTEM SHALL BE CONNECTED TO WATER SUPPLY POINTS OF CONNECTION AS INDICATED ON THE DRAWINGS.

- b. CONNECTIONS SHOULD BE MADE AT APPROXIMATE LOCATIONS AS SHOWN ON DRAWINGS. CONTRACTOR SHALL VERIFY IN FIELD AND BE RESPONSIBLE FOR MINOR CHANGES CAUSED BY ACTUAL SITE CONDITIONS.

3.3 INSTALLATION

A. TRENCHING

- a. DIG TRENCHES STRAIGHT 6" WIDE WITH NEAR VERTICAL SIDE AND SUPPORT PIPE CONTINUOUSLY ON BOTTOM OF TRENCH. REMOVE LUMBER, RUBBISH, LARGE ROCKS ETC. FROM TRENCHES. LAY PIPE TO AN EVEN GRADE - WITH A FIRM, UNIFORM BEARING FOR ENTIRE LENGTH OF PIPE.

- b. REMOVE FOREIGN MATTER OR DIRT FROM INSIDE OF PIPE BEFORE WELDING AND KEEP PIPING CLEAN BY ANY MEANS POSSIBLE DURING AND AFTER LAYING OF PIPE.

- c. PROVIDE A MINIMUM OF EIGHTEEN (18) INCHES OF COVER FOR ALL PRESSURE SUPPLY LINES.

- d. PROVIDE A MINIMUM OF TWELVE (12) INCHES OF COVER FOR ALL NON-PRESSURE LINES.

- e. PROVIDE A MINIMUM COVER OF EIGHTEEN (18) INCHES FOR ALL CONTROL WIRING.

- f. NO MACHINE TRENCHING, UNLESS APPROVED BY THE LANDSCAPE ARCHITECT. SHALL BE DONE WITHIN DRIP LINE OF EXISTING TREES. TRENCHING SHOULD BE DONE BY HAND, TUNNELING OR BORING OR OTHER METHODS APPROVED BY THE LANDSCAPE ARCHITECT. IT SHOULD BE UNDERSTOOD THAT PIPING LAYOUT IS DIAGRAMMATIC AND PIPING SHALL BE ROUTED AROUND TREES AND SHRUBS IN SUCH A MANNER TO AVOID DAMAGE TO PLANTS.

B. BACKFILL

- a. TRENCHES SHALL NOT BE BACKFILLED UNTIL ALL REQUIRED TESTS ARE PERFORMED. TRENCHES SHALL BE CAREFULLY BACKFILLED WITH THE EXCAVATED MATERIALS APPROVED FOR BACKFILLING, CONSISTING OF EARTH, LOAM, SANDY CLAY, SAND OR OTHER APPROVED MATERIALS, FREE FROM LARGE CLOUDS, STONES OR STICKS.

- b. IF SETTLEMENT OCCURS AND SUBSEQUENT ADJUSTMENTS IN PIPE, VALVES, SPRINKLER HEADS, LAWN OR PLANTING OR OTHER

CONSTRUCTION ARE NECESSARY, THE CONTRACTOR SHALL MAKE ALL REQUIRED ADJUSTMENTS WITHOUT THE COST TO THE OWNER.

C. TRENCHING AND BACKFILL UNDER PAVING:

- a. ALL IRRIGATION MAIN LINE AND LATERAL LINES OR WIRING LOCATED UNDER AREAS WHERE PAVING, ASPHALTIC PAVING, OR CONCRETE SHALL BE INSTALLED IN SCHEDULE 40 PVC SLEEVES OF ADEQUATE SIZE. SEE SECTION 32 8423.

D. ASSEMBLIES

- a. INSTALL ALL ASSEMBLIES SPECIFIED HEREIN IN ACCORDANCE WITH RESPECTIVE DETAILS. IN ABSENCE OF DETAIL DRAWINGS OR SPECIFICATIONS, PERFORM SUCH WORK IN ACCORDANCE WITH BEST STANDARD PRACTICES OR MANUFACTURER'S RECOMMENDATIONS AS APPROVED BY THE LANDSCAPE ARCHITECT.

- b. MAKE SOLVENT WELDED JOINTS USING ONLY THE SOLVENT RECOMMENDED BY THE MANUFACTURER. PIPES AND FITTINGS SHOULD BE CLEANED OF ALL DIRT AND DUST AND MOISTENED BEFORE APPLYING SOLVENT.

- c. ON PVC TO METAL CONNECTIONS, THE CONTRACTOR SHALL WORK METAL CONNECTIONS FIRST. USE NON HARDENING PIPE DOPE ON TEFELON TAPE ON THREADED PVC ADAPTERS INTO WHICH PIPE MAY BE WELDED. LIGHT WRENCH PRESSURE IS ALL THAT IS REQUIRED, USE THREADED PVC ADAPTERS INTO WHICH THE PIPE MAY BE WELDED.

- d. LINE CLEARANCE: ALL LINES SHALL HAVE A MINIMUM CLEARANCE OF SIX (6) INCHES FROM EACH OTHER AND FROM OTHER TRADES. PARALLEL LINES SHALL NOT BE DIRECTLY INSTALLED ONE OVER THE OTHER.

- e. WIRING: SUPPLY WIRE FROM THE AUTOMATIC CONTROLLER TO ALL THE VALVES. A SEPARATE WIRE IS REQUIRED TO EACH ELECTRIC VALVE. A COMMON NEUTRAL WIRE IS ALSO REQUIRED FROM EACH CONTROL TO EACH OF THE VALVES. BUNDLE MULTIPLE WIRES AND TAPE THEM TOGETHER AT TEN FOOT INTERVALS. EXPANSION COILS OF TEN INCHES SHALL BE INSTALLED APPROXIMATELY EVERY 100 FEET. MAKE ALL SPLICES WATERPROOF.

- f. AUTOMATIC CONTROLLER: INSTALL AS PER MANUFACTURER'S SPECIFICATIONS AND INSTRUCTIONS. REMOVE CONTROL VALVES SHALL BE CONNECTED TO CONTROLLER IN NUMERICAL SEQUENCE AS SHOWN ON THE DRAWINGS. EACH REMOTE CONTROL VALVE SHALL BE WIRED TO ONE STATION OF THE CONTROLLER.

H. REMOTE CONTROL VALVES:

- a. INSTALL WHERE SHOWN ON DRAWINGS AND DETAILS. VALVES SHALL BE SIZED ACCORDING TO THE DRAWINGS.

- b. INSTALL IN A LEVEL POSITION IN ACCORDANCE TO MANUFACTURER'S SPECIFICATIONS.

- c. WHEN GROUPED TOGETHER, ALLOW AT LEAST TWELVE (12) INCHES BETWEEN VALVES. INSTALL EACH REMOTE CONTROL VALVE IN A SEPARATE VALVE BOX. EACH VALVE NUMBER AND ITS CONTROLLER LETTER SHALL BE STENCILED INSIDE VALVE BOX TOP WITH EXTERIOR PAINT.

I. FLUSHING OF SYSTEM:

- a. AFTER ALL NEW SPRINKLER PIPE LINES AND RISERS ARE IN PLACE AND CONNECTED, ALL NECESSARY WORK HAS BEEN COMPLETED, AND PRIOR TO INSTALLATION OF SPRINKLER HEADS, THE CONTROL VALVES SHALL BE OPENED AND A FULL HEAD OF WATER USED TO FLUSH OUT THE SYSTEM.

- b. SPRINKLER HEADS SHALL BE INSTALLED ONLY AFTER FLUSHING OF THE SYSTEM HAS BEEN ACCOMPLISHED.

J. SPRINKLER HEADS:

- a. INSTALL HEADS AS DESIGNED ON THE DRAWINGS. MAKE APPROPRIATE ADJUSTMENTS TO HEAD LAYOUT TO ACCOMMODATE FOR ACTUAL FIELD CONDITIONS.

- b. SPACING OF HEADS SHALL NOT EXCEED THE MAXIMUM INDICATED ON THE DRAWINGS. IN NO CASE SHALL THE SPACING EXCEED THE MAXIMUM

RECOMMENDED BY THE MANUFACTURER.

- C. ALL SPRINKLERS TO ATTACH TO LATERAL LINES WITH FLEXIBLE CONNECTORS. REFERENCE DETAILS ON DRAWINGS.

3.4 TESTING

- A. THE CONTRACTOR SHALL TEST SPRINKLER MAIN FOR TWELVE TO FOURTEEN HOURS UNDER NORMAL PRESSURE. IF LEAKS ARE PRESENT, REPLACE JOINT OR JOINS AND REPEAT TEST.

- B. A COMPLETE TEST SHALL BE MADE PRIOR TO BACKFILLING. BACKFILLING MATERIALS MAY BE PLACED IN TRENCHES IN LIFTS TO ENSURE STABILITY OF THE LINE UNDER THE PRESSURE OF BACKFILL. IN EACH CASE, LEAVE FITTINGS AND COUPLINGS OPEN TO VISUALLY INSPECT FOR FULL PERIOD OF TEST.

- C. WHEN SYSTEM IS COMPLETE, A COVERAGE TEST SHALL BE PERFORMED IN THE PRESENCE OF THE LANDSCAPE ARCHITECT OR OWNER'S REPRESENTATIVE. IT SHALL BE DETERMINED IF THE WATER COVERAGE FOR ALL PLANTING AREAS IS COMPLETE AND ADEQUATE. FURNISH ALL MATERIALS AND PERFORM ALL WORK REQUIRED TO CORRECT ANY INADEQUACIES OF COVERAGE.

- D. UPON COMPLETION OF EACH PHASE OF WORK, THE ENTIRE SYSTEM SHOULD BE TESTED AND ADJUSTED TO MEET SITE REQUIREMENTS.

END OF SECTION

END OF SECTION

END OF SECTION

END OF SECTION

END OF SECTION

END OF SECTION

END OF SECTION

END OF SECTION

END OF SECTION

END OF SECTION

END OF SECTION

END OF SECTION

END OF SECTION

END OF SECTION

END OF SECTION

END OF SECTION

END OF SECTION

END OF SECTION

END OF SECTION

END OF SECTION

END OF SECTION

END OF SECTION

END OF SECTION

END OF SECTION

END OF SECTION

END OF SECTION

END OF SECTION

END OF SECTION

END OF SECTION

END OF SECTION

END OF SECTION

END OF SECTION

END OF SECTION

END OF SECTION

END OF SECTION

END OF SECTION

END OF SECTION

END OF SECTION

END OF SECTION

END OF SECTION

END OF SECTION

END OF SECTION

END OF SECTION

END OF SECTION

END OF SECTION

END OF SECTION

END OF SECTION

END OF SECTION

END OF SECTION

END OF SECTION

END OF SECTION

END OF SECTION

END OF SECTION

END OF SECTION

END OF SECTION

END OF SECTION

END OF SECTION

END OF SECTION

END OF SECTION

END OF SECTION

END OF SECTION

END OF SECTION

END OF SECTION

END OF SECTION

END OF SECTION

END OF SECTION

END OF SECTION

END OF SECTION

END OF SECTION

END OF SECTION

END OF SECTION

END OF SECTION

END OF SECTION

END OF SECTION

END OF SECTION

END OF SECTION

END OF SECTION

END OF SECTION

END OF SECTION

END OF SECTION

END OF SECTION

END OF SECTION

END OF SECTION

END OF SECTION

END OF SECTION

END OF SECTION

END OF SECTION

END OF SECTION

END OF SECTION

END OF SECTION

END OF SECTION

END OF SECTION

END OF SECTION

END OF SECTION

END OF SECTION

END OF SECTION

END OF SECTION

END OF SECTION

END OF SECTION

END OF SECTION

END OF SECTION

END OF SECTION

END OF SECTION

END OF SECTION

END OF SECTION

END OF SECTION

END OF SECTION

END OF SECTION

END OF SECTION

END OF SECTION

END OF SECTION

END OF SECTION

END OF SECTION

END OF SECTION

END OF SECTION