

**PLANTING NOTES**

- A. CONTRACTOR IS TO REVIEW PLANS, VERIFY SITE CONDITIONS AND PLANT QUANTITIES PRIOR TO INSTALLATION. CONFLICTS BETWEEN THE SITE AND THESE PLANS OR WITHIN THESE PLANS SHALL BE BROUGHT TO THE ATTENTION OF THE OWNER'S AUTHORIZED REPRESENTATIVE PRIOR TO LANDSCAPE INSTALLATION.
- B. ALL TREES SHALL HAVE A MINIMUM 1 1/2" CALIPER AT A POINT 6 INCHES ABOVE ROOT BALL. ALL OTHER MEASUREMENTS SUCH AS NUMBER OF CANES, BALL SIZES, QUALITY DESIGNATIONS, ETC. SHALL BE IN ACCORDANCE WITH THE LATEST EDITION OF "ARIZONA NURSERY ASSOCIATION SPECIFICATIONS"
- C. LANDSCAPE ARCHITECT SHALL APPROVE PLANT MATERIAL PLACEMENT BY CONTRACTOR.
- D. SEE PLANTING DETAILS FOR PLANTING AND STAKING REQUIREMENTS.
- E. SITE UTILITIES AND OTHER OBJECTS SHALL BE SCREENED FROM VIEW WITH LANDSCAPE WHEREVER POSSIBLE.
- F. FINISH GRADE TO BE 2" BELOW CURB OR WALK FOR GROUND COVER AREAS.
- G. CONTRACTOR TO INCLUDE IN HIS BID THE REPAIR OF ANY AND ALL DAMAGE RESULTING FROM INSTALLATION OF UTILITIES. REPAIR TO INCLUDE ALL DAMAGED IRRIGATION AND PLANTING ITEMS. CONNECT TO EXISTING CONDITIONS.
- H. ALL TREES WITHIN 7' OF HARDSCAPE ELEMENTS, SUCH AS CURBS, WALLS, BUILDINGS OR WALKS, SHALL BE PROVIDED WITH DEEP ROOT BARRIER CONTROL DEVICES OR APPROVED EQUAL.
- I. ALL DRIVEWAYS, ALLEYS AND STREET INTERSECTIONS TO HAVE SIGHT VISIBILITY CLEARANCE BETWEEN 24' TO 8'-0" CLEAR.
- J. ALL PLANTING AND IRRIGATION ON THIS PROJECT SHALL ADHERE TO CITY OF MESA LANDSCAPE STANDARDS.
- K. THE LANDSCAPE CONTRACTOR IS RESPONSIBLE FOR AND SHALL MAINTAIN ALL LANDSCAPING FOR 90 DAYS POST FINAL INSPECTION.
- L. THE LANDSCAPE CONTRACTOR SHALL MAINTAIN ALL PLANTED AREAS BY MEANS OF CONTINUOUS WATERING, PRUNING, RAISING TREE BALLS WHICH SETTLE BELOW GRADE, APPLICATION OF SPRAYS WHICH ARE NECESSARY TO KEEP THE PLANTINGS FREE OF INSECTS AND DISEASES, FERTILIZING, WEEDING, ROLLING, MOWING, EDGING, RESEEDING, AND/OR OTHER OPERATIONS NECESSARY FOR PROPER CARE AND UPKEEP. THE LANDSCAPE CONTRACTOR SHALL MAINTAIN ALL PLANTINGS AS SPECIFIED ABOVE FOR A PERIOD OF NINETY (90) DAYS. CONTACT STORE MANAGER FOR ONE YEAR SERVICE CONTRACT. CONTRACTOR TO WALK LANDSCAPE AND IRRIGATION W/STORE MANAGER TO ENSURE EVERYTHING IS IN WORKING ORDER AND THAT THE PLANTS ARE HEALTHY AND IS READY TO BE TAKEN OVER BY ANOTHER MAINTENANCE COMPANY IF APPLICABLE.
- M. REFER TO SPECIFICATIONS FOR STANDARDS OF MATERIALS AND WORKMANSHIP.
- N. ALL SHRUB AREAS TO BE TOP DRESSED WITH 1/2" SCREENED DECOMPOSED GRANITE AT 2" MINIMUM THICKNESS - PROVIDE PRE-EMERGENT HERBICIDE AFTER GRANITE HAS BEEN LAID. GOLD/TAN COLOR. LOCALLY QUARRIED.

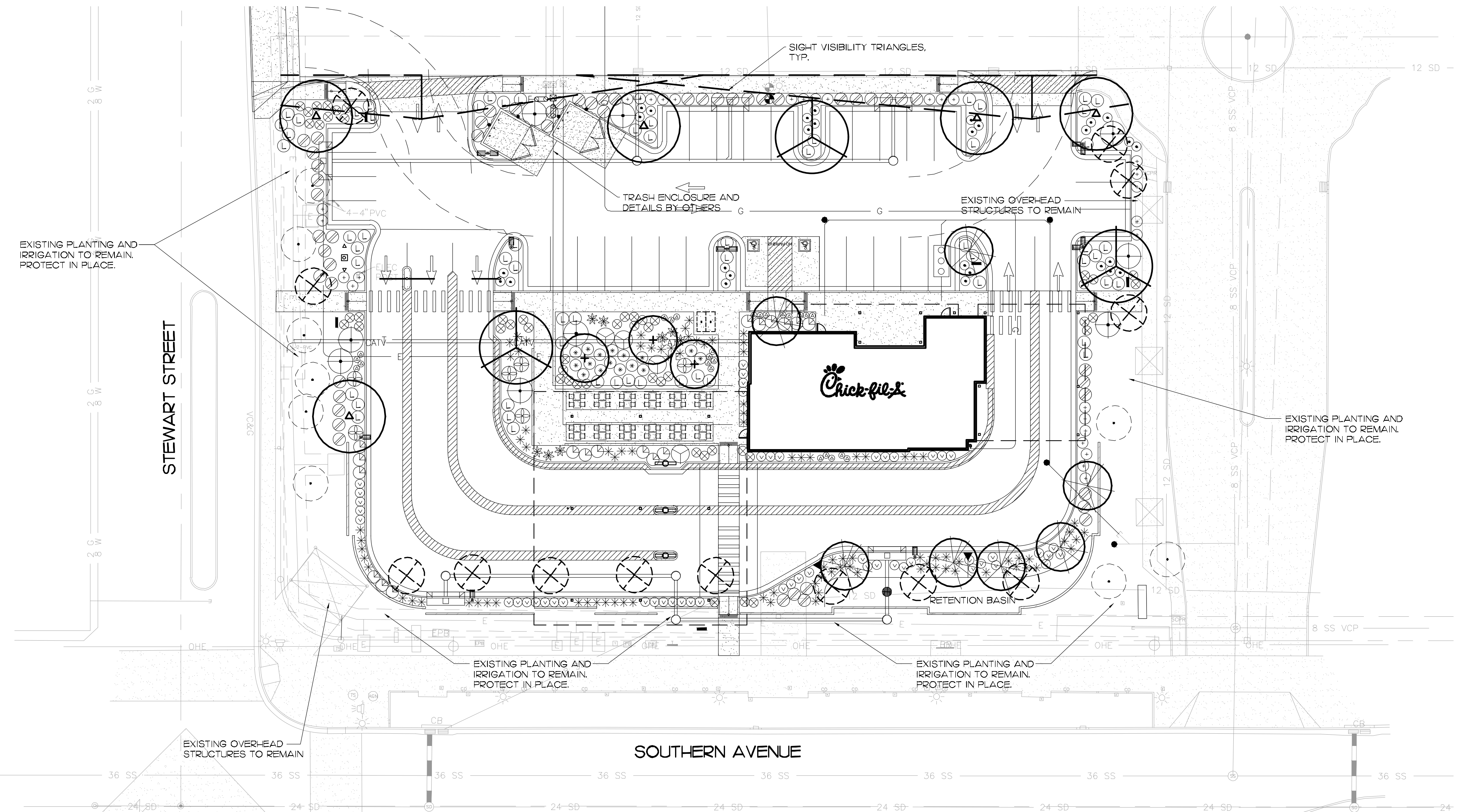

**PLANTING LEGEND**

SYMBOL	BOTANICAL NAME	COMMON NAME	SIZE	QTY	REMARKS
<b>TREES</b>					
+	ACACIA WILLIARDIANA	PALO BLANCO	24' BOX 1.75-2.5" CALIPER	3	MULTI-TRUNK 20' O.C. MINIMUM 10'-12" H X 5'-7" W
Δ	CERCIDIUM HYBRID 'DESERT MUSEUM'	DESERT MUSEUM PALO VERDE	36' BOX 2-1/2" CALIPER MINIMUM *	6	HIGH BRANCHING 20' O.C. MINIMUM 12" H X 6'-8" W
⊙	CHILOPSIS LINEARIS	DESERT WILLOW	24' BOX 1.75-2.5" CALIPER	7	STANDARDS 20' O.C. MINIMUM 10'-12" H X 5'-7" W
⊙	RHUS LANCEA	AFRICAN SUMAC	36' BOX 2-1/2" CALIPER MINIMUM *	3	STANDARDS 20' O.C. MINIMUM
⊙	EXISTING TREE TO REMAIN	SEE LEGEND	--	9	PROTECT IN PLACE
⊙	EXISTING TREE TO BE REMOVED	SEE LEGEND	--	13	REMOVE FROM SITE

<b>SHRUBS</b>					
⊕	AGAVE 'BLUE FLAME'	BLUE FLAME CENTURY PLANT	5 GAL	6	AS SHOWN
*	AGAVE DESMETTIANA	SMOOTH AGAVE	5 GAL	8	AS SHOWN
⊕	ALOE 'BLUE ELF'	BLUE ELF ALOE	5 GAL	25	AS SHOWN
⊕	CAESALPINIA PULCHERRIMA	RED BIRD OF PARADISE	15 GAL	9	AS SHOWN
⊗	CHRYSACTINIA MEXICANA	DAMIANITA DAISY	1 GAL	51	3'-0" O.C.
⊕	ECHINOCACTUS GRISONII	GOLDEN BARREL CACTUS	5 GAL	16	AS SHOWN
⊕	HESPERALOE FUNIFERA	GIANT HESPERALOE	5 GAL	4	AS SHOWN
⊕	HESPERALOE PARVIFLORA	RED YUCCA	5 GAL	31	AS SHOWN
⊕	LANTANA MONTEVIDENSIS 'NEW GOLD'	NEW GOLD LANTANA	5 GAL	64	3'-0" O.C.
⊕	LEUCOPHYLLUM FRUTESCENS 'HEAVENLY CLOUD'	HEAVENLY CLOUD TEXAS SAGE	5 GAL	61	4'-0" O.C.
*	MUHLENBERGIA RIGENS	DEER GRASS	5 GAL	96	3'-0" O.C.
⊕	PENNISETUM SETACEUM 'PURPUREUM'	PURPLE FOUNTAIN GRASS	5 GAL	44	3'-0" O.C.
⊕	RUELLIA BRITTONIANA 'KATIE'	DWARF KATIE RUELLIA	5 GAL	18	4'-0" O.C.
⊕	SALVIA GREGGII	AUTUMN SAGE	5 GAL	52	3'-0" O.C.

<b>VINES</b>					
—	MACFADYENA UNGUIS-CATI	CAT'S CLAW VINE	5 GAL	4	AS SHOWN STAKE TO WALL

<b>GROUND COVER</b>					
NO SYMBOL	DECOMPOSED GRANITE	'DESERT VISTA BROWN'	SELECT	18,115 SF	3/4" SCREENED, 3" DEPTH EXACT COLOR TO MATCH CENTER

NOTE: ALL PLANT QUANTITIES ARE FOR CITY PURPOSES ONLY. CONTRACTOR SHALL VERIFY ALL TOTALS FOR BID PURPOSES.

**LANDSCAPE CALCULATIONS**

SHRUB AND GROUND COVER AREA:	18,115 SF.
TURF AREA:	0 SF.
TOTAL LANDSCAPE AREA:	18,115 SF.

NOTES: SIGHT VISIBILITY TRIANGLES

2111.4 SVTS SHALL BE CLEAR OF FENCES, WALLS, SI-RUBBERY, TREES AND ANY OTHER OBSTRUCTIONS TO VISION BETWEEN A HEIGHT OF TWO AND ONE-HALF FEET (2.5) AND EIGHT FEET (8) ABOVE THE SIDEWALK OR TO FOURTEEN FEET (14) ABOVE THE ROADWAY. HOWEVER, TREES MAY BE CONSIDERED WITHIN SVTS AS LONG AS THEY ARE A SINGLE TRUNK VARIETY WITH A DIAMETER OF NO MORE THAN TWELVE INCHES (12) AT FULL GROWTH. THEIR CANOPIES ARE PLANTED AND MAINTAINED AT EIGHT FEET (8) ABOVE THE SIDEWALK OR FOURTEEN FEET (14) ABOVE THE ROADWAY, AND THEY ARE NOT SPACED IN A MANNER THAT CREATES A PICKET FENCE EFFECT, AS DETERMINED BY THE TRANSPORTATION DEPARTMENT. ANY TREES THAT ARE TO BE LOCATED WITHIN SVTS MUST BE REVIEWED AND APPROVED BY THE TRANSPORTATION DEPARTMENT. FIELD CHANGES MAY BE REQUIRED FOR THE ACCEPTANCE OF A LANDSCAPING PERMIT IF IT IS FOUND THAT THE SVT IS ADVERSELY IMPACTED BY NEW LANDSCAPING.

**PRELIMINARY PLANTING PLAN**  
1" = 20'-0"

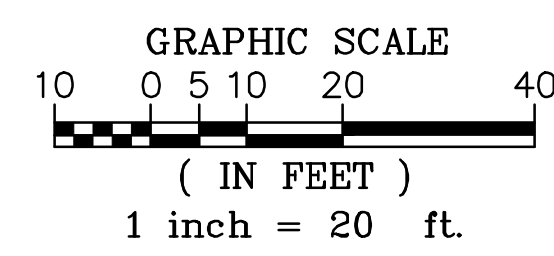

CALL TWO WORKING DAYS BEFORE YOU DIG  
**602-263-1100**  
**1-800-STAKE-IT**  
(OUTSIDE MARICOPA COUNTY)

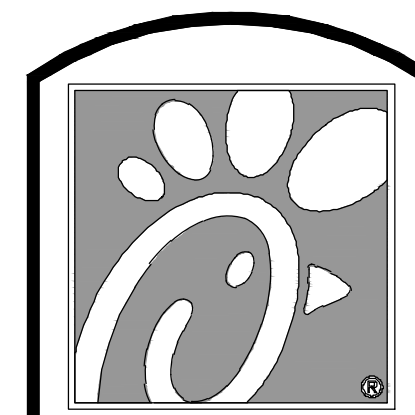

**Chick-fil-A**

5200 Buffington Rd.  
Atlanta Georgia,  
30349-2998

Revisions:  
Mark Date By

△ \_\_\_\_\_

Mark Date By

△ \_\_\_\_\_

Mark Date By

△ \_\_\_\_\_

Seal

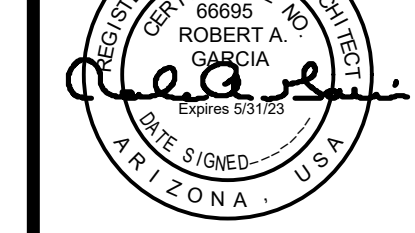

02-06-23



hourian associates, inc.  
landscape architecture + design  
san clemente | santa barbara, california  
o. 949-489-5623 f. 858-810-0355

STORE  
1320 W. SOUTHERN AVENUE

MESA, AZ 85202

SHEET TITLE  
PRELIMINARY  
PLANTING PLAN

VERSION:  
ISSUE DATE:

Job No. : 22-014

Store : 05202

Date : 02/06/23

Drawn By : RA/BG

Checked By : BG

Sheet

**L.I.O.**