

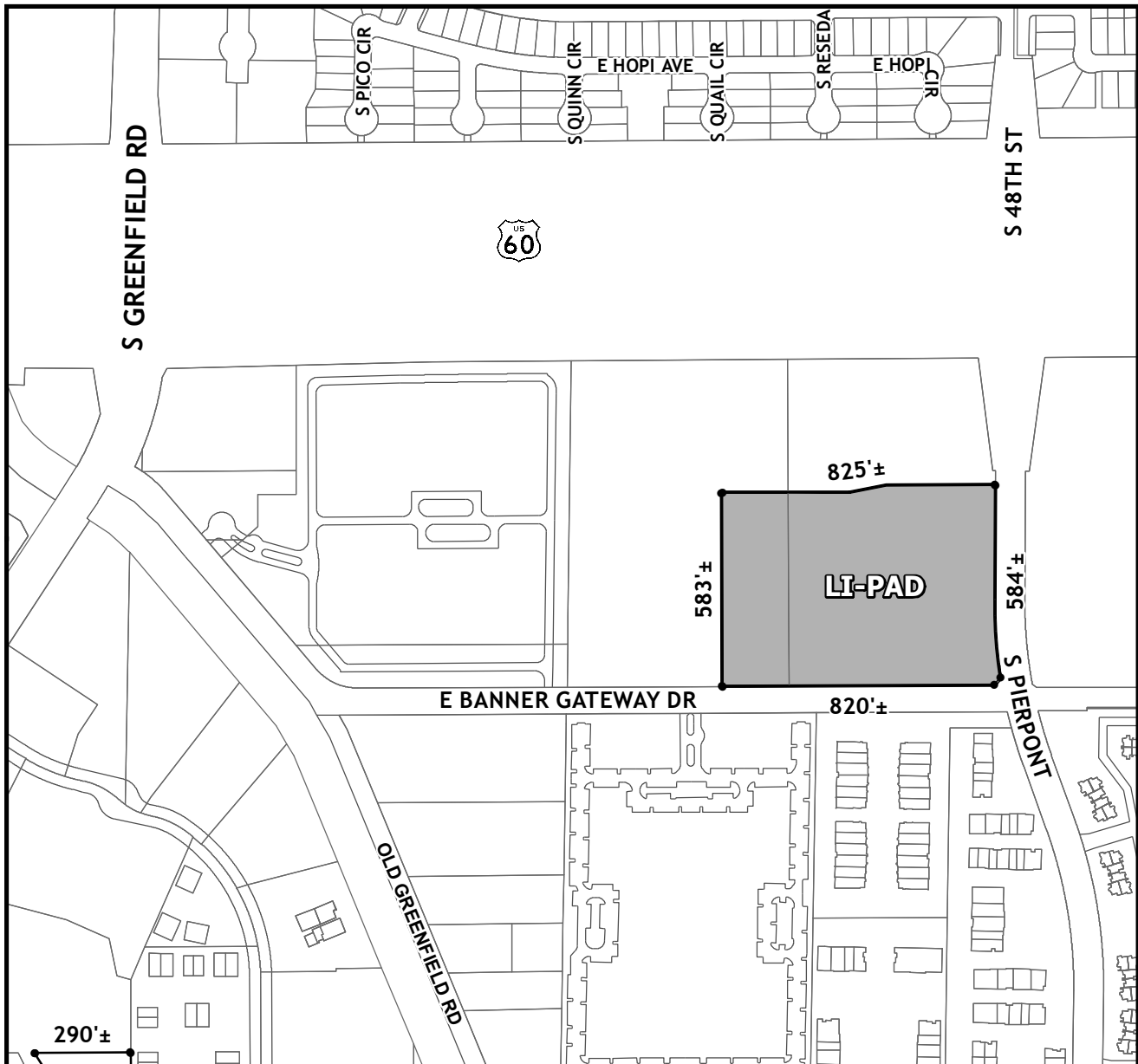

OFFICIAL SUPPLEMENTARY ZONING MAP AMENDING THE CITY OF MESA ZONING MAP



CASE: ZON22-01263

ACREAGE: 13±

REQUEST: Rezone from Light Industrial (LI) and Light Industrial with a Planned Area Development overlay (LI-PAD) to Light Industrial with a Planned Area Development overlay (LI-PAD) and Site Plan Review.

ORDINANCE: _____

Please be advised that the attached zoning changes were approved by the Mesa City Council on _____, 2023 by Ordinance # _____. If you have any questions concerning these changes, contact the City of Mesa Planning Division at 480-644-2385.

ATTEST: _____ DATE: _____

MAYOR

CITY CLERK