

RG-9 #5
#1

Special Event Liquor License Application Attachment B

Licensing Office
55 North Center Street
Mailing Address:
PO Box 1466
Mesa, Arizona 85211-1466
480-644-2316 Telephone
480-644-3999 Fax
www.mesaaz.gov



If you intend to serve alcohol at your special event, you will need to obtain a Special Event Liquor License or an Extension of Premises from the City of Mesa Licensing Office. This must be submitted at least 60 days prior to the event. A license is required with special provisions outlined. Plan a minimum of 60 days to complete this process.

Check all that apply:

☐ Free/Host Alcohol
☐ Beer

☒ Alcohol Sales
☒ Beer and Wine

☐ Host and Sale Alcohol
☐ Beer, Wine and Distilled Spirits

Do you plan to secure a:

☒ **Special Event Liquor License** - The Special Event Liquor License fee is \$25 and must be approved by the City Council. After city approval, your application must be submitted to, and approved by, the State of Arizona. There are fees involved at the State. This license can only be obtained by a non-profit organization, 501(C). (Complete the State of Arizona Special Event Liquor Application and site plan and submit it with this Attachment B.)

☐ **Extension of Premises License** - There is no fee involved with the Extension of Premises. This is allowed when a liquor license is already in effect and you want to extend the area where liquor is sold. (Complete the State of Arizona

Extension of Premises Application and site plan and submit it with this Attachment B.)

If this is an Extension of Premises, are there any other activities taking place except for the sale of liquor in the extended area? No ☒ Yes ☐ Type of activities taking place: _____

Please describe your security plan to ensure the safe sale or distribution of alcohol at your event Perimeter
barriers outside of venue, requiring wrist bands w/ ID

If applying for a Special Event Liquor License the following must be provided:

St. Bridget Roman Catholic Parish 53-0196617 TS
Charity's or Organization's Name 501 (C) #

Pat Shaneyfelt Parish Manager
Name of Contact at Charity/Organization Title with Organization

Dennis Schauer
On-Site Agent Responsible for Liquor

How will attendees over the age of 21 be identified? wrist bands

What controls will be used to keep attendees under the age of 21 from obtaining alcohol at the event? _____

Knight's of Columbus security volunteers

Will food be served? Yes ☒ No ☐ If yes, what type of food will be served Mexican catering

Seating capacity of designated area: # 275

CSR:
Amount:

RECEIVED
DEC 19 2022
CITY OF MESA
LICENSING OFFICE



SPECIAL EVENT LICENSE
APPLICATION FEE \$25.00 PER DAY

Arizona Department of Liquor Licenses and Control
800 W. Washington St. 5th Floor Phoenix, AZ 85007
(602) 542-5141

DLLC USE ONLY

Job #:
Date Accepted:
CSR:
License #:

Application MUST be submitted to the Department of Liquor 10 days prior to the event.

SECTION 1 Applicant must be a member of a qualifying nonprofit organization, political party, or Government entity and authorized by an Officer, Director, or Chairperson of the Organization.

1. Applicant: Dennis Schauer
(Must be an Officer/Member of the Non Profit Entity) Last First Middle
2. Applicant's mailing address: 6263 E. Oasis St Mesa Az 85215
Street City State Zip
3. Applicants home/cell phone: [REDACTED] Applicant's business phone: _____
4. Applicant's email address: finance@Stbridget.org
5. Special Event Name: Irish Festival
6. Name of Non-Profit Organization, Candidate or Political Party/Gov: St. Bridget Roman Catholic Parish
7. Non-Profit/IRS Tax Exempt Number: 53-0196617
8. Arizona Corporation Commission File #: 14600276 If out of State please specify: _____
(Attach letter of good standing)
9. Event Location Name: St Bridget Church Plaza
10. Event Address: 2213 N. Lindsay Road, Mesa Az 85213

Dates and Hours of Event - Days must be consecutive and may not exceed 10 consecutive days.

****SEPARATE APPLICATION FOR EACH "NON-CONSECUTIVE" DAY****

Days	Date	Day of Week	Event Start Time AM/PM	License End Time AM/PM
DAY 1:	<u>2/18/2023</u>	<u>Saturday</u>	<u>5:30 pm</u>	<u>8:00 pm</u>
DAY 2:	_____	_____	_____	_____
DAY 3:	_____	_____	_____	_____
DAY 4:	_____	_____	_____	_____
DAY 5:	_____	_____	_____	_____
DAY 6:	_____	_____	_____	_____
DAY 7:	_____	_____	_____	_____
DAY 8:	_____	_____	_____	_____
DAY 9:	_____	_____	_____	_____
DAY 10:	_____	_____	_____	_____

SECTION 2 What type of security and control measures will you take to prevent violations of liquor laws at this event?
(List type and number of police/security personnel and type of fencing or control barriers, if applicable.)

Number of Police 6 Number of Security Personnel ☐ Fencing ☒ Barriers

Must explain security measures: Event is in a secure location. Barriers will be placed at access points near parking lot. signage will be posted. ID will be required and wrist band given for purchase of alcohol.

SECTION 3 What is the purpose of this event?

☒ On-site consumption ☐ Off-site (auction/wine/distilled spirits pull) ☐ Both

How is this special event going to conduct all dispensing, serving, and selling of spirituous liquors?
Check one of the following boxes. (R-19-318)

- A) ☒ Special Event being held on an **unlicensed** premises will require approval and signature by the Local Governing Body on page 3. (If checked move to section 4)
- B) ☐ Will this event be held on a currently licensed premises and within the already approved and licensed area?
(Must attach a letter from the licensed premises with an explanation of the option checked below)

Name of Business

License Number

Phone (include Area Code)

- ☐ Place license in non-use - Special Event Licensee selling all alcohol without retailer involvement
Must attach letter from the location suspending license for duration of special event
- ☐ Dispense and serve all spirituous liquors under retailer's license - Business operates normally, minimum of 25% of gross revenue from alcohol sales is donated to licensee
- ☒ Dispense and serve all spirituous liquors under special event - The special event licensee is in charge of selling alcohol that was purchased or donated by the special event licensee. The retailers existing alcohol inventory must be separated from any alcohol used during the special event. **Must attach letter from the location suspending license for duration of special event**
- ☐ Split premise between special event and retail location - Both the special event licensee and the retailer will conduct sales of alcohol. (These sales will be done in separate areas. If alcohol is donated or purchased by the special event licensee it must be in a separate area than the alcohol that is dispensed by the licensed retailer.)
- ☐ Off Sale only - Wine/Distilled Spirits Pull, Live or Silent Auctions - Retailer will still be permitted to conduct all normal sale and service of alcohol.

SECTION 4

1. Has the applicant been convicted of a felony, or had a liquor license revoked within the last five (5) years?
☐ Yes ☒ No If yes, attach letter of explanation.
2. How many special event days have been issued to this organization during the calendar year? 0
3. Is the Organization using the services of a Special Event Contractor? (A licensee can utilize the services of a special event contractor who may purchase and sell alcohol on behalf of the licensee. If no special event contractor is listed, the licensee is responsible for the sales and service of alcohol.)
☐ Yes ☒ No If yes, please provide the Name of the Special Event Contractor: _____
4. Is the organization using the services of a series 6, 7, 11, or 12 licensee to manage the sale or service of alcohol? (Licensees who hold a series 6, 7, 11, or 12 license are automatically qualified to be the special event contractor)
☐ Yes ☒ No If yes, please provide the Name of Licensee: _____ License #: _____

5. List the name of the Individual or Organization that will receive revenues, **MUST EQUAL 100 PERCENT.**

Attach additional sheet if necessary.

Name: St Bridget Roman Catholic Parish Percentage: 100%

Address: 2213 N. Lindsay Road Mesa AZ 85213
Street City State Zip

Name: _____ Percentage: _____

Address: _____
Street City State Zip

Please read A.R.S. § 4-203.02 Special event license: rules and R19-1-205 Requirements for a Special Event License.

ALL ALCOHOLIC BEVERAGE SALES MUST BE FOR CONSUMPTION AT THE EVENT SITE ONLY.

**NO ALCOHOLIC BEVERAGES SHALL LEAVE A SPECIAL EVENT UNLESS THEY ARE IN AUCTION WINE OR DISTILLED SPIRITS
PULL SEALED CONTAINERS OR THE SPECIAL EVENT LICENSE IS STACKED WITH WINE /CRAFT DISTILLERY FESTIVAL LICENSE.**

SECTION 5 License premises diagram. The licensed premises for your special event is the area in which you are authorized to sell, dispense or serve alcoholic beverages under the provisions of your license. Please attach a diagram of your special event licensed premises. Please show dimensions, serving areas, fencing, barricades, or other control measures and security position.



If the special event will be held at a location without a permanent liquor license or if the event will be on any portion of a location that is not covered by the existing liquor license, this application must be approved by the local governing body before submitting to the Department of Liquor Licenses and Control. Please contact the local governing board for additional information.

APPLICANT SIGNATURE

Declaration:

I, (Print Name) Dennis Schauer, declare under penalty of perjury that I am authorized to submit this application. I have read the contents of this application, and to the best of my knowledge believe all statements made on this application to be true, correct and complete.

Dennis J. Schauer
Signature

LOCAL GOVERNING BODY

Date Received: _____

I, _____ recommend ☐ APPROVAL ☐ DISAPPROVAL
(Government Official) (Title)

On behalf of _____, _____, _____, _____
(City, Town, County) Signature Date Phone

AZDLLC USE ONLY

☐ APPROVAL ☐ DISAPPROVAL BY: _____ DATE: _____

St. Bridget Church Event Questions-Answered

1. The Irish Festival is our second yearly festival we hold at the church. It is a time for parishioners to come together, especially our parishioners that are here from out of state. We will have food and music and games for the children,
2. There will be no vendors at the event.
3. The number attending is usually around 275 and that includes children.
4. No activities will take place on public sidewalks. Our restrooms are in our church and parish hall.
5. There will be no street closures.

RECEIVED
DEC 27 2022
CITY OF MESA
LICENSING OFFICE

Area Dimensions
 taken from Google Maps
 Circumference=314.159 ft
 Area= 7853.98 ft

← N

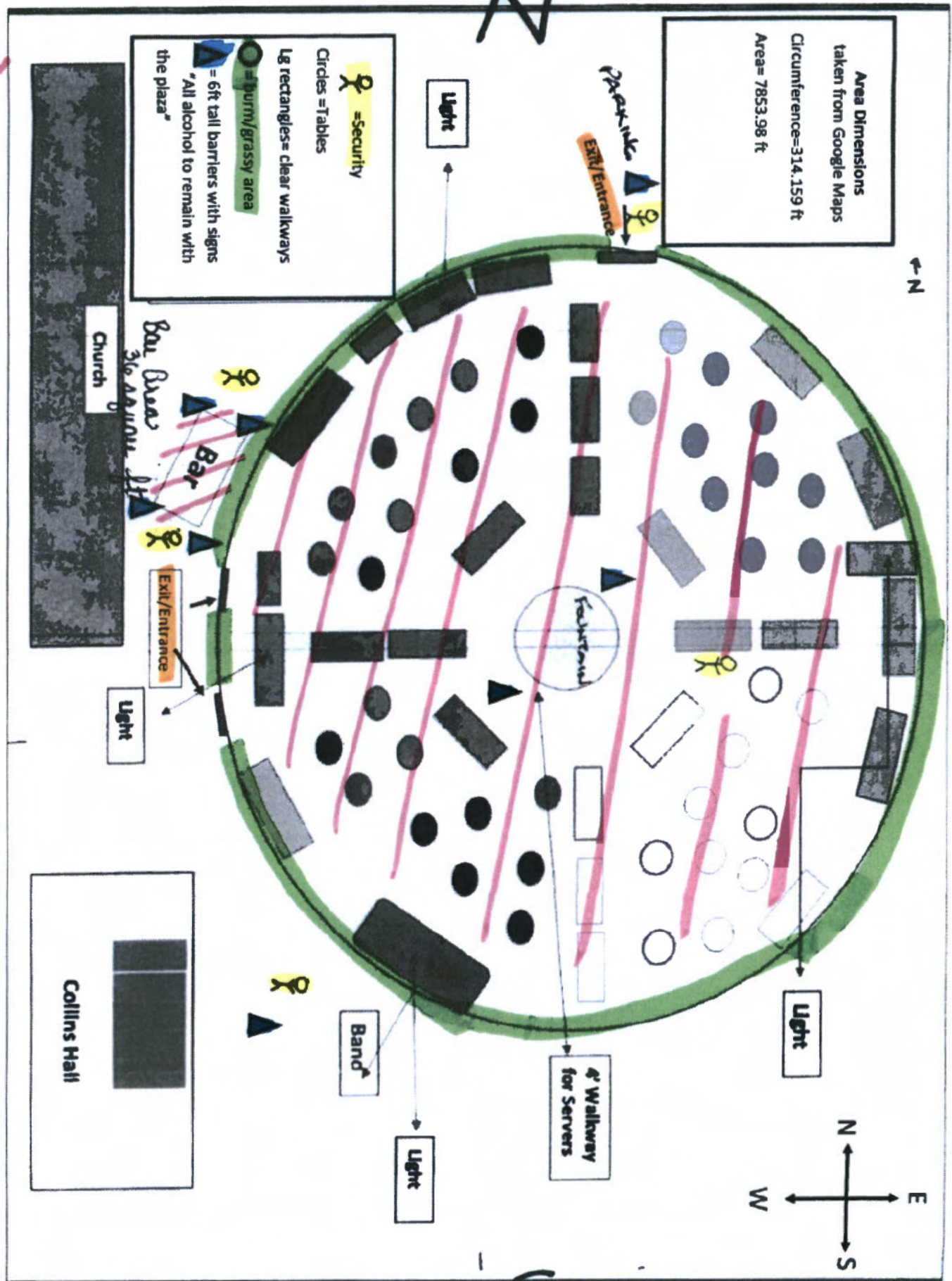
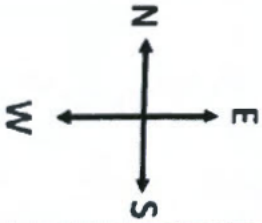

Requested area for where alcoholic beverages would be sold, dispensed, or consumed

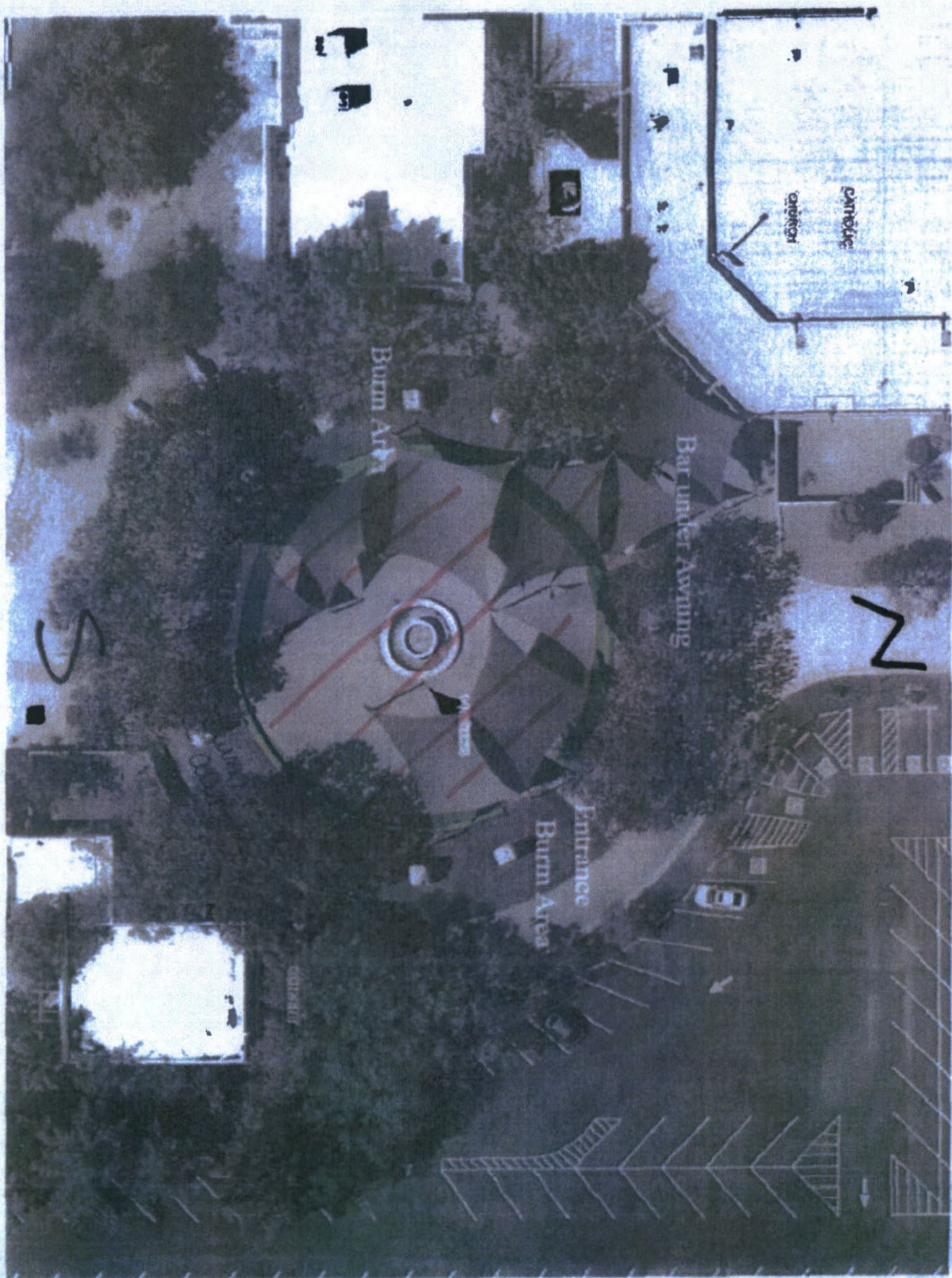

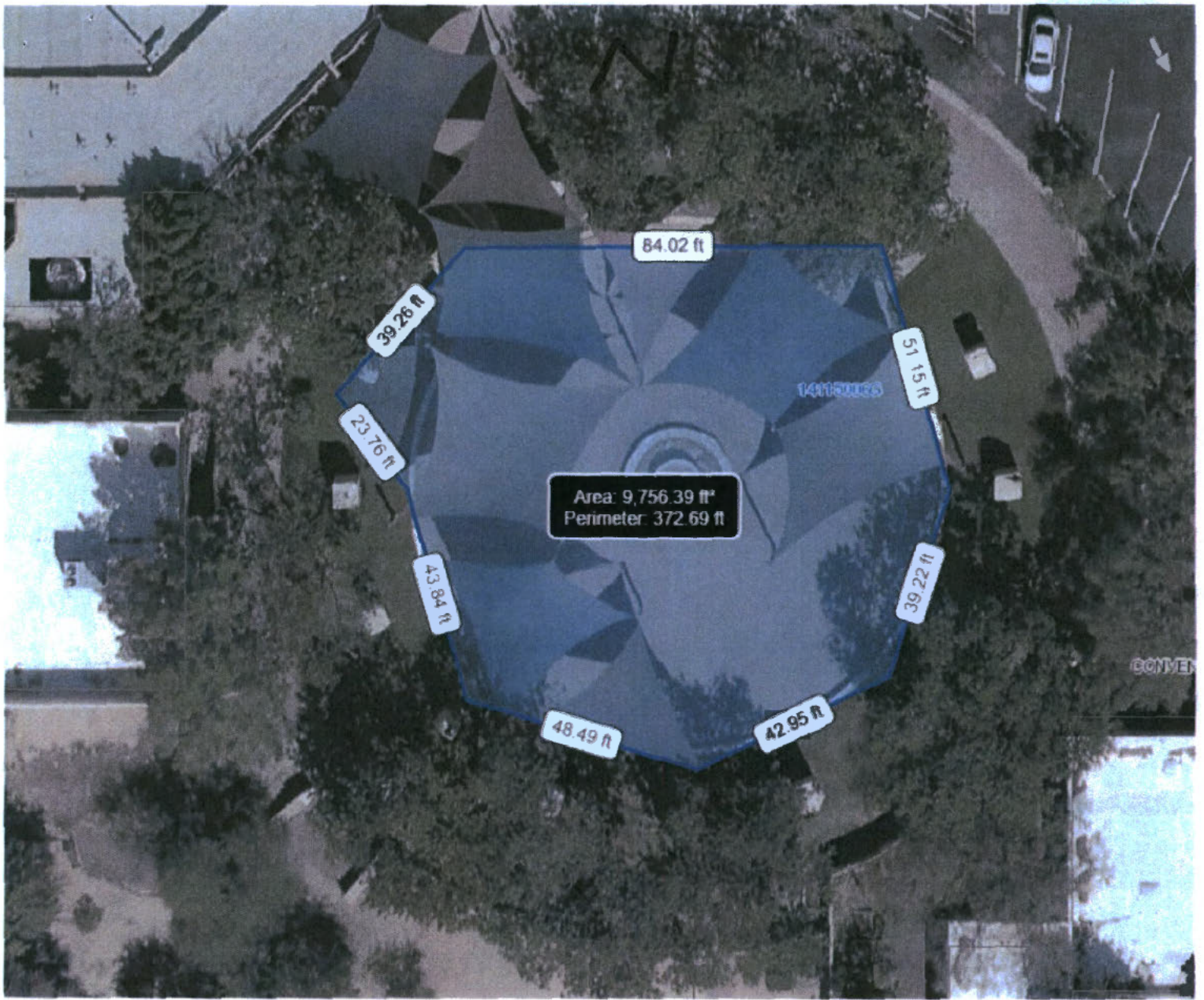

S

Internal Revenue Service
P.O. Box 2508
Cincinnati, OH 45201

Department of the Treasury

Date: July 12, 2011

Person to Contact:

Roger Meyer

Toll Free Telephone Number:

877-829-5500

Employer Identification Number:

53-0196617

Group Exemption Number:

0928

United States Conference of Catholic
Bishops
3211 4th Street, NE
Washington, DC 20017-1194

Dear Sir/Madam:

This responds to your July 1, 2011, request for information regarding the status of your group tax exemption.

Our records indicate that you were issued a determination letter in March 1946, that you are currently exempt from federal income tax under section 501(c)(3) of the Internal Revenue Code, and are not a private foundation within the meaning of section 509(a) of the Code because you are described in sections 509(a)(1) and 170(b)(1)(A)(i).

With your request, you provided a copy of the *Official Catholic Directory for 2011*, which includes the names and addresses of the agencies and instrumentalities and the educational, charitable, and religious institutions operated by the Roman Catholic Church in the United States, its territories, and possessions that are subordinate organizations under your group tax exemption. Your request indicated that each subordinate organization is a non-profit organization, that no part of the net earnings thereof inures to the benefit of any individual, and that no substantial part of their activities is for promotion of legislation. You have further represented that none of your subordinate organizations is a private foundation under section 509(a), although all subordinates do not all share the same sub-classification under section 509(a). Based on your representations, the subordinate organizations in the *Official Catholic Directory for 2011* are recognized as exempt under section 501(c)(3) of the Code under GEN 0928.

Donors may deduct contributions to you and your subordinate organizations as provided in section 170 of the Code. Bequests, legacies, devises, transfers, or gifts to them or for their use are deductible for federal estate and gifts tax purposes if they meet the applicable provisions of section 2055, 2106, and 2522 of the Code.

Subordinate organizations under a group exemption do not receive individual exemption letters. Most subordinate organizations are not separately listed in Publication 78 or the EO Business Master File. Donors may verify that a subordinate organization is included

in your group exemption by consulting the *Official Catholic Directory*, the official subordinate listing approved by you, or by contacting you directly. IRS does not verify the inclusion of subordinate organizations under your group exemption. See IRS Publication 4573, *Group Exemption*, for additional information about group exemptions.

Each subordinate organization covered in a group exemption should have its own EIN. Each subordinate organization must use its own EIN, not the EIN of the central organization, in all filings with IRS.

If you have any questions, please call us at the telephone number shown in the heading of this letter.

Sincerely,

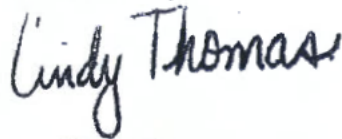
A handwritten signature in black ink that reads "Cindy Thomas". The signature is written in a cursive style with a large, stylized "C" and "T".

Cindy Thomas
Manager, Exempt Organizations
Determinations

- Brown, Douglas T. '06 (CLV) Presbyteral Council; Presbyteral Conveners; Cleveland, OH Mary Queen of Peace.
- Brown, Edward J. m.s. '1 (FR)[E] Attleboro, MA La Salette Missionary Association; [E] Attleboro, MA La Salette Shrine & Retreat Center.
- Brown, Erin '07 (TR) Trenton, NJ Bede House; [S] Trenton, NJ Bede House, College of New Jersey.
- Brown, Eugene M. '60 (NU) Retired.
- Brown, Everett s.m.m. '61 (RVC)[N] Bay Shore, NY Montfort Missionaries.
- Brown, Francis Xavier o.s.b. '84 (TLS)[G] Hulbert, OK Our Lady of the Annunciation of Clear Creek Abbey.
- Brown, George o.m.i. '64 (BO)[R] Lowell, MA Missionary Oblates of Mary Immaculate.
- Brown, Gerald L. p.s.s. '64 (BAL)[M] Baltimore, MD St. Charles Villa; [Q] Baltimore, MD Society of St. Sulpice, Province of the United States.
- Brown, Gregory J. a.f.m.c.p. '04 (PIT)[M] Pittsburgh, PA St. Augustine Friary.
- Brown, Harold C. c.p.p.s. '59 (TOL)[H] Bellevue, OH Mary Lay Center; [J] Bellevue, OH Sorrowful Mother Shrine.
- Brown, James E. '72 (TOL) Marblehead, OH St. Joseph.
- Brown, James T. '97 (NEW) Bloomfield, NJ Sacred Heart.
- Brown, James V. o.a.r. '46 (LA)[F] Oxnard, CA Order of Augustinian Recollects (O.A.R.), St. Augustine Priory.
- Brown, Jerry W. '01 (OAK) Retired; Priests' Ongoing Formation.
- Brown, Rev. Msgr. John J. '83 (BRK) Attorneys and Counselors at Canon Law; Brooklyn, NY St. Thomas Aquinas.
- Brown, John T. g.h.m. '84 (SAV) Blakely, GA Holy Family.
- Brown, Jonathan s.j. '11 (NO)[Q] New Orleans, LA Jesuit Provincial Office.
- Brown, Joseph c.p.p.s. '61 (CIN)[N] Carthage, OH St. Charles.
- Brown, Joseph A. s.j. '72 (MIL)[O] Milwaukee, WI Jesuit Provincial Office, Wisconsin Province.
- Brown, Joseph Mary c.s.j. '97 (PEO)[J] Princeville, IL Congregation of St. John.
- Brown, Joshua S. '10 (GI) Diocesan Consultors; Priests' Advisory Board (Presbyteral Council); North Platte, NE St. Patrick.
- Brown, Keenan Wynn '02 (LAF) Arnaudville, LA St. Catherine; Arnaudville, LA St. John Francis Regis.
- Brown, Kenneth A. '77 (STL) Deaneries/Deans; Webster Groves, MO Holy Redeemer Catholic Church.
- Brown, Lawrence o.s.b. '84 (TLS)[G] Hulbert, OK Our Lady of the Annunciation of Clear Creek Abbey.
- Brown, Lea c.m.f. '82 (SAT)[C] San Antonio, TX The Mexican American Catholic College.
- Brown, Leonard c.m.f. '82 (CHI)[N] Chicago, IL Claretian Missionaries-U.S.A. Province, Inc.; [N] Oak Park, IL Claretian Missionaries Community Support Trust.
- Brown, Leonard J. c.m.f. '82 (SAT) San Antonio, TX In Res.
- Brown, Lewis '67 (ROC) Priests' Council; Retired.
- Brown, Lewis E. '67 (MO) DEPARTMENT OF VETERANS AFFAIRS HOSPITALS AND CHAPLAINS.
- Brown, Matthew F. '63 (SY) Vestal, NY Our Lady of Sorrows; Vestal, NY Binghamton Nursing Homes; Retired.
- Brown, Michael K. '16 (BUF) Elma, NY St. Gabriel.
- Brown, Michael O. '74 (TOL) College of Consultors; Retired.
- Brown, Michael R. '89 (ROC) Auburn, NY Sacred Heart; Priests' Council; Auburn, NY Auburn Correctional Facility; Sonoma, NY Groveland Correctional Facility; Sonoma, NY Livingston Correctional Facility and Seneca Correctional Facility.
- Brown, Ned J. '98 (CIN) Fort Recovery, OH Mary Help of Christians; Fort Recovery, OH St. Joseph; Fort Recovery, OH St. Peter; Fort Recovery, OH St. Paul.
- Brown, Nicholas '15 (HON) Presbyteral Council; Ewa, HI Immaculate Conception Church.
- Brown, Nicholas s.c.j. '76 (SAT) San Antonio, TX St. Luke's Baptist Hospital; University Hospital; [M] San Antonio, TX Hospital Ministry House.
- Brown, Nicholas J. '13 (L) Jamestown, KY Holy Spirit; Columbia, KY Holy Redeemer.
- Brown, Patrick o.c.s.o. '74 (WOR)[N] Spencer, MA St. Joseph's Abbey.
- Brown, Rev. Msgr. Patrick E. '78 (PAT) Wayne, NJ Annunciation.
- Brown, Philip J. p.s.s. '89 (BAL)[A] Baltimore, MD St. Mary's Seminary and University; [A] Baltimore, MD St. Mary's Seminary and University.
- Brown, Phillip J. p.s.s. '89 (BAL)[Q] Baltimore, MD Society of St. Sulpice, Province of the United States.
- Brown, Phillip J. s.s. '89 (BIS) On Duty Outside the Diocese.
- Brown, Richard '80 (DAL) On Duty Outside the Diocese.
- Brown, Richard s.j. '88 (SD) San Diego, CA Our Lady of Guadalupe Catholic Parish San Diego.
- Brown, Rev. Msgr. Robert '69 (NOR) Board of Education.
- Brown, Rev. Msgr. Robert L. '69 (NOR) Chancellor; College of Consultors; Members; Diocesan Pastoral Council; Notaries; Advisory Ministry Evaluation Committee; Catholic Relief Services; Uncasville, CT St. John the Evangelist.
- Brown, Robert P. '63 (SC) Retired.
- Brown, Russell D. '04 (MRY) Vicars Forane; Diocesan Consultors; Presbyteral Council; San Luis Obispo, CA Old Mission Church.
- Brown, Samuel Moses '13 (SR) Santa Rosa, CA St. Rose of Lima; [A] Santa Rosa, CA Cardinal Newman High School.
- Brown, Seth A. '14 (SFD) On Duty Outside the Diocese; College of Consultors.
- Brown, Shaun s.j. '94 (CAM) Cape May, NJ United States Coast Guard, Command Chaplain's Office.
- Brown, Shaun S. '94 (NTN) Military Chaplain; Priests Serving Outside the Eparchy; (MO) Navy Chaplains.
- Brown, Stephan s.v.d. '93 (CHI)[N] Techny, IL Divine Word Residence.
- Brown, Stephan s.v.d. '93 (SP) Tampa, FL St. Paul.
- Brown, Steven P. '77 (SJ) San Jose, CA St. John Vianney.
- Brown, Thomas E. '78 (E) Eldred, PA St. Raphael; Shinglehouse, PA St. Theresa.
- Brown, Thomas J. '99 (GR) Elected Members; College of Consultors; Ionia, MI SS. Peter and Paul; Lake Odessa, MI St. Edward.
- Brown, Timothy '88 (ROC) Rochester, NY Peace of Christ.
- Brown, Timothy B. s.j. '86 (BAL)[B] Baltimore, MD Jesuit Community of Loyola University, Inc.; [Q] Baltimore, MD Jesuit Community of Loyola University Maryland, Inc.
- Brown, Victor o.p. '63 (NO) New Orleans, LA St. Dominic; Retired.
- Brown, W. P. '80 (PT) Panama City, FL Our Lady of the Rosary.
- Brown, Warren o.m.i. '82 (WDC)[O] Washington, DC Provincial Offices of the United States Province of the Missionary Oblates of Mary Immaculate.
- Brown, Warren A. o.m.i. '82 (CHI)[X] Chicago, IL Oblates for International Pastoral.
- Brown, Wilbur J. '04 (LAF) Retired.
- Brown, William E. '88 (SFR) Tiburon, CA St. Hilary.
- Brown, William M. o.m.v. '94 (BO)[Z] Boston, MA Lanteri Charitable Trust.
- Brown, William P. '80 (PT) Catholic Women, Diocesan Council of; Panama City, FL Our Lady Queen of Peace Mission.
- Browne, Dennis '79 (SJ) On Leave of Absence.
- Browne, Rev. Msgr. J. Patrick '87 (SU) Permanent Diaconate Admissions and Evaluations Board; Retired.
- Browne, Jeremiah (NEW) Pastoral Services Team; [Q] Plainfield, NJ RENEW International.
- Browne, Robert M. '61 (BO) Senior Priests.
- Browne, Rev. Msgr. Ronald T. '91 (DET) Judicial Vicar.
- Browne, Stanley '81 (GB) Absent on Leave, Sick, Disabled or Inactive.
- Browne, William '98 (CHI) Oak Lawn, IL St. Gerald.
- Browne, William E. '04 (CLV) Barberton, OH St. Augustine.
- Brownell, Patrick '94 (KNX) Morristown, TN St. Patrick.
- Brownell, Patrick P. '94 (MO) Army National Guard Chaplains.
- Brownfield, David L. '90 (DAV) Kalona, IA Holy Trinity Church of Richmond, Iowa; Riverside, IA St. Mary Church of Riverside, Iowa; Wellman, IA St. Joseph Church of Wellman, Iowa.
- Brownholtz, Andrew C. '01 (PH) Yardley, PA St. Ignatius of Antioch.
- Browning, Ryan B. '13 (RCK) Censures Librorum; Loves Park, IL St. Bridget.
- Brownsey, Rev. Msgr. Brian '96 (PEO) Peoria, IL St. Mark's.
- Brownstein, Donald P. '81 (COS) Monument, CO St. Peter.
- Broy, Francis R. s.j. '61 (BR)[J] Convent, LA Manress House of Retreats.
- Broznowicz, Grzegorz P. '96 (NOR) Members; Continuing Education and Formation Commission for the Clergy; Old Saybrook, CT St. John; Westbrook, CT St. Mark.
- Brubaker, Claude '55 (VEN) Retired.
- Brubaker, Rev. Msgr. George J. '80 (WIL) Delaware City, DE St. Paul; New Castle, DE Our Lady of Fatima; Governor Bacon Health Center.
- Brubaker, Rev. Msgr. George J. '80 (WIL) Judges; Catholic Relief Services, Inc.
- Brubaker, W. Scott '82 (PHX) Mesa, AZ St. Bridget Roman Catholic Parish.
- Bruce, Joseph J. s.j. '81 (WDC)[U] Washington, DC Gallaudet University Catholic Community.
- Bruce, Joseph J. s.j. '81 (BO)[D] Boston, MA Boston College High School.
- Bruce, Terry '67 (KC) Kansas City, MO St. Peter's; Retired.
- Bruch, James A. '85 (SC) Madrid, IA St. Malachy's; Ogden, IA St. John's.
- Bruch, Lynn A. '86 (SC) Auburn, IA St. Mary's; Lake City, IA St. Joseph's.
- Bruck, Donald '88 (DM) Retired.
- Bruck, Raymond E. '58 (GR) Retired.
- Brucker, G. Fredrick '76 (GR) Conklin, MI St. Francis Xavier; Ravenna, MI St. Catherine; Conklin, MI St. Joseph Wright; On Special Assignment.
- Brucker, George W. '66 (ALB) Retired.
- Brucksch, Rev. Msgr. James L. '69 (GLD) Retired.
- Brucz, James M. c.a.p. '74 (PMB)[H] Vero Beach, FL Paulist Fathers Residence.
- Brudzynski, Peter F. '50 (BO) Senior Priests.
- Bruecken, Albert o.s.b. '77 (KC)[A] Conception, MO Conception Seminary College; [J] Conception, MO Conception Abbey.
- Bruener, David P. '12 (LC) Rudolph, WI St. Philip; Wisconsin Rapids, WI St. Lawrence.
- Bruggeman, Donald R. '62 (DUB) Retired.
- Bruggeman, Sidney B. '09 (GI) Personnel Board; St. Libory, NE St. Libory's; U.S. Veterans' Hospital; (MO) DEPARTMENT OF VETERANS AFFAIRS HOSPITALS AND CHAPLAINS.
- Brugger, Rev. Msgr. Robert L. '68 (E) Finance Council; Erie, PA St. George.
- Brum, Rev. Msgr. Louis L. '74 (BWN) Priests' Assignment Board; McAllen, TX Holy Spirit.
- Brumleve, Matthew '88 (KC) Oak Grove, MO St. Jude the Apostle; Odessa, MO St. George.
- Brummel, Mark J. c.m.f. '60 (CHI)[N] Chicago, IL Claret House (Formation Residence); [N] Chicago, IL Claretians, Inc.; [N] Oak Park, IL Claretian Missionaries Community Support Trust; [N] Chicago, IL Claretian Missionaries Charitable Property Trust; [N] Chicago, IL Claretian Missionaries Continuing Care Trust; [N] Chicago, IL Claretian Missionaries Endowment Trust; [N] Chicago, IL Claretian Missionaries Service Corporation; [N] Chicago, IL Claretian Volunteers and Lay Missionaries; [N] Chicago, IL St. Jude League; [X] Chicago, IL Villa Guadalupe Senior Services Corporation.
- Brummel, Thomas c.m.f. '59 (CHI)[N] Oak Park, IL Provincial Residence.
- Brundage, John L. '70 (MET) Retired.
- Brundage, Thomas T. '88 (MIL) Oconomowoc, WI St. Jerome.
- Brune, Meinrad o.s.b. '61 (IND)[K] St. Meinrad, IN St. Meinrad Archabbey.
- Brune, Philip '14 (VIC) El Campo, TX St. Robert Bellarmine.
- Brunelle, J. Ernest m.m. '59 (NY)[CC] Maryknoll, NY Maryknoll Fathers and Brothers.
- Brunet, Rev. Msgr. Frederic '60 (HT) Retired.
- Brunet, Jules A. '55 (BR) Retired.
- Brunet, Paul J. '11 (SEA) Lakewood, WA St. Frances Cabrini; Clearwater / Olympic Correction Center.
- Brunetta, Juan-Diego o.p. '01 (NY)[CC] New York, NY St. Vincent Ferrer Priory.
- Brunetta, Juan-Diego o.p. '01 (HRT) Judicial Vicar (Officialis); Special and other Archdiocesan Assignment.
- Brunette, Larry H. '99 (SFD) Retired.
- Bruney, James L. '84 (PIT) Defenders of the Bond; Pittsburgh, PA St. Cyril of Alexandria.
- Bruni, John E. '76 (CAM) Mantua, NJ R.C. Church of the Incarnation.
- Brunick, Charles J. c.s.p. '70 (NY)[CC] New York, NY Paulist Fathers' Motherhouse.
- Bruning, David R. '78 (TOL) Wauseon, OH St. Caspar.
- Bruning, William '93 (KCK) Overland Park, KS Queen of the Holy Rosary.
- Brunkan, Rev. Msgr. Walter L. '56 (DUB) College of Consultors; Deanery Representatives; Directors; Rockford, IA Holy Name; Greene, IA St. Mary.
- Brunner, John H. '62 (NU) Retired.
- Brunner, Michael o.s.b. '05 (STL) St. Louis, MO St. Anselm Catholic Church; [F] Creve Coeur, MO St. Louis Priory School; [Q] St. Louis, MO The Abbey of St. Mary and St. Louis.
- Brunner, William a.s.c. '62 (OM)[K] St. Columban, NE Missionary Society of St. Columban.
- Brunner, William '11 (SD) El Cajon, CA Our Lady of Grace Catholic Parish.
- Brunner III, William J. '11 (MO) Navy Chaplains; (GB) Military Chaplains.
- Brunnett, Edward J. m.s. '63 (LKC) Westlake, LA St. John Bosco.
- Brunnett, Jude m.s. '64 (LKC) De Ridder, LA St. Joseph's.
- Bruno, Anthony J. '68 (HRT) Enfield, CT St. Adalbert's; Wethersfield, CT Connecticut Department of Correction; Special and other Archdiocesan Assignment.
- Bruno, Jean S. '09 (BRK) Long Island Jewish Hospital.
- Bruno, Jean Schmed '10 (BRK) Oakland Gardens, NY In Res.
- Bruno, John r.c.j. '74 (FRS) Vicars Forane; Personnel Board; Priests' Council; Sanger, CA St. Katherine; Sanger, CA St. Mary.
- Bruno, Joseph R. '80 (BRK) Cambria Heights, NY In Res.

The Catholic Directory

Churches, Mass Times, Schools, Ministries

(<https://www.catholicdirectory.com>)

Select Language ▼

Contact Us (<http://helpdesk.catholicdirectory.com>)

Member Login (</login>)

Advertise Today > (</join>)



Church Name or Keyword



City, State, Zip, County, and/or Country

Search

[Home \(/www.catholicdirectory.com\)](https://www.catholicdirectory.com) / [United States \(/united-states\)](/united-states) / [Mesa \(/united-states/mesa\)](/united-states/mesa)
/ [Church \(/united-states/mesa/church\)](/united-states/mesa/church) / [St. Bridget Roman Catholic Parish](#)



(</mesa/church/st-bridget-roman-catholic-parish/connect>)

St. Bridget Roman Catholic Parish

Church (66840)

♥ LIKE

[Diocese of Phoenix \(/phoenix/diocese/diocese-of-phoenix\)](/phoenix/diocese/diocese-of-phoenix) | Rite: Roman Rite | Language: English

📍 Mesa Arizona 85213

Update this Listing
(<https://catholicdirectory.supportsystem.com/kb/faq.php?id=7>)

Write a Review (</mesa/church/st-bridget-roman-catholic-parish/writeareview>)



Are you St. Bridget Roman Catholic Parish? Claim your free listing to make updates!

[Claim Listing Now »](http://helpdesk.catholicdirectory.com/kb/faq.php?id=113) (<http://helpdesk.catholicdirectory.com/kb/faq.php?id=113>)

[Overview](#)

[Mass Times \(2\)](#)

Contact Information

Organization



St. Bridget Roman Catholic Parish

Website

<http://www.stbridget.org/> (<http://www.stbridget.org/>)

Location



2213 North Lindsay Rd.
Mesa, AZ 85213
United States of America

[View Map & Get Directions ↗](http://maps.google.com/maps?daddr=33.45758989999999,-111.76997879999999&saddr=) ([http://maps.google.com/maps?
daddr=33.45758989999999,-111.76997879999999&saddr=](http://maps.google.com/maps?daddr=33.45758989999999,-111.76997879999999&saddr=))

Find Churches in a Region

City, State, Zip, County, and/or Count

20mi



[Search Now »](#)

-->

Featured Advertisers

CBD Superstore > use code 'CatholicLife'
(<https://shopcbdhealthstore.com>)

ENTITY INFORMATION

Search Date and Time: 12/22/2022 4:45:43 PM

Entity Details

Entity Name:

ST. BRIDGET ROMAN CATHOLIC PARISH MESA

Entity ID:

14600276

Entity Type:

Domestic Nonprofit Corporation

Entity Status:

Active

Formation Date:

7/1/2008

Reason for Status:

In Good Standing

Approval Date:

7/15/2008

Status Date:

Original Incorporation Date:

7/1/2008

Life Period:

Perpetual

Business Type:

Other Services (except Public Administration)

Last Annual Report Filed:

2022

Domicile State:

Arizona

Annual Report Due Date:

7/1/2023

Years Due:

8/18/2008

Statutory Agent Information

Name:

DENNIS M NAUGHTON

Appointed Status:

Active

Attention:

Address:

400 E MONROE ST , PHOENIX, AZ 85004, USA

Agent Last Updated:

6/6/2022

E-mail:

Attention:

Mailing Address:

County:

Maricopa

Principal Information

Title	Name	Attention	Address	Date of Taking Office	Last Updated
Director	JOHN ROMERO		1302 E HACKAMORE, MESA, AZ, 85203, Maricopa County, USA	7/1/2015	4/25/2019
Director	DENNIS SCHAUER		6263 E OASIS ST, MESA, AZ, 85215, Maricopa County, USA	7/1/2015	4/25/2019
Director	FREDRICK J ADAMSON		400 E MONROE ST, PHOENIX, AZ, 85004, Maricopa County, USA	7/1/2008	4/25/2019
Director	W SCOTT BRUBAKER		2213 N LINDSAY RD, MESA, AZ, 85213, Maricopa County, USA	7/1/2008	4/25/2019
Director	THOMAS J OLMSTED		400 E MONROE ST, PHOENIX, AZ, 85004, Maricopa County, USA	7/1/2008	4/25/2019

< Previous

...

1

2

...

Next >

Page 1 of 2, records 1 to 5 of 8

Go to Page

Privacy Policy (<http://azcc.gov/privacy-policy>) | Contact Us (<http://azcc.gov/corporations/corporation-contacts>)

Address 

Attention:

Address: 2213 N LINDSAY RD, MESA, AZ, 85213, USA

County: Maricopa

Last Updated: 6/6/2022

Entity Principal Office Address

Attention:

Address:

County:

Last Updated:

Back

Return to Search

Return to Results

Document History

Name/Restructuring History

Pending Documents

Microfilm History