

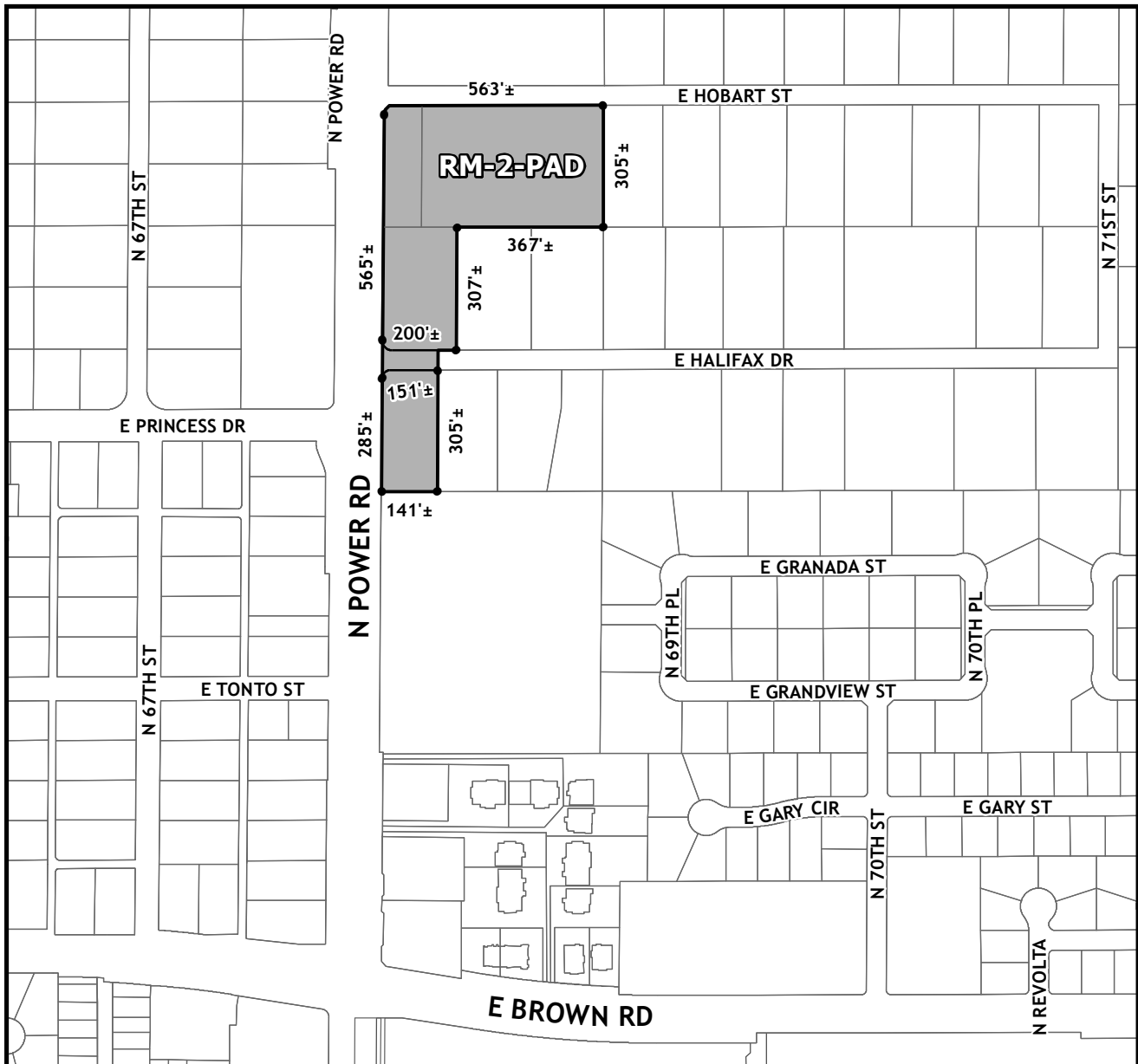

OFFICIAL SUPPLEMENTARY ZONING MAP AMENDING THE CITY OF MESA ZONING MAP



CASE: ZON22-00671

ACREAGE: 6±

REQUEST: Rezone from Single Residence-35 (RS-35) and Office Commercial (OC) to Multiple Residence-2 with a Planned Area Development overlay (RM-2-PAD) and Site Plan Review.

ORDINANCE: _____

Please be advised that the attached zoning changes were approved by the Mesa City Council on _____, 2022 by Ordinance # _____. If you have any questions concerning these changes, contact the City of Mesa Planning Division at 480-644-2385.

ATTEST: _____ DATE: _____

MAYOR

CITY CLERK