

**Special Event
Liquor License
Application
Attachment B**

Licensing Office
55 North Center Street
Mailing Address:
PO Box 1466
Mesa, Arizona 85211-1466
480-644-2316 Telephone
480-644-3999 Fax
www.mesaaz.gov

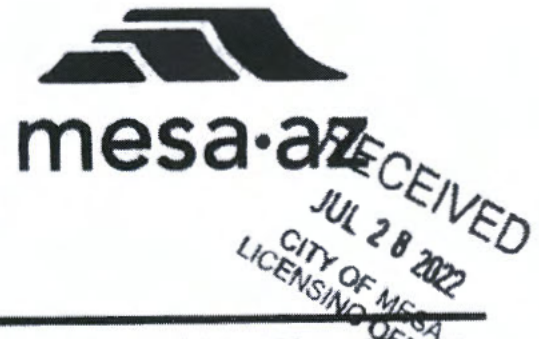

If you intend to serve alcohol at your special event, you will need to obtain a Special Event Liquor License or an Extension of Premises from the City of Mesa Licensing Office. This must be submitted at least 60 days prior to the event. A license is required with special provisions outlined. Plan a minimum of 60 days to complete this process.

Check all that apply:

- ☐ Free/Host Alcohol
☐ Beer
- ☒ Alcohol Sales
Beer and Wine
- ☒ Host and Sale Alcohol
☐ Beer, Wine and Distilled Spirits

Do you plan to secure a:

☒ **Special Event Liquor License** - The Special Event Liquor License fee is \$25 and must be approved by the City Council. After city approval, your application must be submitted to, and approved by, the State of Arizona. There are fees involved at the State. This license can only be obtained by a non-profit organization, 501(C). (Complete the State of Arizona Special Event Liquor Application and site plan and submit it with this Attachment B.)

☐ **Extension of Premises License** - There is no fee involved with the Extension of Premises. This is allowed when a liquor license is already in effect and you want to extend the area where liquor is sold. (Complete the State of Arizona

Extension of Premises Application and site plan and submit it with this Attachment B.)

If this is an Extension of Premises, are there any other activities taking place except for the sale of liquor in the extended area? No ☒ Yes ☐ Type of activities taking place: _____

Please describe your security plan to ensure the safe sale or distribution of alcohol at your event We will have volunteers stationed throughout the event (indicated on site plan) this event is for 21 yrs and older

If applying for a Special Event Liquor License the following must be provided:

St. Timothy Roman Catholic Parish Mesa *TS

Charity's or Organization's Name

501 (C)#

Lisa Stevens

Coordinator of Evangelization

Name of Contact at Charity/Organization

Title with Organization

Phone Number

Lisa Stevens

On-Site Agent Responsible for Liquor

☒ How will attendees over the age of 21 be identified? through ticket sales and ID's will be checked

Bartenders serving the alcohol will be non-profit members/employees.

What controls will be used to keep attendees under the age of 21 from obtaining alcohol at the event? this event is for adults only

Will food be served? Yes ☒ No ☐ If yes, what type of food will be served BBQ and Desserts

Seating capacity of designated area: # 300

AMENDMENT

☒ Date 9/1/22 Staff TS

CSR:

Amount:



SPECIAL EVENT LICENSE

APPLICATION FEE \$25.00 PER DAY

Arizona Dept. of Liquor Licenses and Control
800 W. Washington St. 5th Floor Phoenix, AZ 85007
(602) 542-5141

DLLC USE ONLY

Job #:

Date Accepted:

CSR:

Type or Print with **Black Ink**

1-10 days consecutive days only, Cash, Checks or Money Orders Only

SECTION 1 Applicant must be a member of a qualifying nonprofit organization, political party, or Government entity and authorized by an Officer, Director, or Chairperson of the Organization.

1. Applicant: Lisa Stevens2. Applicant's mailing address: 1730 W Guadalupe Rd Mesa AZ 85202

Street

City

State

Zip

3. Applicants home/cell phone: na Applicant's business phone: [REDACTED]4. Applicant's email address: lstevens@sttimothymesa.org

SECTION 2 Name of Non-Profit Organization, Candidate or Political Party/Gov.: St. Timothy Roman Catholic Parish Mesa

SECTION 3 Non-Profit/IRS Tax Exempt Number: 32-0267724

SECTION 4 Arizona Corporation Commission File #: 14588920 If out of State please specify: _____

SECTION 5 Event Location Name: St. Timothy Catholic School

SECTION 6 Event Address: 2520 S Alma School Rd Mesa AZ 85210

SECTION 7 Dates and Hours of Event. Days must be consecutive but may not exceed 10 consecutive days.

****SEPARATE APPLICATION FOR EACH "NON-CONSECUTIVE" DAY****

Days	Date	Day of Week	Event Start Time AM/PM	License End Time AM/PM
DAY 1:	<u>10/22/22</u>	<u>Saturday</u>	<u>6:00pm</u>	<u>10:00pm</u>
DAY 2:	_____	_____	_____	_____
DAY 3:	_____	_____	_____	_____
DAY 4:	_____	_____	_____	_____
DAY 5:	_____	_____	_____	_____
DAY 6:	_____	_____	_____	_____
DAY 7:	_____	_____	_____	_____
DAY 8:	_____	_____	_____	_____
DAY 9:	_____	_____	_____	_____
DAY10:	_____	_____	_____	_____

★ 7/21/2022

Page 1 of 3

Individuals requiring ADA accommodations please call (602) 542-2299

AMENDMENT

Date 9/1/22 Staff TS

SECTION 6 What type of security and control measures will you take to prevent violations of liquor laws at this event?
(List type and number of police/security personnel and type of fencing or control barriers, if applicable.)

Number of Police 2 Number of Security Personnel ☒ Fencing ☐ Barriers

Explanation: The event will be held at our school. Security personnel will be monitoring the event.

The event is a school fundraiser for adults 21 years and older. ID will be required at the check in table by the entrance.

The bar will be under a 10x10 tent with sides for containment.

SECTION 7 Will this event be held on a currently licensed premises and within the already approved premises?

☐ Yes ☒ No If yes, Local Governing Body signature is not required.

Name of Business

License Number

Phone (Include Area Code)

SECTION 8 How is this special event going to conduct all dispensing, serving, and selling of spirituous liquors? Please read R-19-318 for explanation and check one of the following boxes.

- ☐ Place license in non-use
☐ Dispense and serve all spirituous liquors under retailer's license
☒ Dispense and serve all spirituous liquors under special event
☐ Split premise between special event and retail location

SECTION 9 What is the purpose of this event?

☒ On-site consumption ☐ Off-site (auction/wine/distilled spirits pull) ☐ Both

SECTION 10

1. Has the applicant been convicted of a felony, or had a liquor license revoked within the last five (5) years?

☐ Yes ☒ No If yes, attach explanation.

2. How many special event days have been issued to this organization during the calendar year? 0

3. Is the Organization using the services of a Licensed Contractor?

☐ Yes ☒ No If yes, please provide the Name of the Licensed Contractor: _____

4. Is the organization using the services of a series 6, 7, 11, or 12 licensee to manage the sale or service of alcohol?

☐ Yes ☒ No if yes, please provide the Name of Licensee: _____ License #: _____

5. List the name of the Individual or Organization that will receive revenues, **MUST EQUAL 100%**.

Name: St. Timothy Roman Catholic Parish Mesa Percentage: 100%

Address: 1730 W Guadalupe Rd Mesa AZ 85202

Street

City

State

Zip

Name: _____ Percentage: _____

Address: _____

Street

City

State

Zip

~~7/21/2022~~

AMENDMENT

Date 8/31/22 Staff TS

Please read A.R.S. § 4-203.02 Special event license; rules and R19-1-205 Requirements for a Special Event License.

ALL ALCOHOLIC BEVERAGE SALES MUST BE FOR CONSUMPTION AT THE EVENT SITE ONLY.

NO ALCOHOLIC BEVERAGES SHALL LEAVE A SPECIAL EVENT UNLESS THEY ARE IN AUCTION WINE OR DISTILLED SPIRITS PULL SEALED CONTAINERS OR THE SPECIAL EVENT LICENSE IS STACKED WITH WINE /CRAFT DISTILLERY FESTIVAL LICENSE.

SECTION 11 License premises diagram. The licensed premises for your special event is the area in which you are authorized to sell, dispense or serve alcoholic beverages under the provisions of your license. Please attach a diagram of your special event licensed premises. Please show dimensions, serving areas, fencing, barricades, or other control measures and security position.



If the special event will be held at a location without a permanent liquor license or if the event will be on any portion of a location that is not covered by the existing liquor license, this application must be approved by the local government before submission to the Department of Liquor Licenses and Control. Please contact the local governing board for additional application requirements and submission deadlines. Additional licensing fees may also be required before approval may be granted. For more information, please contact your local jurisdiction.

Declaration:

I, (Print Name) Lisa Stevens, declare under penalty of perjury that I am authorized to submit this application. I have read the contents of this application, and to the best of my knowledge believe all statements made on this application to be true, correct and complete.

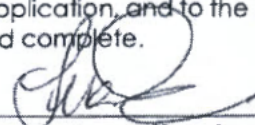
Signature

Date Received: _____

I, _____ recommend ☐ APPROVAL ☐ DISAPPROVAL
(Government Official) (Title)

On behalf of _____
(City, Town, County) Signature Date Phone

☐ APPROVAL ☐ DISAPPROVAL BY: _____ DATE: _____

A.R.S. § 41-1030. Invalidity of rules not made according to this chapter; prohibited agency action; prohibited acts by state employees: enforcement; notice

B. An agency shall not base a licensing decision in whole or in part on a licensing requirement or condition that is not specifically authorized by statute, rule or state tribal gaming compact. A general grant of authority in statute does not constitute a basis for imposing a licensing requirement or condition unless a rule is made pursuant to that general grant of authority that specifically authorizes the requirement or condition.

D. This section may be enforced in a private civil action and relief may be awarded against the state. The court may award reasonable attorney fees, damages and all fees associated with the license application to a party that prevails in an action against the state for a violation of this section.

E. A state employee may not intentionally or knowingly violate this section. A violation of this section is cause for disciplinary action or dismissal pursuant to the agency's adopted personnel policy.

F. This section does not abrogate the immunity provided by section 12-620.01 or 12-620.02.

7/21/2022

Page 3 of 3

Individuals requiring ADA accommodations please call (602) 542-2999

AMENDMENT

Date 8/31/22 Staff TS

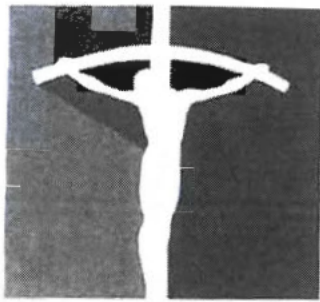

ST TIMOTHY CATHOLIC CHURCH

PRAY • SERVE • GIVE | IN SERVICE OF THE NEW EVANGELIZATION

August 31, 2022

Licensing Office
55 North Center St.
PO Box 1466
Mesa, AZ 85211

RECEIVED
AUG 31 2022
CITY OF MESA
LICENSING OFFICE

Dear City of Mesa Licensing Office,

I hereby confirm that Lisa Stevens is a member of St. Timothy Catholic Church and that she is authorized to apply for and make decisions regarding Special Event Permit and Liquor License Applications.

Sincerely,

Fr. John Greb
Pastor

 = Security

 = 10x10 tent with solid sides *

tables in courtyard = high tops

tables in bar area - 60' table with 10 chairs

 The school is gated and fenced all around - the fence is 6'

 locked gate

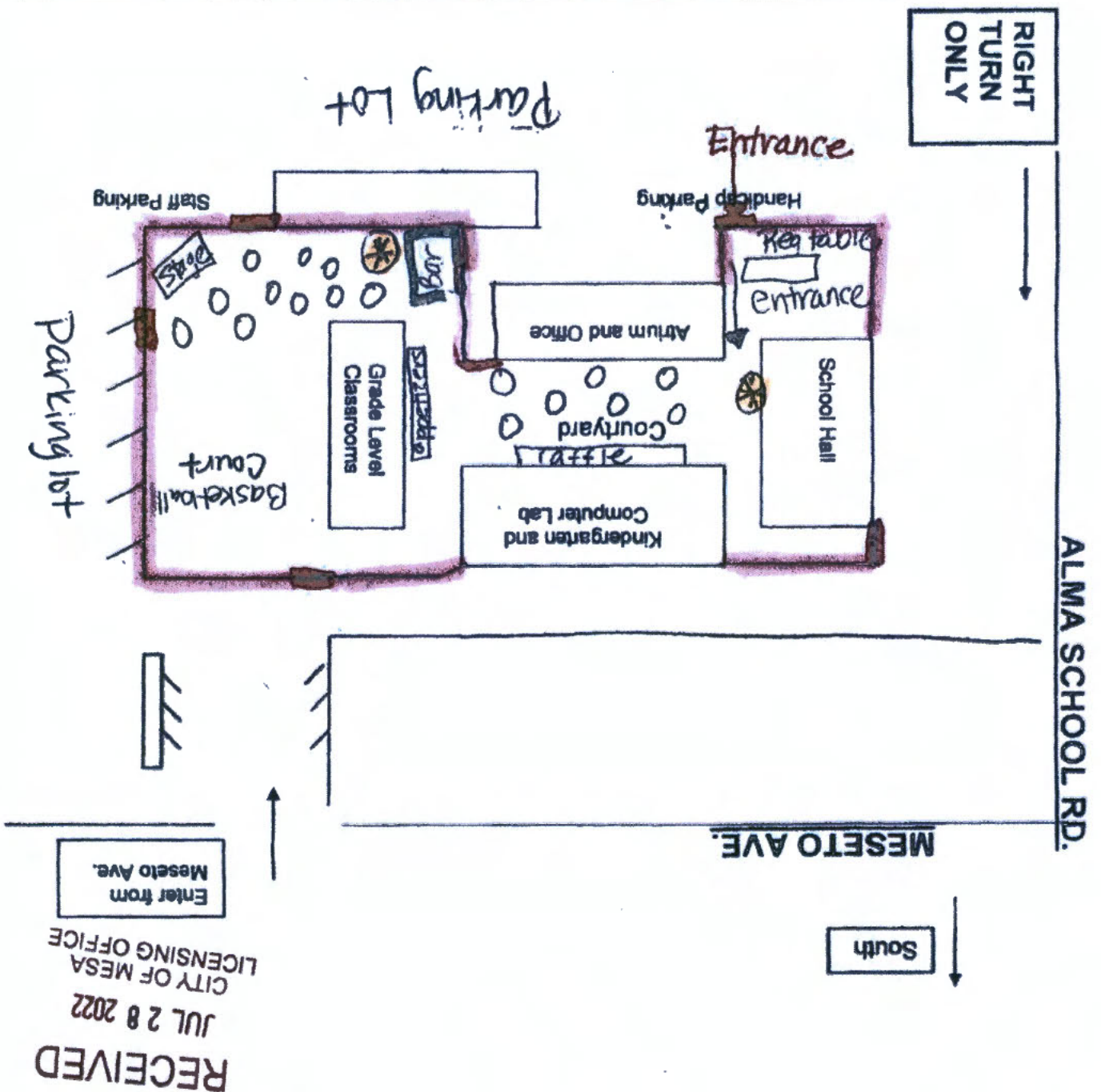

North



ENTITY INFORMATION

Search Date and Time: 8/29/2022 9:49:58 AM

Entity Details

	ST. TIMOTHY ROMAN CATHOLIC PARISH MESA	Entity Name:
	14588920	Entity ID:
	Domestic Nonprofit Corporation	Entity Type:
	Active	Entity Status:
	7/1/2008	Formation Date:
	In Good Standing	Reason for Status:
	8/14/2018	Approval Date:
	11/15/2021	Status Date:
	7/1/2008	Original Incorporation Date:
	Perpetual	Life Period:
	RELIGIOUS	Business Type:
	2022	Last Annual Report Filed:
	Arizona	Domicile State:
	7/1/2023	Annual Report Due Date:

Privacy Policy (<http://azcc.gov/privacy-policy>) | Contact Us (<http://azcc.gov/corporations/corporation-contacts>) **Years Due:**

Original Publish Date:

9/8/2008

Statutory Agent Information

Name:

DENNIS M NAUGHTON

Appointed Status:

Active

Attention:

Address:

400 E MONROE ST , PHOENIX, AZ 85004, USA

Agent Last Updated:

5/10/2022

E-mail:

Attention:

Mailing Address:

County:

Maricopa

Principal Information

Title	Name	Attention	Address	Date of Taking Office	Last Updated
Director	John Greb		1730 W GUADALUPE RD, MESA, AZ, 85202, Maricopa County, USA	5/16/2019	6/14/2019
Director	FREDERRICK J ADAMSON		400 E MONROE ST, PHOENIX, AZ, 85004, Maricopa County, USA	7/1/2008	6/14/2019
Director	THOMAS J OLMSTED		400 E MONROE ST, PHOENIX, AZ, 85004, Maricopa County, USA	7/1/2008	6/14/2019
President	John Greb		1730 W GUADALUPE RD, MESA, AZ, 85202, Maricopa County, USA		6/14/2019
Secretary	ANNE DOAK		119 NORTH MONDEL DRIVE, GILBERT, AZ, 85233, Maricopa County, USA	1/1/2017	6/14/2019

Privacy Policy (<http://azcc.gov/privacy-policy>) Contact Us (<http://azcc.gov/corporations/corporation-contacts>)

[< Previous](#)

...

1

2

...

[Next >](#)

Page 1 of 2, records 1 to 5 of 7

[Go to Page](#)Address 

Attention:

✧ Address: 1730 W GUADALUPE RD, MESA, AZ, 85202, USA

County: Maricopa

Last Updated: 8/15/2011

Entity Principal Office Address

Attention:

Address:

County:

Last Updated:

[Back](#)[Return to Search](#)[Return to Results](#)[Document History](#)[Name/Restructuring History](#)[Pending Documents](#)[Microfilm History](#)

Internal Revenue Service
P.O. Box 2508
Cincinnati, OH 45201

Department of the Treasury

RECEIVED
JUL 28 2022
CITY OF MESA
LICENSING OFFICE

Date: August 21, 2019

Person to Contact:

R. Meyer ID# 0110429

Toll Free Telephone Number:

877-829-5500

United States Conference of Catholic
Bishops
3211 4th Street, NE
Washington, DC 20017-1194

Group Exemption Number:

0928

Dear Sir/Madam:

This responds to your August 14, 2019, request for information regarding the status of your group tax exemption.

Our records indicate that you were issued a determination letter in March 1946, that you are currently exempt from federal income tax under section 501(c)(3) of the Internal Revenue Code, and are not a private foundation within the meaning of section 509(a) of the Code because you are described in sections 509(a)(1) and 170(b)(1)(A)(i).

With your request, you provided a copy of the *Official Catholic Directory for 2019*, which includes the names and addresses of the agencies and instrumentalities and the educational, charitable, and religious institutions operated by the Roman Catholic Church in the United States, its territories, and possessions that are subordinate organizations under your group tax exemption. Your request indicated that each subordinate organization is a non-profit organization, that no part of the net earnings thereof inures to the benefit of any individual, and that no substantial part of their activities is for promotion of legislation. You have further represented that none of your subordinate organizations is a private foundation under section 509(a), although all subordinates do not all share the same sub-classification under section 509(a). Based on your representations, the subordinate organizations in the *Official Catholic Directory for 2019* are recognized as exempt under section 501(c)(3) of the Code under GEN 0928.

Donors may deduct contributions to you and your subordinate organizations as provided in section 170 of the Code. Bequests, legacies, devises, transfers, or gifts to them or for their use are deductible for federal estate and gifts tax purposes if they meet the applicable provisions of section 2055, 2106, and 2522 of the Code.

Subordinate organizations under a group exemption do not receive individual exemption letters. Subordinate organizations are not listed in Tax Exempt Organization Search (Pub 78 data), and many are not listed in the Exempt Organizations Business Master

File extract, or EO BMF. Donors may verify that a subordinate organization is included in your group exemption by consulting the *Official Catholic Directory*, the official subordinate listing approved by you, or by contacting you directly. IRS does not verify the inclusion of subordinate organizations under your group exemption. See IRS Publication 4573, *Group Exemption*, for additional information about group exemptions.

Each subordinate organization covered in a group exemption should have its own EIN. Each subordinate organization must use its own EIN, not the EIN of the central organization, in all filings with IRS.

If you have any questions, please call us at the telephone number shown in the heading of this letter.

Sincerely,

A handwritten signature in cursive script that reads "Stephen A. Martin".

Stephen A. Martin
Director, Exempt Organizations
Rulings and Agreements

The Catholic Directory

Churches, Mass Times, Schools, Ministries

(<https://www.catholicdirectory.com>)

Select Language ▼

Contact Us (<http://helpdesk.catholicdirectory.com>)

Member Login (</login>)

Advertise Today > (</join>)



Church Name or Keyword



City, State, Zip, County, and/or Country

Search

[Home \(/www.catholicdirectory.com\)](#) / [United States \(/united-states\)](#) / [Mesa \(/united-states/mesa\)](#)
/ [Church \(/united-states/mesa/church\)](#) / St. Timothy Catholic Church



(</mesa/church/st-timothy-catholic-church/connect>)

✈ St. Timothy Catholic Church

Church (66836)

Diocese of Phoenix (</phoenix/diocese/diocese-of-phoenix>) | Rite: Roman Rite | Language: English

📍 Mesa Arizona 85202-7424

♥ LIKE

Update this Listing
(<https://catholicdirectory.supportsystem.com/kb/faq.php?id=7>)

Write a Review (</mesa/church/st-timothy-catholic-church/writeareview>)



Are you St. Timothy Catholic Church? Claim your free listing to make updates!

Claim Listing Now » (<http://helpdesk.catholicdirectory.com/kb/faq.php?id=113>)

Overview

Mass Times (3)

Contact Information

Organization

St. Timothy Catholic Church

Website

<http://www.sttimothymesa.org/> (<http://www.sttimothymesa.org/>)

Location

✈ 1730 West Guadalupe Rd.
Mesa, AZ 85202-7424
United States of America

View Map & Get Directions  ([http://maps.google.com/maps?
daddr=33.365,-111.870849000000002&saddr=](http://maps.google.com/maps?daddr=33.365,-111.870849000000002&saddr=))

Find Churches in a Region

City, State, Zip, County, and/or County

20mi



Search Now »

-->

Featured Advertisers

CBD Superstore > use code 'CatholicLife'
(<https://shopcbdhealthstore.com>)

- Graczyk, Carl *o.f.m.* '73 (MIL)[M] Milwaukee, WI St. Ann Rest Home; [O] Franklin, WI Provincial Offices of the Franciscan Friars, Assumption BVM Province, Inc.
- Graczyk, Randolph *o.f.m.cap.* '68 (GF) Priests' Council; Pryor, MT St. Charles Borromeo Church.
- Graden, John L. *o.s.f.s.* '76 (BUF) Niagara Falls, NY Holy Family of Jesus, Mary and Joseph; [S] Stella Niagara, NY DeSales Resources and Ministries, Inc.
- Grady, Bernard C. '68 (DUB) Retired.
- Grady, Brian D. '00 (RCK) Crystal Lake, IL St. Elizabeth Ann Seton.
- Grady, Francis *s.s.c.* '63 (OM)[K] St. Columbans, NE Missionary Society of St. Columban.
- Grady, Francis *s.s.c.* '63 (PRO)[L] Bristol, RI St. Columban's Retirement House.
- Grady, Matthew '12 (VEN)[B] Sarasota, FL Cardinal Mooney Catholic High School, Inc.; Sarasota, FL Incarnation.
- Grady, Michael '94 (MIA) Fort Lauderdale, FL St. Anthony.
- Graebe, Brian '11 (NY) Graduate Studies.
- Graeve, Stephen L. '15 (LIN) Advocates; Lincoln, NE St. Joseph.
- Graf, Gary M. '84 (CHI) Chicago, IL St. Procopius; Cicero, IL Our Lady of the Mount.
- Graf, James W. '72 (L) Retired.
- Graf, Rev. Msgr. John W. '74 (PH) Retired.
- Graf, Paul M. '82 (LFT)[C] Lafayette, IN Franciscan Health Lafayette Central; [C] Lafayette, IN Franciscan Health Lafayette East.
- Graf, William E. '60 (ROC) Censores Librorum; Staff; Ministry to Priests; Retired.
- Graff, Francis C. '65 (PIT) Retired.
- Graff, Joseph P. '76 (GLD) Ecumenical and Interreligious Affairs, Delegate for; Spiritual Formation; Cross Village, MI Holy Cross; Good Hart, MI St. Ignatius; Harbor Springs, MI Holy Childhood of Jesus; Pellston, MI St. Nicholas.
- Graff, Timothy G. '85 (NEW) New Energies - Archdiocesan Implementation Team (New Energies Parish Transition Project); Department of Social Concerns; Public Policy Committee of the New Jersey Catholic Conference; Kearny, NJ Youth and Young Adult Ministries; Kearny, NJ Boy Scouts/Girl Scouts/Catholic Committee on Scouting; Archdiocesan Commission on Justice and Peace; Bogota, NJ St. Joseph.
- Graffis, Joseph T. '71 (L) Retired.
- Grafsgaard, Thomas '13 (BIS) Bismarck, ND Saint Anne.
- Grafsky, George J. '71 (STP) St. Paul, MN Retired.
- Graham, David '91 (MEM) Presbyteral Council; Brownsville, TN St. John Church; Jackson, TN St. Mary Church.
- Graham, George Nelson '92 (LC)[L] Athens, WI Saint Anthony Parish Endowment Trust; Athens, WI St. Anthony de Padua; Athens, WI St. Thomas.
- Graham, James D. '12 (P) Area Vicars; Coquille, OR Holy Name; North Bend, OR Holy Redeemer.
- Graham, Rev. Msgr. James J. '73 (PH) Archdiocesan Judges; North Wales, PA St. Rose of Lima.
- Graham, James K. '93 (NTN) Lansing, MI St. Joseph.
- Graham, Jerry *s.j.* '00 (SEA) Tacoma, WA St. Patrick; [C] Tacoma, WA Bellarmine Preparatory School.
- Graham, John J. '90 (BO) Arlington, MA Saint Agnes.
- Graham, Rev. Msgr. John K. '74 (NY) East Bronx; Canon 1742 Panel of Pastors; Bronx, NY St. Frances de Chantal.
- Graham, Matthew J. '15 (BR) Presbyteral Council; Belle Rose, LA St. Jules; Paincourtville, LA St. Elizabeth.
- Graham, Michael J. *s.j.* '88 (CIN)[D] Cincinnati, OH Xavier University; [N] Cincinnati, OH Cincinnati Jesuit Community.
- Graham, Rev. Msgr. Neil '59 (NY) Retired.
- Graham, Robert *s.m.* '50 (WDC)[O] Washington, DC Marist Center.
- Graham, William *o.f.m.cap.* '72 (BAL) Adjutant Judicial Vicars; Baltimore, MD St. Ambrose; [Q] Baltimore, MD St. Ambrose Friary.
- Graham, William C. '76 (DUL) Duluth, MN St. Michael.
- Graham, Rev. Msgr. William P. '65 (CAM) Retired.
- Grajeda, Juan (TSL) Bartlesville, OK St. John's.
- Grajeda, Miguel Angel '97 (MRY) Watsonville, CA Vicar for Clergy; Diocesan Consultors; Presbyteral Council; Clergy Personnel Board; Watsonville, CA St. Patrick.
- Grajek, Lawrence '57 (SB) Retired.
- Grala, Paul *s.o.f.s.* '95 (SFE) Mora, NM St. Gertrude the Great.
- Gramaje, Art *c.m.f.* '94 (FRS) Fresno, CA St. Anthony Claret.
- Gramaje, Arthur *c.m.f.* '94 (CHI)[N] Chicago, IL Claretian Missionaries-U.S.A. Province, Inc.
- Gramann, Robert B. (ATL) Atlanta, GA St. Dominic.
- Gramata, Raymond C. '70 (E)[N] Bradford, PA University of Pittsburgh - Bradford Campus; Deans; Presbyteral Council; Bradford, PA St. Bernard; Bradford, PA St. Francis of Assisi.
- Grambow, Arnold J. '69 (MAR) Retired.
- Gramigna, Francis J. '64 (CAM) Retired.
- Gramlich, Anthony *m.i.c.* '02 (SPR)[G] Stockbridge, MA Association of Marian Helpers, Marian Helpers Center; [G] Stockbridge, MA The National Shrine of The Divine Mercy.
- Grams, Very Rev. Msgr. Douglas L. '87 (NU) Vicar General; Associate Judges; College of Consultors; Priests' Council; Committee on Parishes; Corporate Board; Priest Personnel Board; Bishop's Delegate in Matters Pertaining to Sexual Misconduct; Board of Trustees for Pension Plan for Priests; New Ulm, MN Cathedral of the Holy Trinity; New Ulm, MN St. Mary; Lafayette, MN St. Gregory the Great; New Ulm, MN St. John the Baptist; New Ulm, MN St. George; On Special or Other Diocesan Assignment; [A] New Ulm, MN New Ulm Area Catholic Schools.
- Gramza, Ronald '73 (MIL) Retired.
- Granado, Jason '08 (CHK) Presbyteral Council; Commission on Marriage and Family Life; Diocesan Publications Office; Electronic Media; Children of God the Father, Inc.; Saipan, MP San Vicente Parish.
- Granado, Jason '08 (AGN) On Duty Outside the Archdiocese.
- Granados, John J. (R) Cary, NC St. Michael the Archangel.
- Granados, Jorge (YAK) Moses Lake, WA Our Lady of Fatima; Moses Lake, WA Queen of All Saints.
- Granados, Luis *d.c.j.m.* '05 (DEN)[P] Littleton, CO Disciples of the Hearts of Jesus and Mary.
- Granados-Benavides, Jairo Enrique (SJN) Guaynabo, PR Nuestra Señora de la Paz.
- Granato, John '06 (HRT) Torrington, CT Saint John Paul the Great Parish Corporation; Torrington, CT Sacred Heart.
- Granato, Rev. Msgr. Joseph J. '55 (NEW) Newark, NJ St. Lucy; Retired.
- Grande, Kenneth J. '78 (BRK) Brooklyn, NY Saint John the Evangelist-Saint Rocco.
- Grandon, Douglas '08 (DEN) Denver, CO St. Vincent De Paul Catholic Parish in Denver.
- Graner, Thomas '94 (FAR) Rural Life; Rugby, ND St. Mary's Church of Knox; Rugby, ND St. Theresa, Little Flower Church of Rugby.
- Graney, Paul W. '16 (DET) Farmington, MI Our Lady of Sorrows.
- Graney, William F. '71 (WIL) Wilmington, DE Parish of the Resurrection.
- Granger, Sean '07 (MIL) Kenosha, WI St. Elizabeth; Kenosha, WI St. James.
- Granito, Mark E. '98 (SFE) Tijeras, NM Holy Child.
- Grankauskas, Paul M. '00 (ARL) Vienna, VA St. Mark.
- Grankowski, Zbigniew '83 (DET) Detroit, MI St. Cunegunda; Dearborn, MI St. Barbara.
- Granstrand, Charles P. '66 (NEW) Retired; Park Ridge, NJ Our Lady of Mercy.
- Grant, Benedict W. *f.p.o.* '08 (BO) Lend Lease.
- Grant, Francis A. (SB) Wildomar, CA St. Frances of Rome.
- Grant, James A. '66 (PH) Retired.
- Grant, Jeffery A. '82 (SFD) Springfield Deanery; Commission for Priests' Benefits; Presbyteral Council; Springfield, IL Blessed Sacrament.
- Grant, John L. '12 (TSL) Office of Divine Worship; Tulsa, OK Holy Family Cathedral.
- Grant, Paul '84 (WDC)[V] Washington, DC Prelature of the Holy Cross and Opus Dei.
- Grant, Robert '84 (DM) On Duty Outside the Diocese.
- Grant, Robert J. '93 (HRT) Retired.
- Grant, Robert L. '84 (DAV)[A] Davenport, IA St. Ambrose University; Blue Grass, IA St. Andrew Church of Blue Grass, Iowa.
- Grant, Robert L. '80 (DAV)[A] Davenport, IA St. Ambrose University.
- Grant, W. Douglas '80 (PRO) Warren, RI St. Mary of the Bay.
- Grant, William David '86 (LIN) Apostolates to the Elderly.
- Granyak, Esteban '12 (PHI) Philadelphia, PA St. Charles Borromeo.
- Granyak, Esteban Nelson '12 (NEW) On Duty Outside the Archdiocese.
- Granzotto, Peter *s.d.b.* '57 (NY) Port Chester, NY Parish of St. John Bosco.
- Grappoli, Frank B. *s.x.* '63 (PAT)[L] Wayne, NJ Xaverian Missionary Fathers; (FgM) Wayne, NJ XAVERIAN MISSIONARY FATHERS.
- Grasher, Albert '86 (SPK) Colfax, WA St. Patrick; Colfax, WA St. Joseph.
- Grasing, John A. '88 (WIL) Wilmington, DE Office for Deacons; Chestertown, MD Sacred Heart.
- Grassel, Martin *s.o.s.b.* '04 (P)[L] St. Benedict, OR Mt. Angel Abbey; [Q] St. Benedict, OR The Abbey Foundation of Oregon.
- Grasselli, Rev. Msgr. Renato '94 (NEW)[A] Kearny, NJ Redemptoris Mater Archdiocesan Missionary Seminary; [P] Kearny, NJ Eucharistic Shrine of the Adorable Face of Jesus.
- Grassi, Dominic J. '73 (CHI) Retired.
- Grassi, Timothy J. '00 (WH) Thomas, WV Our Lady of Mercy Mission; Thomas, WV St. Thomas Aquinas.
- Grasso, Aldo *s.o.s.j.* '44 (MRY)[G] Santa Cruz, CA Shrine of St. Joseph.
- Grasso, Anthony R. *c.s.c.* '78 (SCR)[B] Wilkes-Barre, PA King's College.
- Grasso, Joseph *c.p.p.s.* '91 (ALB) Stratton Veterans' Administration Medical Center.
- Grasso, Joseph '92 (ALB) Special Assignment.
- Grasso, Joseph A. *c.p.p.s.* '91 (MO) DEPARTMENT OF VETERANS AFFAIRS HOSPITALS AND CHAPLAINS.
- Gratkowski, Eugene W. '87 (CHI) River Grove, IL St. Cyprian; Retired.
- Grattaroti, Robert A. '62 (WOR) Cursillo; Charlton City, MA St. Joseph's.
- Gratton, Scott A. '15 (BUR) Winooski, VT St. Francis Xavier.
- Grau, James Christopher '13 (DET) Detroit, MI Office of the Archbishop.
- Grauls, Paul *s.d.b.* '62 (SP)[Q] Tampa, FL Mary Help of Christians Center.
- Grave de Peralta, Miguel (NTN) Priests Serving Outside the Eparchy.
- Grave de Peralta, Miguel '96 (ATL) Marietta, GA Holy Family Catholic Church.
- Graven, Thomas J. '68 (STU) Retired.
- Graves, Edwin '92 (LR)[G] Little Rock, AR St. John Manor; Retired.
- Gray, Christopher P. '13 (SLC) Ecumenical Commission; Salt Lake City, UT Cathedral of the Madeleine LLC 202.
- Gray, Daniel J. '76 (PRO) Portsmouth, RI St. Anthony.
- Gray, Edward J. *c.s.s.r.* '58 (ORL) New Smyrna Beach, FL Sacred Heart.
- Gray, Howard (DET)[P] Bloomfield Hills, MI Manresa Jesuit Retreat House.
- Gray, Howard J. *s.j.* '55 (WDC)[O] Washington, DC The Jesuit Community at Georgetown University.
- Gray, James C. '88 (STL) Overland, MO All Souls Catholic Church; Overland, MO St. Jude Catholic Church.
- Gray, Rev. Msgr. Jason A. '97 (PEO) Judges; Peoria Heights, IL St. Thomas.
- Gray, John W. '58 (PRO) Retired.
- Gray, Joseph B. '09 (KAL) Retired; Albion, MI St. John the Evangelist.
- Gray, Josh (SAN) Midland, TX Our Lady of Guadalupe.
- Gray, Kevin J. '84 (HRT)[A] Bloomfield, CT St. Thomas Seminary; [G] Hartford, CT Saint Francis Hospital and Medical Center.
- Gray, Peter W. *p.s.s.* '79 (BAL)[Q] Baltimore, MD Society of St. Sulpice, Province of the United States.
- Gray, Richard '03 (BAL) Baltimore, MD St. Clare.
- Gray, Robert '88 (SJ) On Leave of Absence.
- Gray, Robert B. '57 (L) Louisville, KY St. Elizabeth of Hungary; Louisville, KY Our Mother of Sorrows; Louisville, KY St. Theresa; Retired.
- Gray, Ryan '16 (STU) Steubenville, OH Holy Name Cathedral; Steubenville, OH Hospitals; Steubenville, OH Triumph of the Cross.
- Gray, S. Matthew '11 (CHR) Scouting, Diocese of Charleston Catholic Committee on.
- Gray, S. Matthew (CHR) Columbia, SC St. Joseph.
- Gray, Samuel M. (MO) Air National Guard Chaplains.
- Gray, Sherman '70 (BGP) Leave of Absence.
- Gray, Tim *s.c.j.* '78 (GAL) Houston, TX Our Lady of Guadalupe.
- Graziadio, Rev. Msgr. Domenick T. '66 (RVC) Retired.
- Graziano, Gerard J. '61 (NEW) Retired.
- Graziano, J. Damien '67 (JOL) Retired.
- Graziano, Peter N. '63 (FR) Retired.
- Grazulis, Antanas *s.j.* '78 (CHI)[N] Lemont, IL Baltic Jesuits Advancement Project.
- Grbavac, Charbel R. *o.praem.* '06 (LA) Wilmington, CA SS. Peter and Paul.
- Grbavac, Charbel R. *o.praem.* '06 (ORG)[I] Silverado, CA Norbertine Fathers of Orange Inc.
- Grbes, Jozo *o.f.m.* '93 (CHI)[N] Chicago, IL Croatian Franciscan Custody of the Holy Family.
- Greaney, Thomas M. *s.o.s.m.* '70 (CHI)[N] Chicago, IL Monastery of Our Lady of Sorrows.
- Greany, Brendan (BRK) Brooklyn, NY Our Lady of Perpetual Help Basilica.
- Greaves, Gerald F. '74 (NEW) Bloomfield, NJ Sacred Heart; Livingston, NJ St. Raphael; Retired.
- Greaves, John G. '58 (PRO) Retired.
- Greb, John '06 (PHX) Mesa, AZ St. Timothy Roman Catholic Parish.
- Greb, Michael P. *o.f.m.cap.* '89 (PIT) New Brighton, PA McGuire Memorial Home; Forbes Hospice; [M] Beaver, PA St. Fidelis Friary.
- Grebe, James L. '12 (PT) Catholic Campus Ministry at University of West Florida; Pensacola, FL Nativity of Our Lord.
- Greco, Robert J. '93 (PIT) Pittsburgh, PA Sacred Heart.
- Grecia, Rolando '98 (HT) Houma, LA Our Lady of the Most Holy Rosary.
- Greco, Michael '15 (FWT) Permanent Deacon Formation Program; Keller, TX St. Elizabeth Ann Seton.
- Greeley, Rev. Msgr. Joseph F. '74 (LA) Lakewood, CA St. Pancratius.
- Green, Benjamin F. '12 (WCH)[C] Wichita, KS Via Christi Hospital St. Francis.
- Green, Chad (SEA) Kirkland, WA Holy Family.