

OLYMPUS GATEWAY - PECOS & S 89TH PL

MESA

project consultants

landscape architecture:

DESIGN ETHIC, LLC
7525 EAST 6TH AVENUE
SCOTTSDALE, ARIZONA 85251
CONTACT: BRANDON PAUL
PHONE: 480.225.7077
EMAIL: bpaul@designethic.net

engineering:

KBELL ENGINEERING
1355 NORTH 86TH PLACE
MESA, ARIZONA 85207
CONTACT: KELLY BELL
PHONE: 602.980.8246
EMAIL: kbell@kbelleng.com

architecture:

PINNACLE DESIGN, INC.
1048 NORTH 44TH STREET #200
PHOENIX, ARIZONA 85295
PROJECT CONTACT: COLE BRUNO
PHONE: 602.952.858
EMAIL: cbruno@pdi-az.com

owner:

OLYMPUS CONSTRUCTION MANAGEMENT
EAST PECOS ROAD #120
GILBERT, ARIZONA 85295
CONTACT: TRAVIS KAY
PHONE: 602.619.9710
EMAIL: tkay@olympuscm.com

site data:

ZONING: LT
NET SITE AREA: 84,564 SF / 1.94 AC

sheet index

SHEET	TITLE
L.01	COVER SHEET & NOTES
L.02 - L.03	PLANTING PLAN

city of mesa landscape data

ZONING:	LT - LIGHT INDUSTRIAL
NET SITE AREA:	84,564 SF / 1.94 AC
TOTAL R.O.W.:	NOT A PART
TOTAL FRONTAGE:	967 L.F.
TOTAL ON-SITE LANDSCAPE:	22,375 S.F.
PERCENTAGE OF LANDSCAPE:	85.2%
OVERALL:	
TREES PROVIDED FOR ENTIRE SITE:	71 TREES
36" BOX TREES REQUIRED:	18 TREES
(25% OF TREES REQUIRED FOR ENTIRE SITE)	
36" BOX TREES PROVIDED:	18 TREES
STREET FRONTAGE 967 LINEAR FEET:	
TREES REQUIRED:	38
(1 PER 25' OF STREET FRONTAGE - 967/25= 38)	
TREES PROVIDED:	38
24" BOX TREES REQUIRED:	19
(50% OF TREES REQUIRED)	
24" BOX TREES PROVIDED:	19
36" BOX TREES REQUIRED:	10
(25% OF TREES REQUIRED)	
36" BOX TREES PROVIDED:	10
SHRUBS REQUIRED:	228
(6 PER 25' OF STREET FRONTAGE)	
SHRUBS PROVIDED:	228

city of mesa vegetation credit table

	CREDIT (S.F.)	QTY ON PLAN	TOTAL CREDIT (S.F.)
EVERGREEN TREE: (MIN. 25'-0" TALL AT MATURITY)	100	53	5,300
SHADE TREE:	50	18	900
LARGE SHRUB: (MIN. 8'-0" TALL AT MATURITY)	50	25	1,400
MEDIUM SHRUB: (4'-0" - 8'-0" TALL AT MATURITY)	25	365	9,125
EVERGREEN GROUNDCOVER:	25	220	5,500
COLUMNAR EVERGREEN SHRUB: (MAX. 8'-0" TALL AT MATURITY)	10	15	150
TOTAL VEGETATION CREDIT (S.F.)			22,375
TOTAL OPEN SPACE (S.F.)			26,275
VEGETATION COVERAGE (%)			85.16

city of mesa notes

ALL LANDSCAPING WITHIN THE RIGHT-OF-WAY IS IN CONFORMANCE WITH THE LOW WATER USE PLANT LIST PROVIDED BY THE ARIZONA DEPT. OF WATER RESOURCES.

ALL LANDSCAPING INSTALLED WITH THIS PROJECT SHALL BE MAINTAINED BY OWNER/OR LESSEE IN ACCORDANCE WITH THE APPROVED LANDSCAPE PLAN. TREE HEIGHTS & CALIPERS WILL COMPLY WITH "ARIZONA NURSEY ASSOCIATION SPECIFICATIONS" FOR THAT TYPE & SIZE OF TREE.

ALL TREES AND SHRUBS LOCATED IN THE LINE-OF-SIGHT WILL BE MAINTAINED FOR A CLEAR AREA BETWEEN 3' TO 7' ALL BACKFLOW PREVENTERS 2" OR LARGER SHALL BE SCREENED WITH LANDSCAPE MATERIAL LOCATED WITHIN A 6' RADIUS OF OF THE BACKFLOW PREVENTER.

ALL BACKFLOW PREVENTERS LESS THAN 2" SHALL BE PLACED IN A WIRE MESH BASKET AND PAINTED GREEN.

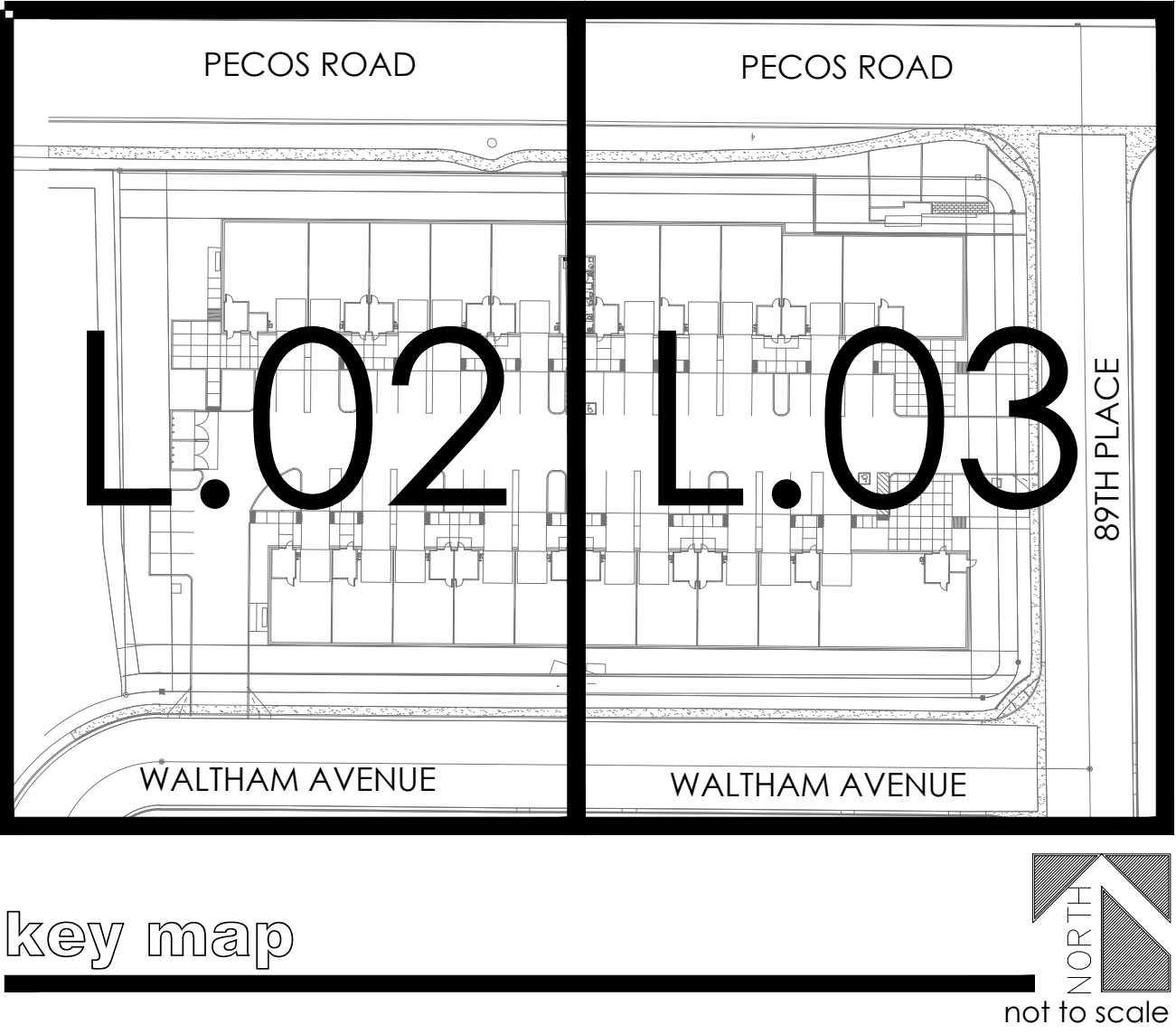
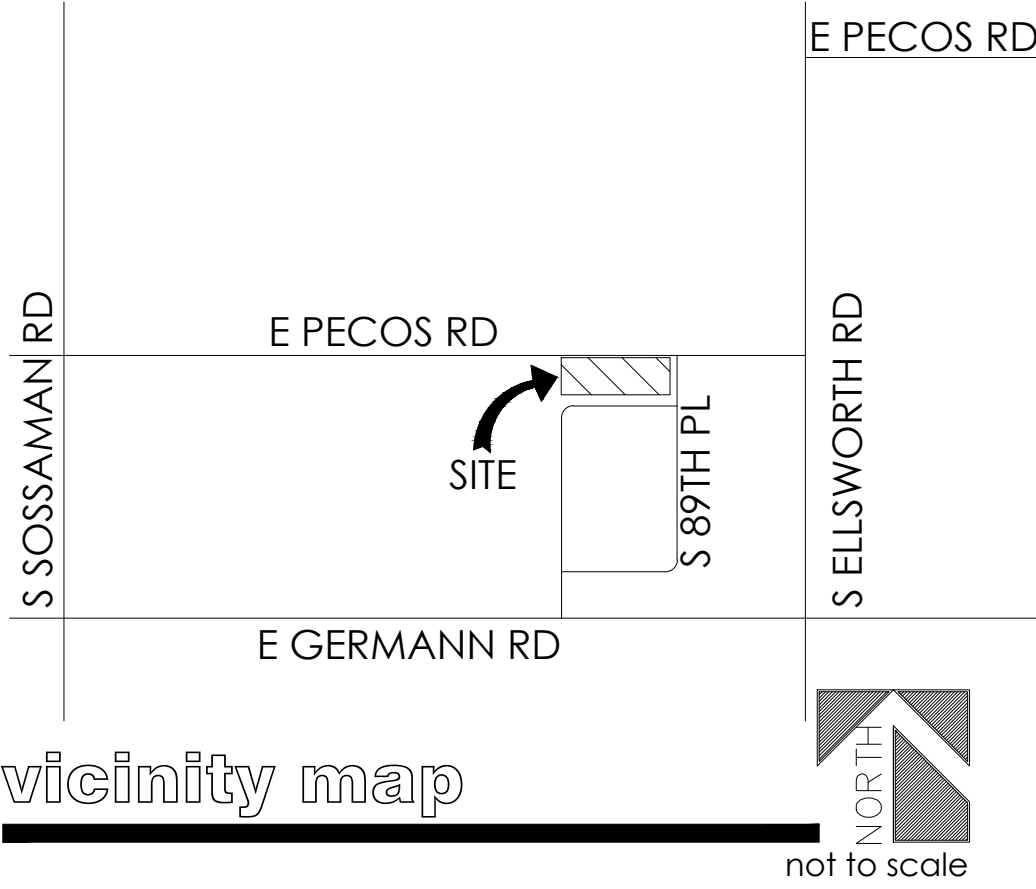
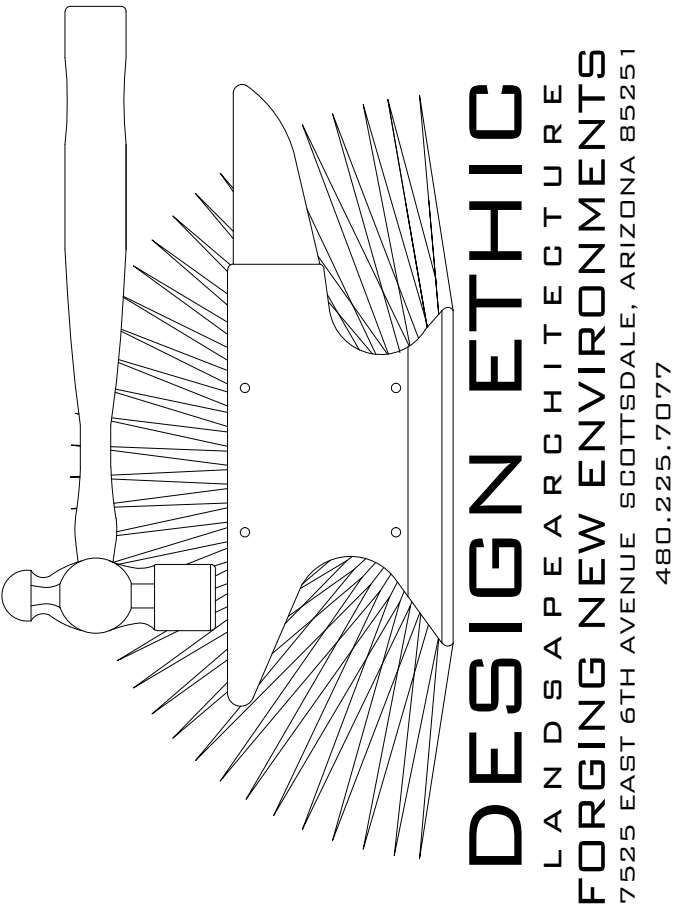

OLYMPUS GATEWAY
PECOS RD & SOUTH 89TH PL
MESA, ARIZONA
COVER SHEET & NOTES

PROJECT:	
JOB NO:	21-077
DATE:	
DRAWN BY:	B. PAUL
SUBMITTED:	08.03.2022
REVISED:	
SHEET	

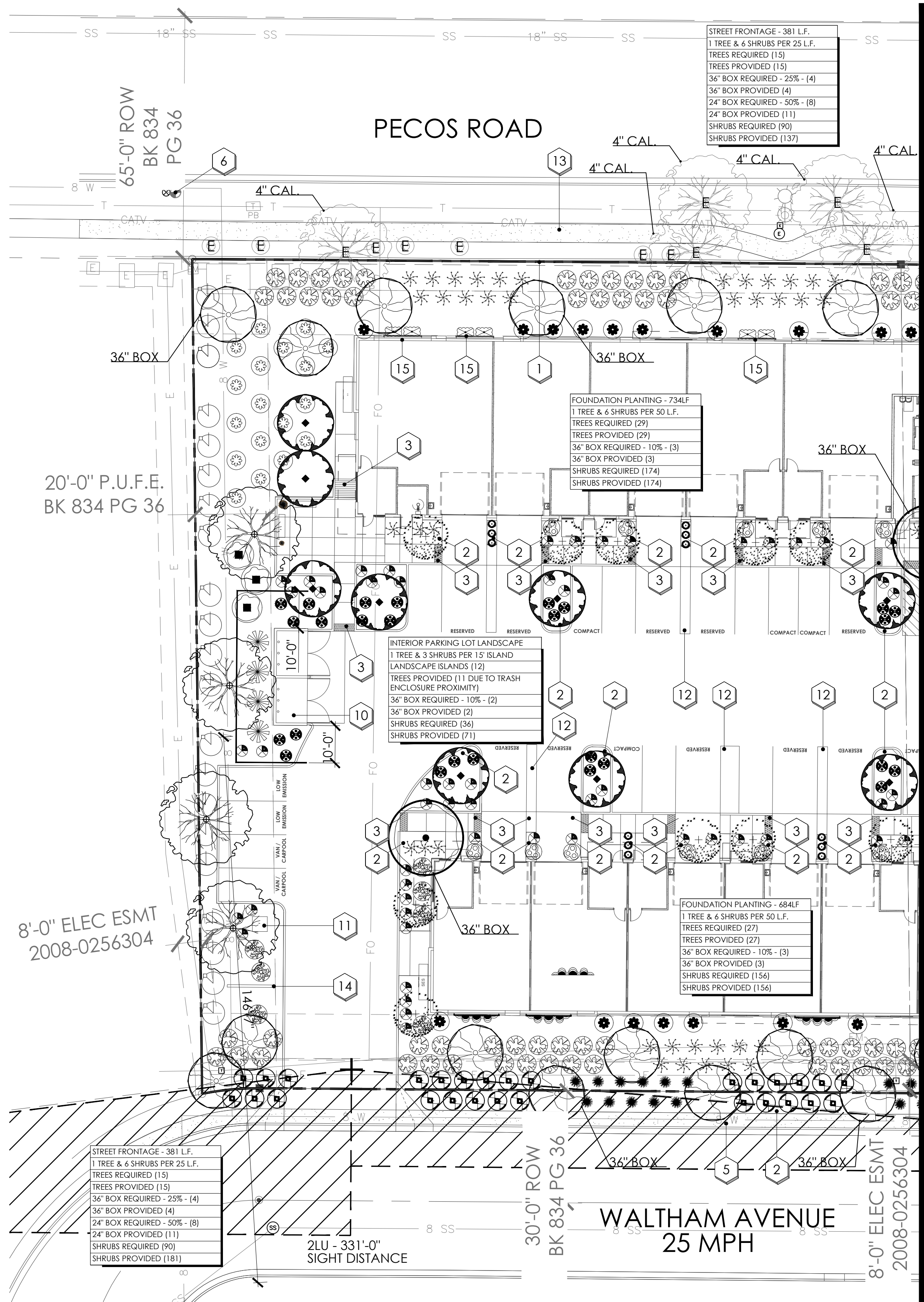

existing landscape & irrigation notes

1. SITE VERIFY ALL EXISTING CONDITIONS PRIOR TO BIDDING. ANY DISCREPANCIES ARE TO BE BROUGHT TO THE LANDSCAPE ARCHITECT'S ATTENTION WITHIN 24 HOURS OF THE OBSERVATION.
2. CONTRACTOR TO INSPECT EXISTING IRRIGATION SYSTEM AND VERIFY THAT THE SYSTEM IS WORKING PROPERLY.
3. ALL PLANT MATERIAL DESIGNATED AS "EXISTING TO REMAIN" SHALL BE PROTECTED DURING ALL PHASES OF CONSTRUCTION. ANY TREE(S) THAT DIE DUE TO: LACK OF WATER, LACK OF MAINTENANCE OR CARE, NEGLIGENCE OR VANDALISM SHALL BE REPLACED BY A SIMILAR SPECIES OF TREE, (MINIMUM 48" BOX) AT NO ADDITIONAL COST TO OWNER. PALMS THAT DIE SHALL BE REPLACED WITH LIKE TYPE: HEIGHT AND SIZE. ALL SHRUBS AND GROUNDCOVER SHALL BE REPLACED WITH 5 GALLON PLANTS.
4. LANDSCAPE AREAS DISTURBED BY NEW CONSTRUCTION SHALL BE REPAIRED WITH SOD IN TURF AREAS AND NEW DECOMPOSED GRANITE MATCHING EXISTING. BLEND ALL DISTURBED AREAS WITH UNDISTURBED SO THERE IS A SMOOTH TRANSITION BETWEEN ALL EDGES. REPLACE ALL DISTURBED, BROKEN OR DAMAGED HEADERS WITH MATCHING TYPE.
5. ALL EXISTING PLANT MATERIAL AND ADJACENT PLANT MATERIAL SHALL HAVE UN-INTERRUPTED WATERING DURING ALL PHASES OF CONSTRUCTION. THIS SHALL INCLUDE BUT NOT BE LIMITED TO; HAND WATERING, TEMPORARY ABOVE GROUND IRRIGATION, EXISTING SYSTEM, ETC.
6. THE EXISTING IRRIGATION SYSTEM SHALL BE PROTECTED, MAINTAINED AND REPAIRED DURING ALL PHASES OF CONSTRUCTION. ALL EQUIPMENT SUCH AS MAINLINE, WIRES, LATERAL HEADS AND ETC. SHALL BE REPAIRED AND REPLACED TO MAINTAIN CONTINUOUS WATER.
7. PROVIDE NEW SCHEDULE 40 SLEEVES AT ALL NEW DRIVES. (SEE SLEEVE SCHEDULE FOR SIZE.) ANY EXISTING IRRIGATION SYSTEM IS TO BE MAINTAINED AT ALL TIMES DURING CONSTRUCTION AND GUARANTEE 100% COVERAGE.
8. EXISTING TREES TO REMAIN SHALL BE SELECTIVELY PRUNED PER LANDSCAPE ARCHITECT INSTRUCTIONS.
9. ALL EXISTING SHRUBS WITHIN THE SIGHT DISTANCE LINES AND SIGHT VISIBILITY TRIANGLES SHALL BE SELECTIVELY PRUNED SO THAT THEY DO NOT EXCEED A MAXIMUM HEIGHT OF 30 INCHES.
10. ALL EXISTING TREES SHALL BE TRIMMED TO MAINTAIN A CLEAR A MINIMUM CANOPY HEIGHT OF 7 FEET.

planting key notes

- 1 PROPERTY LINE / RIGHT OF WAY LINE
- 2 DECOMPOSED GRANITE IN ALL PLANTING AREAS
- 3 SIGHT VISIBILITY TRIANGLE. MAXIMUM MATURE PLANT MATERIAL HEIGHT IN THE SIGHT VISIBILITY TRIANGLES IS 24 INCHES
- 4 ACCESSIBLE RAMP. SEE CIVIL ENG. PLANS.
- 5 SIDEWALK.
- 6 FIRE HYDRANT -3'-0" CLEAR OF ALL PLANT MATERIAL
- 7 FIRE LINE BACKFLOW PREVENTOR - SCREEN MAINTAIN 3' ACCESS & CLEARANCE PER MAG STANDARD DETAIL 362.
- 8 EXISTING MONUMENT SIGN (TO REMAIN)
- 9 CURB. SEE CIVIL ENG. PLANS.
- 10 TRASH ENCLOSURE. SEE ARCHITECT'S SITE PLAN. TREE PLANTING SHOULD NOT TAKE PLACE WITHIN TEN (10) FEET OF THE BIN ENCLOSURE AND SHOULD BE SPACED SO AS NOT TO CREATE AN AERIAL OBSTRUCTION FOR THE BIN DUMPING AT THE FINAL FULL GROWTH DIMENSIONS.
- 11 PROPOSED TRANSFORMER LOCATION. MAINTAIN 3' ACCESS & CLEARANCE AROUND ALL EDGES. ALLOW FOR 12' CLEAR OPERATIONAL AREA IMMEDIATELY IN FRONT OF TRANSFORMER.
- 12 PARKING STRIPE (TYPICAL)
- 13 EXISTING SIDEWALK & LANDSCAPE (TYPICAL)
- 14 SCREEN WALL. SEE ARCH. PLANS.
- 15 10'-0" X 10'-0" PLANTING TRELLIS. SEE ARCH. PLANS.

general landscape notes

1. CONTRACTOR TO VERIFY ALL QUANTITIES.
2. CONTRACTOR TO PROVIDE DECOMPOSED GRANITE SAMPLES TO LANDSCAPE ARCHITECT FOR APPROVAL.
3. MAINTAIN 3' TO 5' TREE AND SHRUB CLEARANCE FROM WALLS.
4. MAINTAIN 1' TO 2' TREE AND SHRUB CLEARANCE FROM SIDEWALKS.
5. TREES ADJACENT TO PEDESTRIAN WALKWAYS SHOULD HAVE A MINIMUM CANOPY CLEARANCE OF 6'-8".
6. ALL MATURE TREES AND PALM CANOPIES MUST BE A MINIMUM OF 5' FROM ANY BUILDING WALLS OR BUILDING WINDOWS.

existing plant legend

	botanical name common name	emitters	size	qty	comments
trees					
	OLEA EUROPAEA SWAN HILL OLIVE	(6 @ 1.0 GPH)	SIZE VARIES	6	REMAIN IN PLACE
	ULMUS PARVIFOLIA EVERGREEN ELM	(6 @ 2.0 GPH)	SIZE VARIES	8	REMAIN IN PLACE
palms					
	PHOENIX DACTYLIFERA DATE PALM		SIZE VARIES	5	STAKE IN PLACE
shrubs					
	LEUCOPHYLLUM FRUTESCENS 'GREEN CLOUD' GREEN CLOUD SAGE	(1 @ 1.0 GPH)	5 GAL.	15	PLANT AT 8' O.C.
	NERIUM OLEANDER PETITE PINK OLEANDER	(1 @ 1.0 GPH)	5 GAL.	16	PLANT AT 5' O.C.
accents					
	DASYLIRON WHEELERI DESERT SPOON		5 GAL.	30	PLANT AT 5' O.C.

proposed plant legend

	botanical name common name	emitters	size	qty	comments
evergreen trees					
	ACACIA ANEURA MULGA	(5 @ 1.0 GPH)	15 GAL.	13	4.0H., 1.0W., 0.5CAL. STAKE IN PLACE
	ACACIA SALICINA WILLOW ACACIA	(5 @ 1.0 GPH)	24" BOX 36" BOX	17 8	7.0H., 2.5W., 1.25CAL. 9.0H., 5.0W., 2.0CAL. STAKE IN PLACE
	MARIOSOSA WILLARDIANA PALO BLANCO	(5 @ 1.0 GPH)	24" BOX	15	5.0H., 2.5W., 1.0CAL. STAKE IN PLACE
shade trees					
	ULMUS PARVIFOLIA EVERGREEN ELM	(5 @ 1.0 GPH)	15 GAL.	4	6.0H., 2.0W., 0.5CAL. STAKE IN PLACE
	PARKINSONIA X. 'DESERT MUSEUM' DESERT MUSEUM	(5 @ 1.0 GPH)	24" BOX 36" BOX	4 10	5.0H., 3.0W., 1.0CAL. 8.0H., 5.0W., 1.75CAL. STAKE IN PLACE
large shrubs					
	TECOMA STANS YELLOW BELLS	(1 @ 1.0 GPH)	5 GAL.	22	
	LEUCOPHYLLUM FRUTESCENS 'GREEN CLOUD' GREEN CLOUD SAGE	(1 @ 1.0 GPH)	5 GAL.	3	
medium shrubs					
	AGAVE AMERICANA CENTURY PLANT	(1 @ 1.0 GPH)	5 GAL.	4	
	BOUGAINVILLEA 'LA JOLLA' LA JOLLA BOUGAINVILLEA	(1 @ 1.0 GPH)	5 GAL.	30	
	BOUGAINVILLEA X BUTTIANA 'ORANGE KING' 'ORANGE KING BOUGAINVILLEA	(1 @ 1.0 GPH)	5 GAL.	33	
	DASYLIRON WHEELERI DESERT SPOON	(1 @ 1.0 GPH)	5 GAL.	97	
	EUPHORBIA TRICUCALLI STICKS OF FIRE	(1 @ 1.0 GPH)	5 GAL.	22	
	HESPERALOE FUNIFERA GIANT HESPERALOE	(1 @ 1.0 GPH)	5 GAL.	91	
	HESPERALOE PARVIFLORA RED YUCCA	(1 @ 1.0 GPH)	5 GAL.	58	
	MUHLENBERGIA RIGENS DEER GRASS	(1 @ 1.0 GPH)	5 GAL.	9	
	OPUNTIA FICUS INDICA INDIAN FIG PRICKLY PEAR	(1 @ 1.0 GPH)	5 GAL.	21	
evergreen groundcover					
	LANTANA 'DALLAS RED' RED LANTANA	(1 @ 1.0 GPH)	5 GAL.	35	
	EREMOPHILA GLABRA 'MIGNEW GOLD'. OUTBACK SUNRISE EMU	(1 @ 1.0 GPH)	5 GAL.	76	
	MUHLENBERGIA CAPILLARIS REGAL MIST	(1 @ 1.0 GPH)	5 GAL.	82	
	MUHLENBERGIA RIGIDA NASHVILLE DEER GRASS	(1 @ 1.0 GPH)	5 GAL.	27	
columnar evergreen shrub					
	FICUS PUMILA CREEPING FIG	(1 @ 1.0 GPH)	5 GAL.	8	
	MACFADYENA UNGUIS-CATI CAT'S CLAW VINE	(1 @ 1.0 GPH)	5 GAL.	7	
inerts					
	1/2" SCREENED DECOMPOSED GRANITE EXPRESS GOLD MATCH EXISTING ADJACENT	1/2" SCRN	26.275 S.F.	2"	MINIMUM IN ALL PLANTERS

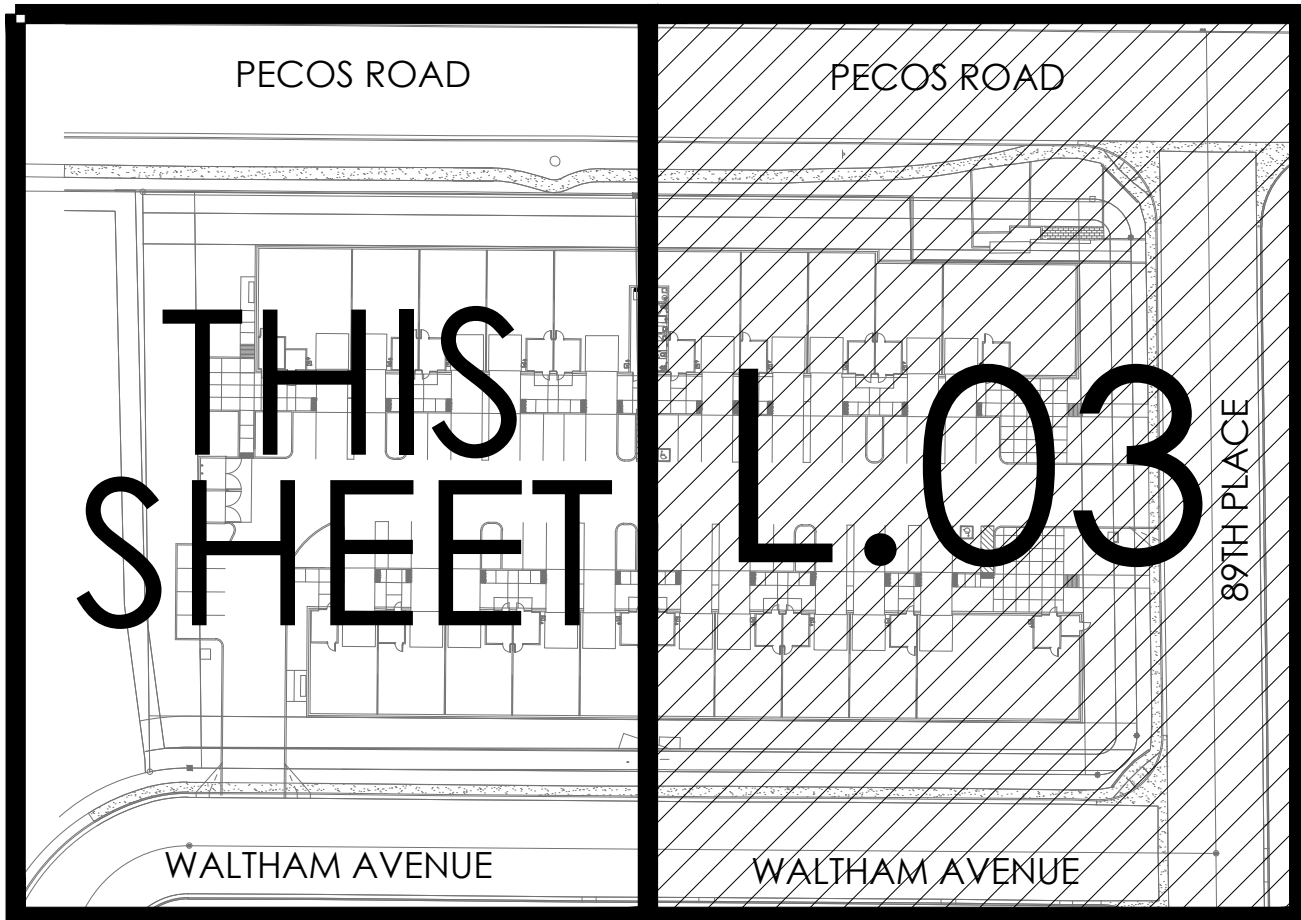

key map

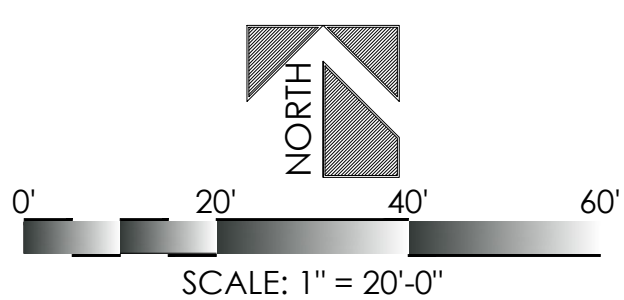
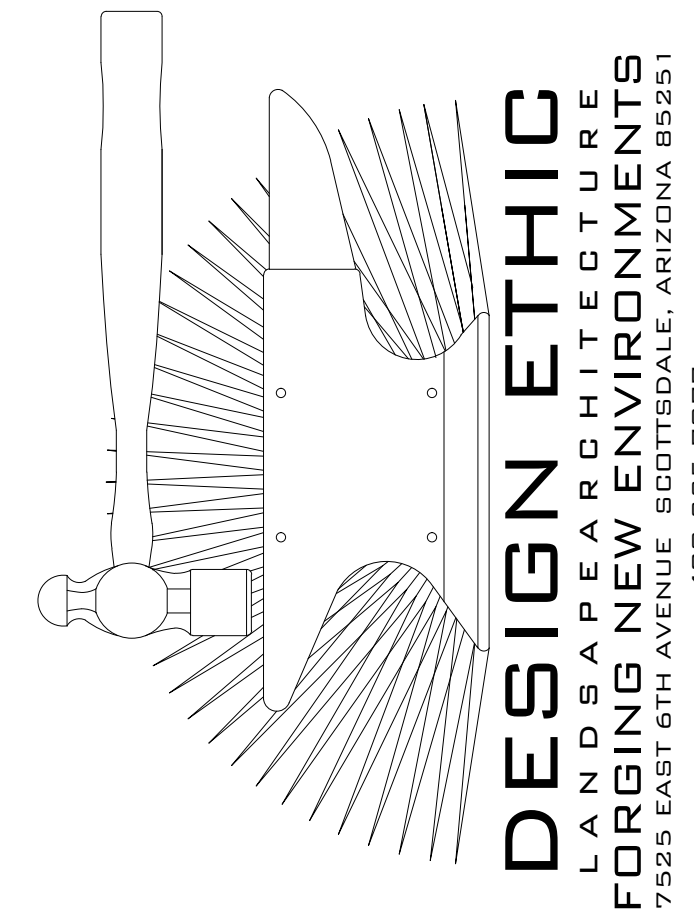

OLYMPUS GATEWAY
PECOS RD & SOUTH 89TH PL
MESA, ARIZONA

PLANTING PLAN

PROJECT:

JOB NO: 21-077
DATE:
DRAWN BY: B. PAUL
SUBMITTED: 08.03.2022
REVISED:

SHEET TITLE:

SHEET

L.02 of L.03

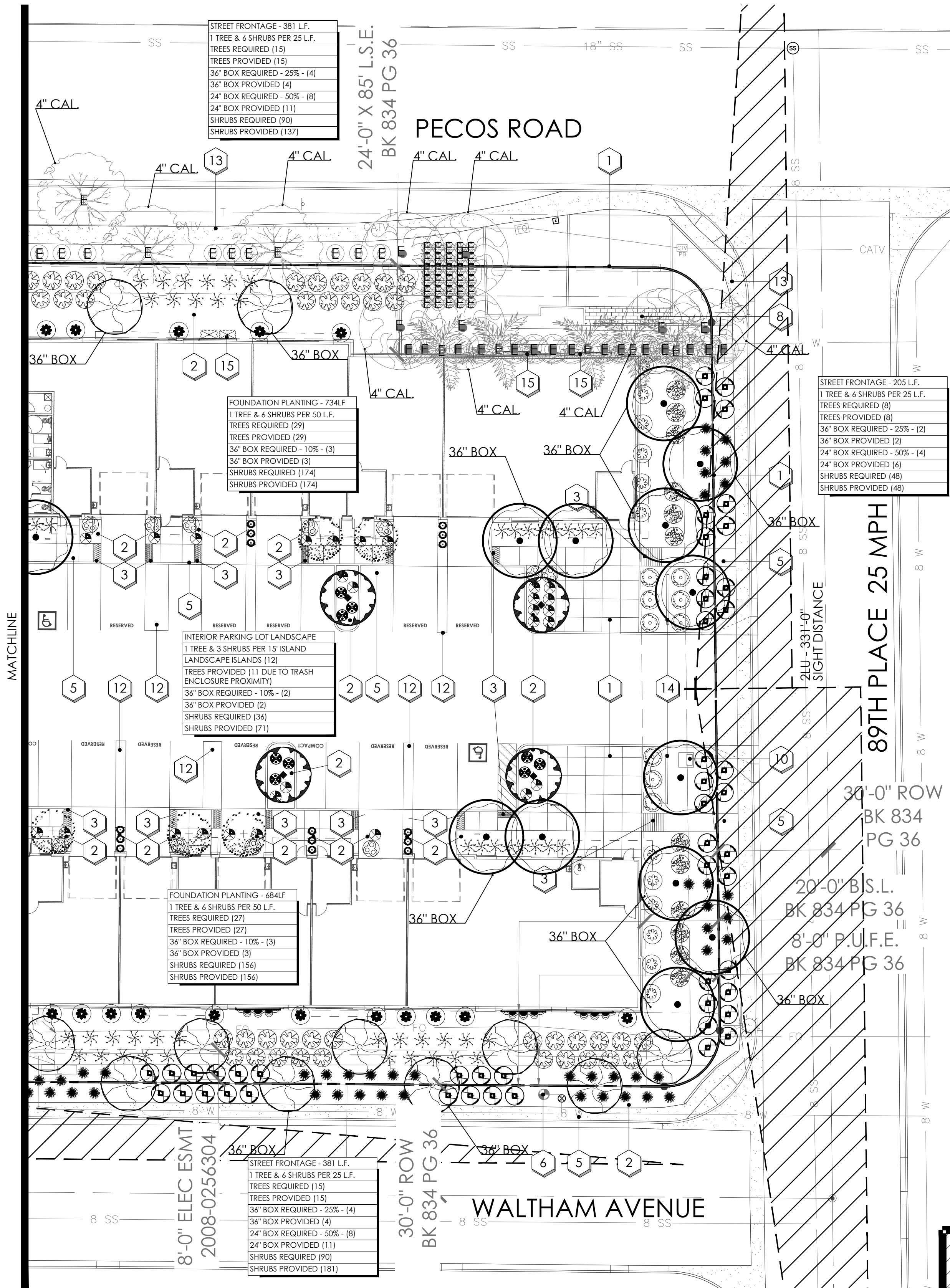

existing landscape & irrigation notes

1. SITE VERIFY ALL EXISTING CONDITIONS PRIOR TO BIDDING. ANY DISCREPANCIES ARE TO BE BROUGHT TO THE LANDSCAPE ARCHITECT'S ATTENTION WITHIN 24 HOURS OF THE OBSERVATION.
2. CONTRACTOR TO INSPECT EXISTING IRRIGATION SYSTEM AND VERIFY THAT THE SYSTEM IS WORKING PROPERLY.
3. ALL PLANT MATERIAL DESIGNATED AS "EXISTING TO REMAIN" SHALL BE PROTECTED DURING ALL PHASES OF CONSTRUCTION. ANY TREE(S) THAT DIE DUE TO: LACK OF WATER, LACK OF MAINTENANCE OR CARE, NEGLECT OR VANDALISM SHALL BE REPLACED BY A SIMILAR SPECIES OF TREE, (MINIMUM 48" BOX) AT NO ADDITIONAL COST TO OWNER. PALMS THAT DIE SHALL BE REPLACED WITH LIKE TYPE: HEIGHT AND SIZE. ALL SHRUBS AND GROUNDCOVER SHALL BE REPLACED WITH 5 GALLON PLANTS.
4. LANDSCAPE AREAS DISTURBED BY NEW CONSTRUCTION SHALL BE REPAIRED WITH SOD IN TURF AREAS AND NEW DECOMPOSED GRANITE MATCHING EXISTING. BLEND ALL DISTURBED AREAS WITH UNDISTURBED SO THERE IS A SMOOTH TRANSITION BETWEEN ALL EDGES. REPLACE ALL DISTURBED, BROKEN OR DAMAGED HEADERS WITH MATCHING TYPE.
5. ALL EXISTING PLANT MATERIAL AND ADJACENT PLANT MATERIAL SHALL HAVE UN-INTERRUPTED WATERING DURING ALL PHASES OF CONSTRUCTION. THIS SHALL INCLUDE BUT NOT BE LIMITED TO; HAND WATERING, TEMPORARY ABOVE GROUND IRRIGATION, EXISTING SYSTEM ,ETC.
6. THE EXISTING IRRIGATION SYSTEM SHALL BE PROTECTED, MAINTAINED AND REPAIRED DURING ALL PHASES OF CONSTRUCTION. ALL EQUIPMENT SUCH AS MAINLINE, WIRES, LATERAL HEADS AND ETC. SHALL BE REPAIRED AND REPLACED TO MAINTAIN CONTINUOUS WATER.
7. PROVIDE NEW SCHEDULE 40 SLEEVES AT ALL NEW DRIVES. (SEE SLEEVE SCHEDULE FOR SIZE.) ANY EXISTING IRRIGATION SYSTEM IS TO BE MAINTAINED AT ALL TIMES DURING CONSTRUCTION AND GUARANTEE 100% COVERAGE.
8. EXISTING TREES TO REMAIN SHALL BE SELECTIVELY PRUNED PER LANDSCAPE ARCHITECT INSTRUCTIONS.
9. ALL EXISTING SHRUBS WITHIN THE SIGHT DISTANCE LINES AND SIGHT VISIBILITY TRIANGLES SHALL BE SELECTIVELY PRUNED SO THAT THEY DO NOT EXCEED A MAXIMUM HEIGHT OF 30 INCHES.
10. ALL EXISTING TREES SHALL BE TRIMMED TO MAINTAIN A CLEAR A MINIMUM CANOPY HEIGHT OF 7 FEET.

planting key notes

- 1 PROPERTY LINE / RIGHT OF WAY LINE
- 2 DECOMPOSED GRANITE IN ALL PLANTING AREAS
- 3 SIGHT VISIBILITY TRIANGLE. MAXIMUM MATURE PLANT MATERIAL HEIGHT IN THE SIGHT VISIBILITY TRIANGLES IS 24 INCHES
- 4 ACCESSIBLE RAMP. SEE CIVIL ENG. PLANS.
- 5 SIDEWALK.
- 6 FIRE HYDRANT -3'-0" CLEAR OF ALL PLANT MATERIAL
- 7 FIRE LINE BACKFLOW PREVENTOR - SCREEN MAINTAIN 3' ACCESS & CLEARANCE PER MAG STANDARD DETAIL 362.
- 8 EXISTING MONUMENT SIGN (TO REMAIN)
- 9 CURB. SEE CIVIL ENG. PLANS.
- 10 TRASH ENCLOSURE. SEE ARCHITECT'S SITE PLAN. TREE PLANTING SHOULD NOT TAKE PLACE WITHIN TEN (10) FEET OF THE BIN ENCLOSURE AND SHOULD BE SPACED SO AS NOT TO CREATE AN AERIAL OBSTRUCTION FOR THE BIN DUMPING AT THE FINAL FULL GROWTH DIMENSIONS.
- 11 PROPOSED TRANSFORMER LOCATION. MAINTAIN 3' ACCESS & CLEARANCE AROUND ALL EDGES. ALLOW FOR 12' CLEAR OPERATIONAL AREA IMMEDIATELY IN FRONT OF TRANSFORMER.
- 12 PARKING STRIPE (TYPICAL)
- 13 EXISTING SIDEWALK & LANDSCAPE (TYPICAL)
- 14 SCREEN WALL. SEE ARCH. PLANS.
- 15 10'-0" X 10'-0" PLANTING TRELLIS. SEE ARCH. PLANS.

existing plant legend

	botanical name common name	emitters	size	qty	comments
trees					
	OLEA EUROPAEA SWAN HILL OLIVE	(6 @ 1.0 GPH)	SIZE VARIES	6	REMAIN IN PLACE
	ULMUS PARVIFOLIA EVERGREEN ELM	(6 @ 2.0 GPH)	SIZE VARIES	8	REMAIN IN PLACE
palms					
	PHOENIX DACTYLIFERA DATE PALM		SIZE VARIES	5	STAKE IN PLACE
shrubs					
	LEUCOPHYLLUM FRUTESCENS 'GREEN CLOUD' GREEN CLOUD SAGE	(1 @ 1.0 GPH)	5 GAL.	15	PLANT AT 8' O.C.
	NERIUM OLEANDER PETITE PINK OLEANDER	(1 @ 1.0 GPH)	5 GAL.	16	PLANT AT 5' O.C.
accents					
	DASYLIRION WHEELERI DESERT SPOON		5 GAL.	30	PLANT AT 5' O.C.

proposed plant legend

	botanical name common name	emitters	size	qty	comments
evergreen trees					
	ACACIA ANEURA MULGA	(5 @ 1.0 GPH)	15 GAL.	13	4.0H., 1.0W., 0.5CAL. STAKE IN PLACE
	ACACIA SALICINA WILLOW ACACIA	(5 @ 1.0 GPH)	24" BOX 36" BOX	17 8	7.0H., 2.5W., 1.25CAL. 9.0H., 5.0W., 2.0CAL. STAKE IN PLACE
	MARIOSOSA WILLARDIANA PALO BLANCO	(5 @ 1.0 GPH)	24" BOX	15	5.0H., 2.5W., 1.0CAL. STAKE IN PLACE
shade trees					
	ULMUS PARVIFOLIA EVERGREEN ELM	(5 @ 1.0 GPH)	15 GAL.	4	6.0H., 2.0W., 0.5CAL. STAKE IN PLACE
	PARKINSONIA X. 'DESERT MUSEUM' DESERT MUSEUM	(5 @ 1.0 GPH)	24" BOX 36" BOX	4 10	5.0H., 3.0W., 1.0CAL. 8.0H., 5.0W., 1.75CAL. STAKE IN PLACE
large shrubs					
	TECOMA STANS YELLOW BELLS	(1 @ 1.0 GPH)	5 GAL.	22	
	LEUCOPHYLLUM FRUTESCENS 'GREEN CLOUD' GREEN CLOUD SAGE	(1 @ 1.0 GPH)	5 GAL.	3	
medium shrubs					
	AGAVE AMERICANA CENTURY PLANT	(1 @ 1.0 GPH)	5 GAL.	4	
	BOUGAINVILLEA 'LA JOLLA' LA JOLLA BOUGAINVILLEA	(1 @ 1.0 GPH)	5 GAL.	30	
	BOUGAINVILLEA X BUTTIANA 'ORANGE KING' 'ORANGE KING BOUGAINVILLEA	(1 @ 1.0 GPH)	5 GAL.	33	
	DASYLIRION WHEELERI DESERT SPOON	(1 @ 1.0 GPH)	5 GAL.	97	
	EUPHORBIA TRICUCALLI STICKS OF FIRE	(1 @ 1.0 GPH)	5 GAL.	22	
	HESPERALOE FUNIFERA GIANT HESPERALOE	(1 @ 1.0 GPH)	5 GAL.	91	
	HESPERALOE PARVIFLORA RED YUCCA	(1 @ 1.0 GPH)	5 GAL.	58	
	MUHLBERGIA RIGENS DEER GRASS	(1 @ 1.0 GPH)	5 GAL.	9	
	OPUNTIA FICUS INDICA INDIAN FIG 'PRICKLY PEAR	(1 @ 1.0 GPH)	5 GAL.	21	
evergreen groundcover					
	LANTANA 'DALLAS RED' RED LANTANA	(1 @ 1.0 GPH)	5 GAL.	35	
	EREMOPHILA GLABRA 'MIGNEW GOLD'. OUTBACK SUNRISE EMU	(1 @ 1.0 GPH)	5 GAL.	76	
	MUHLBERGIA CAPILLARIS REGAL MIST	(1 @ 1.0 GPH)	5 GAL.	82	
	MUHLBERGIA RIGIDA NASHVILLE DEER GRASS	(1 @ 1.0 GPH)	5 GAL.	27	
columnar evergreen shrub					
	FICUS PUMILA CREEPING FIG	(1 @ 1.0 GPH)	5 GAL.	8	
	MACFADYENA UNGUIS-CATI CAT'S CLAW VINE	(1 @ 1.0 GPH)	5 GAL.	7	
inerts					
	1/2" SCREENED DECOMPOSED GRANITE EXPRESS GOLD MATCH EXISTING ADJACENT		1/2" SCRN	26,275 S.F.	2" MINIMUM IN ALL PLANTERS

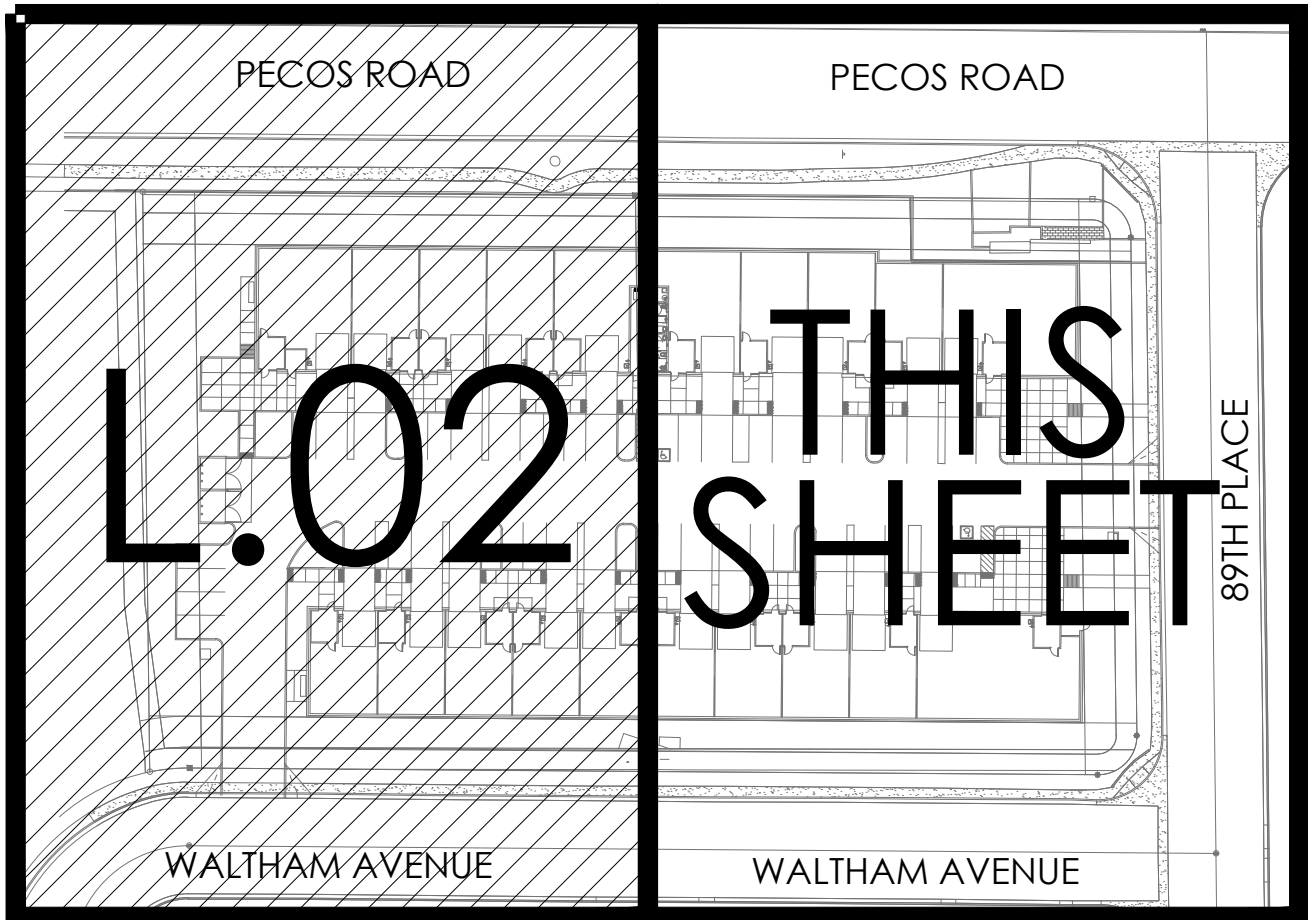

key map

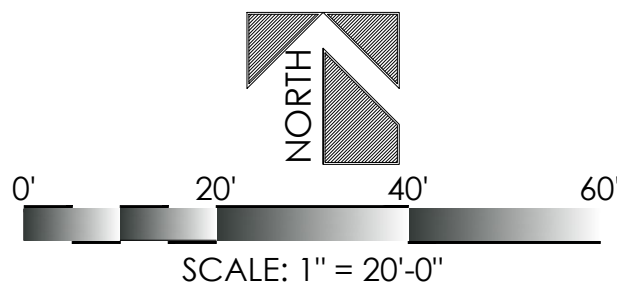
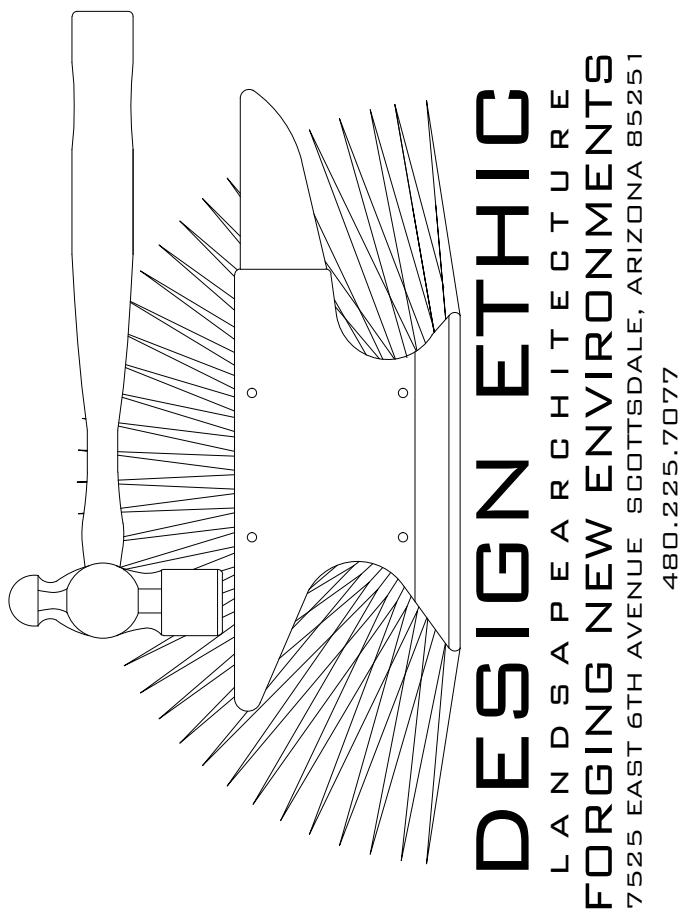

OLYMPUS GATEWAY
PECOS RD & SOUTH 89TH PL
MESA, ARIZONA

PLANTING PLAN

PROJECT:

JOB NO: 21-077
DATE:
DRAWN BY: B. PAUL
SUBMITTED: 08.03.2022
REVISED:

SHEET TITLE:

SHEET

L.03 of L.03