

Orcutt|Winslow Project 21_042 Primary Care Clinic at Cadence, architectural plans Sheet A-101 first floor plan was plotted by hspenciu.c on Monday, June 27, 2022 at 2:14 PM. file found at BIMcloud - OW BIMcloud - BIMcloud/Health Care Studio/21_191 PCH Primary Care Clinic Prototype

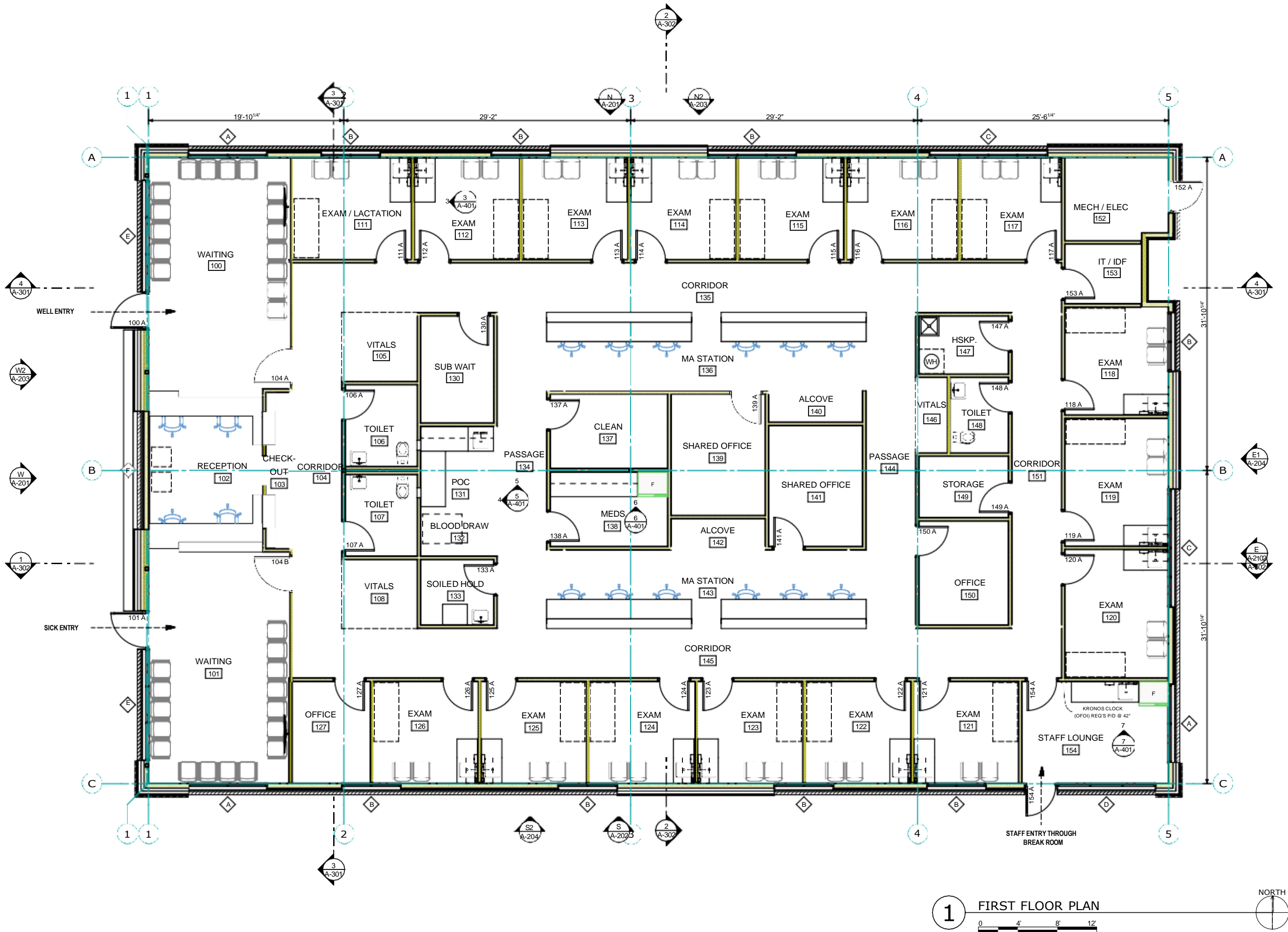

FLOOR PLAN GENERAL NOTES:

- A. Keynotes and legends are typical for all floor plan sheets, and may not apply to each sheet.
- B. Dimensions are to face of masonry, concrete and studs and centerline of columns, unless noted otherwise.
- C. Refer enlarged floor plans and details for specific locations of plumbing fixtures.
- D. Field verify all dimensions prior to fabrication of any cabinetry, frames, structural items, etc.
- E. Provide painted access panels in walls and ceilings at concealed items, such as valves, shock absorbers, controls, switches, etc., and any other items that may require access. It is the Contractor's responsibility to determine access panel locations.
- F. Fabricate and install all guardrails and handrails in accordance with all applicable codes, regulations, and AHJ.
- G. Seal all penetrations in fire rated assemblies as required by all applicable codes. Permanently label all penetrations and assemblies.
- H. Verify and coordinate all requirements for owner furnished items, prior to performance of any work that is to accommodate and interface with such items.
- I. All angles are increments of 45 degrees unless noted otherwise.
- J. Extend wall envelope insulation from floor line to meet roof insulation.
- K. Provide "Fry" reveal FDM 625-75 or equal at all gypsum board to masonry or concrete transitions.
- L. Refer to sheet G-004 for wall types and diagrams. All stud frame walls to be Type W04 and all furred walls to be WF07E, unless noted otherwise.

FLOOR PLAN KEYNOTES:

FLOOR PLAN LEGEND

- FEC 107 FIRE EXTINGUISHER IN CABINET.
- FE FIRE EXTINGUISHER ON WALL BRACKET CENTER @ 48" AFF
- PS PROJECTION SCREEN
- TB 4'-0" X 4'-0" TACKBOARD . MOUNT AT 3'-2" A.F.F.
- [51"] FLAT-PANEL TELEVISION, WALL-MOUNTED WITH POWER & AV CONNECTION
- MB 4'-0" X 8'-0" MARKERBOARD . MOUNT AT 3'-2" A.F.F.
- 1 HOUR RATED WALL ASSEMBLY
- 2 HOUR RATED WALL ASSEMBLY

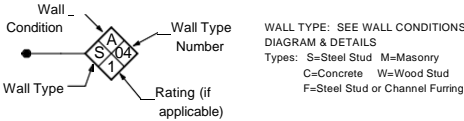

orcutt|winslow

2929 n central ave
eleventh floor
phoenix arizona 85012
chasty.t@owp.com

602.257.1764 t
602.257.9029 f

www.owp.com

18963
H. NEIL
TERRY

© 2021 this third copy or electronic drawing is an instrument of service and the property of the Orcutt|Winslow Partnership and shall remain their property. The design professional shall not be responsible for any alterations, modifications or additions made to this drawing by any party other than the design professional. Use of this drawing shall be limited to the original use for which it was prepared and publication thereof is expressly limited to such use, re-use or reproduction. Unless otherwise agreed in writing, design professional reserves all copyright or other proprietary interest in this drawing, and it may not be re-used for any other purpose without the design professional's written consent. Publication by any method in whole or part is prohibited without the written permission of the design professional. Any information obtained or conclusions derived from this drawing shall be at the user's sole risk.

Phoenix Children's Hospital

Primary Care Clinic at Cadence

S Ellsworth Rd & E Cadence Pkwy, Mesa, Arizona 85212

CLIENT CONTACT

Jessica Adams	602.933.2903 t
1919 East Thomas Road	jadams3
Phoenix, Arizona 85016	@phoenixchildrens.com
PROJECT NO.	DATE OF ISSUE
21_042	05.26.2022
REVISION NO.	DATE

PROJECT TEAM	DRAWN BY
healthcare	TJC, CH

PROJECT PHASE	
DR Package	

SHEET CONTENTS	
first floor plan	

SHEET NO.	
-----------	--

A-101