

- A. ALL DRAWINGS ARE TO BE REFERENCED AS A COMPLETE SET AND SHALL BE COORDINATED WITH THE OTHER DISCIPLINES. INFORMATION INDICATED ON ONE DRAWING ARE TO BE ASSUMED AS INCLUSIVE TO ALL DRAWINGS. ANNOTATION PROVIDED AS TYPICAL CONDITIONS RELATE TO ALL SIMILAR CONDITIONS WHETHER NOTED OR GRAPHICALLY REPRESENTED. REQUEST IN WRITING TO ARCHITECT FOR DISCREPANCIES OR CLARIFICATIONS PRIOR TO COMMENCING PORTION OF WORK.
- B. ALL DIMENSIONS ARE FROM FACE OF METAL STUD, FACE OF MASONRY OR CENTERLINE OF GRID.
- C. ALL METAL STUD AND MASONRY WALLS WILL EXTEND TO THE UNDERSIDE OF DECK UNLESS OTHERWISE NOTED.
- D. PROVIDE FRY Z REGLET WHERE GYM/EIFS/DEFS ABUTS FINISHED MASONRY/BRICK. UNLESS NOTED OTHERWISE.
- E. UNLESS NOTED OTHERWISE, ALL PARTITIONS ARE TO BE ASSUMED SFP2 AND ALL ACOUSTIC WALLS ARE TO BE ASSUMED SAG.
- F. PROVIDE ADDITIONAL FRAMING, BLOCKING AND FINISHES AS REQUIRED FOR PLUMBING, MECHANICAL, AND ELECTRICAL ACCESS PANELS.
- G. PROVIDE ADDITIONAL BLOCKING AS REQUIRED TO SUPPORT SHELVING, RAILINGS, WALL MOUNTED ACCESSORIES & EQUIPMENT.
- H. PROVIDE U.L. APPROVED THROUGH PENETRATION AND MEMBRANE PENETRATION FIRESTOP SYSTEMS AS REQUIRED BY CODE AT ALL PLUMBING, MECHANICAL, AND ELECTRICAL PENETRATIONS.
- I. AT ALL STUD WALLS PROVIDE HEAD AND BASE INSTALLATIONS PER DETAILS.
- J. METAL STUDS SHALL BE SPACED AT 16" O.C. UNLESS NOTED OTHERWISE.
- K. ALL STRUCTURE AND SHEATHING SHALL EXTEND TO THE FULL HEIGHT OF THE WALL (TOP OF PARAPET OR UNDERSIDE OF DECKING) UNLESS NOTED OTHERWISE.
- L. WHERE PARTITION OCCURS IN WET LOCATIONS, USE MOISTURE RESISTANT GYPSUM BOARD. USE CEMENT BACKER BOARD AT TILED LOCATIONS.
- M. COORDINATE ALL MECHANICAL, PLUMBING, ELECTRICAL, AND TECHNOLOGY PENETRATIONS THROUGH ACOUSTICAL PARTITIONS AND ENSURE ALL PENETRATIONS ARE TO BE ACOUSTICALLY SEALED TO PREVENT SOUND TRANSMITTANCE.

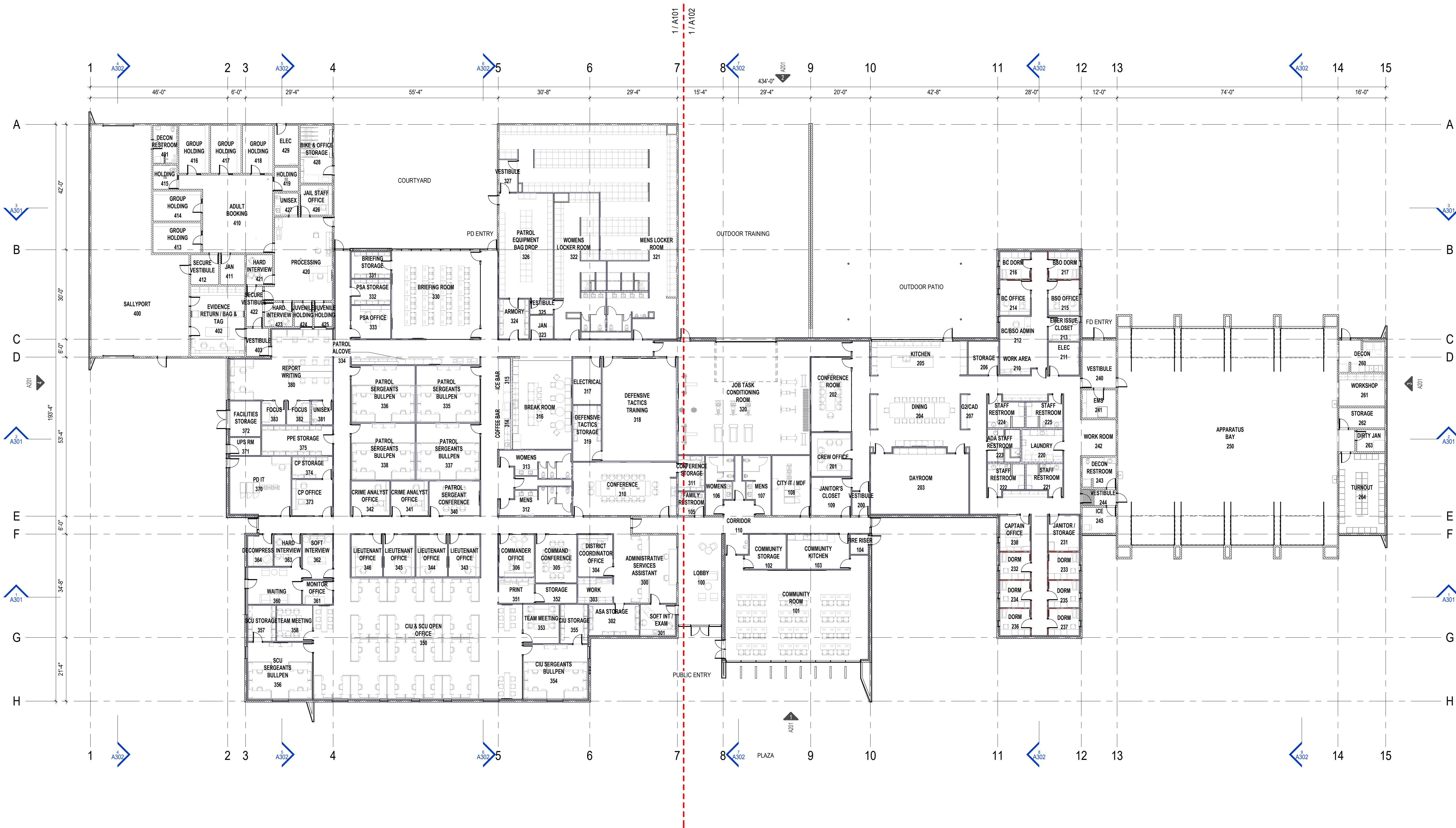

1 FLOOR PLAN - OVERALL
1/16" = 1'-0"

NORTHEAST PUBLIC
SAFETY FACILITY

CITY OF MESA
1333 N POWER ROAD
MESA, ARIZONA 85207

DELTA REVISIONS	DESCRIPTION	DATE
1		

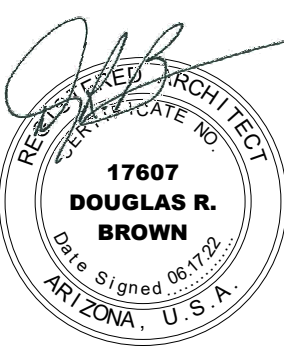

EXPIRES 03/31/2023

PROJECT # 20112
ISSUE DATE: 05/11/22
ISSUE NAME: ORS SUBMITTAL
PLOT DATE: 5/11/2022 3:10:58 PM

A100
FLOOR PLAN - OVERALL