

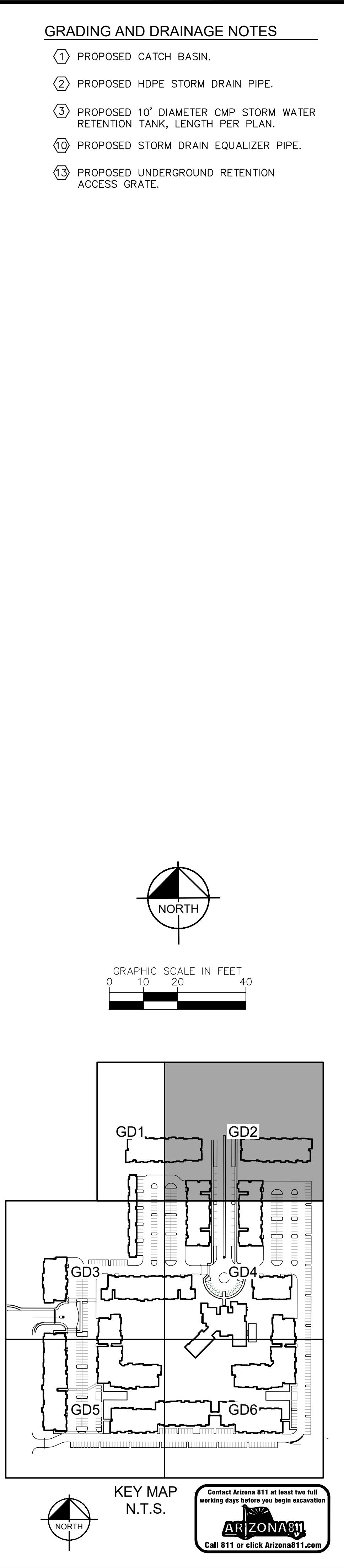



K:\P\K\_VLW\_091245698 - Action Item\Interconnect Files\245698P-09\_Apt\_Locate.GPJ May 02, 2022 -- 8:20am Dave Burke  
XREFS: X245698BM\_Compactort1 245698OT 245698VF 245698TR 245698HS 245698U7  
This document, together with the concepts and designs presented herein, as an instrument of service, is intended only for the specific purpose and client for which it was prepared. REUSE OF THIS DOCUMENT FOR ANY OTHER PURPOSE WITHOUT THE WRITTEN CONSENT OF THE ENGINEER IS PROHIBITED.



<p>SEC CRISMON RD AND WILLIAMS FIELD RD</p> <p><b>PRELIMINARY GRADING AND DRAINAGE PLAN</b></p> <p>MESA, ARIZONA</p>	<p><b>Toll Brothers</b></p> <p>APARTMENT LIVING</p>	<p><b>Kimley»»Horn</b></p> <p>© 2022 KIMLEY-HORN AND ASSOCIATES, INC.  7401 North 15th Street, Suite 100  Phoenix, Arizona 85020-6022 944-5500</p>
<p>PROJECT NO. 064578100</p> <p>SCALE (H): 1"=20'</p> <p>SCALE (V): NONE</p> <p>DRAWN BY: DBB</p> <p>DESIGN BY: BEQ</p> <p>CHECK BY: TMJ</p> <p>DATE: 02/08/2022</p>	<p><b>PRELIMINARY</b></p> <p>FOR REVIEW ONLY NOT FOR CONSTRUCTION</p> <p><b>Kimley»»Horn</b></p> <p>ENGINEER T. JONES PE NO. 52738, DATE 04/26</p>	
<p>245059Pre-CD.dwg</p> <p><b>GD2</b></p> <p>2 OF 8 SHEETS</p>		



K:\P\W\_Civil\201245908 - Action West\GIS\Workpoint\_Bills\245908B-CP App\_Letter\_G03\_May\_02\_2012 - 8.21am DaveBurke  
KREFS: X245908BM\_X\_Comparison\_1246QOATX X245908B X245908D X245908E X245908H X245908I X245908J X245908L X245908M X245908N X245908O X245908P X245908R X245908T X245908U X245908V X245908W X245908Y X245908Z  
THIS DOCUMENT, TOGETHER WITH THE CONCEPTS AND DESIGNS PRESENTED HEREIN, IS AN INSTRUMENT OF SERVICE, IS INTENDED ONLY FOR THE SPECIFIC PURPOSE AND CLIENT FOR WHICH IT WAS PREPARED. REUSE OR MODIFICATION OF THIS DOCUMENT WITHOUT THE WRITTEN PERMISSION OF THE ENGINEER OR ARCHITECT IS PROHIBITED.

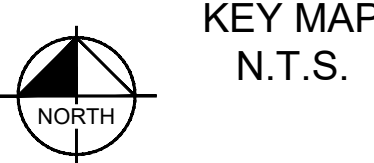
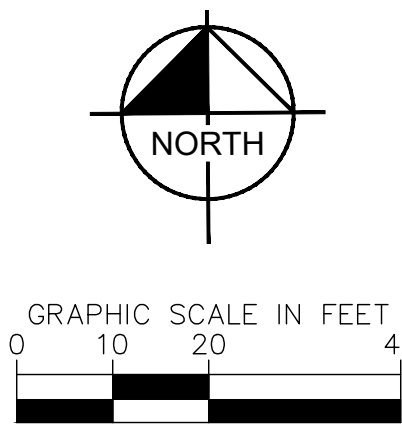
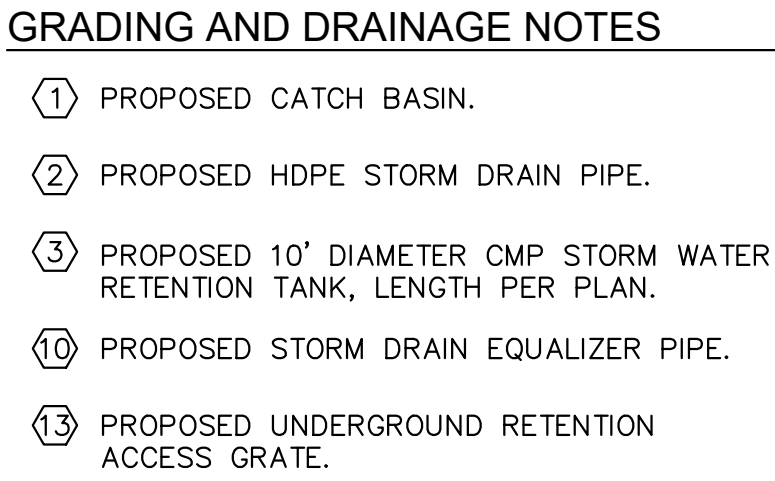

# SEC CRISMON RD AND WILLIAMS FIELD RD PRELIMINARY GRADING AND DRAINAGE PLAN MESA, ARIZONA

PROJECT No.
064578100
SCALE (H): 1"=20'
SCALE (V): NONE
DRAWN BY: DBB
DESIGN BY: BEQ
CHECK BY: TMJ
DATE: 02/08/2022

**PRELIMINARY**  
FOR REVIEW ONLY  
NOT FOR CONSTRUCTION

**Kimley»Horn**

ENGINEER T. JONES  
PE NO. 52738 DATE 04/26

**GD3**  
3 OF 8 SHEETS

**Kimley»»Horn**  
© 2022 KIMLEY-HORN AND ASSOCIATES, INC.  
7740 North 16th Street, Suite 300  
Phoenix, Arizona 85020 (602) 944-5500

**Toll Brothers**  
APARTMENT LIVING



X:\PHX\_Civil\231245009 - Avalon Mesa\CAOD\Improvement\_Plans\245009Pre-G3.dwg, Layout:G04 May 02, 2022 - a21am Dove Burke  
 AREFS: X245009B\_M\_X\_Compactor X245009T X245009F X245009B X245009C X245009H X245009S X245009HS X245009IT  
 THIS DOCUMENT, TOGETHER WITH THE CONCEPTS AND DESIGNS PRESENTED HEREIN, IS AN INSTRUMENT OF SERVICE, IS INTENDED ONLY FOR THE SPECIFIC PURPOSE AND CLIENT FOR WHICH IT WAS PREPARED, AND IS NOT TO BE REUSED FOR ANY OTHER PROJECT OR PURPOSE.

GD3

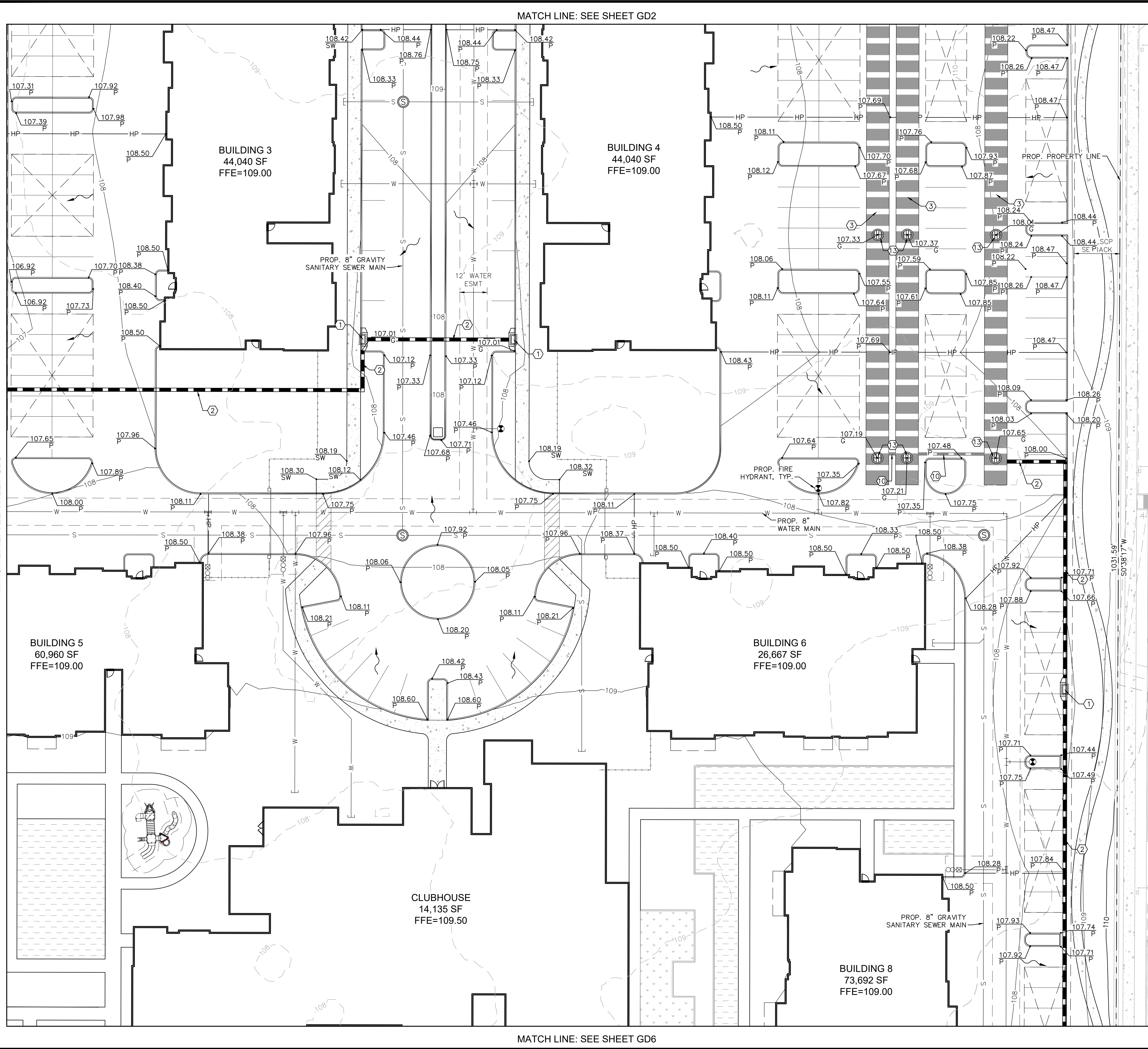

- ① PROPOSED CATCH BASIN.
- ② PROPOSED HDPE STORM DRAIN PIPE.
- ③ PROPOSED 10' DIAMETER CMP STORM WATER RETENTION TANK, LENGTH PER PLAN.
- ④ PROPOSED STORM DRAIN EQUALIZER PIPE.
- ⑤ PROPOSED UNDERGROUND RETENTION ACCESS GRATE.

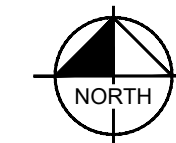

Contact Arizona 811 at least two full working days before you begin excavating.

**ARIZONA 811**

245009Pre-GD.dwg

**GD4**

4 OF 8 SHEETS

**Kimley»»Horn**  
© 2022 KIMLEY-HORN AND ASSOCIATES, INC.  
7740 North 16th Street, Suite 300  
Phoenix, Arizona 85020 (602) 944-5500



K:\PRIVACY\917245609 - Action Item\COMP\Interconnect Files\245609P-09\_Apt\_Locate.DSE May 02, 2022 - 8:21am DaveBurke  
KREFS\_X245609BM\_Compactort1 245609VF 245609TH 245609HS 245609U7  
this document, together with the concepts and designs presented herein, as an instrument of service, is intended only for the specific purpose and client for which it was prepared. REUSE

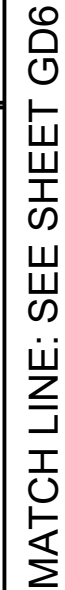

① PROPOSED CATCH BASIN.

② PROPOSED HDPE STORM DRAIN PIPE.

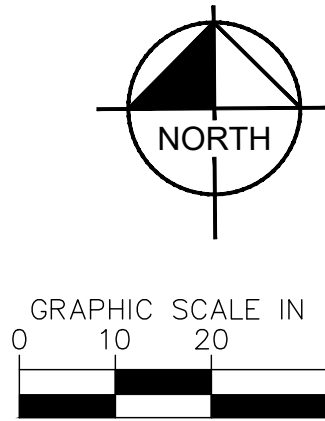

Contact Arizona 811 at least two full working days before you begin excavation.

**ARIZONA811**

Call 811 or click [Arizona811.com](http://Arizona811.com)

**GD5**  
5 OF 8 SHEETS

**Kimley»»Horn**  
© 2022 KIMLEY-HORN AND ASSOCIATES, INC.  
7740 North 16th Street, Suite 300  
Phoenix, Arizona 85020 (602) 944-5500



K:\P\KJL\091245698 - Action Item\Interconnect Plans\245698P-09\_Apt\_Locate\_086\_May\_02\_2022 - 8:21am DaveBurke  
XREFS: X245698BM\_Compartment1 245698DOT 245698VIF 245698OTR 245698QD 245698HS 245698U7  
This document, together with the concepts and designs presented herein, as an instrument of service, is intended only for the specific purpose and client for which it was prepared. REUSE OF THIS DOCUMENT FOR ANY OTHER PURPOSE WITHOUT THE EXPRESS WRITTEN PERMISSION OF THE ENGINEER OR ARCHITECT IS PROHIBITED.

3D5

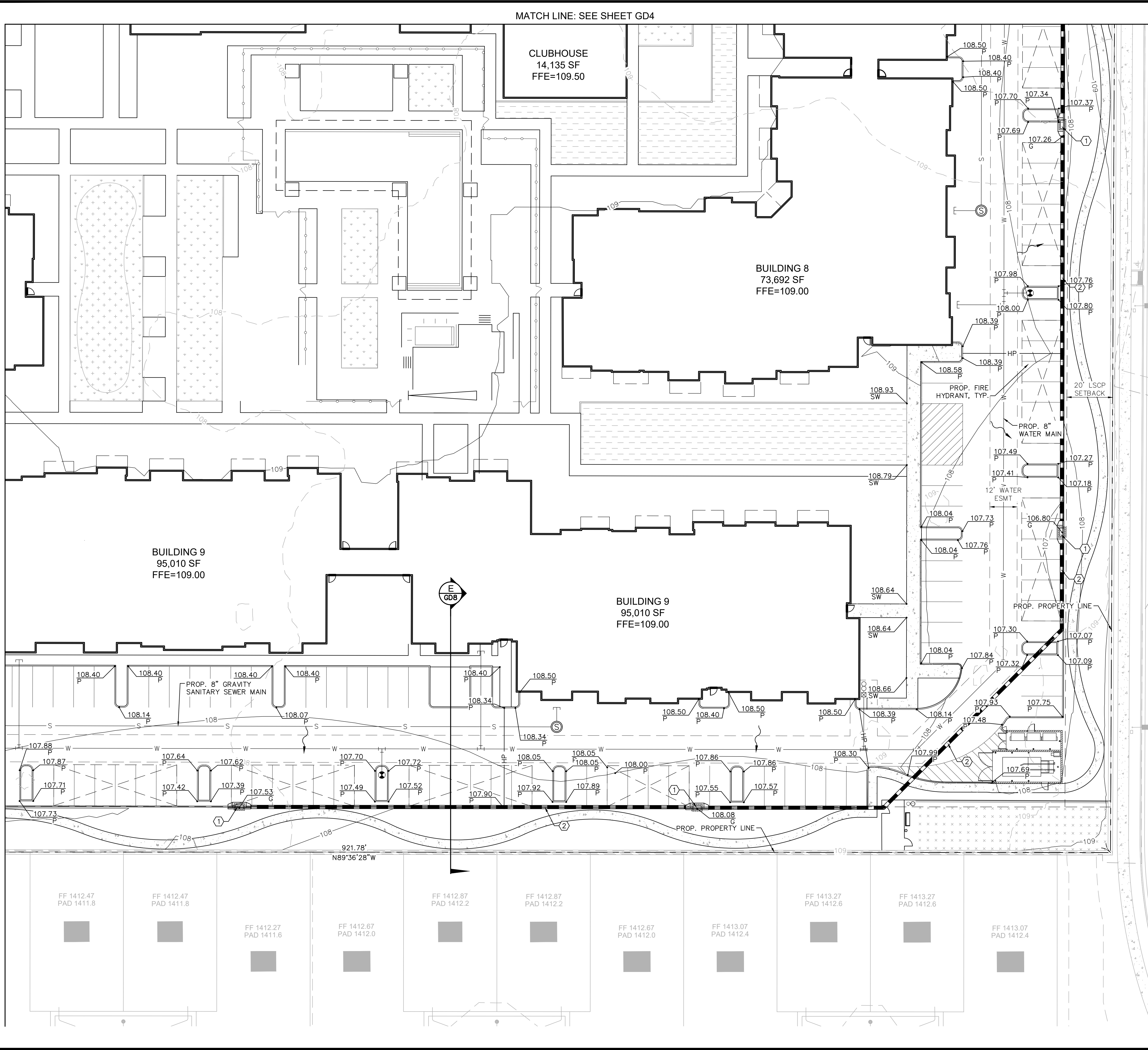

### GRADING AND DRAINAGE NOTES

- ① PROPOSED CATCH BASIN.
- ② PROPOSED HDPE STORM DRAIN PIPE.

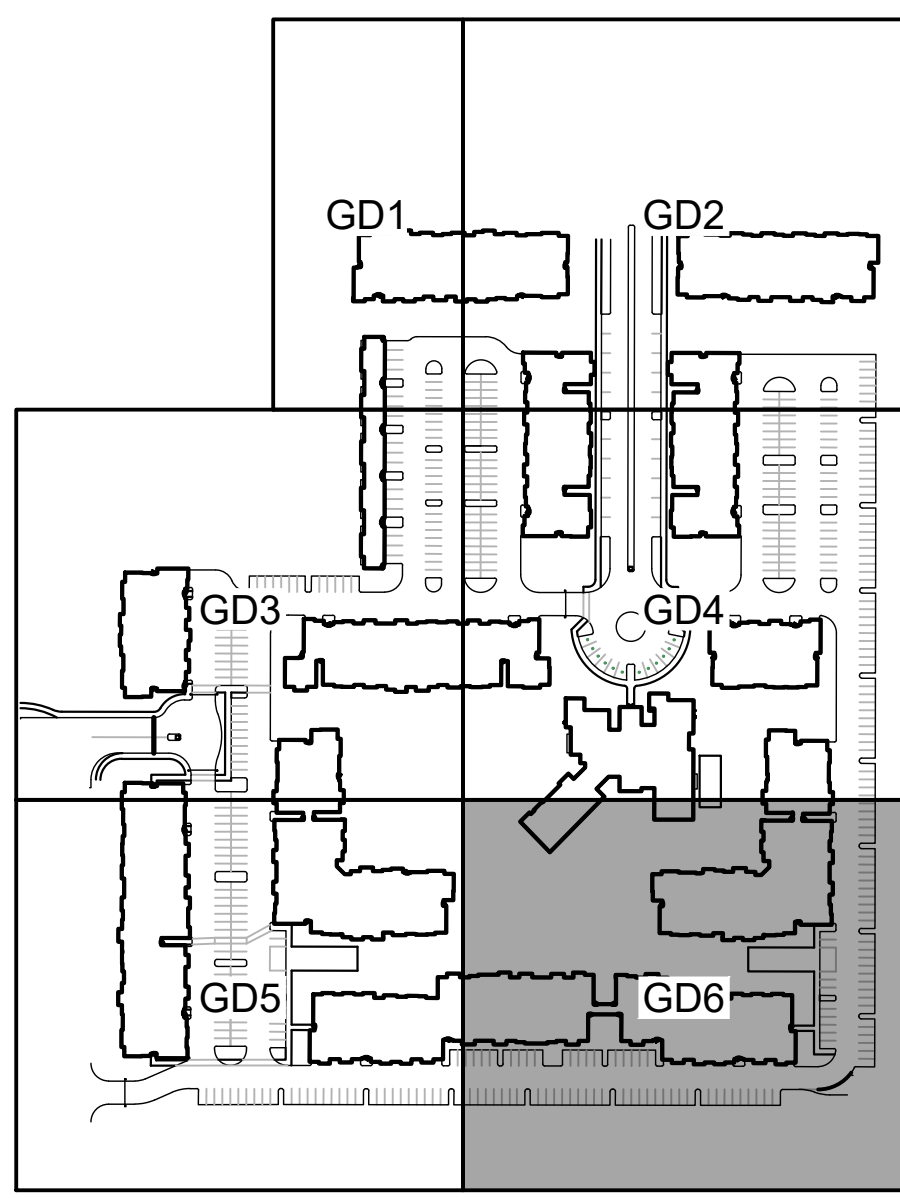
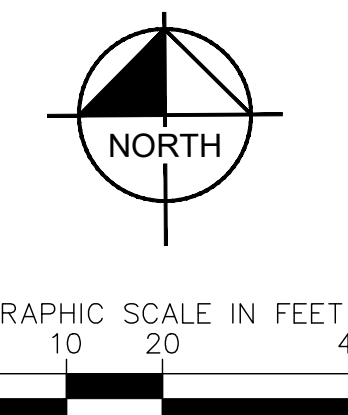

KEY MAP  
N.T.S.

Contact Arizona 811 at least two full working days before you begin excavation

**ARIZONA811**

Call 811 or click [Arizona811.com](http://Arizona811.com)

SEC CRISMON RD AND WILLIAMS FIELD RD  
**PRELIMINARY GRADING AND  
DRAINAGE PLAN**  
MESA, ARIZONA

PROJECT No. 064578100
SCALE (H): 1"=20'
SCALE (V): NONE
DRAWN BY: DBB
DESIGN BY: BEQ
CHECK BY: TMJ
DATE: 02/08/2022

PRELIMINARY  
FOR REVIEW ONLY  
NOT FOR CONSTRUCTION  
**Kimley»Horn**  
ENGINEER T. JONES  
PE NO. 52738 DATE 04/26

**GD6**  
6 OF 8 SHEETS

**Kimley»»Horn**

© 2022 KIMLEY-HORN AND ASSOCIATES, INC.  
7740 North 16th Street, Suite 300  
Phoenix, Arizona 85020 (602) 944-5500



K:\PHK\_Civil\291745009 -- Avalon Mesa\CA04\Improvement Plans\245009XS.dwg, Layout:G07 May 02, 2022 -- 8:21am DoveBurke  
XREFS: 245009BM, 245009BD, 245009HS, 245009GT, 245009GU, 245009JV, 245009KS, 245009PB, X-Compactor  
OF AND MERGER RELIANCE ON THIS DOCUMENT WITHOUT WRITTEN AUTHORIZATION AND ADAPTATION BY KALE-HORN AND ASSOCIATES, INC. SHALL BE WITHOUT LIABILITY TO KALE-HORN AND ASSOCIATES, INC.

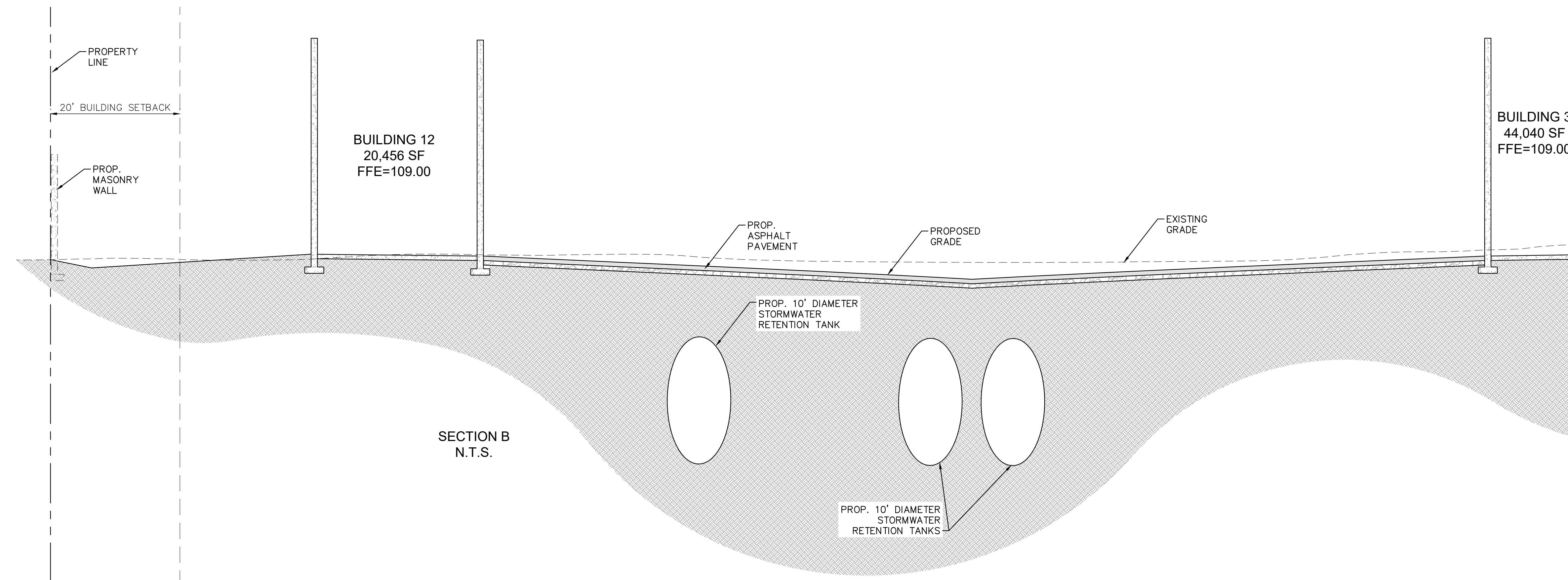



K:\PHK\_Civil\291745009 -- Avden Mesa\CA04\Improvement Plans\245009XS.dwg, Layout:GB8 May 02, 2022 -- 8:21am DoveBurke  
XREFS: 245009BM, 245009BD, 245009HS, 245009GT, 245009GU, 245009JV, 245009KS, 245009PB, 245009PL, 245009PM, 245009PS, 245009PT, 245009Q, 245009R, 245009S, 245009T, 245009U, 245009V, 245009W, 245009X, 245009Y, 245009Z, 245009AA, 245009AB, 245009AC, 245009AD, 245009AE, 245009AF, 245009AG, 245009AH, 245009AI, 245009AJ, 245009AK, 245009AL, 245009AM, 245009AN, 245009AO, 245009AP, 245009AQ, 245009AR, 245009AS, 245009AT, 245009AU, 245009AV, 245009AW, 245009AX, 245009AY, 245009AZ, 245009BA, 245009BB, 245009BC, 245009BD, 245009BE, 245009BF, 245009BG, 245009BH, 245009BI, 245009BJ, 245009BK, 245009BL, 245009BM, 245009BN, 245009BO, 245009BP, 245009BQ, 245009BR, 245009BS, 245009BT, 245009BU, 245009BV, 245009BW, 245009BX, 245009BY, 245009BZ, 245009CA, 245009CB, 245009CC, 245009CD, 245009CE, 245009CF, 245009CG, 245009CH, 245009CI, 245009CJ, 245009CK, 245009CL, 245009CM, 245009CN, 245009CO, 245009CP, 245009CQ, 245009CR, 245009CS, 245009CT, 245009CU, 245009CV, 245009CW, 245009CX, 245009CY, 245009CZ, 245009DA, 245009DB, 245009DC, 245009DD, 245009DE, 245009DF, 245009DG, 245009DH, 245009DI, 245009DJ, 245009DK, 245009DL, 245009DM, 245009DN, 245009DO, 245009DP, 245009DQ, 245009DR, 245009DS, 245009DT, 245009DU, 245009DV, 245009DW, 245009DX, 245009DY, 245009DZ, 245009EA, 245009EB, 245009EC, 245009ED, 245009EE, 245009EF, 245009EG, 245009EH, 245009EI, 245009EJ, 245009EK, 245009EL, 245009EM, 245009EN, 245009EO, 245009EP, 245009EQ, 245009ER, 245009ES, 245009ET, 245009EU, 245009EV, 245009EW, 245009EX, 245009EY, 245009EZ, 245009FA, 245009FB, 245009FC, 245009FD, 245009FE, 245009FF, 245009FG, 245009FH, 245009FI, 245009FJ, 245009FK, 245009FL, 245009FM, 245009FN, 245009FO, 245009FP, 245009FQ, 245009FR, 245009FS, 245009FT, 245009FU, 245009FV, 245009FW, 245009FX, 245009FY, 245009FZ, 245009GA, 245009GB, 245009GC, 245009GD, 245009GE, 245009GF, 245009GG, 245009GH, 245009GI, 245009GJ, 245009GK, 245009GL, 245009GM, 245009GN, 245009GO, 245009GP, 245009GQ, 245009GR, 245009GS, 245009GT, 245009GU, 245009GV, 245009GW, 245009GX, 245009GY, 245009GZ, 245009HA, 245009HB, 245009HC, 245009HD, 245009HE, 245009HF, 245009HG, 245009HH, 245009HI, 245009HJ, 245009HK, 245009HL, 245009HM, 245009HN, 245009HO, 245009HP, 245009HQ, 245009HR, 245009HS, 245009HT, 245009HU, 245009HV, 245009HW, 245009HX, 245009HY, 245009HZ, 245009IA, 245009IB, 245009IC, 245009ID, 245009IE, 245009IF, 245009IG, 245009IH, 245009II, 245009IJ, 245009IK, 245009IL, 245009IM, 245009IN, 245009IO, 245009IP, 245009IQ, 245009IR, 245009IS, 245009IT, 245009IU, 245009IV, 245009IW, 245009IX, 245009IY, 245009IZ, 245009JA, 245009JB, 245009JC, 245009JD, 245009JE, 245009JF, 245009JG, 245009JH, 245009JI, 245009JJ, 245009JK, 245009JL, 245009JM, 245009JN, 245009JO, 245009JP, 245009JQ, 245009JR, 245009JS, 245009JT, 245009JU, 245009JV, 245009JW, 245009JX, 245009JY, 245009JZ, 245009KA, 245009KB, 245009KC, 245009KD, 245009KE, 245009KF, 245009KG, 245009KH, 245009KI, 245009KJ, 245009KK, 245009KL, 245009KM, 245009KN, 245009KO, 245009KP, 245009KQ, 245009KR, 245009KS, 245009KT, 245009KU, 245009KV, 245009KW, 245009KX, 245009KY, 245009KZ, 245009LA, 245009LB, 245009LC, 245009LD, 245009LE, 245009LF, 245009LG, 245009LH, 245009LI, 245009LJ, 245009LK, 245009LL, 245009LM, 245009LN, 245009LO, 245009LP, 245009LQ, 245009LR, 245009LS, 245009LT, 245009LU, 245009LV, 245009LW, 245009LX, 245009LY, 245009LZ, 245009MA, 245009MB, 245009MC, 245009MD, 245009ME, 245009MF, 245009MG, 245009MH, 245009MI, 245009MJ, 245009MK, 245009ML, 245009MM, 245009MN, 245009MO, 245009MP, 245009MQ, 245009MR, 245009MS, 245009MT, 245009MU, 245009MV, 245009MW, 245009MX, 245009MY, 245009MZ, 245009NA, 245009NB, 245009NC, 245009ND, 245009NE, 245009NF, 245009NG, 245009NH, 245009NI, 245009NJ, 245009NK, 245009NL, 245009NM, 245009NO, 245009NP, 245009NQ, 245009NR, 245009NS, 245009NT, 245009NU, 245009NV, 245009NW, 245009NX, 245009NY, 245009NZ, 245009OA, 245009OB, 245009OC, 245009OD, 245009OE, 245009OF, 245009OG, 245009OH, 245009OI, 245009OJ, 245009OK, 245009OL, 245009OM, 245009ON, 245009OO, 245009OP, 245009OQ, 245009OR, 245009OS, 245009OT, 245009OU, 245009OV, 245009OW, 245009OX, 245009OY, 245009OZ, 245009PA, 245009PB, 245009PC, 245009PD, 245009PE, 245009PF, 245009PG, 245009PH, 245009PI, 245009PJ, 245009PK, 245009PL, 245009PM, 245009PN, 245009PO, 245009PP, 245009PQ, 245009PR, 245009PS, 245009PT, 245009PU, 245009PV, 245009PW, 245009PX, 245009PY, 245009PZ, 245009QA, 245009QB, 245009QC, 245009QD, 245009QE, 2

