

**When recorded mail to:
City of Mesa
Real Estate Services
P.O. Box 1466
Mesa, AZ 85211-1466**

ANNEXATION

City of Mesa

DO NOT REMOVE

This is part of the official document

When recorded, return to:
City of Mesa
Planning Division
P.O. Box 1466
Mesa AZ 85211-1466

ANNEXATION PETITION
ANX22-00020

TO: THE HONORABLE MAYOR AND CITY COUNCIL OF THE CITY OF
MESA, ARIZONA:

We the undersigned, owners of not less than one-half in value of the real property and personal property and more than one-half of the persons owning real and personal property that would be subject to taxation by the City of Mesa in the event of annexation within the territory proposed to be annexed, which is hereafter described, said territory being completely surrounded by the corporate limits of the City of Mesa, with the exterior boundaries of the territory proposed to be annexed shown on the map attached hereto, marked Exhibit "A" and made a part hereof, request the City of Mesa to annex the following described territory, provided Section 9-471, Arizona Revised Statutes, and amendments thereto, are fully observed.

The description of the territory proposed to be annexed, not already within the present limits of the City of Mesa and located in Maricopa County, Arizona, is as follows:

A portion of the Southwest Quarter of Section 35, Township 1 South, Range 7 East of the Gila and Salt River Meridian, Maricopa County, Arizona, more particularly described as follows:

COMMENCING at the South Quarter Corner of said Section 35, being marked by a 3" brass cap in handhole, from which the Southwest Corner of said Section 35, being marked by a cotton picker spindle, bears North 89 degrees 25 minutes 50 seconds West, 2643.70 feet;

thence along the East line of said Southwest Quarter, North 0 degrees 33 minutes 55 seconds West, 50.01 feet to the **POINT OF BEGINNING**;

thence along a line 50.00 feet North of and parallel with the South line of said Southwest Quarter, North 89 degrees 25 minutes 50 seconds West, 1234.87 feet;

thence North 0 degrees 33 minutes 55 seconds West, 1328.89 feet;

thence South 89 degrees 25 minutes 50 seconds East, 1234.87 feet;

thence along the East line of said Southwest Quarter, South 0 degrees 33 minutes 55 seconds East, 1328.89 feet to the **POINT OF BEGINNING**.

Contains 1,640,685 square feet or 37.6649 acres, more or less.

ANX22-00020

37.7± Acres

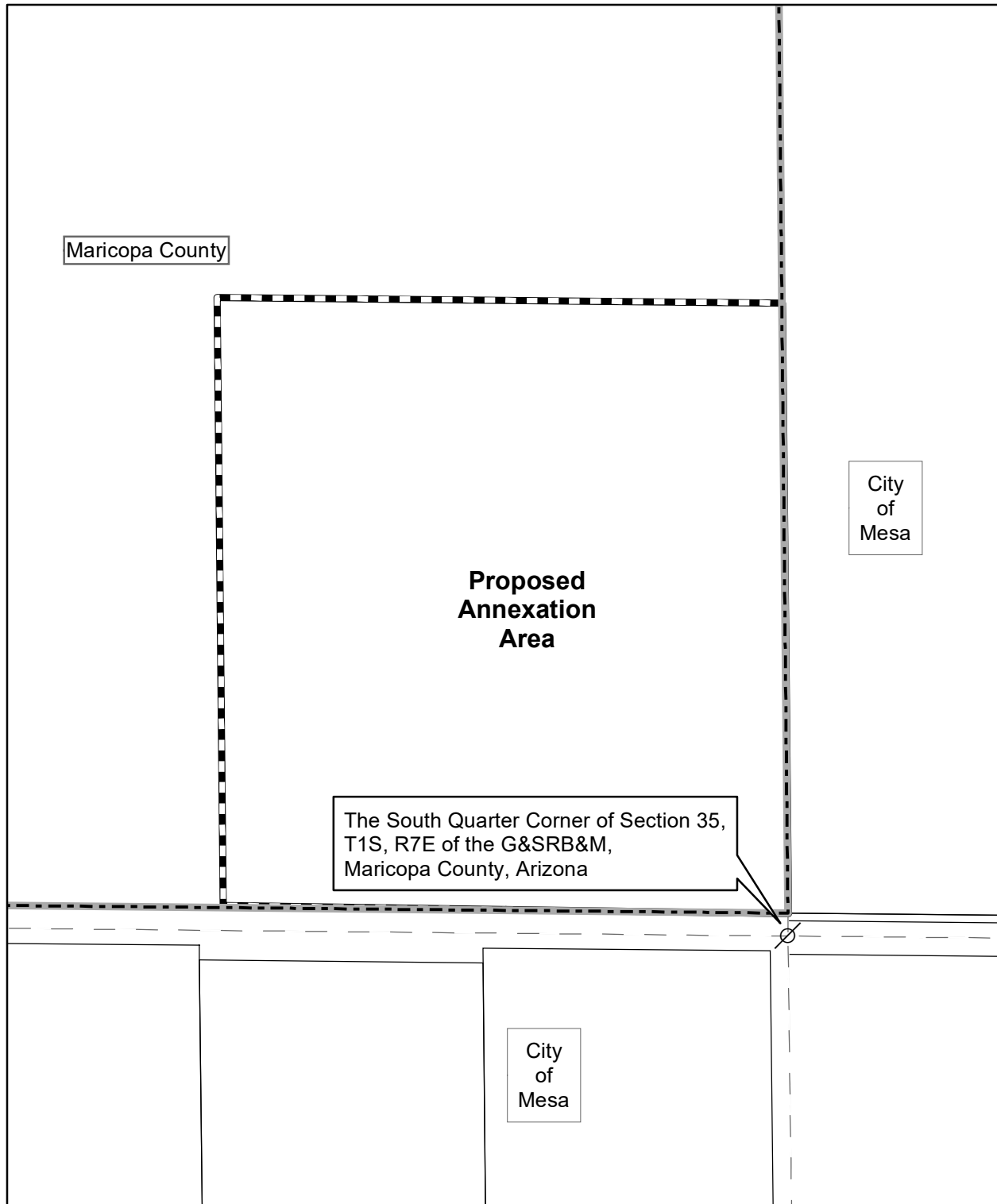

-  Legal Control Point
-  City of Mesa Boundary
-  Quarter Section
-  Proposed Annexation Boundary

EXHIBIT 'A'

We the undersigned owners, hereby sign in favor for annexation of our property to the City of Mesa Corporate Limits, as described by the attached annexation petition.

PLEASE PRINT OR TYPE, EXCEPT FOR SIGNATURES.

Owner (s) _____ Phone No. _____

Mailing Address _____

County Assessor Parcel No. _____

Signature (s) _____ Date _____

Owner (s) _____ Phone No. _____

Mailing Address _____

County Assessor Parcel No. _____

Signature (s) _____ Date _____

Owner (s) _____ Phone No. _____

Mailing Address _____

County Assessor Parcel No. _____

Signature (s) _____ Date _____

Owner (s) _____ Phone No. _____

Mailing Address _____

County Assessor Parcel No. _____

Signature (s) _____ Date _____
