

Hilton Garden Inn

Design Review

March 2, 2022

PLANT LEGEND

	BOTANICAL NAME	COMMON NAME	PLANTING SIZE	COMMENTS
	TREES			
	Bauhinia purpurea	Purple Orchid Tree	24" Box	Standard Trunk Dense Canopy
	Eucalyptus papuana	Ghost Gym Eucalyptus	36" Box	Standard Trunk Dense Canopy
	Parkinsonia x 'Desert Museum'	Desert Museum	36" Box	Multi - Trunk Dense Canopy
	Ulmus parvifolia	Chinese Elm	36" Box	Standard Trunk Dense Canopy
	Fraxinus velutina 'Fan Tex'	Fan Tex Ash	24" Box	Standard Trunk Dense Canopy
	Phoenix dactylifera	Date Palm	18' C.T.H.	Size Per Plan Diamond Cut
	Nerium oleander	Oleander Tree	24" Box	Standard Trunk Dense Canopy
	Olea europaea	Fruitless Olive	36" Box	Standard Trunk Dense Canopy
	Sophora secundiflora	Texas Mountain Laurel	24" Box	Standard Trunk Dense Canopy
	Olneya tesota	Ironwood	24" Box	Standard Trunk Dense Canopy
	Ficus nitida	Indian Laurel Columns	15 Gal.	Standard Trunk Dense Canopy
	Thevetia peruviana	Thevetia	24" Box	Standard Trunk Dense Canopy
	Quercus virginiana 'Empire'	Southern Live Oak	36" Box	Standard Trunk Dense Canopy

ACCENTS/VINES

Bougainvillea 'Barbara Karst'	Vine Bougainvillea	5 Gal.	As Per Plan
Bougainvillea brasiliensis	Purple Bougainvillea	5 Gal.	As Per Plan
Muhlenbergia dubia	Deer Grass	5 Gal.	As Per Plan
Ficus pumila	Creeping Fig Vine	5 Gal.	As Per Plan
Fedilanthus macrocarpus	Lady Slipper Plant	5 Gal.	As Per Plan
Trachelospermum jasminoides	Star Jasmine	5 Gal.	As Per Plan

SHRUBS

Caesalpinia pulcherrima	Red Bird of Paradise	24" Box	As Per Plan
Buxus semperviens	Boxwood	5 Gal.	As Per Plan
Olea europaea 'Little Ollie'	Little Ollie	5 Gal.	As Per Plan
Eremophila maculata 'valentine'	Red Emu Bush	5 Gal.	As Per Plan
Myrtus communis	Dwarf Myrtle	5 Gal.	As Per Plan
Ruellia peninsularis	Baja Ruellia	5 Gal.	As Per Plan
Carissa macrocarpa	Natal Plum	5 Gal.	As Per Plan
Tecoma stans	Yellow Bells	5 Gal.	As Per Plan
Tecoma stans 'Orange Jubilee'	Orange Jubilee	5 Gal.	As Per Plan

GROUND COVERS

Rosmarinus officinalis 'Tuscan Blue'	Rosemary	1 Gal.	As Per Plan
Lantana hybrid 'Bandara'	Red Lantana	1 Gal.	As Per Plan
Lantana hybrid 'New Gold'	New Gold Lantana	1 Gal.	As Per Plan
Lantana montevidensis	Purple Trailing Lantana	1 Gal.	As Per Plan
Wedelia trilobata	Yellow Dot	1 Gal.	As Per Plan
Dietes bicolor	Evergreen Iris	1 Gal.	As Per Plan
Carissa macrocarpa	Green Carpet Natal Plum	1 Gal.	As Per Plan

MISCELLANEOUS

Decomposed Granite - 1/2" Screened Sunset Gold or equal from Treasure Chest Granite (480) 354-6905
2" Depth in All Planting Areas (Typ) - **22,222 SQ. FT.**

CITY OF MESA LS REQUIREMENTS

	REQUIRED	PROVIDED
PRIVATE STREET ROW.	1 Tree/4 Shrub per 25 L.F.	
TREES	19	19
SHRUBS	76	80
PARKING LOT ISLAND	1 Tree/3 Shrub per Island	
TREES	51	61
SHRUBS	153	201

NOTES

- 25% OF TREES REQUIRED IN ROW SHOULD BE 36" BOX OR LARGER WITH A MINIMUM OF 50% OF REQUIRED TREES BEING 24" BOX. NO TREES SMALLER THAN 15 GALLON.
- 10% OF TREES REQUIRED IN PARKING ISLANDS & FOUNDATION PLANTING AREAS NEED TO BE 36" BOX WITH THE BALANCE BEING AT LEAST 24" BOX
- 50% OF TREES REQUIRED IN PERIMETER LANDSCAPE AREAS TO BE 24" BOX WITH THE BALANCE BEING 15 GALLON.
- 50% OF ALL REQUIRED SHRUBS TO BE 5 GALLON WITH NO SHRUBS LESS THAN 1 GALLON.

Additional Note:
*(2) ADDITIONAL 24" BOX TREES SUBSTITUTED FOR (4) 15 GALLON TREES
*(3) 24" BOX SUBSTITUTED FOR (6) 15 GALLON TREES

CONCEPTUAL GENERAL NOTES

- CONCEPTUAL LANDSCAPE PLAN IS SCHEMATIC IN NATURE. AT THE TIME OF LANDSCAPE CONSTRUCTION DRAWINGS ACTUAL LOCATIONS, QUANTITIES, SIZES, AND SPECIES SHALL BE DETERMINED AND WILL BE PER CITY CODES.
- ALL TREES USED WITHIN THIS PROJECT SHALL BE NURSERY GROWN. EXACT LOCATIONS AND QUANTITIES SHALL BE DETERMINED ON LANDSCAPE CONSTRUCTION DRAWINGS. ALL EXISTING TREES SHALL BE PROTECTED DURING CONSTRUCTION.
- ALL LANDSCAPE AREAS SHALL RECEIVE AN AUTOMATIC IRRIGATION SYSTEM.
- ALL PLANT MATERIAL SHALL BE INSTALLED PER CITY REQUIREMENTS. PLANT MATERIAL INSTALLED WITHIN SIGHT DISTANCE TRIANGLES SHALL BE OF A SPECIES THAT DOES NOT GROW TO A HEIGHT OF MORE THAN 30" AND SHALL BE MAINTAINED PER CITY REQUIREMENTS.
- ALL NON-TURF AREAS SHALL RECEIVE A 2" DEPTH OF DECOMPOSED GRANITE.
- THE RETENTION SHOWN ON THE PLANS IS CONCEPTUAL IN NATURE. REFER TO THE ENGINEERING PLANS FOR ACTUAL GRADING AND DRAINAGE CONFIGURATIONS.
- ALL EARTHWORK WILL BE DONE TO DRAIN AWAY FROM SIDEWALKS AND STRUCTURES.
- FINAL SITE PLAN CONFIGURATION MAY VARY AT THE TIME OF FINAL PLAT APPROVAL.
- ADDITIONAL PLANT MATERIAL MAY BE INTRODUCED AS DIFFERENT VARIETIES BECOME AVAILABLE THROUGH LOCAL NURSERIES AND IF THEY ARE CONSISTENT WITH THE OVERALL THEME OF THIS PROJECT.
- SVT LOCATIONS WILL BE ADDRESSED ON THE FINAL PLAT. ALL LANDSCAPE ELEMENTS WILL COMPLY WITH MESA CITY CODE FOR SVTs.

PLANTING NOTES

- CLARIFICATION OF DISCREPANCIES BETWEEN THE CONSTRUCTION DOCUMENTS AND THE SITE SHOULD BE BROUGHT TO THE ATTENTION OF THE LANDSCAPE ARCHITECT.
- ALL PLANT MATERIAL MUST MEET ANA SPECIFICATIONS.
- THE LANDSCAPE ARCHITECT AND/OR OWNER'S REPRESENTATIVE RESERVES THE RIGHT TO REFUSE ANY PLANT MATERIAL HE DEEMS UNACCEPTABLE. ALL PLANT MATERIAL SHALL BE INSPECTED PRIOR TO INSTALLATION.
- PLANTS TO BE LOCATED AWAY FROM OBSTACLES SUCH AS FIRE HYDRANTS, TRANSFORMERS, POWER POLES, AND LIGHT FIXTURES AS NECESSARY. DO NOT INSTALL PLANT MATERIAL IN ANY AREA WHICH WILL CAUSE HARM TO ADJACENT IMPROVEMENTS.
- VERIFY PLANT QUANTITIES PRIOR TO INSTALLATION. QUANTITIES ARE LISTED FOR CONVENIENCE ONLY, THE ACTUAL NUMBER OF SYMBOLS INDICATED ON THE PLANTING PLANS SHALL HAVE PRIORITY OVER QUANTITIES DESIGNATED. NOTIFY THE LANDSCAPE ARCHITECT OF QUANTITY DISCREPANCIES IMMEDIATELY.
- PLANT TREES, SHRUBS, AND CACTI PLUMB, AND FACED TO GIVE THE BEST APPEARANCE OR RELATIONSHIP TO ADJACENT PLANTS OR VIEWS.
- NOTIFY OWNER AND LANDSCAPE ARCHITECT IMMEDIATELY SHOULD SOIL CONDITIONS BE PRESENT WHICH WOULD PREVENT PROPER SOIL DRAINAGE AND ALLOW WATER TO STAND IN PLANTING PITS.
- DOUBLE STAKE ALL TREES OUTSIDE ROOTBALL., EXCEPT FOR SALVAGED TREES.
- LANDSCAPE CONTRACTOR TO PERFORM A SOILS TEST PRIOR TO LANDSCAPE CONSTRUCTION TO DETERMINE ANY NUTRIENT DEFICIENCIES. IF ANY DEFICIENCIES EXIST, IT SHALL BE THE RESPONSIBILITY OF THE CONTRACTOR TO AMEND THE SOIL ACCORDINGLY.
- SIGNS REQUIRE SEPARATE APPROVALS AND PERMITS.

OWNER/DEVELOPER

POWER 202 MIXED-USE, LLC
C/O VIVO DEVELOPMENT PARTNERS, LLC
4650 EAST COTTON CENTER BLVD.
SUITE 200
PHOENIX, ARIZONA 85040
CONTACT: JOSE POMBO
602-393-5899

SHEET INDEX

SHEET NO.	SHEET DESCRIPTION
CLS-1	Cover Sheet and Notes
CLS-2	Conceptual Tree Plan
CLS-3 - CLS-6	Conceptual Landscape Plans

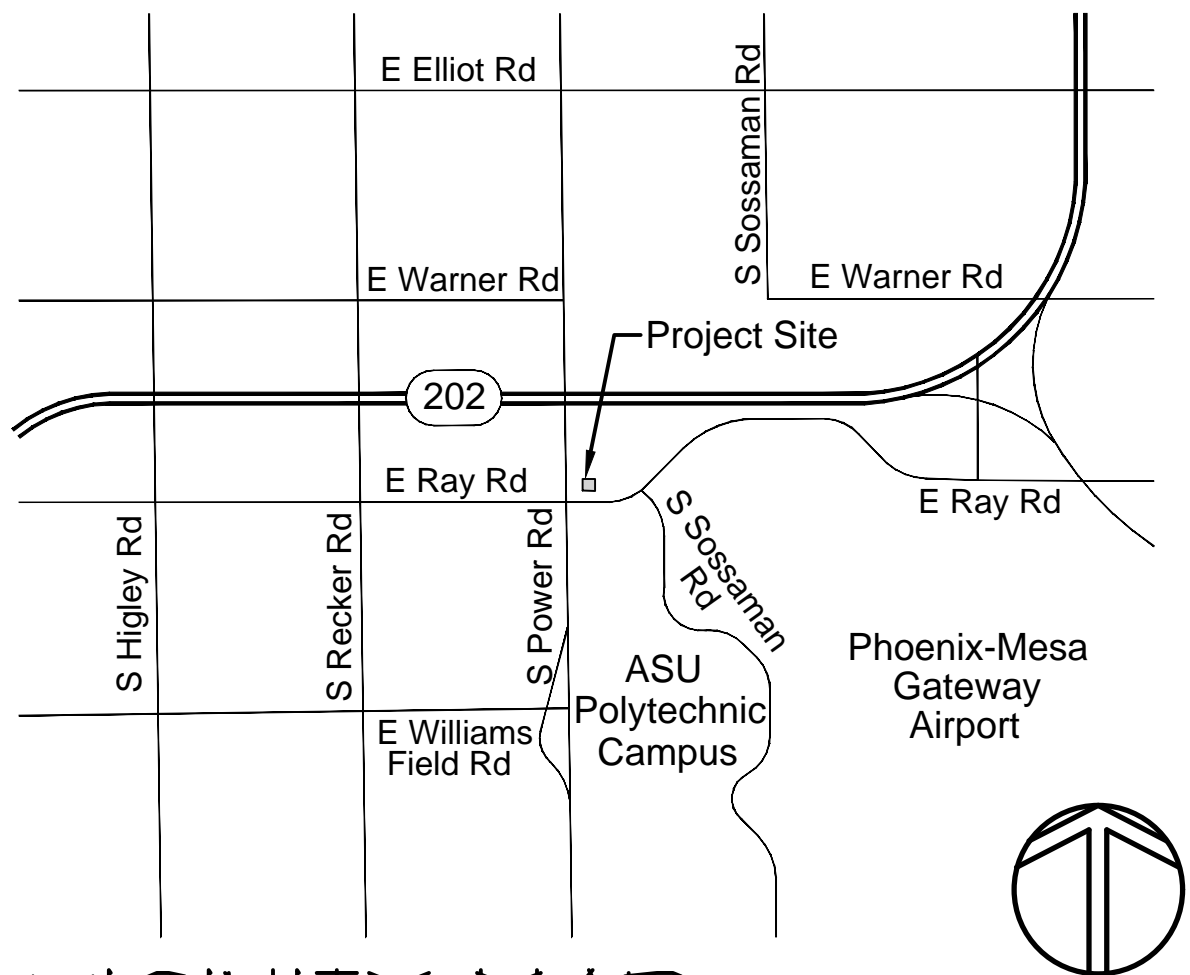

VICINITY MAP

CITY OF MESA NOTES

- LANDSCAPE CONTRACTOR SHALL CONFIRM LOCATION OF ALL UNDERGROUND UTILITIES PRIOR TO ANY EXCAVATION AND SHALL BE RESPONSIBLE FOR THE FOLLOWING:
A. DAMAGES TO SUCH UTILITIES CAUSED AS A RESULT OF THE CONTRACTOR'S ACTIVITIES
B. DAMAGES TO EXISTING WALKS, WALLS, DRIVES, CURBS, ETC.
C. INSPECTING THE SITE IN ORDER TO BE FULLY AWARE OF EXISTING CONDITIONS PRIOR TO SUBMITTING A BID.
- INSTALLATION OF ALL LANDSCAPE AND IRRIGATION MATERIALS SHALL COMPLY WITH SECTIONS 424, 425, 787, AND 795 OF THE MAG STANDARD SPECIFICATIONS AS AMENDED BY THE CITY OF MESA.
- CONTRACTOR SHALL REPAIR ANY DAMAGE MADE TO THE EXISTING SPRINKLER SYSTEM TO THE SATISFACTION OF THE CITY AT NO ADDITIONAL COST TO THE CITY.
- LANDSCAPE REMOVAL IS A NON-PAY ITEM UNLESS OTHERWISE NOTED.
- ALL EXISTING VEGETATION, WEEDS, DEBRIS, ETC. SHALL BE REMOVED FROM PROJECT AREA AND DISPOSED OF PROPERLY OFF THE SITE AT THE CONTRACTOR'S EXPENSE (SCARIFY EXISTING SUBGRADE, MINIMUM 6" DEPTH).
- DAMAGE TO TURF SHALL BE REPAIRED BY CONTRACTOR, I.E. RUTS FILLED WITH CLEAN SOIL, COMPACTED TO MATCH SURROUNDING GRADES. EXCESS SOIL, ROCK, ETC. SHALL BE REMOVED TO LEAVE THE SITE CLEAN.
- ALL PLANT MATERIAL, OTHER THAN TREES, SHALL CONFORM TO GRADING, TYPE, ETC. AS SET FORTH IN THE AMERICAN STANDARD FOR NURSERY STOCK BY THE AMERICAN ASSOCIATION OF NURSERYMEN. ALL TREES SHALL CONFORM TO THE CURRENT ARIZONA NURSERY ASSOCIATION TREE SPECIFICATIONS AND MAG SPEC 795.1. SHOULD ANY CONFLICTS IN THE SPECIFICATIONS OCCUR, THE ARIZONA NURSERY ASSOCIATION'S SPECIFICATIONS SHALL PREVAIL.
- CITY RESERVES THE RIGHT TO INSPECT SHRUBS AND CONTAINERED TREES FOR CONDITION OF ROOT BALLS, FOR ANY SUCH INSPECTIONS WHICH MAY DESTROY ROOT BALL, CONTRACTOR SHALL SUPPLY ADDITIONAL PLANT AT NO COST TO CITY.
- PLANT PITS SHALL BE INSPECTED BY CITY PRIOR TO PLANTING BY THE CONTRACTOR BY REQUESTING AN INSPECTION 48 HOURS IN ADVANCE.
- ROUGH AND FINE GRADING TO ESTABLISH UNIFORM SMOOTH GRADE IS INCLUDED IN THIS PROJECT.
- SOIL TEST FOR FERTILITY AND ADDITIVE RECOMMENDATIONS (FOR TURF AND ORNAMENTALS) SHALL BE COMPLETED BY CONTRACTOR TO DETERMINE IF ADDITIVES ARE REQUIRED. CONTRACTOR SHALL PROVIDE COPY OF SOIL TEST RESULTS FOR REVIEW AND APPROVAL TO ENGINEERING INSPECTOR AT LEAST SEVEN DAYS PRIOR TO ANTICIPATED PLANTING. AFTER APPROVAL BY THE CITY, THE CONTRACTOR SHALL PROVIDE AND INCORPORATE ANY ADDITIVES REQUIRED PRIOR TO OR AT TIME OF PLANTING.
- PLANT PIT SOIL MIXTURE SHALL CONSIST OF FOUR AND ONE HALF PARTS NATURAL FERTILE, FRIABLE SOIL AND ONE PART HUMUS BY VOLUME, THOROUGHLY MIXED PRIOR TO BACKFILLING IN PITS. BACKFILLING SHALL BE IN 6" LIFTS WITH EACH LIFT WATER SETTLED WITHOUT FUDDLING.
- CONTRACTOR SHALL STAKE TREE AND SHRUB LOCATIONS FOR 5-GALLON PLANTS AND LARGER. STAKES SHALL BE MARKED WITH PLANT NAME OR PLANT LEGEND ITEM NUMBER FROM PLANS.
- ALL EXISTING (GAS, ELECTRIC, WATER, ETC.) COVERS AND BOXES SHALL REMAIN UNCOVERED. CONTRACTOR TO ADJUST TO FINAL GRADE AS NECESSARY. NFI UNLESS OTHERWISE NOTED.
- THE CONTRACTOR SHALL INSTALL WATER METER PROVIDED BY THE CITY OF MESA. THE CONTRACTOR SHALL PROVIDE ALL MATERIALS AND LABOR NECESSARY TO INSTALL THE COMPLETE AUTOMATIC SPRINKLER SYSTEM FROM THE METER (WATER USAGE CHARGES SHALL BE PAID BY CONTRACTOR UNTIL PROJECT FINAL ACCEPTANCE BY CITY OF MESA). CONTRACTOR SHALL ORDER METER FROM DEVELOPMENT SERVICES.
- THE CONTRACTOR SHALL BE RESPONSIBLE FOR LOCATING THE UNDERGROUND SPRINKLER SYSTEMS IN ADVANCE OF CONSTRUCTION. THE SPRINKLER SYSTEM LOCATIONS NOTED ON PLANS ARE FOR REFERENCE ONLY.
- CONTRACTOR TO VERIFY DEPTH OF ALL INLET STRUCTURES AND SPRINKLER SYSTEMS PRIOR TO TRENCHING FOR LOW-FLOW CHANNEL.
- CONTRACTOR TO PROVIDE PUMPING WITHIN FIVE (5) DAYS AFTER THE NOTICE TO PROCEED IS GIVEN AS REQUIRED TO DRY THE AREA SUFFICIENTLY TO BEGIN CONSTRUCTION.
- CONTRACTOR SHALL ARRANGE FOR SPRINKLER SYSTEM SHUTDOWN DURING CONSTRUCTION BY CONTACTING THE ENGINEERING INSPECTOR.
- NO ROCKS LARGER THAN 1" IN DIAMETER SHALL BE ALLOWED IN THE TOP 6" OF TOPSOIL WHERE TURF ESTABLISHMENT IS SPECIFIED. ROCK REMOVAL AS NECESSARY IS INCLUDED IN THIS PROJECT (NFI).
- WHERE CALICHE IS ENCOUNTERED IN PLANT PITS, DEPTH AND WIDTH OF PIT SHALL BE INCREASED BY ONE-THIRD (1/3) OVER SPECIFICATION, AND A LIQUID PENETRATOR, "AL-KALICHE" OR EQUAL, SHALL BE INCORPORATED FOR EACH PIT PER MANUFACTURER'S RECOMMENDATIONS.
- PROJECT RECORD (AS-BUILT) DRAWINGS FOR IRRIGATION SYSTEM:
A. MAINTAIN ON SITE AND SEPARATE FROM DOCUMENTS USED FOR CONSTRUCTION. ONE COMPLETE SET OF CONTRACT DOCUMENTS AS PROJECT RECORD DOCUMENTS. KEEP DOCUMENTS CURRENT. DO NOT PERMANENTLY COVER WORK UNTIL AS-BUILT INFORMATION IS RECORDED.
B. RECORD PIPE AND WIRING NETWORK ALTERATIONS. RECORD WORK WHICH IS INSTALLED DIFFERENTLY THAN SHOWN ON THE CONSTRUCTION DRAWINGS. RECORD ACCURATE REFERENCE DIMENSIONS, MEASURED FROM AT LEAST TWO PERMANENT REFERENCE POINTS OF EACH IRRIGATION SYSTEM VALVE, EACH BACKFLOW PREVENTION DEVICE, EACH CONTROLLER OR CONTROLLER UNIT, EACH SLEEVE END, EACH SUB-OUT FOR FUTURE PIPE OR WIRING CONNECTIONS, AND OTHER IRRIGATION COMPONENTS ENCLOSED WITHIN A VALVE BOX.

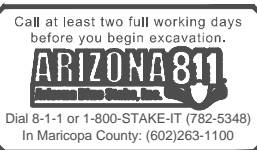

Collaborative V
Design Studio Inc.
7116 East 1st Ave.,
Suite 103
Scottsdale, Arizona
85251
office: 480-347-0590
fax: 480-656-6012



EXPIRES 06 / 30 / 2022

LANDSCAPE IMPROVEMENTS

Hilton Garden Inn

Mesa, AZ

CONCEPTUAL LANDSCAPE PLAN

DESIGNED BY: PV/MD/CP
DRAWN BY: CP
CHECKED BY: PV
DATE: 10/28/2021
REVISION: 03/02/2022 City Comments

Hilton Garden Inn
Design Review

CLS-1

1 of 3



PLANT LEGEND

BOTANICAL NAME	COMMON NAME	PLANTING SIZE	COMMENTS
TREES			
Bauhinia purpurea	Purple Orchid Tree	24" Box	Standard Trunk Dense Canopy
Eucalyptus papuana	Ghost Gum Eucalyptus	36" Box	Standard Trunk Dense Canopy
Parkinsonia x 'Desert Museum'	Desert Museum	36" Box	Multi-Trunk Dense Canopy
Ulmus parvifolia	Chinese Elm	36" Box	Standard Trunk Dense Canopy
Fraxinus velutina 'Fan Tex'	Fan Tex Ash	24" Box	Standard Trunk Dense Canopy
Phoenix dactylifera	Date Palm	18' C.T.H.	Size Per Plan Diamond Cut
Nerium oleander	Oleander Tree	24" Box	Standard Trunk Dense Canopy
Olea europaea	Fruitless Olive	36" Box	Standard Trunk Dense Canopy
Sophora secundiflora	Texas Mountain Laurel	24" Box	Standard Trunk Dense Canopy
Olneya tesota	Ironwood	24" Box	Standard Trunk Dense Canopy
Ficus nitida	Indian Laurel Columns	15 Gal.	Standard Trunk Dense Canopy
Thevetia peruviana	Thevetia	24" Box	Standard Trunk Dense Canopy
Quercus virginiana 'Empire'	Southern Live Oak	36" Box	Standard Trunk Dense Canopy



Ghost Gum Eucalyptus



Desert Museum



Purple Orchid Tree



Indian Laurel columns

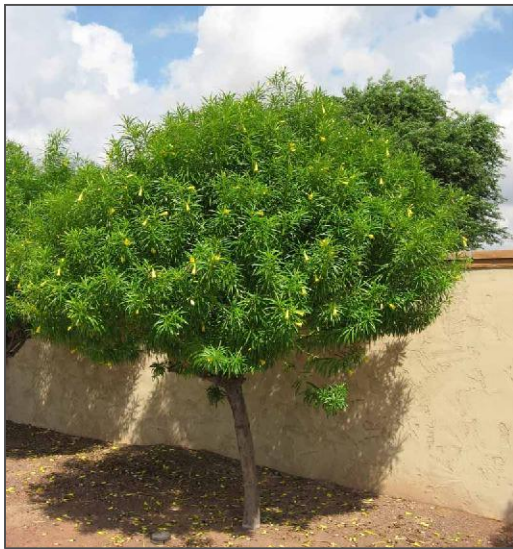

Thevetia

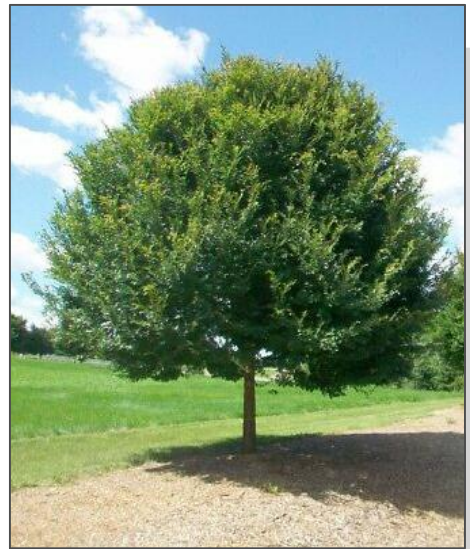

Chinese Elm



Chitalpa



Texas Mountain Laurel



Fan Tex Ash



Ironwood



Chinese Pistache



Date Palm



Southern Live Oak



Oleander Tree



Fruitless Olive

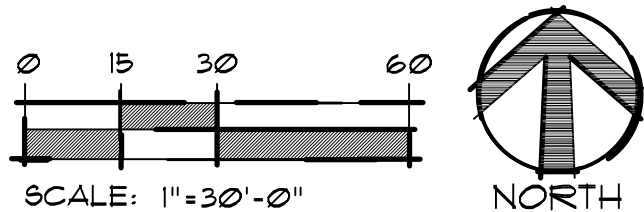

CONCEPTUAL LANDSCAPE PLAN



Collaborative V
Design Studio Inc.
7116 East 1st Ave.,
Suite 103
Scottsdale, Arizona
85251
office: 480-347-0590
fax: 480-656-6012



EXPIRES 06 / 30 / 2022

LANDSCAPE IMPROVEMENTS
Hilton Garden Inn
Mesa, AZ

DESIGNED BY:	PV/MD/CP
DRAWN BY:	CP
CHECKED BY:	PV
DATE:	10/28/2021
REVISIONS:	03/02/2022 City Comments

Hilton Garden Inn
Design Review

CLS-2



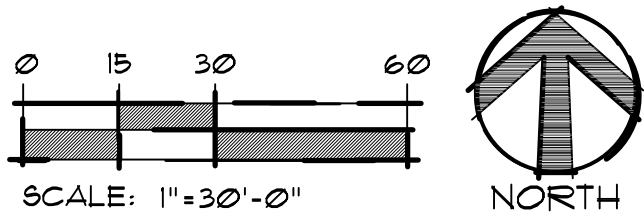
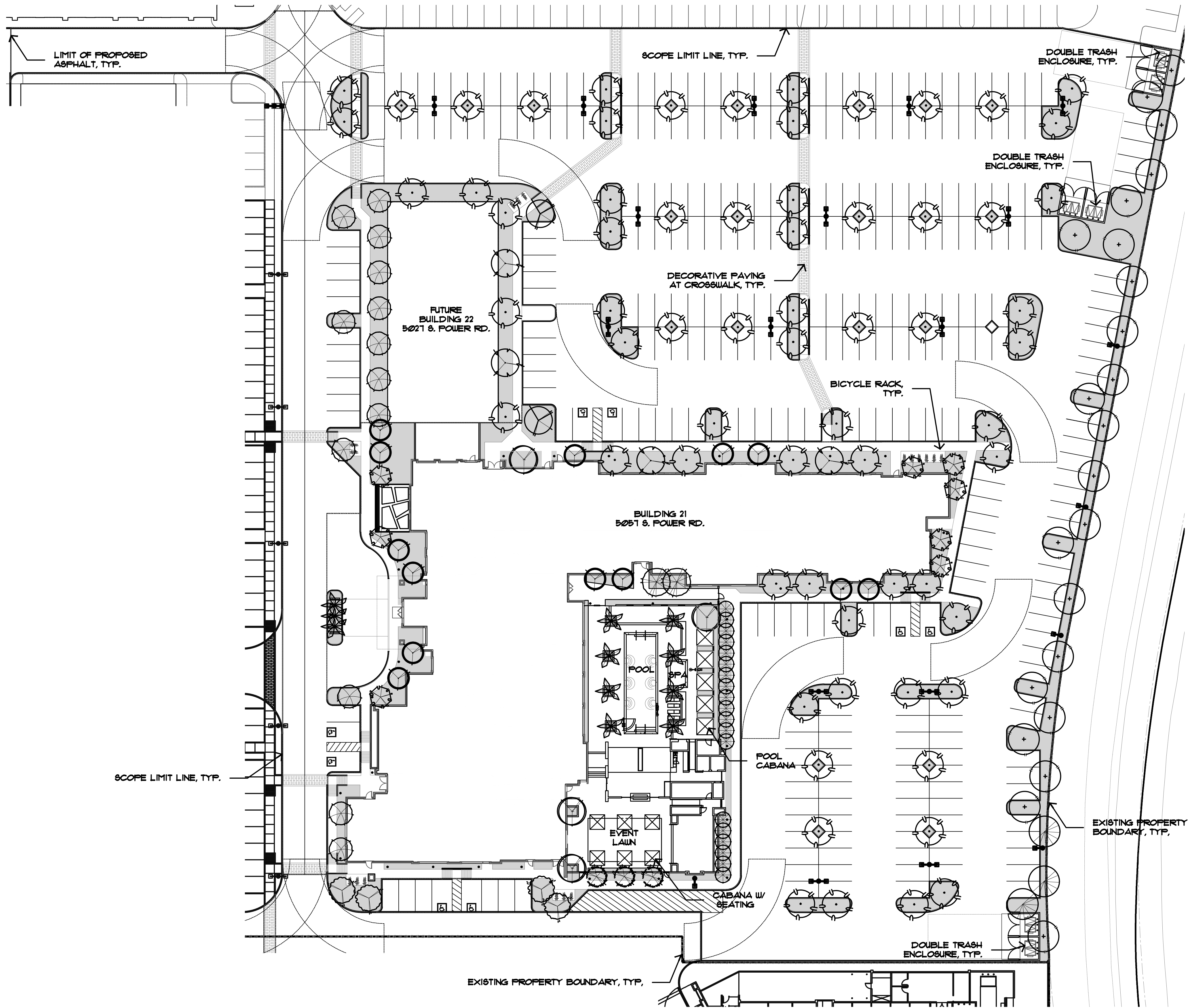

PLANT LEGEND

BOTANICAL NAME	COMMON NAME	PLANTING SIZE	COMMENTS
TREES			
Bauhinia purpurea	Purple Orchid Tree	24" Box	Standard Trunk, Dense Canopy
Eucalyptus papuana	Ghost Gum Eucalyptus	36" Box	Standard Trunk, Dense Canopy
Parkinsonia x 'Desert Museum'	Desert Museum	36" Box	Multi-Trunk, Dense Canopy
Ulmus parvifolia	Chinese Elm	36" Box	Standard Trunk, Dense Canopy
Fraxinus velutina 'Fan Tex'	Fan Tex Ash	24" Box	Standard Trunk, Dense Canopy
Phoenix dactylifera	Date Palm	18' C.T.H.	Size Per Plan, Diamond Cut
Nerium oleander	Oleander Tree	24" Box	Standard Trunk, Dense Canopy
Olea europaea	Fruitless Olive	36" Box	Standard Trunk, Dense Canopy
Sophora secundiflora	Texas Mountain Laurel	24" Box	Standard Trunk, Dense Canopy
Olneya tesota	Ironwood	24" Box	Standard Trunk, Dense Canopy
Ficus nitida	Indian Laurel Columns	15 Gal.	Standard Trunk, Dense Canopy
Thevetia peruviana	Thevetia	24" Box	Standard Trunk, Dense Canopy
Quercus virginiana 'Empire'	Southern Live Oak	36" Box	Standard Trunk, Dense Canopy
ACCENTS/VINES			
Bougainvillea	Vine Bougainvillea	5 Gal.	As Per Plan
Bougainvillea 'Barbara Karst'	Purple Bougainvillea	5 Gal.	As Per Plan
Muhlenbergia dubia	Deer Grass	5 Gal.	As Per Plan
Ficus pumila	Creeping Fig Vine	5 Gal.	As Per Plan
Pedicularis macrocarpa	Lady Slipper Plant	5 Gal.	As Per Plan
Trachelospermum jasminoides	Star Jasmine	5 Gal.	As Per Plan
SHRUBS			
Cassia pulcherrima	Red Bird of Paradise	24" Box	As Per Plan
Buxus sempervirens	Boxwood	5 Gal.	As Per Plan
Olea europaea 'Little Ollie'	Little Ollie	5 Gal.	As Per Plan
Eremophila maculata 'valentine'	Red Emu Bush	5 Gal.	As Per Plan
Myrtus communis	Dwarf Myrtle	5 Gal.	As Per Plan
Ruellia peninsularis	Baja Ruellia	5 Gal.	As Per Plan
Carissa macrocarpa	Natal Plum	5 Gal.	As Per Plan
Tecoma stans	Yellow Bells	5 Gal.	As Per Plan
Tecoma stans 'Orange Jubilee'	Orange Jubilee	5 Gal.	As Per Plan
GROUND COVERS			
Rosmarinus officinalis 'Tuscan Blue'	Rosemary	1 Gal.	As Per Plan
Lantana hybrid 'Bandana'	Red Lantana	1 Gal.	As Per Plan
Lantana hybrid 'New Gold'	New Gold Lantana	1 Gal.	As Per Plan
Lantana montevidensis	Purple Trailing Lantana	1 Gal.	As Per Plan
Wedelia trilobata	Yellow Dot	1 Gal.	As Per Plan
Dietsa bicolor	Evergreen Iris	1 Gal.	As Per Plan
Carissa macrocarpa	Green Carpet Natal Plum	1 Gal.	As Per Plan
MISCELLANEOUS			
Decomposed Granite - 1/2" Screened Sunset Gold or equal from Treasure Chest Granite (480) 354-6805 2" Depth In All Planting Areas (Typ) - 23,333 SQ. FT.			



Collaborative V
 Design Studio Inc.
 7116 East 1st Ave.,
 Suite 103
 Scottsdale, Arizona
 85251
 office: 480-347-0590
 fax: 480-656-6012



EXPIRES 06 / 30 / 2022

LANDSCAPE IMPROVEMENTS
Hilton Garden Inn
 Mesa, AZ

ENLARGED CONCEPTUAL LANDSCAPE PLAN

DESIGNED BY:	PV/MD/CP
DRAWN BY:	CP
CHECKED BY:	PV
DATE:	10/28/2021
REVISIONS:	03/02/2022 City Comments

Hilton Garden Inn
Design Review

CLS-3

