

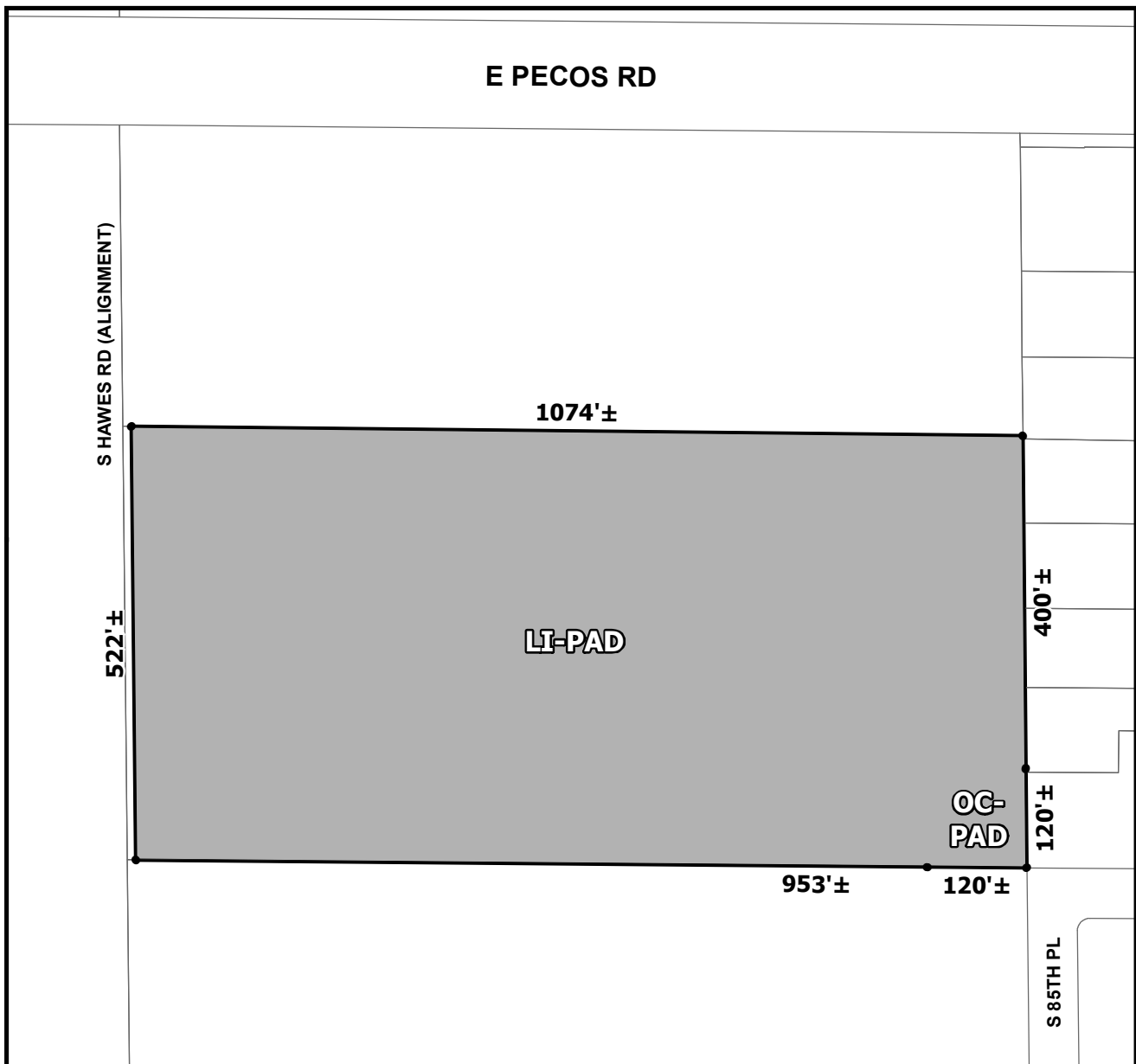

OFFICIAL SUPPLEMENTARY ZONING MAP AMENDING THE CITY OF MESA ZONING MAP



CASE: ZON21-01024

ACREAGE: 13±

REQUEST: REZONE FROM LIGHT INDUSTRIAL WITH A BONUS INTENSITY ZONE OVERLAY AND OFFICE COMMERCIAL WITH A BONUS INTENSITY ZONE OVERLAY (LI-BIZ AND OC-BIZ) TO LIGHT INDUSTRIAL AND OFFICE COMMERCIAL WITH A PLANNED AREA DEVELOPMENT OVERLAY (LI-PAD AND OC-PAD), AND SITE PLAN REVIEW.

ORDINANCE: _____

Please be advised that the attached zoning changes were approved by the Mesa City Council on _____, 2022 by Ordinance # _____. If you have any questions concerning these changes, contact the City of Mesa Planning Division at 480-644-2385.

MAYOR

ATTEST: _____

CITY CLERK

DATE: _____