

When recorded mail to:
City of Mesa
Real Estate Services
P.O. Box 1466
Mesa, AZ 85211-1466

5409-6-1-1--
yorkm

ANNEXATION

City of Mesa

DO NOT REMOVE

This is part of the official document

When recorded mail to:
City of Mesa
Real Estate Services
P.O. Box 1466
Mesa, AZ 85211-1466

ANNEXATION

City of Mesa

DO NOT REMOVE

This is part of the official document



AFFIDAVIT

I, Rachel Prelog, the Assistant Planning Director of the City of Mesa, Maricopa County, Arizona, do hereby certify that Annexation Number ANX21-00649 does not include lands that are subject to an earlier filing for annexation.

I, certify that the information contained in this form is true and accurate to the best of my knowledge, and I acknowledge that this document will be recorded as an official record in the Office of the Maricopa County Recorder.

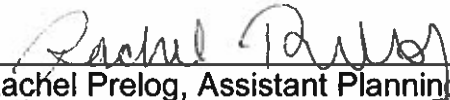

Rachel Prelog, Assistant Planning Director
On Behalf of Nana Appiah, Planning Director

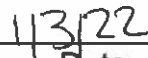

Date

State of Arizona)
)ss
County of Maricopa)

This instrument was acknowledged before me this 3rd day of January 2022.

WITNESS my hand and official seal the day and year in this affidavit above written.



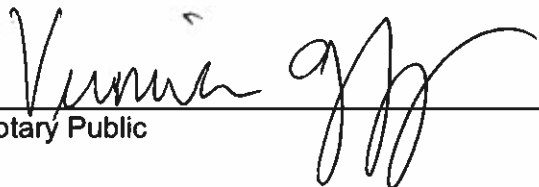

Notary Public

When recorded, return to:
City of Mesa
Planning Division
P.O. Box 1466
Mesa AZ 85211-1466

ANNEXATION PETITION
ANX21-00649

TO: THE HONORABLE MAYOR AND CITY COUNCIL OF THE CITY OF
MESA, ARIZONA:

We the undersigned, owners of not less than one-half in value of the real property and personal property and more than one-half of the persons owning real and personal property that would be subject to taxation by the City of Mesa in the event of annexation within the territory proposed to be annexed, which is hereafter described, said territory being completely surrounded by the corporate limits of the City of Mesa, with the exterior boundaries of the territory proposed to be annexed shown on the map attached hereto, marked Exhibit "A" and made a part hereof, request the City of Mesa annex the following described territory, provided Section 9-471, Arizona Revised Statutes, and amendments thereto, are fully observed.

The description of the territory proposed to be annexed, not already within the present limits of the City of Mesa and located in Maricopa County, Arizona, is as follows:

PARCEL 1:
COMMENCING AT THE SOUTH QUARTER CORNER OF SECTION 25,
TOWNSHIP 1 SOUTH, RANGE 7 EAST, GILA AND SALT RIVER BASE AND
MERIDIAN, MARICOPA COUNTY, ARIZONA, BEING MARKED BY A 3" BRASS
CAP;

THENCE NORTH 0 DEGREES 29 MINUTES 07 SECONDS WEST (BASIS OF
BEARINGS) ALONG THE NORTH-SOUTH MID-SECTION LINE OF SAID
SECTION 25, A DISTANCE OF 2344.00 FEET TO THE POINT OF
BEGINNING;

THENCE NORTH 89 DEGREES 30 MINUTES 48 SECONDS WEST, A
DISTANCE OF 875.54 FEET TO A POINT ON THE WESTERLY LINE OF THE
EAST ONE-THIRD OF THE SOUTHWEST QUARTER OF SAID SECTION 25
AND ALSO BEING THE EAST LINE OF TRACT G, PER BOOK 1535, PAGE 48,
M.C.R.;

THENCE NORTH 0 DEGREES 25 MINUTES 18 SECONDS WEST, 284.57 FEET TO THE NORTHWEST CORNER OF THE SAID EAST ONE-THIRD OF THE SOUTHWEST QUARTER OF SECTION 25 AND FROM WHICH POINT THE WEST QUARTER CORNER OF SAID SECTION 25, BEING MARKED BY A 3" BRASS CAP, BEARS NORTH 89 DEGREES 33 MINUTES 08 SECONDS WEST, 1750.32 FEET DISTANCE THEREFROM;

THENCE SOUTH 89 DEGREES 33 MINUTES 08 SECONDS EAST, 875.21 FEET TO THE CENTER OF SAID SECTION 25, FOUND 3" BRASS CAP, 0.58' NORTH OF ACCEPTED CENTER OF SECTION;

THENCE SOUTH 0 DEGREES 29 MINUTES 07 SECONDS EAST, ALONG THE SAID NORTH-SOUTH MID-SECTION LINE OF SECTION 25, A DISTANCE OF 285.17 FEET TO THE POINT OF BEGINNING.

EXCEPTING THEREFROM THE EAST 33.00 FEET.

PARCEL 2:

COMMENCING AT THE SOUTH QUARTER CORNER OF SECTION 25, TOWNSHIP 1 SOUTH, RANGE 7 EAST, GILA AND SALT RIVER BASE AND MERIDIAN, MARICOPA COUNTY, ARIZONA, BEING MARKED BY A 3" BRASS CAP;

THENCE NORTH 0 DEGREES 29 MINUTES 07 SECONDS WEST (BASIS OF BEARINGS) ALONG THE NORTH-SOUTH MIDSECTION LINE OF SAID SECTION 25, A DISTANCE OF 2058.82 FEET TO THE POINT OF BEGINNING;

THENCE NORTH 89 DEGREES 28 MINUTES 00 SECONDS WEST, A DISTANCE OF 875.87 FEET TO A POINT ON THE WESTERLY LINE OF THE EAST ONE-THIRD OF THE SOUTHWEST QUARTER OF SAID SECTION 25 AND ALSO BEING THE EAST LINE OF TRACT G, PER BOOK 1535, PAGE 48, M.C.R.;

THENCE NORTH 0 DEGREES 25 MINUTES 18 SECONDS WEST, 284.46 FEET TO A POINT FROM WHICH THE NORTHWEST CORNER OF THE SAID EAST ONE-THIRD OF THE SOUTHWEST QUARTER OF SECTION 25, BEARS NORTH 0 DEGREES 25 MINUTES 18 SECONDS WEST, 284.57 FEET DISTANT THEREFROM;

THENCE SOUTH 89 DEGREES 30 MINUTES 48 SECONDS EAST, 875.54 FEET TO A POINT ON THE SAID NORTH-SOUTH MID-SECTION LINE OF SECTION 25, AND FROM WHICH POINT THE CENTER OF SAID SECTION 25, BEARS NORTH 0 DEGREES 29 MINUTES 07 SECONDS WEST, 285.17 FEET DISTANT THEREFROM;

THENCE SOUTH 0 DEGREES 29 MINUTES 07 SECONDS EAST, ALONG THE SAID NORTH-SOUTH MID-SECTION LINE OF SECTION 25, A DISTANCE OF 285.18 FEET TO THE POINT OF BEGINNING.

EXCEPTING THEREFROM THE EAST 33.00 FEET.

ANX21-00649
11.0± Acres

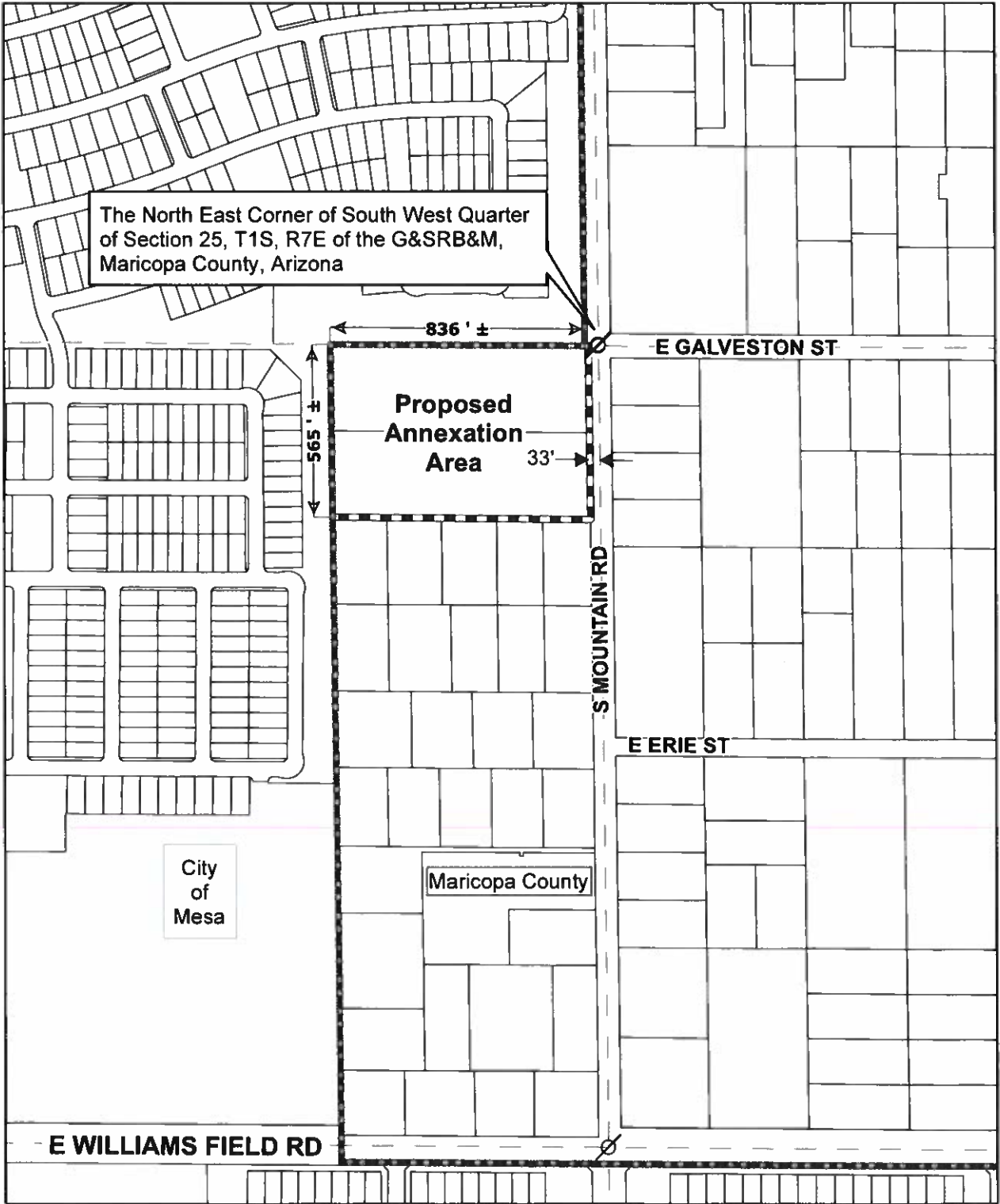

- ⊘ Legal Control Point City of Mesa Boundary
 Quarter Section Proposed Annexation Boundary

EXHIBIT 'A'

We the undersigned owners, hereby sign in favor for annexation of our property to the City of Mesa Corporate Limits, as described by the attached annexation petition.

PLEASE PRINT OR TYPE, EXCEPT FOR SIGNATURES.

Owner (s) _____ Phone No. _____

Mailing Address _____

County Assessor Parcel No. _____

Signature (s) _____ Date _____

Owner (s) _____ Phone No. _____

Mailing Address _____

County Assessor Parcel No. _____

Signature (s) _____ Date _____

Owner (s) _____ Phone No. _____

Mailing Address _____

County Assessor Parcel No. _____

Signature (s) _____ Date _____

Owner (s) _____ Phone No. _____

Mailing Address _____

County Assessor Parcel No. _____

Signature (s) _____ Date _____
