

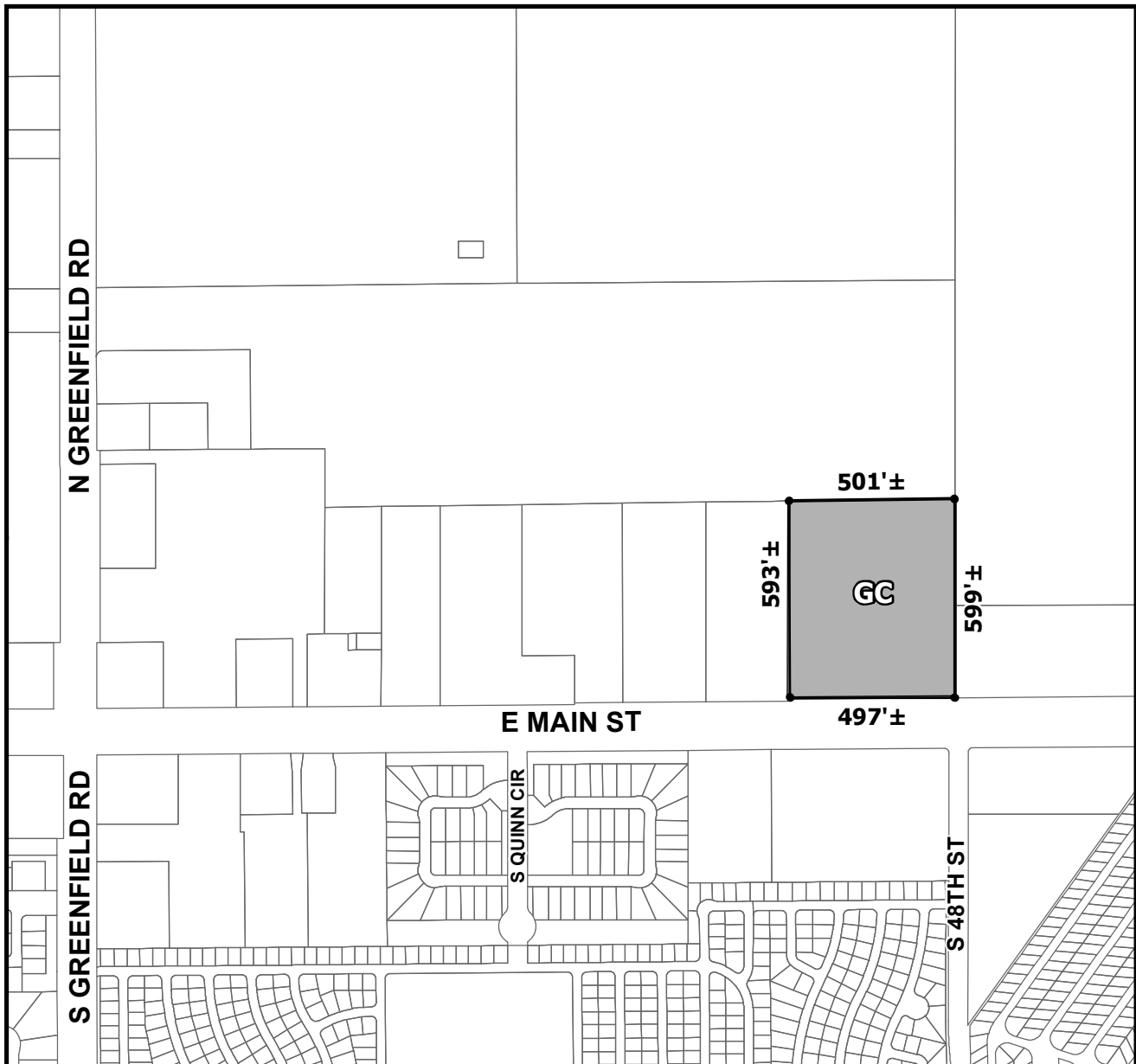

# OFFICIAL SUPPLEMENTARY ZONING MAP AMENDING THE CITY OF MESA ZONING MAP



**CASE: ZON21-00288**  
**ACREAGE: 6.8±**  
**REQUEST: SITE PLAN REVIEW**

**ORDINANCE:** \_\_\_\_\_

Please be advised that the attached zoning changes were approved by the Mesa City Council on \_\_\_\_\_, 2022 by Ordinance # \_\_\_\_\_. If you have any questions concerning these changes, contact the City of Mesa Planning Division at 480-644-2385.

\_\_\_\_\_  
**MAYOR**

**ATTEST:** \_\_\_\_\_  
**CITY CLERK**

**DATE:** \_\_\_\_\_