

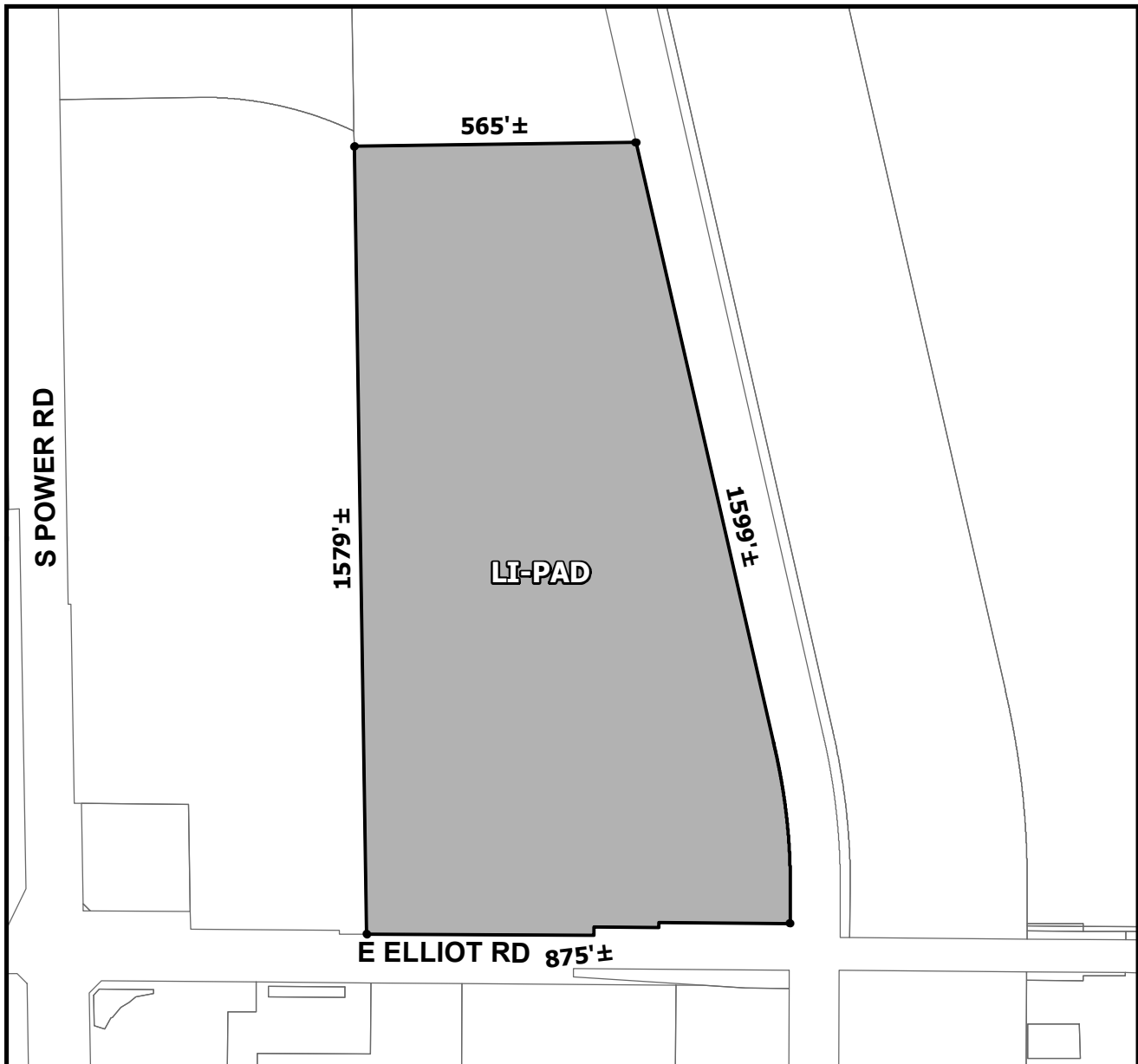

OFFICIAL SUPPLEMENTARY ZONING MAP AMENDING THE CITY OF MESA ZONING MAP



CASE: ZON21-00746

ACREAGE: 26.3±

REQUEST: REZONE FROM SINGLE RESIDENCE 43 (RS-43) TO LIGHT INDUSTRIAL WITH A PLANNED AREA DEVELOPMENT OVERLAY (LI-PAD) AND SITE PLAN REVIEW. THIS REQUEST WILL ALLOW FOR AN INDUSTRIAL DEVELOPMENT.

ORDINANCE: _____

Please be advised that the attached zoning changes were approved by the Mesa City Council on _____, 2022 by Ordinance # _____. If you have any questions concerning these changes, contact the City of Mesa Planning Division at 480-644-2385.

MAYOR

ATTEST: _____
CITY CLERK

DATE: _____