

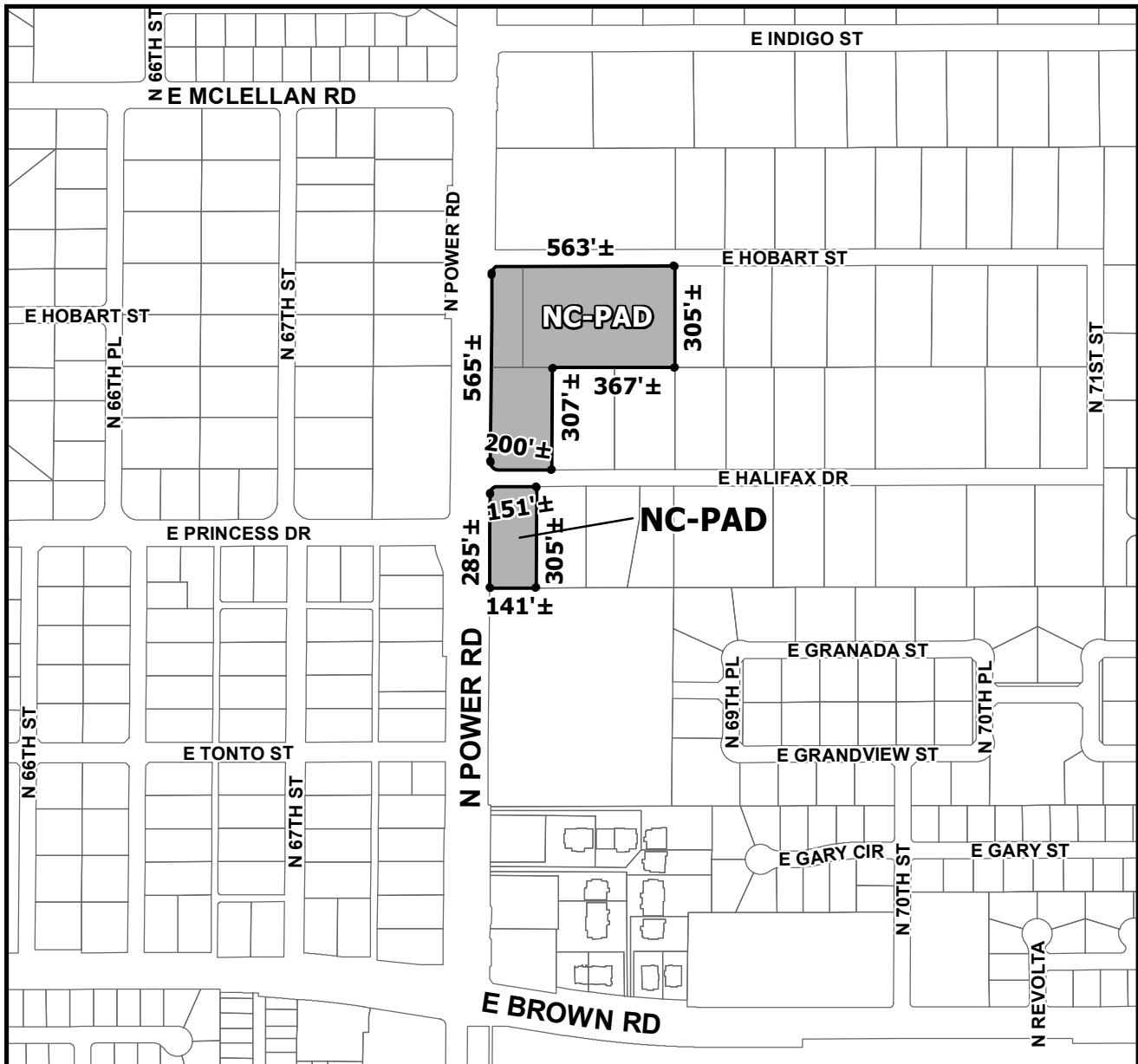

# OFFICIAL SUPPLEMENTARY ZONING MAP AMENDING THE CITY OF MESA ZONING MAP



**CASE: ZON21-00278**

**ACREAGE: 6.13±**

**REQUEST: REZONE FROM OFFICE COMMERCIAL (OC) AND SINGLE RESIDENCE 35 (RS-35) TO NEIGHBORHOOD COMMERCIAL WITH A PLANNED AREA DEVELOPMENT OVERLAY (NC-PAD) AND SITE PLAN REVIEW.**

**ORDINANCE: \_\_\_\_\_**

Please be advised that the attached zoning changes were approved by the Mesa City Council on \_\_\_\_\_, 2022 by Ordinance # \_\_\_\_\_. If you have any questions concerning these changes, contact the City of Mesa Planning Division at 480-644-2385.

**ATTEST: \_\_\_\_\_ DATE: \_\_\_\_\_**

**MAYOR**

**CITY CLERK**