

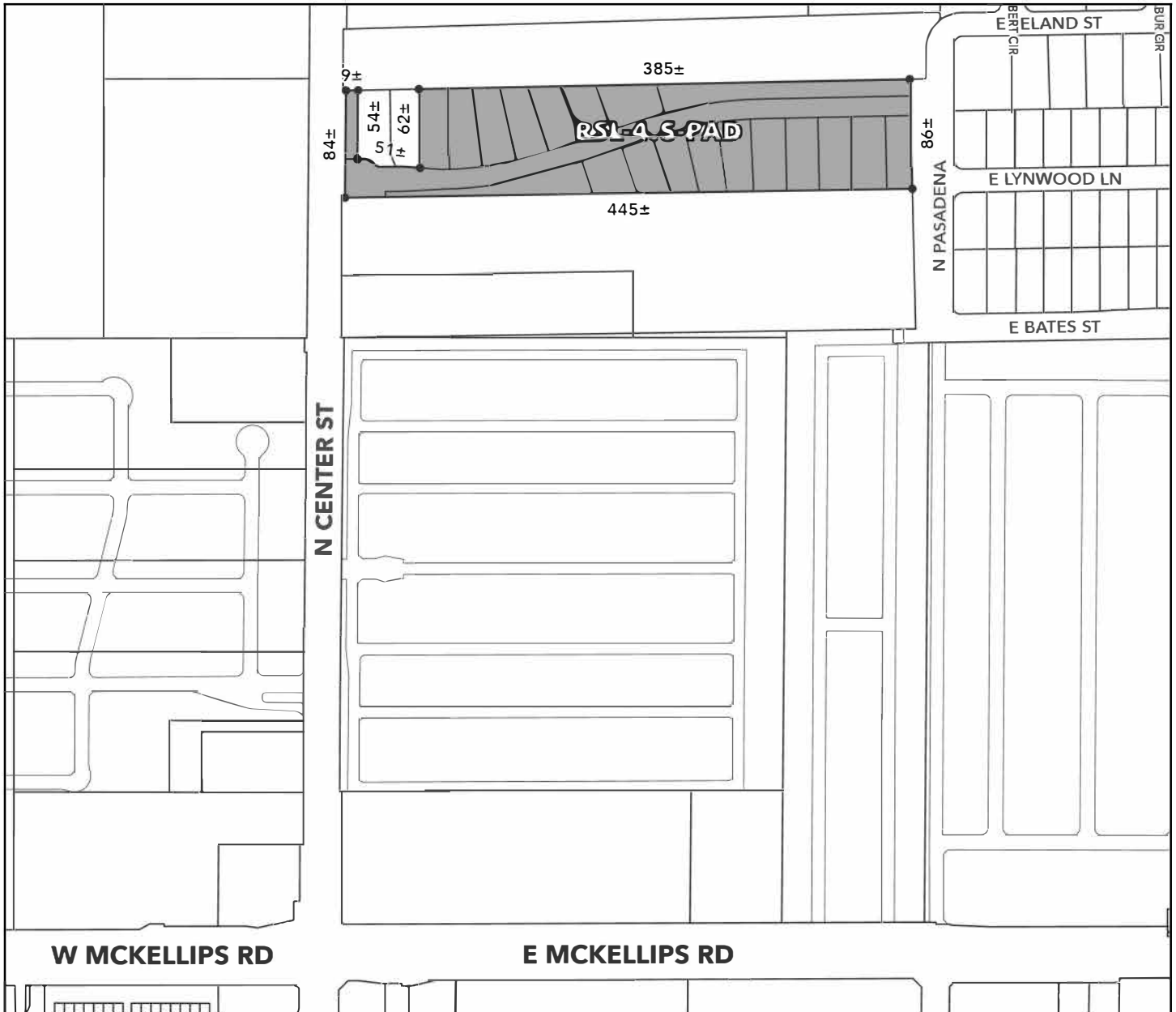

OFFICIAL SUPPLEMENTARY ZONING MAP AMENDING THE CITY OF MESA ZONING MAP



CASE: ZON25-00304

ACREAGE: 6.5±

REQUEST: Rezone from Single Residence-9 with a Planned Area Development overlay (RS-9-PAD) to Small Lot Single Residence 4.5 with a PAD overlay (RSL-4.5-PAD) for a 41-lot single residence development.

ORDINANCE: 5965

Please be advised that the attached zoning changes were approved by the Mesa City Council on September 22, 2025 by Ordinance #5965. If you have any questions concerning these changes, contact the City of Mesa Planning Division at 480-644-2385.

MAYOR

ATTEST: _____
CITY CLERK

DATE: _____