

6-15-23	CUP APP	item
8-12-23	CUP REVISIONS	UB no. B2311
9-28-23	CUP REVISION	

**COUNCIL USE PERMIT**  
 FOR POLARIS ACADEMY  
 1440 S CLEARVIEW, MESA, ARIZONA 85209

**COUNCIL USE PERMIT SITE PLAN**

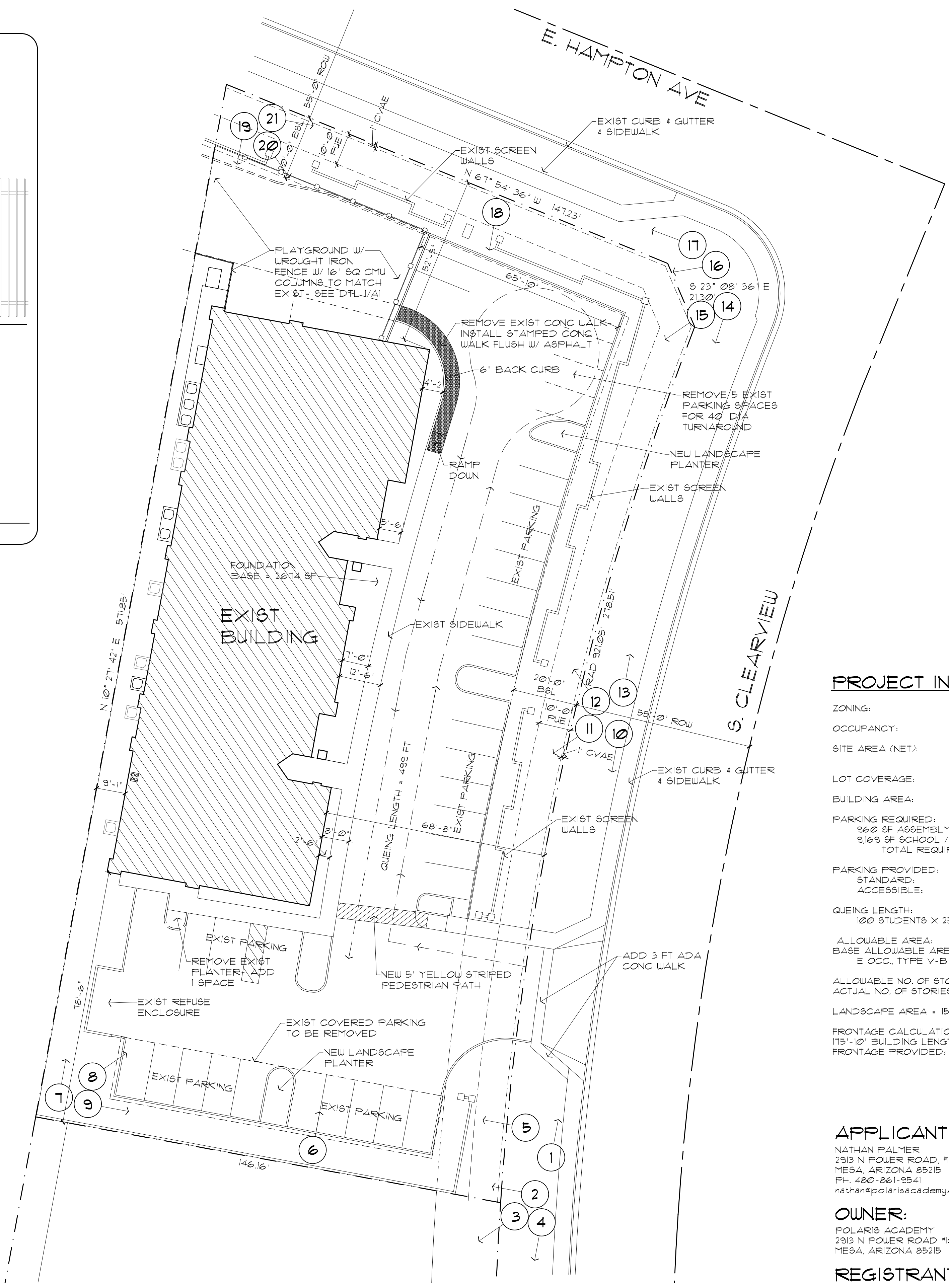
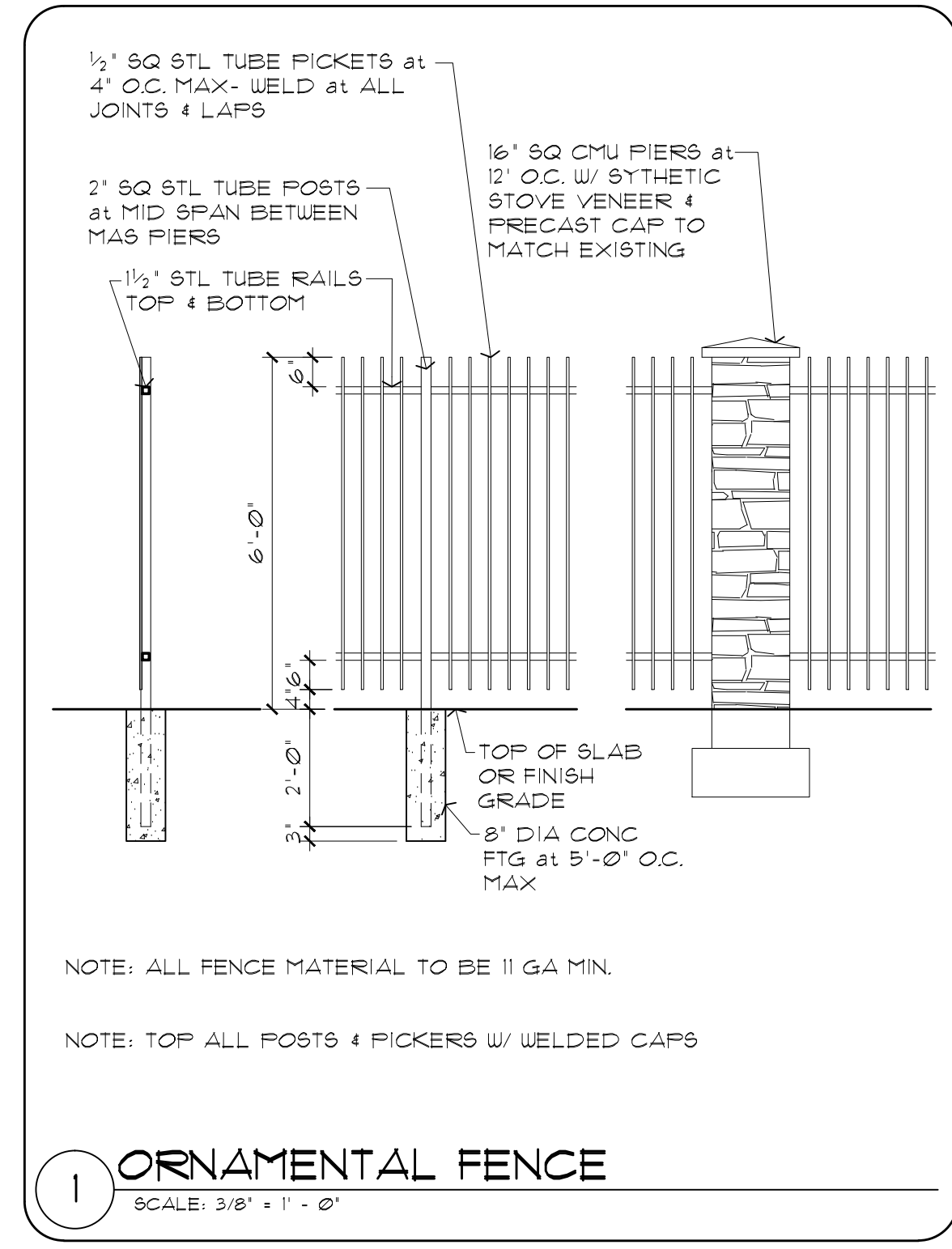

**SITE PLAN**  
 SCALE: 1" = 20' - 0"

**PROJECT INFORMATION**

ZONING:	LIGHT COMMERCIAL
OCCUPANCY:	E - PRIVATE SCHOOL
SITE AREA (NET):	44,736 SF. 1021 AC.
LOT COVERAGE:	10/29 / 44,736 = 22.64%
BUILDING AREA:	10/29 SF.
PARKING REQUIRED:	
360 SF ASSEMBLY / 75+	13 SPACES
9169 SF SCHOOL / 6000+	16 SPACES
TOTAL REQUIRED:	29 SPACES
PARKING PROVIDED:	31 SPACES
STANDARD:	29 SPACES
ACCESSIBLE:	2 SPACES
QUEING LENGTH:	100 STUDENTS X 25 FT X 0.15 = 375 FT
ALLOWABLE AREA:	
BASE ALLOWABLE AREAS PER TABLE 503:	
E OCC. TYPE V-B - AFES:	38,000 SF.
ALLOWABLE NO. OF STORIES = 2	
ACTUAL NO. OF STORIES = 1	
LANDSCAPE AREA = 15,837 SF	
FRONTAGE CALCULATION:	
175'-10" BUILDING LENGTH X 15' = 2613 SF REQ'D	
FRONTAGE PROVIDED: 2614 SF	

**APPLICANT:**  
 NATHAN PALMER  
 2913 N POWER ROAD #108  
 MESA, ARIZONA 85215  
 PH. 480-261-9541  
 nathan@polarisacademy.org

**OWNER:**  
 POLARIS ACADEMY  
 2913 N POWER ROAD #108  
 MESA, ARIZONA 85215

**REGISTRANT:**  
 BOYD H THACKER  
 2637 E. EL MORO AVENUE  
 MESA, ARIZONA 85204  
 PHONE: 602-909-3686