

PROJECT DIRECTORY

ARCHITECT:
 RKA ARCHITECTS, INC.
 2233 EAST THOMAS ROAD
 PHOENIX, ARIZONA 85016
 CONTACT: NEIL FEASER
 PHONE: (602) 955-3900
 FAX: (602) 955-0496
 E-MAIL: nfeaser@rkaa.com

SITE DATA

PARCEL NUMBER: 304-17-211 THRU 304-17-219
 EXISTING ZONING: LC -PAD-BIZ
 NET SITE AREA: 12.04 ACRES (524,473 S.F.)
 GROSS SITE AREA: 14.46 ACRES (630,003 S.F.)
 MAX. LOT COVERAGE PER CODE: 80%
 LOT COVERAGE PROPOSED: 79.1%
 MAX. HEIGHT PER CODE: 30'-0"
 PUBLIC SPACE REQUIRED: 5 SF / 1000 SF OF BUILD. AREA
 5 X 76,700 SF / 1000 : 383.5 S.F.
 PUBLIC SPACE PROVIDED PER MZO 11-6-2.b.1: 400 S.F.

PROPOSED USE: RETAIL/RESTAURANT/FITNESS/GAS STATION

BUILDING AREA:
 PAD A: GAS STATION-CSTORE 4,782 S.F.
 PAD B: RESTAURANT - DT 3,843 S.F.
 PAD C: RESTAURANT - DT 2,320 S.F.
 PAD D: AUTO SERVICE - OIL & LUBE 1,674 S.F.
 PAD E: RESTAURANT - DT 1,000 S.F.
 ALDI- RETAIL: 19,500 S.F.
 EOS FITNESS 40,000 S.F.
 TOTAL BUILDING AREA: 73,119 S.F.

TOTAL PATIO AREA 300 S.F.
 TOTAL GROSS AREA: 73,419 S.F.
 SITE COVERAGE: 13.99 %

PUBLIC SPACE REQUIRED: 367 S.F.
 PUBLIC SPACE PROVIDED: 400 S.F.

PARKING REQUIRED
 GAS STATION-CSTORE-4,782 SF : 1 PER 375 14 SPACES
 RESTAURANT-7163 SF - DT: 1 PER 100 72 SPACES
 PATIO SEATING: 1 PER 300 02 SPACES
 AUTO SERVICE: OIL & LUBE 1 PER 375 05 SPACES
 ALDI - RETAIL : 1 PER 375 52 SPACES
 EOS FITNESS : 1 PER 100 400 SPACES

TOTAL PARKING REQUIRED: 545 SPACES
 PARKING APPROVED PER ZON22-01271: 526 SPACES
 TOTAL PARKING PROVIDED: 9' X 18' 534 SPACES

ACCESSIBLE SPACES PROVIDED: 20 SPACES

BICYCLE SPACE REQUIRED:
 1 PER 10 PARKING SPACES UP TO 50 50 SPACES
 1 PER 20 PARKING SPACES MORE THAN 50 02 SPACES
 TOTAL BICYCLE SPACE REQUIRED: MIN 2' X 6' 52 SPACES
 BICYCLE SPACES PROVIDED: MIN 2' X 6' 38 SPACES
 MOTORCYCLE SPACES PROVIDED: 4' X 9' 05 SPACES
 (MIN. SIZE PER CODE 5' X 9')

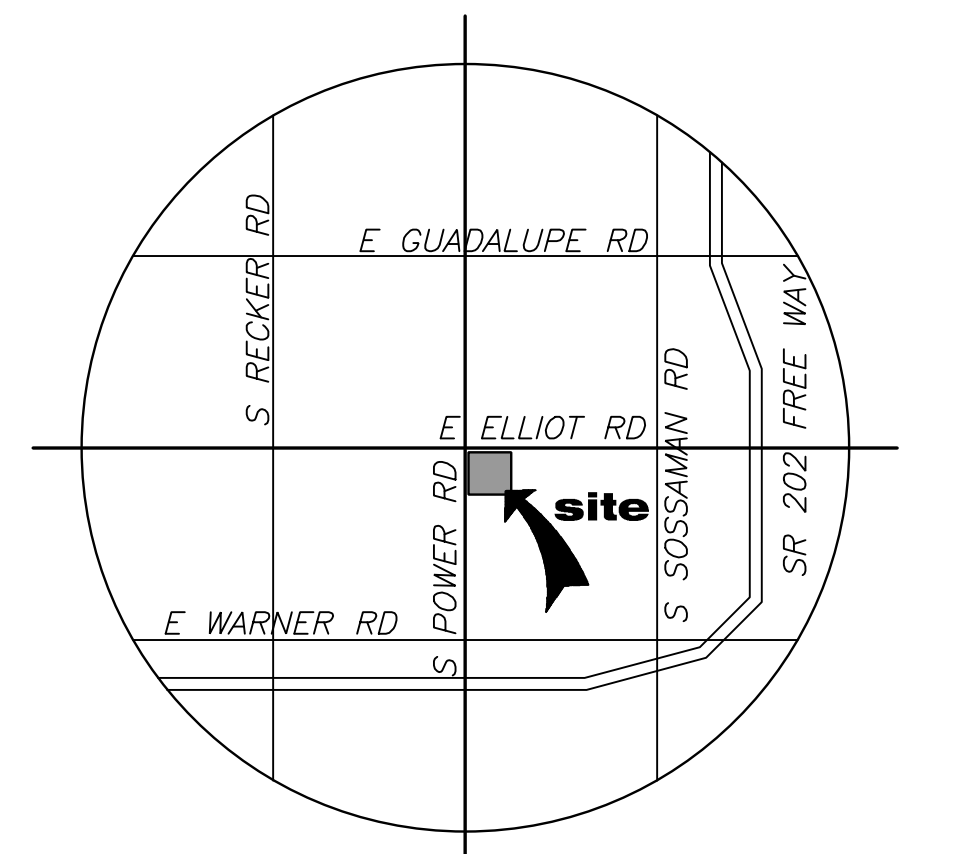
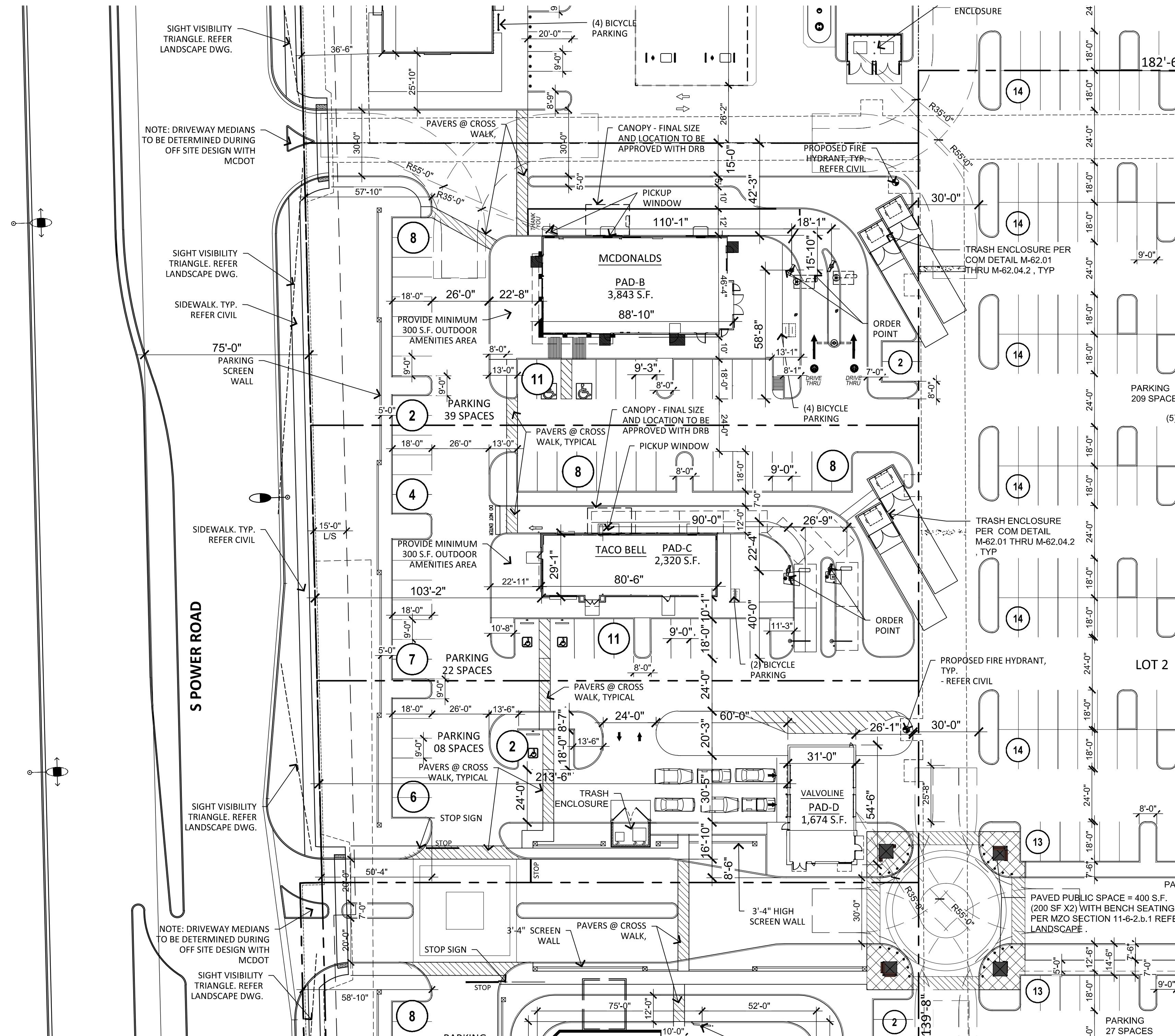

ENLARGED SITE PLAN

SCALE: 1" = 30'-0"

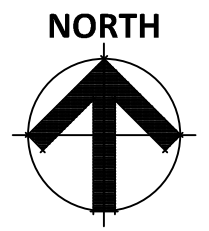

POWER & ELLIOT - PAD-B PAD-C & PAD-D

3663 E POWER ROAD MESA ARIZONA 85212
 SEC OF S POWER ROAD AND E ELLIOT ROAD
 DATE: 08-19-2024 (PRELIMINARY)

© 2017 RKA ARCHITECTS, INC. ALL RIGHTS RESERVED. THIS DRAWING IS AN INSTRUMENT OF SERVICE. IT IS THE PROPERTY OF RKA ARCHITECTS, INC. AND MAY NOT BE DUPLICATED, USED OR DISCLOSED WITHOUT WRITTEN PERMISSION OF THE ARCHITECT.

SP-1

RKAA# 22223.50



ZON24-00649

THIS SITE PLAN HAS BEEN PREPARED WITHOUT THE AID OF A SURVEY. ALL PROPERTY BOUNDARIES ARE ROUGH APPROXIMATIONS. THIS DRAWING IS TO BE USED FOR CONCEPTUAL PURPOSES ONLY AND IT IS NOT TO BE THE BASIS FOR ANY LEGALLY BINDING DOCUMENTATION.