

**RESOLUTION NO. 12208**

A RESOLUTION OF THE CITY COUNCIL OF THE CITY OF MESA, MARICOPA COUNTY, ARIZONA, APPROVING THE ANNUAL ASSESSMENTS FOR THE MESA TOWN CENTER IMPROVEMENT DISTRICT NO. 228.

WHEREAS, the City Council of the City of Mesa has made the annual statement and estimate of the expenses of the Mesa Town Center Improvement District No. 228 for the 2024 (tax year), and did assess, under Resolution of Intention No. 5617, the total sum upon the several lots, each respectively, in proportion to the benefits to be received by each lot and has caused said assessment to be recorded as provided by law; and

WHEREAS, the 20th day of May 2024, was set for the annual hearing on said assessment by Resolution No. 12024, the Council of the City Council of the City of Mesa approved the annual assessment; and

WHEREAS, notice thereof has been given as required by law by publication for five (5) consecutive days in the Arizona Republic, a daily newspaper published and circulated in the said City of Mesa; and

WHEREAS, the total cost of the annual expenses, as shown on Exhibit C attached thereto, of said improvement for the 2024 (tax year) have now been assessed upon each of the several pieces, parcels, lots, portions of lots and parcels of land, as shown on Exhibit B attached hereto, included within the assessment district, as shown on Exhibit A attached hereto and described in the Resolution of Intention for said work in proportion to the benefits to be received by each of said pieces, parcels, lots, portions of lots and parcels of land and that none of the respective pieces, parcels, lots, portions of lots and parcels of land have

been assessed in excess of the benefits to be derived from said improvement by such respective pieces, parcels, lots, portions of lots and parcels of land; and

WHEREAS, said assessment in all respects complies with the laws providing for such assessments and under which said improvement was ordered.

NOW THEREFORE, BE IT RESOLVED BY THE CITY COUNCIL OF THE CITY OF MESA, MARICOPA COUNTY, ARIZONA, that the said assessments so made and recorded as aforesaid, be, and the same hereby confirmed and approved in the amounts for 2024 (tax year) as shown in the attached Exhibit B.

PASSED AND ADOPTED by the City Council of the City of Mesa, Maricopa County, Arizona, this 20<sup>th</sup> day of May 2024.

APPROVED:

\_\_\_\_\_  
Mayor

ATTEST:

\_\_\_\_\_  
City Clerk

# EXHIBIT A

## SID 228 District Boundary

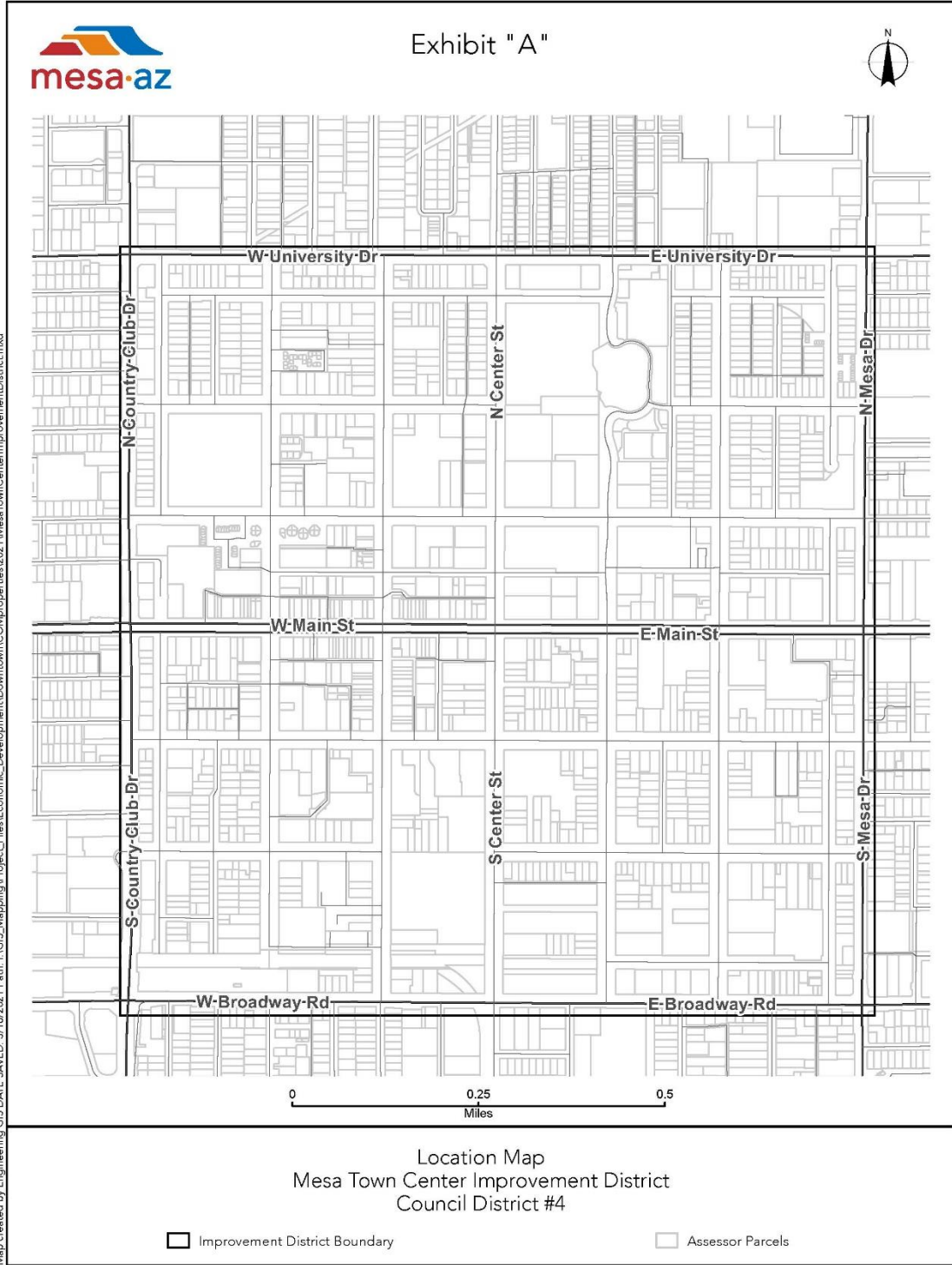

The City of Mesa makes no claims concerning the accuracy of the data on this product nor assumes any liability from the use of the information herein. Copyright 1988, 2021 City of Mesa, Arizona

EXHIBIT B

Mesa Town Center Improvement District No. 228  
Map Parcel Assessment Listing of Property as Per Maricopa County Tax Rolls/Statutes

<b>PARCEL NUMBER</b>	<b>PERMITTED 2024 DISTRICT ASSESSMENT PER PARCEL</b>
138-51-029	\$0.40
138-52-040A	\$2.30
138-59-010B	\$3.85
138-51-027	\$4.69
138-38-007	\$4.75
138-43-014H	\$7.06
138-53-046B	\$8.96
138-35-027	\$9.74
138-52-023A	\$9.88
138-35-043	\$13.20
138-47-056	\$14.18
138-47-061B	\$15.54
138-47-012	\$16.13
138-47-061D	\$19.80
138-34-016	\$21.18
138-47-055B	\$22.87
138-52-040B	\$24.48
138-51-001	\$29.33
138-41-020B	\$30.63
138-47-061C	\$30.72
138-47-060	\$39.02
138-34-015	\$42.35
138-47-057	\$43.26
138-58-045C	\$43.61
138-52-049	\$44.08
138-59-012A	\$45.35
138-34-017	\$46.20
138-66-019	\$47.92
138-47-011	\$49.41
138-52-024A	\$49.88
138-35-028	\$51.29
138-63-012	\$52.46
138-58-026B	\$52.50
138-52-050	\$57.06
138-55-010	\$57.75
138-34-011	\$58.00
138-58-027B	\$59.99
138-66-027	\$63.00
138-59-010A	\$63.40
138-58-026A	\$63.49
138-34-012	\$63.87
138-47-030	\$66.20
138-52-045	\$67.93

138-52-043	\$67.94
138-64-033	\$70.00
138-57-017A	\$70.97
138-51-026	\$73.32
138-51-020D	\$73.37
138-47-010	\$73.50
138-52-038	\$75.66
138-31-037A	\$77.71
138-51-023	\$78.00
138-51-024	\$78.00
138-51-025	\$78.00
138-52-014	\$79.94
138-52-015	\$80.18
138-52-012	\$80.30
138-52-011	\$80.54
138-52-013	\$81.02
138-52-029	\$81.56
138-52-030	\$81.91
138-52-032	\$82.00
138-52-031	\$82.12
138-58-027A	\$82.54
138-52-034	\$82.60
138-47-004H	\$82.74
138-52-051B	\$82.77
138-52-033	\$82.96
138-52-035	\$83.08
138-52-036	\$83.44
138-52-052A	\$83.51
138-51-019B	\$84.50
138-51-015	\$84.86
138-47-058	\$85.12
138-58-033	\$85.65
138-58-045B	\$87.35
138-52-022A	\$90.96
138-64-031	\$93.37
138-47-017	\$93.37
138-47-016	\$93.53
138-51-030D	\$94.45
138-47-004E	\$98.04
138-58-035	\$101.06
138-51-016	\$102.43
138-47-018	\$106.26
138-51-022	\$111.15
138-42-015	\$115.20
138-58-028	\$115.99
138-47-007	\$118.65
138-53-045A	\$118.97
138-53-048	\$124.15
138-52-020	\$124.85
138-36-021B	\$125.17
138-53-045C	\$125.61
138-53-044	\$127.09

138-66-081	\$127.61
138-43-002B	\$128.33
138-52-048	\$129.77
138-50-007A	\$132.27
138-53-047	\$134.62
138-45-036D	\$135.12
138-56-045	\$135.72
138-57-009	\$136.10
138-64-032	\$137.24
138-56-049	\$137.81
138-47-028	\$138.23
138-47-033	\$138.35
138-66-080	\$138.72
138-42-007	\$138.87
138-47-031	\$139.43
138-57-008	\$139.45
138-56-052	\$139.58
138-56-051	\$139.67
138-47-025	\$140.03
138-57-007	\$140.22
138-56-048	\$140.31
138-56-050	\$140.70
138-35-040	\$144.00
138-59-031	\$144.49
138-57-021B	\$144.97
138-57-019	\$145.05
138-47-021	\$145.13
138-57-013B	\$145.17
138-57-014A	\$145.20
138-57-020	\$145.29
138-57-016	\$145.65
138-47-006	\$145.85
138-57-018	\$146.01
138-47-020C	\$147.53
138-57-021C	\$148.01
138-66-084	\$150.37
138-47-008A	\$151.45
138-50-008C	\$152.25
138-52-037	\$152.31
138-52-006D	\$152.69
138-42-013A	\$152.74
138-66-085	\$153.37
138-47-063	\$153.78
138-49-970B	\$154.04
138-55-007	\$155.10
138-35-051	\$157.43
138-59-025B	\$157.50
138-53-040	\$161.76
138-54-049F	\$163.23
138-66-082	\$165.92
138-47-023A	\$166.68
138-42-011	\$168.67

138-66-025B	\$169.92
138-57-010C	\$171.31
138-53-042	\$174.00
138-61-095	\$174.17
138-50-009B	\$179.29
138-56-047	\$180.02
138-47-059	\$181.50
138-47-027	\$181.71
138-66-078	\$183.14
138-53-043	\$187.43
138-58-014	\$191.39
138-58-042	\$191.48
138-47-026	\$191.95
138-47-019	\$192.51
138-53-026D	\$194.23
138-54-007	\$199.59
138-54-009A	\$209.49
138-42-014	\$210.34
138-56-053A	\$213.72
138-36-009A	\$214.90
138-56-054	\$214.94
138-66-088	\$218.46
138-57-010B	\$220.57
138-47-034	\$222.07
138-56-055	\$222.80
138-47-053	\$223.00
138-52-016A	\$223.94
138-65-018	\$224.77
138-59-009	\$225.25
138-36-007A	\$231.50
138-65-021A	\$233.17
138-35-046	\$234.61
138-66-017	\$235.56
138-47-062A	\$236.90
138-66-083	\$241.64
138-52-010	\$244.34
138-42-004	\$245.28
138-47-052	\$245.87
138-59-011A	\$246.83
138-47-029C	\$251.22
138-63-011	\$252.46
138-66-013	\$252.89
138-41-008	\$254.20
138-52-042	\$255.72
138-55-003	\$257.70
138-47-032	\$258.11
138-54-006	\$258.92
138-42-008C	\$260.66
138-54-008A	\$262.66
138-54-024	\$264.60
138-54-002	\$268.49
138-54-005	\$269.05

138-53-039	\$269.51
138-41-013B	\$271.62
138-35-044	\$271.90
138-57-021E	\$272.04
138-51-021	\$277.25
138-48-032A	\$277.28
138-35-017	\$278.03
138-50-010	\$279.07
138-57-006A	\$281.02
138-52-041B	\$283.90
138-35-047	\$284.10
138-53-041	\$287.48
138-53-038	\$287.54
138-55-017	\$288.46
138-64-034	\$290.99
138-54-023B	\$293.23
138-64-020	\$293.66
138-42-040	\$294.88
138-45-028	\$296.79
138-41-016A	\$303.78
138-42-003	\$304.20
138-47-062B	\$304.48
138-54-023A	\$306.65
138-48-030A	\$308.63
138-42-012D	\$312.17
138-50-003B	\$314.99
138-59-025A	\$320.48
138-64-035	\$320.93
138-58-036	\$323.15
138-49-025	\$325.35
138-56-046	\$328.56
138-64-036	\$329.84
138-52-047A	\$330.50
138-42-043	\$333.13
138-41-030	\$336.66
138-42-006	\$336.93
138-57-013A	\$337.62
138-41-016B	\$337.78
138-41-016C	\$339.88
138-59-027	\$350.82
138-57-015	\$354.04
138-41-006	\$357.31
138-36-015	\$358.55
138-42-019	\$361.73
138-41-014B	\$361.78
138-47-001A	\$363.23
138-59-029	\$367.50
138-54-027	\$370.20
138-55-016A	\$371.82
138-48-004A	\$374.50
138-54-036	\$375.01
138-51-031	\$377.84



138-41-022	\$383.08
138-33-014A	\$385.26
138-55-002	\$385.53
138-54-010	\$387.78
138-36-013	\$390.10
138-43-012A	\$390.34
138-57-036	\$396.30
138-43-014F	\$398.11
138-52-021A	\$398.85
138-54-003	\$399.29
138-35-014A	\$400.35
138-42-036	\$408.93
138-53-008	\$409.38
138-36-023	\$416.89
138-35-031	\$417.76
138-64-028	\$420.12
138-64-023	\$420.24
138-41-012A	\$420.40
138-64-025	\$420.46
138-42-035	\$423.68
138-66-023	\$425.83
138-65-019A	\$426.12
138-57-045A	\$426.75
138-42-013B	\$431.58
138-41-001	\$435.00
138-41-028	\$435.48
138-41-031	\$435.54
138-43-003	\$438.00
138-36-007B	\$439.14
138-36-017	\$442.55
138-47-024	\$443.58
138-51-017	\$445.40
138-57-055	\$449.13
138-52-004A	\$449.78
138-42-031	\$451.25
138-57-005	\$452.45
138-54-015	\$452.90
138-66-079	\$454.94
138-35-024	\$464.85
138-41-021C	\$469.49
138-46-034	\$474.10
138-54-017	\$475.35
138-47-004G	\$476.75
138-47-023B	\$481.35
138-48-025A	\$483.64
138-59-052	\$484.00
138-41-027	\$485.59
138-36-002	\$487.06
138-45-029	\$487.39
138-42-037	\$487.63
138-59-047	\$490.85
138-42-005	\$498.54

138-46-050	\$500.88
138-46-052	\$502.20
138-47-003A	\$502.31
138-46-030	\$505.03
138-59-051	\$508.36
138-65-017	\$514.52
138-41-002	\$516.96
138-42-047	\$517.13
138-43-004	\$525.60
138-42-012C	\$532.56
138-41-020A	\$533.25
138-41-003	\$538.08
138-64-024	\$544.80
138-46-047B	\$544.92
138-55-009	\$544.95
138-64-022	\$546.60
138-41-019B	\$550.73
138-45-004A	\$553.60
138-42-012A	\$556.50
138-48-039	\$560.27
138-35-045	\$561.60
138-57-037	\$563.63
138-35-018	\$565.93
138-31-044	\$567.73
138-31-011	\$570.32
138-41-018A	\$571.80
138-54-016	\$580.56
138-35-042	\$581.55
138-31-036A	\$586.19
138-54-025	\$586.79
138-31-001C	\$588.95
138-46-043	\$590.42
138-46-031	\$593.94
138-34-014	\$595.24
138-48-029A	\$597.63
138-36-004	\$598.54
138-62-074B	\$599.23
138-46-027E	\$599.80
138-57-047	\$601.84
138-53-021	\$607.71
138-43-001	\$613.20
138-38-012	\$615.57
138-57-001A	\$616.46
138-48-038	\$619.11
138-45-027A	\$620.02
138-66-024	\$621.70
138-66-006	\$623.80
138-52-046	\$625.34
138-41-014A	\$628.12
138-42-038	\$633.33
138-61-091B	\$636.61
138-55-001	\$637.75

138-36-029A	\$641.22
138-34-004B	\$642.64
138-36-018	\$647.26
138-64-010	\$647.53
138-41-010	\$647.64
138-57-023	\$647.86
138-41-021B	\$652.21
138-47-043A	\$652.48
138-65-014	\$653.03
138-64-007	\$657.84
138-46-037	\$660.16
138-41-021E	\$662.66
138-57-011A	\$662.98
138-54-040	\$662.99
138-54-030	\$663.56
138-43-008	\$663.94
138-41-011	\$668.25
138-54-046	\$674.30
138-57-035	\$678.99
138-65-020A	\$679.57
138-38-011	\$692.57
138-54-045	\$703.88
138-53-034	\$705.98
138-59-044	\$706.46
138-35-026A	\$711.17
138-42-042	\$722.76
138-35-038	\$726.00
138-54-047	\$731.45
138-44-039	\$732.87
138-35-039	\$737.59
138-54-049E	\$740.85
138-35-013	\$743.10
138-48-003A	\$743.21
138-41-007C	\$754.50
138-45-031	\$769.17
138-36-005	\$771.40
138-54-048	\$773.75
138-35-030	\$776.62
138-36-012	\$777.92
138-33-018	\$791.44
138-42-033	\$803.21
138-42-039A	\$817.58
138-38-010B	\$817.91
138-55-021	\$828.57
138-55-004	\$829.80
138-64-018A	\$838.57
138-36-020A	\$843.09
138-53-020	\$849.83
138-64-005	\$850.67
138-58-003	\$862.72
138-41-009A	\$868.20
138-66-026A	\$868.92

138-55-011	\$874.30
138-33-020A	\$875.06
138-54-043	\$883.46
138-66-007A	\$890.54
138-64-021	\$894.22
138-38-014	\$906.61
138-55-040A	\$914.41
138-42-051A	\$927.33
138-58-013	\$927.39
138-59-021C	\$928.55
138-59-026	\$942.09
138-41-021F	\$943.83
138-43-021	\$943.99
138-48-027B	\$945.47
138-55-034	\$949.17
138-34-013C	\$970.31
138-35-029	\$974.05
138-38-010A	\$979.34
138-54-042	\$980.25
138-42-046	\$980.86
138-35-019	\$985.36
138-55-041B	\$988.24
138-64-027	\$1,010.72
138-45-026	\$1,011.49
138-38-026	\$1,029.77
138-66-090	\$1,036.56
138-36-006A	\$1,045.33
138-35-008	\$1,050.72
138-42-029	\$1,066.67
138-64-030	\$1,069.48
138-35-023	\$1,075.40
138-41-009B	\$1,083.56
138-42-022	\$1,117.29
138-42-048	\$1,127.77
138-64-003	\$1,152.92
138-42-017	\$1,176.71
138-54-051	\$1,177.53
138-55-019	\$1,195.55
138-54-049B	\$1,205.50
138-59-032	\$1,225.60
138-47-064D	\$1,236.26
138-54-044	\$1,237.67
138-43-020A	\$1,238.81
138-66-029A	\$1,247.48
138-44-038	\$1,258.47
138-54-039	\$1,271.29
138-41-025	\$1,274.38
138-39-014C	\$1,290.42
138-54-014A	\$1,301.54
138-64-006	\$1,320.73
138-35-016	\$1,323.78
138-36-001A	\$1,325.36

138-55-042A	\$1,341.19
138-58-009	\$1,383.50
138-49-970A	\$1,411.37
138-36-010	\$1,422.78
138-36-008A	\$1,466.02
138-35-048	\$1,488.10
138-54-038	\$1,514.36
138-43-005	\$1,515.08
138-36-003	\$1,533.35
138-42-026A	\$1,539.98
138-42-016	\$1,553.84
138-52-006E	\$1,557.23
138-42-025	\$1,569.85
138-35-009A	\$1,607.99
138-41-029	\$1,681.32
138-42-023A	\$1,724.56
138-33-002	\$1,759.49
138-64-004	\$1,764.62
138-38-013	\$1,778.54
138-51-014A	\$1,845.54
138-41-019A	\$1,849.25
138-60-002B	\$1,849.91
138-61-096B	\$1,876.74
138-54-041	\$1,942.64
138-64-002	\$1,961.79
138-41-004	\$2,007.07
138-31-039B	\$2,029.46
138-52-001A	\$2,029.73
138-42-030	\$2,039.54
138-41-023	\$2,087.51
138-61-092	\$2,139.68
138-43-010A	\$2,174.26
138-43-019	\$2,174.66
138-55-005A	\$2,203.77
138-36-014	\$2,241.81
138-35-032	\$2,319.00
138-41-024	\$2,367.72
138-64-001B	\$2,464.17
138-54-049D	\$2,475.49
138-36-970	\$2,567.15
138-55-023A	\$2,666.67
138-66-028A	\$2,761.56
138-42-020	\$2,767.13
138-54-050	\$2,788.40
138-35-015	\$2,821.84
138-43-018A	\$2,827.51
138-37-002	\$2,950.96
138-43-015B	\$3,141.91
138-31-039A	\$3,205.87
138-61-041A	\$3,328.46
138-36-033A	\$3,347.27
138-41-026	\$3,425.52

138-36-019A	\$3,527.99
138-38-015A	\$3,547.03
138-43-028B	\$3,590.90
138-66-012A	\$3,777.43
138-64-001C	\$4,224.08
138-65-006B	\$4,292.39
138-43-032D	\$4,575.71
138-55-025B	\$5,036.00
138-55-022D	\$5,207.58
138-42-018	\$5,936.81
138-32-012A	\$6,751.78
138-61-081C	\$8,234.24
138-39-018C	\$9,322.20
138-34-029G	\$278.05
138-34-040	\$13.20
138-44-050	\$1,100.84
138-53-026E	\$3,327.09
<b>Total</b>	<b>\$371,373.11</b>

## EXHIBIT C

### Total Cost of Annual Expenses

#### Mesa Town Center Improvement District No. 228

#### **FY 2024 / 2025 ESTIMATED COST OF EXPENSES**

#### **EXPENSES ESTIMATED COST\***

Administrative Salaries/Retirement/Benefits	\$171,000.00
Clean Sweep Ambassador Staffing Costs	\$99,640.61
Rent	\$1.00
Utilities	\$4,000.00
Telephones	\$1,000.00
Building, Liability, D&O Insurance	\$4,500.00
Repairs and Maintenance	\$5,500.00
Equipment	\$1,000.00
Printing/Publishing	\$1,000.00
Postage	\$300.00
Supplies	\$2,000.00
Vehicles Costs	\$3,710.11
Conferences/Seminars	\$2,000.00
Dues/Subscriptions	\$300.00
Taxes/Licenses	\$400.00
Promotions/Marketing/Advertising	\$25,000.00
Weed Control & graffiti Abatement	\$5,000.00
Business Development	\$10,021.39
Pressure Washing	\$10,000.00
Events	\$25,000.00
<b>TOTAL BUDGET</b>	<b>\$371,373.11</b>

\*Estimated cost of contract as part of overall Downtown Mesa Association budget.  
Figures relate only to the SID Assessment not reflecting overall assessments and other City Contract related expenses.