

SUPERSTITION SPRINGS CENTER - CSP MODIFICATION
SITE AND SIGN LOCATION PLAN

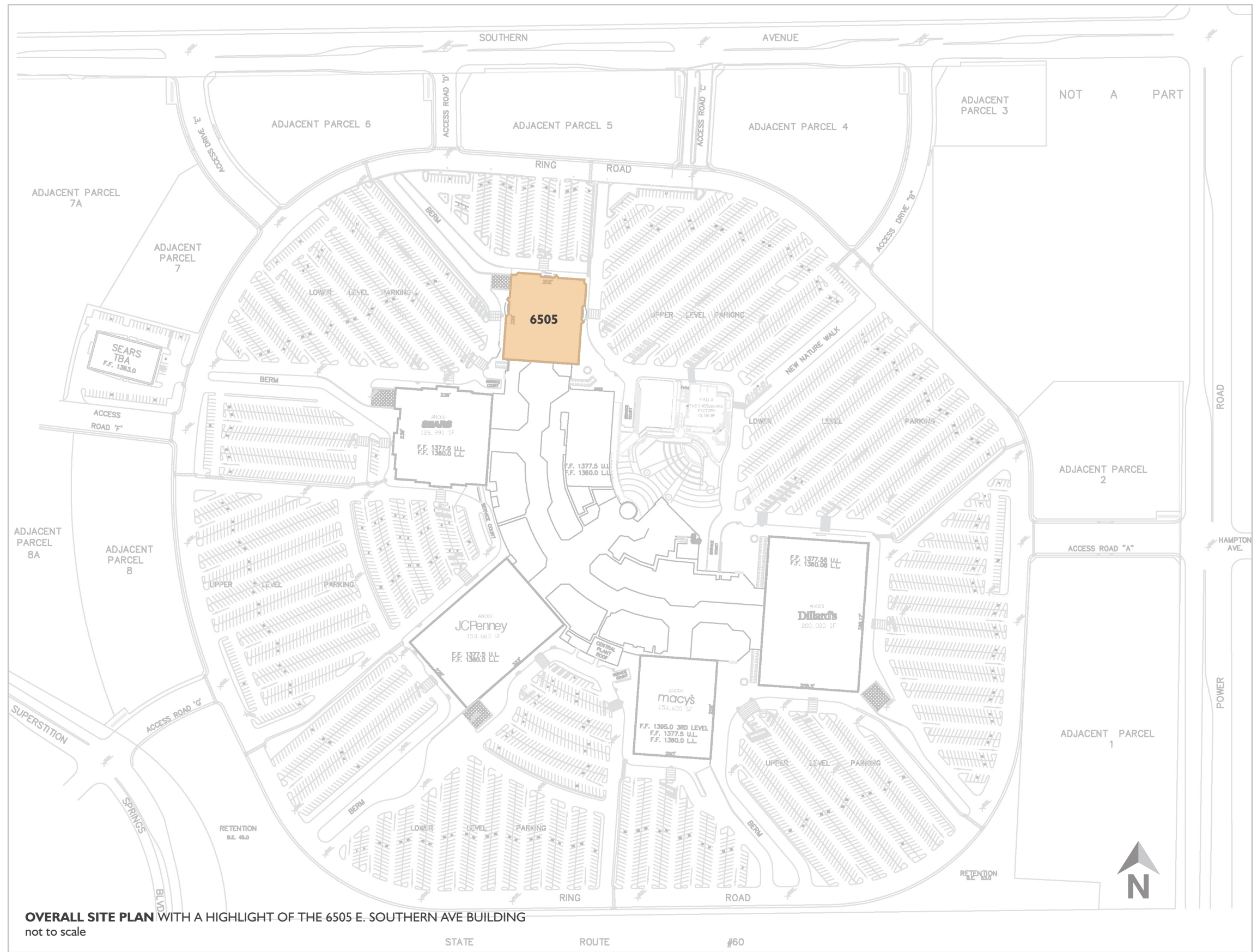

OVERALL SITE PLAN WITH A HIGHLIGHT OF THE 6505 E. SOUTHERN AVE BUILDING
 not to scale

STATE ROUTE #60

THINKING CAPS DESIGN p 602.495.1260 1425 north first street, suite 101 phoenix, arizona 85004 thinkingcaps.net

project:
 SUPERSTITION SPRINGS CENTER
 CSP MODIFICATION
 EXTERIOR BUILDING SIGNAGE

drawing type:
Design Development

start date:
04|22|2019

revisions:

sign type/name:
 SITE AND SIGN
 LOCATION
 PLAN

sheet: **1.01**

© 2019 Thinking Caps

client:
MACERICH[®]