

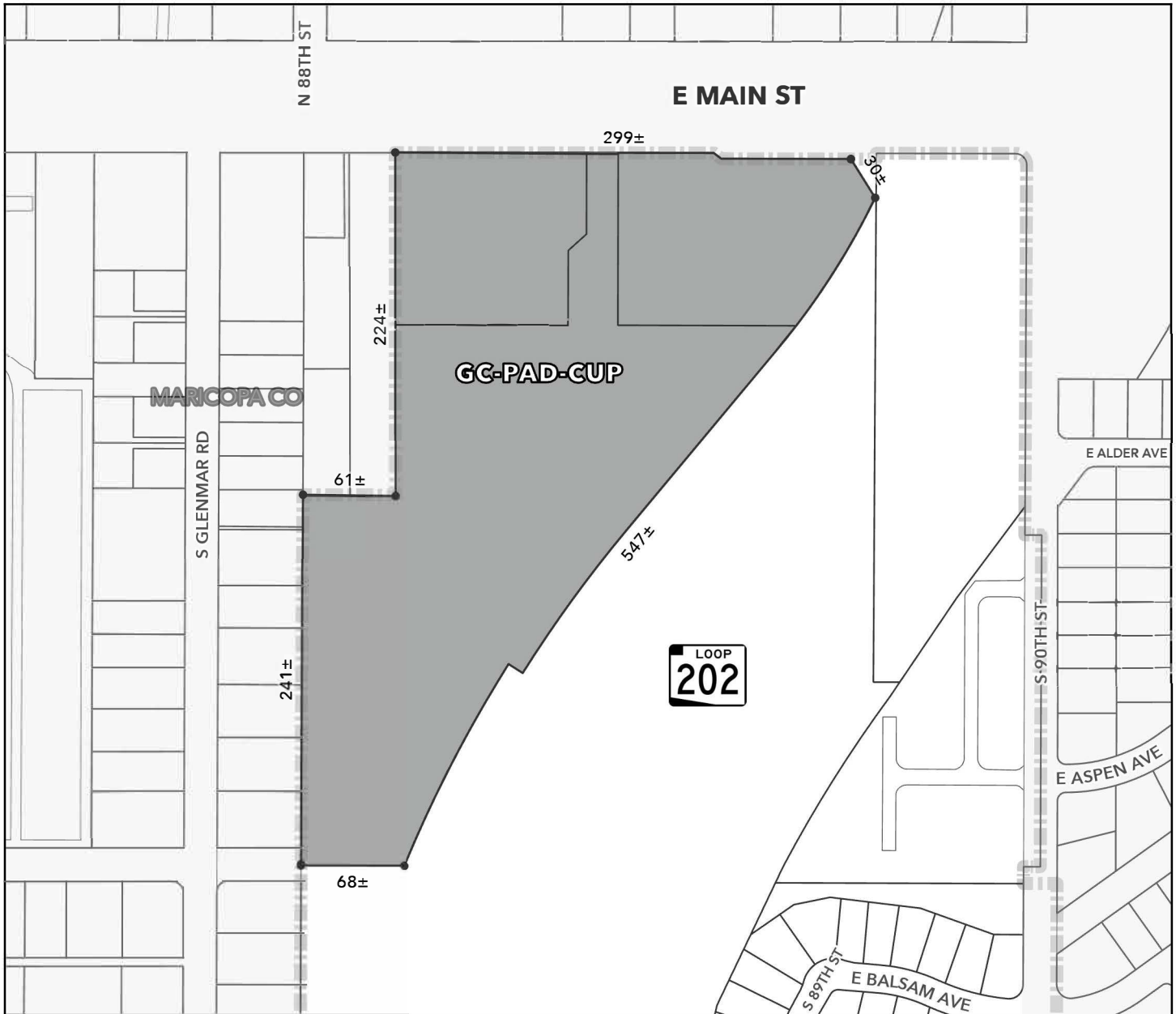

OFFICIAL SUPPLEMENTARY ZONING MAP AMENDING THE CITY OF MESA ZONING MAP



CASE: ZON24-00525

ACREAGE: 15.5±

REQUEST: Rezone from General Commercial with Planned Area Development Overlay (GC-PAD) to GC with a new PAD Overlay, Site Plan Review and Council Use Permit (CUP). This request will allow for a 58,845± square foot Boat and RV Storage facility.

ORDINANCE: _____

Please be advised that the attached zoning changes were approved by the Mesa City Council on January 26 , 2026 by Ordinance #6000. If you have any questions concerning these changes, contact the City of Mesa Planning Division at 480-644-2385.

MAYOR

ATTEST: _____
CITY CLERK

DATE: _____