

This document, together with the concepts and designs presented herein, as an instrument of service, is intended only for the specific purpose and client for which it was prepared. Reuse of and improper reliance on this document without written authorization and adaptation by Kimley-Horn and Associates, Inc. shall be without liability to Kimley-Horn and Associates, Inc.

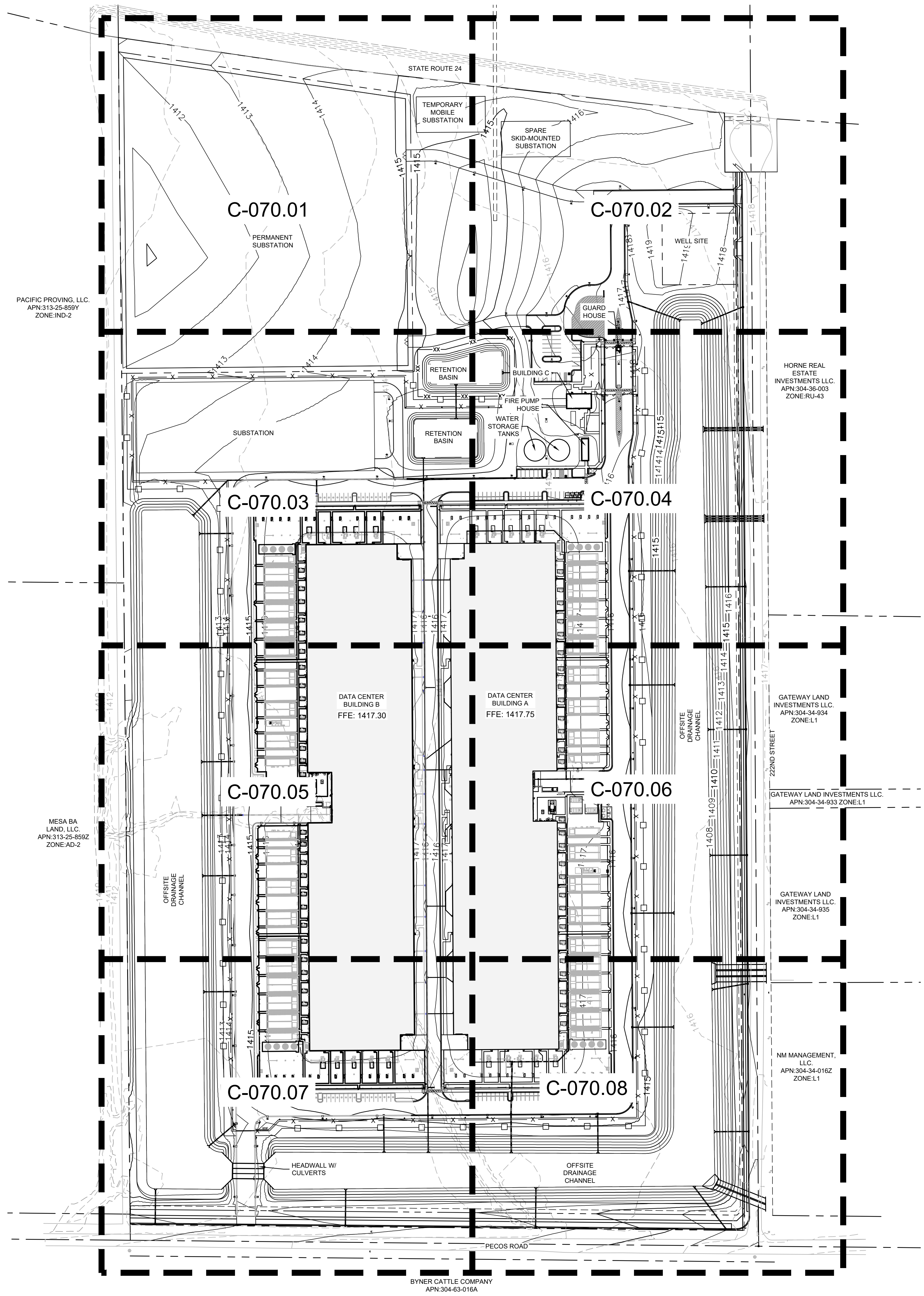

Sheet Number	Sheet Title
C-070.00	OVERALL GRADING PLAN
C-070.01	GRADING AND DRAINAGE PLAN (1 OF 8)
C-070.02	GRADING AND DRAINAGE PLAN (2 OF 8)
C-070.03	GRADING AND DRAINAGE PLAN (3 OF 8)
C-070.04	GRADING AND DRAINAGE PLAN (4 OF 8)
C-070.05	GRADING AND DRAINAGE PLAN (5 OF 8)
C-070.06	GRADING AND DRAINAGE PLAN (6 OF 8)
C-070.07	GRADING AND DRAINAGE PLAN (7 OF 8)
C-070.08	GRADING AND DRAINAGE PLAN (8 OF 8)
C-070.09	GRADING SECTIONS

Kimley»Horn
 © 2023 KIMLEY-HORN AND ASSOCIATES, INC.
 7740 N 16TH ST, SUITE 300
 PHOENIX, AZ 85020
 WWW.KIMLEY-HORN.COM

CONFIDENTIAL

PROJECT ADDRESS
 10464 E PECOS ROAD
 MESA, ARIZONA

PROJECT DELIVERY PACKAGE
 SITE PLAN REVIEW

SEAL/SIGNATURE

NOT FOR CONSTRUCTION

THE LICENSED PROFESSIONAL SEAL AFFIXED TO THIS SHEET APPLIES ONLY TO THE MATERIAL AND ITEMS SHOWN ON THIS SHEET. ALL DRAWINGS, INSTRUMENTS OR OTHER DOCUMENTS NOT EXHIBITING THIS SEAL SHALL NOT BE CONSIDERED PREPARED BY THIS PROFESSIONAL, AND THIS PROFESSIONAL EXPRESSLY DISCLAIMS ANY AND ALL RESPONSIBILITY FOR SUCH PLAN, DRAWINGS OR DOCUMENTS NOT EXHIBITING THIS SEAL.

REV.	DATE	DESCRIPTION
1	11DEC2023	SITE PLAN REVIEW
2	12FEB2024	SITE PLAN REVIEW: RESPONSE TO CITY COMMENTS

CONFIDENTIAL
 ANY UNAUTHORIZED USE OR REPRODUCTION OF THIS DOCUMENT IN WHOLE OR IN PART IS PROHIBITED. DELETE THIS DOCUMENT IF YOU HAVE RECEIVED IT IN ERROR.

MECHANICAL ENGINEER:
 SWANSON RINK
 MECHANICAL EOR
 (303) 832-2666
 1120 LINCOLN ST.
 STE 1200
 DENVER, CO 80203

CIVIL ENGINEER:
 KIMLEY-HORN
 CHARLES WURL
 (602) 944-5500
 7740 N 16TH ST, STE 300
 PHOENIX, AZ 85020

ARCHITECT:
 GENSLER
 PATRICK MAGNESS
 (602) 523-4900
 2575 E CAMELBACK RD STE 175
 PHOENIX, AZ 85016

TELECOM ENGINEER:
 SWANSON RINK
 THAINA GLASSEN
 (303) 832-2666
 1120 LINCOLN ST.
 STE 1200
 DENVER, CO 80203

LANDSCAPE ARCHITECT:
 KIMLEY-HORN
 ANDREW VALESTIN
 (602) 906-1103
 7740 N 16TH ST, STE 300
 PHOENIX, AZ 85020

PROJECT:
 DATA CENTER - 10464 E PECOS ROAD
 TITLE:
OVERALL GRADING PLAN
 DRAWING:
C-070.00
 PAPER SIZE: ARCH D SCALE: AGILE NO: REV: 1

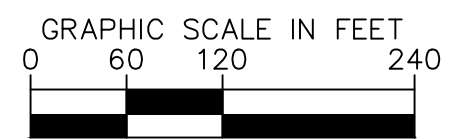
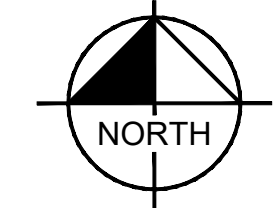

This document, together with the concepts and designs presented herein, as an instrument of service, is intended only for the specific purpose and client for which it was prepared. Reuse of and improper reliance on this document without written authorization and adaptation by Kimley-Horn and Associates, Inc. shall be without liability to Kimley-Horn and Associates, Inc.

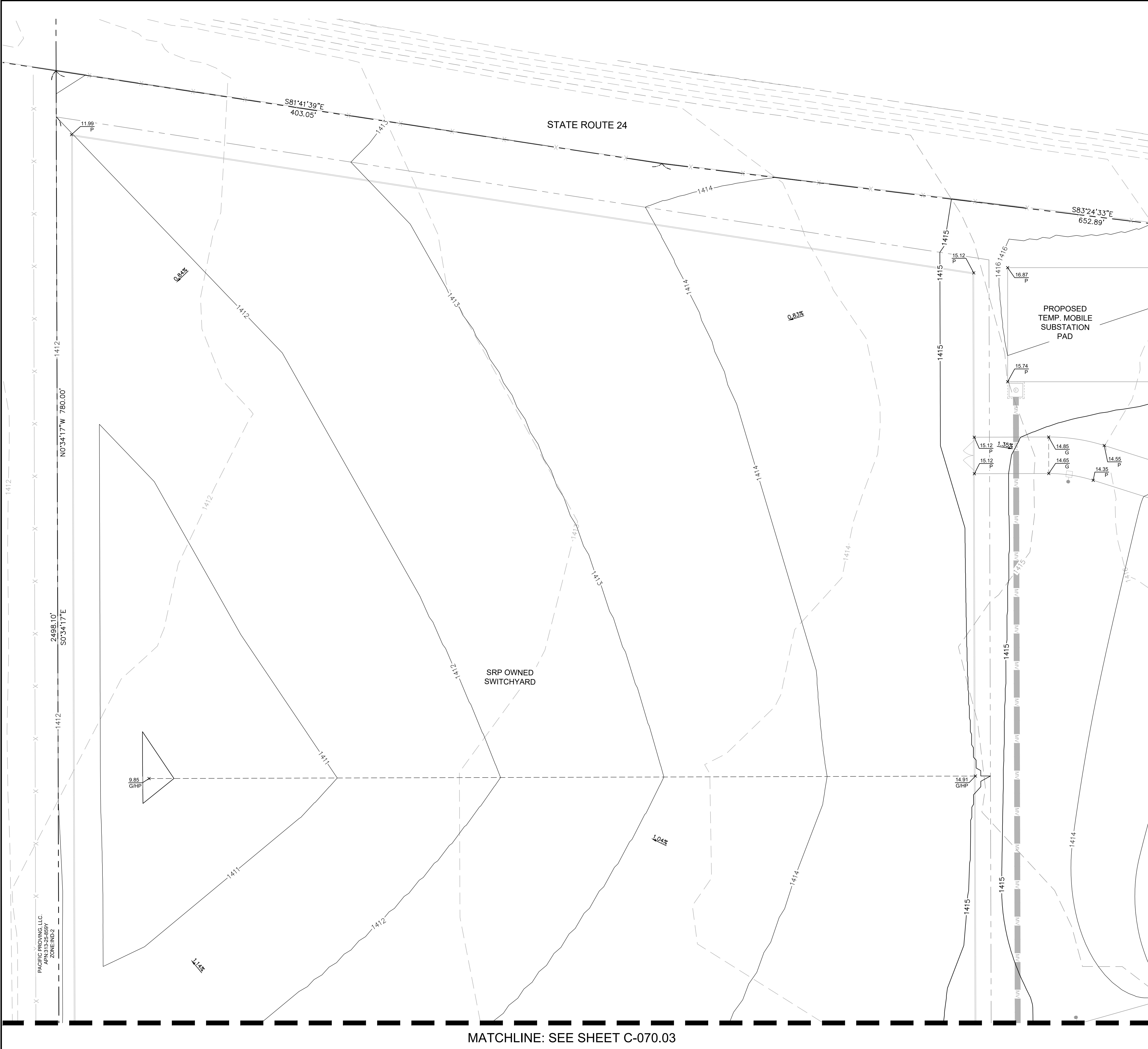

NOTES

1. ALL EXISTING UTILITY LOCATIONS SHOWN HEREIN ARE APPROXIMATE ONLY. IT SHALL BE THE CONTRACTOR'S RESPONSIBILITY TO DETERMINE THE EXACT VERTICAL AND HORIZONTAL LOCATION OF ALL EXISTING UNDERGROUND UTILITIES PRIOR TO COMMENCING CONSTRUCTION. NO REPRESENTATION IS MADE THAT ALL UTILITIES ARE SHOWN HEREON. THE ENGINEER ASSUMES NO RESPONSIBILITY FOR UTILITIES NOT SHOWN OR UTILITIES NOT SHOWN IN THEIR PROPER LOCATION.
2. ALL ABOVE GROUND UTILITY APPURTENANCES SHALL BE ADJUSTED TO MATCH PROPOSED FINISHED GRADE ELEVATIONS.
3. ALL FG SPOT ELEVATIONS ALONG PROPOSED CURB ARE BOTTOM FACE OF CURB ELEVATIONS.

ABBREVIATIONS

15.00 P	FINISHED GRADE SPOT ELEVATION
15.00 FF	FINISHED FLOOR SPOT ELEVATION
15.00 SW	SIDEWALK SPOT ELEVATION
15.00 G	GRADE BRAKE SPOT ELEVATION
15.00 HP	HIGH POINT SPOT ELEVATION
15.00 LP	LOW POINT SPOT ELEVATION

LEGEND

---	PROPERTY LINE
- - - -	EXISTING MAJOR CONTOUR
- - - -	EXISTING MINOR CONTOUR
- - - -	PROPOSED MAJOR CONTOUR
- - - -	PROPOSED MINOR CONTOUR
- - - -	EXISTING OVERHEAD POWER LINE
- - - -	EXISTING STORM DRAIN LINE
- - - -	PROPOSED STORM DRAIN LINE
- - - -	GRADE BREAK

MATCHLINE: SEE SHEET C-070.02

KEYMAP

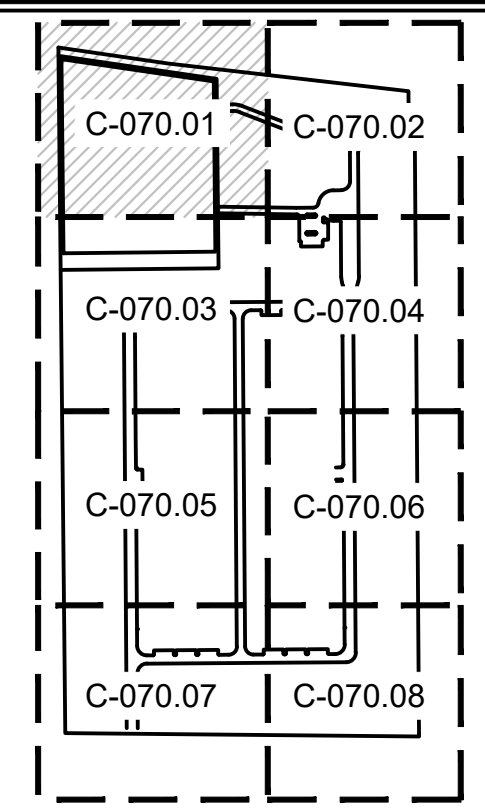

Kimley»Horn
 © 2023 KIMLEY-HORN AND ASSOCIATES, INC.
 7740 N 16TH ST, SUITE 300
 PHOENIX, AZ 85020
 WWW.KIMLEY-HORN.COM

CONFIDENTIAL

PROJECT ADDRESS
 10464 E PECOS ROAD
 MESA, ARIZONA

PROJECT DELIVERY PACKAGE
 SITE PLAN REVIEW

SEAL/SIGNATURE

NOT FOR CONSTRUCTION

THE LICENSED PROFESSIONAL SEAL AFFIXED TO THIS SHEET APPLIES ONLY TO THE MATERIAL AND ITEMS SHOWN ON THIS SHEET. ALL DRAWINGS, INSTRUMENTS OR OTHER DOCUMENTS NOT EXHIBITING THIS SEAL SHALL NOT BE CONSIDERED PREPARED BY THIS PROFESSIONAL, AND THIS PROFESSIONAL EXPRESSLY DISCLAIMS ANY AND ALL RESPONSIBILITY FOR SUCH PLAN, DRAWINGS OR DOCUMENTS NOT EXHIBITING THIS SEAL.

ISSUE DATE:	12FEB2024	PROJECT NO:	78 3116.000
DESIGNED:	GENSLER	ARCHITECT:	PATRICK MAGNESS
REV.	DATE	DESCRIPTION	
1	11DEC2023	SITE PLAN REVIEW	
2	12FEB2024	SITE PLAN REVIEW RESPONSE TO CITY COMMENTS	

CONFIDENTIAL
 ANY UNAUTHORIZED USE OR REPRODUCTION OF THIS DOCUMENT IN WHOLE OR IN PART IS PROHIBITED. DELETE THIS DOCUMENT IF YOU HAVE RECEIVED IT IN ERROR.

MECHANICAL ENGINEER: SWANSON RINK MECHANICAL EOR (303) 832-2666 1120 LINCOLN ST. STE 1200 DENVER, CO 80203	ELECTRICAL ENGINEER: SWANSON RINK ELECTRICAL EOR (303) 832-2666 1120 LINCOLN ST. STE 1200 DENVER, CO 80203
--	--

CIVIL ENGINEER: KIMLEY-HORN CHARLES WURL (602) 944-5500 7740 N 16TH ST, STE 300 PHOENIX, AZ 85020	STRUCTURAL ENGINEER: S.A. MIRO, INC. STRUCTURAL EOR (303) 741-5737 4582 S ULLSTER ST. STE 750 DENVER, CO 80237
--	--

ARCHITECT: GENSLER PATRICK MAGNESS (602) 523-4900 2575 E CAMELBACK RD STE 175 PHOENIX, AZ 85016	SECURITY ENGINEER: SWANSON RINK MICHAEL GHEZZI (303) 832-2666 1120 LINCOLN ST. STE 1200 DENVER, CO 80203
--	--

TELECOM ENGINEER: SWANSON RINK THAINA GLASSEN (303) 832-2666 1120 LINCOLN ST. STE 1200 DENVER, CO 80203	LANDSCAPE ARCHITECT: KIMLEY-HORN ANDREW VALESTIN (602) 906-1103 7740 N 16TH ST, STE 300 PHOENIX, AZ 85020
---	--

PROJECT:
DATA CENTER - 10464 E PECOS ROAD
 TITLE: **GRADING AND DRAINAGE PLAN (1 OF 8)**

DRAWING:	C-070.01
PAPER SIZE:	ARCH D
SCALE:	
AGILE NO:	
REV:	1

MATCHLINE: SEE SHEET C-070.03

This document, together with the concepts and designs presented herein, as an instrument of service, is intended only for the specific purpose and client for which it was prepared. Reuse of and improper reliance on this document without written authorization and adaptation by Kimley-Horn and Associates, Inc. shall be without liability to Kimley-Horn and Associates, Inc.

MATCHLINE: SEE SHEET C-070.01

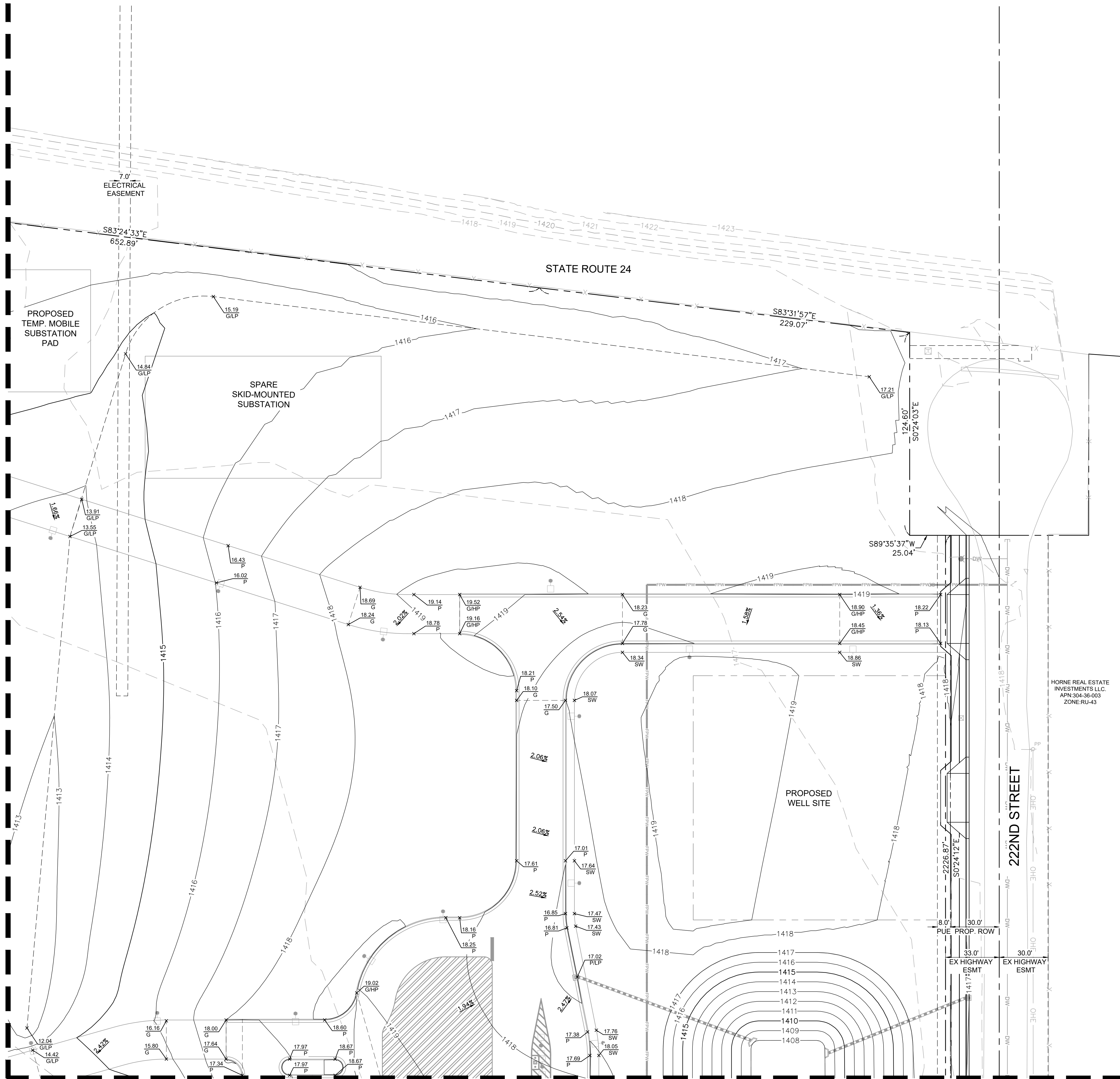

MATCHLINE: SEE SHEET C-070.03

NOTES

1. ALL EXISTING UTILITY LOCATIONS SHOWN HEREIN ARE APPROXIMATE ONLY. IT SHALL BE THE CONTRACTOR'S RESPONSIBILITY TO DETERMINE THE EXACT VERTICAL AND HORIZONTAL LOCATION OF ALL EXISTING UNDERGROUND UTILITIES PRIOR TO COMMENCING CONSTRUCTION. NO REPRESENTATION IS MADE THAT ALL UTILITIES ARE SHOWN HEREON. THE ENGINEER ASSUMES NO RESPONSIBILITY FOR UTILITIES NOT SHOWN OR UTILITIES NOT SHOWN IN THEIR PROPER LOCATION.
2. ALL ABOVE GROUND UTILITY APPURTENANCES SHALL BE ADJUSTED TO MATCH PROPOSED FINISHED GRADE ELEVATIONS.
3. ALL FG SPOT ELEVATIONS ALONG PROPOSED CURB ARE BOTTOM FACE OF CURB ELEVATIONS.

ABBREVIATIONS

15.00 P	FINISHED GRADE SPOT ELEVATION
15.00 FF	FINISHED FLOOR SPOT ELEVATION
15.00 SW	SIDEWALK SPOT ELEVATION
15.00 G	GRADE BRAKE SPOT ELEVATION
15.00 HP	HIGH POINT SPOT ELEVATION
15.00 LP	LOW POINT SPOT ELEVATION

LEGEND

---	PROPERTY LINE
- - - - -	EXISTING MAJOR CONTOUR
- · - · -	EXISTING MINOR CONTOUR
---	PROPOSED MAJOR CONTOUR
- · - · -	PROPOSED MINOR CONTOUR
---	EXISTING OVERHEAD POWER LINE
---	EXISTING STORM DRAIN LINE
---	PROPOSED STORM DRAIN LINE
---	GRADE BREAK

KEYMAP

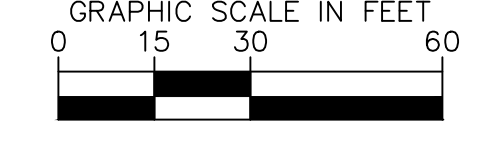
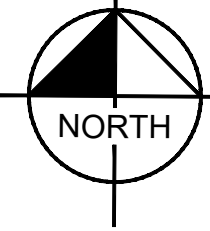
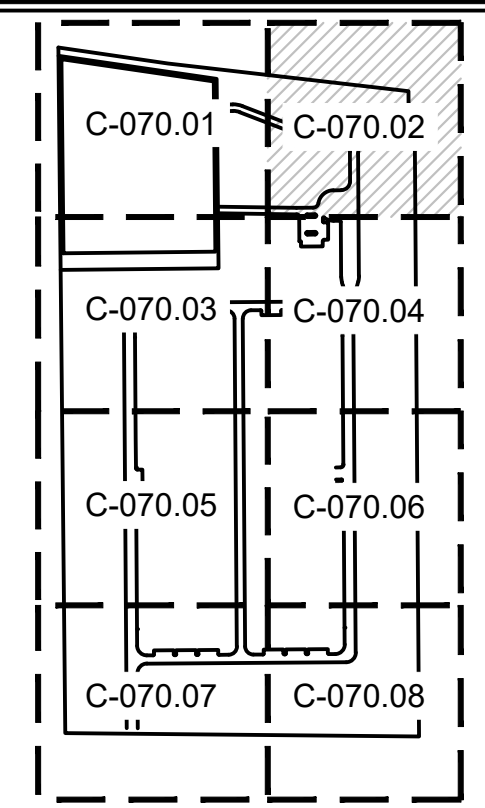

Kimley-Horn
 © 2023 KIMLEY-HORN AND ASSOCIATES, INC.
 7740 N 16TH ST, SUITE 300
 PHOENIX, AZ 85020
 WWW.KIMLEY-HORN.COM

CONFIDENTIAL

PROJECT ADDRESS
 10464 E PECOS ROAD
 MESA, ARIZONA

PROJECT DELIVERY PACKAGE
 SITE PLAN REVIEW

SEAL/SIGNATURE

NOT FOR CONSTRUCTION

THE LICENSED PROFESSIONAL SEAL AFFIXED TO THIS SHEET APPLIES ONLY TO THE MATERIAL AND ITEMS SHOWN ON THIS SHEET. ALL DRAWINGS, INSTRUMENTS OR OTHER DOCUMENTS NOT EXHIBITING THIS SEAL SHALL NOT BE CONSIDERED PREPARED BY THIS PROFESSIONAL, AND THIS PROFESSIONAL EXPRESSLY DISCLAIMS ANY AND ALL RESPONSIBILITY FOR SUCH PLAN, DRAWINGS OR DOCUMENTS NOT EXHIBITING THIS SEAL.

ISSUE DATE:	12FEB2024	PROJECT NO.:	78.3116.000
DESIGNED:	ARCHITECT: PATRICK MAGNESS	ENGINEER:	GENSLENER
REV.	DATE	DESCRIPTION	
1	11DEC2023	SITE PLAN REVIEW	
2	12FEB2024	SITE PLAN REVIEW RESPONSE TO CITY COMMENTS	

CONFIDENTIAL
 ANY UNAUTHORIZED USE OR REPRODUCTION OF THIS DOCUMENT IN WHOLE OR IN PART IS PROHIBITED. DELETE THIS DOCUMENT IF YOU HAVE RECEIVED IT IN ERROR.

MECHANICAL ENGINEER: SWANSON RINK MECHANICAL EOR (303) 832-2666 1120 LINCOLN ST. STE 1200 DENVER, CO 80203	ELECTRICAL ENGINEER: SWANSON RINK ELECTRICAL EOR (303) 832-2666 1120 LINCOLN ST. STE 1200 DENVER, CO 80203
--	--

CIVIL ENGINEER: KIMLEY-HORN CHARLES WURL (602) 944-5500 7740 N 16TH ST, STE 300 PHOENIX, AZ 85020	STRUCTURAL ENGINEER: S.A. MIRO, INC. STRUCTURAL EOR (602) 741-3737 4582 S ULSTER ST. STE 750 DENVER, CO 80237
--	---

ARCHITECT: GENSLENER PATRICK MAGNESS (602) 523-4900 2575 E CAMELBACK RD STE 175 PHOENIX, AZ 85016	SECURITY ENGINEER: SWANSON RINK MICHAEL GHEZZI (303) 832-2666 1120 LINCOLN ST. STE 1200 DENVER, CO 80203
--	--

TELECOM ENGINEER: SWANSON RINK THAINA GLASSEN (303) 832-2666 1120 LINCOLN ST. STE 1200 DENVER, CO 80203	LANDSCAPE ARCHITECT: KIMLEY-HORN ANDREW VALESTIN (602) 906-1103 7740 N 16TH ST, STE 300 PHOENIX, AZ 85020
---	--

PROJECT:
DATA CENTER - 10464 E PECOS ROAD

TITLE: **GRADING AND DRAINAGE PLAN (2 OF 8)**

DRAWING:	C-070.02
PAPER SIZE:	ARCH D
SCALE:	AGILE NO.:
REV:	1

MATCHLINE: SEE SHEET C-070.01

NOTES

1. ALL EXISTING UTILITY LOCATIONS SHOWN HEREIN ARE APPROXIMATE ONLY. IT SHALL BE THE CONTRACTOR'S RESPONSIBILITY TO DETERMINE THE EXACT VERTICAL AND HORIZONTAL LOCATION OF ALL EXISTING UNDERGROUND UTILITIES PRIOR TO COMMENCING CONSTRUCTION. NO REPRESENTATION IS MADE THAT ALL UTILITIES ARE SHOWN HEREON. THE ENGINEER ASSUMES NO RESPONSIBILITY FOR UTILITIES NOT SHOWN OR UTILITIES NOT SHOWN IN THEIR PROPER LOCATION.
2. ALL ABOVE GROUND UTILITY APPURTENANCES SHALL BE ADJUSTED TO MATCH PROPOSED FINISHED GRADE ELEVATIONS.
3. ALL FG SPOT ELEVATIONS ALONG PROPOSED CURB ARE BOTTOM FACE OF CURB ELEVATIONS.

ABBREVIATIONS

15.00 P	FINISHED GRADE SPOT ELEVATION
15.00 FF	FINISHED FLOOR SPOT ELEVATION
15.00 SW	SIDEWALK SPOT ELEVATION
15.00 G	GRADE BRAKE SPOT ELEVATION
15.00 HP	HIGH POINT SPOT ELEVATION
15.00 LP	LOW POINT SPOT ELEVATION

LEGEND

---	PROPERTY LINE
- - - -	EXISTING MAJOR CONTOUR
- - - -	EXISTING MINOR CONTOUR
- - - -	PROPOSED MAJOR CONTOUR
- - - -	PROPOSED MINOR CONTOUR
- - - -	OHE
- - - -	EXISTING OVERHEAD POWER LINE
- - - -	EXISTING STORM DRAIN LINE
- - - -	PROPOSED STORM DRAIN LINE
- - - -	GRADE BREAK

Kimley»Horn
 © 2023 KIMLEY-HORN AND ASSOCIATES, INC.
 7740 N 16TH ST, SUITE 300
 PHOENIX, AZ 85020
 WWW.KIMLEY-HORN.COM

CONFIDENTIAL

PROJECT ADDRESS
 10464 E PECOS ROAD
 MESA, ARIZONA

PROJECT DELIVERY PACKAGE

SITE PLAN REVIEW

SEAL/SIGNATURE

NOT FOR CONSTRUCTION

THE LICENSED PROFESSIONAL SEAL AFFIXED TO THIS SHEET APPLIES ONLY TO THE MATERIAL AND ITEMS SHOWN ON THIS SHEET. ALL DRAWINGS, INSTRUMENTS OR OTHER DOCUMENTS NOT EXHIBITING THIS SEAL SHALL NOT BE CONSIDERED PREPARED BY THIS PROFESSIONAL, AND THIS PROFESSIONAL EXPRESSLY DISCLAIMS ANY AND ALL RESPONSIBILITY FOR SUCH PLAN, DRAWINGS OR DOCUMENTS NOT EXHIBITING THIS SEAL.

ISSUE DATE:	12FEB2024	PROJECT NO:	78 3116.000
DESIGNED:	ARCHITECT: PATRICK MAGNESS	GENSLER	
REV.	DATE	DESCRIPTION	
1	11DEC2023	SITE PLAN REVIEW	
2	12FEB2024	SITE PLAN REVIEW RESPONSE TO CITY COMMENTS	

CONFIDENTIAL
 ANY UNAUTHORIZED USE OR REPRODUCTION OF THIS DOCUMENT IN WHOLE OR IN PART IS PROHIBITED. DELETE THIS DOCUMENT IF YOU HAVE RECEIVED IT IN ERROR

MECHANICAL ENGINEER:	ELECTRICAL ENGINEER:
SWANSON RINK MECHANICAL EOR (303) 832-2666 1120 LINCOLN ST. STE 1200 DENVER, CO 80203	SWANSON RINK ELECTRICAL EOR (303) 832-2666 1120 LINCOLN ST. STE 1200 DENVER, CO 80203

CIVIL ENGINEER:	STRUCTURAL ENGINEER:
KIMLEY-HORN CHARLES WURL (602) 944-5500 7740 N 16TH ST, STE 300 PHOENIX, AZ 85020	S.A. MIRO, INC. STRUCTURAL EOR (602) 741-3737 4582 S ULLSTER ST. STE 750 DENVER, CO 80237

ARCHITECT:	SECURITY ENGINEER:
GENSLER PATRICK MAGNESS (602) 523-4900 2575 E CAMELBACK RD STE 175 PHOENIX, AZ 85016	SWANSON RINK MICHAEL GHEZZI (303) 832-2666 1120 LINCOLN ST. STE 1200 DENVER, CO 80203

TELECOM ENGINEER:	LANDSCAPE ARCHITECT:
SWANSON RINK THAINA GLASSEN (303) 832-2666 1120 LINCOLN ST. STE 1200 DENVER, CO 80203	KIMLEY-HORN ANDREW VALESTIN (602) 906-1103 7740 N 16TH ST, STE 300 PHOENIX, AZ 85020

PROJECT:
 DATA CENTER - 10464 E PECOS ROAD
 TITLE: **GRADING AND DRAINAGE PLAN (3 OF 8)**

DRAWING: **C-070.03**
 PAPER SIZE: ARCH D SCALE: AGILE NO: REV: 1

MATCHLINE: SEE SHEET C-070.04

KEYMAP

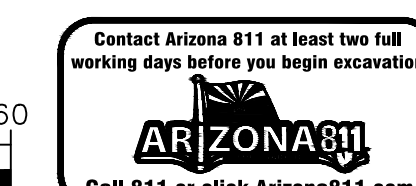
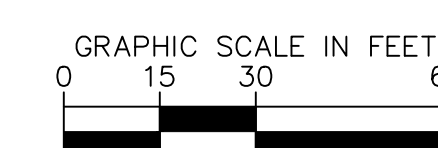
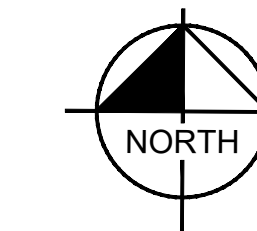
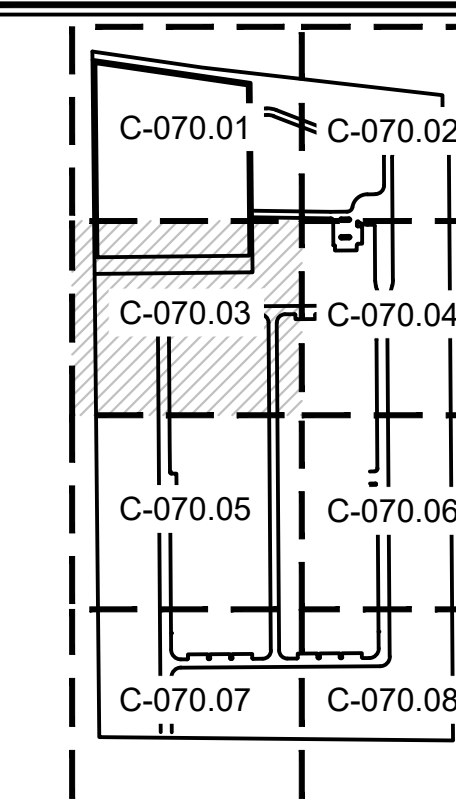

MATCHLINE: SEE SHEET C-070.05

PROPOSED DRAINAGE CHANNEL

DATA CENTER BUILDING B
FFE: 1417.30

SRP OWNED SWITCHYARD

SUBSTATION

PROPOSED RETENTION BASIN

PROPOSED RETENTION BASIN

This document, together with the concepts and designs presented herein, is intended only for the specific purpose and client for which it was prepared. Results of and improper reliance on this document without written authorization and adaptation by Kimley-Horn and Associates, Inc. shall be without liability to Kimley-Horn and Associates, Inc.

MESA BALD, LLC
 APN: 313-25-569Z
 ZONE: AD2

MESA BALD, LLC
 APN: 313-25-569Z
 ZONE: AD2

This document, together with the concepts and designs presented herein, is intended only for the specific purpose and client for which it was prepared. Reuse of and improper reliance on this document without written authorization and adaptation by Kimley-Horn and Associates, Inc. shall be without liability to Kimley-Horn and Associates, Inc.

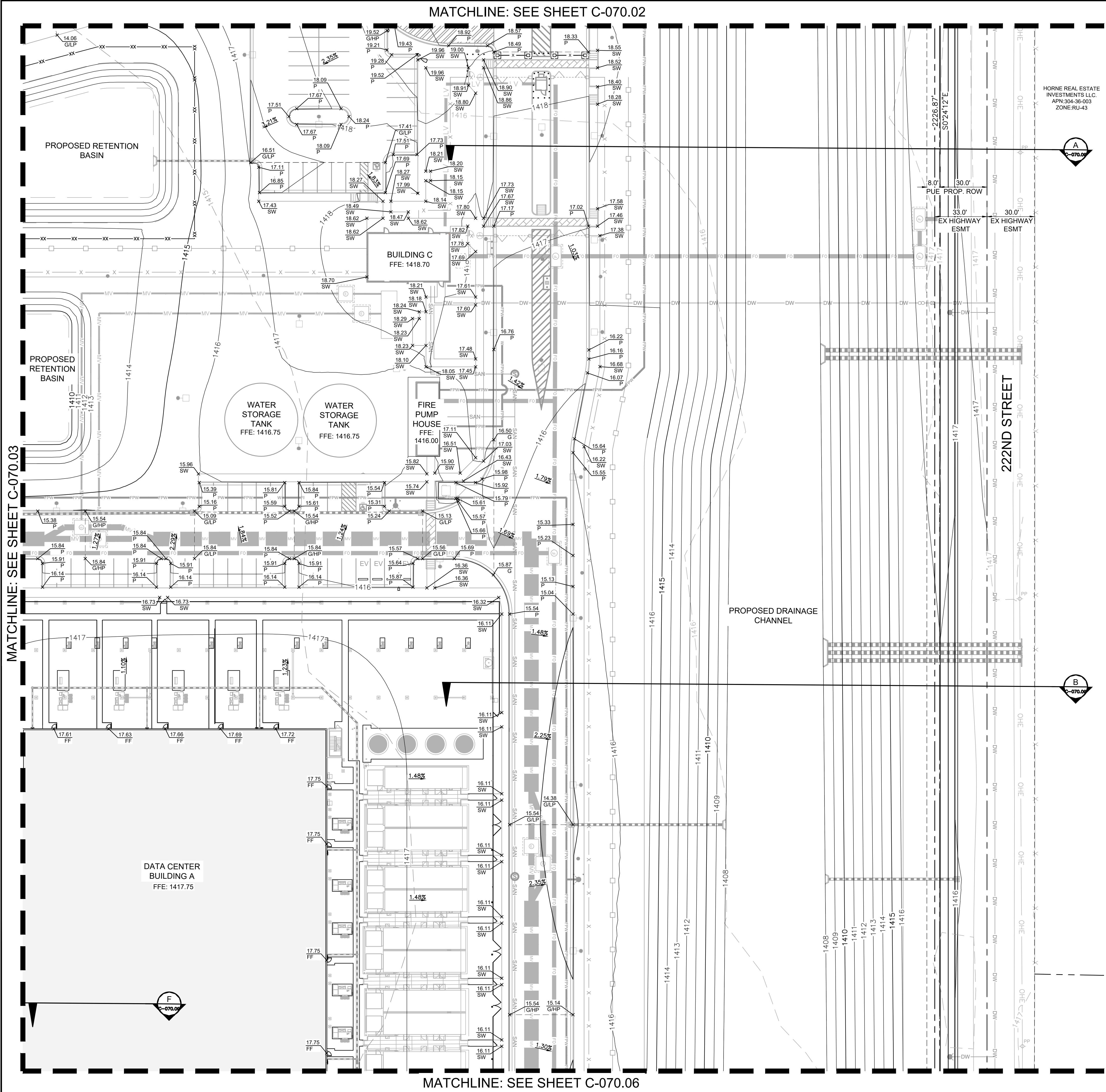

NOTES

- ALL EXISTING UTILITY LOCATIONS SHOWN HEREIN ARE APPROXIMATE ONLY. IT SHALL BE THE CONTRACTOR'S RESPONSIBILITY TO DETERMINE THE EXACT VERTICAL AND HORIZONTAL LOCATION OF ALL EXISTING UNDERGROUND UTILITIES PRIOR TO COMMENCING CONSTRUCTION. NO REPRESENTATION IS MADE THAT ALL UTILITIES ARE SHOWN HEREON. THE ENGINEER ASSUMES NO RESPONSIBILITY FOR UTILITIES NOT SHOWN OR UTILITIES NOT SHOWN IN THEIR PROPER LOCATION.
- ALL ABOVE GROUND UTILITY APPURTENANCES SHALL BE ADJUSTED TO MATCH PROPOSED FINISHED GRADE ELEVATIONS.
- ALL FG SPOT ELEVATIONS ALONG PROPOSED CURB ARE BOTTOM FACE OF CURB ELEVATIONS.

ABBREVIATIONS

15.00 P	FINISHED GRADE SPOT ELEVATION
15.00 FF	FINISHED FLOOR SPOT ELEVATION
15.00 SW	SIDEWALK SPOT ELEVATION
15.00 G	GRADE BRAKE SPOT ELEVATION
15.00 HP	HIGH POINT SPOT ELEVATION
15.00 LP	LOW POINT SPOT ELEVATION

LEGEND

	PROPERTY LINE
	EXISTING MAJOR CONTOUR
	EXISTING MINOR CONTOUR
	PROPOSED MAJOR CONTOUR
	PROPOSED MINOR CONTOUR
	EXISTING OVERHEAD POWER LINE
	EXISTING STORM DRAIN LINE
	PROPOSED STORM DRAIN LINE
	GRADE BREAK

KEYMAP

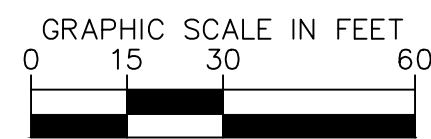
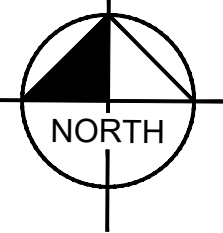
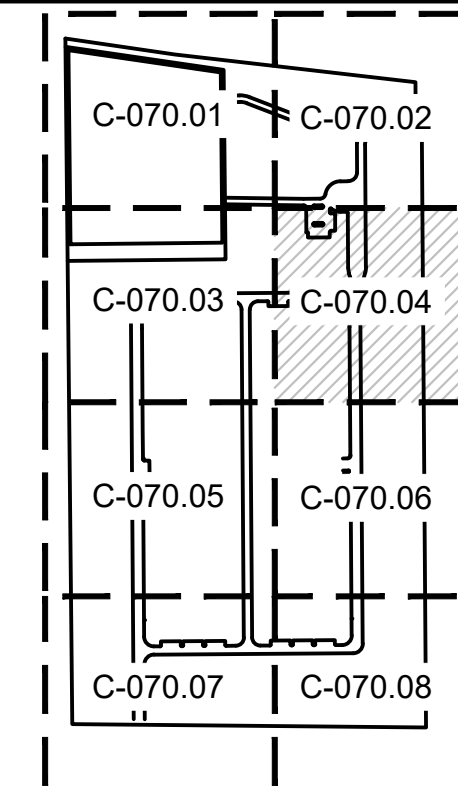

Kimley-Horn
 © 2023 KIMLEY-HORN AND ASSOCIATES, INC.
 7740 N 16TH ST, SUITE 300
 PHOENIX, AZ 85020
 WWW.KIMLEY-HORN.COM

CONFIDENTIAL

PROJECT ADDRESS
 10464 E PECOS ROAD
 MESA, ARIZONA

PROJECT DELIVERY PACKAGE

SITE PLAN REVIEW

SEAL/SIGNATURE

NOT FOR CONSTRUCTION

THE LICENSED PROFESSIONAL SEAL AFFIXED TO THIS SHEET APPLIES ONLY TO THE MATERIAL AND ITEMS SHOWN ON THIS SHEET. ALL DRAWINGS, INSTRUMENTS OR OTHER DOCUMENTS NOT EXHIBITING THIS SEAL SHALL NOT BE CONSIDERED PREPARED BY THIS PROFESSIONAL, AND THIS PROFESSIONAL EXPRESSLY DISCLAIMS ANY AND ALL RESPONSIBILITY FOR SUCH PLAN, DRAWINGS OR DOCUMENTS NOT EXHIBITING THIS SEAL.

ISSUE DATE:	12FEB2024	PROJECT NO:	78 3116.000
DESIGNED:	ARCHITECT: PATRICK MAGNESS	GENSLER	
REV.	DATE	DESCRIPTION	
1	11DEC2023	SITE PLAN REVIEW	
2	12FEB2024	SITE PLAN REVIEW: RESPONSE TO CITY COMMENTS	

CONFIDENTIAL
 ANY UNAUTHORIZED USE OR REPRODUCTION OF THIS DOCUMENT IN WHOLE OR IN PART IS PROHIBITED. DELETE THIS DOCUMENT IF YOU HAVE RECEIVED IT IN ERROR

MECHANICAL ENGINEER: SWANSON RINK MECHANICAL EOR (303) 832-2666 1120 LINCOLN ST. STE 1200 DENVER, CO 80203	ELECTRICAL ENGINEER: SWANSON RINK ELECTRICAL EOR (303) 832-2666 1120 LINCOLN ST. STE 1200 DENVER, CO 80203
--	--

CIVIL ENGINEER: KIMLEY-HORN CHARLES WURL (602) 944-5500 7740 N 16TH ST, STE 300 PHOENIX, AZ 85020	STRUCTURAL ENGINEER: S.A. MIRO, INC. STRUCTURAL EOR (602) 741-5737 4582 S ULLSTER ST. STE 750 DENVER, CO 80237
--	--

ARCHITECT: GENSLER PATRICK MAGNESS (602) 523-4900 2575 E CAMELBACK RD STE 775 PHOENIX, AZ 85016	SECURITY ENGINEER: SWANSON RINK MICHAEL GHEZZI (303) 832-2666 1120 LINCOLN ST. STE 1200 DENVER, CO 80203
--	--

TELECOM ENGINEER: SWANSON RINK THAINA GLASSEN (303) 832-2666 1120 LINCOLN ST. STE 1200 DENVER, CO 80203	LANDSCAPE ARCHITECT: KIMLEY-HORN ANDREW VALESTIN (602) 906-1103 7740 N 16TH ST, STE 300 PHOENIX, AZ 85020
---	--

PROJECT: DATA CENTER - 10464 E PECOS ROAD

TITLE: **GRADING AND DRAINAGE PLAN (4 OF 8)**

DRAWING: C-070.04

PAPER SIZE: ARCH D	SCALE:	AGILE NO:	REV: 1
--------------------	--------	-----------	--------

This document, together with the concepts and designs presented herein, as an instrument of service, is intended only for the specific purpose and client for which it was prepared. Reuse of and improper reliance on this document without written authorization and adaptation by Kimley-Horn and Associates, Inc. shall be without liability to Kimley-Horn and Associates, Inc.

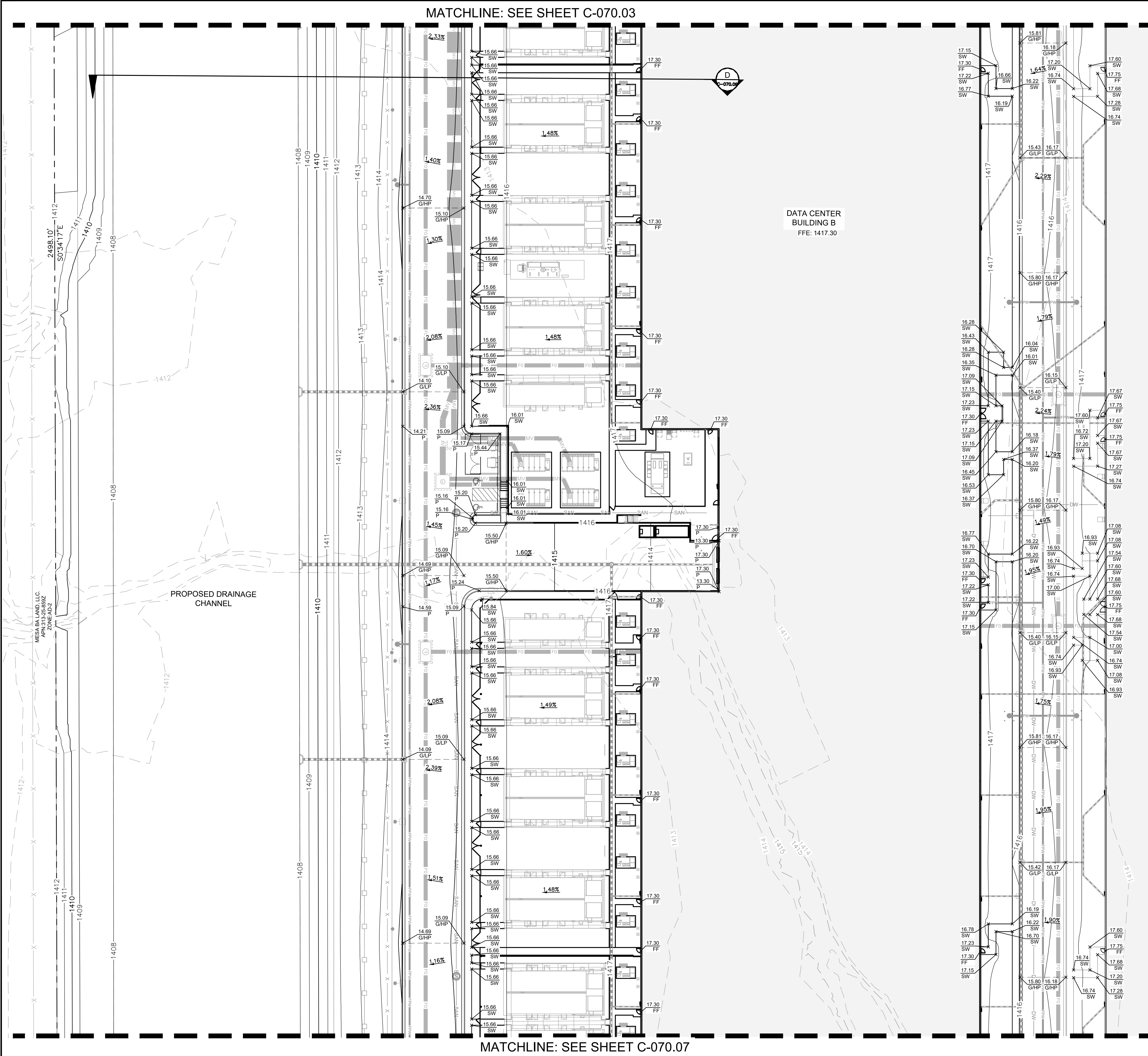

MATCHLINE: SEE SHEET C-070.03

MATCHLINE: SEE SHEET C-070.07

DATA CENTER BUILDING B
FFE: 1417.30

NOTES

- ALL EXISTING UTILITY LOCATIONS SHOWN HEREIN ARE APPROXIMATE ONLY. IT SHALL BE THE CONTRACTOR'S RESPONSIBILITY TO DETERMINE THE EXACT VERTICAL AND HORIZONTAL LOCATION OF ALL EXISTING UNDERGROUND UTILITIES PRIOR TO COMMENCING CONSTRUCTION. NO REPRESENTATION IS MADE THAT ALL UTILITIES ARE SHOWN HEREON. THE ENGINEER ASSUMES NO RESPONSIBILITY FOR UTILITIES NOT SHOWN OR UTILITIES NOT SHOWN IN THEIR PROPER LOCATION.
- ALL ABOVE GROUND UTILITY APPURTENANCES SHALL BE ADJUSTED TO MATCH PROPOSED FINISHED GRADE ELEVATIONS.
- ALL FG SPOT ELEVATIONS ALONG PROPOSED CURB ARE BOTTOM FACE OF CURB ELEVATIONS.

ABBREVIATIONS

15.00 P	FINISHED GRADE SPOT ELEVATION
15.00 FF	FINISHED FLOOR SPOT ELEVATION
15.00 SW	SIDEWALK SPOT ELEVATION
15.00 G	GRADE BRAKE SPOT ELEVATION
15.00 HP	HIGH POINT SPOT ELEVATION
15.00 LP	LOW POINT SPOT ELEVATION

LEGEND

	PROPERTY LINE
	EXISTING MAJOR CONTOUR
	EXISTING MINOR CONTOUR
	PROPOSED MAJOR CONTOUR
	PROPOSED MINOR CONTOUR
	EXISTING OVERHEAD POWER LINE
	EXISTING STORM DRAIN LINE
	PROPOSED STORM DRAIN LINE
	GRADE BREAK

MATCHLINE: SEE SHEET C-070.06

KEYMAP

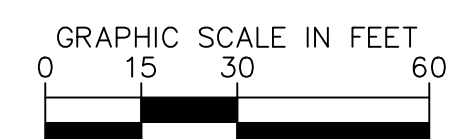
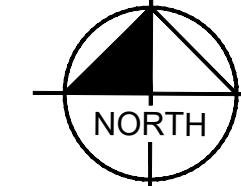
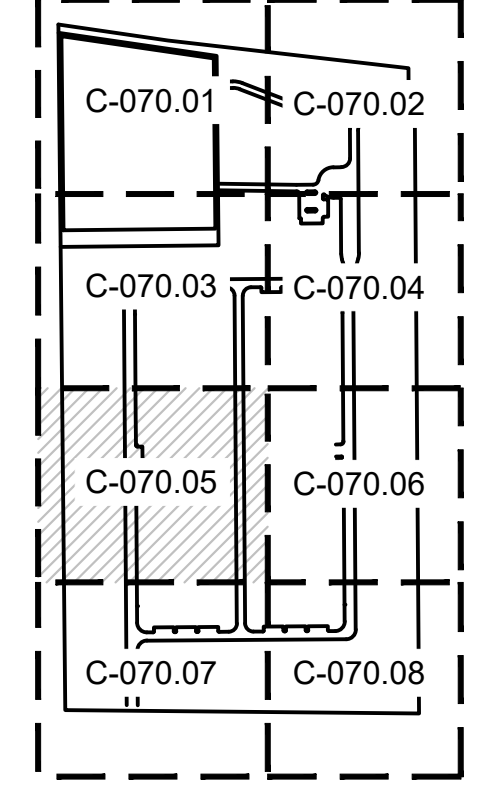

Kimley-Horn
© 2023 KIMLEY-HORN AND ASSOCIATES, INC.
7740 N 16TH ST, SUITE 300
PHOENIX, AZ 85020
WWW.KIMLEY-HORN.COM

CONFIDENTIAL

PROJECT ADDRESS
10464 E PECOS ROAD
MESA, ARIZONA

PROJECT DELIVERY PACKAGE
SITE PLAN REVIEW

SEAL/SIGNATURE

NOT FOR CONSTRUCTION

THE LICENSED PROFESSIONAL SEAL AFFIXED TO THIS SHEET APPLIES ONLY TO THE MATERIAL AND ITEMS SHOWN ON THIS SHEET. ALL DRAWINGS, INSTRUMENTS OR OTHER DOCUMENTS NOT EXHIBITING THIS SEAL SHALL NOT BE CONSIDERED PREPARED BY THIS PROFESSIONAL, AND THIS PROFESSIONAL EXPRESSLY DISCLAIMS ANY AND ALL RESPONSIBILITIES FOR SUCH PLAN, DRAWINGS OR DOCUMENTS NOT EXHIBITING THIS SEAL.

ISSUE DATE:	12FEB2024	PROJECT NO:	78 3116.000
DESIGNED:	ARCHITECT: PATRICK MAGNESS	SEAL:	
REV.	DATE	DESCRIPTION	
1	11DEC2023	SITE PLAN REVIEW	
2	12FEB2024	SITE PLAN REVIEW RESPONSE TO CITY COMMENTS	

CONFIDENTIAL
ANY UNAUTHORIZED USE OR REPRODUCTION OF THIS DOCUMENT IN WHOLE OR IN PART IS PROHIBITED. DELETE THIS DOCUMENT IF YOU HAVE RECEIVED IT IN ERROR

MECHANICAL ENGINEER: SWANSON RINK MECHANICAL EOR (303) 832-2666 1120 LINCOLN ST, STE 1200 DENVER, CO 80203	ELECTRICAL ENGINEER: SWANSON RINK ELECTRICAL EOR (303) 832-2666 1120 LINCOLN ST, STE 1200 DENVER, CO 80203
---	---

CIVIL ENGINEER: KIMLEY-HORN CHARLES WURL (602) 944-5500 7740 N 16TH ST, STE 300 PHOENIX, AZ 85020	STRUCTURAL ENGINEER: S.A. MIRO, INC. STRUCTURAL EOR (303) 741-3737 4582 S ULLSTER ST, STE 750 DENVER, CO 80237
--	---

ARCHITECT: GENSLER PATRICK MAGNESS (602) 523-4900 2575 E CAMELBACK RD STE 175 PHOENIX, AZ 85016	SECURITY ENGINEER: SWANSON RINK MICHAEL GHEZZI (303) 832-2666 1120 LINCOLN ST, STE 1200 DENVER, CO 80203
--	---

TELECOM ENGINEER: SWANSON RINK THAINA GLASSAN (303) 832-2666 1120 LINCOLN ST, STE 1200 DENVER, CO 80203	LANDSCAPE ARCHITECT: KIMLEY-HORN ANDREW VALESTIN (602) 906-1103 7740 N 16TH ST, STE 300 PHOENIX, AZ 85020
--	--

PROJECT:
DATA CENTER - 10464 E PECOS ROAD

TITLE:
GRADING AND DRAINAGE PLAN (5 OF 8)

DRAWING:	C-070.05
PAPER SIZE:	ARCH D
SCALE:	AGILE NO:
REV:	1

This document, together with the concepts and designs presented herein, as an instrument of service, is intended only for the specific purpose and client for which it was prepared. Reuse of and improper reliance on this document without written authorization and adaptation by Kimley-Horn and Associates, Inc. shall be without liability to Kimley-Horn and Associates, Inc.

MATCHLINE: SEE SHEET C-070.05

MATCHLINE: SEE SHEET C-070.04

DATA CENTER BUILDING A
FFE: 1417.75

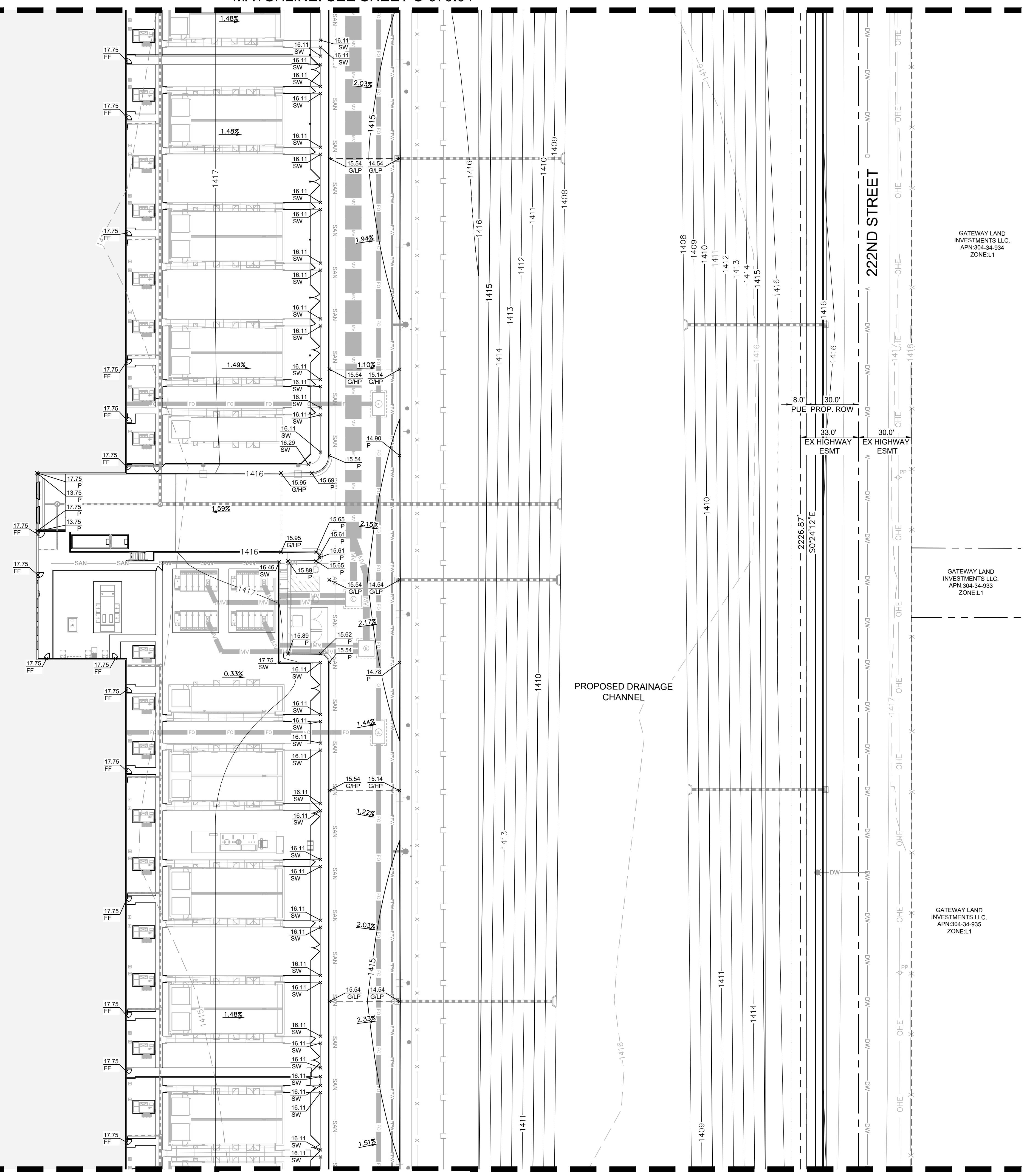

MATCHLINE: SEE SHEET C-070.06

NOTES

- 1. ALL EXISTING UTILITY LOCATIONS SHOWN HEREIN ARE APPROXIMATE ONLY. IT SHALL BE THE CONTRACTOR'S RESPONSIBILITY TO DETERMINE THE EXACT VERTICAL AND HORIZONTAL LOCATION OF ALL EXISTING UNDERGROUND UTILITIES PRIOR TO COMMENCING CONSTRUCTION. NO REPRESENTATION IS MADE THAT ALL UTILITIES ARE SHOWN HEREON. THE ENGINEER ASSUMES NO RESPONSIBILITY FOR UTILITIES NOT SHOWN OR UTILITIES NOT SHOWN IN THEIR PROPER LOCATION.
2. ALL ABOVE GROUND UTILITY APPURTENANCES SHALL BE ADJUSTED TO MATCH PROPOSED FINISHED GRADE ELEVATIONS.
3. ALL FG SPOT ELEVATIONS ALONG PROPOSED CURB ARE BOTTOM FACE OF CURB ELEVATIONS.

ABBREVIATIONS

Table with 2 columns: Abbreviation and Description. Includes 15.00 P (FINISHED GRADE SPOT ELEVATION), 15.00 FF (FINISHED FLOOR SPOT ELEVATION), 15.00 SW (SIDEWALK SPOT ELEVATION), 15.00 G (GRADE BRAKE SPOT ELEVATION), 15.00 HP (HIGH POINT SPOT ELEVATION), 15.00 LP (LOW POINT SPOT ELEVATION).

LEGEND

Table with 2 columns: Symbol and Description. Includes symbols for PROPERTY LINE, EXISTING MAJOR CONTOUR, EXISTING MINOR CONTOUR, PROPOSED MAJOR CONTOUR, PROPOSED MINOR CONTOUR, EXISTING OVERHEAD POWER LINE, EXISTING STORM DRAIN LINE, PROPOSED STORM DRAIN LINE, GRADE BREAK.

KEYMAP

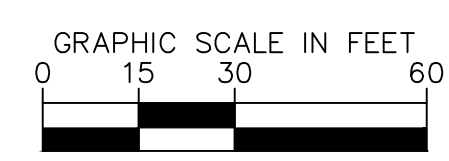
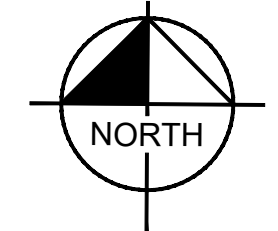
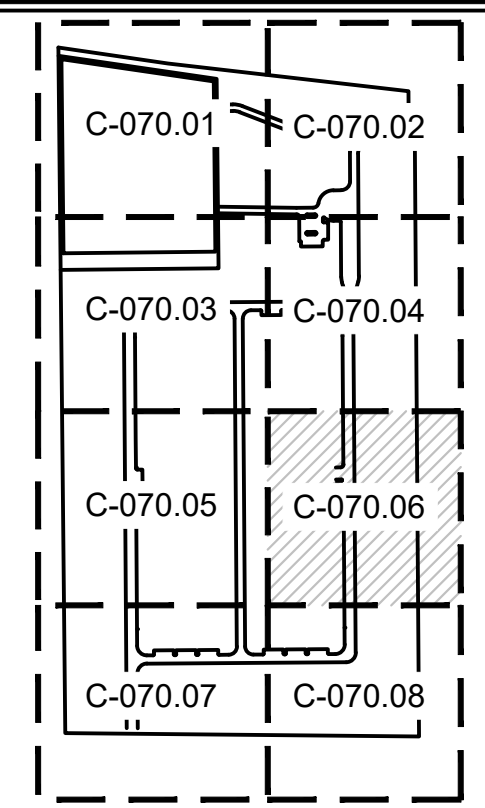

Kimley-Horn & Associates, Inc.
© 2023 KIMLEY-HORN AND ASSOCIATES, INC.
7740 N 16TH ST, SUITE 300
PHOENIX, AZ 85020
WWW.KIMLEY-HORN.COM

CONFIDENTIAL

PROJECT ADDRESS
10464 E PECOS ROAD
MESA, ARIZONA

PROJECT DELIVERY PACKAGE
SITE PLAN REVIEW

SEAL/SIGNATURE

NOT FOR CONSTRUCTION

THE LICENSED PROFESSIONAL SEAL AFFIXED TO THIS SHEET APPLIES ONLY TO THE MATERIAL AND ITEMS SHOWN ON THIS SHEET. ALL DRAWINGS, INSTRUMENTS OR OTHER DOCUMENTS NOT EXHIBITING THIS SEAL SHALL NOT BE CONSIDERED PREPARED BY THIS PROFESSIONAL, AND THIS PROFESSIONAL EXPRESSLY DISCLAIMS ANY AND ALL RESPONSIBILITY FOR SUCH PLAN, DRAWINGS OR DOCUMENTS NOT EXHIBITING THIS SEAL.

Table with columns: REV., DATE, DESCRIPTION. Includes revision 1 (12DEC2023) SITE PLAN REVIEW and revision 2 (12FEB2024) SITE PLAN REVIEW RESPONSE TO CITY COMMENTS.

CONFIDENTIAL
ANY UNAUTHORIZED USE OR REPRODUCTION OF THIS DOCUMENT IN WHOLE OR IN PART IS PROHIBITED. DELETE THIS DOCUMENT IF YOU HAVE RECEIVED IT IN ERROR.

Table with columns: MECHANICAL ENGINEER, ELECTRICAL ENGINEER. Lists SWANSON RINK MECHANICAL EOR and SWANSON RINK ELECTRICAL EOR.

Table with columns: CIVIL ENGINEER, STRUCTURAL ENGINEER. Lists KIMLEY-HORN CHARLES WURL and S.A. MIRO, INC.

Table with columns: ARCHITECT, SECURITY ENGINEER. Lists GENSLER PATRICK MAGNESS and SWANSON RINK MICHAEL GHEZZI.

Table with columns: TELECOM ENGINEER, LANDSCAPE ARCHITECT. Lists SWANSON RINK THAINA GLASSEN and KIMLEY-HORN ANDREW VALESTIN.

PROJECT: DATA CENTER - 10464 E PECOS ROAD
TITLE: GRADING AND DRAINAGE PLAN (6 OF 8)

Table with columns: DRAWING, PAPER SIZE, SCALE, AGILE NO., REV. Includes drawing title C-070.06 and revision 1.

MATCHLINE: SEE SHEET C-070.05

NOTES

- ALL EXISTING UTILITY LOCATIONS SHOWN HEREIN ARE APPROXIMATE ONLY. IT SHALL BE THE CONTRACTOR'S RESPONSIBILITY TO DETERMINE THE EXACT VERTICAL AND HORIZONTAL LOCATION OF ALL EXISTING UNDERGROUND UTILITIES PRIOR TO COMMENCING CONSTRUCTION. NO REPRESENTATION IS MADE THAT ALL UTILITIES ARE SHOWN HEREON. THE ENGINEER ASSUMES NO RESPONSIBILITY FOR UTILITIES NOT SHOWN OR UTILITIES NOT SHOWN IN THEIR PROPER LOCATION.
- ALL ABOVE GROUND UTILITY APPURTENANCES SHALL BE ADJUSTED TO MATCH PROPOSED FINISHED GRADE ELEVATIONS.
- ALL FG SPOT ELEVATIONS ALONG PROPOSED CURB ARE BOTTOM FACE OF CURB ELEVATIONS.

ABBREVIATIONS

15.00 P	FINISHED GRADE SPOT ELEVATION
15.00 FF	FINISHED FLOOR SPOT ELEVATION
15.00 SW	SIDEWALK SPOT ELEVATION
15.00 G	GRADE BRAKE SPOT ELEVATION
15.00 HP	HIGH POINT SPOT ELEVATION
15.00 LP	LOW POINT SPOT ELEVATION

LEGEND

	PROPERTY LINE
	EXISTING MAJOR CONTOUR
	EXISTING MINOR CONTOUR
	PROPOSED MAJOR CONTOUR
	PROPOSED MINOR CONTOUR
	EXISTING OVERHEAD POWER LINE
	EXISTING STORM DRAIN LINE
	PROPOSED STORM DRAIN LINE
	GRADE BREAK

Kimley»Horn
 © 2023 KIMLEY-HORN AND ASSOCIATES, INC.
 7740 N 16TH ST, SUITE 300
 PHOENIX, AZ 85020
 WWW.KIMLEY-HORN.COM

CONFIDENTIAL

PROJECT ADDRESS
 10464 E PECOS ROAD
 MESA, ARIZONA

PROJECT DELIVERY PACKAGE
 SITE PLAN REVIEW

SEAL/SIGNATURE

NOT FOR CONSTRUCTION

THE LICENSED PROFESSIONAL SEAL AFFIXED TO THIS SHEET APPLIES ONLY TO THE MATERIAL AND ITEMS SHOWN ON THIS SHEET. ALL DRAWINGS, INSTRUMENTS OR OTHER DOCUMENTS NOT EXHIBITING THIS SEAL SHALL NOT BE CONSIDERED PREPARED BY THIS PROFESSIONAL, AND THIS PROFESSIONAL EXPRESSLY DISCLAIMS ANY AND ALL RESPONSIBILITY FOR SUCH PLAN, DRAWINGS OR DOCUMENTS NOT EXHIBITING THIS SEAL.

ISSUE DATE:	12FEB2024	PROJECT NO:	78 3116.000
DESIGNED:	GENSLER	ARCHITECT:	PATRICK MAGNESS
REV.	DATE	DESCRIPTION	
1	11DEC2023	SITE PLAN REVIEW	
2	12FEB2024	SITE PLAN REVIEW RESPONSE TO CITY COMMENTS	

CONFIDENTIAL
 ANY UNAUTHORIZED USE OR REPRODUCTION OF THIS DOCUMENT IN WHOLE OR IN PART IS PROHIBITED. DELETE THIS DOCUMENT IF YOU HAVE RECEIVED IT IN ERROR

MECHANICAL ENGINEER: SWANSON RINK MECHANICAL EOR (303) 832-2666 1120 LINCOLN ST. STE 1200 DENVER, CO 80203	ELECTRICAL ENGINEER: SWANSON RINK ELECTRICAL EOR (303) 832-2666 1120 LINCOLN ST. STE 1200 DENVER, CO 80203
--	--

CIVIL ENGINEER: KIMLEY-HORN CHARLES WURL (602) 944-5500 7740 N 16TH ST, STE 300 PHOENIX, AZ 85020	STRUCTURAL ENGINEER: S.A. MIRO, INC. STRUCTURAL EOR (303) 743-3737 4582 S ULSTER ST. STE 750 DENVER, CO 80237
--	---

ARCHITECT: GENSLER PATRICK MAGNESS (602) 523-4900 2575 E CAMELBACK RD STE 175 PHOENIX, AZ 85016	SECURITY ENGINEER: SWANSON RINK MICHAEL GHEZZI (303) 832-2666 1120 LINCOLN ST. STE 1200 DENVER, CO 80203
--	--

TELECOM ENGINEER: SWANSON RINK THAINA GLASSEN (303) 832-2666 1120 LINCOLN ST. STE 1200 DENVER, CO 80203	LANDSCAPE ARCHITECT: KIMLEY-HORN ANDREW VALESTIN (602) 906-1103 7740 N 16TH ST, STE 300 PHOENIX, AZ 85020
---	--

PROJECT:
 DATA CENTER - 10464 E PECOS ROAD
 TITLE: **GRADING AND DRAINAGE PLAN (7 OF 8)**

DRAWING: **C-070.07**
 PAPER SIZE: ARCH D SCALE: AGILE NO: REV: 1

MATCHLINE: SEE SHEET C-070.08

KEYMAP

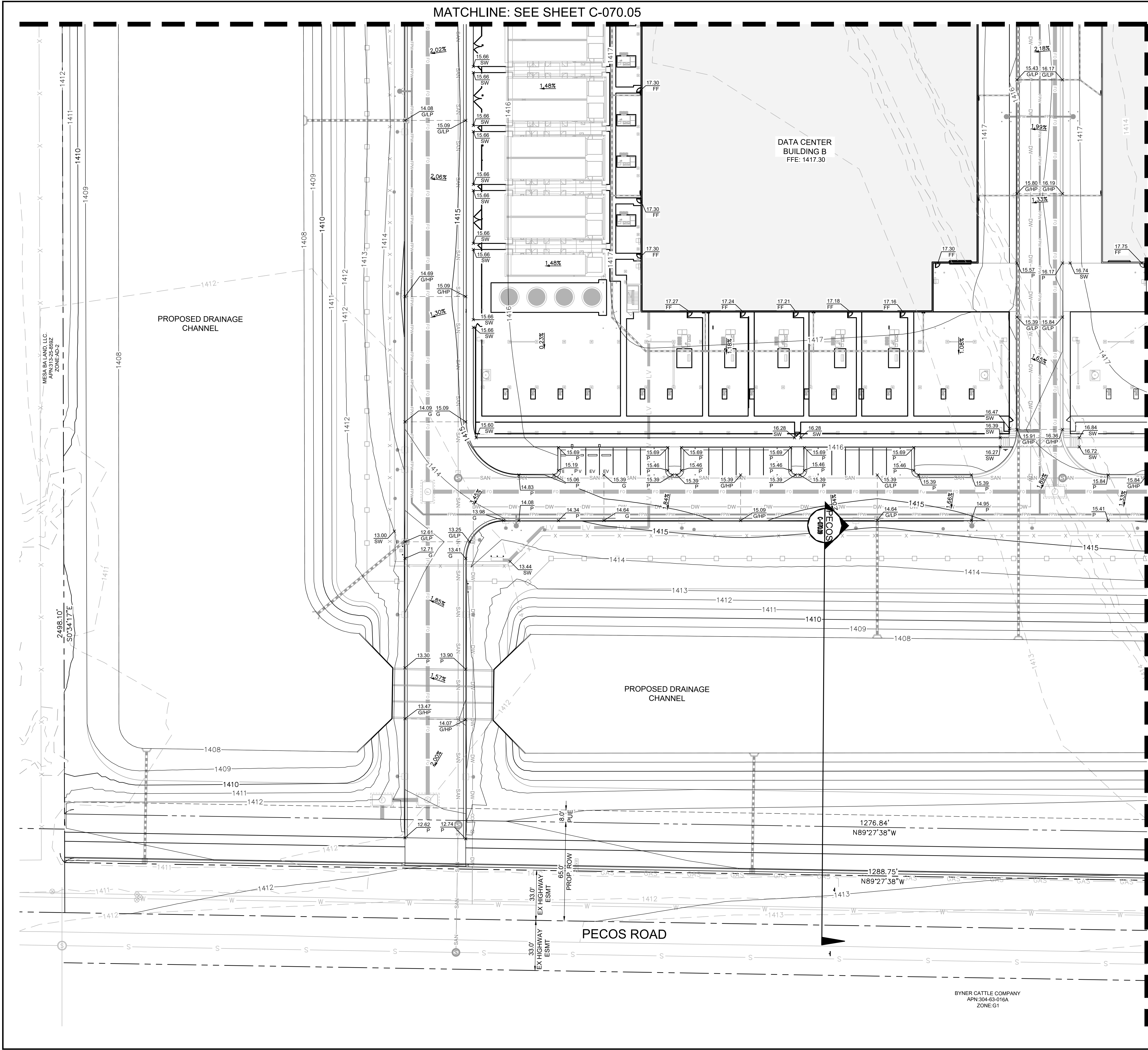
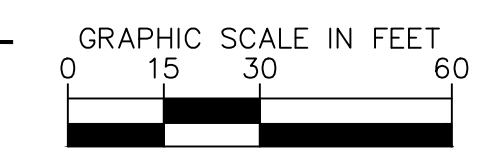
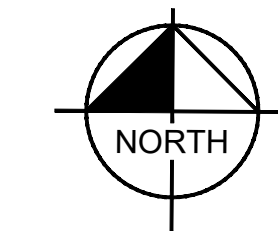
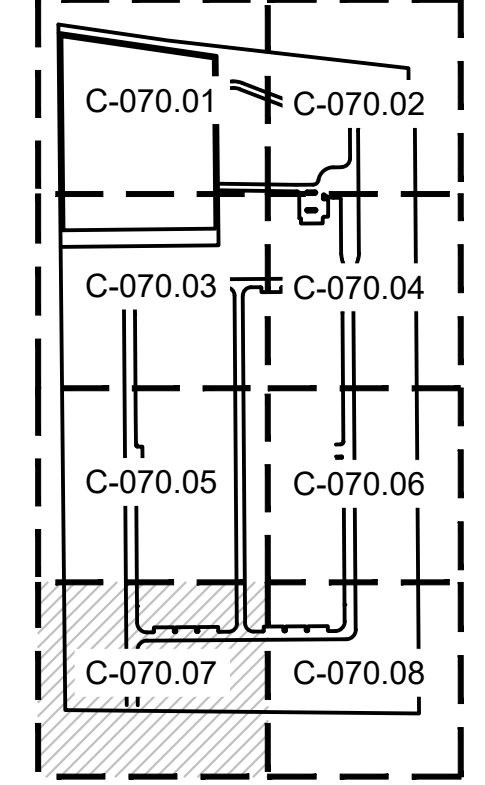

BYNER CATTLE COMPANY
 APN:304-03-016A
 ZONE:G1

This document, together with the concepts and designs presented herein, is intended only for the specific purpose and client for which it was prepared. Results of and improper reliance on this document without written authorization and adaptation by Kimley-Horn and Associates, Inc. shall be without liability to Kimley-Horn and Associates, Inc.

This document, together with the concepts and designs presented herein, is intended only for the specific purpose and client for which it was prepared. Results of and improper reliance on this document without written authorization and adaptation by Kimley-Horn and Associates, Inc. shall be without liability to Kimley-Horn and Associates, Inc.

MATCHLINE: SEE SHEET C-070.06

MATCHLINE: SEE SHEET C-070.07

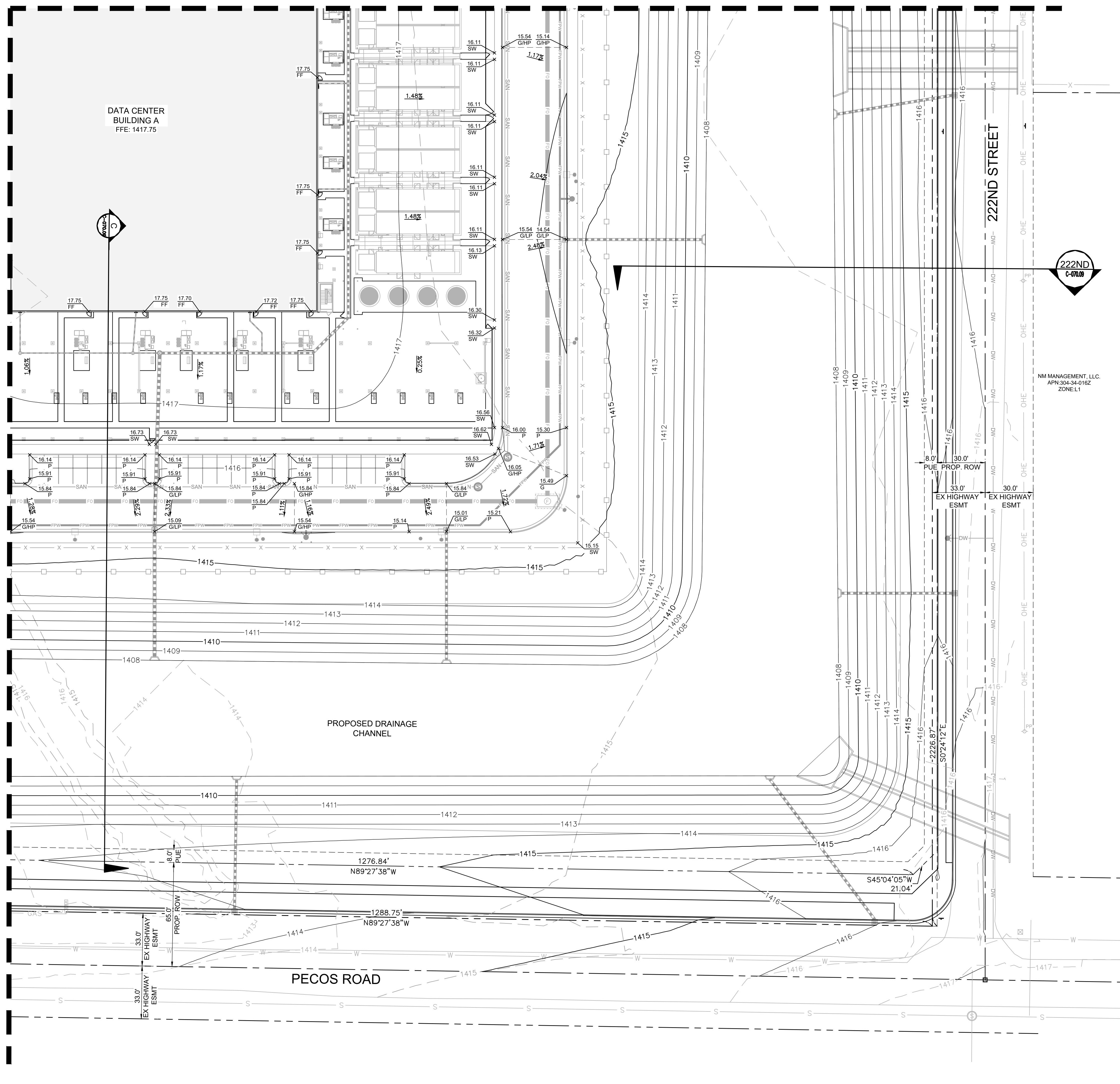

NOTES

- ALL EXISTING UTILITY LOCATIONS SHOWN HEREIN ARE APPROXIMATE ONLY. IT SHALL BE THE CONTRACTOR'S RESPONSIBILITY TO DETERMINE THE EXACT VERTICAL AND HORIZONTAL LOCATION OF ALL EXISTING UNDERGROUND UTILITIES PRIOR TO COMMENCING CONSTRUCTION. NO REPRESENTATION IS MADE THAT ALL UTILITIES ARE SHOWN HEREON. THE ENGINEER ASSUMES NO RESPONSIBILITY FOR UTILITIES NOT SHOWN OR UTILITIES NOT SHOWN IN THEIR PROPER LOCATION.
- ALL ABOVE GROUND UTILITY APPURTENANCES SHALL BE ADJUSTED TO MATCH PROPOSED FINISHED GRADE ELEVATIONS.
- ALL FG SPOT ELEVATIONS ALONG PROPOSED CURB ARE BOTTOM FACE OF CURB ELEVATIONS.

ABBREVIATIONS

15.00 P	FINISHED GRADE SPOT ELEVATION
15.00 FF	FINISHED FLOOR SPOT ELEVATION
15.00 SW	SIDEWALK SPOT ELEVATION
15.00 G	GRADE BRAKE SPOT ELEVATION
15.00 HP	HIGH POINT SPOT ELEVATION
15.00 LP	LOW POINT SPOT ELEVATION

LEGEND

	PROPERTY LINE
	EXISTING MAJOR CONTOUR
	EXISTING MINOR CONTOUR
	PROPOSED MAJOR CONTOUR
	PROPOSED MINOR CONTOUR
	EXISTING OVERHEAD POWER LINE
	EXISTING STORM DRAIN LINE
	PROPOSED STORM DRAIN LINE
	GRADE BREAK

Kimley-Horn
 © 2023 KIMLEY-HORN AND ASSOCIATES, INC.
 7740 N 16TH ST, SUITE 300
 PHOENIX, AZ 85020
 WWW.KIMLEY-HORN.COM

CONFIDENTIAL

PROJECT ADDRESS
 10464 E PECOS ROAD
 MESA, ARIZONA

PROJECT DELIVERY PACKAGE
 SITE PLAN REVIEW

SEAL/SIGNATURE

NOT FOR CONSTRUCTION

THE LICENSED PROFESSIONAL SEAL AFFIXED TO THIS SHEET APPLIES ONLY TO THE MATERIAL AND ITEMS SHOWN ON THIS SHEET. ALL DRAWINGS, INSTRUMENTS OR OTHER DOCUMENTS NOT EXHIBITING THIS SEAL SHALL NOT BE CONSIDERED PREPARED BY THIS PROFESSIONAL, AND THIS PROFESSIONAL EXPRESSLY DISCLAIMS ANY AND ALL RESPONSIBILITY FOR SUCH PLAN, DRAWINGS OR DOCUMENTS NOT EXHIBITING THIS SEAL.

ISSUE DATE:	12/FEB/2024	PROJECT NO:	78 3116 000
DESIGNED:	ARCHITECT: PATRICK MAGNESS	SEAL:	
REV.	DATE	DESCRIPTION	
1	11/DEC/2023	SITE PLAN REVIEW	
2	12/FEB/2024	SITE PLAN REVIEW: RESPONSE TO CITY COMMENTS	

CONFIDENTIAL
 ANY UNAUTHORIZED USE OR REPRODUCTION OF THIS DOCUMENT IN WHOLE OR IN PART IS PROHIBITED. DELETE THIS DOCUMENT IF YOU HAVE RECEIVED IT IN ERROR

MECHANICAL ENGINEER: SWANSON RINK MECHANICAL EOR (303) 832-2666 1120 LINCOLN ST. STE 1200 DENVER, CO 80203	ELECTRICAL ENGINEER: SWANSON RINK ELECTRICAL EOR (303) 832-2666 1120 LINCOLN ST. STE 1200 DENVER, CO 80203
--	--

CIVIL ENGINEER: KIMLEY-HORN CHARLES WURL (602) 944-5500 7740 N 16TH ST, STE 300 PHOENIX, AZ 85020	STRUCTURAL ENGINEER: S.A. MIRO, INC. STRUCTURAL EOR (303) 741-3737 4582 S ULSTER ST. STE 750 DENVER, CO 80237
--	---

ARCHITECT: GENSLER PATRICK MAGNESS (602) 523-4900 2575 E CAMELBACK RD STE 175 PHOENIX, AZ 85016	SECURITY ENGINEER: SWANSON RINK MICHAEL GHEZZI (303) 832-2666 1120 LINCOLN ST. STE 1200 DENVER, CO 80203
--	--

TELECOM ENGINEER: SWANSON RINK THAINA GLASSEN (303) 832-2666 1120 LINCOLN ST. STE 1200 DENVER, CO 80203	LANDSCAPE ARCHITECT: KIMLEY-HORN ANDREW VALESTIN (602) 906-1103 7740 N 16TH ST, STE 300 PHOENIX, AZ 85020
---	--

PROJECT:
DATA CENTER - 10464 E PECOS ROAD
 TITLE: **GRADING AND DRAINAGE PLAN (8 OF 8)**

DRAWING:	C-070.08
PAPER SIZE:	ARCH D
SCALE:	AGILE NO:
REV:	1

KEYMAP

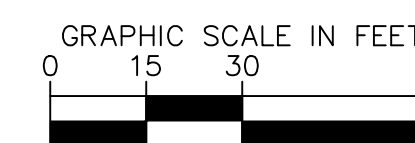
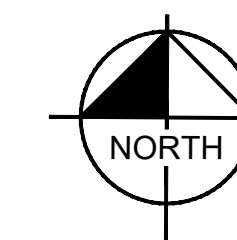
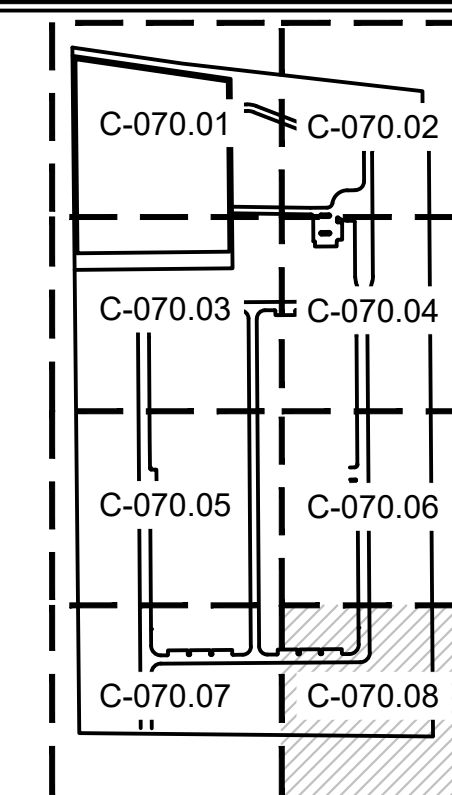

This document, together with the concepts and designs presented herein, is intended only for the specific purpose and client for which it was prepared. Results of and improper reliance on this document without written authorization and adaptation by Kimley-Horn and Associates, Inc. shall be without liability to Kimley-Horn and Associates, Inc.

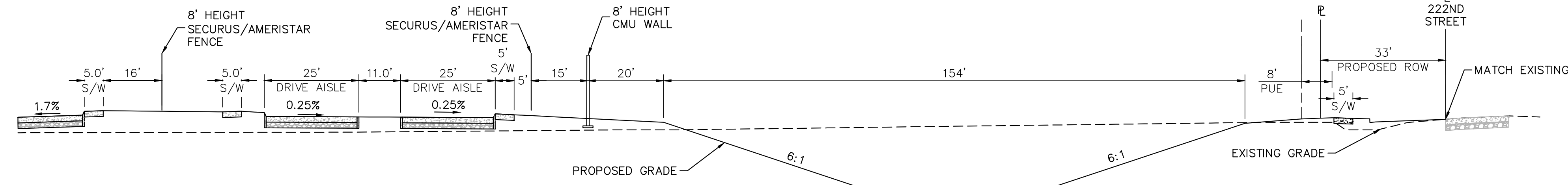

SECTION A

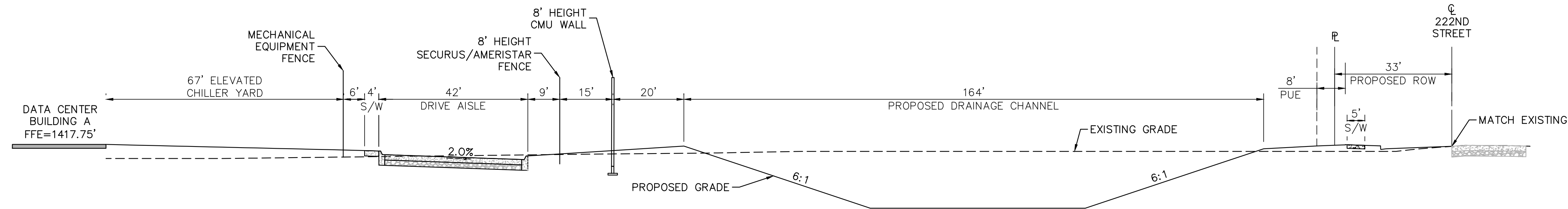

SECTION B

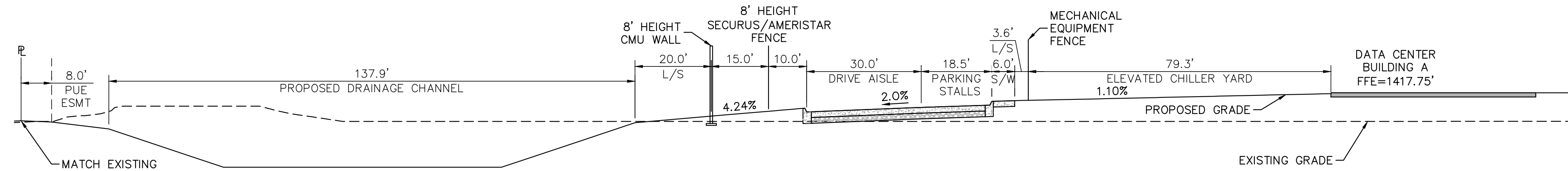

SECTION C

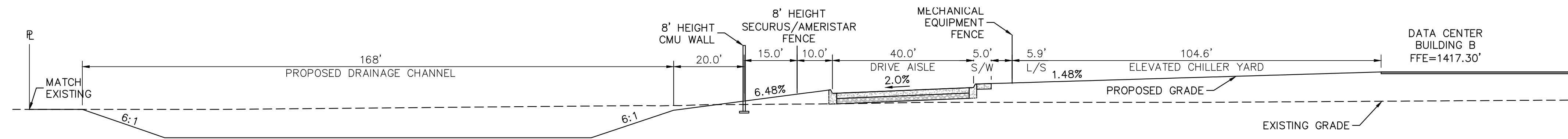

SECTION D

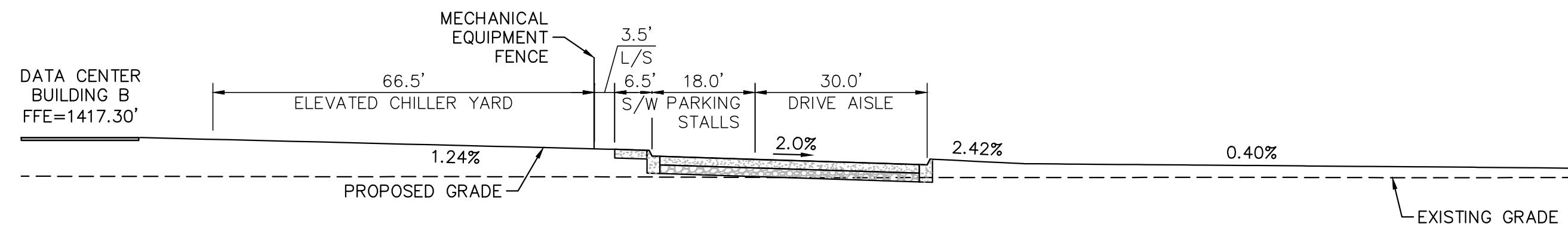

SECTION E

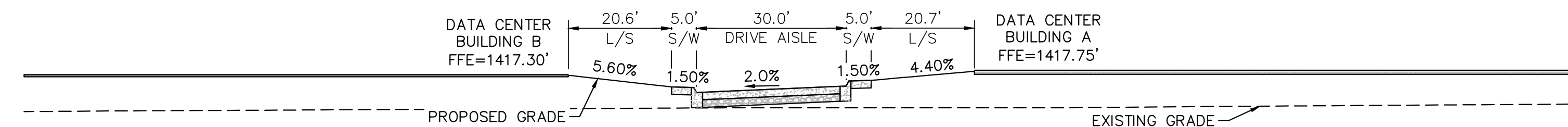

SECTION F

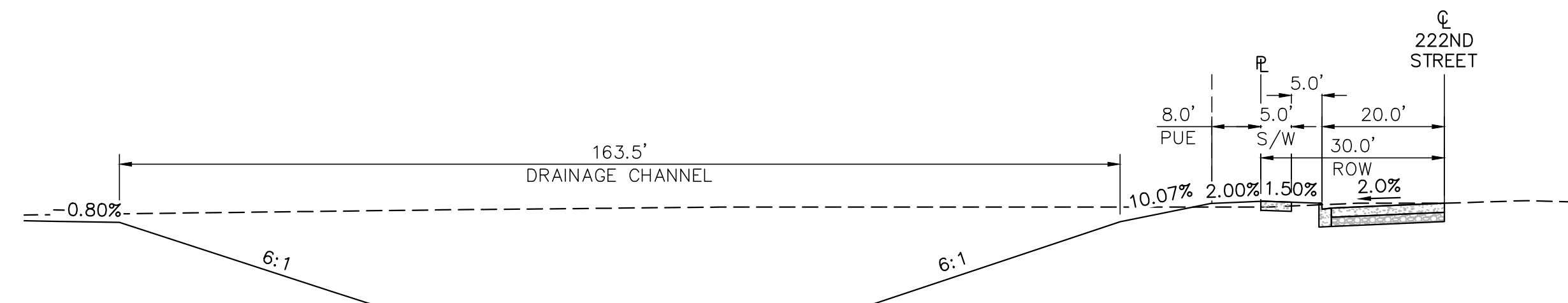

222ND STREET SECTION

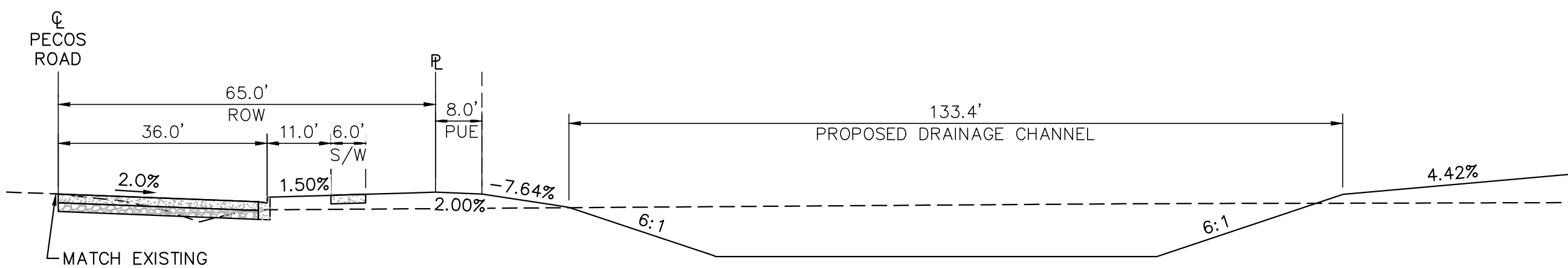

PECOS ROAD SECTION

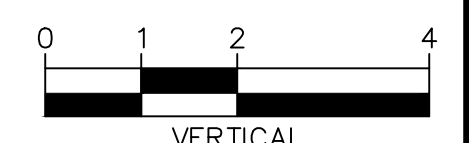
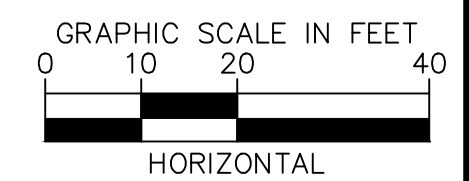

CONFIDENTIAL

PROJECT ADDRESS
10464 E PECOS ROAD
MESA, ARIZONA

PROJECT DELIVERY PACKAGE
SITE PLAN REVIEW

SEAL/SIGNATURE

NOT FOR CONSTRUCTION

THE LICENSED PROFESSIONAL SEAL AFFIXED TO THIS SHEET APPLIES ONLY TO THE MATERIAL AND ITEMS SHOWN ON THIS SHEET. ALL DRAWINGS, INSTRUMENTS OR OTHER DOCUMENTS NOT EXHIBITING THIS SEAL SHALL NOT BE CONSIDERED PREPARED BY THIS PROFESSIONAL, AND THIS PROFESSIONAL EXPRESSLY DISCLAIMS ANY AND ALL RESPONSIBILITY FOR SUCH PLAN, DRAWINGS OR DOCUMENTS NOT EXHIBITING THIS SEAL.

REV.	DATE	DESCRIPTION
1	11DEC2023	SITE PLAN REVIEW
2	12FEB2024	SITE PLAN REVIEW RESPONSE TO CITY COMMENTS

CONFIDENTIAL
ANY UNAUTHORIZED USE OR REPRODUCTION OF THIS DOCUMENT IN WHOLE OR IN PART IS PROHIBITED. DELETE THIS DOCUMENT IF YOU HAVE RECEIVED IT IN ERROR.

MECHANICAL ENGINEER:	ELECTRICAL ENGINEER:
SWANSON RINK MECHANICAL EOR (303) 832-2666 1120 LINCOLN ST. STE 1200 DENVER, CO 80203	SWANSON RINK ELECTRICAL EOR (303) 832-2666 1120 LINCOLN ST. STE 1200 DENVER, CO 80203

CIVIL ENGINEER:	STRUCTURAL ENGINEER:
KIMLEY-HORN CHARLES WURL (602) 944-5500 7740 N 16TH ST, STE 300 PHOENIX, AZ 85020	S.A. MIRO, INC. STRUCTURAL EOR (303) 741-3737 4582 S ULSTER ST. STE 750 DENVER, CO 80237

ARCHITECT:	SECURITY ENGINEER:
GENSLER PATRICK MAGNESS (602) 523-4900 2575 E CAMELBACK RD STE 175 PHOENIX, AZ 85016	SWANSON RINK MICHAEL GHEZZI (303) 832-2666 1120 LINCOLN ST. STE 1200 DENVER, CO 80203

TELECOM ENGINEER:	LANDSCAPE ARCHITECT:
SWANSON RINK THAINA GLASSEN (303) 832-2666 1120 LINCOLN ST. STE 1200 DENVER, CO 80203	KIMLEY-HORN ANDREW VALESTIN (602) 906-1103 7740 N 16TH ST, STE 300 PHOENIX, AZ 85020

PROJECT:
DATA CENTER - 10464 E PECOS ROAD

TITLE:
GRADING SECTIONS

DRAWING:	SCALE:	AGILE NO.:	REV.:
C-070.09			1