

**PLANT LEGEND**

TREES	SPECIFICATION	QTY
<i>Parkinsonia florida</i> Blue Palo Verde	2.25" Cal. 9'H x 6'W 3.50" Cal. 12'H x 10'W	94 5
<i>Chilopsis linearis</i> Desert Willow	2.0" Cal. 8'H x 7'W Double Stake	128
<i>Prosopis glandulosa</i> Thornless Honey Mesquite	2.0" Cal. 9'H x 7'W 3.50" Cal. 12'H x 10'W	23 2
<i>Prosopis velutina</i> Arizona Mesquite	2.50" Cal. 8'H x 6'W Double Stake	70
<i>Pithecellobium flexicaule</i> Texas Ebony	2.0" Cal. 9'H x 6'W Double Stake	16
<i>Olneya tesota</i> Ironwood	8'H x 5'W Multi Trunk	36
<i>Parkinsonia praecox</i> Palo Brea	2.25" Cal. 9'H x 6'W Double Stake	32
<i>Acacia salicina</i> Willow Acacia	2.25" Cal. 9'H x 6'W Double Stake	13
<i>Ungnadia speciosa</i> Mexican Buckeye	2.25" Cal. 9'H x 6'W Double Stake	24

SHRUBS	SIZE	QTY	SHRUBS	SIZE	QTY
<i>Ambrosia deltoidea</i> Triangle Leaf Bursage	5 Gallon	264	<i>Salvia coccinea</i> Cherry Red Sage	5 Gallon	119
<i>Anisacanthus thumberi</i> Desert Honeysuckle	5 Gallon	63	<i>Buddleia marubifolia</i> Woolly Butterfly Bush	5 Gallon	128
<i>Calliandra californica</i> Baja Red Fairy Duster	5 Gallon	7	<i>Caesalpinia pulcherrima</i> Red Bird of Paradise	5 Gallon	260
<i>Chrysactina mexicana</i> Damianita	5 Gallon	67	<i>Senna phyllodinea</i> Silver Leaf Senna	5 Gallon	265
<i>Dalea pulchra</i> Indigo Bush	5 Gallon	168	<i>Cordia boissieri</i> Anacahuita	5 Gallon	192
<i>Encelia farinosa</i> Brittlebush	5 Gallon	440	<i>Dodonea viscosa</i> Green Hopbush	5 Gallon	232
<i>Justicia californica</i> Chuparosa	5 Gallon	320	<i>Larrea tridentata</i> Creosote Bush	5 Gallon	214
<i>Ruellia Peninsularis</i> Desert Ruellia	5 Gallon	126	<i>Leucophyllum laevigatum</i> Chihuahuan Sage	5 Gallon	371
<i>Salvia clevelandi</i> Chaparral Sage	5 Gallon	337	<i>Tecoma hybrid</i> Orange Jubilee	5 Gallon	218
<i>Muhlenbergia capillaris</i> Regal Mist Deer Grass	5 Gallon	231			
CACTI & SUCCULENTS	SIZE	QTY	GROUNDCOVERS	SIZE	QTY
<i>Aloe barbadensis</i> Medicinal Aloe	1 Gallon	141	<i>Lantana montevidensis</i> Purple Trailing Lantana	1 Gallon	212
<i>Aloe saponaria</i> African Aloe	1 Gallon	90	<i>Baccharis Cv. "Centennial"</i> Centennial Baccharis	1 Gallon	227
<i>Hesperaloe parviflora</i> Red Yucca	5 Gallon	118	<i>Verbena goodingii</i> Gooding's Verbena	1 Gallon	225
<i>Carnegiea gigantea</i> Saguaro	5' Spear	37	<i>Cynodon dactylon</i> Midiron Hybrid	Sod	3,925 S.F.
<i>Dasyliiron wheeleri</i> Desert Spoon	5 Gallon	180	<i>Synthetic turf</i> "Easyturf"	Nutmeg Lush	3,610 S.F.
<i>Ferocactus wislizenii</i> Fishhook Barrel Cactus	2' Height	197	LANDSCAPE MATERIALS		QTY
<i>Fouquieria splendens</i> Ocotillo	6'-8' Canes	158	<i>Decomposed granite(Site)</i>	3/4" Mixed	
<i>Echinocactus grusonii</i> Golden Barrel Cactus	12" Diameter	54	Desert Gold Pioneer Materials	2" Depth	
	Matching		<i>Decomposed granite(Trail)</i>	1/4" Minus	
			Desert Gold Pioneer Materials	3" Depth Compacted	
			<i>Concrete header</i>	4"x 6"	
			Extruded		
			<i>Steel header (Trail)</i>	1/2" x 8"	
			<i>Boulders</i>		
			Decomposed Granite	3'x3'x3'	115
			Surface Select	2'x2'x2'	55
				1'x1'x1'	37

**LANDSCAPE CALCULATIONS:**

	REQUIRED	PROVIDED
STREET FRONTAGE LANDSCAPE ALONG RECKER ROAD: 1,380 L.F. / 1 TREE & 6 SHRUBS PER 25 L.F.	56 TREES, 336 SHRUBS (14) 36" BOX OR LARGER (28) 24" BOX MINIMUM (14) 15 GALLON	64 TREES, 940 SHRUBS (20) 36" BOX OR LARGER (44) 24" BOX MINIMUM
STREET FRONTAGE LANDSCAPE ALONG LONGBOW ROAD: 573 L.F. / 1 TREE & 6 SHRUBS PER 25 L.F.	23 TREES, 138 SHRUBS (8) 36" BOX OR LARGER (12) 24" BOX MINIMUM (5) 15 GALLON	24 TREES, 280 SHRUBS (10) 36" BOX OR LARGER (14) 24" BOX MINIMUM
LANDSCAPE ADJACENT TO SOUTH PROPERTY LINE: 830 L.F. / 3 TREE & 20 SHRUBS PER 100 L.F.	25 TREES, 160 SHRUBS (6) 36" BOX MINIMUM (12) 24" BOX MINIMUM (7) 15 GALLON	28 TREES, 230 SHRUBS (8) 36" BOX OR LARGER (20) 24" BOX MINIMUM
LANDSCAPE ADJACENT TO WEST PROPERTY LINE: 1,870 L.F. / 3 TREE & 20 SHRUBS PER 100 L.F.	56 TREES, 360 SHRUBS (14) 36" BOX MINIMUM (28) 24" BOX MINIMUM (14) 15 GALLON	70 TREES, 478 SHRUBS (18) 36" BOX OR LARGER (52) 24" BOX MINIMUM

**biltform**  
landscape  
architecture

biltform landscape  
architecture group,  
inc.

11460 North Cave Creek Rd. suite 6  
Phoenix - Arizona 85020  
Phone 602.285.9200 Fax 602.285.9229  
email: dave@biltform.com

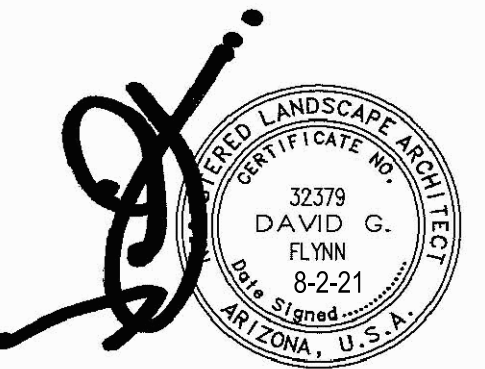

**ASCEND at LONGBOW HIGHPOINT**  
MIXED USE PROJECT  
CITY OF MESA, ARIZONA

**D-R-HORTON**  
America's Builder

PROJECT OWNER:  
PROJECT OWNER:  
1341 Horton Circle  
Arlington, Texas 76001

Phone: (817) 390-8264

REVISIONS:

3rd City Review	Comments 9-29-21
4th City Review	Comments 10-20-21

JOB NO: 21-031  
DATE: JULY 26, 2021  
SCALE: 1" = 70'-0"  
SHEET NO:



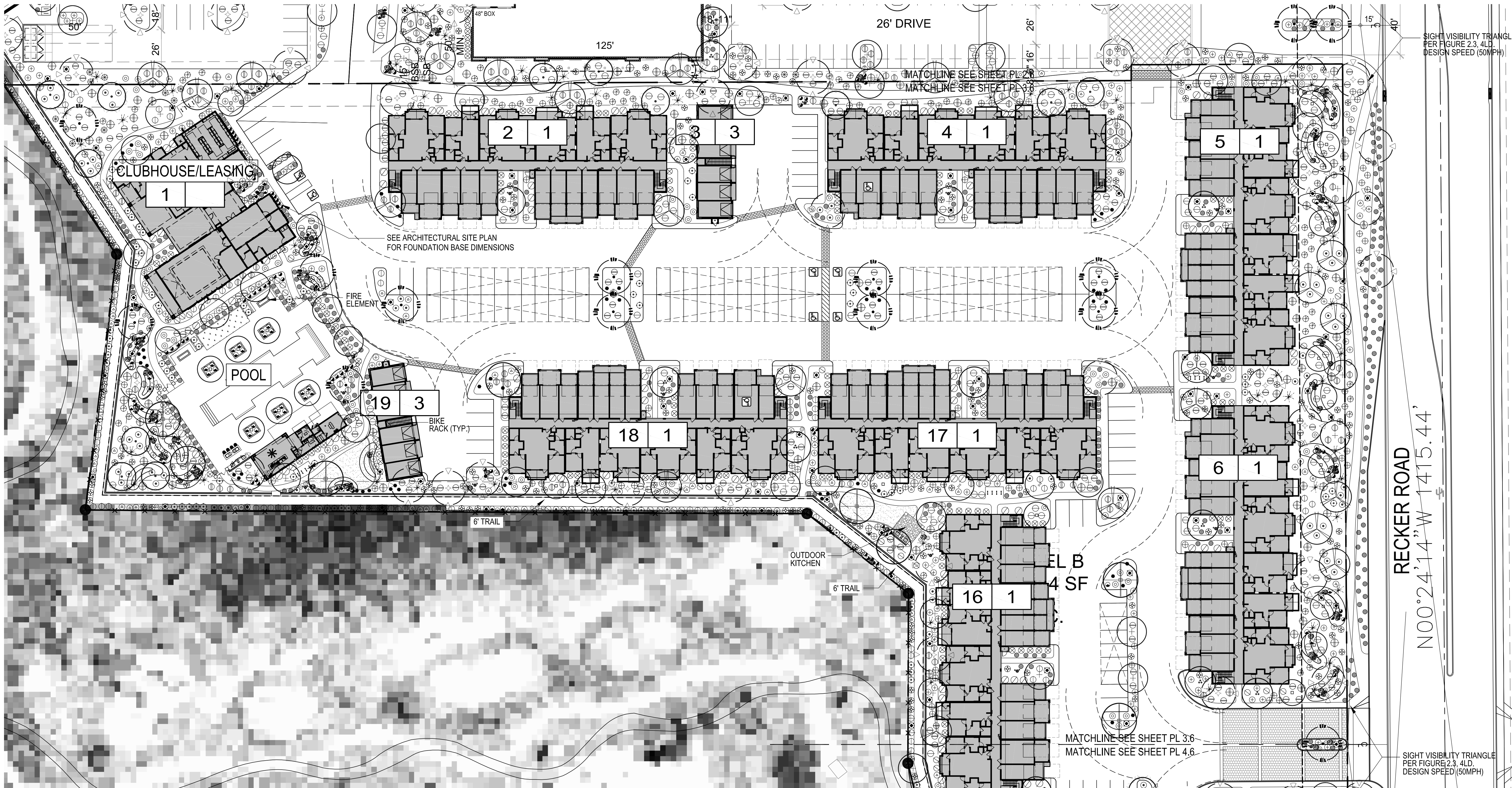

**biltform**  
landscape  
architecture

biltform landscape  
architecture group,  
inc.

11460 North Cave Creek Rd. suite 6  
phoenix . arizona 85020  
Phone 602.285.9200 Fax 602.285.9229  
email: dave@biltform.com

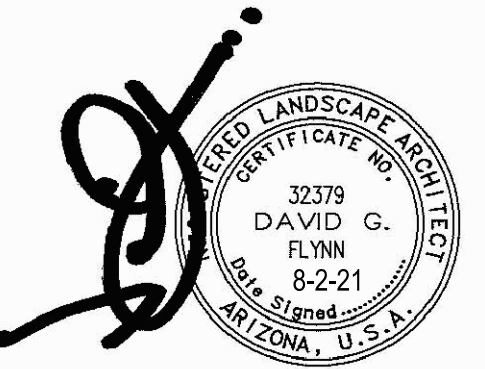

**ASCEND at LONGBOW HIGHPOINT**  
MIXED USE PROJECT  
CITY OF MESA, ARIZONA

**D. HORTON**  
America's Builder

1341 Horton Circle  
Arlington, Texas 76001

Phone: (817) 390-8264

**PLANT LEGEND**

TREES	SPECIFICATION	SHRUBS	SIZE	SHRUBS	SIZE	CACTI & SUCCULENTS	SIZE	GROUNDCOVERS	SIZE	LANDSCAPE MATERIALS	
<i>Parkinsonia florida</i> Blue Palo Verde	2.25" Cal. 9'H x 6'W 3.50" Cal. 12'H x 10'W	<i>Ambrosia deltoidea</i> Triangle Leaf Bursage	5 Gallon	<i>Salvia coccinea</i> Cherry Red Sage	5 Gallon	<i>Aloe barbadensis</i> Medicinal Aloe	1 Gallon	<i>Lantana montevidensis</i> Purple Trailing Lantana	1 Gallon	<i>Decomposed granite (Site)</i> Desert Gold Pioneer Materials	3/4" Mixed 2" Depth
<i>Chilopsis linearis</i> Desert Willow	2.0" Cal. 8'H x 7'W Double Stake	<i>Anisacanthus thumberi</i> Desert Honeysuckle	5 Gallon	<i>Buddleia marrubifolia</i> Woolly Butterfly Bush	5 Gallon	<i>Aloe saponaria</i> African Aloe	1 Gallon	<i>Baccharis Cv. "Centennial"</i> Centennial Baccharis	1 Gallon	<i>Decomposed granite (Trail)</i> Desert Gold Pioneer Materials	1/4" Minus 3" Depth Compacted
<i>Prosopis glandulosa</i> Thornless Honey Mesquite	2.0" Cal. 9'H x 7'W 3.50" Cal. 12'H x 10'W	<i>Calliandra californica</i> Baja Red Fairy Duster	5 Gallon	<i>Caesalpinia pulcherrima</i> Red Bird of Paradise	5 Gallon	<i>Hesperaloe parviflora</i> Red Yucca	5 Gallon	<i>Verbena goodingii</i> Gooding's Verbena	1 Gallon	<i>Concrete header</i> Extruded	4" x 6"
<i>Prosopis velutina</i> Arizona Mesquite	2.50" Cal. 8'H x 6'W Double Stake	<i>Chrysactina mexicana</i> Damianita	5 Gallon	<i>Senna phyllodinea</i> Silver Leaf Senna	5 Gallon	<i>Carnegiea gigantea</i> Saguaro	5' Spear	<i>Cynodon dactylon</i> Midiron Hybrid	Sod	<i>Steel header (Trail)</i>	1/2" x 8"
<i>Pithecolobium flexicaule</i> Texas Ebony	2.0" Cal. 9'H x 6'W Double Stake	<i>Dalea pulchra</i> Indigo Bush	5 Gallon	<i>Cordia boissieri</i> Anacahuita	5 Gallon	<i>Dasylirion wheeleri</i> Desert Spoon	5 Gallon	<i>Synthetic turf "Easyturf"</i>	Nutmeg Lush	<i>Boulders</i> Decomposed Granite Surface Select	3'x3'x3' 2'x2'x2' 1'x1'x1'
<i>Olneya tesota</i> Ironwood	8'H x 5'W Multi Trunk	<i>Encelia farinosa</i> Brittlebush	5 Gallon	<i>Dodonea viscosa</i> Green Hopbush	5 Gallon	<i>Ferocactus wislizenii</i> Fishhook Barrel Cactus	2' Height				
<i>Parkinsonia praecox</i> Palo Brea	2.25" Cal. 9'H x 6'W Double Stake	<i>Justicia californica</i> Chuparosa	5 Gallon	<i>Larrea tridentata</i> Creosote Bush	5 Gallon	<i>Fouquieria splendens</i> Ocotillo	6'- 8' Canes 8 Cane Minimum				
<i>Acacia Salicina</i> Willow Acacia	2.25" Cal. 9'H x 6'W Double Stake	<i>Ruellia Peninsularis</i> Desert Ruellia	5 Gallon	<i>Leucophyllum laevigatum</i> Chihuahuan Sage	5 Gallon	<i>Echinocactus grusonii</i> Golden Barrel Cactus	12" Diameter Matching				
<i>Ungnadia speciosa</i> Mexican Buckeye	2.25" Cal. 9'H x 6'W Double Stake	<i>Salvia clevelandi</i> Chaparral Sage	5 Gallon	<i>Tecoma hybrid</i> Orange Jubilee	5 Gallon						
		<i>Muhlenbergia capillaris</i> Regal Mist Deer Grass	5 Gallon								

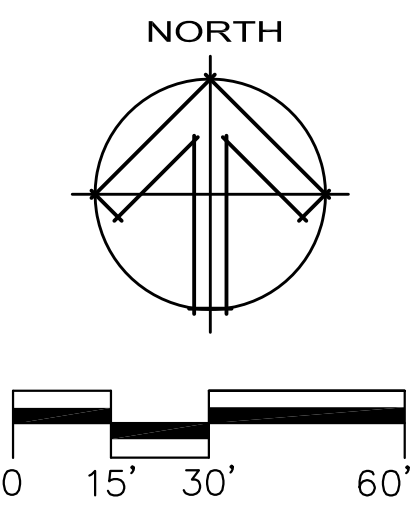

PRELIMINARY LANDSCAPE PLAN

**PL 3.6**

3 of 6

© BILTFORM ARCHITECTURE GROUP, INC.

REVISIONS:

	3rd City Review	Comments 9-29-21
	4th City Review	Comments 10-20-21

JOB NO: 21-031  
DATE: JULY 26, 2021  
SCALE: 1" = 30'-0"  
SHEET NO:

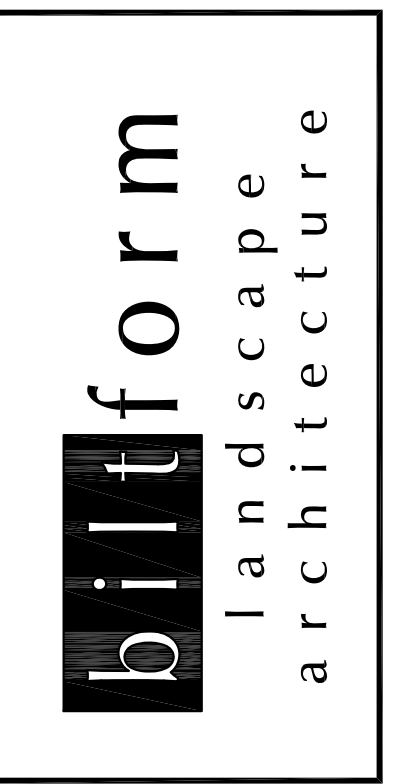

biltform landscape architecture group, inc.  
 11460 North Cave Creek Rd. suite 6  
 phoenix, arizona 85020  
 Phone 602.285.9200 Fax 602.285.9209  
 email: dave@biltform.com

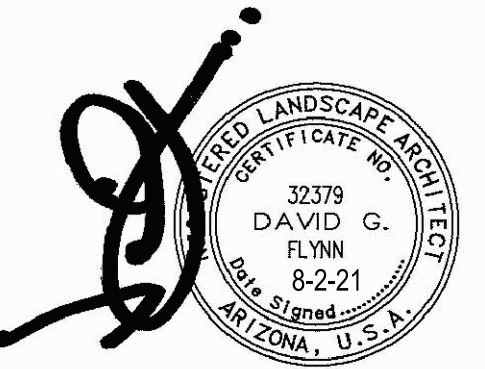

**ASCEND at LONGBOW HIGHPOINT**  
 MIXED USE PROJECT  
 CITY OF MESA, ARIZONA

**D. HORTON**  
 America's Builder

1341 Horton Circle  
 Arlington, Texas 76001  
 Phone: (817) 390-8264



**PLANT LEGEND**

TREES	SPECIFICATION	SHRUBS	SIZE	SHRUBS	SIZE	CACTI & SUCCULENTS	SIZE	GROUNDCOVERS	SIZE	LANDSCAPE MATERIALS	
<i>Parkinsonia florida</i> Blue Palo Verde	2.25" Cal. 9'H x 6'W 3.50" Cal. 12'H x 10'W	<i>Ambrosia deltoidea</i> Triangle Leaf Bursage	5 Gallon	<i>Salvia coccinea</i> Cherry Red Sage	5 Gallon	<i>Aloe barbadensis</i> Medicinal Aloe	1 Gallon	<i>Lantana montevidensis</i> Purple Trailing Lantana	1 Gallon	<i>Decomposed granite(Site)</i> Desert Gold Pioneer Materials	3/4" Mixed 2" Depth
<i>Chilopsis linearis</i> Desert Willow	2.0" Cal. 8'H x 7'W Double Stake	<i>Anisacanthus thurberi</i> Desert Honeysuckle	5 Gallon	<i>Buddleia marrubifolia</i> Woolly Butterfly Bush	5 Gallon	<i>Aloe saponaria</i> African Aloe	1 Gallon	<i>Baccharis Cv. "Centennial"</i> Centennial Baccharis	1 Gallon	<i>Decomposed granite(Trail)</i> Desert Gold Pioneer Materials	1/4" Minus 3" Depth Compacted
<i>Prosopis glandulosa</i> Thornless Honey Mesquite	2.0" Cal. 9'H x 7'W 3.50" Cal. 12'H x 10'W	<i>Calliandra californica</i> Baja Red Fairy Duster	5 Gallon	<i>Caesalpinia pulcherrima</i> Red Bird of Paradise	5 Gallon	<i>Hesperaloe parviflora</i> Red Yucca	5 Gallon	<i>Verbena goodingii</i> Gooding's Verbena	1 Gallon	<i>Concrete header</i> Extruded	4" x 6"
<i>Prosopis velutina</i> Arizona Mesquite	2.50" Cal. 8'H x 6'W Double Stake	<i>Chrysactina mexicana</i> Damiania	5 Gallon	<i>Senna phyllodinea</i> Silver Leaf Senna	5 Gallon	<i>Carnegiea gigantea</i> Saguaro	5' Spear	<i>Cynodon dactylon</i> Midiron Hybrid	Sod	<i>Steel header (Trail)</i>	1/2" x 8"
<i>Pithecellobium flexicaule</i> Texas Ebony	2.0" Cal. 9'H x 6'W Double Stake	<i>Dalea pulchra</i> Indigo Bush	5 Gallon	<i>Cordia boissieri</i> Anacahuita	5 Gallon	<i>Dasyliiron wheeleri</i> Desert Spoon	5 Gallon	<i>Synthetic turf</i> "Easyturf"	Nutmeg Lush	<i>Boulders</i> Decomposed Granite Surface Select	3'x3'x3' 2'x2'x2' 1'x1'x1'
<i>Olneya tesota</i> Ironwood	8'H x 5'W Multi Trunk	<i>Encelia farinosa</i> Brittlebush	5 Gallon	<i>Dodonea viscosa</i> Green Hopbush	5 Gallon	<i>Ferocactus wislizenii</i> Fishhook Barrel Cactus	2' Height				
<i>Parkinsonia praecox</i> Palo Brea	2.25" Cal. 9'H x 6'W Double Stake	<i>Justicia californica</i> Chuparosa	5 Gallon	<i>Larrea tridentata</i> Creosote Bush	5 Gallon	<i>Fouquieria splendens</i> Ocotillo	6'-8' Canes 8 Cane Minimum				
<i>Acacia Salicina</i> Willow Acacia	2.25" Cal. 9'H x 6'W Double Stake	<i>Ruellia Peninsularis</i> Desert Ruellia	5 Gallon	<i>Leucophyllum laevigatum</i> Chihuahuan Sage	5 Gallon	<i>Echinocactus grusonii</i> Golden Barrel Cactus	12" Diameter Matching				
<i>Ungnadia speciosa</i> Mexican Buckeye	2.25" Cal. 9'H x 6'W Double Stake	<i>Salvia clevelandi</i> Chaparral Sage	5 Gallon	<i>Tecoma hybrid</i> Orange Jubilee	5 Gallon						
		<i>Muhlenbergia capillaris</i> Regal Mist Deer Grass	5 Gallon								

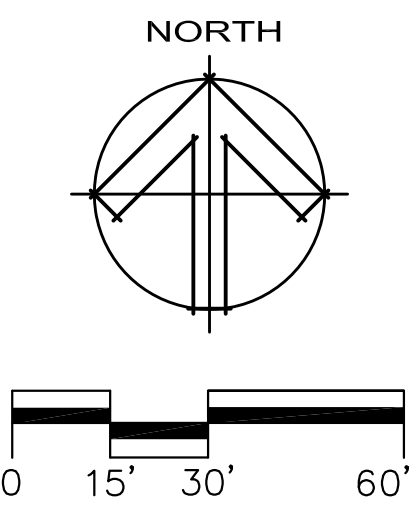

REVISIONS:

△	3rd City Review	Comments 9-29-21
△	4rd City Review	Comments 10-20-21
△		
△		
△		

JOB NO: 21-031  
 DATE: JULY 26, 2021  
 SCALE: 1" = 30'-0"  
 SHEET NO:

**PL 4.6**

**PRELIMINARY LANDSCAPE PLAN**

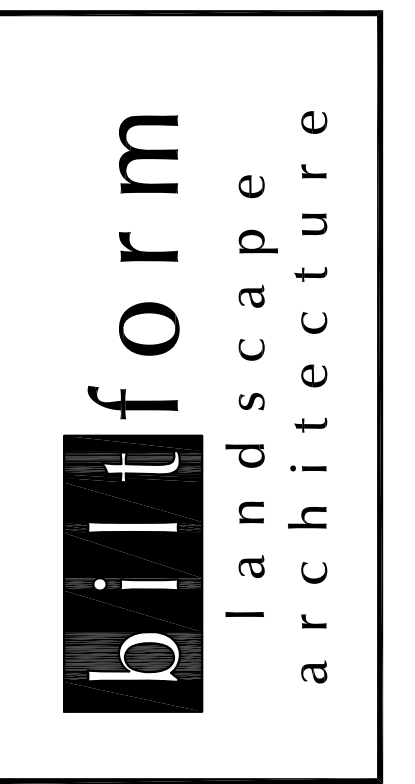

biltform landscape architecture group, inc.  
 11460 North Cave Creek Rd. suite 6  
 phoenix, arizona 85020  
 Phone 602.285.9200 Fax 602.285.9229  
 email: dave@biltform.com

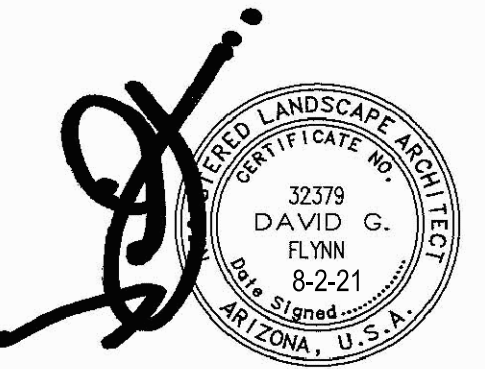

**ASCEND at LONGBOW HIGHPOINT**  
 MIXED USE PROJECT  
 CITY OF MESA, ARIZONA  
**D. HORTON** P.E.  
*America's Builder*  
 Phone: (817) 390-8264  
 PROJECT OWNER: 1341 Horton Circle, Arlington, Texas 76001

REVISIONS:  
 3rd City Review Comments 9-29-21  
 4th City Review Comments 10-20-21  
 JOB NO: 21-031  
 DATE: JULY 26, 2021  
 SCALE: 1" = 30'-0"  
 SHEET NO: **PL 5.6**

5 of 6  
 © BILTFORM ARCHITECTURE GROUP, INC.



**PLANT LEGEND**

TREES	SPECIFICATION	SHRUBS	SIZE	SHRUBS	SIZE	CACTI & SUCCULENTS	SIZE	GROUNDCOVERS	SIZE	LANDSCAPE MATERIALS	
<i>Parkinsonia florida</i> Blue Palo Verde	2.25" Cal. 9'H x 6'W 3.50" Cal. 12'H x 10'W	<i>Ambrosia deltoidea</i> Triangle Leaf Bursage	5 Gallon	<i>Salvia coccinea</i> Cherry Red Sage	5 Gallon	<i>Aloe barbadensis</i> Medicinal Aloe	1 Gallon	<i>Lantana montevidensis</i> Purple Trailing Lantana	1 Gallon	<i>Decomposed granite(Site)</i> Desert Gold Pioneer Materials	3/4" Mixed 2" Depth
<i>Chilopsis linearis</i> Desert Willow	2.0" Cal. 8'H x 7'W Double Stake	<i>Anisacanthus thumberi</i> Desert Honeysuckle	5 Gallon	<i>Buddleia marrubifolia</i> Woolly Butterfly Bush	5 Gallon	<i>Aloe saponaria</i> African Aloe	1 Gallon	<i>Baccharis Cv. "Centennial"</i> Centennial Baccharis	1 Gallon	<i>Decomposed granite(Trail)</i> Desert Gold Pioneer Materials	1/4" Minus 3" Depth Compacted
<i>Prosopis glandulosa</i> Thornless Honey Mesquite	2.0" Cal. 9'H x 7'W 3.50" Cal. 12'H x 10'W	<i>Calliandra californica</i> Baja Red Fairy Duster	5 Gallon	<i>Caesalpinia pulcherrima</i> Red Bird of Paradise	5 Gallon	<i>Hesperaloe parviflora</i> Red Yucca	5 Gallon	<i>Verbena goodingii</i> Gooding's Verbena	1 Gallon	<i>Concrete header</i> Extruded	4"x 6"
<i>Prosopis velutina</i> Arizona Mesquite	2.50" Cal. 8'H x 6'W Double Stake	<i>Chrysactinia mexicana</i> Damianita	5 Gallon	<i>Senna phyllodinea</i> Silver Leaf Senna	5 Gallon	<i>Carnegiea gigantea</i> Saguaro	5' Spear	<i>Cynodon dactylon</i> Midiron Hybrid	Sod	<i>Steel header (Trail)</i>	1/2" x 8"
<i>Pithecellobium flexicaule</i> Texas Ebony	2.0" Cal. 9'H x 6'W Double Stake	<i>Dalea pulchra</i> Indigo Bush	5 Gallon	<i>Cordia boissieri</i> Anacahuitta	5 Gallon	<i>Dasyliiron wheeleri</i> Desert Spoon	5 Gallon	<i>Synthetic turf</i> "Easyturf"	Nutmeg Lush	<i>Boulders</i> Decomposed Granite Surface Select	3'x3'x3' 2'x2'x2' 1'x1'x1'
<i>Olneya tesota</i> Ironwood	8'H x 5'W Multi Trunk	<i>Encelia farinosa</i> Brittlebush	5 Gallon	<i>Dodonaea viscosa</i> Green Hopbush	5 Gallon	<i>Ferocactus wislizenii</i> Fishhook Barrel Cactus	2' Height				
<i>Parkinsonia praecox</i> Palo Brea	2.25" Cal. 9'H x 6'W Double Stake	<i>Justicia californica</i> Chuparosa	5 Gallon	<i>Larrea tridentata</i> Creosote Bush	5 Gallon	<i>Fouquieria splendens</i> Ocotillo	6'- 8' Canes 8 Cane Minimum				
<i>Acacia Salicina</i> Willow Acacia	2.25" Cal. 9'H x 6'W Double Stake	<i>Ruellia Peninsularis</i> Desert Ruellia	5 Gallon	<i>Leucophyllum laevigatum</i> Chihuahuan Sage	5 Gallon	<i>Echinocactus grusonii</i> Golden Barrel Cactus	12" Diameter Matching				
<i>Ungnadia speciosa</i> Mexican Buckeye	2.25" Cal. 9'H x 6'W Double Stake	<i>Salvia clevelandi</i> Chaparral Sage	5 Gallon	<i>Tecoma hybrid</i> Orange Jubilee	5 Gallon						
		<i>Muhlenbergia capillaris</i> Regal Mist Deer Grass	5 Gallon								

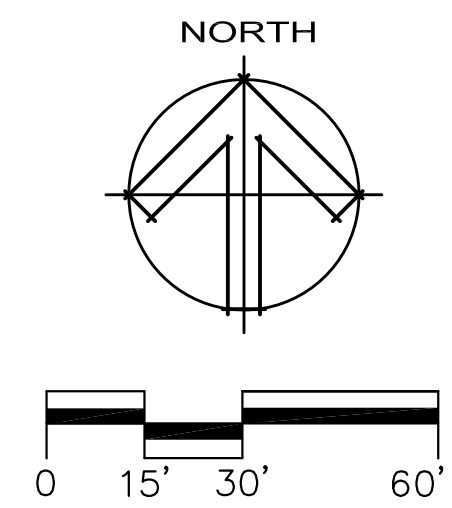

**PRELIMINARY LANDSCAPE PLAN**

