

GUADALUPE & POWER RETAIL

SITE ELECTRICAL

MESA, ARIZONA

GENERAL ELECTRICAL NOTES

1. ELECTRICAL WORK SHALL COMPLY WITH THE NATIONAL ELECTRIC CODE (LATEST EDITION), FEDERAL, STATE AND LOCAL JURISDICTION CODES.
2. ALL WORK SHALL BE DONE IN A NEAT, WORKMANLIKE, FINISHED AND SAFE MANNER, ACCORDING TO THE LATEST PUBLISHED NATIONAL ELECTRICAL CONTRACTORS ASSOCIATION STANDARDS OF INSTALLATION, UNDER COMPETENT SUPERVISION.
3. VISIT THE SITE PRIOR TO BIDDING TO BECOME FAMILIAR WITH EXISTING CONDITIONS AND ALL OTHER FACTORS WHICH MAY AFFECT THE EXECUTION OF THIS WORK. INCLUDE ALL RELATED COSTS IN THE INITIAL BID PROPOSAL.
4. CONTRACTOR IS RESPONSIBLE FOR VERIFYING LOCATIONS OF ALL EXISTING UTILITIES AND AVOIDING DAMAGE TO SAME. CONTRACTOR TO CALL 811 FOR BLUE STAKE. FOR ALL MUNICIPAL OR PRIVATELY OWNED UTILITIES EXISTING WITHIN LIMITS OF WORK OF PROJECT, CONTRACTOR TO PRIVATELY LOCATE UTILITIES. IRRIGATION LINES LESS THAN 2" WILL NOT TYPICALLY BE MARKED AND CAUTION SHOULD BE USED TO AVOID DAMAGE. CONTRACTOR SHALL BE RESPONSIBLE FOR DAMAGE TO ALL UTILITIES CAUSED AS A RESULT OF CONTRACT WORK, ALL DAMAGES TO BE REPAIRED IN KIND.
5. CONTRACTOR SHALL BE RESPONSIBLE FOR DAMAGE TO EXISTING WALKS, WALLS, DRIVES, CURBS, ETC. DAMAGES SHALL BE REPAIRED BY THE CONTRACTOR TO THE SATISFACTION OF THE OWNER AT NO ADDITIONAL COST TO THE OWNER.
6. PROPER PROTECTION OF THE CONSTRUCTION AREA FOR SAFETY SHALL BE THE RESPONSIBILITY OF THE CONTRACTOR. COVER ALL TRENCHES AT THE END OF EACH WORK DAY. BARRICADES SHALL BE INSTALLED AS DIRECTED BY THE OWNER OR THE PROJECT INSPECTOR. THE SITE AND ALL WORK SHALL CONFORM TO OSHA REQUIREMENTS.
7. ALL EXISTING LANDSCAPE, HARDSCAPE AND SPRINKLER SYSTEMS DAMAGED OR DISTURBED DURING THE CONSTRUCTION OF THIS PROJECT BY THE CONTRACTOR SHALL BE REPLACED IN KIND.
8. CONTRACTOR SHALL PAY FOR PERMITS AND INSPECTIONS AS MAY BE REQUIRED AND PROVIDE A CERTIFICATE OF INSPECTION TO THE OWNER.
9. PROTECT ALL MATERIAL AND EQUIPMENT INSTALLED AGAINST DAMAGE BY OTHER TRADES, WEATHER CONDITIONS OR ANY OTHER CAUSES. EQUIPMENT FOUND DAMAGED OR IN OTHER THAN NEW CONDITION WILL BE REJECTED AS DEFECTIVE. ALL COMPONENTS SHALL BE FREE OF DUST, GRIT AND FOREIGN MATERIALS, AND LEFT AS NEW BEFORE FINAL ACCEPTANCE OF WORK.
10. LEAVE THE SITE CLEAN, REMOVE ALL DEBRIS, EMPTY CARTONS, TOOLS, CONDUIT, WIRE SCRAPS AND ALL MISCELLANEOUS SPARE EQUIPMENT AND MATERIALS USED IN THE WORK DURING CONSTRUCTION.
11. IT IS THE OBLIGATION OF THE CONTRACTOR TO ORGANIZE HIS WORK SO THAT A COMPLETE ELECTRICAL, INSTRUMENTATION, AND/OR CONTROL SYSTEM FOR THE FACILITY WILL BE PROVIDED AND SUPPORTED BY ACCURATE SHOP AND RECORD DRAWINGS, AND ALL O & M MANUALS.
12. ALL UNDERGROUND CONDUIT SHALL BE SCHEDULE 40 PVC, BURIED 24" MINIMUM BELOW FINISHED GRADE, UNLESS SPECIFICALLY NOTED OTHERWISE ON PLANS OR IN DETAILS.
13. PROVIDE EMT INDOOR AND GRS OUTDOOR FOR ABOVE GROUND CONDUIT. WHERE METALLIC CONDUITS COME IN CONTACT WITH DIRT, THEY SHALL BE HALF LAP WRAPPED WITH SCOTCH 50 TAPE TO 12" AFG. FITTINGS SHALL BE STEEL, THREADED TYPE WITH INSULATED THROATS. SECURELY ATTACH ALL SURFACE MOUNTED CONDUIT EVERY 10 FEET AND WITHIN 3 FEET OF EACH JUNCTION BOX, PER NEC ARTICLE 344.30.
14. MINIMUM CONDUIT SIZE SHALL BE 3/4" UNLESS SPECIFICALLY NOTED OTHERWISE ON PLANS OR IN DETAILS.
15. ALL FEEDERS AND BRANCH CIRCUIT WIRE SHALL BE COPPER TYPE XHHW (75 DEGREE C) FOR BELOW GRADE INSTALLATIONS (AND CONDUIT RISERS) AND THHN/THWN (75 DEGREE C) FOR ABOVE GRADE INSTALLATIONS. MINIMUM SIZE SHALL BE #12 AWG, UNLESS SPECIFICALLY NOTED OTHERWISE ON PLANS OR IN DETAILS. ALL WIRING SHALL BE IN CONDUIT. FOR NEW WIRING IN COMMERCIAL APPLICATIONS, THE USE OF TYPES NM, NMC, (ROMEX) CABLES IS NOT PERMITTED. ALL CONDUCTORS SHALL BE NEW UNLESS NOTED OTHERWISE IN PLANS.
16. A SEPARATE GREEN INSULATED EQUIPMENT GROUNDING CONDUCTOR (BOND) SHALL BE INSTALLED WITHIN EACH RACEWAY, INCLUDING WITHIN EMT CONDUIT. EQUIPMENT GROUNDING CONDUCTOR SHALL BE SIZED PER NEC TABLE 250.122.
17. WHEN A PANEL IS SUPPLIED BY A FEEDER OR BRANCH CIRCUIT, ANY INSTALLED GROUNDED CONDUCTOR SHALL NOT BE CONNECTED TO THE EQUIPMENT GROUNDING CONDUCTOR (GEC) OR TO THE GROUNDING ELECTRODE(S) PER NEC ARTICLE 250.32(B).
18. BOND ALL ENCLOSURES PER NEC ARTICLE 250.96.
19. CONTRACTOR SHALL PROVIDE ALL LABOR, MATERIAL, ETC. NECESSARY FOR A COMPLETE AND WORKABLE ELECTRICAL SYSTEM WHETHER OR NOT THESE ITEMS ARE SPECIFICALLY NOTED ON THESE DRAWINGS. INCIDENTAL ITEMS NOT INDICATED ON THE DRAWINGS, NOR MENTIONED IN SPECIFICATIONS THAT CAN BE LEGITIMATELY AND REASONABLY INFERRED TO BELONG TO THE WORK DESCRIBED OR BE NECESSARY IN GOOD PRACTICE TO PROVIDE A COMPLETE SYSTEM, SHALL BE FURNISHED AND INSTALLED AS THOUGH ITEMIZED HERE IN EVERY DETAIL.
20. CONTRACTOR IS RESPONSIBLE FOR AND SHALL PROVIDE ALL LABOR, MATERIAL, TRENCHING, CONDUIT, TRANSFORMER PAD AND OTHER REQUIRED EQUIPMENT PER UTILITY COMPANY PLANS AND SPECIFICATIONS NECESSARY FOR A COMPLETE UNDERGROUND CONDUIT SYSTEM FROM THE UTILITY POINT OF SERVICE TO THE UTILITY CO. TRANSFORMER AND FROM THE UTILITY CO. TRANSFORMER TO THE ELECTRICAL SERVICE ENTRANCE SECTION.
21. ALL TRENCHING, CONDUITS, ETC. SHALL BE ROUTED AND INSTALLED IN SUCH A MANNER THAT WILL NOT DAMAGE EXISTING FACILITIES. SHOULD DAMAGE OCCUR, IT WILL BE THE CONTRACTORS RESPONSIBILITY TO REPAIR DAMAGE TO THE SATISFACTION OF THE OWNER OR INSPECTOR.
22. ALL CONDUIT RUNS SHOWN ON THIS PLAN ARE SCHEMATIC IN NATURE. THE CONTRACTOR SHALL MAKE SURE THAT ALL CONDUIT, ETC. FALLS WITHIN THE CONSTRUCTION AREA/RIGHT OF WAY. (THIS INCLUDES MAINTAINING ALL REQUIRED CLEARANCES.)
23. WHEN CROSSING PATHWAYS OR SIDEWALKS, CONTRACTOR SHALL BORE UNDER EXISTING CONCRETE WALKS AND SAWCUT ASPHALT WALKS. ASPHALT WALKS SHALL BE REPLACED IN KIND.
24. CONTRACTOR SHALL GUARANTEE WORK INSTALLED UNDER THE CONTRACT TO BE FREE FROM DEFECTIVE WORKMANSHIP AND MATERIALS, USUAL WEAR EXCEPTED, AND SHOULD ANY SUCH DEFECTS DEVELOP WITHIN A PERIOD OF ONE YEAR AFTER ACCEPTANCE OF THE PROJECT BY THE OWNER, THE CONTRACTOR SHALL REPAIR AND/OR REPLACE ANY DEFECTIVE ITEMS AND DAMAGE RESULTING FROM FAILURE OF THESE ITEMS, AT NO EXPENSE WHATSOEVER TO THE OWNER.

25. CONTRACTOR SHALL IDENTIFY SERVICE ENTRANCE SECTION MAIN SERVICE DISCONNECT(S) WITH 3/32-INCH THICK LAMINATED PHENOLIC TYPE NAMEPLATES WITH 1/4-INCH MINIMUM HEIGHT LETTERS. NAMEPLATE TO BE BLACK MATTE FINISH SURFACE WITH WHITE LETTER ENGRAVING. ATTACH NAMEPLATE TO THE OUTSIDE PANEL FACE WITH TWO STAINLESS STEEL SELF-TAPPING SCREWS. NAMEPLATE SHALL READ "SERVICE DISCONNECT" PER NEC ARTICLE 230.70(B).
26. ALL CIRCUITS SHALL BE LEGIBLY IDENTIFIED AT THE PANEL, JUNCTION BOXES AND AT ALL EQUIPMENT IN A PERMANENT MANNER (I.E. ETCHED PLATES, CONDUCTOR TAG, PERMANENT MARKER, ETC.). THE LABELING SHALL INCLUDE PANEL CIRCUIT NUMBER, "TO" AND "FROM" IDENTIFICATION, AND MARKED "SPARE" WHERE APPLICABLE.
27. CONTRACTOR SHALL TEST ELECTRICAL SYSTEM FOR SHORT CIRCUITS AND MEGGER TEST FEEDER CIRCUIT WIRING. PROVIDE CERTIFIED TEST RESULTS FOR MEGGER TEST TO OWNER UPON COMPLETION OF PROJECT.
28. CONTRACTOR SHALL PERFORM HIGH POTENTIAL (HIPOT) TESTING WHEN REQUIRED BY LOCAL JURISDICTION OR OWNER.
29. CONTRACTOR SHALL INSURE LOW IMPEDANCE GROUND PATH SYSTEM PER NEC ARTICLE 250.122.
30. CONTRACTOR SHALL PROVIDE A GROUND-FAULT COORDINATION STUDY AND PERFORM RECOMMENDED SETTINGS ON NEW (AND EXISTING) OVERCURRENT PROTECTION DEVICES, AS NEEDED OR WHEN REQUIRED BY LOCAL JURISDICTION OR OWNER. PROVIDE LABELS ON EQUIPMENT INDICATING SETTINGS.
31. CONTRACTOR SHALL PROVIDE AN ARC-FLASH STUDY WHEN REQUIRED BY LOCAL JURISDICTION OR OWNER. PROVIDE ALL APPLICABLE LABELS ON NEW (AND EXISTING) EQUIPMENT AFTER STUDY IS COMPLETED.
32. ALL CONDUIT SHOWN SHALL BE CONCEALED WHEN POSSIBLE. WHEN NOT POSSIBLE, CONDUIT MAY BE SURFACE MOUNTED WITH PERMISSION OF THE OWNER OR OWNER'S REPRESENTATIVE.
33. CONTRACTOR SHALL COORDINATE ALL EQUIPMENT CONNECTIONS WITH EQUIPMENT SUPPLIER PRIOR TO ROUGH-IN. PROVIDE ADDITIONAL FUSED DISCONNECT SWITCHES AND CONTROLS IF OVERCURRENT PROTECTION OR CONTROLS IS NOT INTEGRAL WITH UNITS.
34. ALL EQUIPMENT SHALL BE FUSE SIZED PER MANUFACTURERS RECOMMENDATIONS AND BEAR U.L. APPROVAL. COORDINATE WITH ENGINEER/OWNER.
35. ALL OUTDOOR ELECTRICAL EQUIPMENT SHALL BE NEMA-3R OR NEMA-4 ENCLOSURES.
36. CONDUITS OR RACEWAYS ROUTED FROM INDOORS TO OUTDOORS OR AS DESCRIBED IN NEC 300.7(A), SHALL BE SEALED WITH A PLIABLE SEALING COMPOUND AT A CONDUIT BODY OR AT A JUNCTION BOX BEFORE THE CONDUIT ENTERS THE COLDER ENVIRONMENT.
37. CONDUITS OR RACEWAYS INSTALLED IN AREAS WHERE ELEVATION CHANGES MAY CAUSE WATER OR MOISTURE TO ENTER THE ELECTRICAL EQUIPMENT THROUGH THE CONDUIT SHALL BE SEALED WITH A HERMETIC CONDUIT SEAL AT BOTH ENDS OF THE CONDUIT OR RACEWAY.
38. INSTALL FIRE SEALS IN ALL CONDUITS PENETRATING THE FIRE WALL TO MAINTAIN THE FIRE RESISTANCE RATING OF THE WALL, AS REQUIRED BY NEC 300.21.
39. ALL POLE LIGHTS SHALL BE PROVIDED WITH A TWO POLE FUSE HOLDER BUSSMANN #HEX OR A SINGLE POLE FUSE HOLDER BUSSMANN #HEB OR EQUAL FOR INLINE FUSING, PROVIDE 5 AMP FUSING IN FUSEHOLDER.
40. PRIOR TO POURING THE POLE BASES OR COVERING ANY ELECTRICAL CONDUITS, CONTACT THE INSPECTION DEPARTMENT 24 HOURS IN ADVANCE FOR APPROVAL.
41. MATERIALS SHALL BE NEW AND OF THE BEST QUALITY WITH MANUFACTURER'S NAME PRINTED THEREON. MATERIALS SHALL BE MANUFACTURED IN ACCORDANCE WITH NEMA, ANSI, UNDERWRITER'S LABORATORY OR OTHER APPLICABLE STANDARDS AND RATED FOR HEAVY DUTY SERVICE.
42. ALL WIRING DEVICES SHALL BE SPECIFICATION GRADE. ALL 15 AND 20 AMP, 125 AND 250 VOLT, NONLOCKING RECEPTACLES INSTALLED OUTDOORS SHALL BE LISTED WEATHER-RESISTANT TYPE. RECEPTACLE COVERS IN WET LOCATIONS SHALL BE EXTRA DUTY PER NEC 406.9(B). ALL WEATHERPROOF WHILE IN-USE RECEPTACLE COVERS SHALL BE METAL.
43. SELECTION OF MATERIALS SHALL BE IN STRICT ACCORDANCE WITH THE DRAWINGS AND/OR SPECIFICATIONS. THE USE OF MANUFACTURER'S NAME, MODEL, AND NUMBER IS INTENDED TO ESTABLISH STYLE, QUALITY, APPEARANCE, USEFULNESS AND BID PRICE. CONTRACTOR SHALL SUBMIT TO THE OWNER OR OWNER'S REPRESENTATIVE FOR REVIEW AND APPROVAL (PRIOR TO ORDERING MATERIALS) COPIES OF EQUIPMENT SHOP DRAWINGS AS FOLLOWS: LIGHT FIXTURES, POLES, POLE BASES, TIME CLOCKS AND OTHER CONTROLS, LIGHTING CONTACTORS AND PULL BOXES. AT THE TIME OF EACH SUBMITTAL, THE CONTRACTOR SHALL DEFINE AND DELINEATE IN WRITING ANY DEVIATIONS FROM THE CONTRACT DOCUMENTS. THE REVIEW WILL BE ONLY FOR CONFORMANCE WITH THE DESIGN CONCEPT OF THE WORK AND FOR COMPLIANCE WITH THE INFORMATION CONTAINED IN THE CONTRACT DOCUMENTS. THE REVIEW OF A SPECIFIED ITEM, AS SUCH, WILL NOT INDICATE REVIEW OF THE ASSEMBLY IN WHICH THE ITEM FUNCTIONS. REVIEW BY THE OWNER OR OWNER'S REPRESENTATIVE WILL NOT RELIEVE THE CONTRACTOR FROM RESPONSIBILITY FOR ANY ERRORS OR OMISSIONS IN THE SUBMITTALS NOR FROM HIS RESPONSIBILITY FOR COMPLYING WITH THE CONTRACT DOCUMENTS.

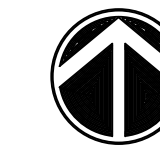
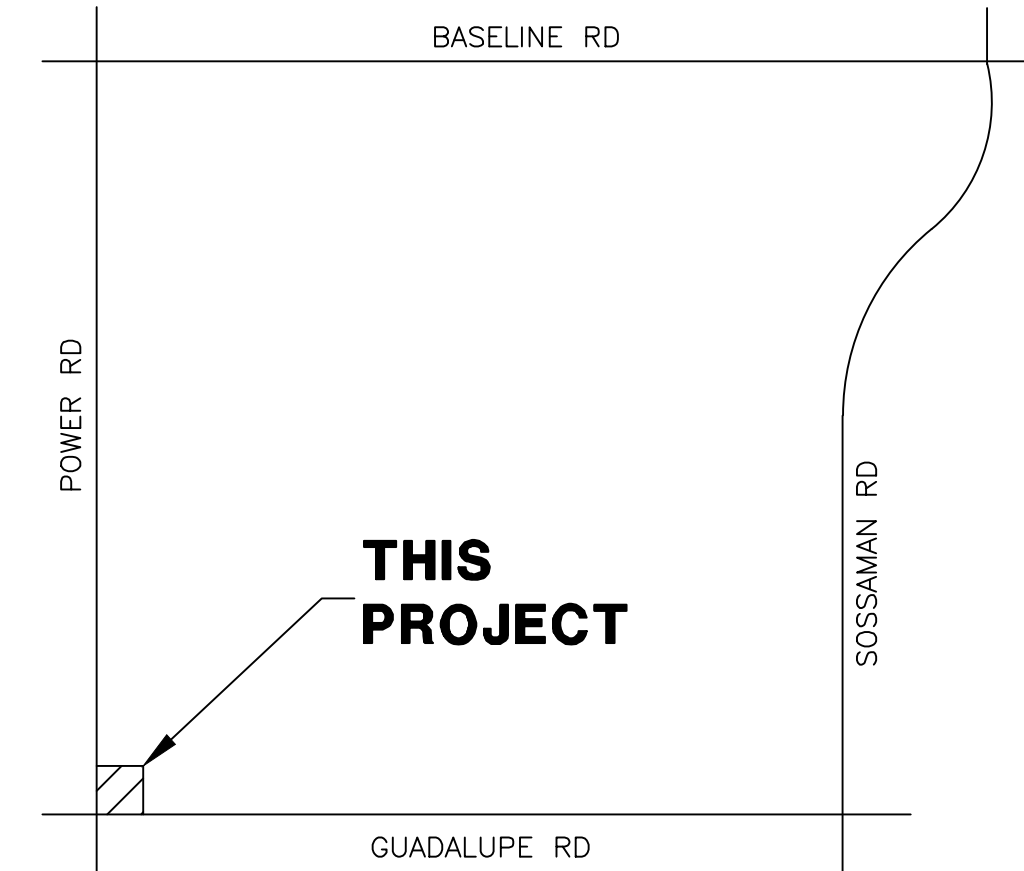

VICINITY MAP

NO SCALE

THESE DRAWINGS AND SPECIFICATIONS ARE THE SOLE PROPERTY OF WRIGHT ENGINEERING CORPORATION AND MAY NOT BE REPRODUCED OR MODIFIED FOR ANY USE WITHOUT THE EXPRESS WRITTEN PERMISSION OF WRIGHT ENGINEERING CORPORATION.
H:\2022\22590-Guadalupe & Power Retail Site Electrical\22590-SE.dwg

WRIGHT ENGINEERING
PROJECT NO:

22590

DESIGN BY: BKM

DRAWN BY: BKM

CHECKED BY:

WRIGHT
engineering corporation
ELECTRICAL ENGINEERING AND DESIGN
165 EAST CHILTON DRIVE • CHANDLER, ARIZONA 85225
PHONE 480.497.5829 • FAX 480.497.5807
www.wrightengineering.us

PROJECT: TITLE:

MESA, ARIZONA
GUADALUPE & POWER RETAIL
GUADALUPE RD & POWER RD
SITE ELECTRICAL COVER SHEET

NO. DATE SUBMITTALS/REVISIONS (DESCRIPTIONS)

| | | |
|---|----------|-----|
| 1 | 11-11-22 | DRB |
| 2 | 12-24-23 | DRB |
| 3 | 1-20-23 | DRB |

PRELIMINARY
NOT FOR
CONSTRUCTION

DRAWING NO:

SE1.1
OF 3



THESE DRAWINGS AND SPECIFICATIONS ARE THE SOLE PROPERTY OF WRIGHT ENGINEERING CORPORATION AND MAY NOT BE REPRODUCED OR MODIFIED FOR ANY USE WITHOUT THE EXPRESS WRITTEN PERMISSION OF WRIGHT ENGINEERING CORPORATION.
H:\2022\22590-Guadalupe & Power Retail Site Electrical\22590-SE.dwg

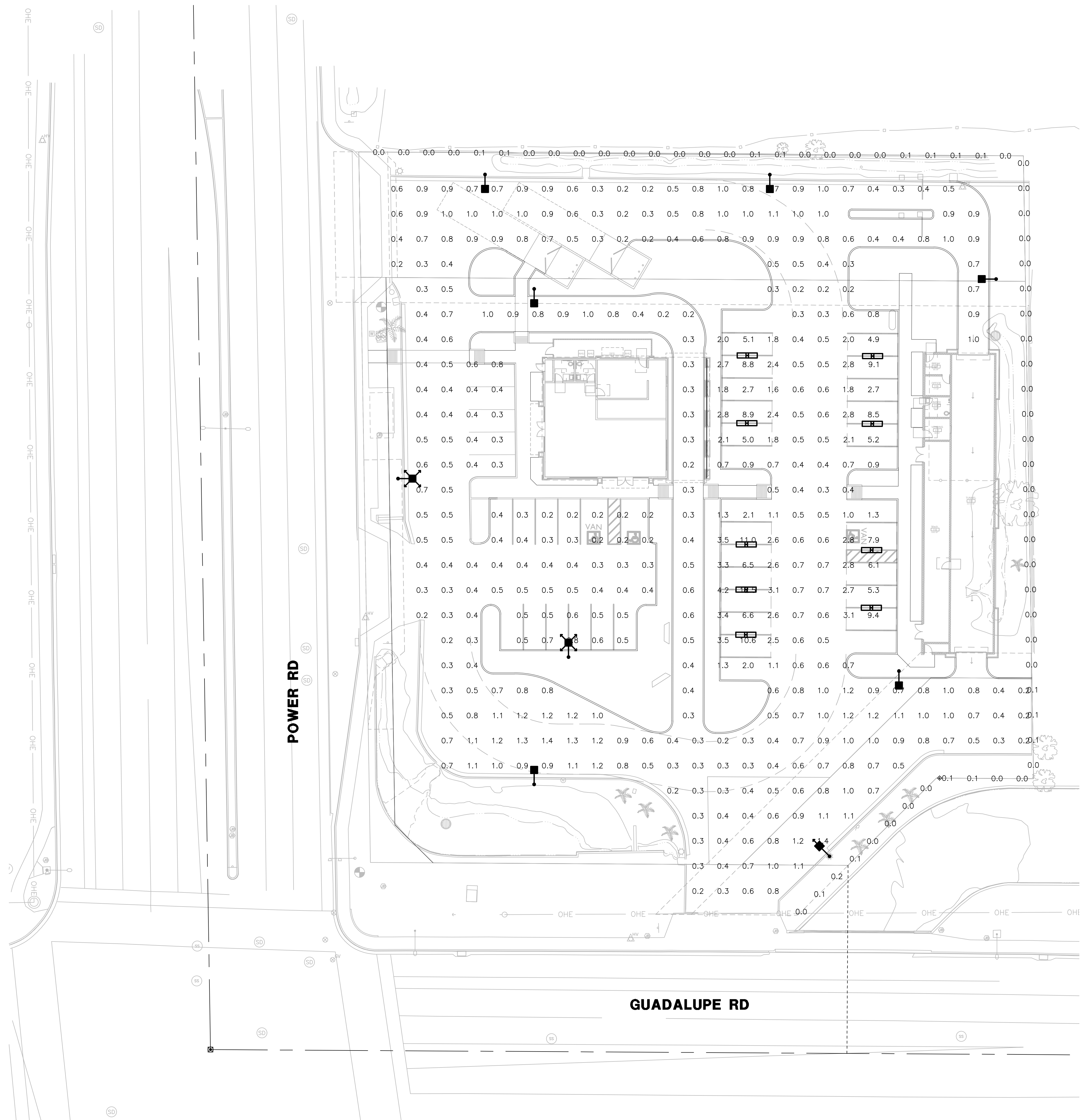



PHOTOMETRIC RESULTS

Parking Lot
358 points
HORIZONTAL FOOTCANDLES
Average 0.7
Maximum 9.4
Minimum 0.2
Avg:Min 3.47
Max:Min 47.00
Coef Var 0.92

Spill Light
63 points
HORIZONTAL FOOTCANDLES
Average 0.0
Maximum 0.2
Minimum 0.0
Avg:Min N/A
Max:Min N/A
Coef Var 1.77

Car Wash Vacuum Spaces
36 points at z=0, sp 10ft by 10ft
HORIZONTAL FOOTCANDLES
Average 4.9
Maximum 12.5
Minimum 1.8
Avg:Min 2.72
Max:Min 6.94
Coef Var 0.60
UnitGrad 3.57

PHOTOMETRIC LEGEND

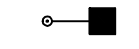
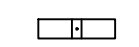
- 
 Parking Lot Light (T4)
 candela file 'GLAN-SA1A-730-U-SL4-HSS_3466 lumens.ies'
 16 lamp(s) per luminaire, photometry is absolute
 Light Loss factor = 0.910, watts per luminaire = 33
 mounting height= 20 ft
 number locations= 1, number luminaires= 1
 kw all locations= 0.0
- 
 Parking Lot Light (T5)
 candela file 'GLAN-SA1A-730-U-5WQ_4411 lumens.ies'
 16 lamp(s) per luminaire, photometry is absolute
 Light Loss factor = 0.910, watts per luminaire = 33
 mounting height= 20 ft
 number locations= 4, number luminaires= 4
 kw all locations= 0.1
- 
 Parking Lot Light (T3)
 candela file 'GLAN-SA1A-730-U-T3-HSS_3094 lumens.ies'
 16 lamp(s) per luminaire, photometry is absolute
 Light Loss factor = 0.910, watts per luminaire = 33
 mounting height= 20 ft
 number locations= 8, number luminaires= 8
 kw all locations= 0.3
- 
 Canopy Light
 candela file 'VPPF4 4FT 40W 40K CLP.ies'
 168 lamp(s) per luminaire, photometry is absolute
 Light Loss factor = 0.791, watts per luminaire = 42
 mounting height= 10 ft
 number locations= 9, number luminaires= 9
 kw all locations= 0.4

WRIGHT ENGINEERING
PROJECT NO:
22590
DESIGN BY: BKM
DRAWN BY: BKM
CHECKED BY:

WRIGHT
engineering corporation
ELECTRICAL ENGINEERING AND DESIGN
165 EAST CHILTON DRIVE • CHANDLER, ARIZONA 85225
PHONE 480.497.5829 • FAX 480.497.5807
www.wrightengineering.us

PROJECT: TITLE:

MESA, ARIZONA
GUADALUPE & POWER RETAIL
GUADALUPE RD & POWER RD
SITE ELECTRICAL PLAN

| NO. | DATE | SUBMITTALS/REVISIONS (DESCRIPTIONS) |
|-----|----------|-------------------------------------|
| 1 | 11-11-22 | DRB |
| 2 | 2-24-23 | DRB |
| 3 | 3-20-23 | DRB |

PRELIMINARY
NOT FOR
CONSTRUCTION

DRAWING NO:
SE2.1
OF 3

