

# Bond Project Update

Lance Webb, P.E., CFM – City Engineer

July 8, 2025

# Recap of Existing GO Bonds

## 2018 Bond

Public Safety - \$85M

Parks/Culture/Library - \$111M

## 2022 Bond

Public Safety - \$157M

## 2020 Bond

Transportation - \$100M

Additional \$62M of MAG  
Reimbursements

## 2024 Bond

Public Safety - \$90M

Parks and Culture - \$170M

## Construction Price Index In Relation to Bonds

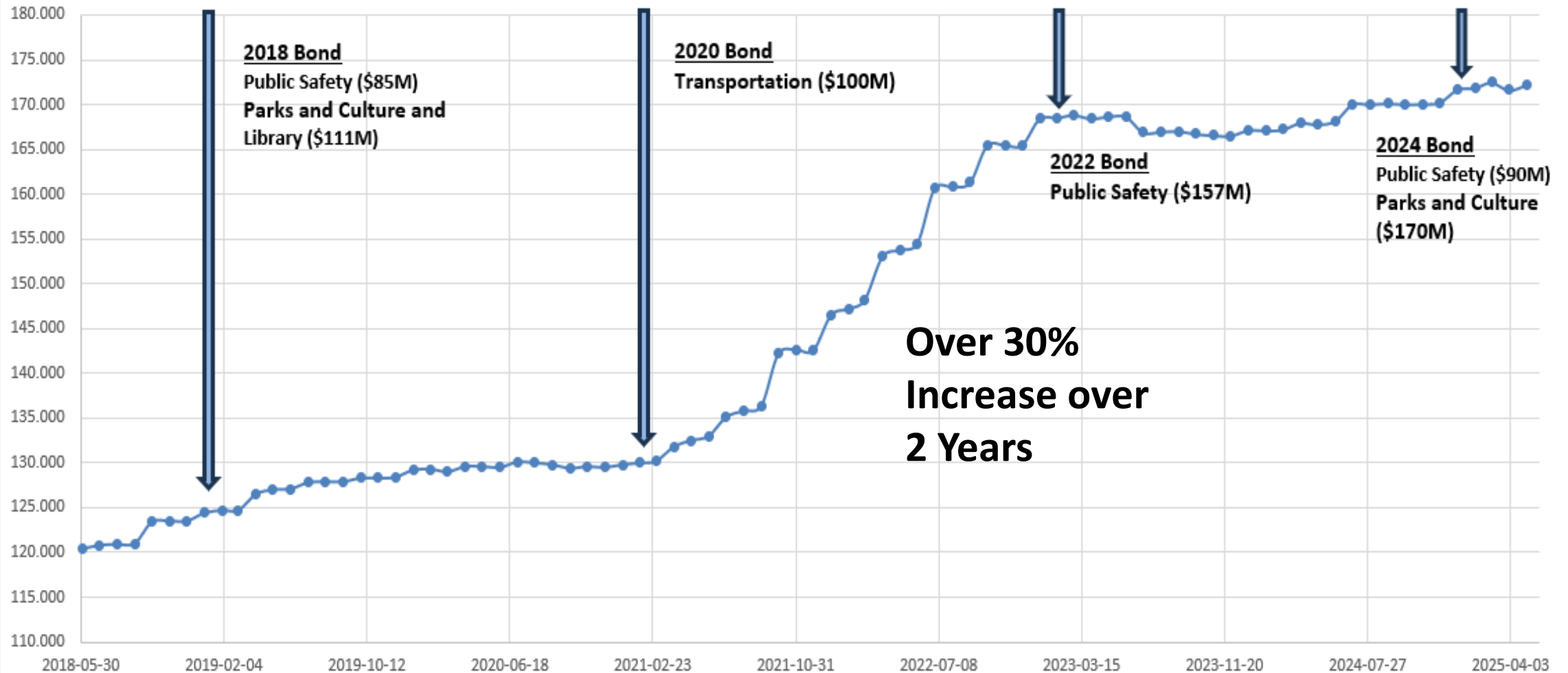

# 2018 Bond Project Summaries

2018 Parks and Culture Bonds	Original Bond Amount	Current Bond Amount	Other Funding	Total Project Cost	Status
City Center Plaza	\$ 7,700,000.00	\$ 7,667,674.00	\$ 643,332.00	\$ 8,311,006.00	Complete
Crismon Basins	\$ 2,500,000.00	\$ -		\$ -	Funding allocated to Signal Butte Park Phase II
Dog Park - Countryside	\$ 550,000.00	\$ 555,250.00	\$ 4,814.00	\$ 560,064.00	Design
Eastern Canal Shared-use Path; Brown Road to Broadway Road	\$ 1,800,000.00	\$ 1,794,516.00	\$ 615,563.00	\$ 2,410,079.00	Design complete
Federal Building Renovation (The Post and Neon Garden)	\$ 3,200,000.00	\$ 4,597,889.00	\$ 12,432,589.00	\$ 16,568,653.00	Complete (Used 2012 Bond and Capital General)
Harris Basin ADA Playground	\$ 300,000.00	\$ 17,795.00	\$ -	\$ 17,795.00	Funding Diverted to Fire Fighter Memorial
idea Museum Phase I	\$ 5,000,000.00	\$ 5,000,000.00	\$ 1,285,779.00	\$ 6,285,779.00	Construction
Lehi Crossings South Phase Shared-use Path	\$ 5,600,000.00	\$ 5,392,872.00	\$ 2,280,093.00	\$ 7,672,965.00	Under Construction
Monterey Park (Brady Park) Athletic Fields	\$ 12,300,000.00	\$ 12,444,751.00	\$ 3,759,531.00	\$ 16,204,282.00	Complete
North Center Fields (Lehi Sports Park)	\$ 14,200,000.00	\$ 13,730,351.00	\$ 1,479,732.00	\$ 15,210,083.00	Complete
Red Mountain Park - Baseball Quad	\$ 7,200,000.00	\$ 31,617,674.00	\$ 1,812,686.00	\$ 33,430,360.00	Complete
Red Mountain Park Community Athletic Fields	\$ 25,000,000.00				
Signal Butte & Elliot Park Phase II	\$ 5,000,000.00	\$ 7,500,000.00	\$ -	\$ 7,500,000.00	Design complete
Palo Verde Park Playground	\$ 350,000.00	\$ 228,194.00	\$ 130,000.00	\$ 358,194.00	Complete
Marlborough Park Playground	\$ 200,000.00	\$ 135,950.00	\$ -	\$ 135,950.00	Complete
Signal Butte & Elliot Park Phase I	\$ -	\$ 22,485.00	\$ 3,991,376.00	\$ 4,013,861.00	Complete
Firefighter Memorial Park	\$ -	\$ 193,707.00	\$ 259,015.00	\$ 452,722.00	Complete
<b>Subtotal Parks &amp; Culture</b>	<b>\$ 90,900,000.00</b>	<b>\$ 90,899,108.00</b>	<b>\$ 28,694,510.00</b>	<b>\$ 119,131,793.00</b>	

Parks and Culture Projects Associated with the 2018 Bond are 87% completed.

2018 Public Safety Bonds	Original Bond Amount	Current Bond Amount	Other Funding	Total Project Cost	Status
Communication Fiber	\$ 8,000,000	\$ 8,000,000	\$ -	\$ 8,000,000	Complete - Added to 2024 Bond
Fire Apparatus Replacement	\$ 24,700,000	\$ 24,700,000	\$ -	\$ 24,700,000	Complete - Added to 2022 and 2024 Bond
Fire Station 221 - Eastmark	\$ 5,100,000	\$ 2,564,405	\$ 5,398,339	\$ 7,962,744	Complete
Fire Station 221 - Concrete Repairs	\$ -				Complete
Fire Station 222 - Northeast	\$ 12,000,000	\$ 38,200,000	\$ 5,648,552	\$ 43,848,552	Complete
Northeast Police Substation	\$ 25,000,000				
Police Evidence Facility	\$ 10,000,000	\$ 9,996,000	\$ -	\$ 9,996,000	Complete - Added to 2022 Bond
Fire Station 204 and 211 Security and Lighting Upgrades	\$ -	\$ 126,678	\$ 301,290	\$ 427,968	Complete
City Center Utility Improvements	\$ -	\$ 204,087	\$ 5,595,250	\$ 5,799,337	Complete
EV Fire Truck	\$ -	\$ 163,540	\$ 21,000	\$ 184,540	Complete - Funding from FS 221 Bond
	<b>\$ 84,800,000</b>	<b>\$ 83,954,710</b>	<b>\$ 16,964,431</b>	<b>\$ 100,919,141</b>	

2018 Public Safety Projects are 100% completed.

2018 Library Bonds	Original Bond Amount	Current Bond Amount	Other Funding	Total Project Cost	Status
Dobson Library/Main Library	\$ 3,000,000	\$ 2,967,263	\$ 40,189	\$ 3,007,452	Complete
Gateway Library	\$ 16,800,000	\$ 16,832,737	\$ 11,942,986	\$ 28,775,723	Construction
<b>Subtotal Library</b>	<b>\$ 19,800,000</b>	<b>\$ 19,800,000</b>	<b>\$ 11,983,175</b>	<b>\$ 31,783,175</b>	

2018 Library Projects are 9% completed.

## Dog Park – Countryside Park

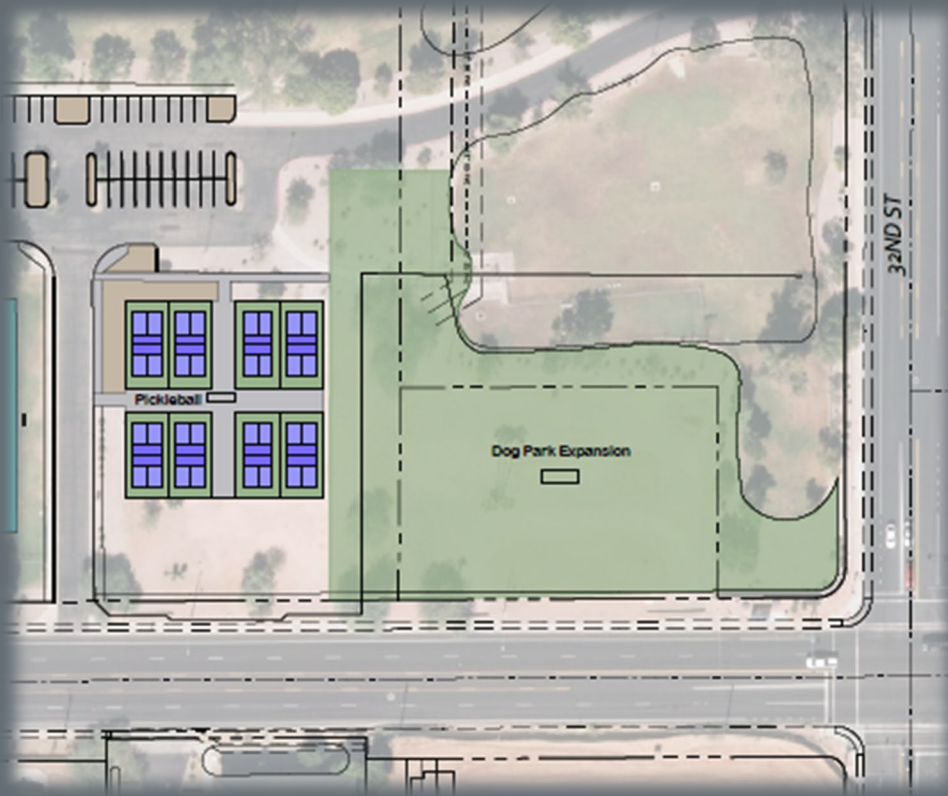

- 1.5-acre expansion at Countryside Park.
- Design under way

## Signal Butte Park – Phase 2

- GMP 1 Executed (electrical equipment)
- GMP 2 – Scheduled for Council consideration on July 8th
- Construction to start in summer 2025 and completed summer 2026.
- Project includes bike park, lighted asphalt trail (1.5 miles), 3 ramadas, pedestrian bridge, restroom facility, and 1 parking lot.



## Lehi Crossing Shared Use Path

- Pathway completed in January 2025.
- SRP is relocating electric power lines to accommodate the tunnel.
- Construction of tunnel to begin in summer of 2025 and be completed by winter 2025.



## Eastern Canal Shared-Use Path – Brown Road to Broadway Road

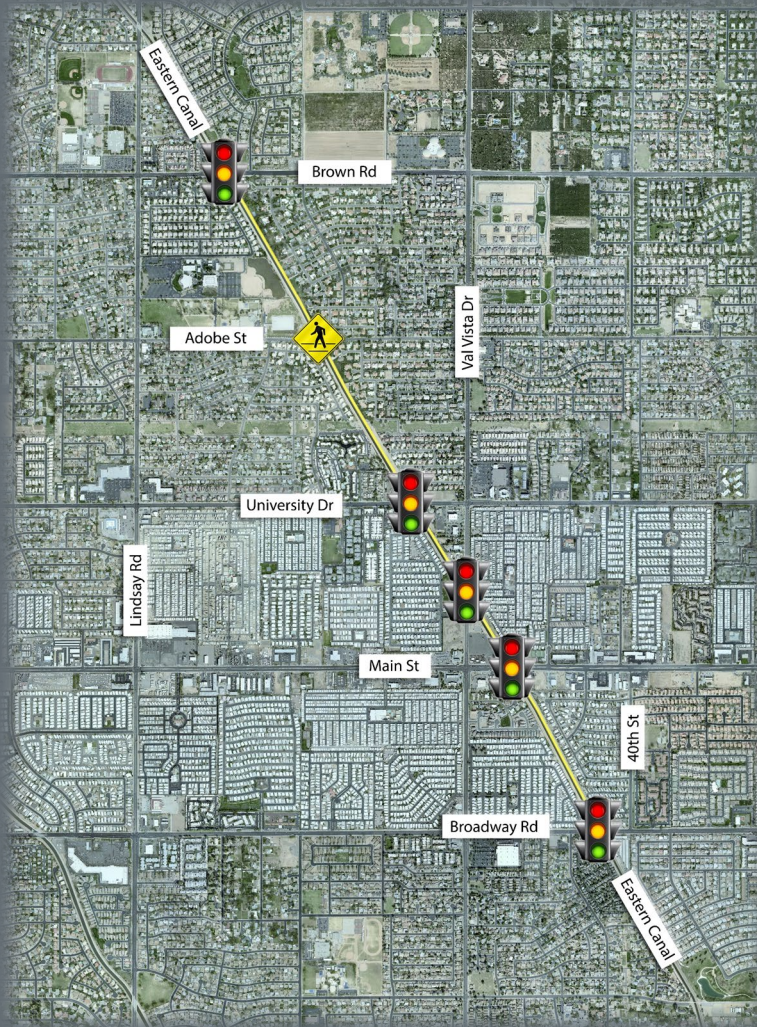

- Construction to begin in summer of 2025.
- Construction completion in spring 2026.
- Signals at street crossings will be completed first followed by the lighted pathway.

## Gateway Library

- Project consists of a new 28,000 SF library adjacent to the Eastmark Great Park.
- Construction began in Summer 2024.
- Construction completion anticipated for fall 2025.



## MESA MOVES PROGRAM ESTIMATED COST (\$M)

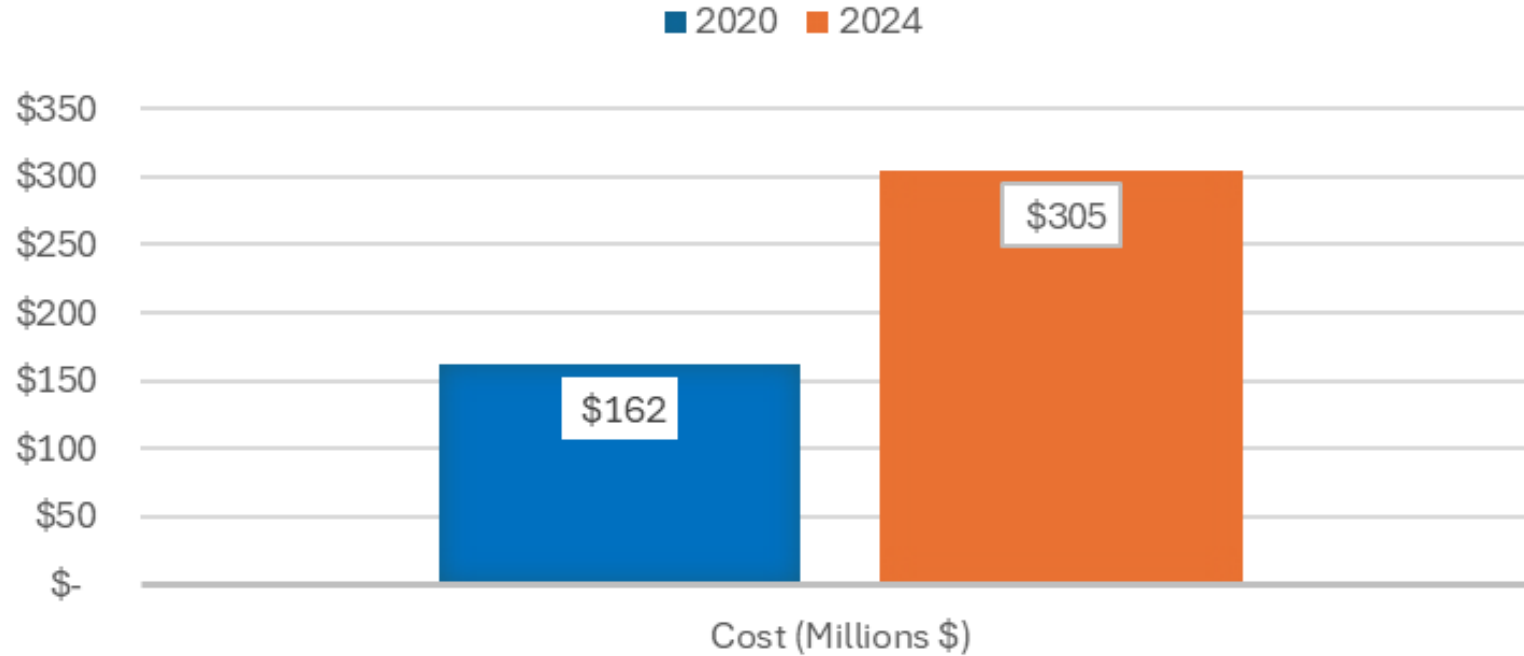

# 2020 Bond Summaries

2020 Transportation Bonds	Bond Amount	Current Bond Amount	Other Funding*	Transportation Project Cost	Status
Broadway Rd-Mesa Dr to Stapley	\$17,500,000	\$ 28,006,155	\$ -	\$ 28,006,155	Design Complete
Elliot Rd-Sossaman Rd to Ellsworth Rd	\$18,100,000	\$ 2,553,702	\$ 33,700,840	\$ 36,254,542	Design
Ellsworth Rd-Germann Rd to Ray Rd	\$6,200,000	\$ 8,150,718	\$ 26,058,090	\$ 34,208,808	Construction
Ray Road Connections to Ellsworth Rd	\$4,800,000	\$ 13,461,398	\$ 1,094,880	\$ 14,556,278	Construction
Signal Butte Rd-Williams Field to Pecos	\$9,500,000	\$ 9,583,016	\$ 7,300,000	\$ 16,883,016	Complete
Sossaman Rd-Ray Rd to Warner Rd	\$4,400,000	\$ 8,137,106	\$ -	\$ 8,137,106	Complete
Sossaman Road and Baseline Road	\$1,200,000	\$ 2,130,577	\$ -	\$ 2,130,577	Complete
Stapley Dr & University Dr	\$9,400,000	\$ 1,787,463	\$ -	\$ 22,855,219	Design only - construction deferred and unfunded
Val Vista Drive-US60 to Pueblo Ave	\$6,500,000	\$ 17,178,303	\$ -	\$ 17,178,303	Construction
Williams Field Rd:SR24 to Ellsworth Rd	\$10,000,000	\$ 9,011,562	\$ 3,738,321	\$ 12,749,883	Complete
Williams Field Road:Airport Aviation Way & Gateway	\$1,300,000				
Arterial Reconstructions	\$11,100,000	\$ -	\$ -	\$ -	Bond funds moved to other projects
<b>Total Bond</b>	<b>\$100,000,000</b>	<b>\$ 100,000,000</b>	<b>\$ 71,892,131</b>	<b>\$ 192,959,887</b>	

\* Other funding includes funding sources such as local street sales tax and transportation fund.

Transportation Projects Associated with the 2020 Bond are 29% completed.

# Additional 2020 Transportation Program Projects

2020 Transportation - MAG Funds	Original Program Amount	Total Project Cost	Status
Signal Butte Rd-Pecos to Germann	\$ 4,000,000	\$ 6,476,648	Complete
City Share		\$ 1,817,500	As needed
Arterial Reconstruction-Stapley Dr from University to McKellips		\$ -	Unfunded/Deferred
Arterial Reconstruction-Broadway Rd from Stapley to Gilbert		\$ -	Unfunded/Deferred
Arterial Reconstruction-Broadway Rd East of Country Club to west of Mesa Dr	\$ 38,000,000	\$ -	Unfunded/Deferred
Country Club Dr & Southern Ave		\$ 36,532,234	Design only-construction unfunded
Arterial Reconstruction-Greenfield Rd-Main St to Adobe Rd		\$ 14,597,536	Construction
Arterial Reconstruction-Greenfield Rd-Southern Ave to Main St		\$ 7,113,204	Construction-also includes HURF funding \$2,139,983
Arterial Reconstruction-Southern Ave - Gilbert Rd to Val Vista Dr		\$ 7,113,204	Construction-also includes HURF funding \$2,139,983
Center Street-Brown Rd to Broadway Rd		\$ 206,650	Study complete
Lehi Loop SUP Phase 2		\$ 146,079	Study complete
Mesa Gateway Phase 3		\$ -	Deferred
US60 Consolidated Canal to Eastern Canal	\$ 20,000,000	\$ 625,351	Design only-construction unfunded
Eastern Canal Shared Use Path:Brown to Broadway		\$ 3,581,401	Design is complete
Eastern Canal Shared Use Path:Broadway to Baseline		\$ 4,215,000	Design is complete
<b>Total MAG</b>	<b>\$62,000,000</b>	<b>\$ 75,311,603</b>	
<b>Total Mesa Moves</b>	<b>\$162,000,000</b>	<b>\$268,271,490</b>	

## Broadway Road – Mesa Drive to Stapley Drive

- Project consists of 1.5 miles of roadway improvements, new sidewalk, traffic signals, lighting, water lines, electric facilities, and storm drain.
- Design is complete.
- Construction expected to begin in fall 2025.
- Construction completion anticipated in the fall of 2027.

## Elliot Road – Sossaman Road to Ellsworth Road

- Project consists of 2 miles of roadway improvements, new curb, gutter, sidewalk, medians, traffic signals, and lighting.
- Design is complete, acquisition of easements and federal funding approvals are under way.
- Construction expected to begin in fall 2026.
- Construction completion anticipated in the summer of 2028.

## Ellsworth Road – Germann Road to Ray Road

- Project consists of 3 miles of roadway improvements to widen the roadway to three lanes in each direction including new sidewalk, medians, and lighting.
- Design is complete.
- Construction expected to begin in fall 2025.
- Construction completion anticipated in the fall of 2026.

## Ray Road Connection to Ellsworth Road

- Project consists of 1 mile of roadway improvements to widen the roadway to three lanes in each direction including new sidewalk, medians, and lighting.
- Design is complete.
- Construction expected to begin in fall 2025.
- Construction completion anticipated in the fall of 2026.

## Val Vista Drive – US 60 to Pueblo

- Project consists of widening the roadway to three lanes in each direction, additional left turn lanes, new sidewalk, traffic signals, and lighting.
- Design is complete.
- Construction to begin in August 2025.
- Construction completion anticipated in the fall of 2026.

# 2022 Bond Summaries

2022 Public Safety Bonds	Original Bond Amount	Current Bond Amount	Other Funding	Total Project Cost	Status
Fire Apparatus Replacement	\$ 10,000,000	\$ 10,000,000	\$ 24,700,000	\$ 34,700,000	In Progress (\$24.7M from 2018 Bond)
Fire Station 205 Rebuild	\$ 16,800,000	\$ 16,716,103	\$ -	\$ 16,716,103	Design
Fire Station 223	\$ 16,800,000	\$ 16,787,251	\$ -	\$ 16,787,251	Design Complete
Fire Station 224	\$ 16,800,000	\$ 16,760,413	\$ -	\$ 16,760,413	Construction
Police Evidence Facility	\$ 11,300,000	\$ 13,074,042	\$ 10,984,000	\$ 24,058,042	Complete (Other Funding - 2018 Bond)
Police Headquarters	\$ 43,400,000	\$ 49,641,613	\$ 13,218,049	\$ 62,859,662	Construction
Public Safety Training Facility	\$ 41,900,000	\$ 33,900,000	\$ 61,358	\$ 33,961,358	Design
<b>Total Bond</b>	<b>\$ 157,000,000</b>	<b>\$ 156,879,422</b>	<b>\$ 48,963,407</b>	<b>\$ 205,842,829</b>	

Public Safety Projects Associated with the 2022 Bond are 8% completed.

## Fire Station 205 Rebuild



- Design is near completion.
- Construction to begin in fall 2025.
- Construction completion anticipated in winter 2026.

## Fire Station 223

- Design is complete.
- Construction to begin in winter 2026.
- Construction completion by spring 2027.



## Fire Station 224

- Design is complete.
- Construction to begin in summer 2025.
- Construction completion by fall 2026.



## Public Safety Training Facility Expansion

- Design of parking lot expansion is under way.
- Project team is reviewing needs for the facility.
- Construction timeframe is to be determined.



## Police Headquarters Remodel



- Design is complete.
- Construction to begin in summer 2025.
- Construction completion anticipated in fall 2027.

# 2024 Bond Summaries

2024 Parks Bonds	Original Bond Amount	Current Bond Amount	Other Funding	Total Project Cost	Status
Heritage Park Playground Renovation	\$ 900,000.00	\$ 900,000.00	\$ -	\$ 900,000.00	Design
Meadowgreen Park Playground Renovation	\$ 800,000.00	\$ 800,000.00	\$ -	\$ 800,000.00	Design
Woodglen Park Playground Renovation	\$ 800,000.00	\$ 800,000.00	\$ -	\$ 800,000.00	Design
Carriage Lane Park Playground Renovation	\$ 700,000.00	\$ 700,000.00	\$ -	\$ 700,000.00	Design
Augusta Ranch Playground Renovation	\$ 1,000,000.00	\$ 1,000,000.00	\$ -	\$ 1,000,000.00	Design
Shepherd's Park Playground Renovation and Pickleball	\$ 1,750,000.00	\$ 1,750,000.00	\$ -	\$ 1,750,000.00	Not Started
Monterey Park (Brady Park) Dog Park Renovation	\$ 800,000.00	\$ 800,000.00	\$ -	\$ 800,000.00	Design
Los Alamos Park Water Conservation	\$ 1,750,000.00	\$ 1,750,000.00	\$ -	\$ 1,750,000.00	Not Started
Skyline Pickleball	\$ 1,100,000.00	\$ 1,100,000.00	\$ -	\$ 1,100,000.00	Not Started
Countryside Pickleball	\$ 1,600,000.00	\$ 1,600,000.00	\$ -	\$ 1,600,000.00	Not Started
Evergreen Pickleball	\$ 1,200,000.00	\$ 1,200,000.00	\$ -	\$ 1,200,000.00	Not Started
Rancho Del Mar Pickleball	\$ 1,100,000.00	\$ 1,100,000.00	\$ -	\$ 1,100,000.00	Not Started
Southeast Aquatic Center	\$ 32,900,000.00	\$ 32,900,000.00	\$ -	\$ 32,900,000.00	Designer Selected
Red Mountain Aquatics Center	\$ 33,570,000.00	\$ 33,570,000.00	\$ -	\$ 33,570,000.00	Designer Selected
Fremont Pool Demolition	\$ 730,000.00	\$ 730,000.00	\$ -	\$ 730,000.00	Designer Selected
Northeast Mesa Regional Trails	\$ 5,000,000.00	\$ 5,000,000.00	\$ -	\$ 5,000,000.00	Study Initiated
Mountain View Park Water Conservation	\$ 1,250,000.00	\$ 1,250,000.00	\$ -	\$ 1,250,000.00	Not Started
Indoor Recreation Center	\$ 52,000,000.00	\$ 52,000,000.00	\$ -	\$ 52,000,000.00	Not Started
Chaparral Park Water Conservation	\$ 1,000,000.00	\$ 1,000,000.00	\$ -	\$ 1,000,000.00	Not Started
Holmes Park Water Conservation	\$ 1,250,000.00	\$ 1,250,000.00	\$ -	\$ 1,250,000.00	Not Started
	<b>\$ 141,200,000.00</b>	<b>\$ 141,200,000.00</b>	<b>\$ -</b>	<b>\$ 141,200,000.00</b>	

Parks Projects Associated with the 2024 Bond are 0% completed.

2024 Public Safety Bonds	Original Bond Amount	Current Bond Amount	Other Funding	Total Project Cost	Status
Expand Fiber Network	\$ 4,000,000	\$ 4,000,000	\$ -	\$ 4,000,000	Starting Construction
Fire Apparatus Replacement	\$ 20,000,000	\$ 20,000,000	\$ -	\$ 20,000,000	Ongoing
Medical Responses Facilities	\$ 5,000,000	\$ 5,000,000	\$ -	\$ 5,000,000	Not Started
Emergency 911 Call Center	\$ 54,000,000	\$ 54,000,000	\$ -	\$ 54,000,000	Design
Safe Streets for All	\$ 7,000,000	\$ 7,000,000	\$ -	\$ 7,000,000	Not Started
	<b>\$ 90,000,000</b>	<b>\$ 90,000,000</b>	<b>\$ -</b>	<b>\$ 90,000,000</b>	

Public Safety Projects Associated with the 2024 Bond are 0% completed.

2024 Arts and Culture Bonds	Original Bond Amount	Current Bond Amount	Other Funding	Total Project Cost	Status
I.D.E.A. Museum Phase 2	\$ 20,000,000	\$ 20,000,000	\$ -	\$ 20,000,000	Design
Sirrine House Historic Preservation	\$ 5,000,000	\$ 5,000,000	\$ -	\$ 5,000,000	Design
	<b>\$ 25,000,000</b>	<b>\$ 25,000,000</b>	<b>\$ -</b>	<b>\$ 25,000,000</b>	

Arts and Culture Projects Associated with the 2024 Bond are 0% completed.

# Parks Playground Renovations

## Heritage Park, Meadowgreen Park, Woodglen Park, Carriage Lane Park, Augusta Ranch Park, and Shepherd's Park

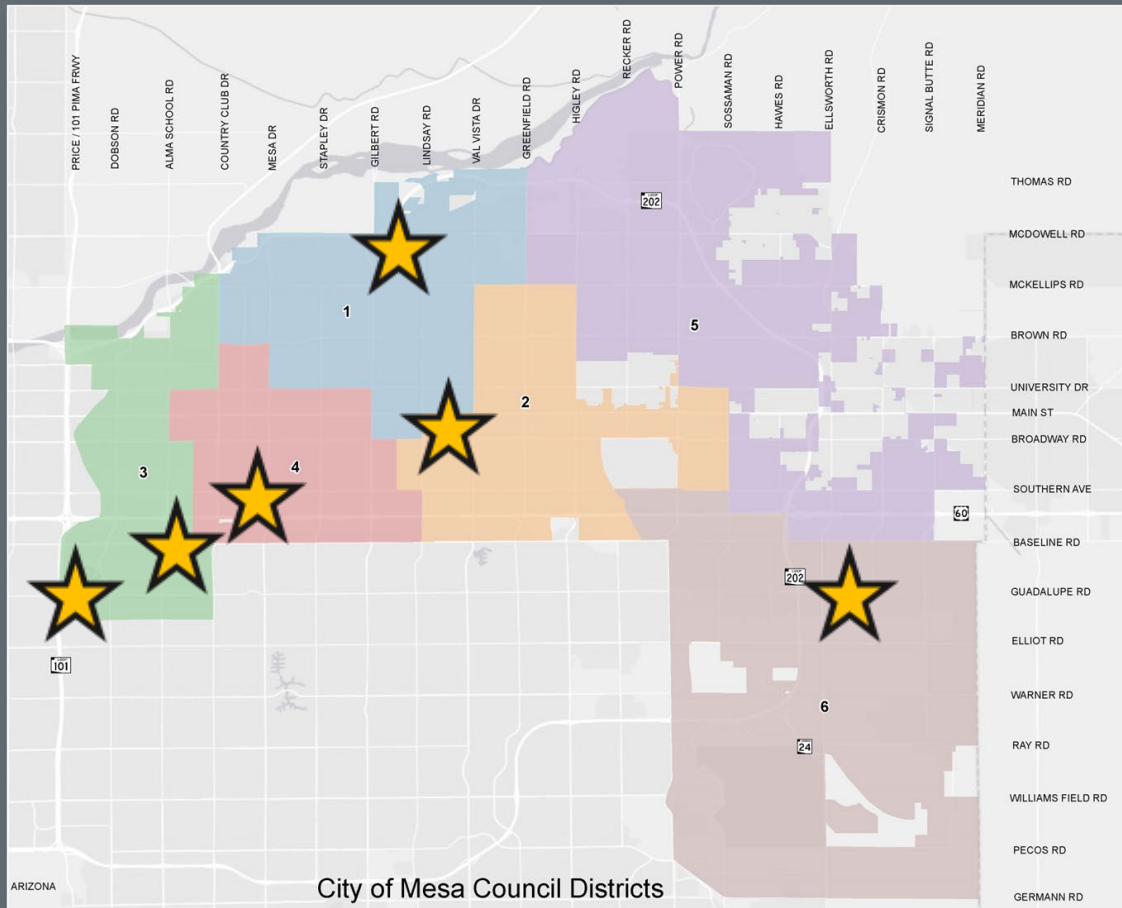

- Design is near completion for 5 playground renovations.
- Public meetings to be held in August-September 2025.
- Construction to begin early fall 2025.
- Renovations complete summer of 2026.

## I.D.E.A. Museum – Phase 2

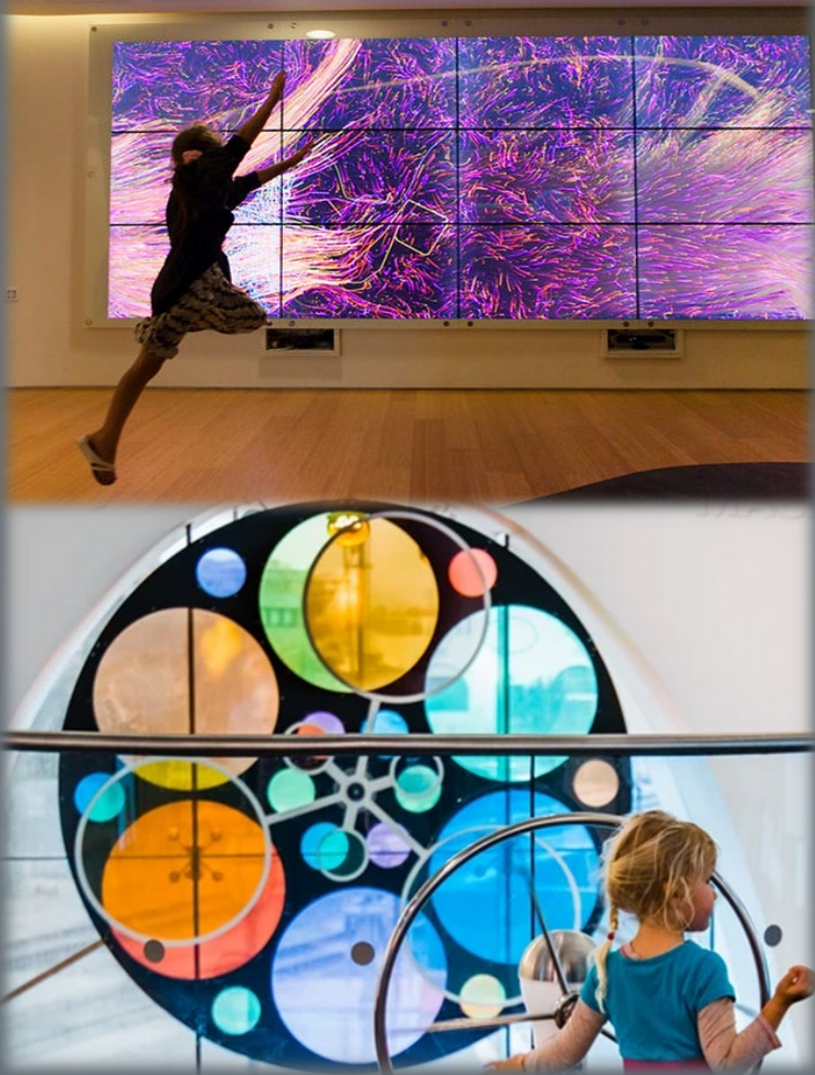

- Designer selected. Contract being negotiated.
- Construction to begin fall of 2026.
- Renovations complete fall of 2028.

## Northeast Mesa Regional Trails System

- Feasibility study to be completed by fall 2025.
- Multiple jurisdictions with agreements and approvals needed.
- Bond funding is for the trailhead only.
- Construction anticipated from spring of 2026 to summer of 2028.



## Aquatics Facilities



Southeast Aquatics Facility



Red Mountain Aquatics Facility

- Consultant has been selected

## Public Safety Communications Facility

- Designer selected and working through programming and schematic design.
- Schematics being prepared at 32nd Street and McDowell – next to Fire Station 223.
- Design team looking at opportunities for shared resources like utilities, access, parking, etc.
- CMAR selection in December 2025.
- Construction anticipated in January 2027 to October 2028.

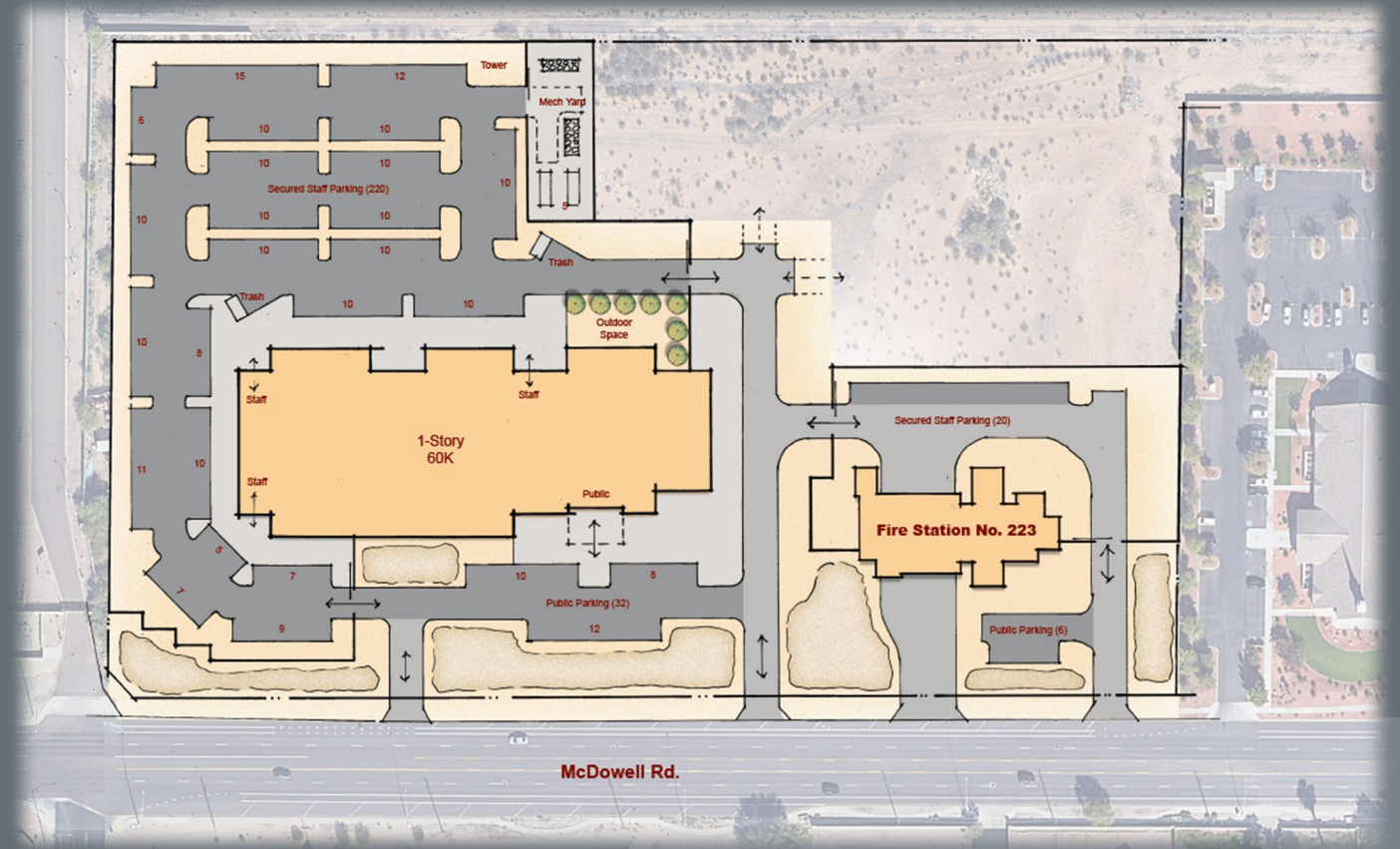

## Indoor Recreation Center

- Working with PRCF staff, the Countryside Park site has been identified as a potential site.
- Schematic layouts were prepared to determine feasibility.
- Construction anticipated spring 2028 to winter 2030.

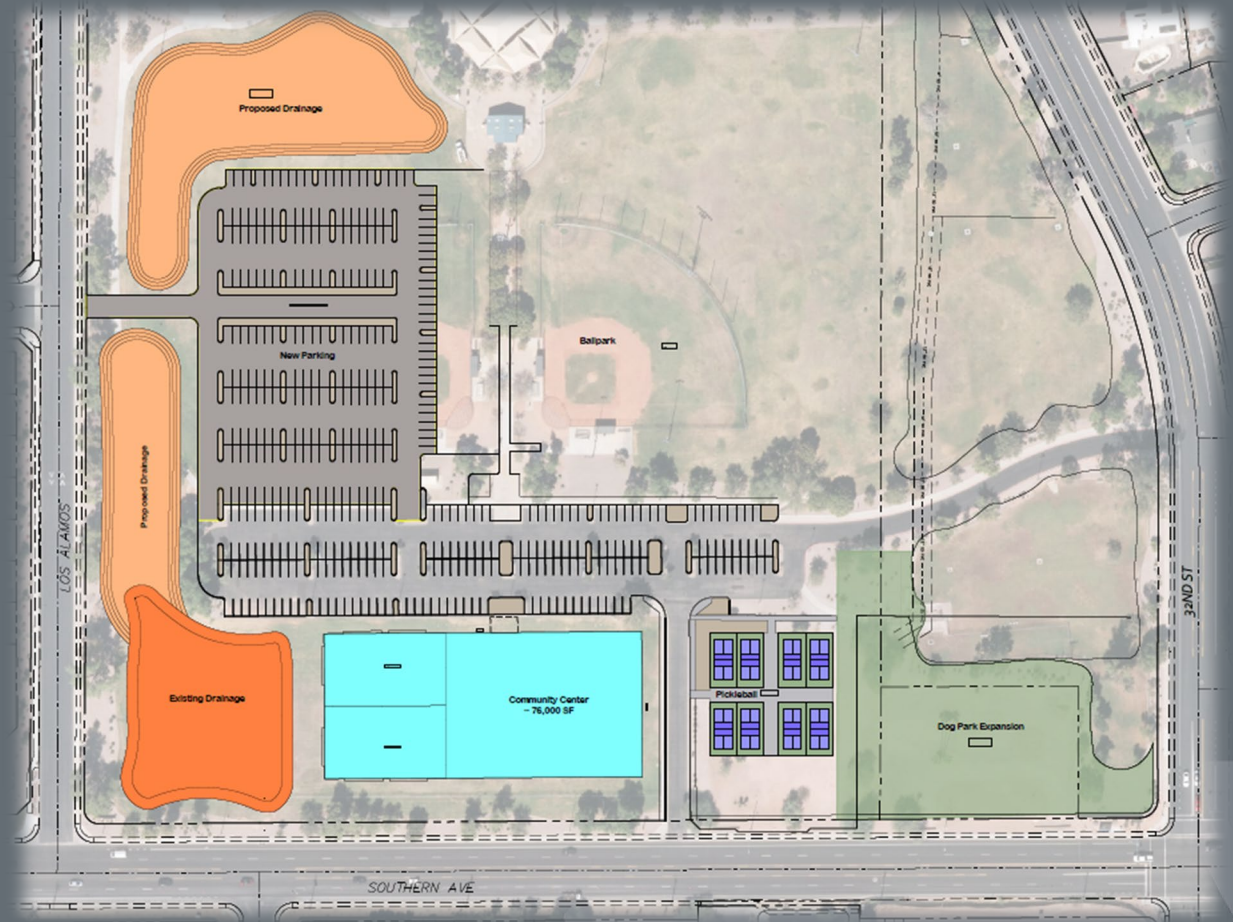



mesa·az

## Crismon and Elliot Basins



- \$2.5M was diverted to fund Signal Butte Park – Phase 2.
- Included 120 parking spaces to support drop-in sports and recreation uses.
- No current funding for this project.