

PLANT SCHEDULE: (FOR ALL SHEETS)

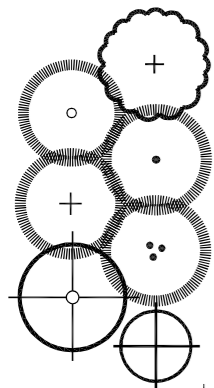

BOTANICAL NAME COMMON NAME	SIZE	TOTAL QTY	MATURE SPREAD
EXISTING PALO VERDE	SALVAGED FROM ON-SITE OR MIN. 60" PALO VERDE	1 TOTAL	25' DIA.
OLNEYA TESOTA IRONWOOD	48" BOX MULTI-TRUNK 12' HT, 1' SP.	5 TOTAL	25' DIA.
CERCIDIUM FLORIDUM 'DM' DESERT MUSEUM PALO VERDE	36" BOX MIN, STANDARD 12' HT, 5.5' SP, 2 1/2' CAL.	19 TOTAL	25' DIA.
CERCIDIUM FLORIDUM BLUE PALO VERDE	36" BOX MIN. 12' HT, 6' SP, 2 1/2' CAL.	7 TOTAL	30' DIA.
PROSOPIA CHILIENSIS THORNLESS MESQUITE	24" BOX MIN, MULTI-TRUNK 8' HT, 4.5' SP, 1 1/2' CAL.	31 TOTAL	30' DIA.
ACACIA SMALLII SWEET ACACIA	24" BOX MIN. 9' HT, 4.5' SP, 1 1/2' CAL.	13 TOTAL	20' DIA.
CHILOPSIS LINEARIS 'LOIS ADAMS' DESERT WILLOW	36" BOX 12' HT, 6' SP, 2 1/2' CAL.	26 TOTAL	20' DIA.
CARNEGIANA GIGANTEA SAGUARO	HT. PER PLAN STRAIGHT, NO HOLES, SPEAR	12 TOTAL	
STENOCLERUS THURBERGI ORGAN PIPE CACTUS	HT. PER PLAN 3-5 STEM	3 TOTAL	
EUPHORBIA TIRYALLI FIRE STICKS	5 GALLON FULL, PAST CAN	18 TOTAL	
OPUNTIA BASILARIS BEAUTIFUL PRICKLEY PEAR	8-10 PADS	21 TOTAL	
AGAVE 'BLUE GLOW' BLUE GLOW AGAVE	5 GALLON FULL, PAST CAN	20 TOTAL	
AGAVE GEMIFLORA TWIN FLOWER AGAVE	5 GALLON FULL, PAST CAN	21 TOTAL	
CAESALPINIA FULCHERRIMA RED BIRD OF PARADISE	5 GALLON	32 TOTAL	
LEUCOPHYLLUM ZYGOPHYLLUM BLUE RANGER SAGE	5 GALLON FULL, PAST CAN	210 TOTAL	
HESPERALOE PARVIFOLIA RED YUCCA	1 GALLON FULL, PAST CAN	38 TOTAL	
RUELLIA BRITTONIANA PENINSULARIS MEXICAN BLUE SAGE	5 GALLON FULL, PAST CAN	31 TOTAL	
MUHLENBERGIA CAPILLARIS 'REGAL MIST' REGAL MIST MUHLY	1 GALLON FULL, PAST CAN	66 TOTAL	
ACACIA REDOLENS 'D.C.' DESERT CARPET	5 GALLON FULL, PAST CAN	141 TOTAL	
CASSIA ARTEMISIOIDES FEATHERY CASSIA	5 GALLON FULL, PAST CAN	30 TOTAL	
ROSMARINUS OFF. PROSTRATUS DWARF ROSEMARY	5 GALLON FULL, PAST CAN	78 TOTAL	
SIMMONDSIA CHINENSIS 'VISTA' COMPACT JOJOBA	5 GALLON FULL, PAST CAN	63 TOTAL	
BREMOPHYLLA GLABRA 'MING'NEW GOLD' OUTBACK SUNRISE	1 GALLON FULL, PAST CAN	33 TOTAL	
LANTANA MONTIVIDENSIS 'N.G.' NEW GOLD LANTANA	5 GALLON FULL, PAST CAN	142 TOTAL	
LANTANA BELLOUJIANA 'T.P.' TRAILING PURPLE LANTANA	5 GALLON FULL, PAST CAN	191 TOTAL	
DECOMPOSED GRANITE PIONEER ROCK 'DESERT GOLD'	1/2" MINUS 2" DEPTH	75,665 SF.	
SIZED GRANITE MATCH DESERT GOLD	1-1/4" SIZE 4" DEPTH	1,332 SF.	
DECOMPOSED GRANITE PATH PIONEER ROCK 'DESERT GOLD'	1/4" MINUS 3" DEPTH	3,945 SF.	

TOTAL MATURE TREE CANOPY AREA: 58,340 S.F.

AREA	FORMULA	REQUIRED				PROVIDED			
		36" BOX TREES	24" BOX TREES	15 GAL. TREES	SHRUBS	36" BOX TREES	24" BOX TREES	15 GAL. TREES	SHRUBS
MCDOWELL ROAD (460 L.F.)	(1 TREE AND 6 SHRUBS/ 25 L.F. OF FRONTAGE) (25% 36" BOX 50% 24" BOX 25% 15 GAL. MIN)	5	10	4	111	5	14	0	194
PARKING LOT (35) 15' ISLANDS	15' ISLAND: (1) TREE AND (3) SHRUBS 30' ISLAND: (2) TREES AND (6) SHRUBS (MIN. 10% OF REQ'D. TREES TO BE 36" BOX- BALANCE OF TREES TO BE 24" BOX)	2	14	0	48	16	0	0	65
SOUTH FOUNDATION BASE (210 L.F.)	(1) TREE / 50 L.F. (10% OF REQ'D. TREES TO BE 36" BOX- BALANCE OF TREES TO BE 24" BOX)	1	4	0	N.A.	8	0	0	15
NORTH FOUNDATION BASE (250 L.F.)	(1) TREE / 50 L.F. (10% OF REQ'D. TREES TO BE 36" BOX- BALANCE OF TREES TO BE 24" BOX)	1	4	0	N.A.	8	0	0	30
WEST FOUNDATION BASE (405 L.F.)	(1) TREE / 50 L.F. (10% OF REQ'D. TREES TO BE 36" BOX- BALANCE OF TREES TO BE 24" BOX)	1	8	0	N.A.	(5) 36" BOX (5) 48" BOX	4	0	166
59TH CIRCLE (320 L.F.)	(1 TREE AND 4 SHRUBS / 25 L.F. OF FRONTAGE) (25% 36" BOX 50% 24" BOX, 25% 15 GAL. MIN)	4	8	4	63	(3) 36" BOX (1) 48" BOX	0	0	114

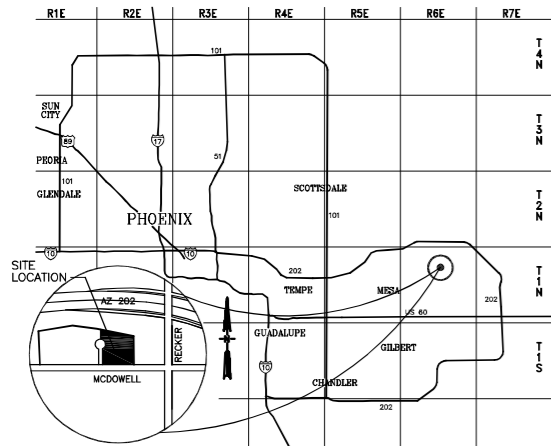

VICINITY MAP

PROJECT TEAM

PROPERTY OWNER: WETTA VENTURES
3104 E. CAMELBACK ROAD #957
PHOENIX, ARIZONA 85016
(480) 290-1502
CONTACT: PAUL SALINAS
EMAIL: PS@WETTAVENTURES.COM

ARCHITECT: DEUTCH ARCHITECTURE GROUP
4600 E. INDIAN SCHOOL ROAD
PHOENIX, ARIZONA 85016
(602) 840-2929
CONTACT: KAREN OHMANN
EMAIL: KOHMANN@2929.COM

CIVIL: KAEKO - NATE COTTRELL
12409 WEST INDIAN SCHOOL C-303
AVONDALE, AZ 85392
(623) 536-1993

LANDSCAPE: PHILLIP R. RYAN - PHIL RYAN
4915 S. QUIET WAY
GILBERT, ARIZONA 85298
(480) 246-9681
EMAIL: MAIL@RYANASSOCIATESONLINE.NET

SHEET INDEX:

- L-1 COVER SHEET
- L-2 LANDSCAPE PLAN
- L-3 LANDSCAPE PLAN
- L-4 LANDSCAPE PLAN
- L-5 ENLARGED LANDSCAPE PLAN

SITE DATA:

NET SITE AREA: 288,166 SF. (6.62 AC.)
GROSS SITE AREA: 320,166 SF. (6.89 AC.)
TOTAL LANDSCAPE AREA: 76,997 SF. (26.7% OF NET SITE AREA)
(25.6% OF GROSS SITE AREA)

phillip r. ryan
landscape architect p.c.
4915 S. QUIET WAY
GILBERT, ARIZONA 85298
(480) 246-9681
mail@ryanassociatesonline.net



4600 E INDIAN SCHOOL RD.
PHOENIX, ARIZONA 85018
602.840.2929
2929.COM

LONGBOW 202 SHELL BUILDING
5818 E. MCDOWELL ROAD
MESA, AZ 85215

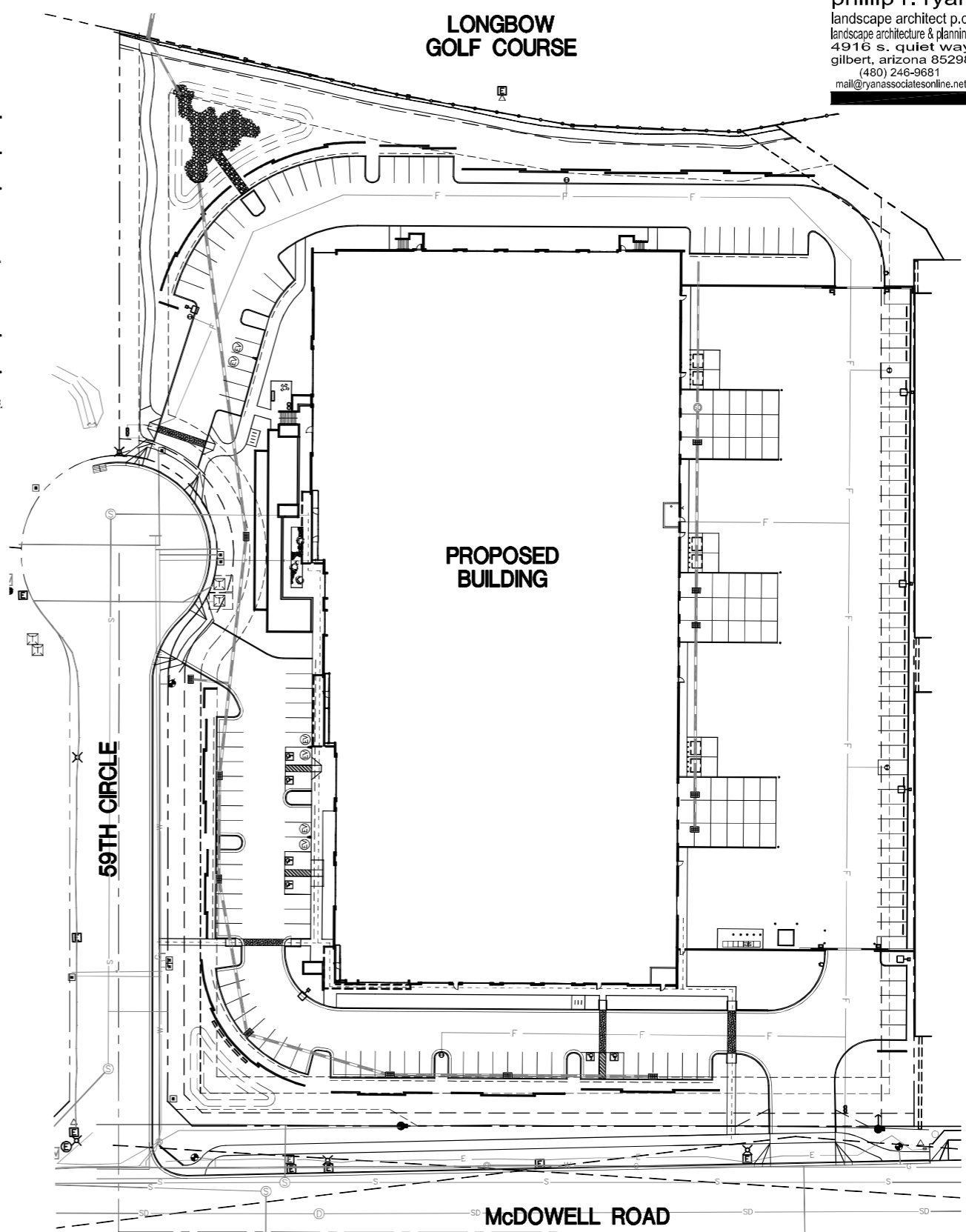

FIRST ISSUED: XX/XX/XX

REVISIONS

No.	DATE	DESCRIPTION

PROJECT NO: 25154.00
DRAWN BY: DLR
CHECKED BY: PRR
COPYRIGHT 2024; DEUTSCH ARCHITECTURE GROUP

COVER SHEET

PRELIMINARY - NOT FOR CONSTRUCTION



phillip r. ryan
 landscape architect p.c.
 landscape architecture & planning
 4916 s. quiet way
 gilbert, arizona 85298
 (480) 246-9681
 mail@ryanassociatesonline.net

4600 E INDIAN SCHOOL RD.
 PHOENIX, ARIZONA 85018
 602.840.2929
 2929.COM

LONGBOW 202 SHELL BUILDING
 5818 E. McDOWELL ROAD
 MESA, AZ 85215

FIRST ISSUED: XX/XX/XX

REVISIONS		
No.	DATE	DESCRIPTION

PROJECT NO: 25154.00
 DRAWN BY: DLR
 CHECKED BY: PRR
 COPYRIGHT 2024; DEUTSCH ARCHITECTURE GROUP

LANDSCAPE PLAN
 L-2

PRELIMINARY - NOT FOR CONSTRUCTION

PLANT SCHEDULE:

(FOR THIS SHEET ONLY)

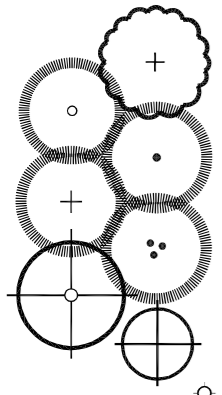

EXISTING PALO VERDE	SALVAGED FROM ON-SITE OR MIN. 60" PALO VERDE	0 TOTAL	+	HESPERALOE PARVIFOLIA RED YUCCA	1 GALLON FULL PAST CAN	22 TOTAL
OLNEYA TESOTA IRONWOOD	48" BOX MULTI-TRUNK 12' HT, 1" SP.	0 TOTAL	○	RUPELLIA BRITTONIANA PENINSULARIS MEXICAN BLUE SAGE	5 GALLON FULL PAST CAN	22 TOTAL
CERCIDIUM FLORIDUM 'DM.' DESERT MUSEUM PALO VERDE	36" BOX MIN. STANDARD 12' HT, 5.5" SP, 2 1/2" CAL.	1 TOTAL	●	MUHLENBERGIA CAPILLARIS 'REGAL MIST' REGAL MIST MUHLY	1 GALLON FULL PAST CAN	0 TOTAL
CERCIDIUM FLORIDUM BLUE PALO VERDE	36" BOX MIN. 12' HT, 6" SP, 2 1/2" CAL.	3 TOTAL	⊕	ACACIA REDOLENS 'D.C.' DESERT CARPET	5 GALLON FULL PAST CAN	50 TOTAL
PROSOPIS CHILIENSIS THORNLESS MESQUITE	24" BOX MIN. MULTI-TRUNK 8' HT, 4.5" SP, 1 1/2" CAL.	11 TOTAL	⊕	CASSIA ARTEMISIOIDES FEATHERY CASSIA	5 GALLON FULL PAST CAN	6 TOTAL
ACACIA SMALLII SWEET ACACIA	24" BOX MIN. 9' HT, 4.5" SP, 1 1/2" CAL.	13 TOTAL	○	ROSMARINUS OFF. PROSTRATUS DWARF ROSEMARY	5 GALLON FULL PAST CAN	15 TOTAL
CHILLOPSIS LINEARIS 'LOIS ADAMS' DESERT WILLOW	36" BOX 12' HT, 6" SP, 2 1/2" CAL.	12 TOTAL	⊕	SIMMONDSIA CHINENSIS 'VISTA' COMPACT JOJOBA	5 GALLON FULL PAST CAN	4 TOTAL
CARNEGIANA GIGANTEA SAGUARO	HT. PER PLAN STRAIGHT, NO HOLES, SPEAR	4 TOTAL	⊗	EREMOPHYLLA GLABRA 'MINGINEU GOLD' OUTBACK SUNRISE	1 GALLON FULL PAST CAN	10 TOTAL
EUPHORBIA TIRYALLI FIRE STICKS	5 GALLON FULL PAST CAN	0 TOTAL	⊗	LANTANA MONTIVIDENSIS 'N.G.' NEW GOLD LANTANA	5 GALLON FULL PAST CAN	14 TOTAL
OPUNTIA BASILARIS BEAUTIFUL PRICKLEY PEAR	8-10 PADS	11 TOTAL	⊗	LANTANA BELLOWIANA 'T.P.' TRAILING PURPLE LANTANA	5 GALLON FULL PAST CAN	94 TOTAL
AGAVE 'BLUE GLOW' BLUE GLOW AGAVE	5 GALLON FULL PAST CAN	6 TOTAL	⊗	DECOMPOSED GRANITE PIONEER ROCK 'DESERT GOLD'	1/2" MINUS 2" DEPTH	31,420 SF.
CAESALPINIA FULCHERRIMA RED BIRD OF PARADISE	5 GALLON	11 TOTAL	⊗	1/4" SIZE 4" DEPTH	0 SF.	
LEUCOPHYLLUM ZYGOPHYLLUM BLUE RANGER SAGE	5 GALLON FULL PAST CAN	82 TOTAL	⊗	DECOMPOSED GRANITE PATH PIONEER ROCK 'DESERT GOLD'	1/4" MINUS 3" DEPTH	0 SF.

PLAN KEY NOTES:

- FIRE HYDRANT
- BUILDING OVERHANG LINE
- DECORATIVE PAVEMENT
- OVERHEAD POWER LINES
- POWER POLE
- DECORATIVE SCREEN WALL (SEE ARCH. DUGS.)
- 6" WIDE X 3" DEPTH DECOMPOSED GRANITE PATH (PIONEER ROCK - 1/2" MINUS DESERT GOLD), DETAIL 1, SHEET L-5
- 6"x6" CONCRETE HEADER
- SIGHT VISIBILITY LINE
- 1/2" MINUS, 2" DEPTH DECOMPOSED GRANITE - DESERT GOLD
- 2"-4" DIA. COBBLE PER SCHEDULE
- 4' HIGH OPEN STEEL MESH FENCE
- DRAINAGE PIPE PER CIVIL DUGS.
- CONCRETE HEADWALL PER CIVIL DUGS.
- 1-1/4" SIZED GRANITE (4" DEPTH)
- RETENTION BASIN PER CIVIL DUGS.
- SITE LIGHT
- NEW 6' TALL SCREEN WALL
- SEE CIVIL DUGS. FOR DRAINAGE SYSTEM
- RIP RAP PROTECTION PER CIVIL DUGS.
- FIRELINE BACKFLOW PREVENTION DEVICE PER CIVIL DUG.
- FIRE DEPT. KNOX BOX
- 4' WIDE X 3" DEPTH DECOMPOSED GRANITE ACCESS PATH TO TRAIL (PIONEER ROCK - 1/2" MINUS DESERT GOLD)
- 6' BENCH
- BLACK BASALT STONE FOUNTAIN W/ BLACK MEXICAN BEACH PEBBLES IN BASE
- STORM DRAIN PIPE PER CIVIL DUGS.
- FIRE LINE

BOULDER SCHEDULE:

- ⊙ A 4'x4'x3" DEEP SELECT GRADE GRANITE SURFACE BOULDER (BURY 12")
- ⊙ B 3'x3'x30" DEEP SELECT GRADE GRANITE SURFACE BOULDER (BURY 12")
- ⊙ C 2'x2'x18" DEEP SELECT GRADE GRANITE SURFACE BOULDER (BURY 6")

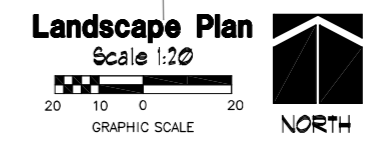
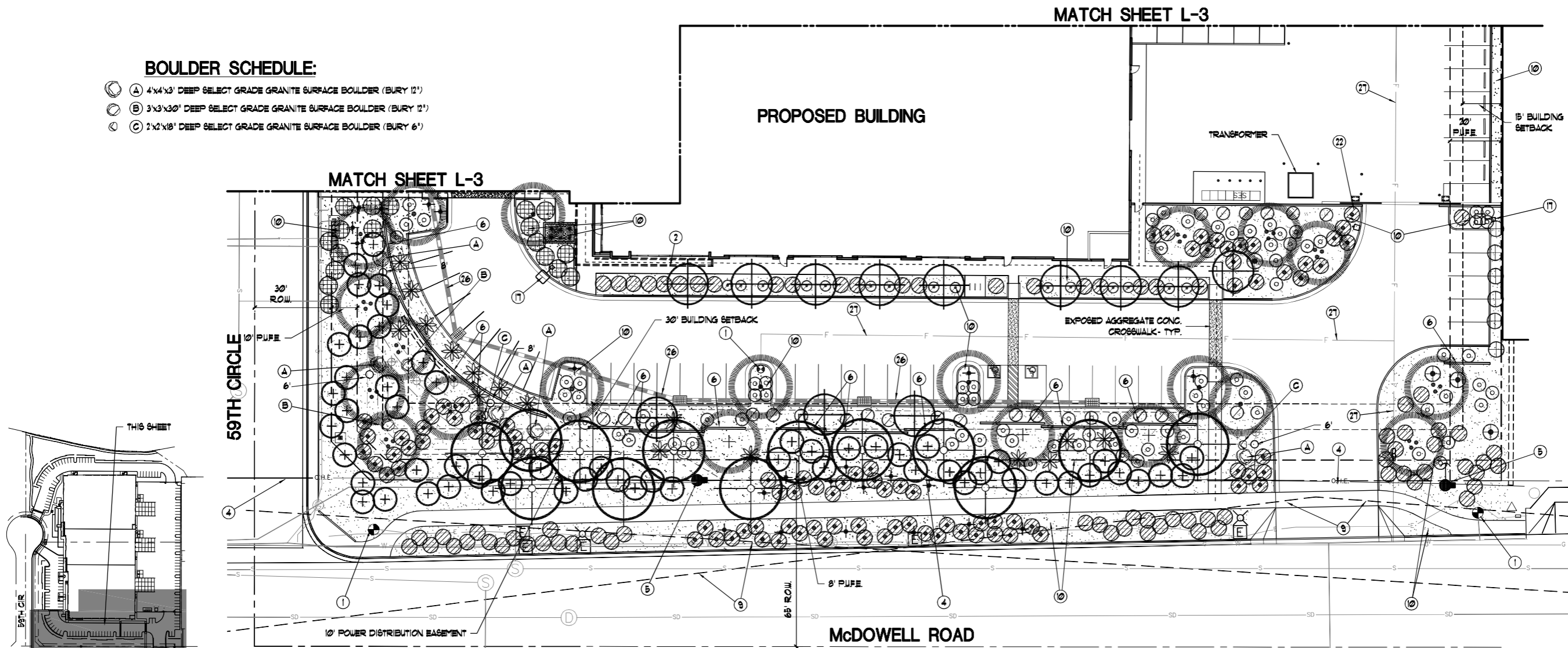

PLANT SCHEDULE:

(FOR THIS SHEET ONLY)

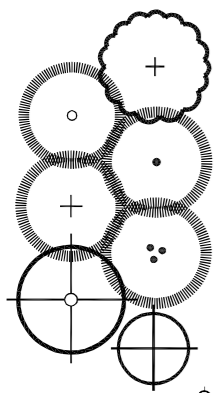

EXISTING PALO VERDE	SALVAGED FROM ON-SITE OR MIN. 60" PALO VERDE	1 TOTAL
OLNEYA TESOTA IRONWOOD	48" BOX MULTI-TRUNK 12' HT, 1" SP.	0 TOTAL
CERCIDIUM FLORIDUM 'DM.' DESERT MUSEUM PALO VERDE	36" BOX MIN. STANDARD 12' HT, 5.5" SP, 2 1/2" CAL.	3 TOTAL
CERCIDIUM FLORIDUM BLUE PALO VERDE	36" BOX MIN. 12' HT, 6" SP, 2 1/2" CAL.	1 TOTAL
PROSORIS CHILIENSIS THORNLESS MESQUITE	24" BOX MIN. MULTI-TRUNK 8' HT, 4.5" SP, 1 1/2" CAL.	5 TOTAL
ACACIA SMALLII SWEET ACACIA	24" BOX MIN. 9' HT, 4.5" SP, 1 1/2" CAL.	0 TOTAL
CHILOPSIS LINEARIS 'LOIS ADAMS' DESERT WILLOW	36" BOX 12' HT, 6" SP, 2 1/2" CAL.	0 TOTAL
CARNEGIANA GIGANTEA SAGUARO	HT. PER PLAN STRAIGHT, NO HOLES, 8" FEAR	0 TOTAL
EUPHORBIA TIRYALLI FIRE STICKS	5 GALLON FULL, PAST CAN	0 TOTAL
OPUNTIA BASILARIS BEAVERTAIL FRICKLEY PEAR	8-10 PADS	0 TOTAL
AGAVE 'BLUE GLOW' BLUE GLOW AGAVE	5 GALLON FULL, PAST CAN	0 TOTAL
CAESALPINIA PULCHERRIMA RED BIRD OF PARADISE	5 GALLON	7 TOTAL
LEUCOPHYLLUM ZYGOPHYLLUM BLUE RANGER SAGE	5 GALLON FULL, PAST CAN	35 TOTAL

HESPERALOE PARVIFOLIA RED YUCCA	1 GALLON FULL, PAST CAN	11 TOTAL
RUELLIA BRITTONIANA PENINSULARIS MEXICAN BLUE SAGE	5 GALLON FULL, PAST CAN	7 TOTAL
MUHLENBERGIA CAPILLARIS 'REGAL MIST' REGAL MIST MUHLY	1 GALLON FULL, PAST CAN	0 TOTAL
ACACIA REDOLENS 'D.C.' DESERT CARPET	5 GALLON FULL, PAST CAN	10 TOTAL
CASSIA ARTEMISIOIDES FEATHERY CASSIA	5 GALLON FULL, PAST CAN	0 TOTAL
ROSMARINUS OFF. PROSTRATUS DWARF ROSEMARY	5 GALLON FULL, PAST CAN	6 TOTAL
SIMYONDISIA CHINENSIS 'VISTA' COMPACT JOJOBA	5 GALLON FULL, PAST CAN	5 TOTAL

EREMOPHYLLA GLABRA 'MINEW GOLD' OUTBACK SUNRISE	1 GALLON FULL, PAST CAN	0 TOTAL
LANTANA MONTYDENSIS 'N.G.' NEW GOLD LANTANA	5 GALLON FULL, PAST CAN	0 TOTAL
LANTANA BELLOUANA 'T.P.' TRAILING PURPLE LANTANA	5 GALLON FULL, PAST CAN	40 TOTAL
DECOMPOSED GRANITE PIONEER ROCK 'DESERT GOLD'	1/2" MINUS 2" DEPTH	7,425 SF.
SIZED GRANITE MATCH DESERT GOLD	1-1/4" SIZE 4" DEPTH	0 SF.
6" WIDE DECOMPOSED GRANITE PATH PIONEER ROCK 'DESERT GOLD'	1/4" MINUS 3" DEPTH	0 SF.

BOULDER SCHEDULE:

- (A) 4'x4'x3" DEEP SELECT GRADE GRANITE SURFACE BOULDER (BURY 12")
- (B) 3'x3'x30" DEEP SELECT GRADE GRANITE SURFACE BOULDER (BURY 12")
- (C) 2'x2'x18" DEEP SELECT GRADE GRANITE SURFACE BOULDER (BURY 6")

MATCH SHEET L-4

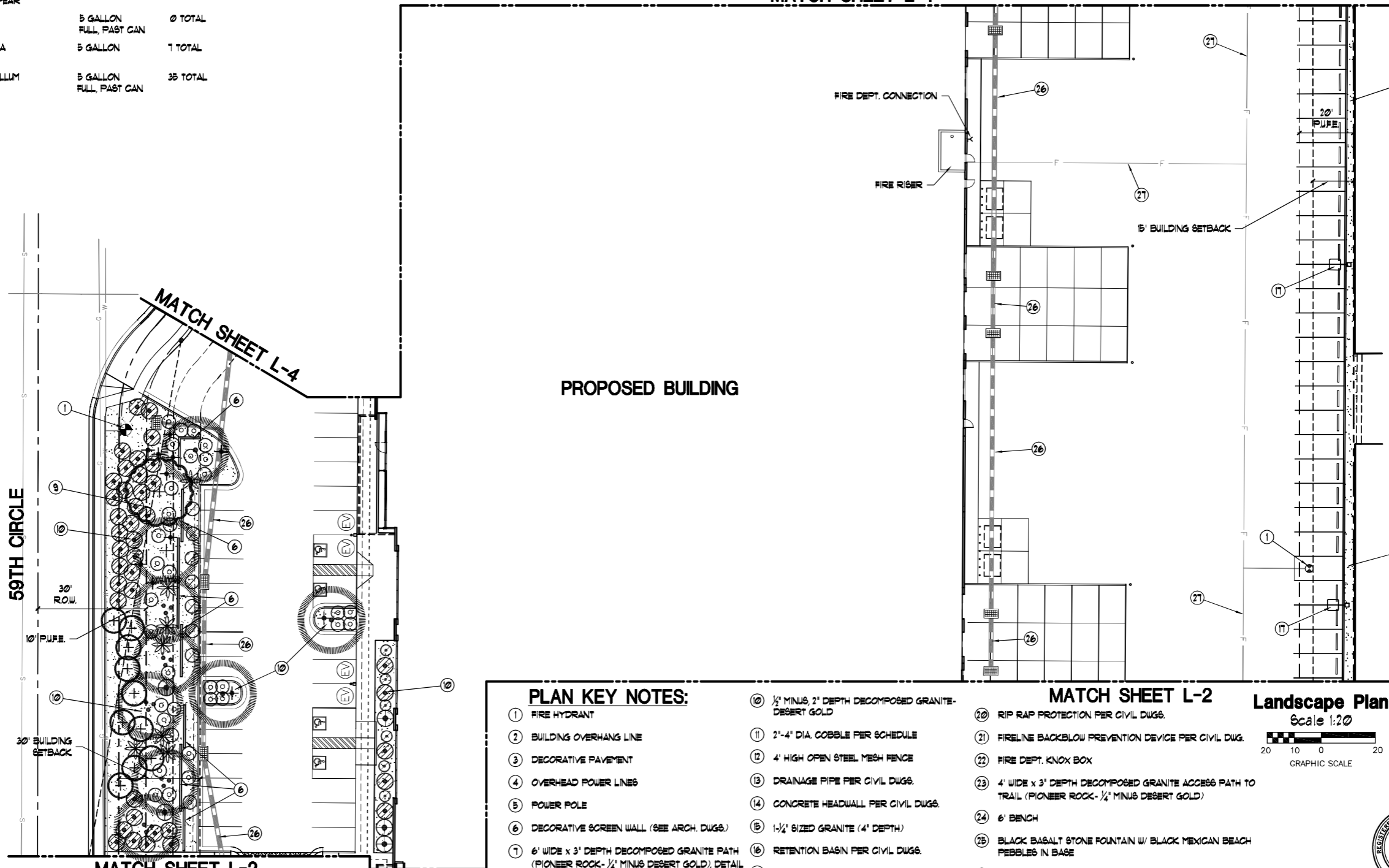

PROPOSED BUILDING

PLAN KEY NOTES:

- (1) FIRE HYDRANT
- (2) BUILDING OVERHANG LINE
- (3) DECORATIVE PAVEMENT
- (4) OVERHEAD POWER LINES
- (5) POWER POLE
- (6) DECORATIVE SCREEN WALL (SEE ARCH. DUGS.)
- (7) 6' WIDE x 3" DEPTH DECOMPOSED GRANITE PATH (PIONEER ROCK - 1/2" MINUS DESERT GOLD). DETAIL 1, SHEET L-5
- (8) 6'x6" CONCRETE HEADER
- (9) SIGHT VISIBILITY LINE
- (10) 1/2" MINUS, 2" DEPTH DECOMPOSED GRANITE - DESERT GOLD
- (11) 2'-4" DIA. COBBLE PER SCHEDULE
- (12) 4' HIGH OPEN STEEL MESH FENCE
- (13) DRAINAGE PIPE PER CIVIL DUGS.
- (14) CONCRETE HEADWALL PER CIVIL DUGS.
- (15) 1-1/4" SIZED GRANITE (4" DEPTH)
- (16) RETENTION BASIN PER CIVIL DUGS.
- (17) SITE LIGHT
- (18) NEW 6' TALL SCREEN WALL
- (19) SEE CIVIL DUGS. FOR DRAINAGE SYSTEM
- (20) RIP RAP PROTECTION PER CIVIL DUGS.
- (21) FIRELINE BACKBLOW PREVENTION DEVICE PER CIVIL DUG.
- (22) FIRE DEPT. KNOX BOX
- (23) 4' WIDE x 3" DEPTH DECOMPOSED GRANITE ACCESS PATH TO TRAIL (PIONEER ROCK - 1/2" MINUS DESERT GOLD)
- (24) 6' BENCH
- (25) BLACK BASALT STONE FOUNTAIN W/ BLACK MEXICAN BEACH PEBBLES IN BASE
- (26) STORM DRAIN PIPE PER CIVIL DUGS.
- (27) FIRE LINE

MATCH SHEET L-2

Landscape Plan Scale 1:20

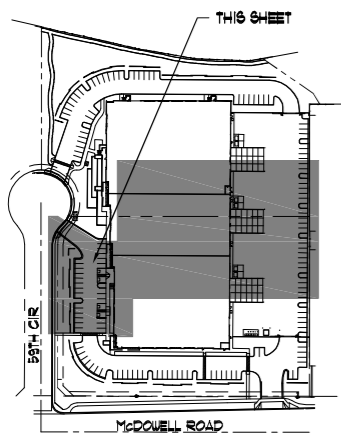
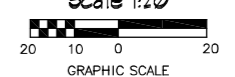

Key Map



phillip r. ryan
landscape architect p.c.
landscape architecture & planning
4916 s. quiet way
gilbert, arizona 85298
(480) 246-9681
mail@ryanassociatesonline.net



4600 E INDIAN SCHOOL RD.
PHOENIX, ARIZONA 85018
602.840.2929
2929.COM

LONGBOW 202 SHELL BUILDING
5818 E. MCDOWELL ROAD
MESA, AZ 85215

FIRST ISSUED: XX/XX/XX

REVISIONS

No.	DATE	DESCRIPTION

LANDSCAPE PLAN

PROJECT NO: 25154.00
DRAWN BY: DLR
CHECKED BY: PRR
COPYRIGHT 2024: DEUTSCH ARCHITECTURE GROUP

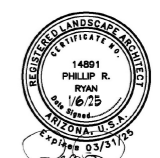

L-3

PRELIMINARY - NOT FOR CONSTRUCTION

phillip r. ryan
landscape architect p.c.
landscape architecture & planning
4916 s. quiet way
gilbert, arizona 85298
(480) 246-9681
mail@ryanassociatesonline.net



4600 E INDIAN SCHOOL RD.
PHOENIX, ARIZONA 85018
602.840.2929
2929.COM

LONGBOW 202 SHELL BUILDING
5818 E. MCDOWELL ROAD
MESA, AZ 85215

FIRST ISSUED: XX/XX/XX

REVISIONS		
No.	DATE	DESCRIPTION

PROJECT NO: 25154.00
DRAWN BY: DLR
CHECKED BY: PRR
COPYRIGHT 2024: DEUTSCH ARCHITECTURE GROUP

LANDSCAPE PLAN

14891
PHILLIP R. RYAN
1/6/25
PHOENIX, ARIZONA

PRELIMINARY - NOT FOR CONSTRUCTION

PLAN KEY NOTES:

- 1 FIRE HYDRANT
- 2 BUILDING OVERHANG LINE
- 3 DECORATIVE PAVEMENT
- 4 OVERHEAD POWER LINES
- 5 POWER POLE
- 6 DECORATIVE SCREEN WALL (SEE ARCH. DUGG.)
- 7 6' WIDE x 3' DEPTH DECOMPOSED GRANITE PATH (PIONEER ROCK - 1/2" MINUS DESERT GOLD), DETAIL 1, SHEET L-5
- 8 6"x6" CONCRETE HEADER
- 9 SIGHT VISIBILITY LINE
- 10 1/2" MINUS, 2" DEPTH DECOMPOSED GRANITE - DESERT GOLD
- 11 2"-4" DIA. COBBLE PER SCHEDULE
- 12 4' HIGH OPEN STEEL MESH FENCE
- 13 DRAINAGE PIPE PER CIVIL DUGG.
- 14 CONCRETE HEADWALL PER CIVIL DUGG.
- 15 1-1/2" SIZED GRANITE (4" DEPTH)
- 16 RETENTION BASIN PER CIVIL DUGG.
- 17 SITE LIGHT
- 18 NEW 6' TALL SCREEN WALL
- 19 SEE CIVIL DUGG. FOR DRAINAGE SYSTEM
- 20 RIP RAP PROTECTION PER CIVIL DUGG.
- 21 FIRELINE BACKBLOW PREVENTION DEVICE PER CIVIL DUGG.
- 22 FIRE DEPT. KNOX BOX
- 23 4' WIDE x 3' DEPTH DECOMPOSED GRANITE ACCESS PATH TO TRAIL (PIONEER ROCK - 1/2" MINUS DESERT GOLD)
- 24 6' BENCH
- 25 BLACK BASALT STONE FOUNTAIN W/ BLACK MEXICAN BEACH PEBBLES IN BASE
- 26 STORM DRAIN PIPE PER CIVIL DUGG.
- 27 FIRE LINE

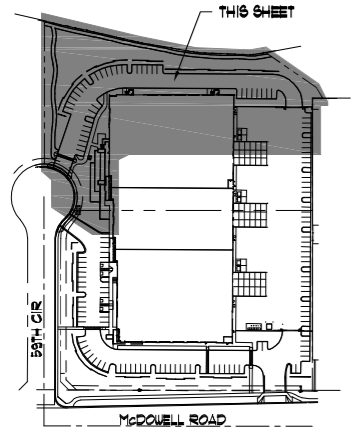
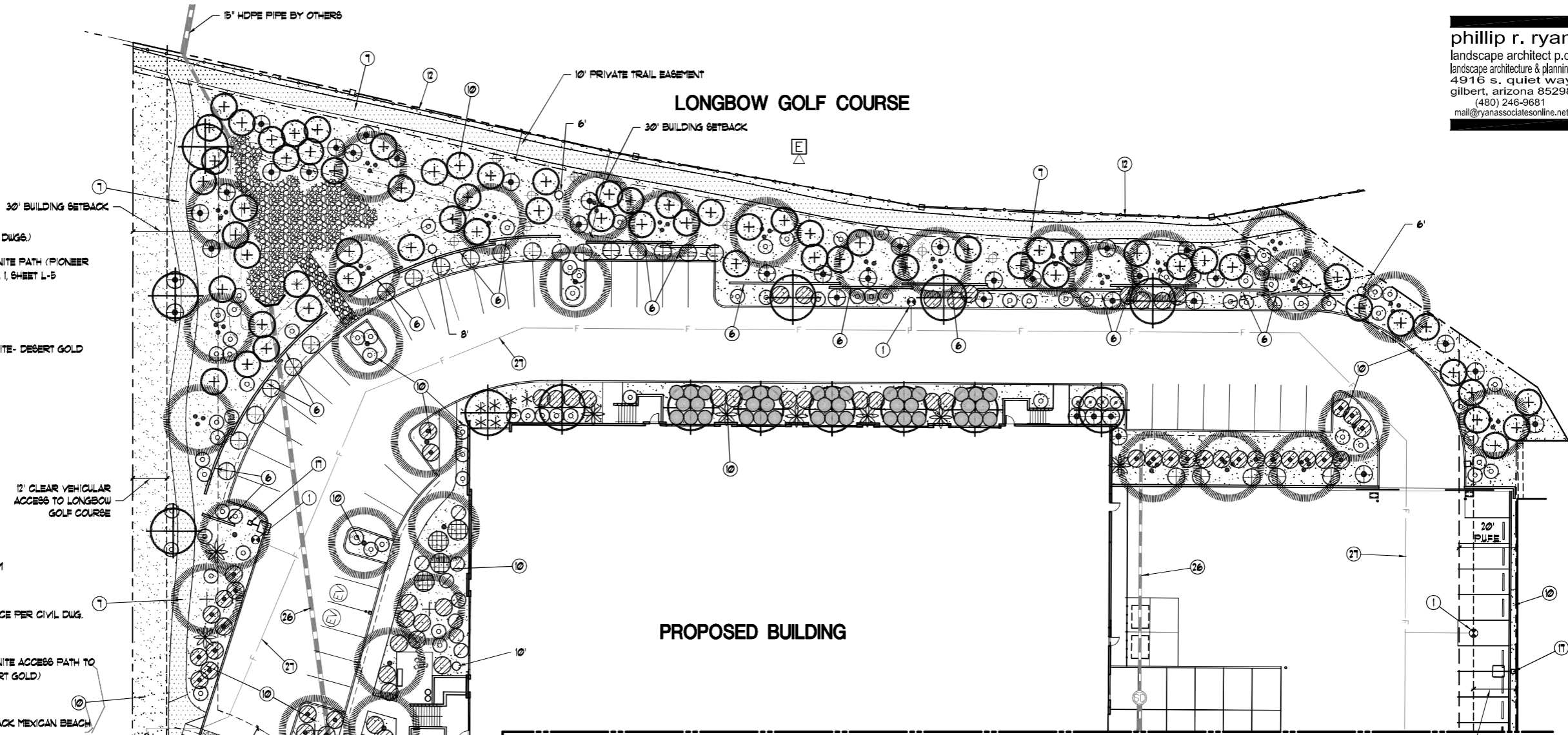

Key Map

NORTH

PROPOSED BUILDING

MATCH SHEET L-3

SEE SHEET L-5 FOR PLANTER AREA ENLARGEMENT

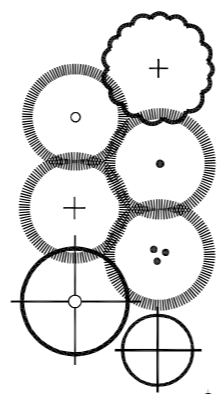

PLANT SCHEDULE:
(FOR THIS SHEET ONLY)

EXISTING	SALVAGED FROM ON-SITE OR MIN. 60" PALO VERDE	HT. PER PLAN STRAIGHT, NO HOLES, SPEAR	Q TOTAL
OLNEYA TESOTA IRONWOOD	48" BOX MULTI-TRUNK 12' HT, 1" SP.		3 TOTAL
CERCIDIUM FLORIDUM 'DM.' DESERT MUSEUM PALO VERDE	36" BOX MIN. STANDARD 12' HT, 5.5' SP., 2 1/2" CAL.		9 TOTAL
CERCIDIUM FLORIDUM BLUE PALO VERDE	36" BOX MIN. 12' HT, 6' SP., 2 1/2" CAL.		3 TOTAL
PROSOPIA CHILIENSIS THORNLESS MESQUITE	24" BOX MIN. MULTI-TRUNK 8' HT, 4.5' SP., 1 1/2" CAL.		21 TOTAL
ACACIA SMALLII SWEET ACACIA	24" BOX MIN. 9' HT, 4.5' SP., 1 1/2" CAL.		0 TOTAL
CHILOPSIS LINEARIS 'LOIS ADAMS' DESERT WILLOW	36" BOX 12' HT, 6' SP., 2 1/2" CAL.		14 TOTAL
CARNEGIANA GIGANTEA SAGUARO		4 TOTAL	
EUPHORBIA TIRVALLI FIRE STICKS	5 GALLON FULL, PAST CAN	6 TOTAL	
OPUNTIA BASILARIS BEAUTIFUL PRICKLY PEAR	8-10 PADS	13 TOTAL	
AGAVE 'BLUE GLOW' BLUE GLOW AGAVE	5 GALLON FULL, PAST CAN	0 TOTAL	
CAESALPINIA FULCHERRIMA RED BIRD OF PARADISE	5 GALLON	8 TOTAL	
LEUCOPHYLLUM ZYGOPHYLLUM BLUE RANGER SAGE	5 GALLON FULL, PAST CAN	84 TOTAL	
HEPERALOE PARVIFOLIA RED YUCCA	1 GALLON FULL, PAST CAN	5 TOTAL	

RUPELLIA BRITTONIANA PENINSULARIS MEXICAN BLUE SAGE	5 GALLON FULL, PAST CAN	8 TOTAL
MUHLENBERGIA CAPILLARIS 'REGAL MIST' REGAL MIST MUHLY	1 GALLON FULL, PAST CAN	40 TOTAL
ACACIA REDOLENS 'D.C.' DESERT CARPET	5 GALLON FULL, PAST CAN	79 TOTAL
CASSIA ARTEMISIOIDES FEATHERY CASSIA	5 GALLON FULL, PAST CAN	24 TOTAL
ROSMARINUS OFF. PROSTRATUS DWARF ROSEMARY	5 GALLON FULL, PAST CAN	4 TOTAL
SYMMONDIA CHINENSIS 'VISTA' COMPACT JOJOBA	5 GALLON FULL, PAST CAN	39 TOTAL
EREMOPHYLLA GLABRA 'MINGINEU GOLD' OUTBACK SUNRISE	1 GALLON FULL, PAST CAN	15 TOTAL
LANTANA MONTIVIDENSIS 'N.G.' NEW GOLD LANTANA	5 GALLON FULL, PAST CAN	32 TOTAL
LANTANA BELLOUIANA 'T.P.' TRAILING PURPLE LANTANA	5 GALLON FULL, PAST CAN	50 TOTAL
DECOMPOSED GRANITE PIONEER ROCK 'DESERT GOLD'	1/2" MINUS 2' DEPTH	34,100 SF.
SIZED GRANITE MATCH DESERT GOLD	1-1/4" SIZE 4" DEPTH	1,270 SF.
6' WIDE DECOMPOSED GRANITE PATH PIONEER ROCK 'DESERT GOLD'	1/4" MINUS 3' DEPTH	3,945 SF.

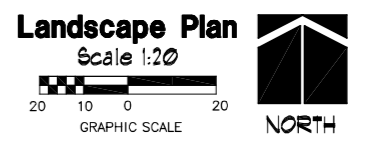

BOULDER SCHEDULE:

- (A) 4'x4'x3' DEEP SELECT GRADE GRANITE SURFACE BOULDER (BURY 12")
- (B) 3'x3'x30" DEEP SELECT GRADE GRANITE SURFACE BOULDER (BURY 12")
- (C) 2'x2'x18" DEEP SELECT GRADE GRANITE SURFACE BOULDER (BURY 6")

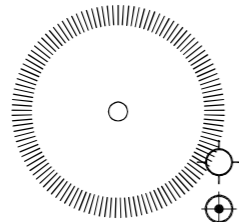

PLANT SCHEDULE:

(FOR THIS SHEET ONLY)

	OLNEYA TEGOTA IRONWOOD	48" BOX, MULTI-TRUNK 12' HT., 1" SP.	2 TOTAL
	CARNEGIANA GIGANTEA SAGUARO	HT. PER PLAN STRAIGHT, NO HOLES, SPEAR	4 TOTAL
	STENOCCEREUS THURBERGI ORGAN PIPE CACTUS	HT. PER PLAN 3-5 STEM	3 TOTAL
	EUPHORBIA TIRVALLI FIRE STICKS	5 GALLON FULL, PAST CAN	12 TOTAL
	OPUNTIA BASILARIS BEAUTIFUL FRICKLEY PEAR	8-10 PADS	3 TOTAL
	AGAVE 'BLUE GLOW' BLUE GLOW AGAVE	5 GALLON FULL, PAST CAN	14 TOTAL
	AGAVE GEMINIFLORA TWIN FLOWER AGAVE	5 GALLON FULL, PAST CAN	21 TOTAL
	LEUCOPHYLLUM ZYGOPHYLLUM BLUE RANGER SAGE	5 GALLON FULL, PAST CAN	9 TOTAL
	MUHLENBERGIA CAPILLARIS 'REGAL MIST' REGAL MIST MUHLY	5 GALLON FULL, PAST CAN	26 TOTAL
	ROSMARINUS OFF. PROSTRATUS DWARF ROSEMARY	5 GALLON FULL, PAST CAN	54 TOTAL
	SYMMONDSIA CHINENSIS 'VISTA' COMPACT JOJOBA	5 GALLON FULL, PAST CAN	15 TOTAL
	LANTANA MONTIVDENSIS 'N.G.' NEW GOLD LANTANA	5 GALLON FULL, PAST CAN	36 TOTAL
	LANTANA SELLOWIANA 'T.P.' TRAILING PURPLE LANTANA	5 GALLON FULL, PAST CAN	13 TOTAL
	DECOMPOSED GRANITE PIONEER ROCK 'DESERT GOLD'	1/2" MINUS 2' DEPTH	2,720 SF.
	SIZED GRANITE MATCH DESERT GOLD	1'-4" SIZE 6" DEPTH	62 SF.

BOULDER SCHEDULE:

- (A) 4'x4'x3" DEEP SELECT GRADE GRANITE SURFACE BOULDER (BURY 12")
- (B) 3'x3'x30" DEEP SELECT GRADE GRANITE SURFACE BOULDER (BURY 12")
- (C) 2'x2'x18" DEEP SELECT GRADE GRANITE SURFACE BOULDER (BURY 6")

GRANITE COLOR: PIONEER MATERIALS 'DESERT GOLD'.

PATH IS TO BE CONSTRUCTED SIX FEET IN WIDTH WITHIN THE TWELVE (12) FOOT EASEMENT.

MEANDER WHERE POSSIBLE.

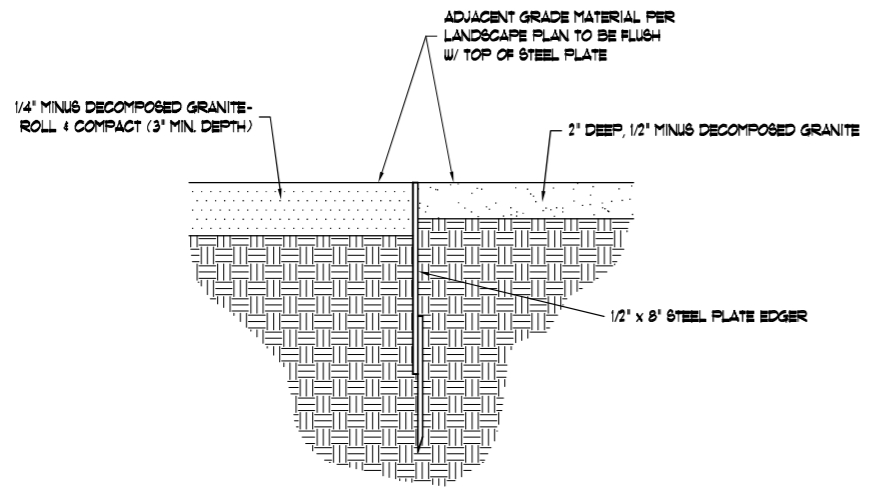

1 STEEL EDGER DETAIL AT LONGBOW FITNESS TRAIL
NOT TO SCALE

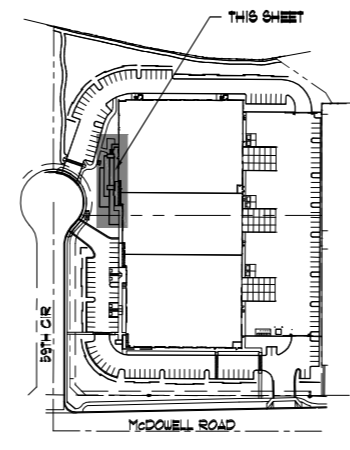

Key Map NORTH

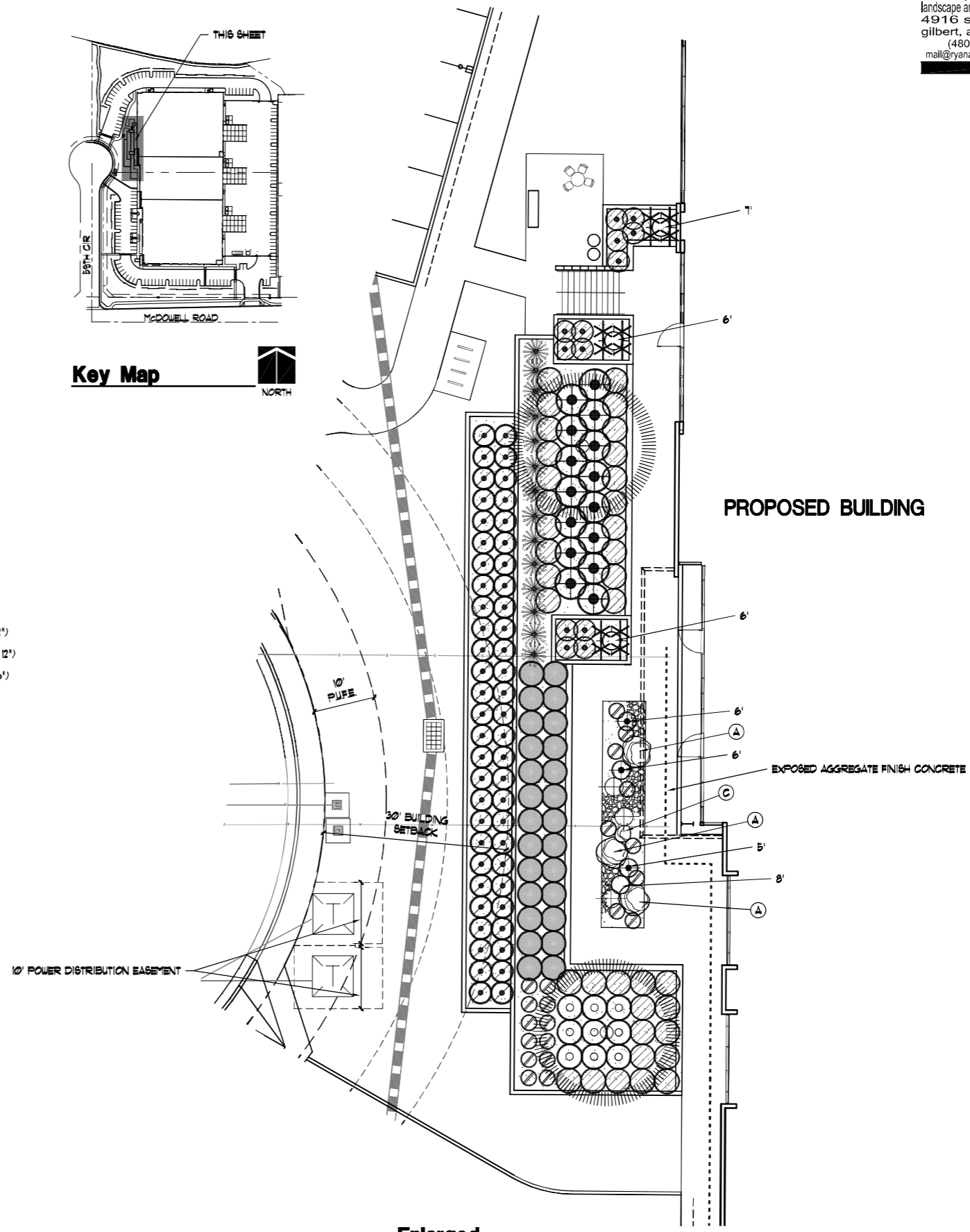

Enlarged Landscape Plan
Scale 1:10

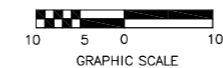

phillip r. ryan
landscape architect p.c.
landscape architecture & planning
4916 s. quiet way
gilbert, arizona 85298
(480) 246-9681
mail@ryanassociatesonline.net



4600 E INDIAN SCHOOL RD.
PHOENIX, ARIZONA 85018
602.840.2929
2929.COM

LONGBOW 202 SHELL BUILDING
5818 E. MCDOWELL ROAD
MESA, AZ 85215

FIRST ISSUED: XX/XX/XX

REVISIONS

No.	DATE	DESCRIPTION

PROJECT NO: 25154.00

DRAWN BY: DLR

CHECKED BY: PRR

COPYRIGHT 2024: DEUTSCH ARCHITECTURE GROUP

LANDSCAPE PLAN



PRELIMINARY - NOT FOR CONSTRUCTION