

E MCKELLIPS RD

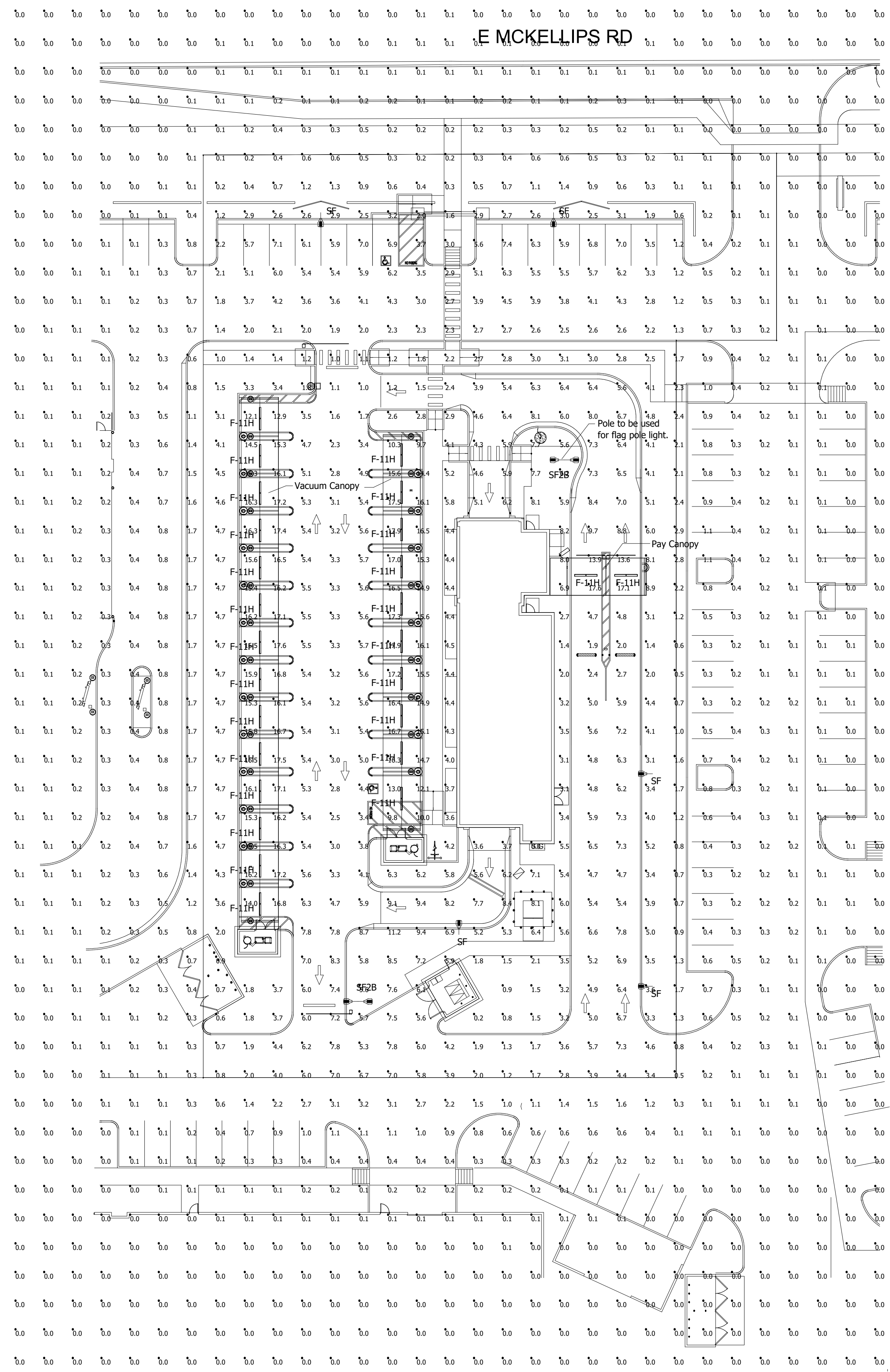

Luminaire Schedule							
Symbol	Qty	Label	Mounting Height	LLF	Lum. Lumens	Lum. Watts	Description
	26	F-11H	12	1.000	6778	52	VT3204HUNV50 (By Hermitage)
	5	SF	18	1.000	17653	135	ASL1-160L-135-5K7-4W-UNV-A-PSS
	2	SF2B	18	1.000	17653	135	ASL1-160L-135-5K7-4W-UNV-A-PSS

Calculation Summary							
Label	CalcType	Units	Avg	Max	Min	Avg/Min	Max/Min
Overall Area	Illuminance	Fc	1.90	17.9	0.0	N.A.	N.A.
Paved Area	Illuminance	Fc	4.76	11.2	0.7	6.80	16.00
Pay Canopy	Illuminance	Fc	14.44	19.8	8.8	1.64	2.25
Vacuum Canopy	Illuminance	Fc	17.20	23.0	8.0	2.15	2.88

Note: SES-16-40-01-D-S2-PSS-TAB30M38 + 2 Foot pole base ordering information based on this drawing. Please confirm EPA and Windload rating prior to ordering. Customer is responsible for base selection per local condi



Quick Quack Standard Color - Silver



#	Date	Comments
Revisions		

Drawn By: DHK  
 Checked By:  
 Date: 11/3/2025  
 Scale: 1" = 25'

QUICK QUACK CARWASH #63-124  
 SITE PHOTOMETRIC PLAN  
 E. MCKELLIPS ROAD  
 MESA, AZ

- Notes:
- 1: Luminaire data is tested to industry standards under laboratory conditions. Operating voltage and normal manufacturing tolerances of LED and drivers may effect field results.
  - 2: Conformance to facility code and other local requirements is the responsibility of the owner and/or the owner's representative.
  - 3: This design may not meet Title 24 or local energy code requirements. If this design needs to be altered to meet compliance, please contact the design team with specific requirements.



Note: For national account pricing/quotations and order placement, please contact Steve Friedman at Hermitage Lighting. (847)830-1444 sfriedman@gohermitage.com

- FEATURES**
- Square Steel Straight Shaft
  - One piece construction
  - 2 3/8" OD tenon, Open Top or Factory drilled Side Mount Options available
  - Steel Base Plate
  - 3 size options for anchor bolts. All anchor bolts fully galvanized with 2 nuts and washers (bolts ordered as separate line item and paper template included as component of anchor bolts)
  - Square base cover available (ordered as separate line item)
  - Pole finished in weather proof powder coat paint in 4 standard colors
  - 3" x 5" Gasketed hand hole standard

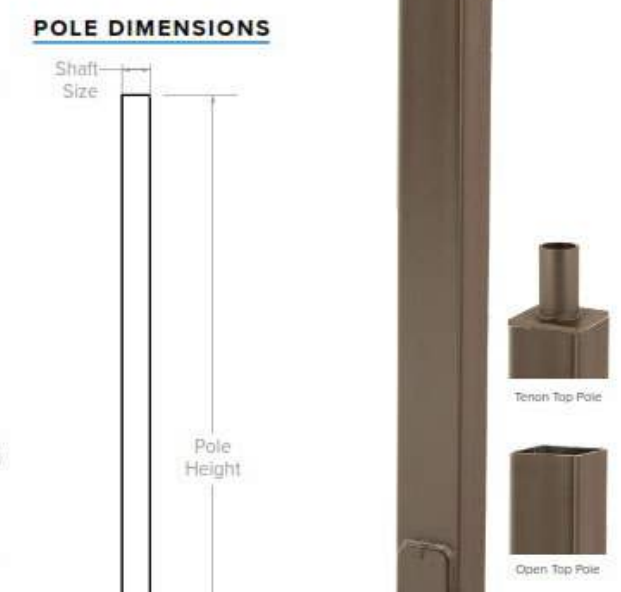

**SPECIFICATIONS**

The Square Steel Straight Pole has been successfully installed in projects of all types for over 30 years and has become the most popular and economical pole option for all site lighting applications including retail, commercial, industrial and residential projects.

The popularity of this series is due to its full offering of sizes, heights and standard colors with complete offering of mounting options, accessories and select styles/colors stocked for immediate shipping.

**ORDERING GUIDE**

Series	Height	Size	Range	Mounting	Drilling	Coating	Color
SES	20, 25, 30 Feet	16, 20, 24, 30	07	TA 21" OD Tenon TB 21" OD Tenon OT Open Top Pole A Side-Single B Side-Double C Side-Double @ 90° D Side-Double @ 90° F Side-Guard @ 90°	Blank No Drilling 2 Dia Pattern 2 6 Dia Pattern 6 26 Dia Pattern 26 C Custom Drill Pattern E3 2bolt @ 12" spacing Ribs, Viper Arms	Blank, None GL Galvanized WH White BL Black PS Premium Silver	DB Dark Bronze WH White BL Black PS Premium Silver

Notes: 1. All items stocked galvanneal poles have an 80 wind load test. 2. Tenon 2" x 5".

**VT4 LED Vaporite**

**Product Description**

The VT4 LED Linear Vaporite is designed to give long lasting, energy efficient light in demanding locations. The VT4 is provided with CCT and lumen output selectable options with the choice of 3500K, 4000K, or 5000K CCTs and low, medium, and high lumen output. It is also DLC 5.1 Standard certified, ensuring top of the line quality and performance. This IP66 rated fixture is dust and water tight and replaces legacy fluorescent strip lights in car wash operations, garages, maintenance facilities, canopies, locker rooms and stairwells.

- Construction**
- Fully gasketed polycarbonate housing
  - Captive stainless steel latches ensure a water tight seal
  - Fully sealed light chamber keeps LEDs sealed during installation

- Optical System**
- UV stabilized, frosted polycarbonate lens
  - Wrapped lens provides 5% uplight
  - 80+ CRI

- Electrical**
- Input voltage of 120-277VAC
  - Wattage selector switch on driver, CCT selector switch in body
  - Dim-to-off via 0-10VDC controls
  - Optional, factory installed, 8W and 18W EM packs available
  - Power factor > 0.95
  - THD < 6%
  - Luminaire surge protection level: designed to withstand up to 2.5Mv ring wave per ANSI C82.7.5-2017 requirements for Indoor Hard-wired and Indoor Portable Luminaires

- Controls**
- Optional microwave sensor installs behind lens
  - 12V output from driver to power NICOR sensor

- Mounting and Installation**
- Toolless surface mount installation via spring-steel clips
  - Clips contain mounting feature for cable suspension
  - Can be surface mounted to walls and ceilings for application variability
  - Drill through knockouts available: 3 on back, 1 on each end
  - Operating temperature range:
    - 40°F to 113°F (-40° to 45°C) when surface mounted
    - 40°F to 122°F (-40° to 50°C) when suspended at least 18" from ceiling
  - For installations where power surge may be possible, NICOR recommends installing additional surge protection at the electrical distribution panel

- Listings**
- e-Listed 1598 Listed for wet locations
  - UL94 V-0 flame classification
  - IP66 Rated
  - RoHS Compliant
  - DLC 5.1 Standard Compliant
  - Meets FCC Part 15, Subpart B, Class A standards for conducted and radiated emissions
  - TM 21 Reported L70/50k hrs > 50,000 hours
  - LM-79, LM-80 testing performed in accordance with IESNA standards

- Warranty**
- 5-year limited system warranty standard
  - Warranty does not cover product failure due to an overvoltage event (power surge)

Project: VT4454SUNVSS  
Catalog: F4, F11  
Type: \_\_\_\_\_  
Date: \_\_\_\_\_



**VT4 LED Adjustable Vapor Tight Wattage Selectable CCT Selectable**



**ORDERING INFORMATION CONTD.**

Catalog Number	Pole Ht. (ft)	Nominal Shaft Dim. (in)	Wind Load Rating: ASCE 7-05 wind map EPA Load Rating (2 second gust wind speeds)										Wall Thick. (in)	Bolt Circle (in)	Bolt Circle (in)	Bolt Sp. (in)	Base Plate (in)	Anchor Bolt Size (in)	Bolt/Prng. (in)		
			85 MPH	90 MPH	100 MPH	110 MPH	120 MPH	130 MPH	140 MPH	150 MPH	160 MPH	170 MPH									
SES-10-40-01-XXXX	10	3.0	4"	25.0	25.0	25.0	22.8	20.6	17.0	14.2	11.0	11.0	0.125"	11"	8.1"	5.6-7.8"	10.25 x 0.75"	3/4 x 30 x 3"	4"	77	
SES-10-50-01-XXXX	10	3.0	5"	25.0	25.0	25.0	22.8	20.6	17.0	14.2	11.0	11.0	0.125"	11"	8.1"	5.6-7.8"	10.25 x 0.75"	3/4 x 30 x 3"	4"	95	
SES-12-40-01-XXXX	12	3.7	4"	25.0	25.0	25.0	20.0	18.1	13.2	9.8	8.9	8.1	7.4	0.125"	11"	8.1"	5.6-7.8"	10.25 x 0.75"	3/4 x 30 x 3"	4"	81
SES-12-50-01-XXXX	12	3.7	5"	25.0	25.0	25.0	20.0	18.1	13.2	9.8	8.9	8.1	7.4	0.125"	11"	8.1"	5.6-7.8"	10.25 x 0.75"	3/4 x 30 x 3"	4"	99
SES-14-40-01-XXXX	14	4.3	4"	25.0	25.0	25.0	20.0	18.1	13.2	9.8	8.9	8.1	7.4	0.125"	11"	8.1"	5.6-7.8"	10.25 x 0.75"	3/4 x 30 x 3"	4"	103
SES-14-50-01-XXXX	14	4.3	5"	25.0	25.0	25.0	20.0	18.1	13.2	9.8	8.9	8.1	7.4	0.125"	11"	8.1"	5.6-7.8"	10.25 x 0.75"	3/4 x 30 x 3"	4"	121
SES-16-40-01-XXXX	16	4.9	4"	19.0	16.7	13.0	11.5	10.1	7.9	6.2	4.7	4.1	3.6	0.125"	11"	8.1"	5.6-7.8"	10.25 x 0.75"	3/4 x 30 x 3"	4"	116
SES-16-50-01-XXXX	16	4.9	5"	25.0	25.0	25.0	20.0	18.1	13.2	9.8	8.9	8.1	7.4	0.125"	11"	8.1"	5.6-7.8"	10.25 x 0.75"	3/4 x 30 x 3"	4"	219
SES-18-40-01-XXXX	18	5.5	4"	15.6	13.6	10.0	9.0	7.8	5.9	4.4	3.1	2.6	2.1	0.125"	11"	8.1"	5.6-7.8"	10.25 x 0.75"	3/4 x 30 x 3"	4"	129
SES-18-50-01-XXXX	18	5.5	5"	25.0	25.0	25.0	22.0	20.4	16.4	13.2	10.7	9.6	8.6	0.188"	11"	8.1"	5.6-7.8"	10.25 x 0.75"	3/4 x 30 x 3"	4"	243
SES-20-40-01-XXXX	20	6.1	4"	13.4	11.6	8.5	7.2	6.1	4.4	3.1	1.9	1.4	1.1	0.188"	11"	8.1"	5.6-7.8"	10.25 x 0.75"	3/4 x 30 x 3"	4"	142
SES-20-50-01-XXXX	20	6.1	5"	25.0	25.0	25.0	21.3	18.9	16.7	13.2	10.4	8.1	7.2	0.125"	11"	8.1"	5.6-7.8"	10.25 x 0.75"	3/4 x 30 x 3"	4"	267
SES-22-50-01-XXXX	22	6.7	5"	25.0	23.0	17.7	15.5	13.5	10.5	8.0	6.0	5.2	4.4	0.125"	11"	8.1"	5.6-7.8"	10.25 x 0.75"	3/4 x 30 x 3"	4"	292
SES-25-40-01-XXXX	25	7.6	4"	7.3	5.9	3.8	2.9	2.1	0.8	NR	NR	NR	NR	0.125"	11"	8.1"	5.6-7.8"	10.25 x 0.75"	3/4 x 30 x 3"	4"	175
SES-25-40-7-XXXX	25	7.6	4"	12.8	11.0	7.9	6.7	5.5	3.7	2.3	1.2	0.7	NR	0.188"	11"	8.1"	5.6-7.8"	11" x 1"	3/4 x 30 x 3"	4"	257
SES-25-50-01-XXXX	25	7.6	5"	20.7	19.8	13.3	11.5	9.8	7.2	5.0	3.3	2.4	1.9	0.125"	11"	8.1"	5.6-7.8"	10.25 x 0.75"	3/4 x 30 x 3"	4"	327
SES-28-50-01-XXXX	27	8.1	5"	10.1	13.7	9.7	8.1	6.7	4.4	2.6	1.1	NR	NR	0.188"	11"	8.1"	5.6-7.8"	10.25 x 0.75"	3/4 x 30 x 3"	4"	235
SES-30-40-01-XXXX	30	9.1	5"	13.5	11.3	7.7	6.2	4.9	2.8	1.1	NR	NR	NR	0.125"	11"	8.1"	5.6-7.8"	10.25 x 0.75"	3/4 x 30 x 3"	4"	367
SES-30-50-01-XXXX	30	9.1	5"	13.5	11.3	7.7	6.2	4.9	2.8	1.1	NR	NR	NR	0.125"	11"	8.1"	5.6-7.8"	10.25 x 0.75"	3/4 x 30 x 3"	4"	367

Catalog Number	Florida Building Code 2010 EPA Load Rating (2 second gust wind speeds)									
	85 MPH	90 MPH	100 MPH	110 MPH	120 MPH	130 MPH	140 MPH	145 MPH	150 MPH	160 MPH
SES-10-40-01-XXXX	25.0	25.0	25.0	23.5	20.5	17.8	15.9	11.0	11.0	0.1
SES-12-40-01-XXXX	25.0	25.0	25.0	21.9	18.6	15.8	13.6	11.7	8.1	7.4
SES-14-40-01-XXXX	25.0	25.0	25.0	21.1	17.5	14.4	12.3	10.4	8.8	5.9
SES-16-40-01-XXXX	23.2	20.9	17.0	15.8	14.4	9.4	7.7	6.3	4.1	3.0
SES-16-50-01-XXXX	25.0	25.0	25.0	23.0	24.9	21.0	17.9	15.2	12.3	11.2
SES-18-40-01-XXXX	19.0	16.8	13.5	12.1	9.0	6.9	5.9	4.7	3.0	2.7
SES-18-50-01-XXXX	25.0	25.0	25.0	24.1	20.0	16.7	13.9	11.6	9.6	8.6
SES-20-40-01-XXXX	15.3	13.6	10.6	8.3	6.4	4.8	3.5	2.5	1.3	0.9
SES-20-50-01-XXXX	25.0	25.0	24.0	19.6	16.0	13.1	10.7	8.7	7.2	6.3
SES-22-50-01-XXXX	25.0	24.8	19.8	15.8	12.7	10.1	8.0	6.2	5.2	4.4
SES-25-40-01-XXXX	8.8	7.4	5.2	3.4	1.9	0.7	NR	NR	NR	NR
SES-25-40-7-XXXX	7.7	6.4	4.3	2.8	1.3	NR	NR	NR	NR	NR
SES-25-50-01-XXXX	21.4	18.9	14.6	11.3	8.6	6.3	4.5	2.9	2.6	1.9
SES-28-50-01-XXXX	16.7	16.4	12.4	9.3	6.9	4.7	3.0	1.5	NR	NR
SES-30-50-01-XXXX	13.4	11.4	8.0	5.3	3.1	1.3	NR	NR	NR	NR
SES-30-40-01-XXXX	13.4	11.4	8.0	5.3	3.1	1.3	NR	NR	NR	NR

- QUICK SHIP**
- SES1807TADL POLE SES 180X4-5G-16A-TENON DARK BRONZE
  - SES22507TADL POLE SES 22X5H-5G-16A-TENON BLACK
  - SES25507TADL POLE SES 25X5H-5G-16A-TENON DARK BRONZE
  - SES25507TADL POLE SES 25X5H-5G-16A-TENON BLACK
  - SES25507TADL POLE SES 25X5H-5G-16A-TENON DARK BRONZE

**VT4 LED Vaporite**

**Ordering**

Series	Version	Length & Selectable Output	Voltage	Selectable CCT	Sensor	Emergency
VT	4 (Version 4)	64.5 (4-sec 45/30/15W)	UNV (120-277VAC)	58 (35-40-50K)	E1 (none)	E3 (18W)

Specifications and dimensions subject to change without notice.

**Accessories**

Snap In Microwave Motion Sensor	SNAPINSENSMWM
Remote Control for Snap In Sensor	SNAPINMWMREMOTE

**Performance Data**

Model	Output Setting	Performance Data				Emergency Pack Performance Data		
		Nominal CCT	Lumens	Max Watts	Efficiency	E1 Lumens	E2 Lumens	E3 Lumens
VT4454S	Standard	4000	5364	37.2	142.2	-	1154	2596
		5000	5544		149.0	-	1192	2682
		3500	6256		140.6	-	1125	2531
VT4454S	Medium	4000	6623	44.5	148.8	-	1190	2678
		5000	6466		145.3	-	1162	2615
		3500	7523		134.6	-	1077	2423
VT4454S	High	4000	7964	55.9	142.5	-	1140	2565
		5000	7776		139.1	-	1113	2504

**Photometric Data**

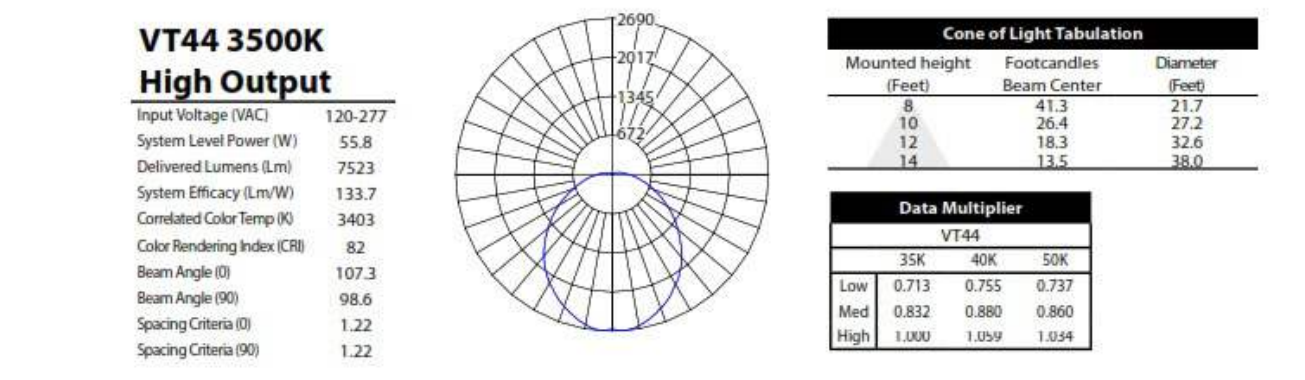

**SLING Micro Strike**

- FEATURES**
- Compact sleek design with multiple LED configurations and simple installation
  - The SLING includes a square mounting block for easy pole installation or mast arm option for 2-3/8" OD roadway brackets
  - Capable of replacing up to 100W HD Luminaires
  - Micro Strike optical distributions of Type 2, 3, 4F, 4W or 5GW
  - Tool-less entry option for easy installation and maintenance
  - 15G rated for high vibration applications including bridges and overpasses

