

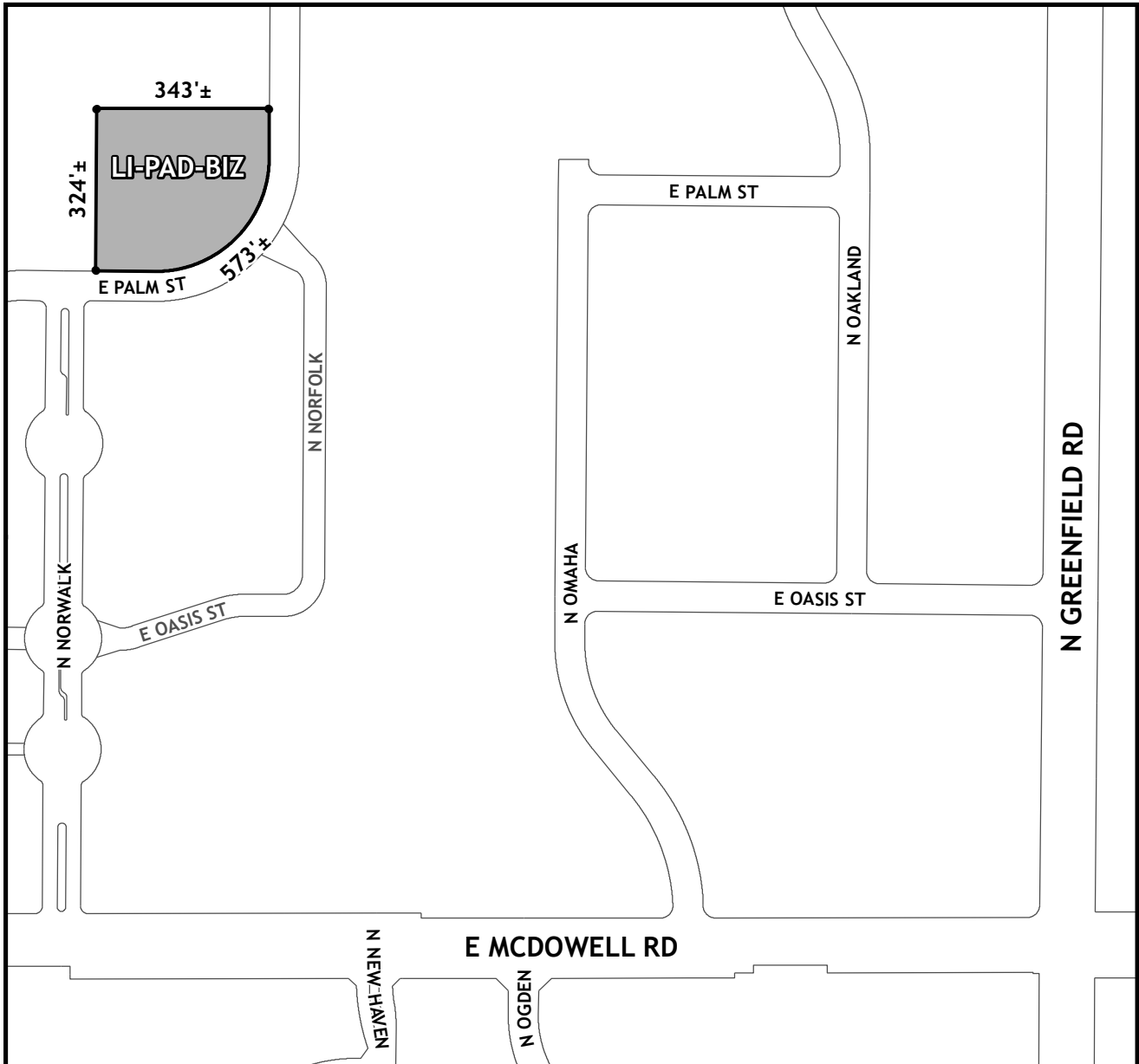

OFFICIAL SUPPLEMENTARY ZONING MAP AMENDING THE CITY OF MESA ZONING MAP



CASE: ZON24-00101

ACREAGE: 2.3±

REQUEST:). Rezone from Light Industrial with a Planned Area Development Overlay (LI-PAD) to Light Industrial with a Planned Area Development Overlay and a Bonus Intensity Zone Overlay (LI-PAD-BIZ) and Site Plan Review.

ORDINANCE: 5878

Please be advised that the attached zoning changes were approved by the Mesa City Council on October 7, 2024 by Ordinance # 5878. If you have any questions concerning these changes, contact the City of Mesa Planning Division at 480-644-2385.

_____ **ATTEST:** _____ **DATE:** _____
MAYOR **CITY CLERK**