

To: City of Mesa  
CC: Salt River Project  
Thursday, May 25, 2023

From: David Billings  
RE: Request for Formation of Irrigation Water Delivery District

Dear City of Mesa,

We as a neighborhood **Amberwood Estates**, are requesting consent to form an Irrigation Water Delivery District (IWDD) from the **City of Mesa**. The purpose of an IWDD is to create an equitable distribution of costs associated with the use and maintenance of the private neighborhood irrigation system. This is accomplished using an annual Maricopa County property assessment. We are asking the **City of Mesa** to pass this request of resolution, authorizing the formation of **Amberwood Estates IWDD**.

Enclosed you will find Salt River Project's approval along with maps of the proposed district, legal description, and the homeowner list. I will be the representative for the proposed IWDD. Once we receive approval from the **City of Mesa**, an Impact Statement to form will be sent to the Maricopa County Board of Supervisors to move the process forward. We appreciate your attention to this request. For questions please contact me at the number below.

Sincerely,

David Billings

[REDACTED]  
[REDACTED]  
[REDACTED]  
[REDACTED]

# Canal, Lateral, Gate: 3-023-0100

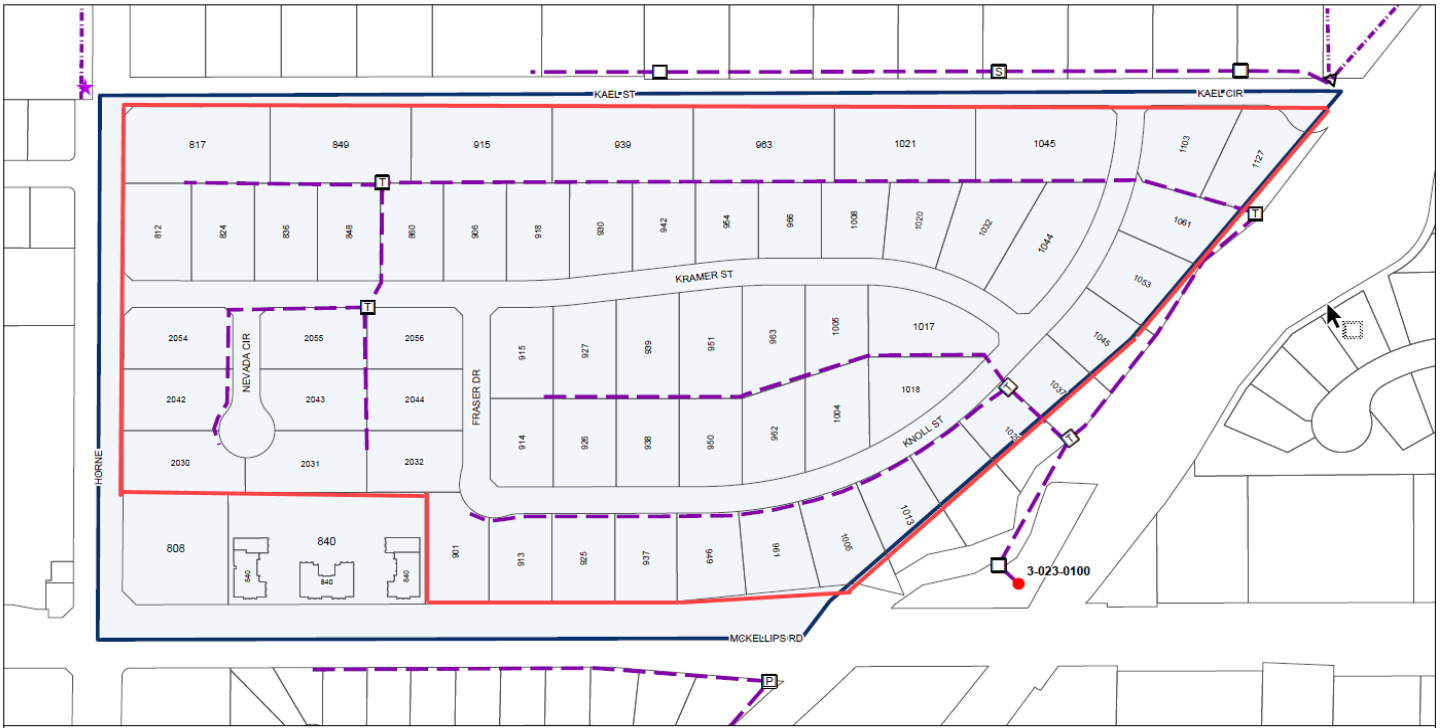

- Gate Boundary
- Dirt
- Pipe
- Standbox
- Pressure Valve
- Wheel Standbox
- Slide Standbox
- ★ Signpost
- Boundary Delivery Point - Active
- Slipform
- ▶ Ditch Check

28/61



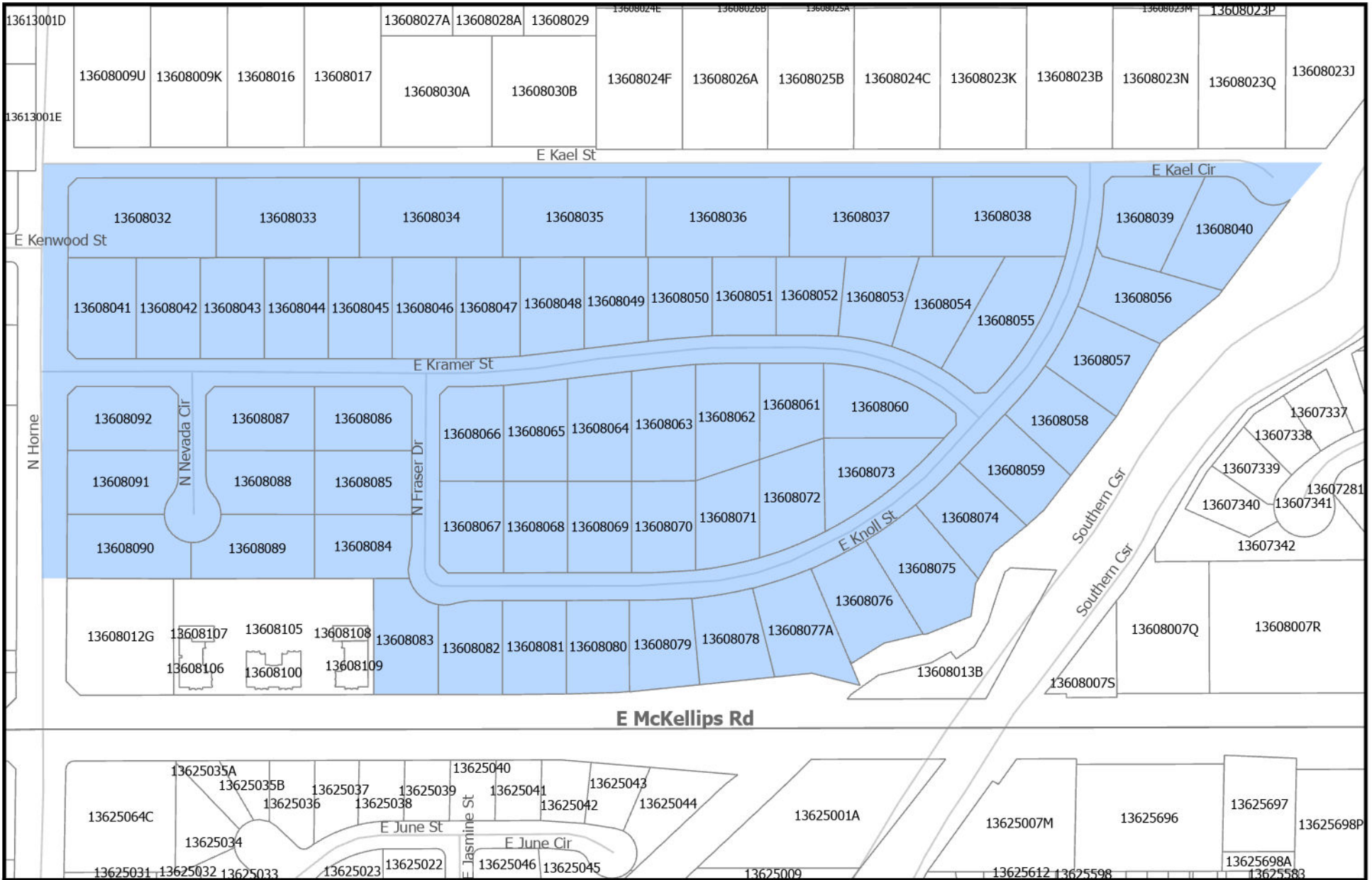

**Amberwood Estates IWDD**



**Legend**

- Parcels
- IWDD Legal Boundaries

Amberwood Estates Pwnership Report  
5/24/2023

Count	Parcel Number	Tax Year	City State Zip	Situs Address	Situs City Zip	Total Acreage
1	136-08-090	2023	MESA AZ 85203	2030 N NEVADA CIR	MESA 85203	0.552
2	136-08-077A	2023	MESA AZ 85203	1005 E KNOLL ST	MESA 85203	0.543
3	136-08-085	2023	MESA AZ 85203	2044 N FRASER DR	MESA 85203	0.462
4	136-08-057	2023	MESA AZ 85203	1053 E KNOLL ST	MESA 85203	0.511
5	136-08-068	2023	MESA AZ 85203	926 E KNOLL ST	MESA 85203	0.441
6	136-08-033	2023	PHOENIX AZ 85053	849 E KAEL ST	MESA 85203	0.847
7	136-08-088	2023	MESA AZ 85203	2043 N NEVADA CIR	MESA 85203	0.494
8	136-08-087	2023	MESA AZ 85203	2055 N NEVADA CIR	MESA 85203	0.511
9	136-08-053	2023	MESA AZ 85203	1020 E KRAMER ST	MESA 85203	0.388
10	136-08-078	2023	MESA AZ 85203	961 E KNOLL ST	MESA 85203	0.447
11	136-08-044	2023	MESA AZ 85203	848 E KRAMER ST	MESA 85203	0.474
12	136-08-034	2023	MESA AZ 85203	915 E KAEL ST	MESA 85203	0.848
13	136-08-079	2023	MESA AZ 85203	949 E KNOLL ST	MESA 85203	0.444
14	136-08-081	2023	MESA AZ 85203	925 E KNOLL ST	MESA 85203	0.441
15	136-08-082	2023	MESA AZ 85203	913 E KNOLL ST	MESA 85203	0.437
16	136-08-070	2023	MESA AZ 85203	950 E KNOLL ST	MESA 85203	0.439
17	136-08-065	2023	MESA AZ 85203	927 E KRAMER ST	MESA 85203	0.465
18	136-08-037	2023	MESA AZ 85203	1021 E KAEL ST	MESA 85203	0.848
19	136-08-084	2023	MESA AZ 85203	2032 N FRASER DR	MESA 85203	0.456

## Amberwood Estates Pwnership Report

5/24/2023

Count	Parcel Number	Tax Year	City State Zip	Situs Address	Situs City Zip	Total Acreage
20	136-08-051	2023	MESA AZ 85203	966 E KRAMER ST	MESA 85203	0.371
21	136-08-050	2023	MESA AZ 85203	954 E KRAMER ST	MESA 85203	0.376
22	136-08-063	2023	MESA AZ 85203	951 E KRAMER ST	MESA 85203	0.540
23	136-08-086	2023	MESA AZ 85203	2056 N FRASER DR	MESA 85203	0.459
24	136-08-049	2023	MESA AZ 85203	942 E KRAMER ST	MESA 85203	0.412
25	136-08-092	2023	MESA AZ 85203	2054 N NEVADA CIR	MESA 85203	0.519
26	136-08-042	2023	MESA AZ 85203	824 E KRAMER ST	MESA 85203	0.474
27	136-08-040	2023	MESA AZ 85203	1127 E KAEL CIR	MESA 85203	0.532
28	136-08-061	2023	MESA AZ 85214	1005 E KRAMER ST	MESA 85203	0.403
29	136-08-089	2023	MESA AZ 85203	2031 N NEVADA CIR	MESA 85203	0.534
30	136-08-083	2023	MESA AZ 85203	901 E KNOLL ST	MESA 85203	0.508
31	136-08-060	2023	MESA AZ 85203	1017 E KRAMER ST	MESA 85203	0.597
32	136-08-056	2023	MESA AZ 85203	1061 E KNOLL ST	MESA 85203	0.557
33	136-08-071	2023	MESA AZ 85203	962 E KNOLL ST	MESA 85203	0.455
34	136-08-064	2023	MESA AZ 85203	939 E KRAMER ST	MESA 85203	0.500
35	136-08-041	2023	MESA AZ 85203	812 E KRAMER ST	MESA 85203	0.506
36	136-08-072	2023	MESA AZ 85203	1004 E KNOLL ST	MESA 85203	0.466
37	136-08-062	2023	MESA AZ 85203	963 E KRAMER ST	MESA 85203	0.498
38	136-08-075	2023	TEMPE AZ 85281	1021 E KNOLL ST	MESA 85203	0.583
39	136-08-035	2023	MESA AZ 85203	939 E KAEL ST	MESA 85203	0.848
40	136-08-076	2023	MESA AZ 85203	1013 E KNOLL ST	MESA 85203	0.575
41	136-08-054	2023	MESA AZ 85203	1032 E KRAMER ST	MESA 85203	0.528
42	136-08-039	2023	MESA AZ 85203	1103 E KAEL CIR	MESA 85203	0.538
43	136-08-052	2023	MESA AZ 85203	1008 E KRAMER ST	MESA 85203	0.382
44	136-08-073	2023	MESA AZ 85201	1018 E KNOLL ST	MESA 85203	0.485
45	136-08-055	2023	MESA AZ 85203	1044 E KRAMER ST	MESA 85203	0.662

Amberwood Estates Pwnership Report  
5/24/2023

Count	Parcel Number	Tax Year	City State Zip	Situs Address	Situs City Zip	Total Acreage
46	136-08-046	2023	MESA AZ 85203	906 E KRAMER ST	MESA 85203	0.474
47	136-08-043	2023	MESA AZ 85203	836 E KRAMER ST	MESA 85203	0.475
48	136-08-067	2023	GILBERT AZ 85296	914 E KNOLL ST	MESA 85203	0.438
49	136-08-047	2023	MESA AZ 85203	918 E KRAMER ST	MESA 85203	0.467
50	136-08-038	2023	MESA AZ 85203	1045 E KAEL ST	MESA 85203	0.824
51	136-08-036	2023	MESA AZ 85201	963 E KAEL ST	MESA 85203	0.847
52	136-08-069	2023	MESA AZ 85203	938 E KNOLL ST	MESA 85203	0.441
53	136-08-045	2023	MESA AZ 85203	860 E KRAMER ST	MESA 85203	0.474
54	136-08-048	2023	MESA AZ 852031933	930 E KRAMER ST	MESA 85203	0.451
55	136-08-074	2023	MESA AZ 85203	1029 E KNOLL ST	MESA 85203	0.443
56	136-08-091	2023	MESA AZ 85203	2042 N NEVADA CIR	MESA 85203	0.503
57	136-08-080	2023	MESA AZ 85203	937 E KNOLL ST	MESA 85203	0.442
58	136-08-032	2023	MESA AZ 85203	817 E KAEL ST	MESA 85203	0.872
59	136-08-058	2023	MESA AZ 85250	1045 E KNOLL ST	MESA 85203	0.451
60	136-08-059	2023	MARICOPA AZ 85138	1037 E KNOLL ST	MESA 85203	0.460
61	136-08-066	2023	MESA AZ 85203	915 E KRAMER ST	MESA 85203	0.445
						<b>31.863</b>

**EXHIBIT A**

**LEGAL DESCRIPTION**

Lots 1 through 61, of AMBERWOOD ESTATES II, a Subdivision of a portion of the South Half of the Southeast Quarter of Section 2, Township 1 North, Range 5 East, of the Gila and Salt River Base and Meridian according to the Plat of Record in the Office of the County Recorder of Maricopa County, Arizona, Recorded in Book 406 of Maps, Page 33.

**EXHIBIT "C".**

**BEFORE THE BOARD OF SUPERVISORS OF MARICOPA COUNTY**

In the Matter of the Application and )	<b>CONSENT OF SALT RIVER PROJECT</b>
Petition for the Formation of an Irrigation )	<b>AGRICULTURAL IMPROVEMENT</b>
Water Delivery District to be known as: )	<b>AND POWER DISTRICT AND SALT</b>
<b>Subdivision Name</b> Irrigation Water )	<b>RIVER VALLEY WATER USERS'</b>
Delivery District of Maricopa County )	<b>ASSOCIATION, COLLECTIVELY</b>
	<b>REFERRED TO AS SRP.</b>

**TO: THE BOARD OF SUPERVISORS OF MARICOPA COUNTY,  
STATE OF ARIZONA**

Erica Trapp, being first duly sworn upon her oath, deposes and says:

That she is the Director of Water Delivery Services of the SRP.

That the lands to be included within the **Amberwood Estates** Irrigation Water Delivery District are within the Salt River Project Agricultural Improvement and Power District and the Salt River Valley Water Users' Association.

That the Board of Directors of the Salt River Project Agricultural Improvement and Power District and the Board of Governors of the Salt River Valley Water Users' Association consent to the formation of said Irrigation Water Delivery District and said action was duly authorized by resolutions dated March 5, 2001.

That she has read this Consent and knows the content thereof and that the matters and things contained herein are true and correct to the best of her own knowledge, information, and belief.

Erica Trapp

SUBSCRIBED AND SWORN TO before me this 25<sup>th</sup> day of May, 2023

My commission expires:

Stephanie Jo-Ann Berry  
Notary Public

