

EXTERIOR FINISH SCHEDULE			
KEY	MATERIAL / MFG.	COLOR / NO.	NOTES
A1	PREFINISHED METAL COPING	A1- SILVER - AT HIGH ROOF & CANOPY A1b - AGED BRONZE - AT NICHHA A1d - GRANITE - AT EIFS	SEE SPEC FOR ADDITIONAL INFO; NOTE AGED BRONZE IS CUSTOM COLOR PAINT (VALSPAR (SW) AGED BRONZE #437K239B) ON POST FORMED ALUMINUM
MASONRY VENEER PALETTE OPTIONS (SPEC-BRICK) - BASE BID (BRICK 'A')			
A2	SPEC-BRICK CONCRETE MASONRY VENEER	4Wx8Hx16L (12W @ CART WALL ONLY) GARDNER BLEND w/ HOLCIM "SANDBEIGE" MORTAR MORTAR ALT: SOLOMON "37H DEEP BROWN"	CONTACT THE CONCRETE PRODUCTS GROUP AT 800-789-0872 FOR ORDERING SEE SPEC FOR ADDITIONAL INFO
MASONRY VENEER PALETTE OPTIONS (QUIK-BRIK) - ALTERNATE No. 2 (BRICK 'B')			
A2	QUIK-BRIK CONCRETE MASONRY VENEER	4Wx8Hx16L (12W @ CART WALL ONLY) BISWARCK BLEND w/ HOLCIM "SANDBEIGE" MORTAR MORTAR ALT: SOLOMON "37H DEEP BROWN"	CONTACT ECHELON MASONRY AT 800-899-8455 FOR ORDERING SEE SPEC FOR ADDITIONAL INFO
MASONRY VENEER PALETTE OPTIONS (BELDEN) - ALTERNATE No.3 (BRICK 'C')			
A2	BELDEN BRICK	MODULAR MAYO BLEND w/ HOLCIM "DANDELION" MORTAR MORTAR ALT: SOLOMON 10X LIGHT BUFF	CONTACT THE BELDEN BRICK COMPANY AT 330-451-2031 FOR ORDERING SEE SPEC FOR ADDITIONAL INFO
A3	PREFINISHED ALUM. SILL FLASHING	A3 - BRIGHT SILVER A3a - PETERSEN ALUMINUM - 'AGED BRONZE'	SEE SPEC FOR ADDITIONAL INFO; NOTE AGED BRONZE IS CUSTOM COLOR PAINT ON POST FORMED ALUMINUM
A4	ALUMINUM STOREFRONT SYSTEM	ANODIZED ALUM.	RE: DWG. A602
A5	MEMBRANE ROOFING	GRAY	TOP OF SLOPED ROOF, CANOPY ROOF, AND BACK OF RAISED ROOF PROJECTIONS - SEE SPECIFICATIONS APPENDIX 'B'
A6	METAL SOFFIT PANELS	SOLID PANELS - SILVER METALLIC	RE: DWG. A301-A304
A7	EXTERIOR PAINT		RE: DWG. A603
A8	NOT USED		
A9	ALUMINUM COMPOSITE PANEL	BRIGHT SILVER	PROVIDE PANEL JOINTS AS SHOWN - PROVIDE ONE PIECE TIGHT FIT EXTRUDED MOLDING INSTALLATION SYSTEM WITH CENTER REVEAL TRIM BETWEEN PANELS AND J TRIM AT PANEL EDGES.
A10	NICHHA FIBER CEMENT EXTERIOR CLADDING	VINTAGEWOOD 'BARK'	CONTACT NICHHA AT 770-805-9466 FOR ORDERING. SEE SPEC FOR TRIM REQUIREMENTS AND ADDITIONAL INFO. ALL INCLUDED TRIM (H, J, L, CORNER, ETC) TO MATCH FCP - PANELS SHALL EXTEND ONTO THE ROOF FOR THE FULL DEPTH OF THE BUMPOUT
A11	BLRD-2	PT-19 / CL-4	RE: DWG A603
A12	BLRD-4		RE: DWG A603
A13	GUARD RAIL TYPE "A"	GALVANIZED STEEL	RE: DWG B2/A507
A14	GUARD RAIL TYPE "B"	GALVANIZED STEEL	RE: DWG B2/A507
A15	BLRD-3	GALVANIZED	RE: DWG A603
A16	DOCK LEVELER / SEAL AND BUMPERS	LEVELER - FACTORY FINISH / SEAL AND BUMPERS - FACTORY FINISH - BLACK	PROVIDE BRICK BEHIND DOCK SEAL
A17	MASONRY CONTROL JOINT		MAX 20' OC
A18	16" OVERFLOW SCUPPER (SEE PLUMBING DWGS)	MATCH COPING ABOVE	RE: DWG A2/A507
A19	ARCHITECTURAL CAST STONE	TANNERSTONE: AG-1	SEE SPEC FOR ADDITIONAL INFORMATION - MORTAR COLOR TO MATCH CAST STONE
A20	ALDI TOWER SIGN	BY SIGN VENDOR	7'-11 1/8" w. x 9'-5 1/2" h.; VERIFY SIGN SIZE PRIOR TO FRAMING OPENING SEE DETAIL C1/A504

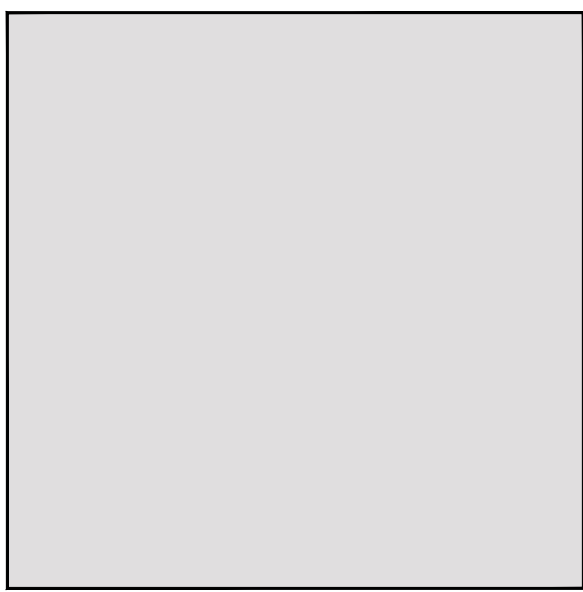

A2

SPEC-BRICK CONCRETE MASONRY VENEER  
"GARDNER BLEND"



A4

KAWNEER NORTH AMERICA  
ALUMINUM STOREFRONT  
"CLEAR ANODIZED FINISH"

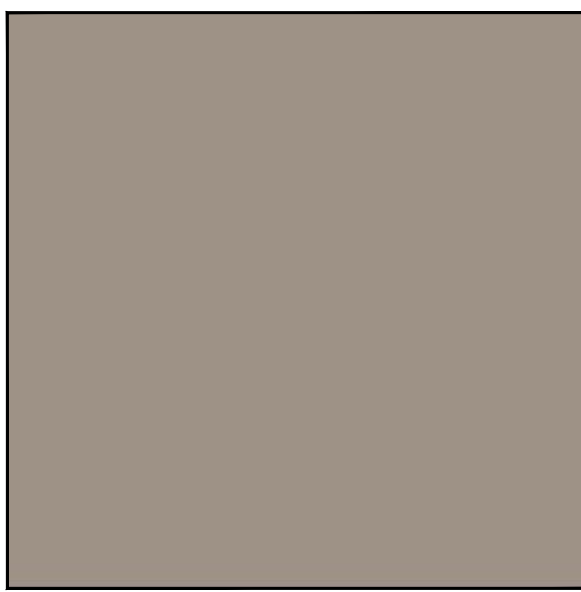

A7

SHERWIN WILLIAMS PAINT  
#7405  
"KEYSTONE GRAY"

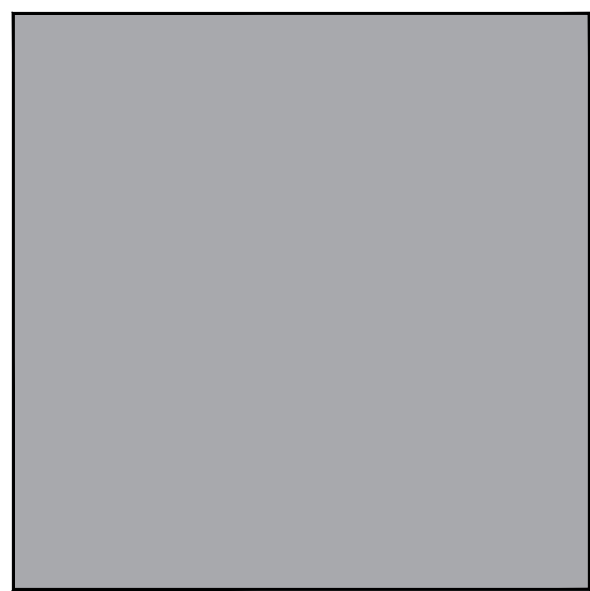

A9

OMEGA-LITE BY LAMINATORS INC  
ALUMINUM-FACED COMPOSITE WALL PANELS  
"BRIGHT SILVER"



A10

NICHIA FIBER CEMENT  
EXTERIOR CLADDING  
VINTAGEWOOD "BARK"

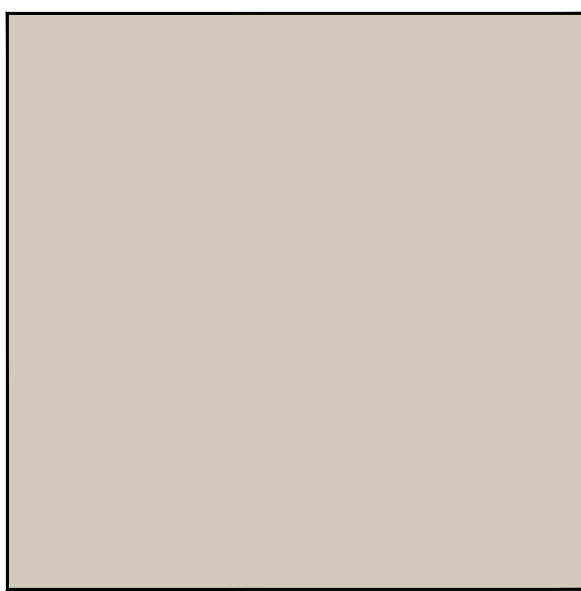

A29

DRYVIT SYSTEMS, INC.  
COLOR TO MATCH  
#104 DOVER SKY

EXTERIOR FINISH SCHEDULE			
KEY	MATERIAL / MFG.	COLOR / NO.	NOTES
A21	CRTB	NATURAL	RE: DWG A603 - SEE STRUCTURAL DWGS
A22	KNOX BOX	FACTORY FINISH	CONFIRM TYPE AND LOCATION WITH LOCAL FIRE MARSHAL
A23	AUTO DOOR SYSTEM & TRANSOM	ANODIZED ALUMINUM	RE: DWG A601 & A602
A24	NOT USED		
A25	8" X 8" PRE-FINISHED ALUM GUTTER	MATCH PREFINISHED METAL COPING	
A26	8" X 8" PRE-FINISHED ALUM DOWNSPOUT	MATCH PREFINISHED METAL COPING	TERMINATE AT CONC. SPLASH BLOCK
A27	ACP H/J TRIM / JOINT COVER		TYPICAL AT EDGES AND BUTT JOINTS OF ACP
A28	NICHHA FIBER CEMENT PANEL BASE FLASHING	PETERSEN ALUMINUM - 'AGED BRONZE'	SEE SPEC FOR ADDITIONAL INFO; NOTE AGED BRONZE IS CUSTOM COLOR PAINT ON POST FORMED ALUMINUM
A29	DRYVIT SYSTEMS, INC EXTERIOR INSULATION FINISH SYSTEM	SANDPEBBLE FINE DPR COLOR #104 DOVER SKY	SEE SPEC FOR ADDITIONAL INFO
A30	SES ENCLOSURE GATE		RE: DWG A507
A31	NICHHA CONTROL JOINT WITH "H" CLIP		
A32	3/4" ESTHETIC EIFS "V" GROVE		
A33	EIFS EXPANSION JOINT		MAX 75' OC
E1	EXIT DISCHARGE LIGHT	FACTORY FINISH	MOUNT @ 8'-0" A.F.F.
E2	WALL SCONCE	FACTORY FINISH	MOUNT @ 14'-8" A.F.F.; RE: DWG. A111 FOR DIMENSIONS
E3	JUNCTION BOX WITH COVER FOR FUTURE CARD READER		MOUNT CENTERED @ 46" A.F.F., SEE ELEC DWGS
E4	UTILITY METERING & C.T.	FACTORY FINISH	SEE ELECTRICAL DWGS
E5	EXTERIOR WALL PACK	FACTORY FINISH	MAN DOORS - MOUNT @ 9'-0" A.F.F., BREAK ROOM WINDOW @ 10'-0" A.F.F. LOADING DOCK - MOUNT @ 12'-0" A.F.F.
E6	EXTERIOR DUPLEX RECEPTACLE	FACTORY FINISH	MOUNT @ 1'-6" A.F.F. IN 4' SQUARE J-BOX
E7	NOT USED		
E8	EXTERIOR UPLIGHTING FIXTURES	FACTORY FINISH	SEE ELEC DWGS
F1	FIRE DEPT. CONNECTION	FACTORY FINISH	SEE FIRE PROTECTION DWGS
F2	MOTOR GONG	FACTORY FINISH	SEE FIRE PROTECTION DWGS
P1	HOSE BIB	FACTORY FINISH	SEE PLUMBING DWGS
P2	RPZ DISCHARGE	FACTORY FINISH	SEE PLUMBING DWGS
P3	GAS METER	FACTORY FINISH	SEE PLUMBING DWGS
XX	GLAZING KEY		RE: DWG A602
XX	ALIGN KEY		A: ALIGN NICHHA PANEL JOINTS AND WINDOW MULLIONS B: ALIGN ALUMINUM COMPOSITE PANEL JOINTS AND NICHHA PANEL JOINTS C: ALIGN NICHHA PANEL JOINTS, ALUMINUM COMPOSITE PANEL JOINTS, AND WINDOW MULLIONS

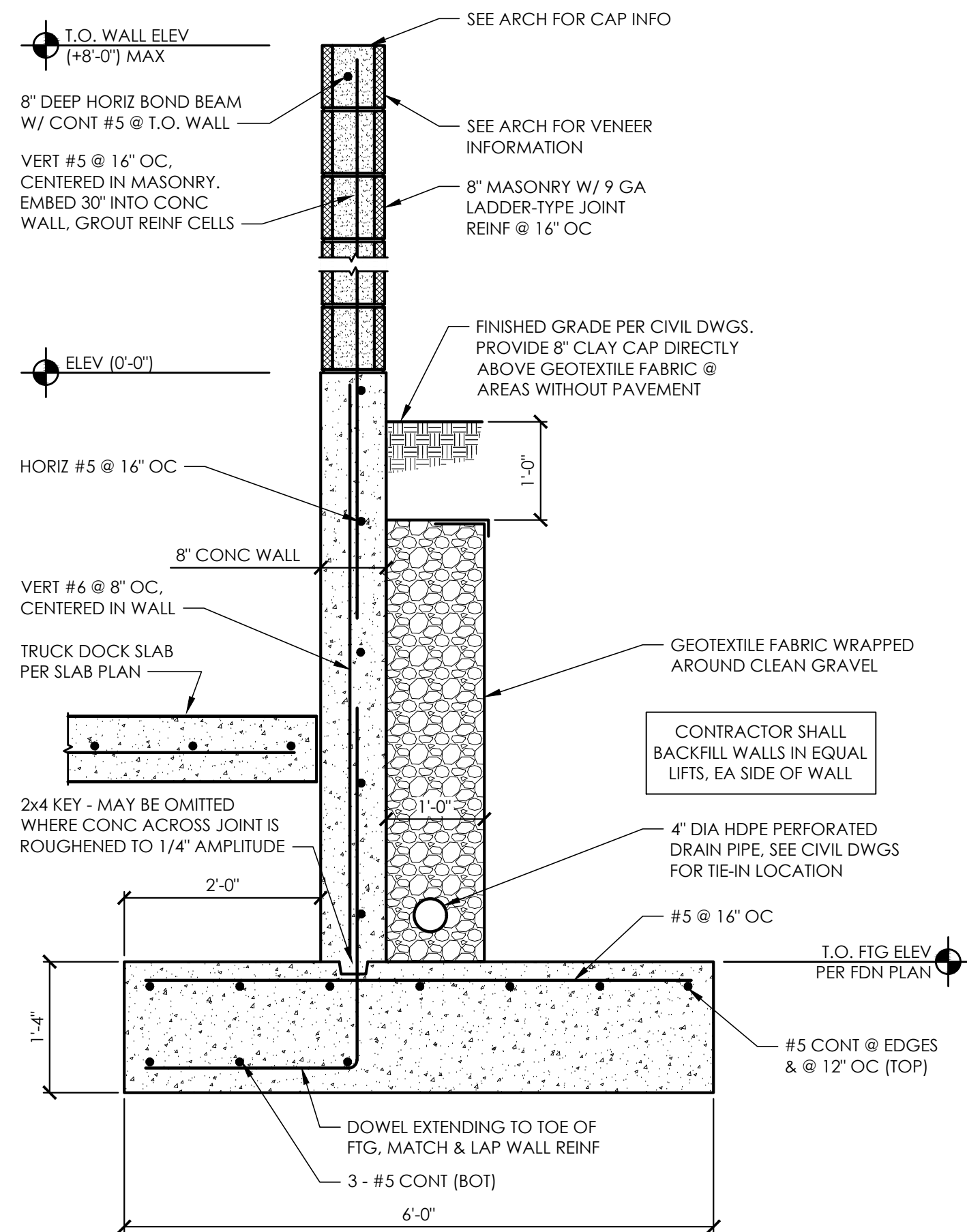

A1 Typical Dock Retaining Wall Section  
SCALE: 3/4" = 1'-0"



Copyright © 2023  
APD Engineering & Architecture  
615 Fishers Run Victor, NY 14564  
585.742.2222 - www.apd.com

Drawing Alteration  
It is a violation of law for any person, unless acting under the direction of licensed Architect, Professional Engineer, Landscape Architect, or Land Surveyor to alter any item on this document in any way. Any licensee who alters this document is required by law to affix his or her seal and to add the notation "Altered By" followed by his or her signature and the specific description of the alteration or revision.

DO NOT SCALE PLANS  
Copying, Printing, Software and other processes required to produce these prints can stretch or shrink the actual paper or layout. Therefore, scaling of this drawing may be inaccurate. Contact APD E&A with any need for additional dimensions or clarifications.

Issued:		Date:
A	Issued for Client Review	08/03/2023
B		
C		
D		
E		

Revisions:		Date:
1		
2		
3		
4		
5		
6		
7		
8		
9		
10		
11		
12		

PROJECT ARCHITECT/ENGINEER	DATE
PROJECT LEAD	DATE

Seal Seal

**ALDI Inc.**  
5080 N. 40th Street, Ste. 335  
Phoenix, AZ 85018  
(602) 888-8931

ALDI Inc. Store #: XX  
Mesa, AZ  
SEC E. Elliot Rd. & S. Power Rd.  
Mesa, AZ 85212  
Maricopa County  
Project Name & Location:

Concept Material Schedule Drawing Name:		Project No.
Date: 08/03/2023		23-0143A
Type: RHRDV7ER		
Drawn By: DRW		CEE-2.1
Scale: As Noted		Drawing No.