



Design Review Board



DRB22-00376

Reed Park Residences

Jennifer Merrill, Senior Planner

June 13, 2023



Request

- Design Review
- To allow a new apartment development





Location

- West of Gilbert Road
- South of Broadway Road
- East side of Williams, across from Reed Park

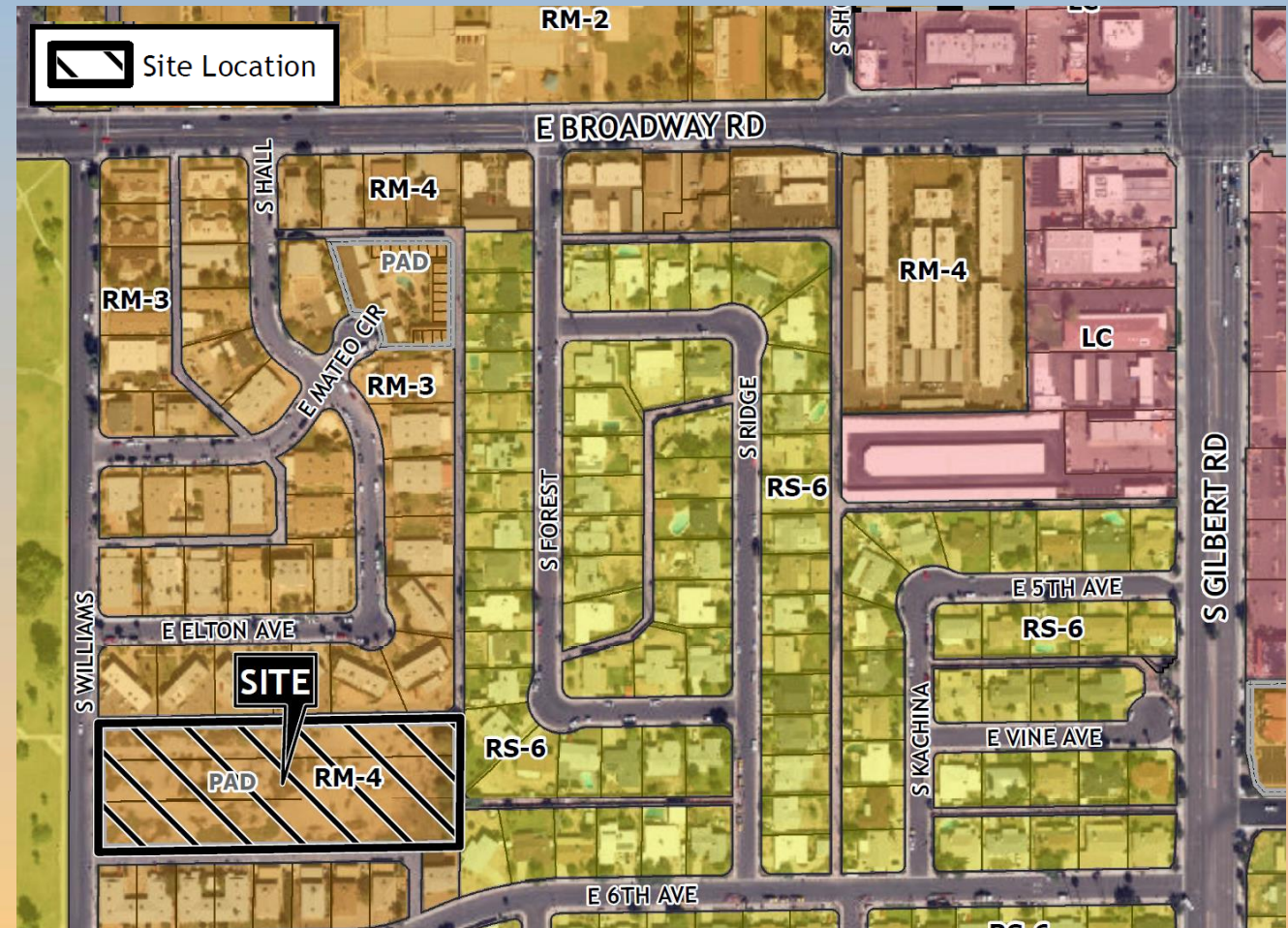



Zoning

Multiple-Residence-4 with a
Planned Area Development
overlay (RM-4 PAD)





Site Photo



Looking northeast towards the site from Williams



Site Photo



Looking southeast towards the site from Williams



Site Plan

- Two 3-story apartment buildings
- Centrally located amenities
- Gated development
- Pavers at entry
- Pedestrian paths around buildings and amenities

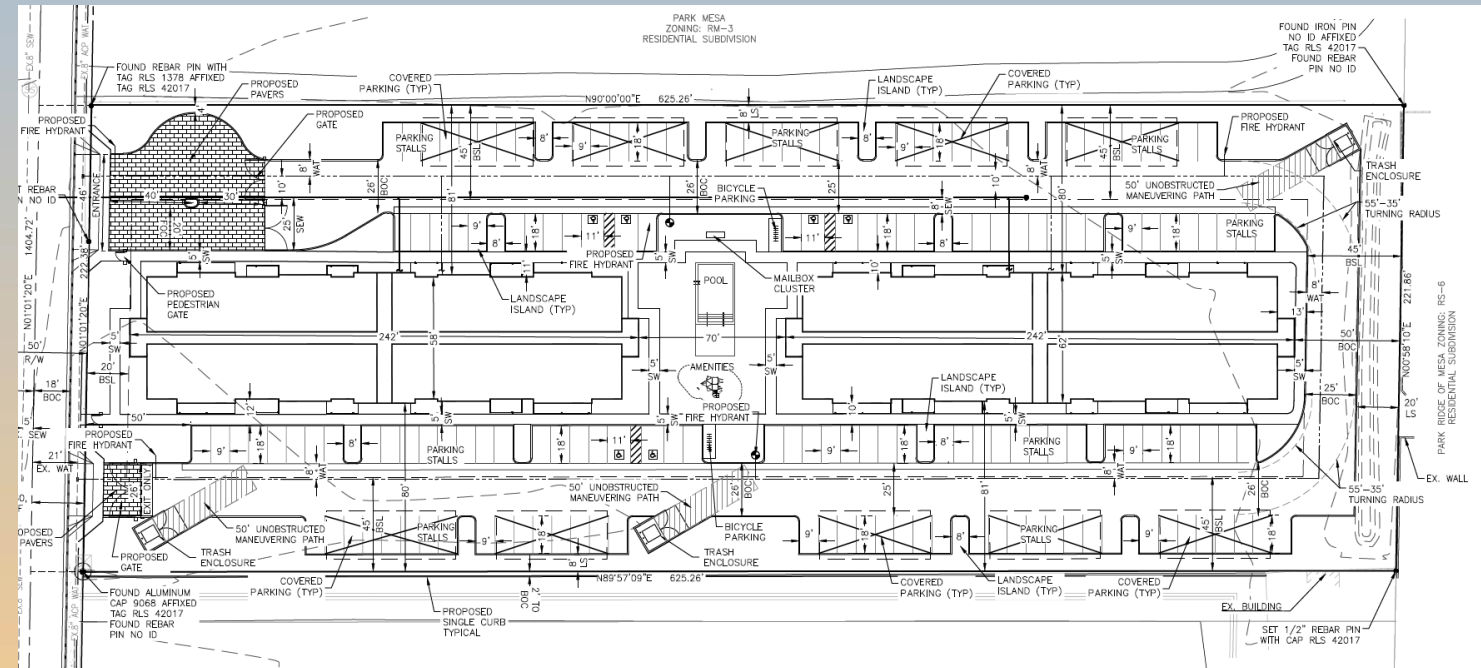



Front Elevation





Side & Rear Elevations





Rendering





Rendering





Material Board



James
Hardie –
Plank Lap
Siding –
Timber
Bark

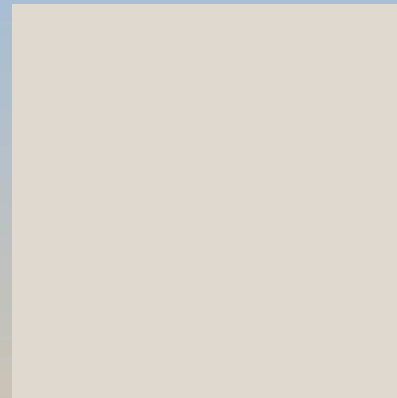

Sherwin-
Williams –
Egret White

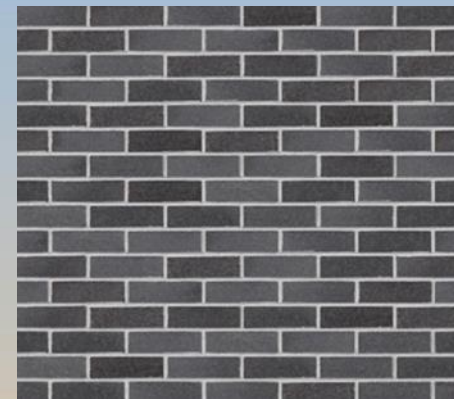

Beehive
Brick &
Stone –
Manganes
e Smooth
Norman
Thin



PPG –
Stonehenge
Greige



Material Board



CMU Wall –
Painted to
match Crystal
Haze #DE6219

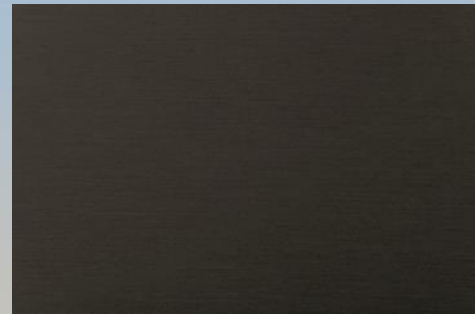

Dark
Anodized
Bronze –
Parking
Canopies,
Fence
Railings &
Trash

Dark
Anodized
Bronze
Aluminum
Metal Mesh
at Exterior
Stairways

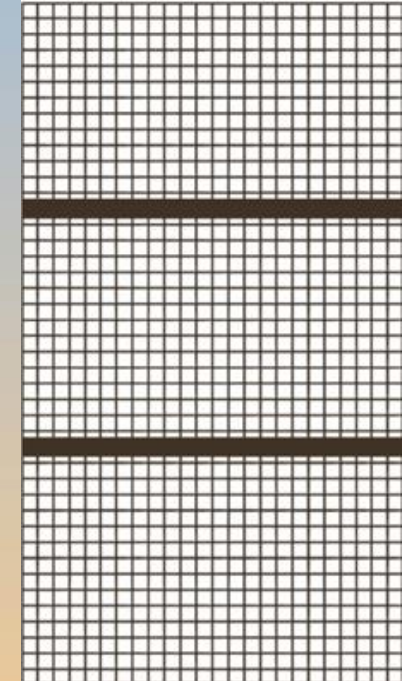



Findings

Staff is seeking your review and recommendation on the following:

- ✓ Proposed building elevations and landscape design

Staff welcomes any feedback



Design Review Board



General Plan

Neighborhood

- Safe places to live and enjoy surrounding community
- Associated non-residential uses

