



2 AMENITY AXON

AMENITY AREA DESIGN:

EACH BUILDING BLOCK WILL ROUTE ROOFTOP HVAC CONDENSATE AND RAINWATER TO A NEARBY LANDSCAPING/RECESSED RETENTION AREA WITH A NUMBER OF DISTINCT PLANTER THAT WILL BE FILLED SEQUENTIALLY. WATER RUNOFF FROM THE DRIVE AISLE WILL ALSO BE ROUTED TO THESE PLANTERS.

IN THE PLAN, EACH OF THE PLANTERS IS NUMBERED, IDENTIFYING THE PLANTERS AND THEIR FILL ORDER.

AREA 1 WILL RECEIVE THE MOST WATER OVER THE YEAR. WHEN IT REACHES CAPACITY, THE WATER WILL BEGIN TO FILL THE NEXT AREA IN THE SEQUENCE AND THEN THE NEXT. AREA 4 IS THE AREA THAT WILL CONTAIN SEATING AND/OR AMENITIES AND WILL ONLY BEGIN TO FILL DURING DURING LARGE RAIN EVENTS.

NOTE:

PLANT MATERIALS AND PERCENTAGES TO BE PROVIDED BY LANDSCAPE ARCHITECT.

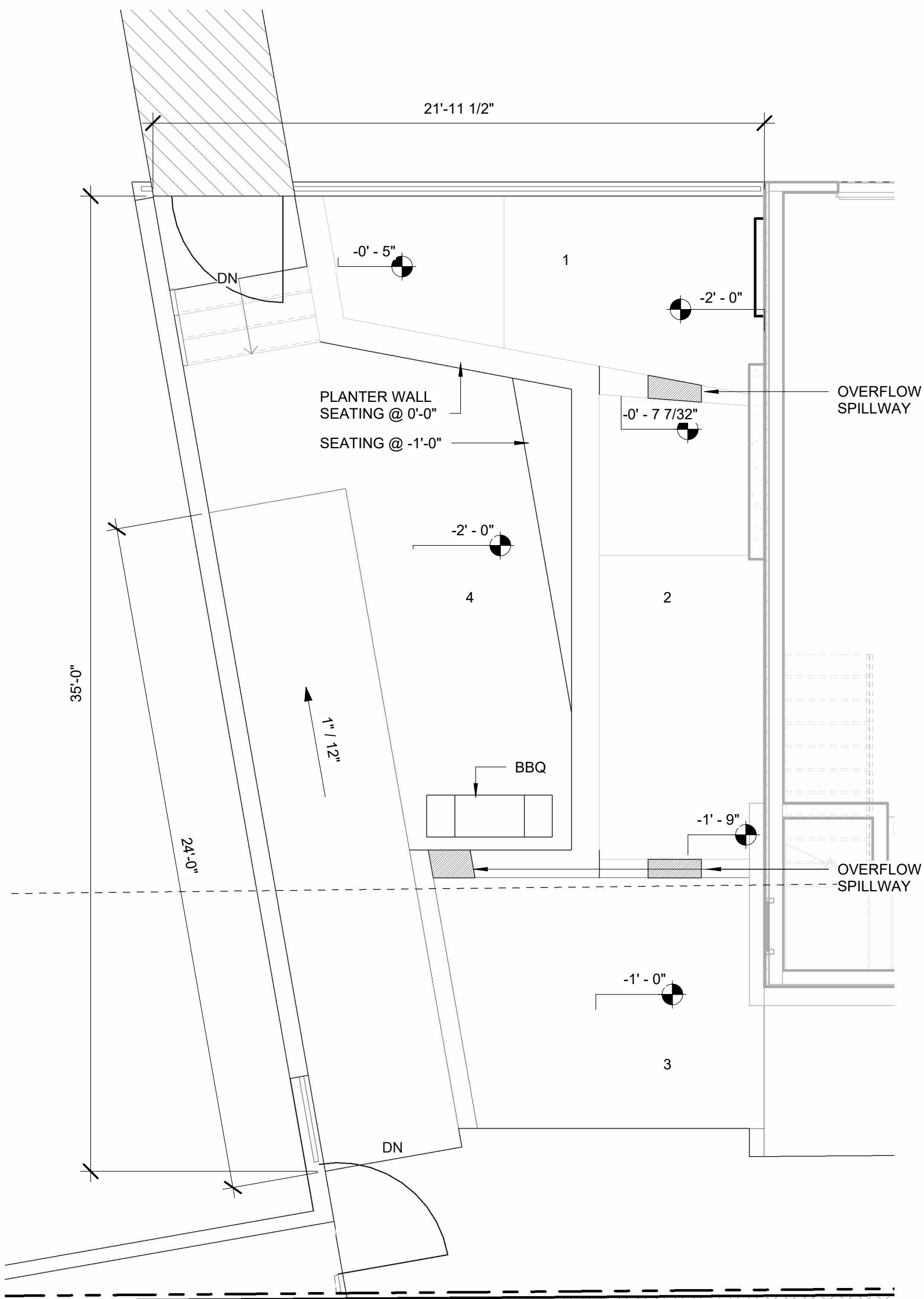

1 AMENITY PLAN
1/4" = 1'-0"

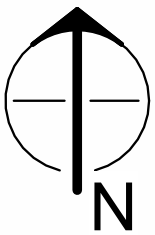
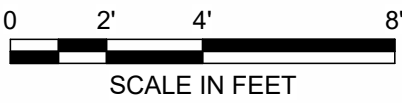

PRELIMINARY
NOT FOR
CONSTRUCTION

no.	date	description

HIGHLIGHTS

623 S MESA DR
MESA, AZ 85210

PROJECT NO: 23065
DATE: 01/11/24



atmosphere architects
p.o. box 5267
mesa, az 85211

contact: Tim Boyle
email: tim@atmosarch.com
tel: 917-526-0323

AMENITY PLAN
AS105