



Design Review Board



DRB22-00376



Request

- Design Review
- To allow a multiple residence development





Location

- West of Gilbert Road
- South of Broadway Road
- East side of Williams

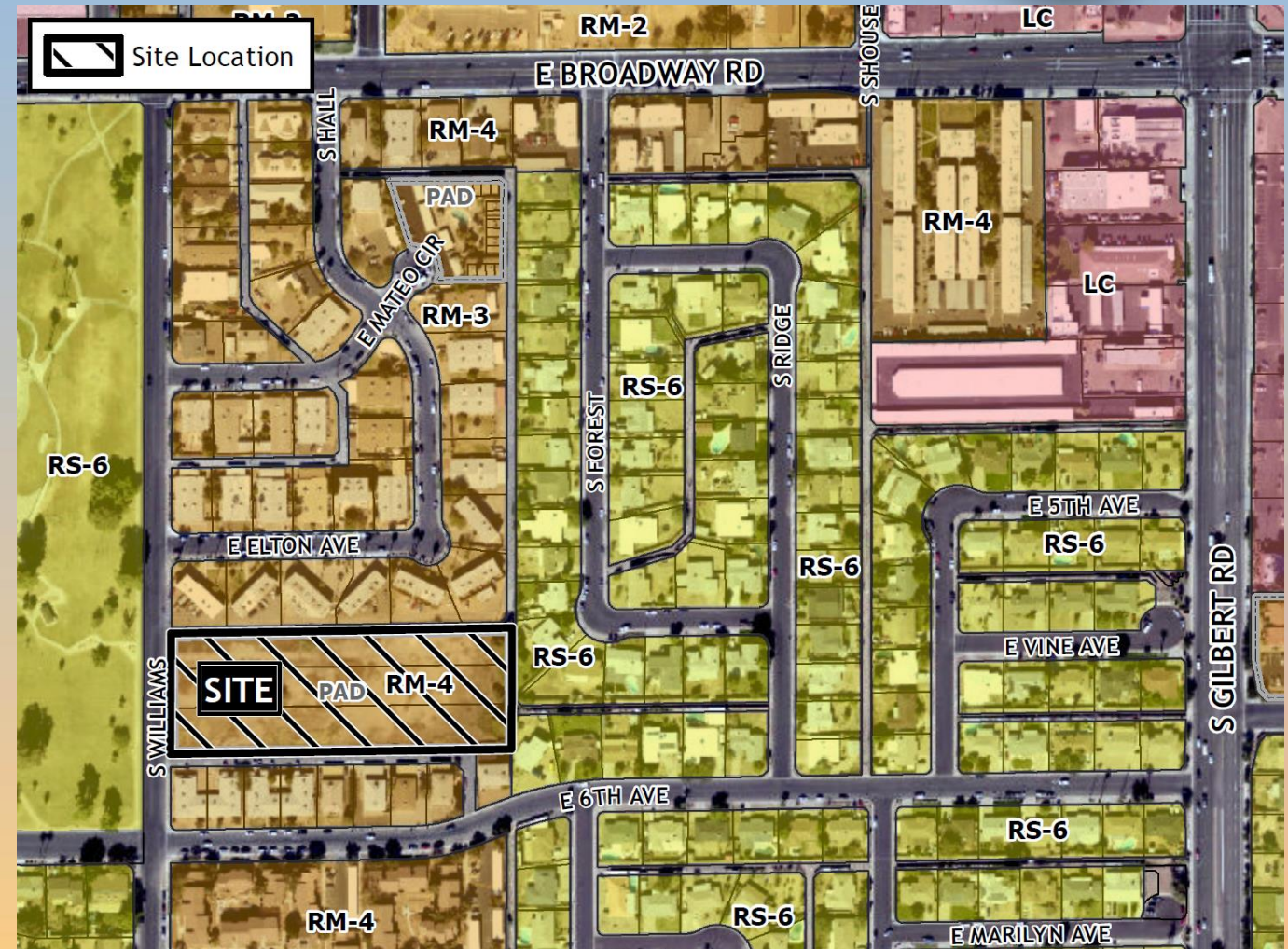



Zoning

- RM-4-PAD

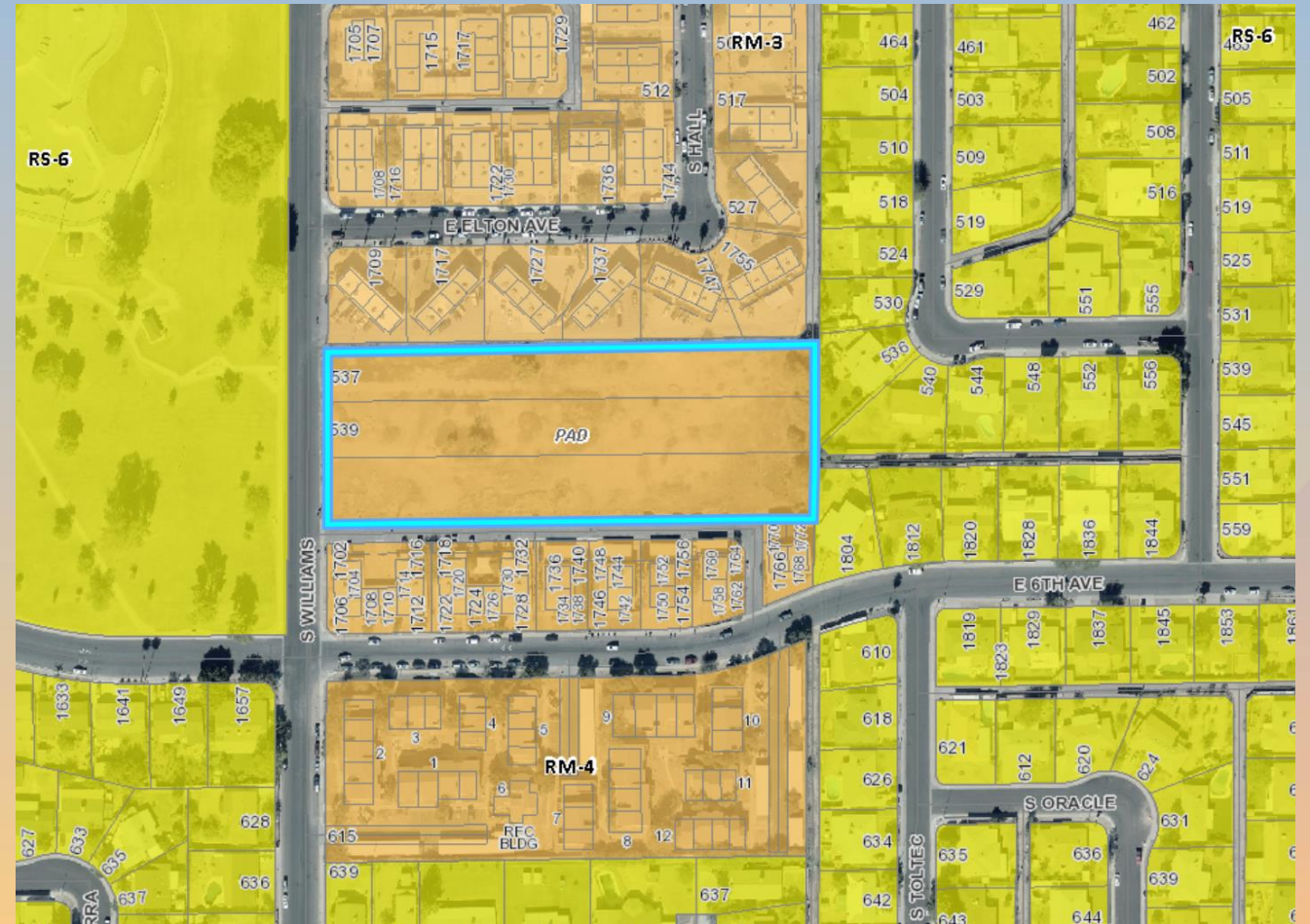



Site Photos



Looking southeast from Williams



Site Photos



Looking northeast from Williams



Site Plan

- 7 multi-unit bldgs
- Swimming pool
- Pedestrian paths
- Guest parking
- Gated

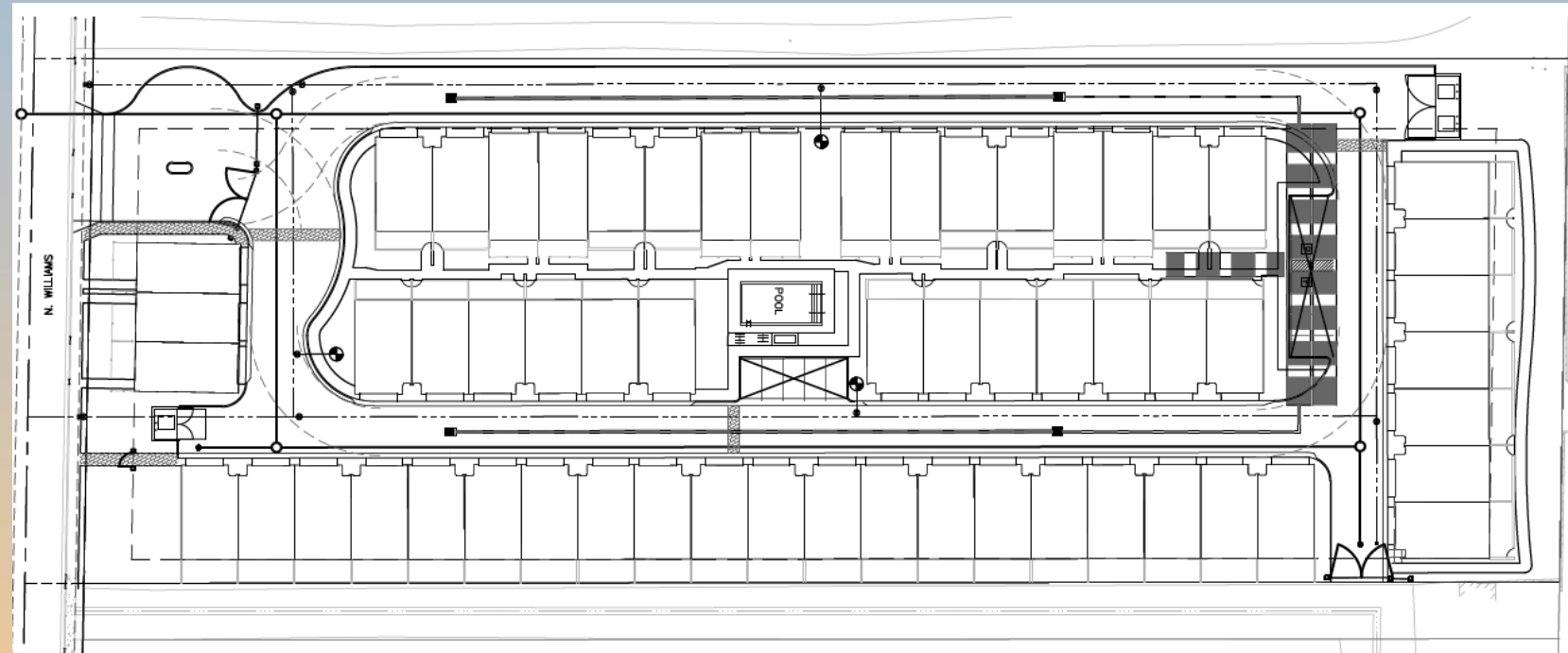



Landscape Plan

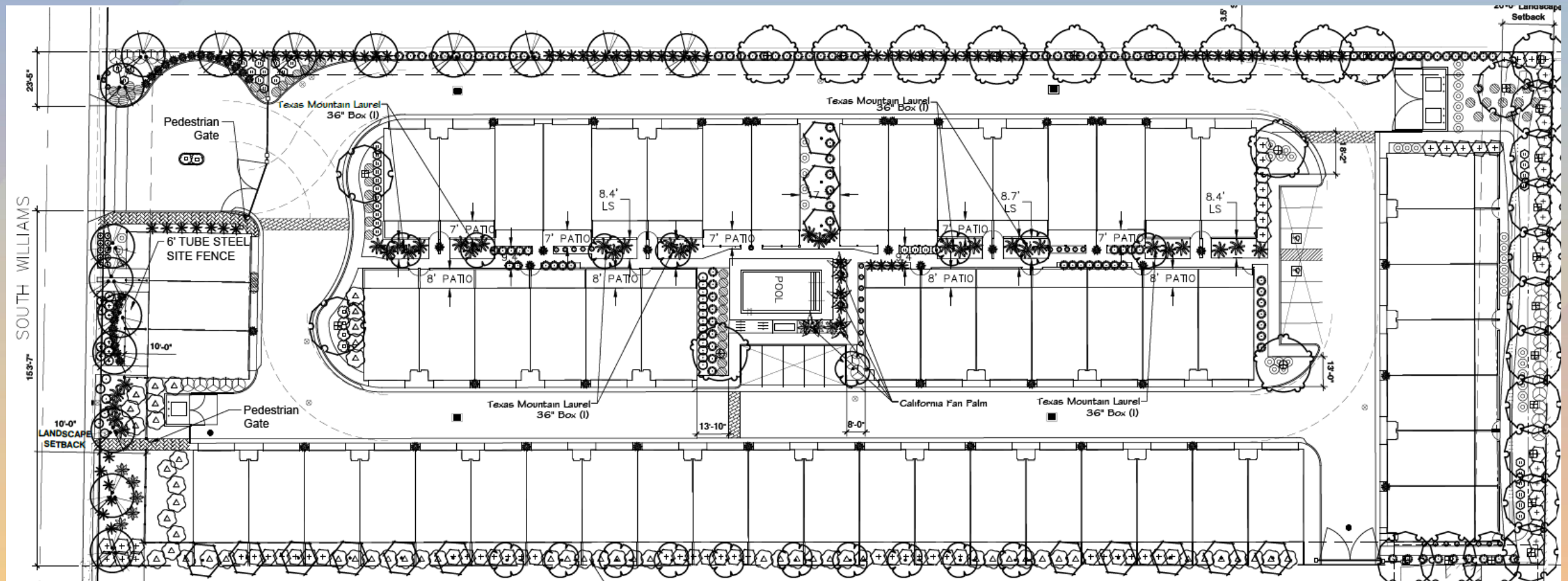



Elevations - Style A



FRONT ELEVATION



RIGHT ELEVATION

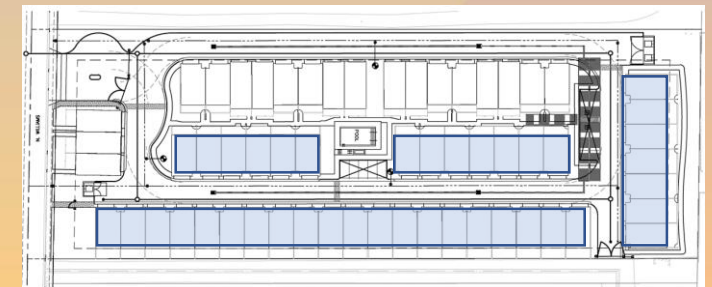



Elevations - Style A



BACK ELEVATION



8
12
LEFT ELEVATION

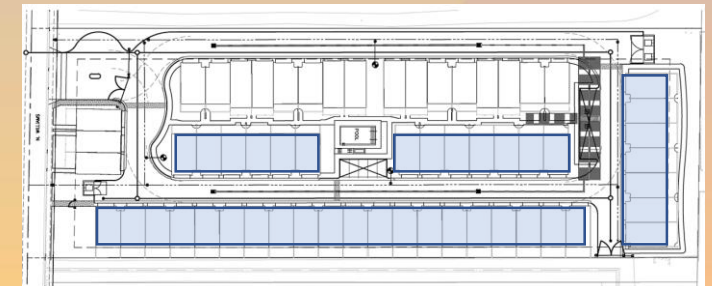



Elevations - A-B Mix



FRONT ELEVATION



**RIGHT ELEVATION
(TYPICAL A-STYLE)**

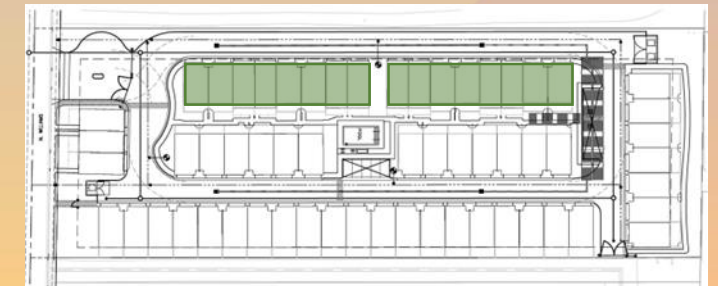



Elevations - A-B Mix



BACK ELEVATION



12 LEFT ELEVATION
(TYPICAL B-STYLE)





Elevations - Style C



FRONT ELEVATION



RIGHT ELEVATION

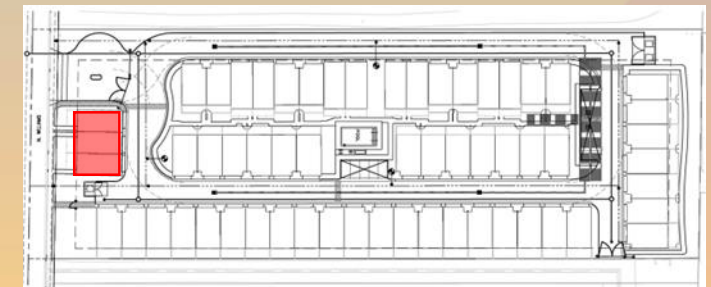



Elevations - Style C



BACK ELEVATION



LEFT ELEVATION

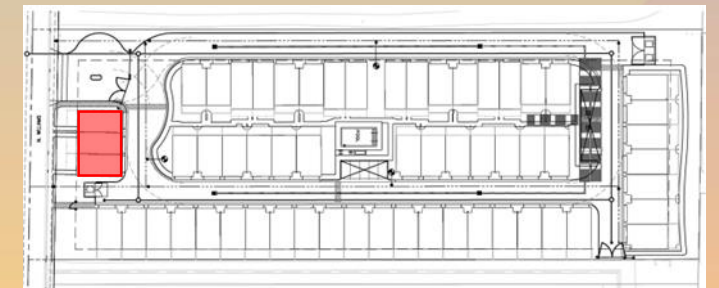



Renderings





Renderings





Renderings





Renderings





Colors and Materials

James Hardie – Plank Lap Siding
– Timber Bark



Sherwin-Williams – Egret White

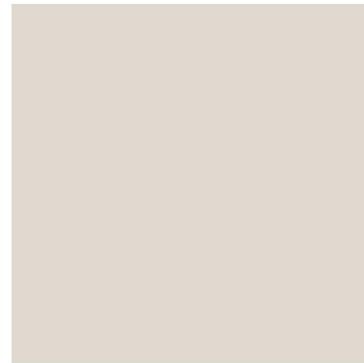

Cultured Stone – Pro Fit® -
Ledgestone



PPG - Stonehenge Greige



CMU Wall - Painted to match
Crystal Haze #DE6219



Dark Anodized Bronze - Parking
Canopies & Trash
Enclosure Doors





Lighting

Project	Catalog #	Type
Prepared by	Notes	Date



McGraw-Edison BRT6 Bollard

Round LED Pedestrian Luminaire

Interactive Menu

- Ordering Information page 1
- Product Specifications page 2
- Optical Distributions page 3
- Energy and Performance Data page 4

Product Certifications



Quick Facts

- 4 Optical Distributions
- Available in 30", 36", and 42"
- Lumen packages range from 560 - 4400 (5W - 49W)
- Efficacy up to 122 lumens per watt
- Zero uplight on all configurations

Dimensional Details

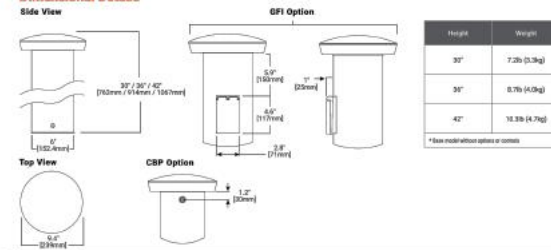

Project	Catalog #	Type
Prepared by	Notes	Date



Streetworks GLAN Galleon II

Area / Site Luminaire

Product Features



Interactive Menu

- Ordering Information page 2
- Mounting Details page 3
- Optical Distributions page 5
- Product Specifications page 6
- Energy and Performance Data page 6
- Control Options page 10

Quick Facts

- Lumen packages range from 3,300 - 73,500 (33W - 552W)
- 16 optical distributions
- Efficacy up to 159 lumens per watt
- Options to meet Buy American and other domestic preference requirements

Dimensional Details

Number of Light Sources	Width "W"	Mounting Length "L"	Weight with Standard or 90° Arm	SPS with Standard or 90° Arm
1-4	16"	22"	29 lb	0.95
5-6	22"	22"	39 lb	0.95
7-9	22"	28-1/8"	48 lb	1.1

NOTES:
1. For arm extension requirements and additional line art, see Mounting Details section.
2. Not Certified for DMX (D) and not for use only.



VISION VPF4

Vandal Resistant

VPF4 Series LED

Fixture Type	Date
Job Name	Approved By
Catalog Number	

SPECIFICATIONS

Description	The Vision VPF4 series features an all aluminum, ligature resistant construction which allows it to be used in nearly any environmental condition. Designed in conjunction with an ophthalmologist, the polycarbonate lens provides complete control of glare and LED image while maintaining the high efficiency of clear optical material. The Vision VPF4 series can be row mounted to any length. Natsatorium finish is standard for all versions of this fixture.
Housing	Marine grade heat treated extruded aluminum. Finished with Super Durable Corrosion Resistant powder coat (SDCR) that meets AAMA 2605 high performance specification, providing superior UV durability and corrosion resistance. Salt spray test: 4,000 hours.
Lens	Extruded UV stabilized polycarbonate with integral prisms. Maximum wall thickness 0.160". Secured to housing with die cast aluminum clamps and stainless steel TORX® head screws.
End Caps	Die cast marine grade aluminum with conduit knockouts that are visible from interior of end cap.
Drivers	Dimming to 1%, 10% or Programmable Lumen Output driver options. Non-Dimming Driver is also available.
LED	Samsung LM561B+ series @ 2700K, 3000K, 3500K, 4000K, or 5000K and 82 CRI wired in parallel-series. L ₉₀ projected life of over 130,000 hours at 50°C.
UL Listing	UL, C,UL, Damp Location Listing standard, Wet Location Listing optional.
Buy American	Luminaire LED, LLC products are assembled in the USA. Our products meet the Buy American(n) government procurement requirements under FAR, DFARS, and DOT. Please refer to www.aaculitybrands.com/buy-american for additional information.
Warranty	Lifetime warranty against vandalism. Luminaire LED will repair or replace any fixture damaged due to vandalism for the lifetime of the installation. 10-year warranty on LED boards against operational defects. Tested in accordance with LM-80.
Note	Actual performance may differ as a result of end-user environment and application. All values are design or typical values, measured under laboratory conditions at 25 °C. Specifications subject to change without notice.

DIMENSIONAL DATA

	A	B	C
VPF4 1FT	15.50	4.35	2.70
VPF4 2FT	26.10	4.35	2.70
VPF4 3FT	37.88	4.35	2.70
VPF4 4FT	49.69	4.35	2.70





Findings

- ✓ Staff is seeking your review and recommendation on the following:
 - ✓ Proposed building and landscape architecture

Staff welcomes any feedback



Design Review Board



Renderings





Renderings





Renderings





Renderings





Renderings





Renderings

