

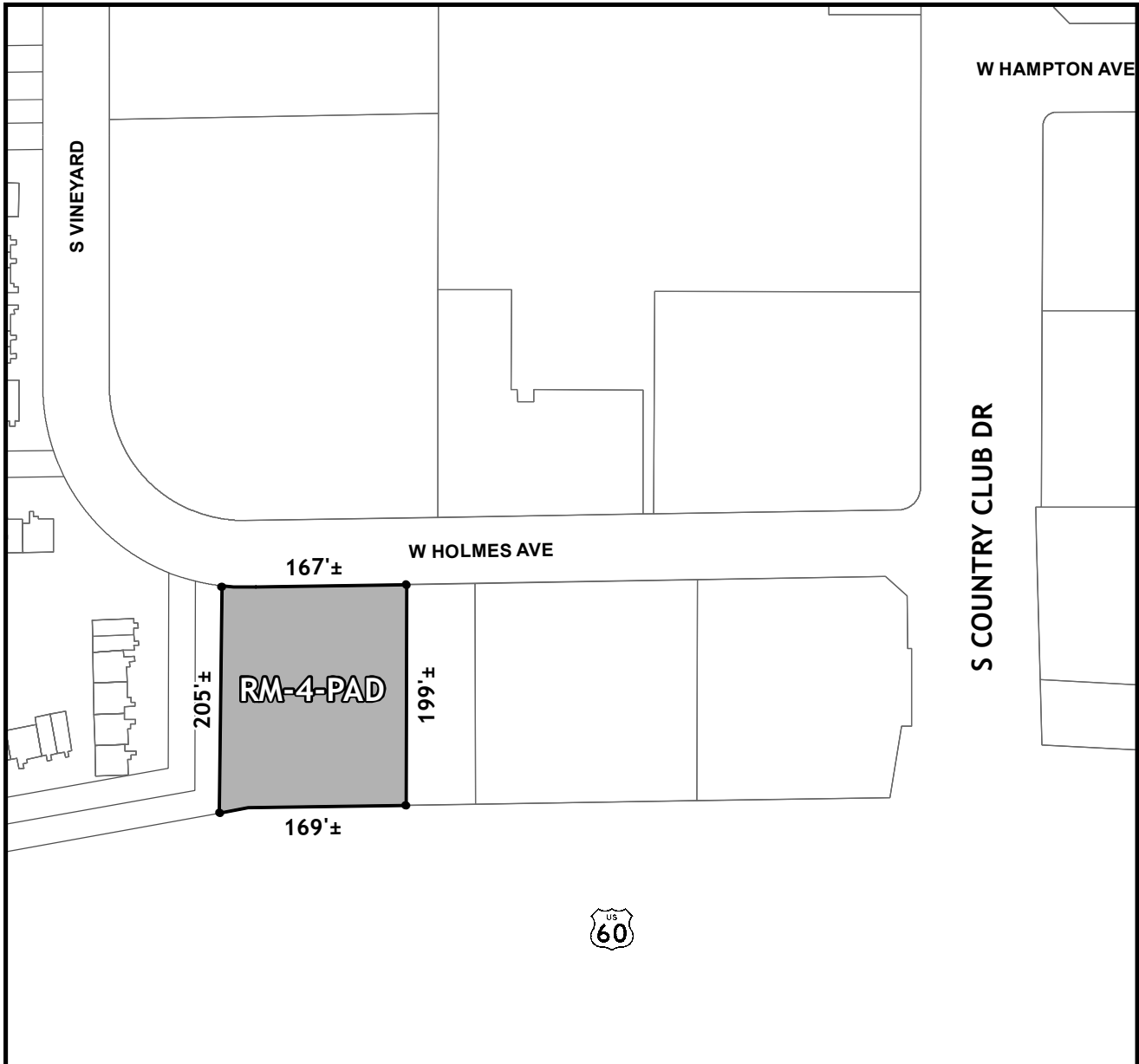

OFFICIAL SUPPLEMENTARY ZONING MAP AMENDING THE CITY OF MESA ZONING MAP



CASE: ZON21-00793

ACREAGE: 0.8±

REQUEST: Rezone from Limited Commercial (LC) to Multiple Residence 4 with a Planned Area Development overlay (RM-4-PAD) and Site Plan Review.

ORDINANCE: _____

Please be advised that the attached zoning changes were approved by the Mesa City Council on _____, 2022 by Ordinance # _____. If you have any questions concerning these changes, contact the City of Mesa Planning Division at 480-644-2385.

_____ ATTEST: _____ DATE: _____

MAYOR CITY CLERK