



SAIA MOTOR FREIGHT LINE, LLC
PROPOSED TRUCKING
FREIGHT FACILITY
E PECOS ROAD, CITY OF MESA,
MARICOPA COUNTY, ARIZONA

No.:	Date:	Description:
1	DEC 03, 2024	REVISED PER CITY OF MESA COMMENTS, DATED NOVEMBER 22, 2024

LANDSCAPE PLAN

Project No.: 2023-0302.01

Cadd File:

Drawn By: JJS

Checked By: BJC

Date: 03/29/2024

Copyright: © 2023 H.F. LENZ COMPANY

Drawing Number

L1.01

Sheet 0 of 00

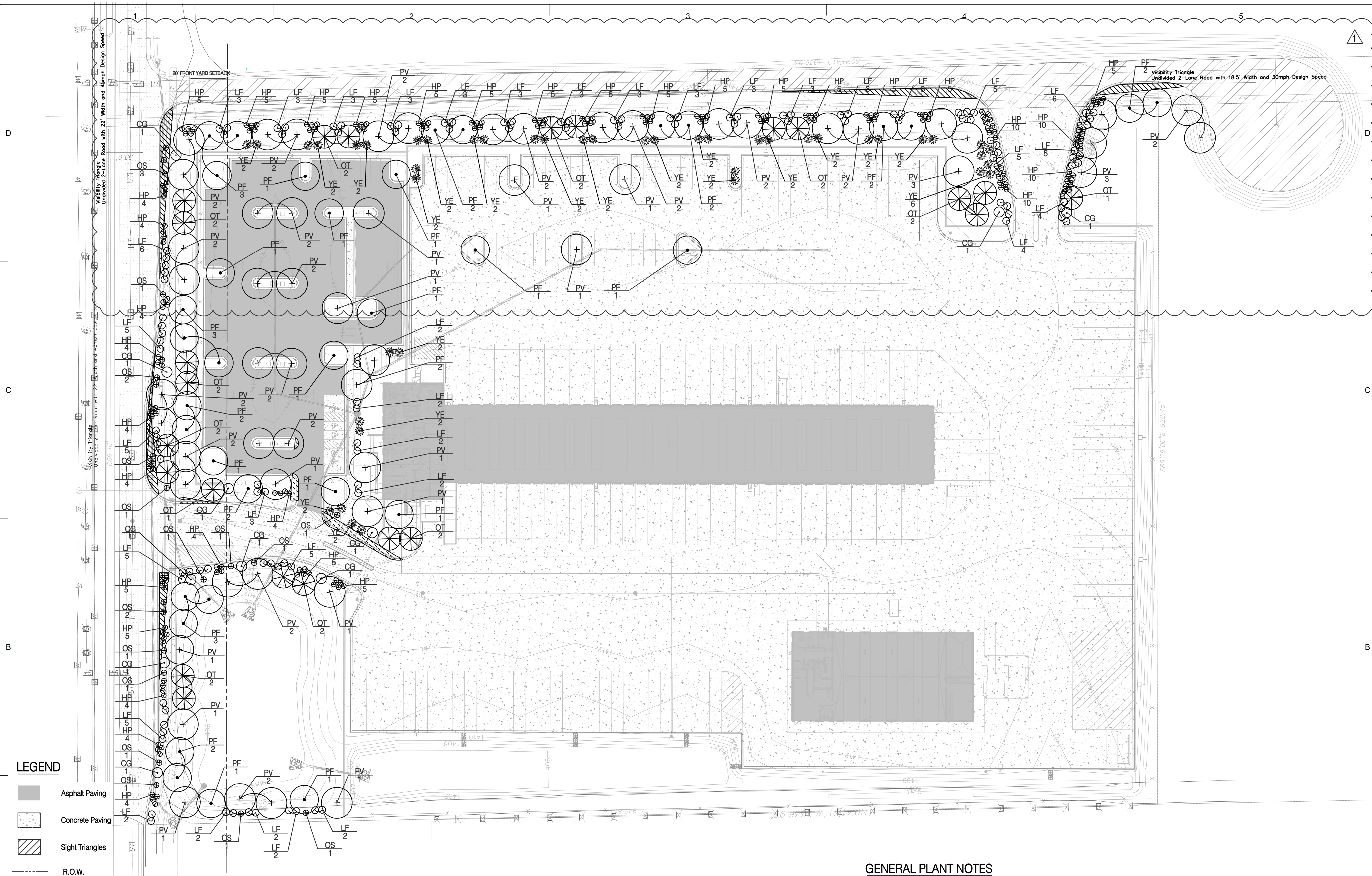

GENERAL PLANT NOTES

- It will be the responsibility of the property owner to perpetually maintain all landscape areas and associated plant material required under City of Mesa codes.
- All unhealthy or dead plant material shall be replaced within one year, or by the next planting period, whichever comes first, while other defective plant material shall be replaced or repaired within three (3) months.
- All plant material located within a utility easement that is damaged or removed due to work required by the utility company shall be immediately replaced by the owner in accordance with City code.
- Street trees shall be planted in a manner that does not affect public safety and maintains proper sight distances.
- Irrigation will be provided as required. This irrigation system shall be designed to provide adequate watering of the proposed plant material. The system shall consist of several watering zones controlled by a central timer with either pop-up and rotating irrigation heads or a drip line system. The proposed system shall be installed prior to planting. See Sheets LT-03 - LT-05 for Irrigation Plan and Schedule.
- Landscape plantings must be installed prior to occupancy of the site or at the next available planting season. These plantings are to be maintained Prior to the issuance of the occupancy certificate. An inspection is required to ensure all plantings have been installed as shown on the final approved plans.
- "Desert Cobble" consisting of natural desert covers and seed to be installed in all landscaped areas and basins not covered by seed, or riprap (see in engineer's drawings).

PLANTING NOTES

1. The Contractor must verify the location and depth of all existing and proposed underground utilities and facilities prior to beginning construction activities, as per Act 38, call 1-800-242-1776.
2. The Contractor shall stake out the location of all proposed plant material for review by the Owner's Representative prior to installation.
3. The Contractor shall not deviate from the proposed Plant Schedule without written approval by the Owner's Representative.
4. All plant material shall be in accordance with the American Standard for Nursery Stock, latest edition.
5. Substitutions: When plants of a specified type or size are not available within a reasonable distance, substitutions may be made upon request by the Contractor, if approved by the Owner's Representative. The Contractor shall notify the Owner's Representative in writing of any plant material which will not be available, prior to submitting a bid on this project. If a bid is received without such qualification, it will be assumed no such substitution will be proposed.
6. Plants with broken root balls or excessive damage to the crown will be replaced at no charge to the Owner prior to installation.
7. Trees in leaf when planted shall be treated with anti-desiccant such as Wiltproof (or an occupational equivalent approved by the Owner's Representative).
8. Preparation of planting soil: before mixing, clean topsoil of roots, vegetation, stones, clay lumps, and other extraneous materials harmful to plant growth. Planting soil for trees shall be amended as directed by the soil test results completed by the Contractor. Provide a copy of the soil test results to the Owner's Representative.
9. The Contractor is responsible for any adjustments to soil pH, fertility, and/or drainage conditions necessary to ensure proper growing conditions for proposed plantings. Proposed solution to be presented to and approved by the Owner's Representative prior to execution.
10. Field conditions may dictate minor adjustments to the location of plant material. Before adjustments of plant locations occur, the Contractor shall notify the Owner's Representative.
11. Contractor to give 48 hour notice to Owner's Representative before planting occurs, so Owner's Representative can approve layout of plants.
12. Quantities in Plant Schedule to override quantities shown on Site Landscape Plan.
13. Trees shall be installed no less than 3' from back of curb.

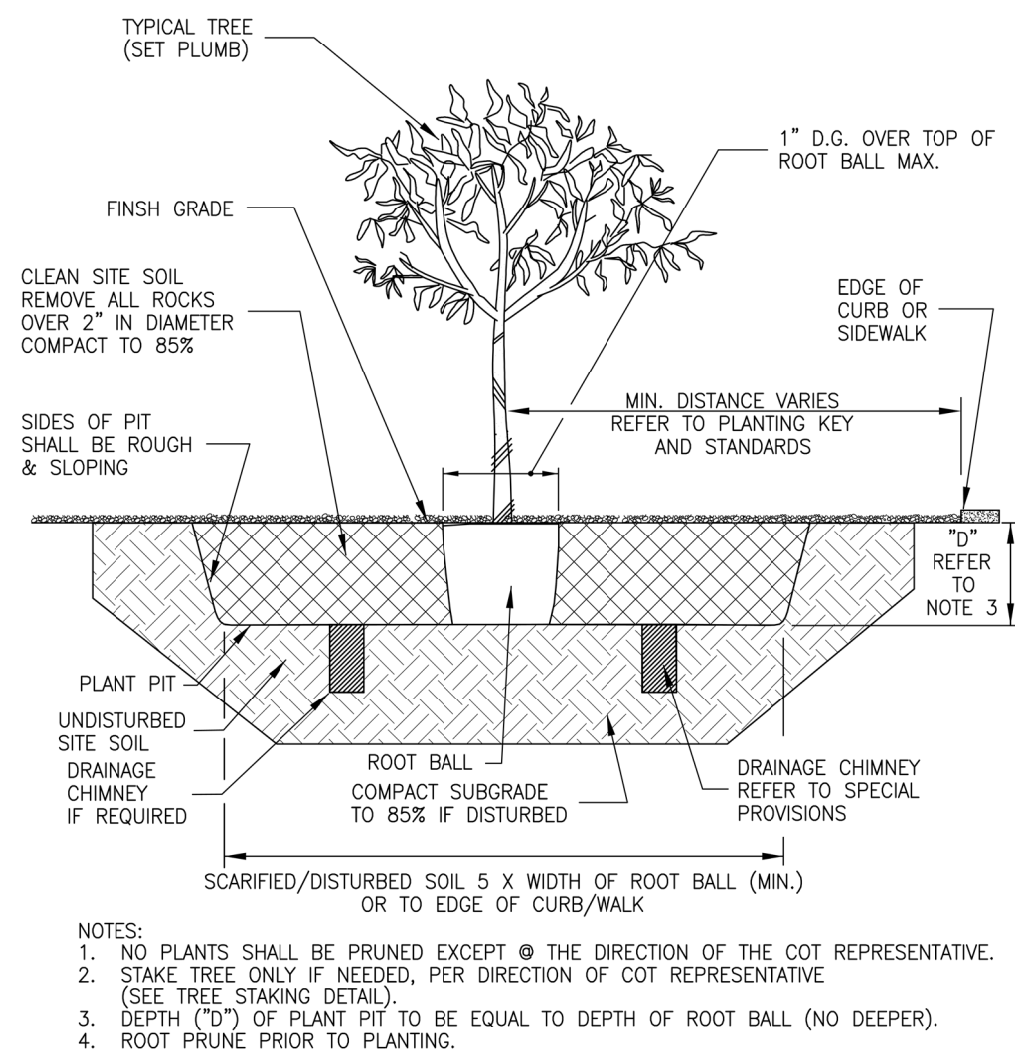

1 TREE PLANTING DETAIL
NTS

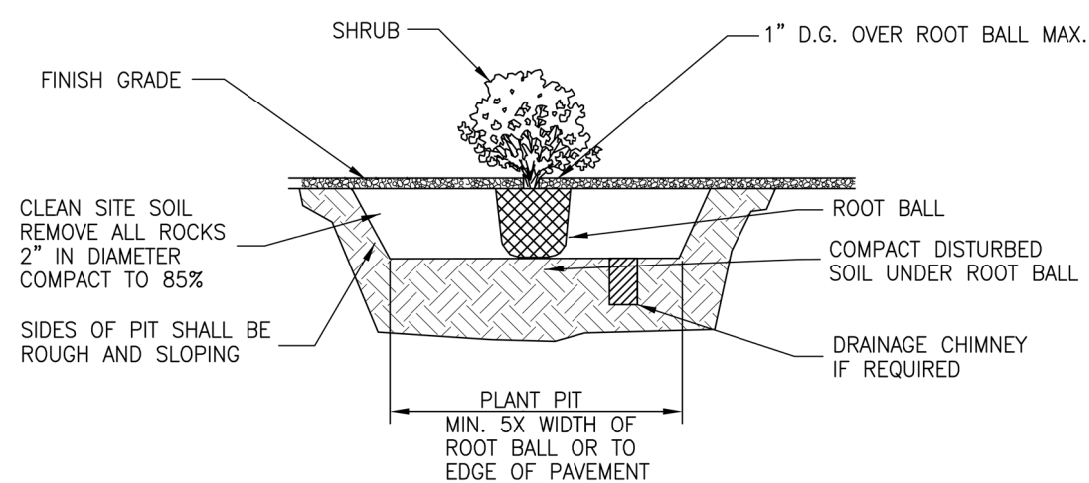

2 SHRUB PLANTING: 1 & 5 GALLON PLANTS
NTS

Planting Schedule

SAIA Mesa, Arizona

CODE	SCIENTIFIC NAME	COMMON NAME	SIZE	QUANTITY	SPACING
TREES & SHRUBS					
PF	<i>Parkinsonia florida</i>	Blue Palo Verde	36-Inch Box	35	As shown
PV	<i>Prosopis velutina</i>	Velvet Mesquite	24-Inch Box	55	As shown
OT	<i>Olneya tesota</i>	Desert Ironwood	24-Inch Box	23	As shown
LF	<i>Leucophyllum frutescens</i>	Texas Sage	5 GAL	119	As shown
CACTI & SUCCULENTS					
CG	<i>Carnegieia gigantea</i>	Saguaro	15 GAL	11	As shown
HP	<i>Hesperaloe parviflora</i>	Red Yucca	5 GAL / TOS	179	As shown
OS	<i>Opuntia santa-rita</i>	Santa Rita Prickly Pear	5 GAL / TOS	20	As shown
YE	<i>Yucca elata</i>	Soaptree yucca	5 GAL / TOS	44	As shown



ENGINEERING

AZ #: 13460-0

Headquarters:
1407 Scalp Avenue
Johnstown, PA 15904
814-269-9300
www.hflenzen.com

Consultants:

environmental planning & design uk

100 ross street, suite 500 pittsburgh, pa 15219
www.epd-pgh.com 412.261.6000

Seal:

Seal:



Project Identification:

SAIA MOTOR FREIGHT LINE, LLC
PROPOSED TRUCKING
FREIGHT FACILITY

E PECOS ROAD, CITY OF MESA
MARICOPA COUNTY, ARIZONA

[illegible]

Sheet Title

LANDSCAPE DETAILS & NOTES

Project No.: 2022-0602.01

Cadd File

Drawn By

JDS

Checked By

03/29/2024

Copyright: C 2023 H.F. LENZ COMPANY

Drawing Number

L1.02

Sheet 0